

Hand Held Can Opener

USE AND CARE GUIDE
MODELS 2244/2244B/2244CAN



IMPORTANT SAFEGUARDS

When using electrical appliances, basic safety precautions should always be followed, including the following:

- ◆ Read all instructions.
- ◆ To protect against risk of electrical shock do not put cord, plugs, or appliance in water or other liquid.
- ◆ Close supervision is necessary when any appliance is used by or near children.
- ◆ Unplug from outlet when not in use, before putting on or taking off parts, and before cleaning.
- ◆ Avoid contacting moving parts.
- ◆ Do not operate any appliance with a damaged cord or plug, or after the appliance malfunctions, or is dropped or damaged in any manner. Contact Consumer Service.
- ◆ The use of attachments not recommended or sold by manufacturer may cause fire, electrical shock or injury.
- ◆ Do not use outdoors.
- ◆ Do not let cord hang over edge of table or counter.
- ◆ Do not let cord contact hot surface, including the stove.
- ◆ Do not open pressurized (aerosol-type) cans.
- ◆ Do not open cans of flammable liquids, such as lighter fluids.

SAVE THESE INSTRUCTIONS

For Household Use Only

ADDITIONAL IMPORTANT SAFEGUARDS

- ◆ All users of this appliance must read and understand this Use and Care Guide before operating or cleaning this appliance.
- ◆ The cord to this appliance should be plugged into a 120V AC electrical outlet only.
- ◆ Do not leave this appliance unattended during use.
- ◆ If this appliance begins to malfunction during use, immediately unplug the cord. Do not use or attempt to repair the malfunctioning appliance.



- ◆ If this appliance falls or accidentally becomes immersed in water, unplug it immediately. Do not reach into the water! Do not use this appliance after it has fallen into or becomes immersed in water.
- ◆ To reduce the risk of injury to persons or property, never use this appliance in an unstable position.
- ◆ Do not use this appliance for other than its intended use.

Polarized Plug

This appliance has a polarized plug, (one blade is wider than the other). To reduce the risk of electrical shock, this plug is intended to fit into a polarized outlet only one way. If the plug does not fit fully in the outlet, reverse the plug. If it still does not fit, contact a qualified electrician. Do not attempt to modify the plug in any way.

Do not use an extension cord with this product.

Electric Power

If the electrical circuit is overloaded with other appliances, your appliance may not operate properly. It should be operated on a separate electrical circuit from other appliances.

Operating Instructions Before First Use

1. Carefully unpack the Can Opener.
2. Make sure the Can Opener is unplugged. Wipe with a soft, clean cloth or sponge. Never immerse the Can Opener in water or any other liquid.
3. Carefully insert the Operating Lever into the Can Opener. Hold the Can Opener facing you with the Lever in the lifted position and slide the Pivot into the Pivot Hole. Push the Lever towards the Soft-Touch Handle (see Figures 2 and 3). Fold the Magnet up for storage.
4. Plug Can Opener into electrical outlet and press down on the Operating Lever to make sure it is operating properly.

CAUTION: Risk of personal injury. Keep hands from beneath the Operating Lever where the Geared Wheel and Cutting Blade are located.

This Can Opener is designed for food contact. DO NOT use to open cans with non-food substances in them such as paint, aerosols, etc.

Getting to know your **Toastmaster** Can Opener

Product may vary slightly from illustrations.

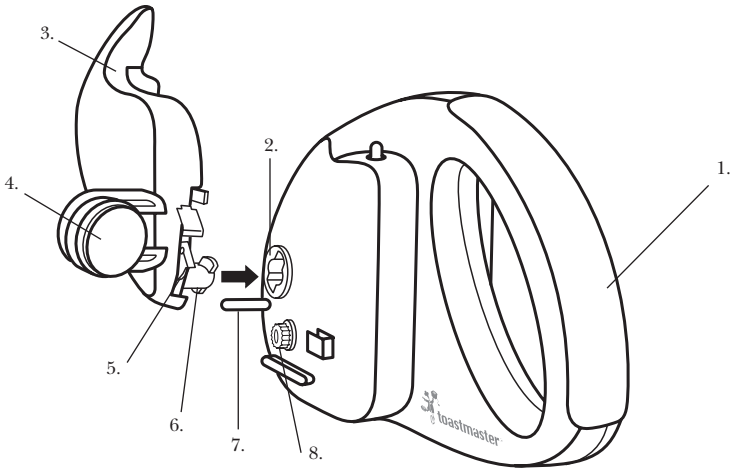

FIGURE 1

- 1. Soft Touch Handle
- 2. Pivot Hole
- 3. Piercing Lever
- 4. Magnet

- 5. Cutting Blade
- 6. Pivot
- 7. Guide Bar
- 8. Geared Wheel

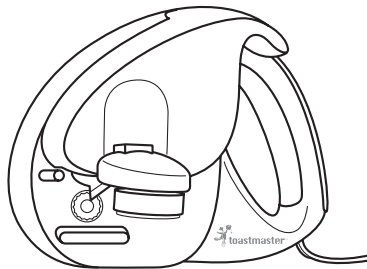

FIGURE 2



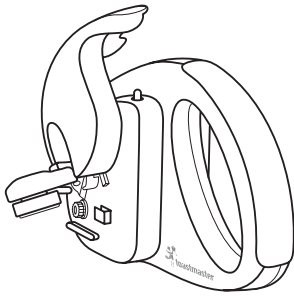

FIGURE 3

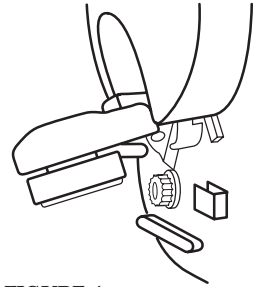

FIGURE 4

Using The Can Opener

See Operating Instructions Before First Use for assembly instructions.

1. Remove all packaging materials before using.
2. Place the Can Opener on a level surface and plug into 120V~60 Hz electrical outlet.
3. Fold the Magnet down in the operating position as shown in Figure 2.
4. Place can level.
5. Raising Piercing Lever, place can under Guide Bar and against Geared Wheel, see Figure 4.
6. Press down on Lever to pierce lid of can. Release the Lever and can will stop automatically when opened.
7. Grasp the can, then raise the Lever up from the can.
8. Slide the lid away from the Magnet. Use caution to avoid injury from sharp edge of lid.

CAUTION: Always unplug Can Opener from electrical outlet when not in use and before cleaning. Never immerse Can Opener, cord or plug in water or any other liquid.

CAUTION: Do not use scouring pads or any type of harsh cleansers that may damage the surfaces or dull the Cutting Blade.

User Maintenance Instructions

This appliance requires little maintenance. It contains no user serviceable parts. Do not try to repair it yourself. Refer it to a qualified appliance repair technician if servicing is needed.

Care And Cleaning

1. Unplug the unit from electrical outlet. The Can Opener should be kept clean to avoid food contamination.
2. To remove Lever, hold the Can Opener facing you. Lift the Lever away from the Soft-Touch Handle (as shown in Figure 1) and pull the Lever away from the Can Opener.
3. Wash Lever in warm, soapy water and wipe the outside surfaces of the unit with a damp cloth.
4. To replace the Lever, hold the Can Opener facing you with the Lever in the lifted position and slide the Pivot into the Pivot Hole. Push the Lever towards the Soft-Touch Handle (see Figures 2 and 3). Fold the Magnet up for storage.

NOTE: Cutting Blade is sharp, use caution.

Storage

1. Unplug the Can Opener and clean as instructed above.
2. Make sure all parts are dry and store appliance in its original box or in a clean, dry drawer or cabinet.
3. Never store with cord plugged in. Do not wrap cord tightly around the appliance.



LIMITED ONE-YEAR WARRANTY

Warranty Coverage: This product is warranted to be free from defects in materials or workmanship for a period of one (1) year from the original purchase date. This product warranty is extended only to the original consumer purchaser of the product and is not transferable. For a period of one (1) year from the date of original purchase of the product, our Repair Center will, at its option, either (1) repair the product or (2) replace the product with a reconditioned comparable model. These remedies are the purchaser's exclusive remedies under this warranty.

Warranty Service: To obtain warranty service, you must call our warranty service number at 1-800-233-9054 for return instructions on how to deliver the product, in either the original packaging or packaging affording an equal degree of protection to the Repair Center specified below. You must enclose a copy of your sales receipt or other proof of purchase to demonstrate eligibility for warranty coverage.

To return the appliance, ship to:

ATTN: Repair Center
708 South Missouri Street
Macon, MO 63552 USA

To contact us, please write to, call, or email:

Consumer Relations Department
PO Box 7366
Columbia MO 65205-7366 USA
1-800-233-9054
E-mail:
consumer_relations@toastmaster.com

What Is Not Covered: This warranty does not cover damage resulting from misuse, accident, commercial use, improper service or any other damage caused by anything other than defects in material or workmanship during ordinary consumer use. This warranty is invalid if the serial number has been altered or removed from the product. This warranty is valid only in the United States and Canada.

LIMITATION ON DAMAGES: THERE SHALL BE NO LIABILITY FOR ANY INCIDENTAL OR CONSEQUENTIAL DAMAGES FOR BREACH OF ANY EXPRESS OR IMPLIED WARRANTY OR CONDITION ON THIS PRODUCT.

DURATION OF IMPLIED WARRANTIES: EXCEPT TO THE EXTENT PROHIBITED BY APPLICABLE LAW, ALL IMPLIED WARRANTIES AND CONDITIONS, INCLUDING, WITHOUT LIMITATION, IMPLIED WARRANTIES AND CONDITIONS OF MERCHANTABILITY AND FITNESS FOR A PARTICULAR PURPOSE OR USE ON THIS PRODUCT ARE LIMITED IN DURATION TO THE DURATION OF THIS WARRANTY.

Some jurisdictions do not allow the exclusion or limitation of incidental or consequential damages, or allow limitations on how long an implied warranty lasts, so the above limitations or exclusions may not apply to you. This warranty gives you specific legal rights and you may have other rights under the laws of your jurisdiction.

For more information on our products, visit our website: www.maxim-toastmaster.com.

Keep Dated Sales Receipts for Warranty Service.

Keep this booklet. Record the following for reference:

Date purchased _____

Model number _____

Date code (stamped on bottom) _____

EVERYBODY EATS. It's a fact of life.

**But sometimes preparing
meals can become a chore.**

**That's why TOASTMASTER has been invited
into millions of kitchens just like yours
so we can HELP YOU MASTER your
mixing, baking, grilling, toasting,
brewing, heating and serving
tasks WITH EASE AND STYLE.**

**The TOASTMASTER name stands for a
CELEBRATION of INNOVATION designed
to serve your life and keep you
COOKIN' IN STYLE.**





toastmaster®

- Soft-touch handle
- Compact stylish design
- Automatic shut-off
- Removable cutting assembly
- Coiled cord
- Stores in drawer - reduces counter-top clutter



Questions

Call toll free 1-800-947-3744

Monday – Friday, 8:00 a.m. - 5:30 p.m. CST

www.maxim-toastmaster.com

2244/2244B/2244CAN

Download from www.Somanuals.com. All Manuals Search And Download.

Free Manuals Download Website

<http://myh66.com>

<http://usermanuals.us>

<http://www.somanuals.com>

<http://www.4manuals.cc>

<http://www.manual-lib.com>

<http://www.404manual.com>

<http://www.luxmanual.com>

<http://aubethermostatmanual.com>

Golf course search by state

<http://golfingnear.com>

Email search by domain

<http://emailbydomain.com>

Auto manuals search

<http://auto.somanuals.com>

TV manuals search

<http://tv.somanuals.com>