

## READ AND SAVE THESE INSTRUCTIONS

**WARNING:** A risk of fire and electrical shock exists in all electrical appliances and may cause personal injury or death. Please follow all safety instructions.



**toastmaster®**  
cookin' in style



# 4-Slice Toaster-Oven-Broiler with Removable Liner

Use and Care Guide

Models 362B and 362W

- DISHWASHER SAFE REMOVABLE NON-STICK LINER
- LARGE CAPACITY HANDLES 4 SLICES OF TOAST, 8" PIE PAN
- 15 MINUTE TIMER
- AUTO SHUT-OFF WHEN COOKING TIME IS REACHED
- INCLUDES WIRE RACK, BAKE/BROIL PAN AND BROIL INSERT
- ADJUSTABLE THERMOSTAT

# IMPORTANT SAFEGUARDS

When using electrical appliances, basic safety precautions should always be followed to reduce the risk of fire, electric shock and injury to persons, including the following:

- Read all instructions before using appliance.
- Close supervision is necessary when any appliance is used near children.
- This appliance is not for use by children.
- Do not touch hot surfaces. Use handles or knobs and oven mitts.
- Do not operate any damaged appliance. Do not operate with a damaged cord or plug, or after the appliance malfunctions or has been dropped or damaged in any manner. Return appliance to the nearest authorized service center facility for examination, repair, electrical or mechanical adjustment.
- Before using this appliance, move it four to six inches from the wall or any object on the countertop. Do not store any item on top of the appliance. Do not use on surfaces where heat may cause a problem.
- A fire may occur if this appliance touches or is covered by flammable material, including curtains, draperies, walls, etc., when in operation.
- Do not store any materials, other than manufacturer's recommended accessories, in this oven when not in use.
- Do not cover part of the oven with metal foil. This will cause overheating of the oven.
- Extreme caution should be exercised when using containers constructed of other than metal.
- Do not place any flammable material such as paper, cardboard, plastic, etc. in the oven.
- When broiling, the bake/broil tray and broil insert rack must be used.
- Oversized foods or utensils must not be inserted into the toaster-oven-broiler.
- Do not immerse cord, plug or appliance in water or other liquid. See instructions for cleaning.
- Do not use outdoors or while standing in damp area.
- Do not clean with metal scouring pads. Pieces of the pad may break off and touch electrical parts.
- Unplug from outlet when not in use and before cleaning. Allow to cool before attaching or removing parts and before cleaning the appliance.
- **CAUTION:** Never leave toaster-oven-broiler unattended when broiling or toasting.
- Do not let cord hang over edge of table or counter, or touch hot surfaces.
- The toaster-oven-broiler is off when the temperature knob and the timer are in the off position.
- Extreme caution must be used when moving an appliance containing hot oil or other hot liquids.
- Use extreme caution when removing broiling tray or disposing of hot grease.

- Do not place on or near a hot gas or electric burner or in a heated oven.
- Use attachments only if recommended by Toastmaster Inc.
- Only use appliance as indicated in these instructions.

## SAVE THESE INSTRUCTIONS

**CAUTION:** A short power supply cord is provided to reduce the risk of personal injury resulting from becoming entangled in or tripping over a longer cord. Extension cords are available from local hardware stores and may be used if care is exercised in their use. If an extension cord is required, special care and caution is necessary. Also the cord must be: (1) marked with an electrical rating of 125 V and at least 13A., 1625 W., and (2) the cord must be arranged so that it will not drape over the countertop or tabletop where it can be pulled on by children or tripped over accidentally.

**POLARIZED PLUG:** This appliance has a polarized plug, (one blade is wider than the other). As a safety feature to reduce the risk of electrical shock, this plug is intended to fit in a polarized outlet only one way. If the plug does not fit fully in the outlet, reverse the plug. If it still does not fit, contact a qualified electrician. Do not attempt to defeat this safety feature.

**ELECTRIC POWER:** If the electric circuit is overloaded with other appliances, your appliance may not operate properly. It should be operated on a separate electrical circuit from other appliances.

This product is for household use only.

Remove all packaging materials including the piece of paper that has been placed between the top of the oven door and oven for protection during shipping. Also remove the piece of cardboard that has also been placed between the bottom of the oven door and the oven.

Your product may vary slightly from illustration.

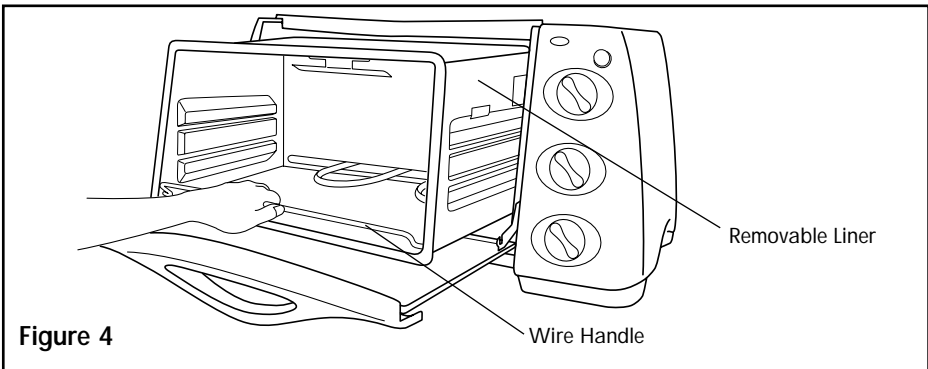
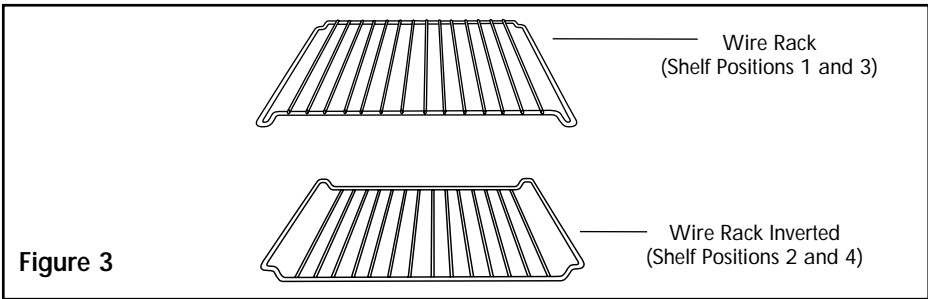
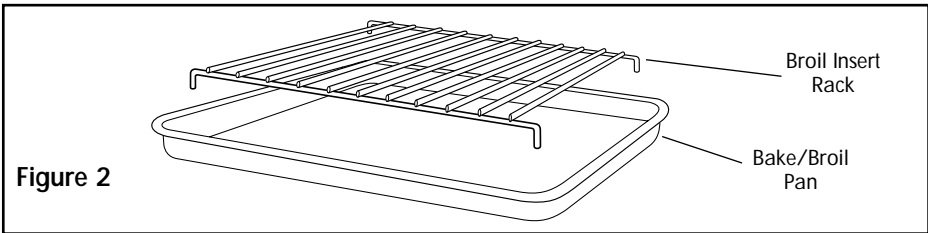
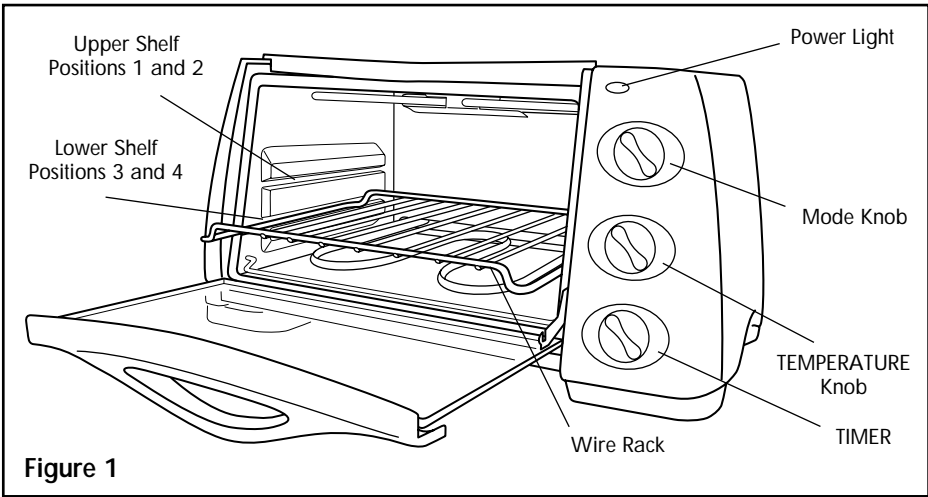

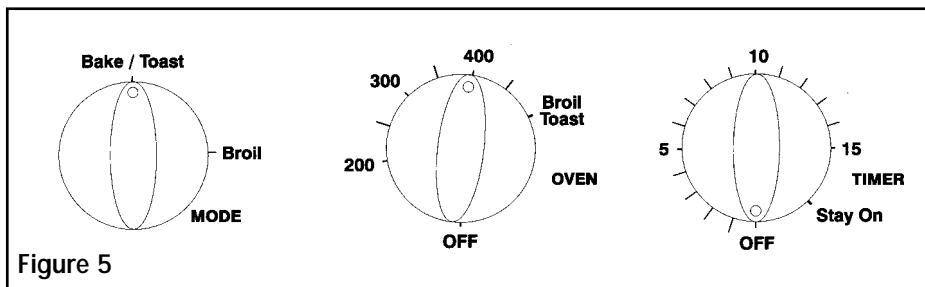

## GETTING TO KNOW YOUR TOASTER-OVEN-BROILER

Your new Toastmaster toaster-oven-broiler has the versatility to bake, broil, defrost, toast, top brown and keep foods warm. The adjustable thermostat allows you to prepare recipes according to package or recipe directions. The Power Light will be on any time the unit is operating. Both upper and lower heating elements will be on when toasting, baking, defrosting, top browning and keeping foods warm. Only the upper elements will be on when broiling.

**CAUTION: APPLIANCE SURFACES ARE HOT DURING AND AFTER USE.**  
**CAUTION: ALWAYS WEAR PROTECTIVE, INSULATED OVEN MITTS ON HANDS WHEN TOUCHING HOT OVEN OR HOT DISHES AND FOOD OR WHEN INSERTING OR REMOVING RACK, PAN OR BAKING DISH.**

Ovenware manufacturers do not recommend using see through glass baking containers or lids in this oven. Glass-ceramic baking containers may be used. Do not use oven roasting bags in this oven, as they may come in contact with the heating elements. If you have any questions regarding the use of either of these items, please contact the manufacturer.

### BAKE/BROIL PAN, TOAST RACK AND BROIL INSERT

For best results use pan to bake, defrost, top brown, keep warm and to minimize clean-up due to spills.

For toasting, place bread directly on rack.

When broiling, both the pan and the broil insert rack must be used.

### TIMER

The TIMER control dial also acts as the oven's ON and OFF switch. Turn the timer clockwise to select the appropriate cooking time up to 15 minutes. When timer is complete, a signal will sound and the unit will turn off automatically. If cooking for less than 10 minutes, using the timer is not recommended.

If you do not wish to use the timer feature or are cooking for more than 15 minutes, turn the dial to **STAY ON** to turn the oven on and watch food for doneness. Turn dial to **OFF** position when cooking is complete.

### **WIRE RACK**

The wire rack must be used for all cooking functions. It may be inserted in either the upper or lower shelf position as shown in Figure 1.

The wire rack may also be inverted for two additional positions (see Figure 3). Each section of instructions suggest a specific position, however, the rack may be adjusted to accommodate the different thickness of foods.

### **INSTRUCTIONS FOR TOAST**

1. Remove pan and rack.
2. Plug into 120 V ~ 60 Hz outlet.
3. Center food on rack. Place in shelf position 2 or 3 of oven and close the door.
4. Turn **MODE** knob to Bake/Toast position and **TEMPERATURE** knob to Broil/Toast position.
5. Set the **TIMER** to the desired toast shade. This will start the toast cycle. The power light will come on. Medium colored toast takes approximately 5 minutes. Additional toast cycles require less time since the oven cavity is already warm.
6. The unit shuts off automatically when the cycle is complete. The power light will go off. Open the door and remove the toast.  
**NOTE:** Watch toast until desired color is achieved and shut off unit manually by turning the timer to the **OFF** position.
7. When finished, turn the **TEMPERATURE** knob to **OFF** and the **TIMER** to **OFF**. The power light will go off.
8. Unplug and allow to cool completely before cleaning.

### **HINTS FOR TOAST**

- Follow toaster food directions.
- Frozen and heavy bread require a darker setting (e.g. bagels and English muffins.)
- One slice requires a lighter setting than several slices.

### **INSTRUCTIONS FOR TOP BROWN**

1. Remove pan and rack.
2. Plug into 120 V ~ 60 Hz outlet.
3. Center a baking container or food on rack, or use bake pan. Place on rack in shelf position 1 or 2 and close door. Food should be approximately 2 inches from the top heating element.
4. Turn **MODE** knob to Bake/Toast position and **TEMPERATURE** knob to Broil/Toast position.
5. Set the **TIMER** to the desired time. This will start the top brown cycle. The power light will come on.

6. The unit shuts off automatically when the cycle is complete. The power light will go off.  
NOTE: Watch food to avoid over-browning. To stop cycle manually, turn the timer to the OFF position. Open the door and remove the food.
7. When finished, turn the TEMPERATURE knob to OFF and the TIMER to OFF.
8. Unplug and allow to cool before cleaning.

### **HINTS FOR TOP BROWN**

- For darker results set the TIMER for additional time to restart the cycle. Watch until desired color is achieved and turn TIMER off manually.
- Top Brown may be used to top brown bagels, English muffins or melt cheese on sandwiches or casseroles.

### **INSTRUCTIONS FOR KEEP WARM**

1. Remove pan and rack.
2. Plug into 120 V ~ 60 Hz outlet.
3. Center a baking container or food on the rack, or use bake pan; place in shelf position 2 or 3 and close door.
4. Turn MODE knob to Bake/Toast position. Turn TEMPERATURE knob to 200°F. Turn TIMER to desired time. The power light will come on.
5. When finished turn the TEMPERATURE knob to OFF and TIMER to OFF. The power light will go off. Open the door and remove the food.
6. Unplug and allow to cool completely before cleaning.

### **HINTS FOR KEEP WARM**

- Use for short periods of time after food is cooked.
- To heat frozen or cold foods, see instructions for defrost.

### **INSTRUCTIONS FOR BAKE**

1. Remove pan and rack.
2. Plug into 120 V ~ 60 Hz outlet.
3. Center a baking container or food directly on rack or use bake pan. Place in shelf position 2 or 3 of oven and close door.
4. Turn MODE to Toast/Bake and TEMPERATURE knob to desired setting. Turn TIMER to desired time. Allow 7 minutes for preheat. The power light will come on.
5. Bake according to package or recipe directions.
6. When finished turn the TEMPERATURE knob to OFF and TIMER to OFF. The power light will go off. Open the door and remove the food.
7. Unplug and allow to cool before cleaning.

## HINTS FOR BAKE

- To prevent heat loss, avoid opening door excessively.
- Foil may be used to cover glass-ceramic baking container if ends are tucked closely against edge of pan.

## INSTRUCTIONS FOR DEFROST

1. Remove pan and rack.
2. Plug into 120 V ~ 60 Hz outlet.
3. Place rack in shelf position 2 or 3 of oven.
4. Center a baking container or food on rack or use bake pan.
5. Turn MODE knob to Bake/Toast position. Turn TEMPERATURE knob to 200°F. Turn TIMER to desired time. The power light will come on.  
NOTE: Defrost will take approximately 1/3 of the time recommended on the package for defrosting at room temperature.
6. When finished turn the TEMPERATURE knob to OFF and the TIMER knob to OFF. The power light will go off. Open the door and remove the food.
7. Unplug and allow to cool completely before cleaning.

## HINTS FOR DEFROST

- Do not use this method for meat, poultry or fish.
- Do not cover food.
- Brush frozen dough with vegetable oil to prevent drying out and remove food to preheat oven before baking.

## INSTRUCTIONS FOR BROIL

1. Remove pan and rack.
2. Place broil insert in bake pan and position food on broil insert.
3. Place rack in shelf position 2 of oven.
4. Plug into 120 V ~ 60 Hz outlet.
5. Turn MODE knob to Broil and TEMPERATURE knob to the Broil/Toast position. Turn TIMER to desired time. The power light will come on. Preheating is not necessary.
6. Broil according to package or recipe instructions.
7. When finished turn the TEMPERATURE knob to OFF and TIMER to OFF. The power light will go off. Open the door and remove the food.
8. Unplug and allow to cool completely before cleaning.

## HINTS FOR BROIL

- Always use pan with the broil insert; this allows juices and fat to drip into tray and decreases spattering while broiling.
- Do not place aluminum foil on top of broil insert; this traps grease and can cause a fire.
- Trim excess fat from meat and score edges to reduce curling and smoke.
- Always thaw meats before broiling.
- Remove grease from tray and wash after each use.



## **CLEAN-UP OF INTERIOR**

Your toaster-oven-broiler features a removable interior that is dishwasher safe.

1. Always unplug and allow to cool completely before cleaning or moving.
2. Remove pan and rack. Wash with a non-abrasive cleaner, rinse and dry thoroughly or clean in a dishwasher.
3. Carefully remove the interior by grasping the wire handle and by pulling straight out, see Figure 4.
4. Clean with a mild non-abrasive cleaner and rinse and dry thoroughly. The interior may also be placed in the dishwasher for cleaning.
5. Slide interior back into the oven and close oven door.

## **CLEAN-UP OF OVEN DOOR AND EXTERIOR**

1. Always unplug and allow to cool completely before cleaning or moving.
2. Clean with glass cleaner or mild detergent and damp cloth or plastic scouring pad. Do not use an abrasive cleaner or pad as they might scratch the finish.
3. Rinse and dry thoroughly with a clean cloth. Allow to dry before closing door.

**Any servicing requiring disassembly other than the above cleaning must be performed by an authorized service center.**

## **SERVICE INFORMATION**

Please refer to warranty statement to determine if in-warranty service applies. This appliance must be serviced by a Toastmaster authorized service center. Unauthorized service will void warranty. Consult your phone directory under "Appliances-Household-Small-Service and Repair," or call 1-800-947-3744 in the U.S. and Canada, 52-5-397-2848 in Mexico.

If an authorized service center is not available locally, your appliance may be returned postage prepaid to our National Service Center at the address shown on the back of this book.

Products must be adequately protected to avoid shipping damage. Surround your appliance with three inches of protective padding and include a copy of your dated sales receipt and a note explaining the problem you have experienced. We recommend insuring your package. No CODs accepted.

## **KEEP DATED SALES RECEIPT FOR WARRANTY SERVICE.**

Keep this booklet. Record the following for reference:

Date purchased \_\_\_\_\_

Model number \_\_\_\_\_

Date code (stamped on bottom) \_\_\_\_\_

## LIMITED ONE-YEAR GUARANTEE

Toastmaster Inc. warrants this product, to original purchaser, for one year from purchase date to be free of defects in material and workmanship.

This warranty is the only written or express warranty given by Toastmaster Inc. This warranty gives you specific legal rights. You may have other rights which vary from state to state. ANY OTHER RIGHT WHICH YOU MAY HAVE, INCLUDING ANY IMPLIED WARRANTY OF MERCHANTABILITY OR FITNESS FOR A PARTICULAR PURPOSE IS LIMITED IN DURATION TO THE DURATION OF THIS WARRANTY.

Defective product may be brought or sent (freight prepaid) to an authorized service center listed in the phone book, or to Service Department, Toastmaster Inc., 708 South Missouri St., Macon, MO 63552, for free repair or replacement at our option.

Your remedy does not include: cost of inconvenience, damage due to product failure, transportation damages, misuse, abuse, accident or the like, or commercial use. IN NO EVENT SHALL TOASTMASTER INC. BE LIABLE FOR INCIDENTAL OR CONSEQUENTIAL DAMAGES.

Some states do not allow limitations on how long an implied warranty lasts, or allow the exclusion or limitation of incidental or consequential damages, so the above limitations or exclusions may not apply to you.

For information, write Consumer Claims Manager, at the Macon address. Send name, address, zip, telephone area code and daytime number, model, serial number, and purchase date.

**EVERYBODY EATS. It's a fact of life.**

**But sometimes preparing  
meals can become a chore.**

**That's why TOASTMASTER has been invited  
into millions of kitchens just like yours  
so we can HELP YOU MASTER your  
mixing, baking, grilling, toasting,  
brewing, heating and serving  
tasks WITH EASE AND STYLE.**

**The TOASTMASTER name stands for a  
CELEBRATION of INNOVATION designed  
to serve your life and keep you  
COOKIN' IN STYLE.**

## Free Manuals Download Website

<http://myh66.com>

<http://usermanuals.us>

<http://www.somanuals.com>

<http://www.4manuals.cc>

<http://www.manual-lib.com>

<http://www.404manual.com>

<http://www.luxmanual.com>

<http://aubethermostatmanual.com>

Golf course search by state

<http://golfingnear.com>

Email search by domain

<http://emailbydomain.com>

Auto manuals search

<http://auto.somanuals.com>

TV manuals search

<http://tv.somanuals.com>