

TOSHIBA

Satellite® P25 Series

Ultimate digital convergence desktop replacement notebook

Feature Model(s):

Satellite P25-S507

P4 2800/17.0" Wide XGA/512MB/60GB/DVD-R/RW/Mdm/LAN/Wi-Fi/WinXP Home

Satellite P25-S508

P4 2800/17.0" Wide XGA/512MB/60GB/DVD-R/RW/Mdm/LAN/Wi-Fi/WinXP Pro

Product Highlights

Performance

- Intel® Pentium® 4 Processor with Hyper-Threading Technology
- 512MB of Main Memory
- 60GB* hard disk drive

Great Features

- 17.0" Wide XGA active matrix display
- **NVIDIA® GeForce™ FX Go5200**, 32MB DDR video memory
- DVD-R/RW multi-function drive

Get On-Line

- Integrated V.92/56K modem
- Integrated 10/100 Ethernet LAN
- Integrated **802.11a/b** Wireless LAN

System Characteristics

CPU (See CPU Performance Disclaimer)**

- Intel® Pentium® 4 processor; 2.80GHz**

L2 Cache

- 512KB Level 2 Cache integrated on die
- 800MHz Processor System Bus Clock Speed (PSB) / Hyper-Threading Technology support

Memory

- 512MB DDR SDRAM (**Expandable to 2048MB**) (Both slots may be occupied)
- Expansion memory: 128/256/512/1024MB, 2.5V, SODIMM, PC2100 DDR SDRAM
- Data/Address Bus Width; 64-bit/32-bit
- Intel® 865PE + ICH5 Chipset

Mass Storage

- **Primary Hard Disk Drive:** 60GB* hard disk drive, 4200rpm, Enhanced IDE (ATA-5) Interface, 9.5mm height, 0.2lbs., Service removable
- **Main Module Bay - DVD-R/RW:** ATAPI Interface; Maximum speed (READ): CD-R(24x), CD-RW(12x), CD-ROM(24x), DVD-ROM(8x), DVD-R(4x), DVD-RW(4x), DVD-RAM(1x); Maximum speed (WRITE): CD-R(16x), CD-RW(4x), HS (High Speed) CD-RW(10x), DVD-R(1x), DVD-RW(1x);
Compatibility: CD-ROM, CD-R (read/write), CD-RW (read/re-write), DVD-ROM. DVD-R (read/write), DVD-RW (read/write), DVD-RAM (read);
Optional accessories: DVD-ROM, DVD/CD-RW, DVD-R/RW, DVD Multi, FDD, 2nd HDD; 12.7mm height, user removable
- **2nd Module Bay:** Main Battery; (Optional Accessories: DVD-ROM, DVD/CDRW, DVD Multi, DVD-R/RW, weight saver)
- Software Decoder: InterVideo® (WinDVD™)

Graphics/Video

- **17.0"** Wide XGA TFT active-matrix display****; internal display supports up to 16M colors at 1440 x 900
- **NVIDIA® GeForce™ FX Go5200** graphics controller; 32MB DDR external video memory
- Direct X 9.0 support, OpenGL support
- External Color Support/Refresh Rate: (Depending on CRT)

800 x 600;	60/70/72/75/85/100/120Hz
1024 x 768;	60/70/72/75/85/100/120Hz
1280 x 1024;	57/60/70/72/75/85/100/120Hz
1440 x 900;	60/70/72/75/85/100Hz
1600 x 1200;	60/70/72/75/85/100Hz
1680 x 1050;	60/70/72/75/85/100Hz
1920 x 1200;	60Hz
1920 x 1440;	60Hz
2048 x 1536;	60Hz

Part Numbers

PSP20U-00VY3V

PSP20U-00VY36

Input Devices

- **Keyboard:** Full sized 85 keys with 12 function keys, 2.7mm key stroke, 6mm height; Dedicated Windows® & Application keys support; HotKey function; **TouchPad** pointing device.
- **CD Control Function:** Play/Pause, Stop/Eject, Previous, Skip/Next, Mode Control switch (CD/DVD/Digital Audio)
- *Optional:* Toshiba Remote Control: Power On/Shut Down, CD/DVD/Digital Audio play control, Volume Control, Keyboard Emulation, Task change, Maximize Window
- Toshiba Console button & Instant Access Internet button
- One Touch TV-out switch

Expandability

- 2 memory slots (*Both slots may be occupied*)
- 2 PC Card slot supports 2 Type II and 1 Type III

Communications

- Integrated V.92/56K modem; Data and fax support
- Integrated 10/100 Ethernet LAN
- Integrated 802.11a/b Wireless LAN – (Atheros)

Due to FCC limitations, speeds of 53kbps are the maximum permissible transmission rates during Download. Actual data transmission speeds will vary depending on line conditions.

Ports

- RGB (monitor) port
- Parallel port
- 4 Universal Serial Bus ports (**USB 2.0**)
- 2 Infrared port (1 Consumer IR port – *Optional Toshiba Remote Control*; 1 FIR port)
- TV-Out (S-Video)
- RJ-45 LAN port
- RJ-11 modem port
- I.Link (IEEE 1394) port
- Secure Digital® (SD) card slot

Physical Description

- Dimensions (LxWxH): 16.4" x 11.5" x 1.8"
- Weight: 9.9lbs
- LED Indicators: Power, HDD, 2nd HDD (common with Module Bay device), DVD/CDRW, DC-IN, Caps Lock, Arrow, Numeric, Main Battery Charging Status, System Sleep/Suspend Status, SD Card, Wireless Communication (right side)

Sound

- Realtek ALC202 Codec Chip, Software Sound
- 16-bit stereo, Windows Sound System Ver. 2.0; SoundBlaster® Pro compatible (in DOS box only)
- **Built-in harman/kardon Stereo Speakers**
- Direct 3D Sound (supported by sound driver); Hardware acceleration for DirectSound and DirectMusic; Full Duplex and MIDI (play back) support
- Sound Volume (by Dial)
- **Ports:** External Microphone port, headphone port (stereo), Line-in port

Power Supply

- **AC Adapter:** 120W AC Adapter, 100-240V / 50-60Hz frequency (Universal) input voltage, 19V x 6.3A Output.
Dimensions (LxWxH): 5.9" x 2.5" x 1.4"
Weight: 1.38lbs
- **Battery Pack:** 12-cell, rechargeable, removable Lithium Ion (Graphite) battery; 14.8V x 6450mAh
Dimension (LxWxH): 5.9" x 5.1" x 0.9"
Weight: 1.41lbs
- Battery Saver (in WindowsXP): Stand by, HDD Auto Off, Display Auto Off, Hibernation
- **Battery Life:** 2.0H ***

Toshiba America Information Systems Inc. ("TAIS") shall not be liable for damages of any kind for use of this information, which is subject to change without notice. Copyright 2003 TAIS satellite_P25-S507.doc Created on 6/11/2003 9:31 AM Rev. 1.0 Page 1 of 3

TOSHIBA

Recharge Time (Off/On): Main Battery– Up to 4Hrs/ Up to 12Hrs
Battery life may vary depending on applications, power management settings and features utilized. Recharge time varies depending on usage. Battery may not charge while computer is consuming full power. After a period of time, the battery will lose its ability to perform at maximum capacity and will need to be replaced. This is normal for all batteries. To purchase a new battery pack or see information on accessories shipping with your computer, visit the Toshiba website at www.accessories.toshiba.com

PA3109U-1FDD	USB Floppy Disk Drive
PA3133U-1H40	2nd HDD 40GB
PA3204U-1H60	2nd HDD 60GB
PA3230U-1H80	2nd HDD 80GB
PA3292U-1ETC	Modular Bay HDD Adapter
PA3294U-1DV1	Modular Bay DVD Multi
PA3273U-2MPC	Wireless LAN Mini-PCI (802.11a/b – Atheros)
PA3271U-1BTM	Bluetooth SD Card II
PA3304U-1ETC	Toshiba Remote Control

Security

- Slot for computer lock, HDD and memory (2 screws), Built-in Modem (2 screws), Wireless LAN module (2 screws), Main Module Bay and 2nd Module Bay (both by sliding lock and sliding latch), User Power-on password, Setup Security, Keyboard Lock (by HotKey), Screen Blank (by HotKey), Screen Saver (by software)

Bios

- ACPI, PnP, VESA, DPMS, DDC, SM BIOS, PCI BIOS support

Operating System

- **Microsoft® Windows XP Home** pre-installed (**P25-S507**)
- **Microsoft® Windows XP Pro** pre-installed (**P25-S508**)
- Microsoft® Windows 2000 component drivers on the web

Additional Software

- Microsoft® Works
- Panasonic MotionDV Studio
- Notebook Maximizer
- Intuit® Quicken® Basic
- Norton® AntiVirus™ 2002
- AOL® (3-month offer)
- Adobe® Acrobat Reader
- AT&T® Worldnet® Service – 1 Month Free
Telephone access and other charges and other terms and conditions may apply. Offer available to new customers only. Offer expires 4/30/04.
- Microsoft Internet Explorer
- Toshiba Custom Utilities
- Satellite Series Online Documentation
- **Toshiba Great Software Offer:** Receive your choice of two software titles. The software selection includes titles from the follow categories; productivity, education/reference, creativity and entertainment

Warranty

- 1 year parts, labor and battery

Environmental Specifications

- **Temperature:** Operating: 5° to 35°C (41° to 95°F); Non-operating: -20° to 65°C (-4° to 149°F)
- **Thermal gradient:** Operating: 15°C per hour maximum; Non-operating: 20°C per hour maximum
- **Relative Humidity:** Operating: 20% to 80% non-condensing; Non-operating: 10% to 95% non-condensing
- **Altitude (relative to sea level):** Operating: -60 to 3000 meters; Non-operating: -60 to 10,000 meters
- **Shock:** Operating: 10G; Non-operating: 60G
- **Vibration:** Operating: 0.5G; Non-operating: 1.0G

SelectServ® Warranty Programs

SWP-PEQQ3V	Warranty Extension to 3 Years
SWP-PEGQ3V	3 Year SystemGuard
SWP-PEQX3V	3 Year Depot Express
SWP-PEGX3V	3 Year SystemGuard + Depot Express
SWP-PEQN3V	3 Year Business On-Site Repair; Next Day Business Day Response
SWP-PEGN3V	3 Year SystemGuard + Business On Site Repair, Next Business Day Response

Product/Part Numbers

Satellite P25-S507	PSP20U-00VY3V
Satellite P25-S508	PSP20U-00VY36

Accessories

Selected Toshiba Accessories

PA3290U-1ACA	Global AC Adapter (120W)
PA3291U-1BRS	Primary Battery Pack (12 cell)

Toshiba America Information Systems Inc. ("TAIS") shall not be liable for damages of any kind for use of this information, which is subject to change without notice. Copyright 2003 TAIS satellite_P25-S507.doc Created on 6/11/2003 9:31 AM Rev. 1.0 Page 2 of 3

SD (Secure Digital) Memory

SD-M3203B3	32MB SD Card
SD-M6403B3	64MB SD Card
SD-M1283B3	128MB SD Card
SD-M2564B3	256MB SD Card

Kingston Memory

KTT3614/128	Kingston 128MB Memory
KTT3614/256	Kingston 256MB Memory
KTT3614/512	Kingston 512MB Memory
KTT3614/1G	Kingston 1GB Memory Module

Cases (Targus)

PA1323U-1NCS	Toshiba Roller/BackPack (case only suitable for this notebook)
--------------	---

* Go to www.accessories.toshiba.com for additional, available accessories

* GB = 1 Billion Bytes

** Central Processing Unit ("CPU") Performance Disclaimer:

CPU performance in your computer product may vary from specifications under the following conditions:

- use of certain external peripheral products
- use of battery power instead of AC power
- use of certain multimedia games or videos with special effects
- use of standard telephone lines or low speed network connections
- use of complex modeling software, such as high end computer aided design applications
- use of computer in areas with low air pressure (high altitude >1,000 meters or >3,280 feet above sea level)
- use of computer at temperatures outside the range of 5°C to 35°C (41°F to 95° F) or >25°C (77°F) at high altitude (all temperature references are approximate).

CPU performance may also vary from specifications due to design configuration.

Under some conditions, your computer product may automatically shut-down. This is a normal protective feature designed to reduce the risk of lost data or damage to the product when used outside recommended conditions. To avoid risk of lost data, always make back-up copies of data by periodically storing it on an external storage medium. For optimum performance, use your computer product only under recommended conditions. Read additional restrictions under "Environmental Conditions" in your product Resource Guide. Contact Toshiba Technical Service and Support for more information.

**** Small bright dots may appear on your TFT display when you turn on your PC. Your display contains an extremely large number of thin-film transistors (TFT) and is manufactured using high-precision technology. Any small bright dots that may appear on your display are an intrinsic characteristic of the TFT manufacturing technology.

Return Policy

TAIS does not accept the return of component parts, or bundled software, which have been removed from the PC system. Pro-rata refunds on individual PC components or bundled software, including the operating system, will not be granted. If you wish to return a complete PC system,

TOSHIBA

contact the TAIS dealer where you purchased the product, and comply with the dealer's standard return policies and procedures.

*** Business Winstone® 2002 BatteryMark™ Version 1.0

These models achieved the battery life times shown using Ziff Davis Media Inc.'s Business Winstone® 2002 BatteryMark™ Version 1.0. These tests were performed without independent verification by the VeriTest testing division of Lionbridge Technologies, Inc. ("VeriTest"). Neither Ziff Davis Media Inc. nor VeriTest makes any representations or warranties as to the results of the tests. Winstone® is a registered trademark and BatteryMark™ is a trademark of Ziff Davis Publishing Holdings Inc. in the U.S. and other countries. Copyright 2002 Ziff Davis Media Inc. All Rights Reserved. All products used in the tests were shipping versions available to the general public. The battery life results were achieved running the Business Winstone® 2002 BatteryMark™ Version 1.0 on the following system parameters. System parameters were set according to Ziff Davis Media Inc.'s recommendations.

NW2.8G(800MHz) w/HT, 17"WXGA, 256MB+256MB, 60GB(4200rpm), DVD-R/-RW, 1394/FIR, 802.11b(Agere), No BT Antenna, NV34M(32MB), 12cell, harman

Battery Life	Catalog Spec (1st)	2.0H
	(1st+2nd)	-
	Number of Conditioning Phase	1
	Life Test Run	2

A	CPU Name	Intel® Pentium®4 Processer	
	Processor info	speed	2.8GHz
		number of processors	1
	amount of RAM	512MB	
	Amount of secondary RAM cache	512KB	

B	Battery	type(1st)	Li-Ion
			14.8Vx6450mAh(12cell)
	model number(1st)	PA3291U-1BAS/1BRS	
	type(2nd)	-	
		-	
	model number(2nd)	-	
number of batteries	1st=1 , 2nd=0		

C	Graphics	nVIDIA NV34M
	amount and type of RAM	32MB
		DDR
	graphics driver name and version	nVIDIA Display Driver for NV34M
	graphics resolution and color depth, refresh rate	17"Wide 1440x900/32bit/60Hz

D	hard disk capacity	60GB (4200rpm)
	hard disk file system & transfer mode+C15	Enhanced IDE(ATA-5)
	hard disk controller model	Intel® 82801EBM
	size of hardware cache if any	-

E	operating system version, service pack	Windows XP Professional Savice Pack 1
	other special conditions	N/A

F	BIOS version	V0.10
	Power management setting	see another sheet

Front with display open

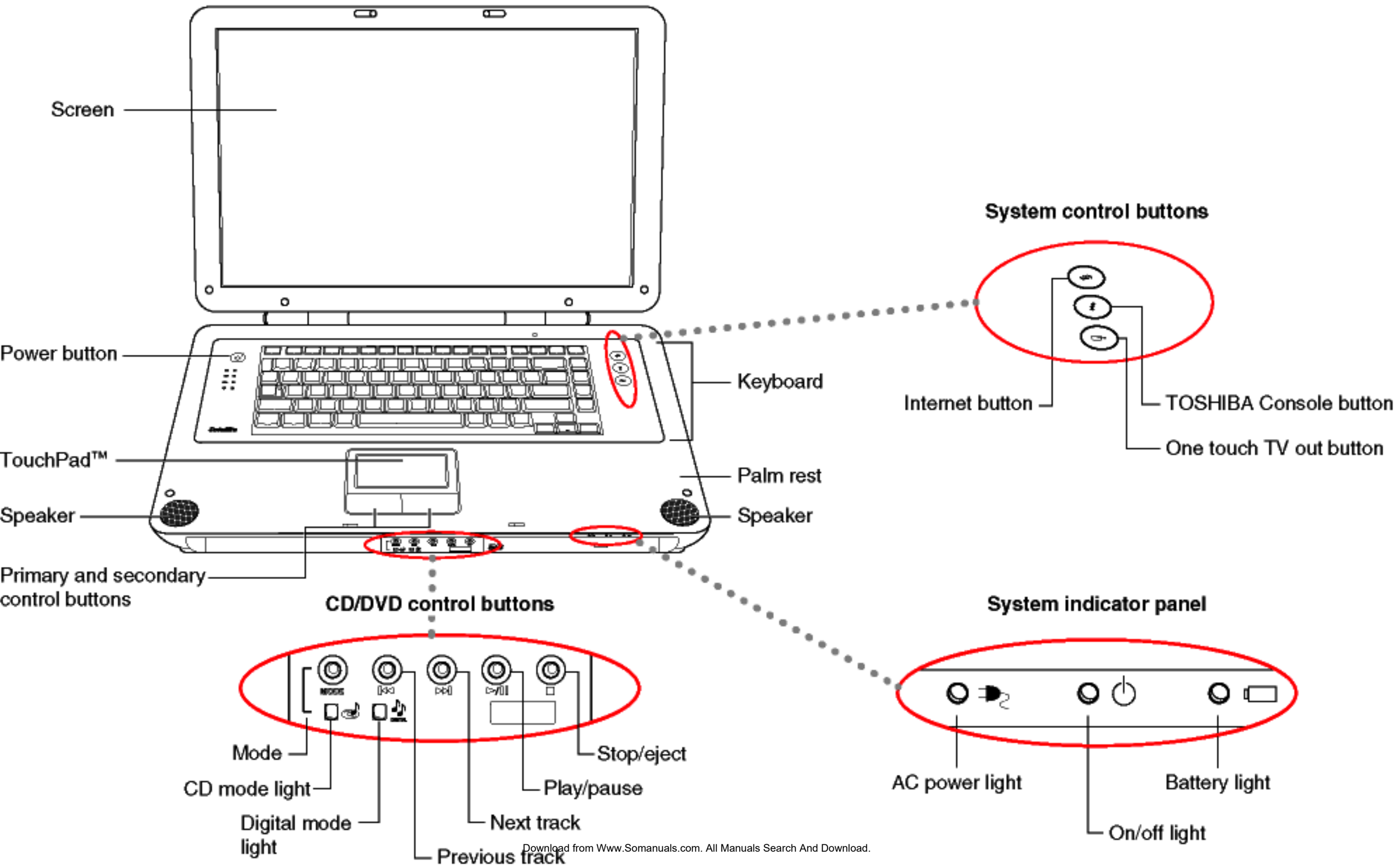

Front with display closed

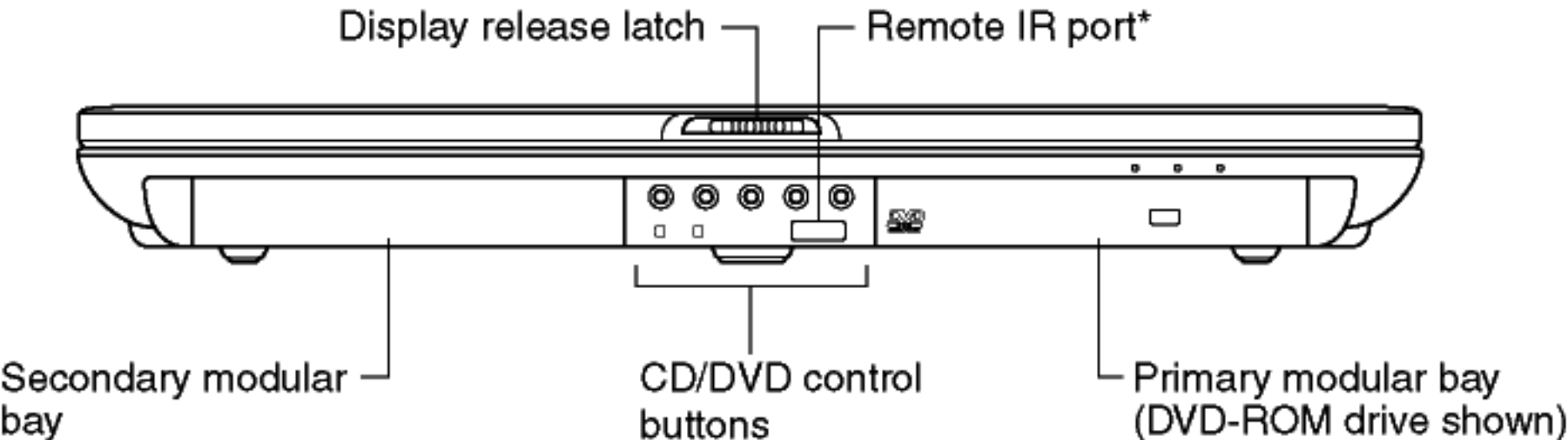

*Functional only on systems with Toshiba remote control.

Right side

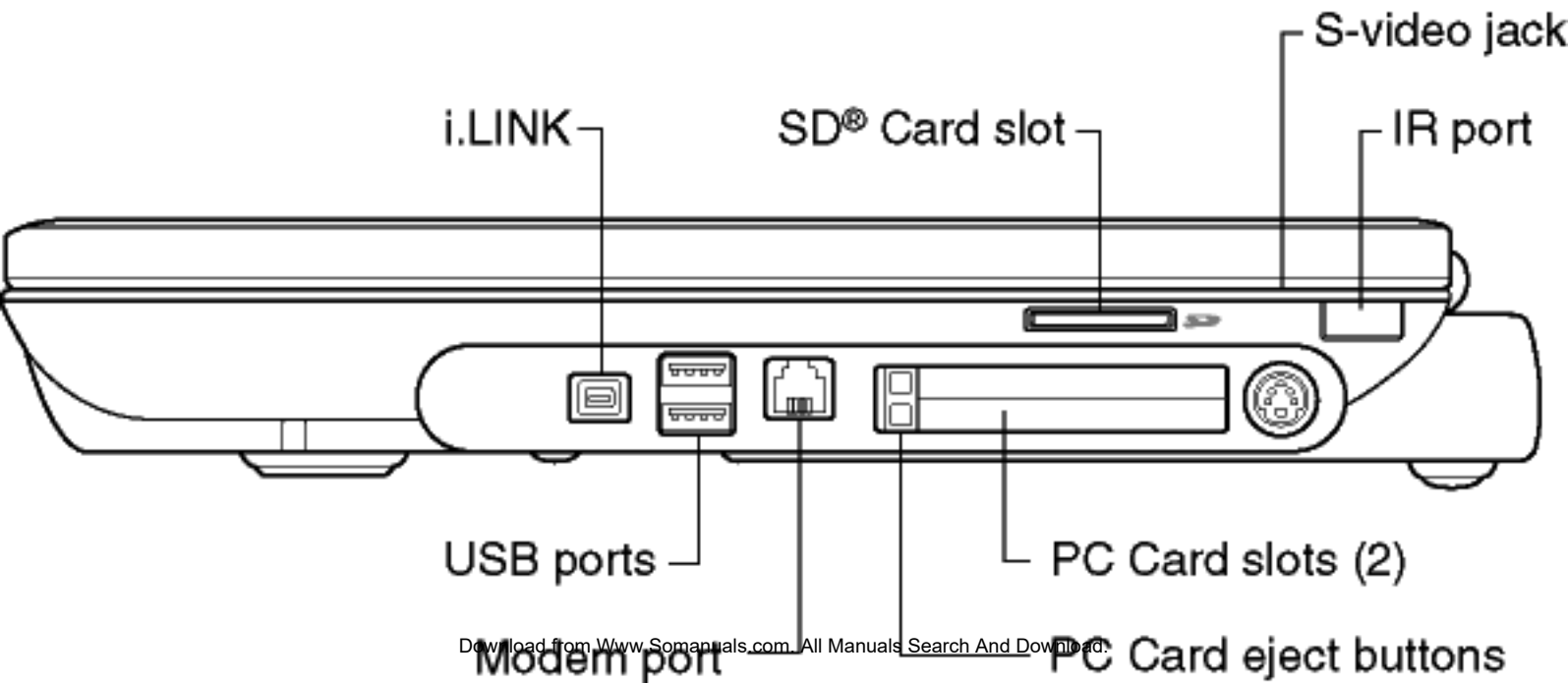

Left side

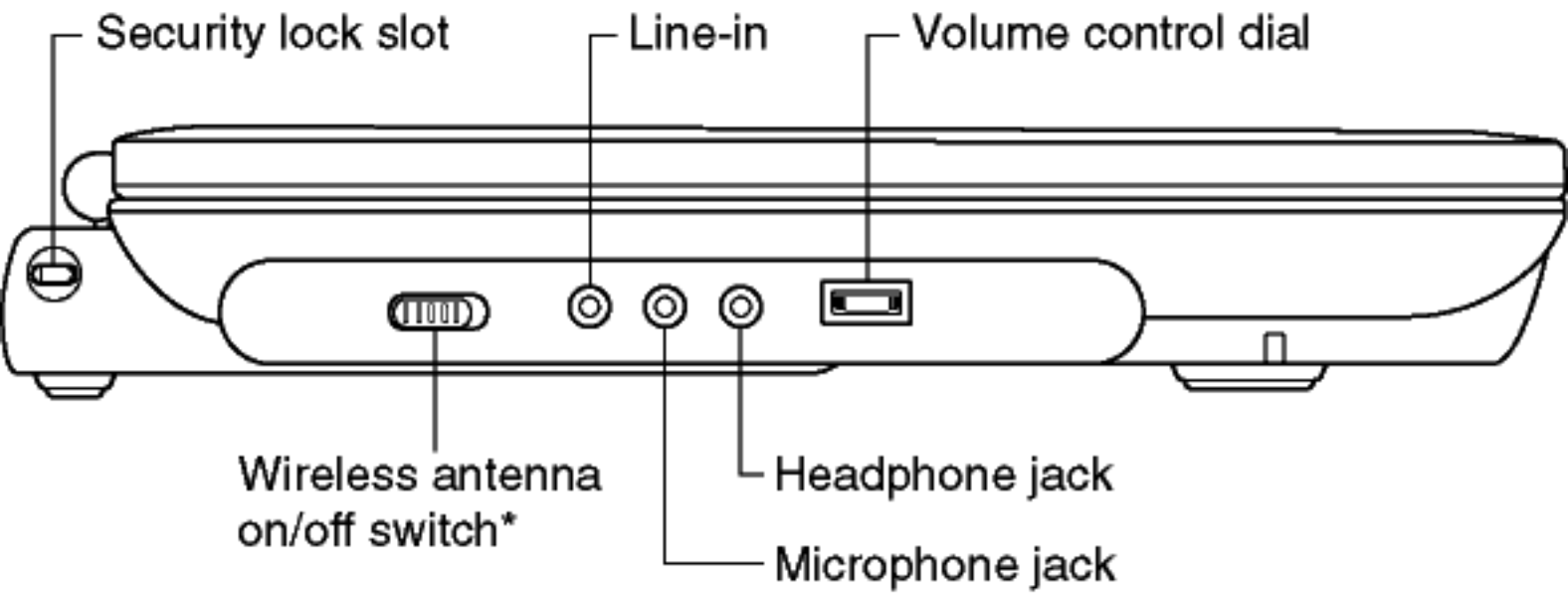

*Functional only on systems with wireless module installed.

Back

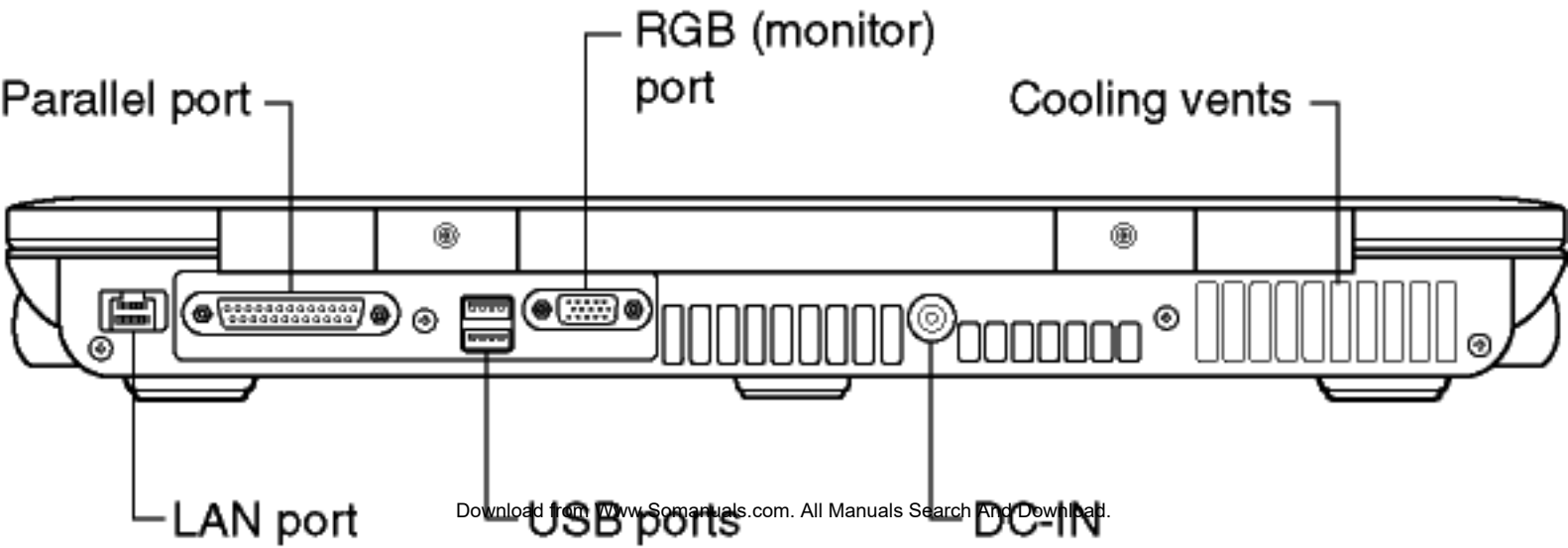

Underside

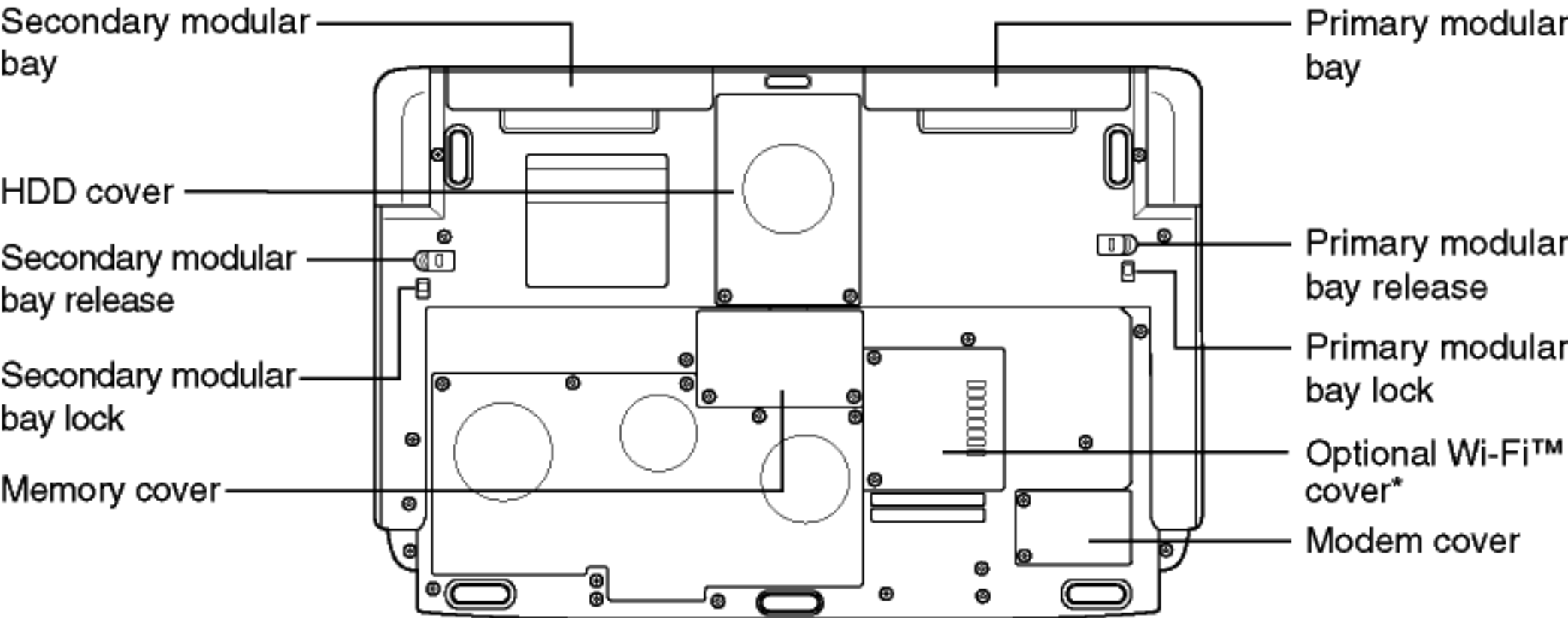

*Functional only on systems with wireless module installed.

Free Manuals Download Website

<http://myh66.com>

<http://usermanuals.us>

<http://www.somanuals.com>

<http://www.4manuals.cc>

<http://www.manual-lib.com>

<http://www.404manual.com>

<http://www.luxmanual.com>

<http://aubethermostatmanual.com>

Golf course search by state

<http://golfingnear.com>

Email search by domain

<http://emailbydomain.com>

Auto manuals search

<http://auto.somanuals.com>

TV manuals search

<http://tv.somanuals.com>