

# SEQUOIA

## 2009 Quick Reference Guide



# 2009 Sequoia

This *Quick Reference Guide* is a summary of basic vehicle operations. It contains brief descriptions of fundamental operations so you can locate and use the vehicle's main equipment quickly and easily.

The *Quick Reference Guide* is not intended as a substitute for the *Owner's Manual* located in your vehicle's glove box. We strongly encourage you to review the *Owner's Manual* and supplementary manuals so you will have a better understanding of your vehicle's capabilities and limitations.

Your dealership and the entire staff of Toyota Motor Sales, U.S.A., Inc. wish you many years of satisfied driving in your new Sequoia.

## ! A word about safe vehicle operations

This *Quick Reference Guide* is not a full description of Sequoia operations. Every Sequoia owner should review the *Owner's Manual* that accompanies this vehicle.

Pay special attention to the boxed information highlighted in color throughout the *Owner's Manual*. Each box contains safe operating instructions to help you avoid injury or equipment malfunction.

All information in this *Quick Reference Guide* is current at the time of printing. Toyota reserves the right to make changes at any time without notice.

# INDEX

## OVERVIEW

Engine maintenance	10
Fuel tank door release and cap	9
Hood release	9
Indicator symbols	6-7
Instrument cluster	5
Instrument panel	2-4
<b>Keyless entry<sup>1</sup></b>	<b>8</b>
Light control-Instrument panel	10

## FEATURES/OPERATIONS

Accessory meter	31
Air Conditioning/Heating	22-23
Audio	24-25
<b>Auto lock functions<sup>1</sup></b>	<b>12</b>
Automatic Transmission	11
Cruise control	20
Cup holders	31
Door locks	28
Door-Power back	19
Dynamic Laser Cruise Control	27
Four-wheel drive	12
Garage door opener (HomeLink <sup>®</sup> ) <sup>3</sup>	26
<b>Lights<sup>1</sup> &amp; turn signals</b>	<b>17</b>
Moonroof	20
<b>Multi-information display<sup>2</sup></b>	<b>28</b>
Parking brake	15
Power outlets-12V DC	30
Power outlets-115V AC	30
Rear seat entertainment system	25
Seat adjustments-Front	13
Seat adjustments-Rear	14
Seat ventilators/Heaters	23
Seats-Folding second row seats	15
Seats-Folding third row seats	16
Seats-Head restraints	13
Steering wheel switches	26
Telephone controls (Bluetooth <sup>®</sup> )	29
Tilt and telescopic steering wheel	21
"TOW/HAUL" switch	11
VSC OFF button	21
Window-Back	19
Windows	18
Windshield wipers & washers	18

## SAFETY AND EMERGENCY FEATURES

Doors-Child safety locks	33
Seat belts	32
Seat belts-Shoulder belt anchor	33
Spare tire & tools	33
Tire Pressure Monitoring (warning) System	32

<sup>1</sup> Visit your Toyota dealer for information on customizing this feature.

<sup>2</sup> Programmable by customer. Refer to the Owner's Manual for instructions and more information.

<sup>3</sup> HomeLink<sup>®</sup> is a registered trademark of Johnson Controls, Inc.

# OVERVIEW

## Instrument panel

### Steering wheel controls (if equipped)

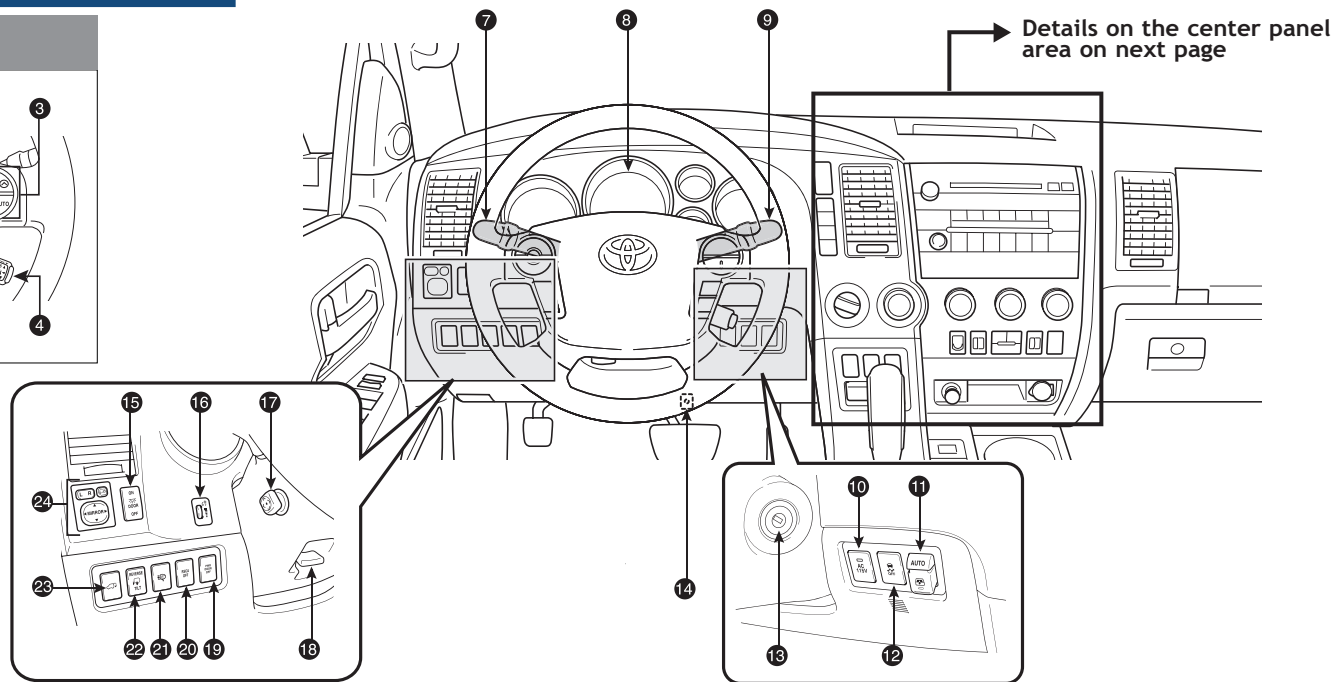
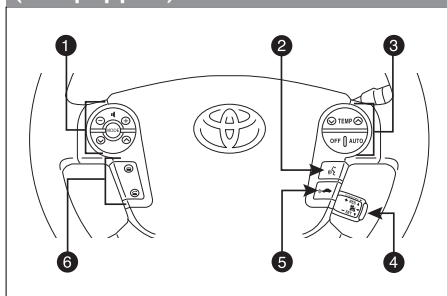

- ❶ Steering wheel audio controls<sup>1</sup>
- ❷ Voice command button<sup>1</sup>
- ❸ Steering wheel climate controls<sup>1</sup>
- ❹ Cruise control
- ❺ Dynamic Laser Cruise Control distance switch<sup>1</sup>
- ❻ Telephone controls<sup>1,2</sup>
- ❼ Headlight, turn signal and front fog light<sup>1</sup> controls
- ❽ Gauges and meters
- ❾ Wiper and washer controls

- ❿ 115V AC Power outlet main switch<sup>1</sup>
- ⓫ Power back window switch
- ⓬ VSC OFF switch
- ⓭ Engine (ignition) switch
- ⓮ Tire Pressure Warning System reset
- ⓯ Personal/Interior light main switch
- ⓰ Instrument panel light control
- ⓱ Tilt and telescopic steering control switch<sup>1</sup>
- ⓲ Tilt and telescopic steering control lever<sup>1</sup>
- ⓳ Power back door main switch<sup>1</sup>
- ⓴ Roll Sensing of Curtain shield Airbag OFF switch
- ⓵ Headlight cleaner<sup>1</sup>
- ⓶ REVERSE TILT (side mirrors) switch<sup>1</sup>
- ⓷ Power back door button<sup>1</sup>
- ⓸ Power rearview mirror controls

<sup>1</sup> If equipped

<sup>2</sup> Vehicles with navigation system: for details, refer to the “Navigation System Owner’s Manual.”

Center panel area

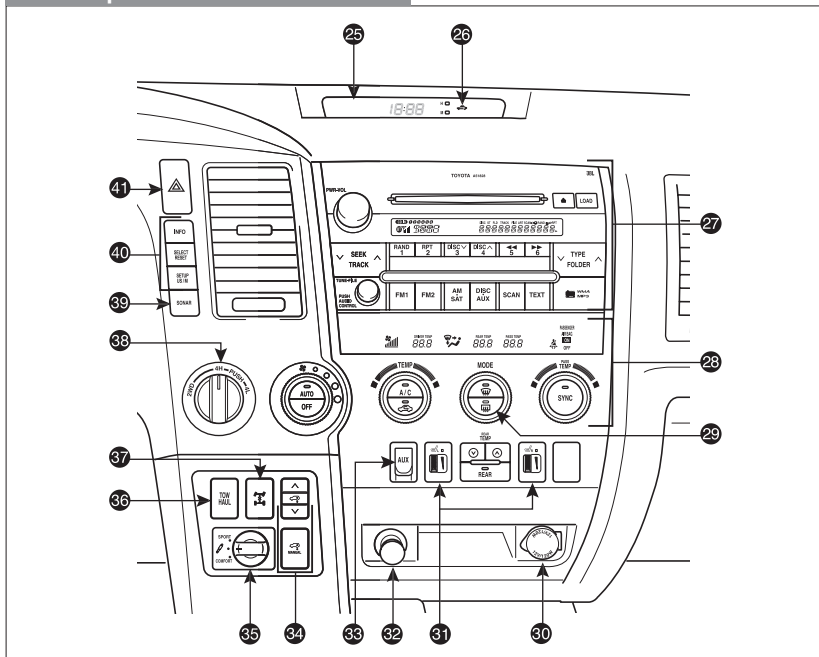

- 25 Accessory meter
- 26 Theft deterrent system/Engine immobilizer indicator
- 27 Audio system<sup>2</sup>
- 28 Air Conditioning controls
- 29 Outside rearview mirrors<sup>1</sup>/Back window defogger/Windshield wiper de-icer<sup>1</sup> button
- 30 12V DC Power outlet
- 31 Seat heater<sup>1</sup> and ventilator<sup>1</sup> controls
- 32 Cigarette lighter
- 33 AUX audio jack
- 34 Height control switch<sup>1</sup>
- 35 AVS button<sup>1</sup>
- 36 “TOW/HAUL” button<sup>1</sup>
- 37 Center differential lock/unlock switch<sup>1</sup>
- 38 Four-wheel drive control switch<sup>1</sup>
- 39 Intuitive parking assist button<sup>1</sup>
- 40 Multi-information display control button<sup>1</sup> and/or accessory meter control button<sup>1</sup>
- 41 Emergency flasher button

<sup>1</sup> If equipped

<sup>2</sup> Vehicles with navigation system: for details, refer to the “Navigation System Owner’s Manual.”

Instrument cluster

With multi-information display

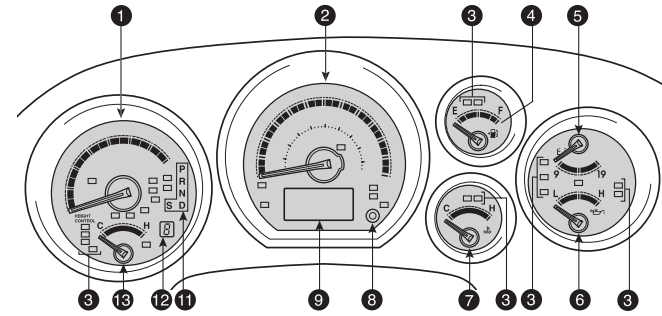

Without multi-information display

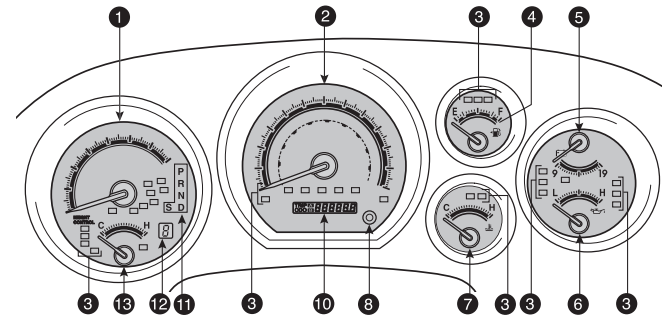

- 1 Tachometer
- 2 Speedometer
- 3 Service indicator and reminder
- 4 Fuel gauge
- 5 Voltmeter
- 6 Engine oil pressure gauge
- 7 Engine coolant temperature
- 8 Odometer/Trip meter and trip meter reset button
- 9 Multi-information display
- 10 Odometer and two trip meters
- 11 Automatic Transmission shift position indicator
- 12 Automatic Transmission shift range display
- 13 Automatic Transmission fluid temperature gauge

## Indicator symbols

For details, refer to “Indicators and warning lights,” Section 2-2, 2009 *Owner’s Manual*.

	Brake system warning <sup>1</sup>
	Driver seat belt reminder (alarm will sound if speed is over 12 mph)
	Front passenger seat belt reminder (alarm will sound if speed is over 12 mph)
	Charging system warning <sup>1</sup>
	AIR BAG ON indicator <sup>1</sup>
	AIR BAG OFF indicator <sup>1</sup>
	Malfunction/Check Engine indicator <sup>1</sup>
	Engine oil replacement reminder
	Low fuel level warning
	Open door warning
	Airbag SRS warning <sup>1</sup>
	Low windshield washer fluid level warning
	Master warning
	Low Tire Pressure Warning <sup>1</sup>
	Theft deterrent/Engine immobilizer system indicator
	Power steering warning <sup>1</sup>
	Roll Sensing of Curtain shield Airbag OFF indicator
	Headlight low/high beam indicator
	Turn signal indicator
	Shift position and shift range indicators
	Vehicle Stability Control OFF indicator <sup>1</sup>

	TOW/HAUL mode indicator		
	AUTO Limited Slip Differential indicator <sup>1</sup>		
	Slip indicator <sup>1</sup>		
		High/Low speed four-wheel drive indicator	
			Height control indicator <sup>1</sup>
	Height control/MANUAL indicator <sup>1</sup>		
	Center differential lock indicator		
	Cruise control indicator		
	Anti-lock Brake System warning		
	Automatic Transmission fluid temperature warning		

<sup>1</sup> If indicator does not turn off within a few seconds of starting engine, there may be a malfunction. Have vehicle inspected by your Toyota dealer.

### Keyless entry

#### Locking operation

With power back door

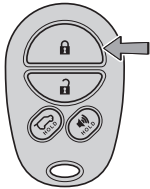

Without power back door

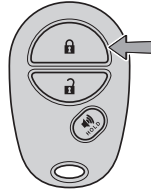

Push 

#### Unlocking operation

With power back door

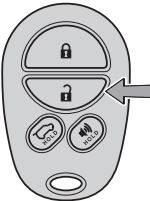

Without power back door

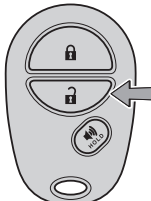

Push ONCE: Driver door  
TWICE: All doors 

**NOTE:** If a door is not opened within 60 seconds of unlocking, all doors will relock for safety.

#### Power back door operation (if equipped)



Push and hold 

#### Panic button



Push and hold 

### Fuel tank door release and cap

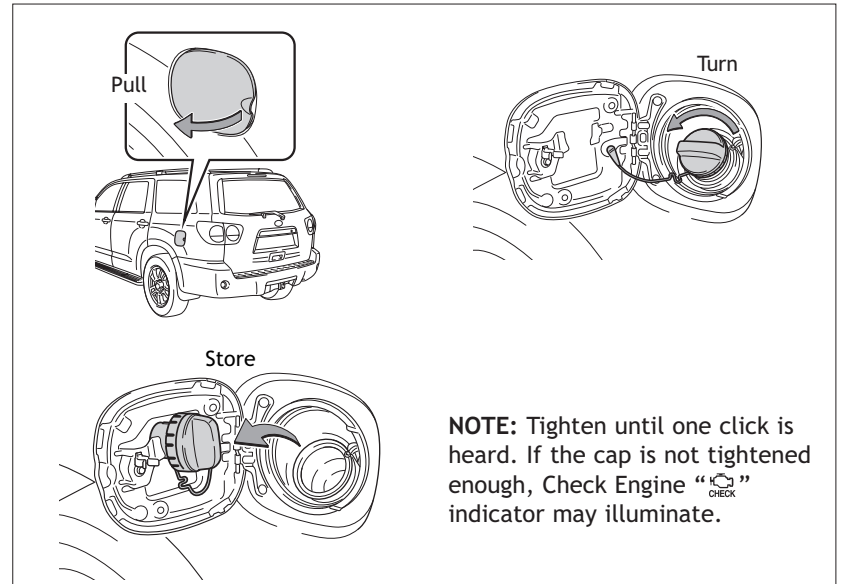

### Hood release

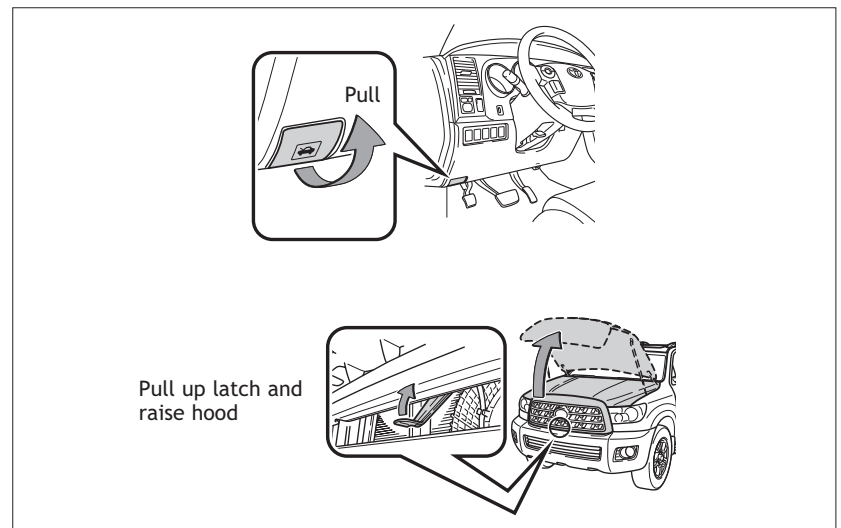

**Light control-Instrument panel**

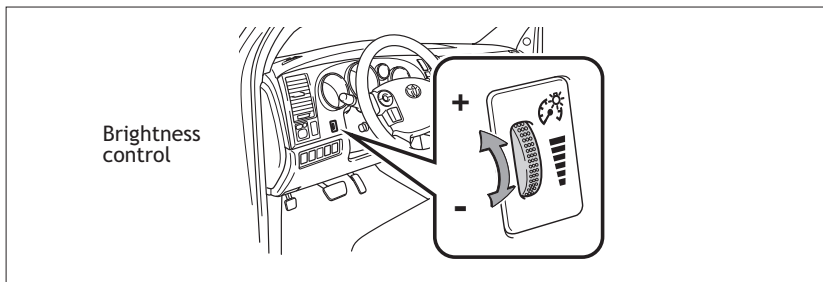

**Engine maintenance**

**4.7L 8 cylinder (2UZ-FE) engine**

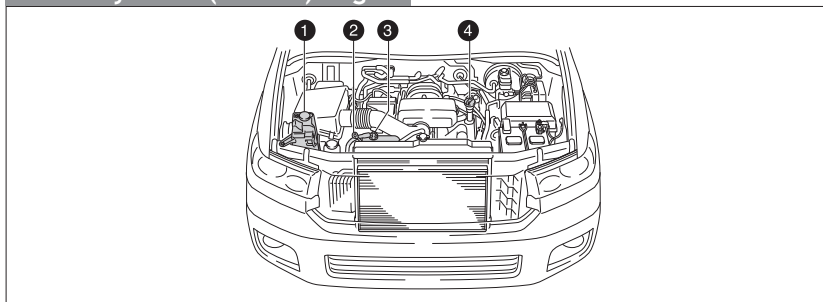

**5.7L 8 cylinder (3UR-FE, 3UR-FBE) engine**

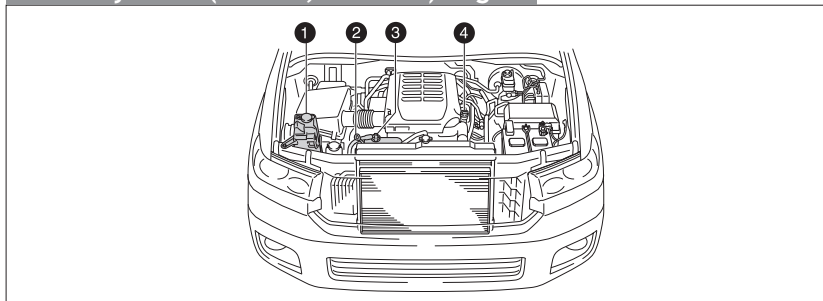

- 1 Windshield washer fluid tank
- 2 Engine oil level dipstick
- 3 Engine coolant reservoir
- 4 Engine oil filler cap

**Note:** Regularly scheduled maintenance, including oil changes, will help extend the life of your vehicle and maintain performance. Please refer to the "Owner's Warranty Information Booklet," "Scheduled Maintenance Guide" or "Owner's Manual Supplement."

**Automatic Transmission**

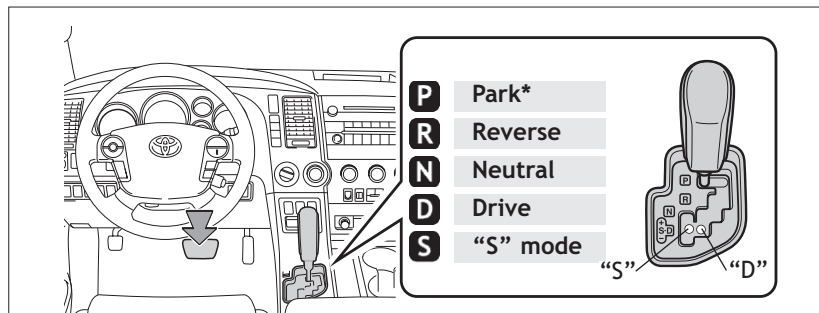

\* The engine switch must be "ON" and the brake pedal depressed to shift from Park.

**"S" (Sequential) mode**

Shift the shift lever to "S" position from "D" position.

**Floor shift type:**

- +: Upshift (push and release)
- : Downshift (pull and release)

Downshifting increases power going uphill, or provides engine braking downhill. For best fuel economy during normal driving conditions, always drive with the shift lever in the "D" position.

**"TOW/HAUL" switch (if equipped)**

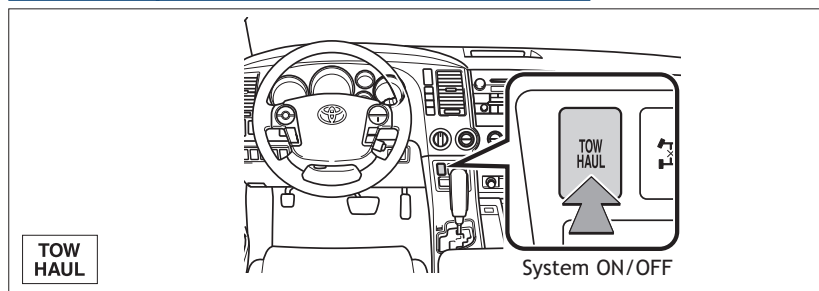

"TOW/HAUL" mode can be used when carrying heavy loads. As fuel economy is reduced while in "TOW/HAUL" mode, deactivating when driving without a load is recommended.

Refer to the *Owner's Manual* for more details on this system before attempting to use it.



### Auto lock functions

Automatic door locks can be programmed to operate in four different modes, or turned OFF.

- Doors lock when shifting from Park.
- Doors lock when the vehicle speed is approximately 12 mph or higher.
- Doors unlock when shifting into Park.
- Doors unlock when the driver's door is opened within 10 seconds after turning the engine switch to the "ACC" or "LOCK" position.

Refer to the *Owner's Manual* for more details.

### Four-wheel drive

#### Four-wheel drive control switch

Turn

Turn

Push and turn

<b>2WD</b>	High speed (2WD)
<b>4H</b>	High speed (4WD) Turn to "4H" with speed below 62 mph.
<b>4L</b>	Low speed (4WD) Shift to "N" position when stopped, then push and turn to "4L."

For best fuel economy and performance under normal driving conditions, keep in "2WD" position.

#### Center differential lock/unlock switch

Push

Lock the center differential when your vehicle's wheels get stuck in a ditch or when driving on a slippery or bumpy surface.

### Seat adjustments-Front

Manual seat

Power seat

- 1 Position
- 2 Seatback angle
- 3 Seat height
- 4 Seat cushion angle
- 5 Lumbar support (if equipped)
- 6 Position, cushion angle and height
- 7 Leg support

### Seats-Head restraints

Front

Second row

Third row

Height

Angle

Height

Height

Height

Lock release button

Lock release button

Lock release button

## Seat adjustments-Rear

### Second row

#### Separate seat

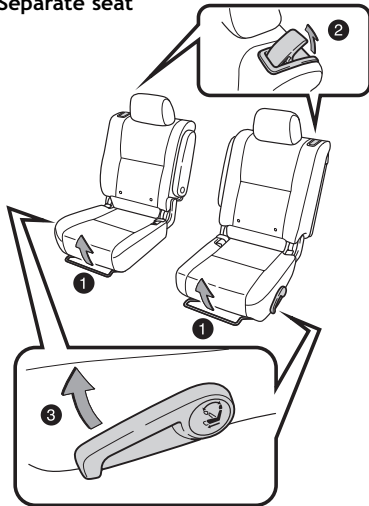

#### Bench seat

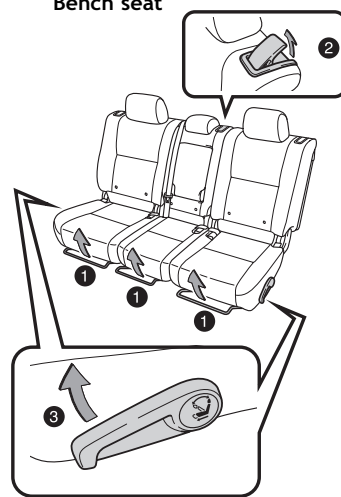

### Third row

#### Manual seat

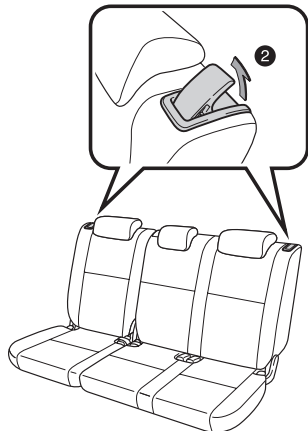

#### Power seat

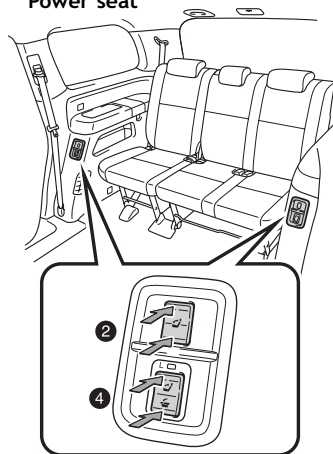

- ① Position
- ② Seatback angle
- ③ Seatback lock release and slide
- ④ Seatback folding/returning

Refer to the *Owner's Manual* for more details.

## Seats-Folding second row seats

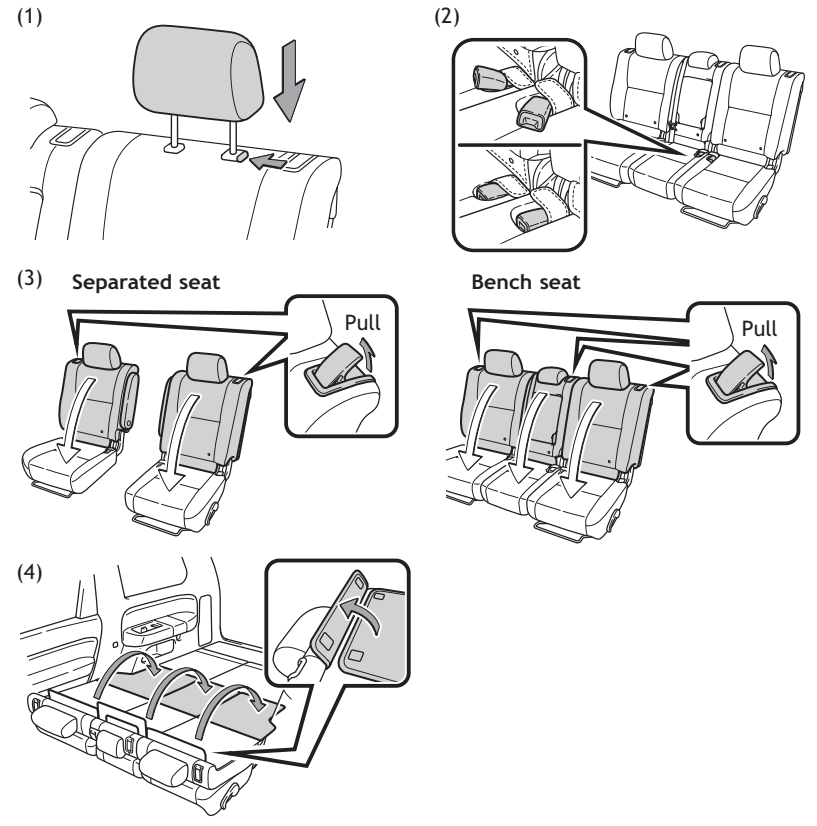

- (1) Lower the head restraints.
- (2) Stow the seat belt buckles.
- (3) Fold down the seatback.
- (4) Fold out the board (if equipped) from the seatback.

## Parking brake

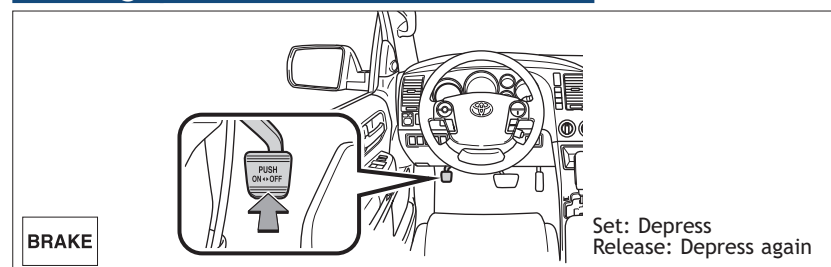

### Seats-Folding third row seats

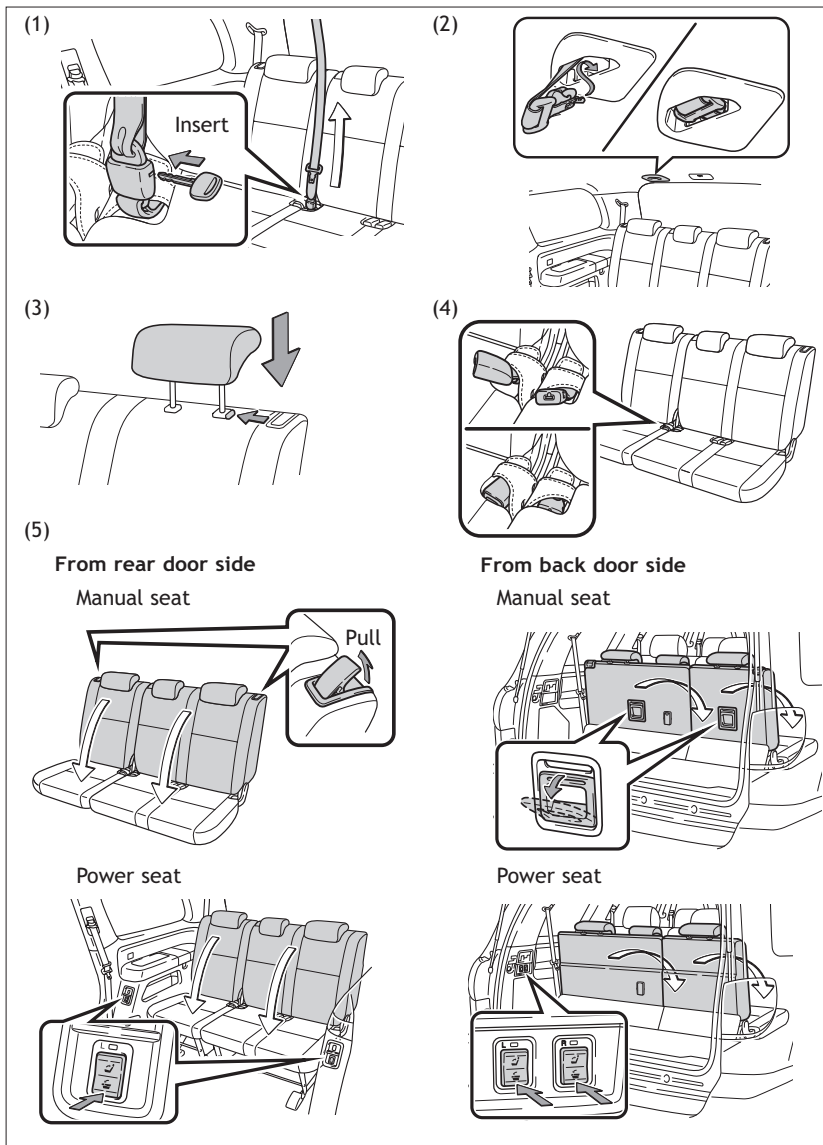

- (1) Release the center seat belt tab.
- (2) Stow the center seat belt tab.
- (3) Lower the head restraint.
- (4) Stow the seat belt buckles.
- (5) Fold the seats.

### Lights & turn signals

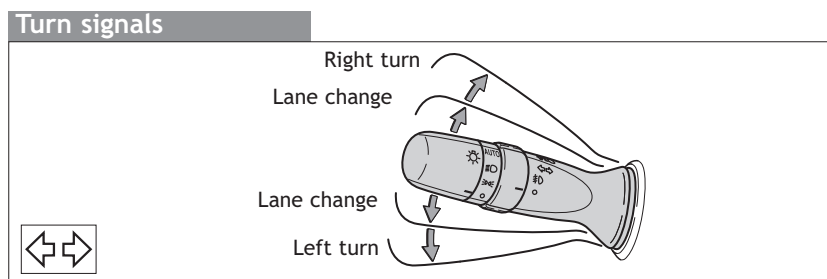
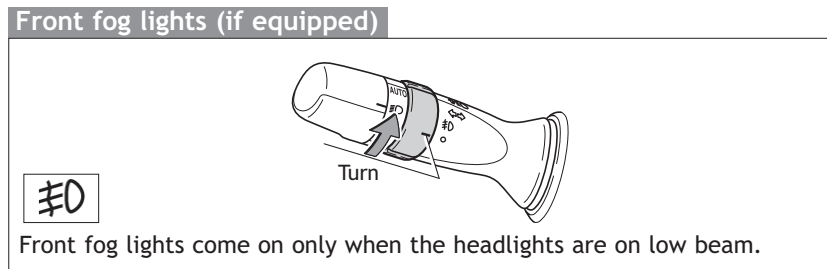
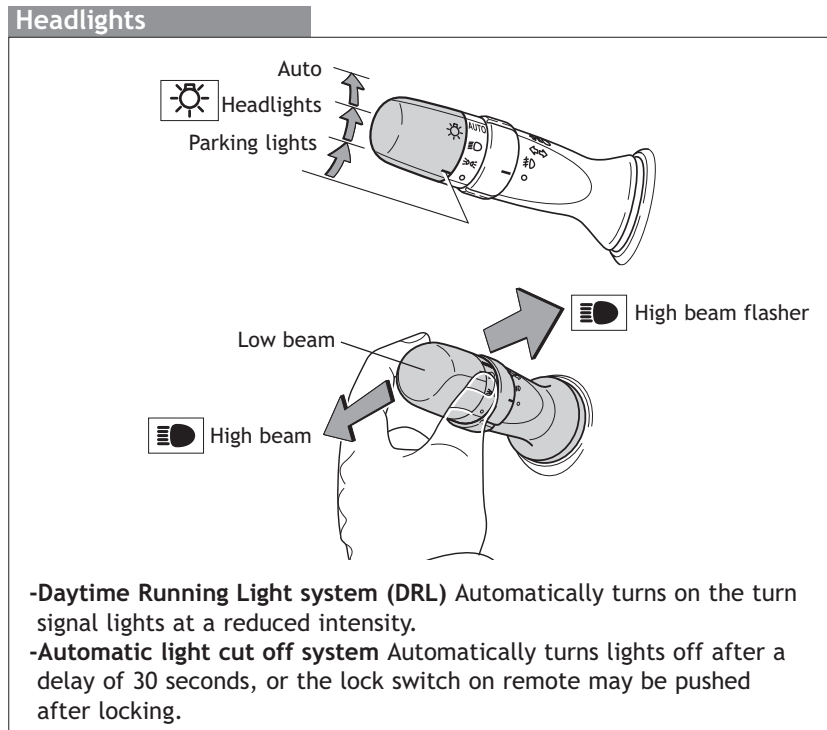

## Windshield wipers & washers

### Front

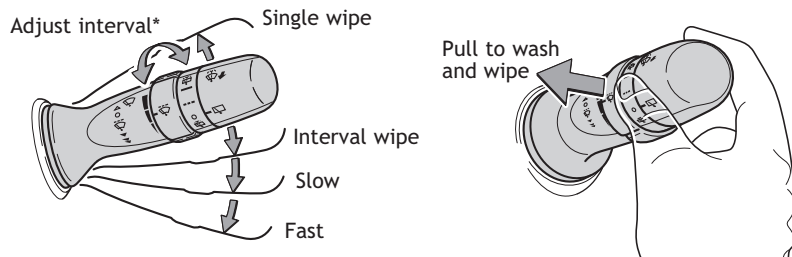

\* **Intermittent windshield wiper interval adjustment**  
Rotate to increase/decrease wipe frequency.

### Rear

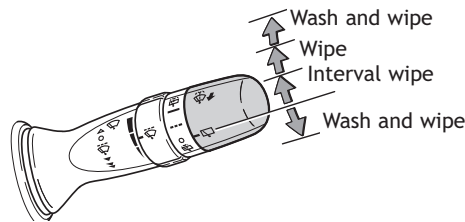

## Windows

### Driver side

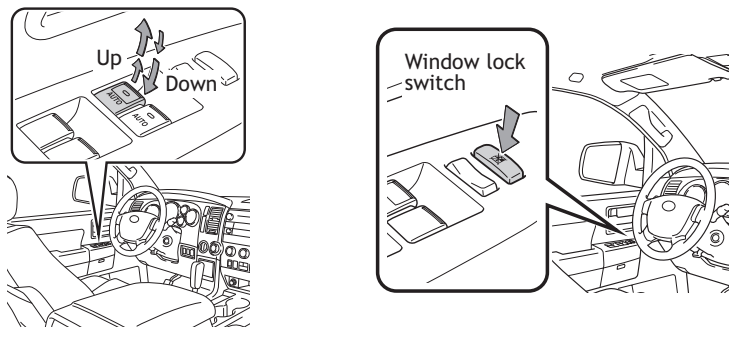

**Automatic operation** Push the switch completely down or pull it completely up and release to fully open or close. To stop window midway, lightly push the switch in the opposite direction.

**Window lock switch** Deactivates all passenger windows and back window. Driver's window remains operable.

## Window-Back

### Operating from inside

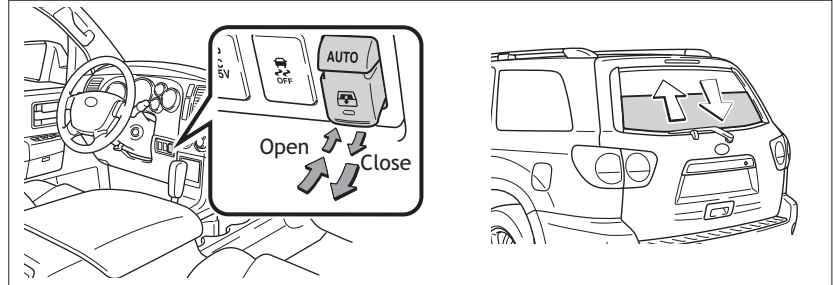

**Automatic operation** Push the switch completely in or pull it completely out and release to fully open or close. To stop window midway, lightly push the switch in the opposite direction.

### Operating from outside

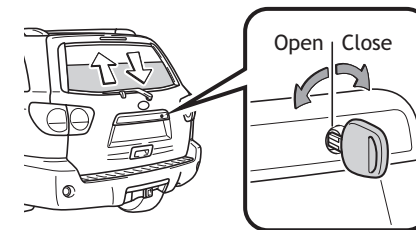

## Door-Power back (if equipped)

### Instrument panel

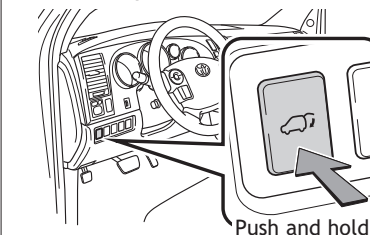

Open: Push and hold  
Close: Push and hold again

### Back door (close only)

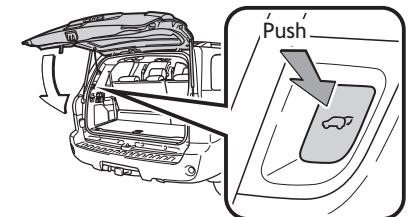

**NOTE:** If battery is disconnected, the power back door needs to be reinitialized. Refer to the *Owner's Manual* for more details.

### Moonroof

#### Sliding operation

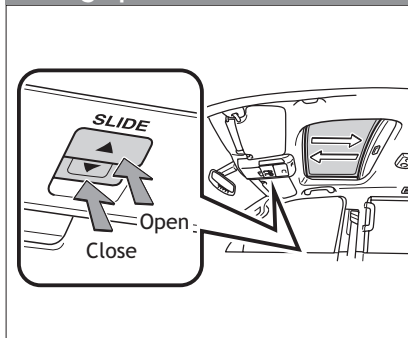

#### Tilting operation

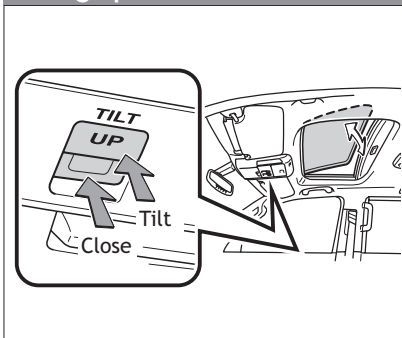

Push once to open/close completely. To stop partway, press the switch lightly.

### Cruise control

#### Turning system ON/OFF

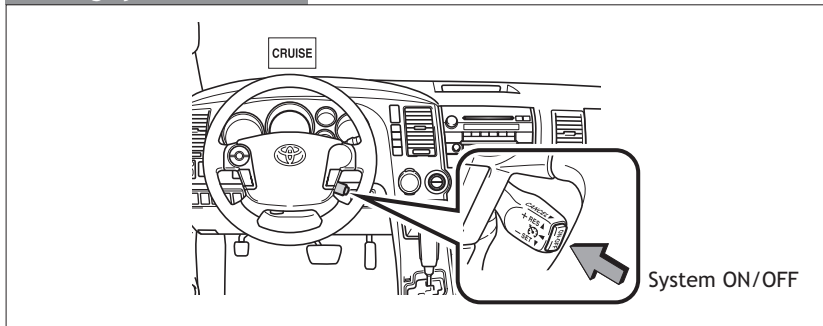

#### Functions

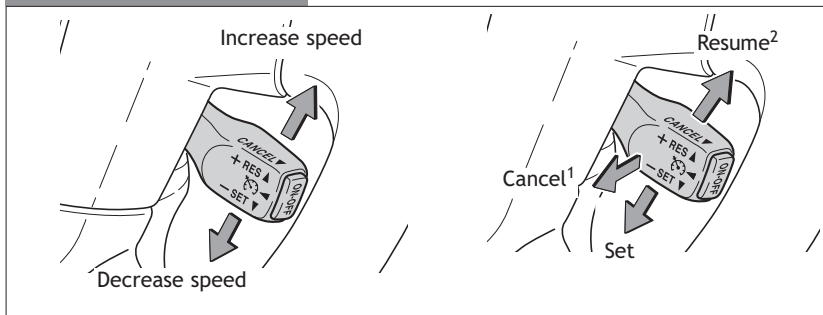

<sup>1</sup> The set speed may also be cancelled by depressing the brake pedal.

<sup>2</sup> The set speed may be resumed once vehicle speed exceeds 25 mph.

### Tilt and telescopic steering wheel

#### Manual

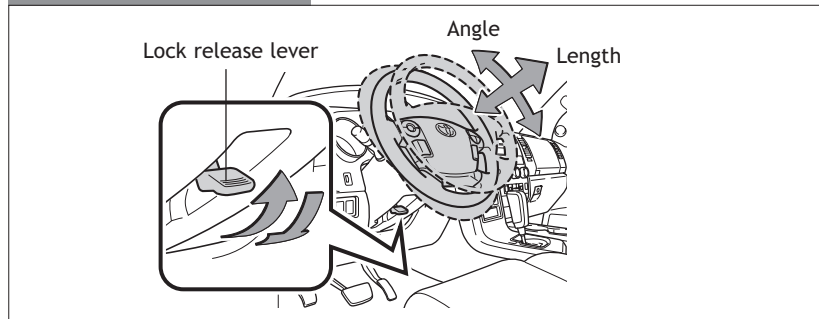

Hold wheel, push lever down, set angle and length, and return lever.

#### Power

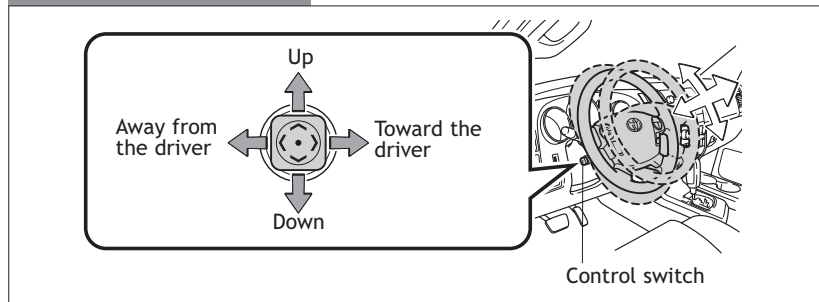

Toggle the control switch to set angle and length.

**Note:** Do not attempt to adjust while the vehicle is in motion.

### VSC OFF button

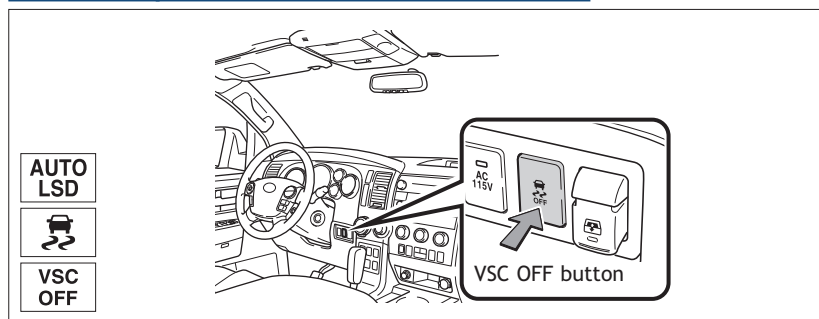

The VSC OFF button is used to switch between modes related to the TRAC, VSC and Auto LSD functions.

Refer to Section 2-4 of the *Owner's Manual* for more information.

## Air Conditioning/Heating

### Front Air Conditioning

Control panel

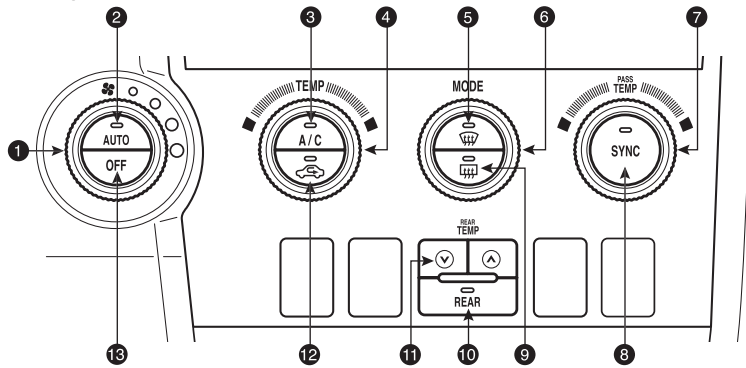

Display

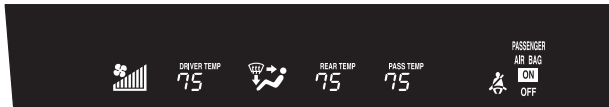

- 1 Fan speed
- 2 Automatic climate control ON  
Adjusting the temperature setting will cause the airflow vents, air intake and fan to adjust automatically.
- 3 Air Conditioning ON/OFF
- 4 Temperature selector (driver side)
- 5 Windshield defogger (fresh air only)
- 6 Airflow vent
- 7 Temperature selector (front passenger side)
- 8 "SYNC" button  
**Indicator ON:** Synchronize temperature settings for driver, front passenger and rear seats.  
**Indicator OFF:** Separate temperature settings for driver, front passenger and rear seats.
- 9 Outside rearview mirror/Back window defogger or windshield wiper de-icer (if equipped)
- 10 Rear Air Conditioning ON/OFF
- 11 Temperature selector (rear passenger area\*)
- 12 Fresh or recirculated cabin air
- 13 Climate control OFF

\* To change the rear seat setting, press the "REAR" button.

### Rear Air Conditioning

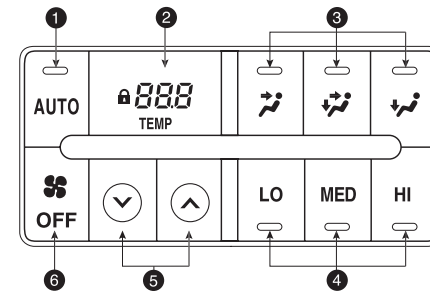

- 1 Automatic climate control ON
- 2 Display
- 3 Airflow vent
- 4 Fan speed
- 5 Temperature selector
- 6 Climate control OFF

### Seat ventilators/Heaters (if equipped)

#### Front seats

With ventilators

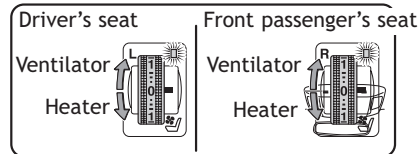

Heater only

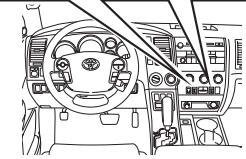
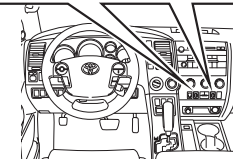
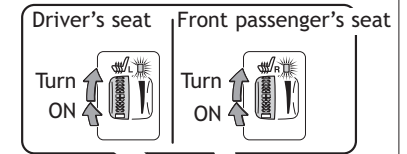

#### Second seats

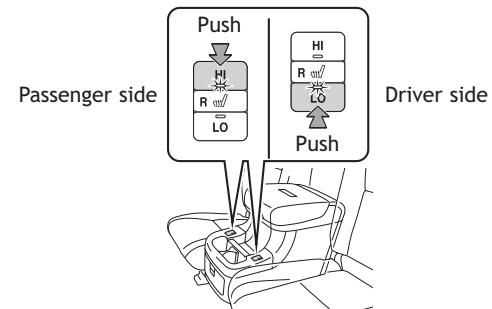

Audio

**Type 1**

Preset buttons - functions in other modes indicated above number

Push to turn ON/OFF

Seek station/ CD track select

Push to adjust tone, balance & ASL\*

Eject CD

Push to skip up/down MP3 folder

Mode Station/CD track scan View CD information

**Type 2 additional functions**

Load CD(s)

View MP3 folder and/or Satellite Radio category type

**Type 3 (with JBL speakers)**

\* Automatic Sound Leveling

CD PLAYER

To scan tracks on a disc Push and hold "SCAN." Push again to hold selection.

CD changer (Types 2 and 3 only)

- To load one disc Push "LOAD" and insert one disc.
- To load multiple discs Push and hold "LOAD" until you hear a beep. Insert one disc. Shutter will close and then re-open for next disc.

To select a file (MP3/WMA only) Turn "TUNE-FILE."

To select a folder (MP3/WMA only) Push either side of "FOLDER."

RADIO

To preset stations Tune in the desired station and hold down a preset button (1-6) until you hear a beep. Push desired preset button (1-6) to select.

To scan stations Push and hold "SCAN" to scan preset stations. Push again to hold selection.

AUX audio jack

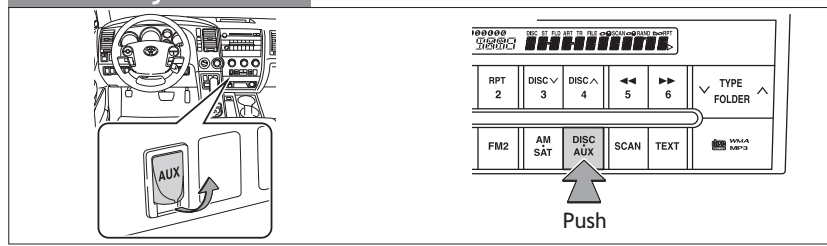

By inserting a mini plug into the AUX audio jack, you can listen to music from a portable audio device through the vehicle's speaker system while in AUX mode.

Rear seat entertainment system (if equipped)

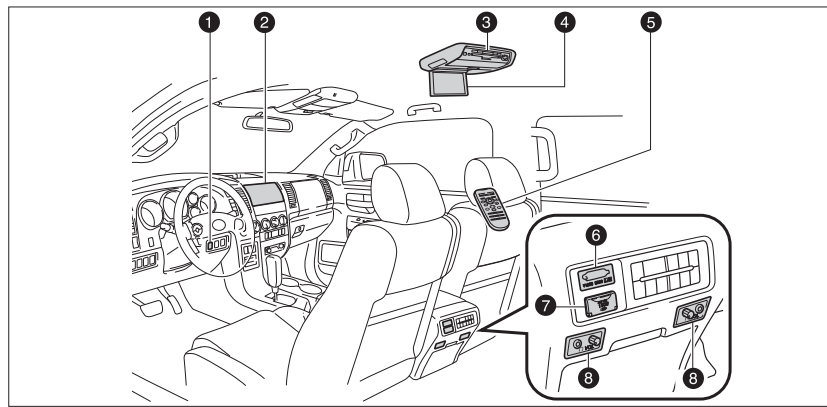

- 115V AC Power outlet main switch
- Front audio system
- DVD player
- DVD screen
- Remote control
- A/V input adapter
- 115V AC Power outlet
- Headphone volume controls and headphone jacks

Vehicles with navigation system: for details, refer to the "Navigation System Owner's Manual."

### Steering wheel switches (if equipped)

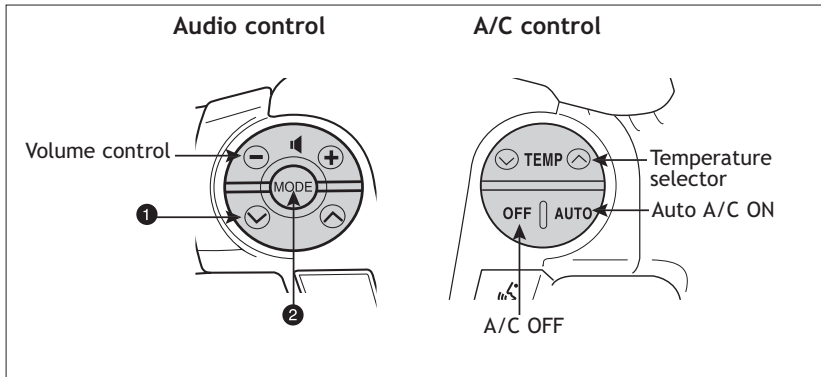

- 1 "V A"
  - In radio mode Push to select a preset station; push and hold to seek the next strong station.
  - In CD mode Push to skip up or down to next/previous track.
- 2 "MODE"
  - Push to turn audio ON and select an audio mode. Push and hold to turn the audio system OFF.

### Garage door opener (HomeLink®)\* (if equipped)

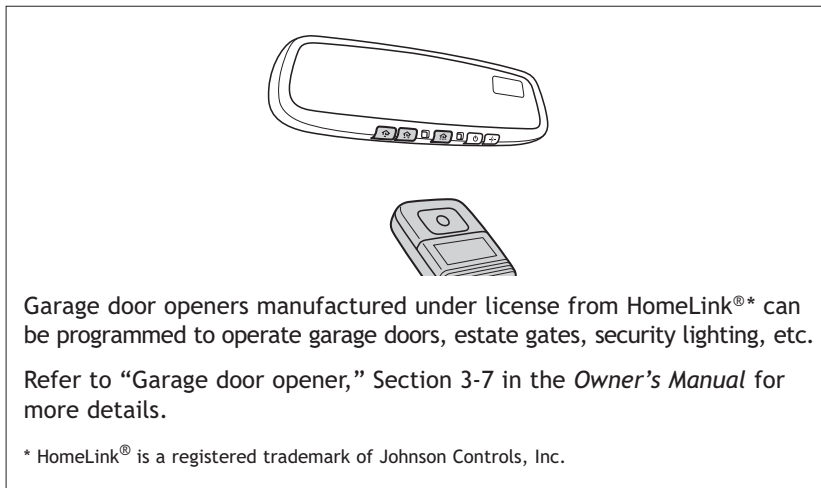

### Dynamic Laser Cruise Control (if equipped)

Refer to the *Owner's Manual* for more details and complete safety precautions before attempting to use "Dynamic Laser Cruise Control."

#### Fixed speed mode

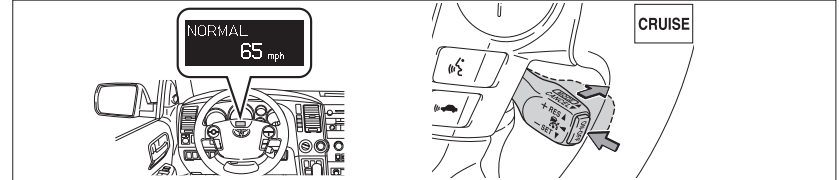

- (1) To select conventional/fixed speed control Push the ON-OFF button. Push the lever forward and hold.
- (2) To set, cancel and resume a speed Refer to instructions for *Cruise Control* on page 20.

#### Distance control mode

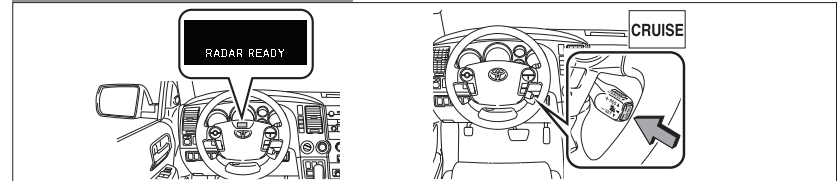

Distance control mode will cruise at a set speed, decelerate to maintain selected distance from a slower vehicle traveling in front of you, and accelerate back up to the selected speed if the vehicle traveling in front of you changes lanes or speeds up.

- (1) To select distance control mode Push the ON-OFF button. The "CRUISE" indicator will come on.
- (2) To set, cancel and resume a speed Refer to instructions for *Cruise Control* on page 20.

**Note:** Once vehicle speed is set, pushing lever up toward "+ RES" will increase speed to the nearest 5 mph, and then in 5 mph increments. Pushing lever down toward "- SET" will reduce speed in the same way.

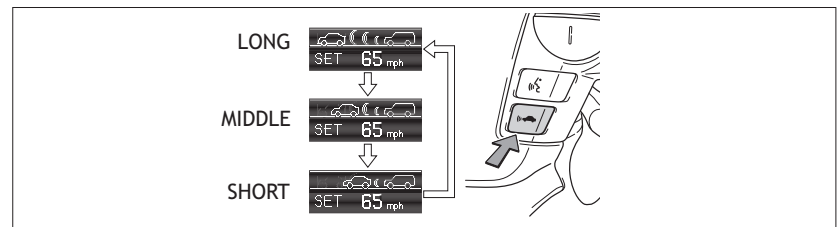

- (3) To change the vehicle-to-vehicle distance
  - Push the distance button to cycle through the settings, which will change progressively from LONG to MIDDLE to SHORT.



**Multi-information display (if equipped)**

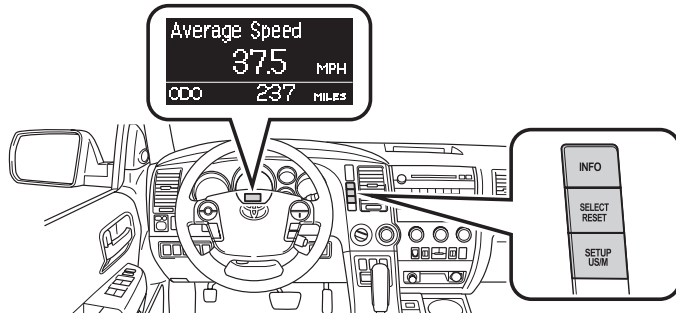

Push “INFO” to change information in the following:

- (1) Zoom display of odometer and trip meter
- (2) Average gas mileage
- (3) Current gas mileage
- (4) Miles left on remaining fuel
- (5) Running time from engine start
- (6) Average vehicle speed

Push “SETUP US/M” to customize to the following settings:

- (1) UNIT
- (2) KEYLESS ENTRY FEEDBACK
- (3) KEYLESS ENTRY RELOCK TIMER
- (4) KEYLESS ENTRY ALL DOORS UNLOCK
- (5) DOOR AUTO LOCKING
- (6) DOOR AUTO UNLOCKING
- (7) HEADLAMPS AUTO OFF TIMER
- (8) COURTESY LAMPS OFF TIMER
- (9) DEFAULT SETTING

**Door locks**

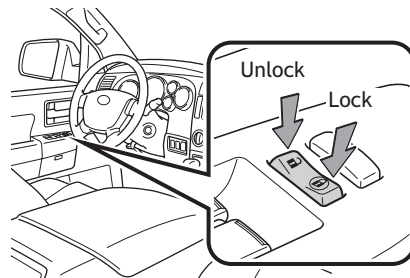

**Telephone controls (Bluetooth® if equipped)**

Audio unit

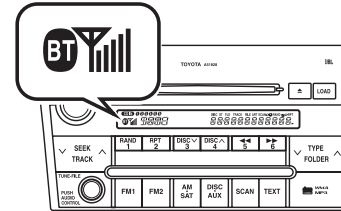

Microphone



Steering wheel telephone switches

Type A

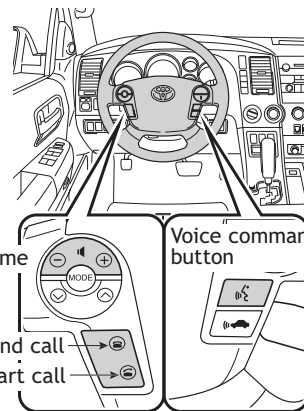

Type B

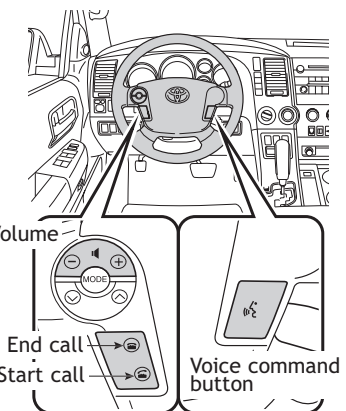

Bluetooth® technology allows dialing or receipt of calls without taking hands from the steering wheel or using a cable to connect the compatible telephone and the system.

Refer to “Hands-free phone system (for cellular phones),” Section 3-4 in the *Owner’s Manual* for more details.

**Power outlets-12V DC (if equipped)**

Instrument panel

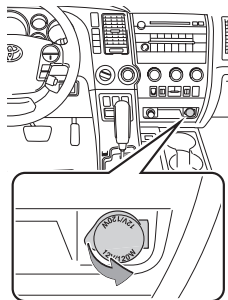

Inside of the center console box

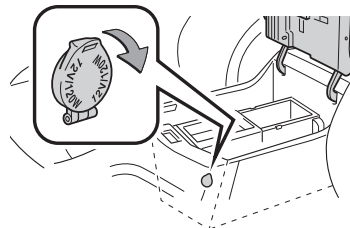

Back of the center console box

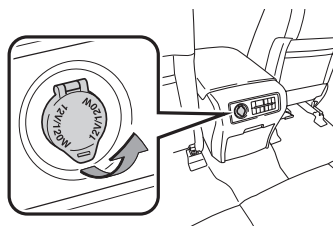

Luggage compartment

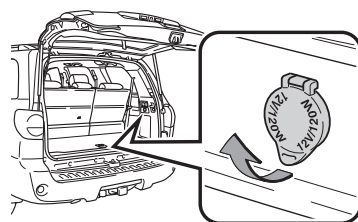

Engine switch must be in the “ACC” or “ON” position to be used.

**Power outlets-115V AC**

ON/OFF switch

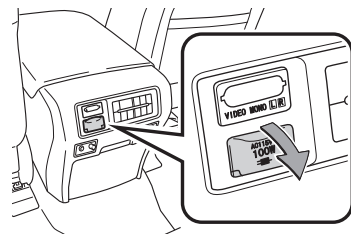
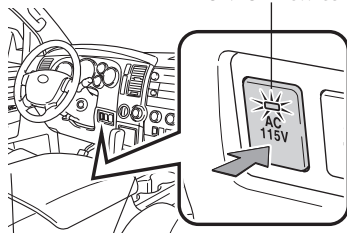

Engine switch must be in the “ON” position to be used.

**Accessory meter**

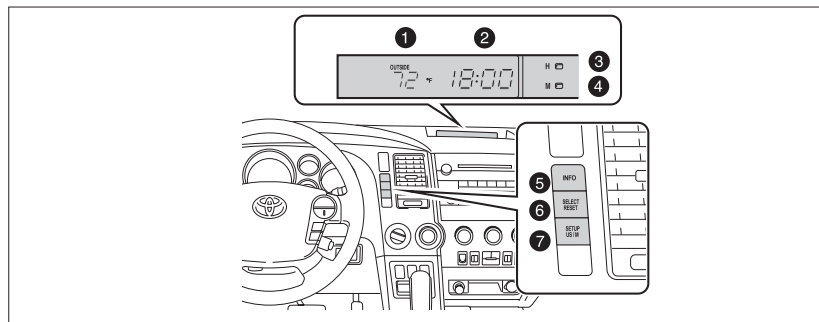

- ❶ Outside temperature/Cruise information display (if equipped)
- ❷ Clock
- ❸ Hour set
- ❹ Minute set
- ❺ Change information (if equipped)
- ❻ “SELECT RESET” button (if equipped)
- ❼ “SETUP US/M” button to customize unit (if equipped)

Refer to your *Owner’s Manual* for complete details on this system before attempting to use it.

**Cup holders**

**Front**

Front console

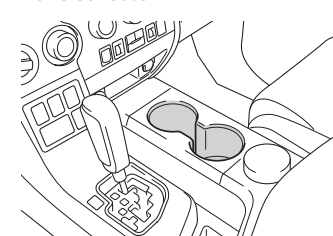

Back of the front console

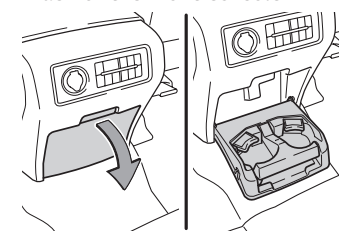

**Rear**

Rear side trim

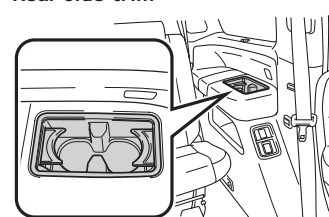

Rear console box (if equipped)

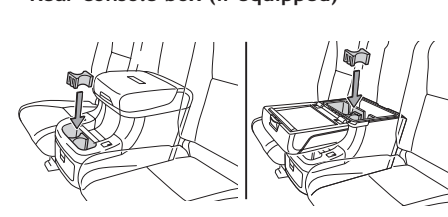

# SAFETY AND EMERGENCY FEATURES

## Tire Pressure Monitoring (warning) System

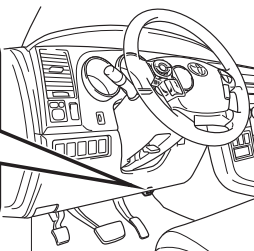
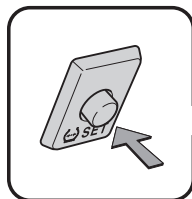

### System reset initialization

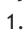
1. Push and hold “ SET” button until the indicator blinks three times.
2. Wait a few minutes to allow initialization to complete.

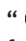

After adjusting tire pressures, or after tires have been rotated or replaced, turn the ignition switch to “ON” and press and hold the “ SET” button until indicator blinks three times. Let the vehicle sit for a few minutes to allow initialization to complete.

Refer to the load label on the door jamb or the *Owner’s Manual* for tire inflation specifications.

If the tire pressure indicator flashes for more than 60 seconds and then remains on, take the vehicle to your local Toyota dealer.

**Note:** The warning light may come on due to temperature changes or changes in tire pressure from natural air leakage. If the system has not been initialized recently, setting the tire pressures to factory specifications should turn off the light.

## Seat belts

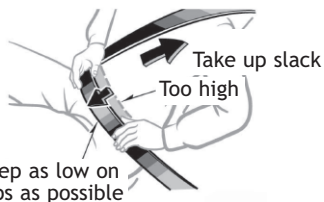

If belt is fully extended, then retracted even slightly, it cannot be re-extended beyond that point, unless fully retracted again. This feature is used to help hold child restraint systems securely.

To find more information about seat belts, and how to install a child restraint system, refer to the *Owner’s Manual*.

## Seat belts-Shoulder belt anchor

Squeeze lock release to lower

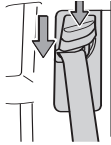

Push up

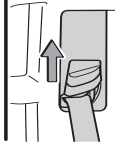

## Doors-Child safety locks

Rear door

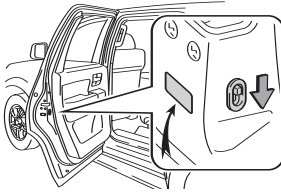

Moving the lever to “LOCK” will allow the door to be opened only from the outside.

## Spare tire & tools

### Spare tire, jack and tool location

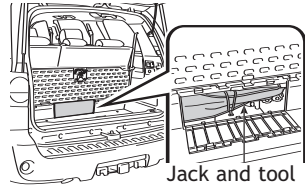
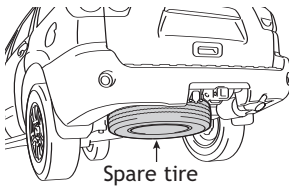

### Removing the spare tire

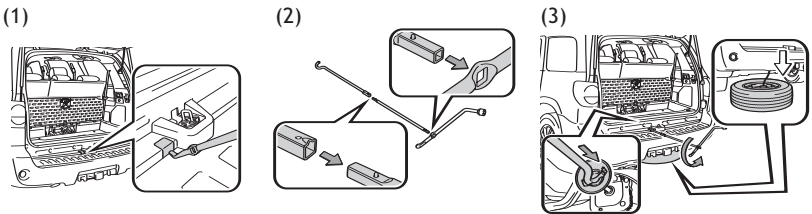

- (1) Remove the cover.
- (2) Assemble the jack handle.
- (3) Insert the jack handle extension into the lowering screw. Lower the spare tire completely to the ground.

Refer to the *Owner's Manual* for tire changing and jack positioning procedures.



Customer Experience Center  
1-800-331-4331

MN 00505-QRG09-SEQ  
Printed in the USA 7/08

Download from [www.somanuals.com](http://www.somanuals.com). All Manuals Search And Download.

## Free Manuals Download Website

<http://myh66.com>

<http://usermanuals.us>

<http://www.somanuals.com>

<http://www.4manuals.cc>

<http://www.manual-lib.com>

<http://www.404manual.com>

<http://www.luxmanual.com>

<http://aubethermostatmanual.com>

Golf course search by state

<http://golfingnear.com>

Email search by domain

<http://emailbydomain.com>

Auto manuals search

<http://auto.somanuals.com>

TV manuals search

<http://tv.somanuals.com>