

Owner's Manual

BP Series

External Battery Packs for Rackmount UPS Systems

Introduction

2

Important Safety Instructions

2

Installation

3

Maintenance

5

Specifications

5

Warranty

6

Español

7

Français

13



1111 W. 35th Street Chicago, IL 60609 USA
Customer Support: (773) 869-1234 • www.tripplite.com

Introduction

Tripp Lite external battery packs are designed for use with various Tripp Lite UPS systems equipped with external battery pack connectors. Before connecting your battery pack to a UPS, make certain that the battery pack voltage matches the DC operating voltage of the UPS. Refer to labeling on the rear panel of the UPS, or call Customer Service at (773) 869-1234. When used with the appropriate Tripp Lite UPS, the battery packs meet UL standard 1778.

Important Safety Instructions



Save These Instructions

WARNING! The mounting shelves are not intended to support more than one battery pack. Do not stack multiple battery packs on a single set of mounting shelves. Failure to follow this warning may lead to product damage and/or a risk of personal bodily harm.

To avoid risk of electrical shock or equipment damage, make certain that the battery pack is suitable for the UPS for which it is intended. Refer to labeling on the rear panel of the UPS, or call Customer Service at (773) 869-1234.

- **Use caution when lifting Battery Packs. Because of the considerable weight of all Rackmount Battery Packs, at least two people should assist in lifting and installing them.**
- **36V and 72V Battery Packs and UPS systems use identical power cables and plugs; make certain that your Battery Packs and UPS use the same DC voltage before connecting them.**
- Suggested mounting procedures are for common rack types and may not be appropriate for all rack configurations. User must determine the fitness of rack- and wallmount hardware and procedures before mounting.
- When connecting multiple Battery Packs to a single UPS, the Battery Packs should be approximately the same age.
- It is normal for sparks to occur inside external battery connectors during final battery connection.
- Do not unplug external batteries from the UPS while the UPS is operating on battery power, due to the possibility of dangerous arcing.
- There are no user-serviceable parts inside the Battery Packs. Do not open the Battery Packs for any reason.
- Because batteries present a risk of electrical shock and burn from high short-circuit current, observe proper precautions. Unplug the Battery Pack from the UPS before performing battery replacement. Do not short or bridge battery terminals with any object. Use tools with insulated handles. Remove metal objects such as watches and rings before working with batteries. Do not open batteries. Replace batteries only with sealed lead-acid batteries of the same number, type, voltage and amp hour capacity.
- Do not dispose of batteries in a fire. The batteries are recyclable. Proper disposal of batteries is required; refer to your local codes for disposal requirements. In the USA only, you may call 1-800-SAV-LEAD (1-800-728-5323) for complete recycling information.

Installation

Color Selection (select models)

Select models can be configured to match black or gray equipment. Switch the gray front panel on the unit for the black front panel if included. If you wish to install an alternate color bezel not included with your unit, call Customer Support at (773) 869-1234.

Single Unit Installation

- 1 Connect the shelves to the shelf extensions **A** using the included hardware **B**. Leave the screws slightly loose so that the shelves can be adjusted in the next step.

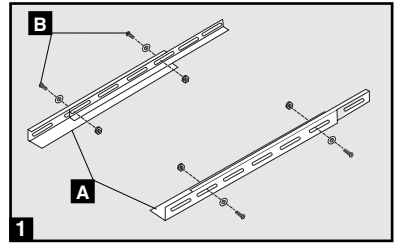

- 2 Adjust each shelf to fit your rack, then mount them in the lowest available space of your rack with the hardware provided **C**. Note that the support ledges should face inward. Tighten the screws that connect the shelf segments **B**.

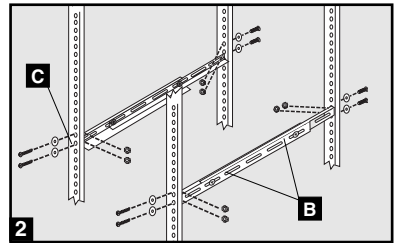

- 3 Attach mounting ears **D** to the front mounting holes of your equipment **E** using the screws provided **F**. The ears should face forward.

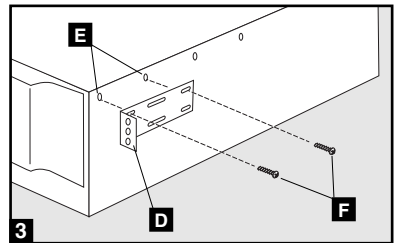

- 4 Using an assistant if necessary, lift your equipment and slide it onto the mounting shelves. Attach your equipment to the rack by passing user-supplied hardware **G** through its mounting ears and into the rack rails.

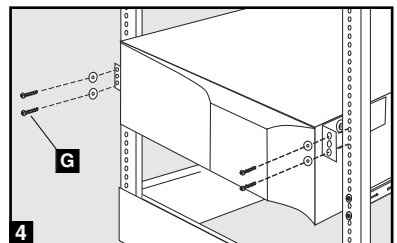

Installation

Tower Mounting

Order optional adjustable tower stands, sold separately (Tripp Lite model: 3-9USTAND) to tower mount UPS system and battery pack.

1 Battery Pack Connection for Battery Packs with Attached Cable

Connect the rack shelves to the shelf extensions using the included hardware. Leave the screws slightly loose so that the shelves can be adjusted in the next step.

Adjust each shelf to fit your rack, then mount them in the lowest available space of your rack with the hardware provided.

Select battery packs have a 175-amp polarized plug **A** on an output cord permanently connected to the rear panel. Simply plug the output cord directly into the external battery connector of your UPS. (See your UPS manual for external battery connector description and location.)

Additional battery packs can be added if an output jack is present.

To connect multiple Battery Packs to a single UPS for greatly increased runtime, connect the output of the first Battery Pack to the UPS's external battery connector, then "daisy chain" the others: connect an input/output plug on the second Battery Pack to an input/output plug on the first, a plug on third to a plug on the second and so on. Note that multiple Battery Pack arrays will provide longer runtimes, but will also require longer recharge times.

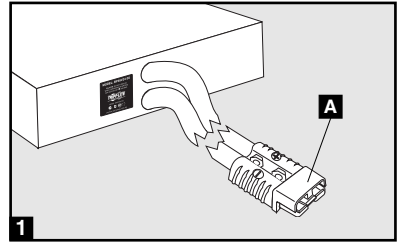

2 Battery Pack Connection for Battery Packs with Detachable Cable

Battery Packs feature dual input/output receptacles on their rear panels **B**. To connect to a UPS, insert one end of the detachable power cable **C** into either plug on the rear of the Battery Pack and the cable's other end into the external battery connector of your UPS. (See your UPS manual for external battery connector description and location.)

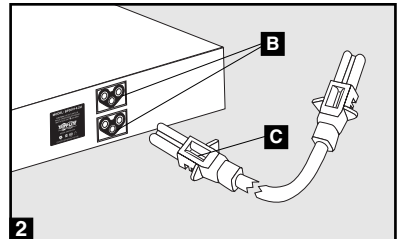

Maintenance

Rackmount Battery Packs require no maintenance but should be kept dry at all times. Avoid installation in locations with high heat and/or humidity. The Battery Pack(s) should be kept fully charged by being connected to an active UPS system, not left in a depleted condition. Batteries left in a discharged state will suffer a permanent loss of capacity.

Troubleshooting

There is a fuse array inside the Battery Packs. If a heavy overload or short circuit is encountered, a fuse will open (blow). A Battery Pack with a blown fuse will deliver no output voltage at any load. A qualified technician must replace the fuses. Contact Tripp Lite Customer Support for additional information.

Internal Battery Replacement

The batteries in the Battery Packs will eventually wear out and be unable to provide adequate backup times. The batteries should only be replaced by factory authorized service personnel. Tripp Lite offers an exchange program for North American customers wherein they may exchange worn-out Battery Packs for new ones at a price comparable to the cost of individual battery replacement. For more details, call Tripp Lite at (773) 869-1234.

Storage

Disconnect your Battery Pack's power cable before storing. If you plan to store your Battery Pack for an extended period of time, fully recharge its batteries every three months by connecting it to a UPS that is connected to AC input for 4-6 hours.

Service

If returning your Battery Pack to Tripp Lite for service, please pack it carefully in its ORIGINAL PACKING MATERIAL that came with the unit. Enclose a letter describing the symptoms of your problem. If the UPS is within the 2-year warranty period, enclose a copy of your sales receipt.

Specifications

Tripp Lite has a policy of continuous improvement. Specifications are subject to change without notice.

<u>Model No.</u>	<u>Voltage (DC)</u>	<u>Connector Type</u>
BP24V14	24 volts	Red/Black
BP24V33	24 volts	Red 2-point
BP36V13	36 volts	Black 3-point
BP36V14-2U	36 volts	Black 3-point
BP36V15-2U	36 volts	Grey 2-point
BP36V18-2U	36 volts	Grey 2-point
BP36V27	36 volts	Grey 2-point
BP48V18	48 volts	Blue 2-point
BP48V21-2U	48 volts	Black 3-point
BP48V24-2U	48 volts	Blue 2-point
BP48V60RT-3U	48 volts	Blue 2-point
BP48V75-6U	48 volts	Blue 2-point
BP72V12-2U	72 volts	Black 3-point
BP72V21RT3U	72 volts	Black 3-point
BP240V7RT-3U	240 volts	Black 3-point
BP240V10RT-3U	240 volts	Black 3-point
SUBP	240 volts	Black 3-point

2-Year Limited Warranty

Seller warrants this product, if used in accordance with all applicable instructions, to be free from original defects in material and workmanship for a period of 2 years from the date of initial purchase. If the product should prove defective in material or workmanship within that period, Seller will repair or replace the product, in its sole discretion.

Customers in the United States may obtain service under this Warranty only by delivering or shipping the product (with all shipping or delivery charges prepaid) to: Tripp Lite, 1111 W. 35th Street, Chicago, IL 60609. Seller will pay return shipping charges. Call Tripp Lite at (773) 869-1234 before sending any equipment back for repair.

Customers in Mexico may obtain service under this Warranty only by delivering or shipping the product (with all shipping or delivery charges prepaid) to an authorized service center. In Mexico City, the authorized service center is CompuSupport Mexico, shipping address Roberto Gayol 29, Col. de Valle, Mexico City—call CompuSupport at (5) 559-3022 before sending any equipment back for repair. Customers elsewhere in Mexico may visit Tripp Lite's PowerZone web page (www.tripp-lite.com) to find the address and telephone number of the nearest authorized service center.

Customers in Canada may obtain service under this Warranty only by delivering or shipping the product (with all shipping or delivery charges prepaid) to an authorized service center. Canadian customers may visit Tripp Lite's PowerZone web page (www.tripp-lite.com) to find the address and telephone number of the nearest authorized service center.

THIS WARRANTY DOES NOT APPLY TO NORMAL WEAR OR TO DAMAGE RESULTING FROM ACCIDENT, MISUSE, ABUSE OR NEGLIGENCE. SELLER MAKES NO EXPRESS WARRANTIES OTHER THAN THE WARRANTY EXPRESSLY SET FORTH HEREIN. EXCEPT TO THE EXTENT PROHIBITED BY APPLICABLE LAW, ALL IMPLIED WARRANTIES, INCLUDING ALL WARRANTIES OF MERCHANTABILITY OR FITNESS, ARE LIMITED IN DURATION TO THE WARRANTY PERIOD SET FORTH ABOVE; AND THIS WARRANTY EXPRESSLY EXCLUDES ALL INCIDENTAL AND CONSEQUENTIAL DAMAGES. (Some states do not allow limitations on how long an implied warranty lasts, and some states do not allow the exclusion or limitation of incidental or consequential damages, so the above limitations or exclusions may not apply to you. This warranty gives you specific legal rights, and you may have other rights which vary from jurisdiction to jurisdiction).

Tripp Lite; 1111 W. 35th Street; Chicago, IL 60609

WARNING: The individual user should take care to determine prior to use whether this device is suitable, adequate or safe for the use intended. Since individual applications are subject to great variation, the manufacturer makes no representation or warranty as to the suitability or fitness of these devices for any specific application.

Tripp Lite's policy is one of continuous improvement. Specifications are subject to change without notice.

Note on Labeling

Two symbols are used on the label.

V~ : AC Voltage

V--- : DC Voltage



1111 W. 35th Street, Chicago, IL 60609 USA
773.869.1234 (USA) • 773.869.1212 (International)
www.triplite.com

Free Manuals Download Website

<http://myh66.com>

<http://usermanuals.us>

<http://www.somanuals.com>

<http://www.4manuals.cc>

<http://www.manual-lib.com>

<http://www.404manual.com>

<http://www.luxmanual.com>

<http://aubethermostatmanual.com>

Golf course search by state

<http://golfingnear.com>

Email search by domain

<http://emailbydomain.com>

Auto manuals search

<http://auto.somanuals.com>

TV manuals search

<http://tv.somanuals.com>