



Owner's Manual



1111 W. 35th Street,
Chicago, IL 60609
Customer Support: (773) 869-1234
www.tripplite.com

HDTV Multimedia Wall Plate Model: A152-000-2



Your A152-000-2 HDTV Multimedia Wall Plate comes preloaded with the most common couplers for multimedia in-wall cable installation. You can customize your wall plate by switching any of the pre-installed keystone inserts with the alternate ones supplied in the package.

Removing a Keystone Insert from the Wall Plate

You can remove any of the keystone inserts from the wall plate by using a small, flathead screwdriver. With the wall plate laying on a flat surface, insert the blade of the screwdriver between the insert's snap-in tab and the wall plate (as shown) and press the tab down toward the insert until the insert snaps out of the port.

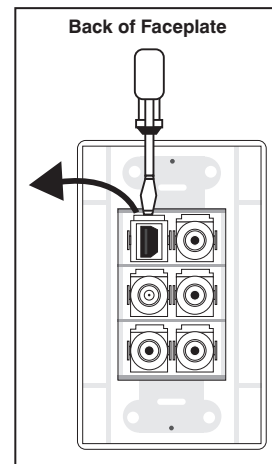

Removing a Coupler from a Keystone Insert

- 1) Using both hands, hold the keystone insert between both of your thumbs and forefingers. Make sure the tabs that hold the coupler in place are facing upward.
- 2) Use your forefingers to gently pull each tab away from the coupler.
- 3) Using both thumbs, push the coupler upward until it can be removed from the keystone insert.

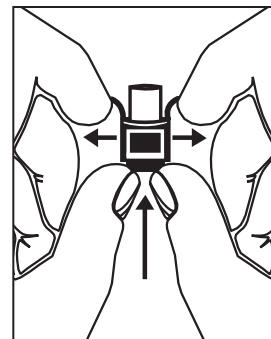

Copyright © 2008 Tripp Lite. All rights reserved. All trademarks are the property of their respective owners.
Tripp Lite follows a policy of continuous improvement. Product specifications are subject to change without notice.

93-2772 200801148

Free Manuals Download Website

<http://myh66.com>

<http://usermanuals.us>

<http://www.somanuals.com>

<http://www.4manuals.cc>

<http://www.manual-lib.com>

<http://www.404manual.com>

<http://www.luxmanual.com>

<http://aubethermostatmanual.com>

Golf course search by state

<http://golfingnear.com>

Email search by domain

<http://emailbydomain.com>

Auto manuals search

<http://auto.somanuals.com>

TV manuals search

<http://tv.somanuals.com>