

Owner's Manual

Line Conditioners

(230V, 50/60Hz)



Important Safety Instructions

2

Quick Installation

3

Basic Operation

3

Service & Warranty

4

Specifications

4

Español

5

Français

9



1111 W. 35th Street Chicago, IL 60609 USA
Customer Support: (773) 869-1234 • www.tripplite.com

Copyright © 2002 Tripp Lite. All rights reserved.

Download from Www.Somanuals.com. All Manuals Search And Download.

Important Safety Instructions



SAVE THESE INSTRUCTIONS

This manual contains instructions and warnings that should be followed during the installation, operation and storage of all Tripp Lite line conditioners. Failure to heed these warnings will void your warranty.

Line Conditioner Location Warnings

- Install your line conditioner indoors, away from excess moisture and heat, direct sunlight, and dust and other conductive contaminants.
- For best performance, keep the indoor temperature between 0° C and 40° C (between 32° F and 104° F).
- Leave adequate space around all sides of the line conditioner for proper ventilation.

Line Conditioner Connection Warnings

- Connect your line conditioner directly to a properly grounded AC power outlet. Do not use adapters that would eliminate the line conditioner's connection to ground.
- Do not use extension cords between the line conditioner and the AC outlet. If necessary, a Tripp Lite surge suppressor may be used between the line conditioner and the AC outlet.
- If you are connecting your line conditioner to a motor-powered AC generator, the generator must provide clean, filtered computer-grade output. Connecting your line conditioner to a generator will void its Ultimate Lifetime Insurance.

Equipment Connection Warning

- Do not use Tripp Lite line conditioners for life support applications in which a malfunction or failure of a Tripp Lite line conditioner could cause failure or significantly alter the performance of a life-support device.

Line Conditioner Maintenance Warning

- Tripp Lite line conditioners require no maintenance. Keep the line conditioner dry at all times. DO NOT open the unit for any reason.

Quick Installation

1 Connect your equipment to the line conditioner, and the line conditioner to an electrical outlet.

- 1) Unplug your computer's power cord from both your AC outlet and your computer's AC input.
- 2) Insert the line conditioner's cord's (A) female plug into your computer's AC input. Insert its male plug into any of the line conditioner's output receptacles.
- 3) Insert the female plug of your computer's cord (B) into your line conditioner's AC input. Insert its male plug into your AC outlet.

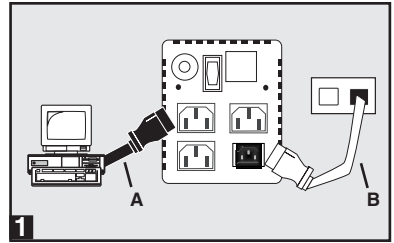

2 Plug your computer and electronics into your line conditioner's outlets.

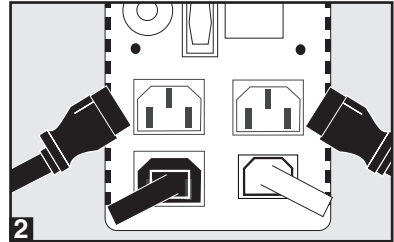

3 Turn your line conditioner's power switch on.

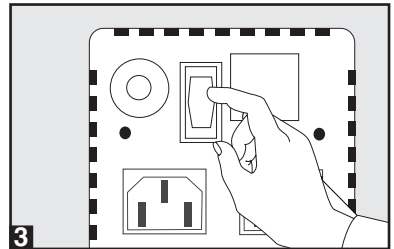

Basic Operation

Indicator Lights

Your line conditioner has up to 3 indicator lights. All indicator light descriptions apply when the line conditioner is plugged into a wall outlet and turned on. Note: As the line conditioner corrects high or low input voltage, the unit will make a gentle clicking sound. The frequency of the clicking will depend on the quality of the utility power in your particular area. The clicking is normal, and no action is required on your part.

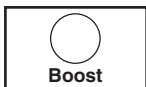

BOOST (Multiple LED Models Only): This yellow light will turn ON whenever your line conditioner is boosting low AC line voltage up to nominal voltage levels.

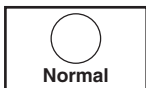

NORMAL (Multiple LED Models Only): This green light will turn ON whenever your line conditioner is receiving normal AC line voltage.

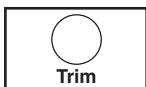

TRIM (Multiple LED Models Only): This yellow light will turn ON whenever your line conditioner is trimming high AC line voltage down to nominal voltage levels.

Basic Operation *continued*

Other Line Conditioner Features

Lighted Power Switch/Input Breaker

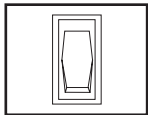

Flip this switch to ON to activate power at the line conditioner's receptacles. This switch will light up when the line conditioner is plugged in and turned on. This switch will trip to prevent dangerous input voltage from damaging the line conditioner. If this happens, wait for the line conditioner to cool, then flip the switch back to reset the breaker.

AC Receptacles

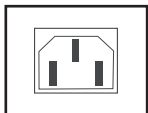

These IEC 320F receptacles provide your connected equipment with AC line power during normal operation. They adjust incoming voltage to provide equipment with nominal 230V power. These receptacles also protect your equipment against damaging surges and line noise, eliminating the need for external surge suppression.

Service & Warranty

If returning your line conditioner to Tripp Lite or an authorized Tripp Lite service center, please carefully pack it using the ORIGINAL PACKING MATERIAL that came with the unit. Enclose a letter describing the symptoms of the problem. If the line conditioner is within the warranty period, enclose a copy of your sales receipt.

2-Year Limited Warranty

TRIPP LITE warrants its products to be free from defects in materials and workmanship for a period of two years from the date of initial purchase. TRIPP LITE's obligation under this warranty is limited to repairing or replacing (at its sole option) any such defective products. To obtain service under this warranty, you must obtain a Returned Material Authorization (RMA) number from TRIPP LITE or an authorized TRIPP LITE service center. Products must be returned to TRIPP LITE or an authorized TRIPP LITE service center with transportation charges prepaid and must be accompanied by a brief description of the problem encountered and proof of date and place of purchase. This warranty does not apply to equipment which has been damaged by accident, negligence or misapplication or has been altered or modified in any way. This warranty applies only to the original purchaser who must have properly registered the product within 10 days of purchase.

EXCEPT AS PROVIDED HEREIN, TRIPP LITE MAKES NO WARRANTIES, EXPRESS OR IMPLIED, INCLUDING WARRANTIES OF MERCHANTABILITY AND FITNESS FOR A PARTICULAR PURPOSE. Some states do not permit limitation or exclusion of implied warranties; therefore, the aforesaid limitation(s) or exclusion(s) may not apply to the purchaser.

EXCEPT AS PROVIDED ABOVE, IN NO EVENT WILL TRIPP LITE BE LIABLE FOR DIRECT, INDIRECT, SPECIAL, INCIDENTAL OR CONSEQUENTIAL DAMAGES ARISING OUT OF THE USE OF THIS PRODUCT, EVEN IF ADVISED OF THE POSSIBILITY OF SUCH DAMAGE. Specifically, TRIPP LITE is not liable for any costs, such as lost profits or revenue, loss of equipment, loss of use of equipment, loss of software, loss of data, costs of substitutes, claims by third parties, or otherwise.

Specifications

Tripp Lite has a policy of continuous improvement. Specifications are subject to change without notice.

Model	LR604
Series	AGLR600Q2
Nominal Voltage:	230 volts
Input Frequency:	50/60 Hz
Input Voltage Range:	179 - 270 volts
Output Capacity (VA/Watts):	600/600
Approvals:	CE

ALL UNITS: AC Surge Suppression (exceeds IEEE 587 Cat. A & B standards); AC Noise Attenuation (>20 dB at 1MHz); AC Protection Modes (H to N).



1111 W. 35th Street, Chicago, IL 60609 USA
773.869.1234 (USA) • 773.869.1212 (International)
www.triplite.com

Free Manuals Download Website

<http://myh66.com>

<http://usermanuals.us>

<http://www.somanuals.com>

<http://www.4manuals.cc>

<http://www.manual-lib.com>

<http://www.404manual.com>

<http://www.luxmanual.com>

<http://aubethermostatmanual.com>

Golf course search by state

<http://golfingnear.com>

Email search by domain

<http://emailbydomain.com>

Auto manuals search

<http://auto.somanuals.com>

TV manuals search

<http://tv.somanuals.com>