



1111 W. 35th Street  
Chicago, IL 60609 USA  
Customer Support:  
+1(773) 869-1234  
www.tripplite.com

Owner's Manual  
**LINE  
CONDITIONERS**

(220/240V-50/60 Hz )

ESPAÑOL: p. 6  
FRANÇAIS: p. 11  
DEUTSCH: p. 16

**Safety: p. 2**

**Quick Installation: p. 3**

**Basic Operation: p. 4**

**Service: p. 5**

**Warranty: p. 5**

# Safety

**This manual contains important instructions and warnings that should be followed during the installation, operation and storage of all Line Conditioners.**

## ***Line Conditioner Location Warnings***

- Install your Line Conditioner indoors, away from excess moisture or heat, dust or direct sunlight.
- For best performance, keep the indoor temperature between 0° C and 40° C (between 32° F and 104° F).
- Leave adequate space around all sides of the Line Conditioner for proper ventilation.

## ***Line Conditioner Connection Warnings***

- Connect your Line Conditioner to a three-wire, grounded AC power outlet. Do not remove or modify the ground pin of the Line Conditioner's plug.
- Do not use two-prong adapters with the Line Conditioner's plug. Do not plug your Line Conditioner into itself; this will damage the Line Conditioner and void your warranty.
- If you are connecting your Line Conditioner to a motor-powered AC generator, the generator must provide clean, filtered computer-grade output.
- Use care when connecting country-specific plugs to selected 220/240V, 50/60 Hz Line Conditioners. Hot 1 and Hot 2 may be reversed. When using a French CEE7/7 plug, always use the separate grounding pin supplied with the unit. When using a Schuko CEE7/4 plug, an ungrounded condition will exist unless separate grounding to the rear of the Line Conditioner is provided by the user.

## ***Equipment Connection Warning***

- Do not use Line Conditioners for life support applications in which a malfunction or failure of a Line Conditioner could cause failure or significantly alter the performance of a life-support device.

## ***Line Conditioner Maintenance Warning***

- Line Conditioners require no maintenance. Keep the Line Conditioner dry at all times. DO NOT open the unit for any reason.

# Quick Installation—220/240V-50/60 Hz

- 1** **Connect your computer or electronics to the Line Conditioner, and the Line Conditioner to an electrical outlet.**

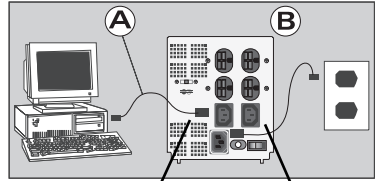

A. Exchange the Line Conditioner's cord with your equipment's cord. Connect the Line Conditioner cord's male plug into a Line Conditioner receptacle. Connect its female plug into the equipment's male input.

B. Connect the equipment cord's male plug into a wall outlet. Connect its female plug into the line conditioner's male input.

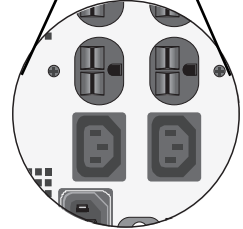

- 2** **Connect additional equipment to the Line Conditioner in the same manner.**

Additional cords and receptacle adapters are available to accommodate most outlet configurations.

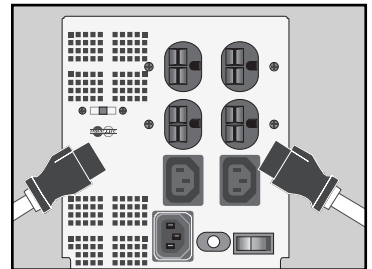

- 3** **Turn on your Line Conditioner's power switch.**

**Note:** (select models) Source Voltage Matching Switch

Set the source voltage matching switch to either 208, 220 or 240 volts to match the input voltage being used.

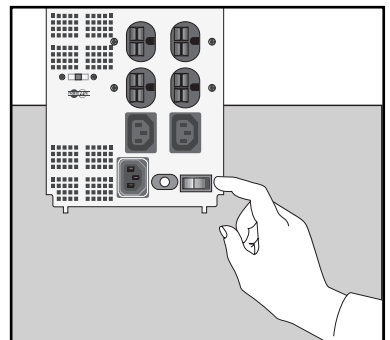

# Basic Operation

## Indicator Lights

All indicator light descriptions apply when the Line Conditioner is plugged into a wall outlet and turned on. (Available on select models only.)

A green "NORM" light will turn ON whenever your Line Conditioner is plugged in and receiving nominal AC line voltage.

Yellow lights labelled "LOW" (or "BOOST") and "HIGH" (or "TRIM") will turn ON when incoming voltage is above or below nominal AC line voltage.

Red lights labelled "VERY HIGH" or "VERY LOW" will turn ON when incoming voltage is substantially above or below nominal AC line voltage.

A green "LINE OK" light will turn ON when AC power is present and no wiring faults are detected. When this light is illuminated, AC power is acceptable for connected equipment.

A red "LINE FAULT" light will turn ON to indicate a wiring fault has been detected. The condition should be investigated and repaired by a qualified technician as soon as possible. A loose wall outlet may cause this light to come ON. Your Line Conditioner will identify most common wiring faults (but not necessarily every possible type of fault).

## Other Features



IEC-320-C13  
(220/240V)

**AC Receptacles:** The receptacles provide your connected equipment with AC line power during normal operation. They adjust incoming voltage to provide equipment with nominal 220/240V power. The receptacles also protect your equipment against damaging surges and line noise, eliminating the need for external surge suppression.



NEMA 5-15R\*  
(220/240V)

**Note:** As the Line Conditioner corrects fluctuating input voltages, the unit will make a gentle clicking sound. The frequency of the clicking will depend on the quality of the utility power in your particular area. The clicking is normal and indicates the Line Conditioner is compensating for fluctuating input voltages as described in this manual.

\* Available on select models.

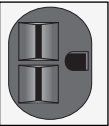

NEMA 6-15R\*  
(220/240V)



**Circuit Breaker (Available on select models):** If the rated capacity of the Line Conditioner is exceeded at any time, the circuit breaker will open (trip). Remove the overload and let the circuit breaker cool for one minute. Reset the circuit breaker by pushing in the plunger.

# Service

If returning your Line Conditioner to Tripp Lite or an authorized Tripp Lite service center, please carefully pack the it using the ORIGINAL PACKING MATERIAL that came with the unit. Enclose a letter describing the symptoms of the problem. If the Line Conditioner is within the 2 year warranty period, enclose a copy of your sales receipt.

## 2-Year Limited Warranty

TRIPP LITE warrants its products to be free from defects in materials and workmanship for a period of two years from the date of initial purchase. TRIPP LITE's obligation under this warranty is limited to repairing or replacing (at its sole option) any such defective products. To obtain service under this warranty, you must obtain a Returned Material Authorization (RMA) number from TRIPP LITE or an authorized TRIPP LITE service center. Products must be returned to TRIPP LITE or an authorized TRIPP LITE service center with transportation charges prepaid and must be accompanied by a brief description of the problem encountered and proof of date and place of purchase. This warranty does not apply to equipment which has been damaged by accident, negligence or misapplication or has been altered or modified in any way. This warranty applies only to the original purchaser who must have properly registered the product within 10 days of purchase.

EXCEPT AS PROVIDED HEREIN, TRIPP LITE MAKES NO WARRANTIES, EXPRESS OR IMPLIED, INCLUDING WARRANTIES OF MERCHANTABILITY AND FITNESS FOR A PARTICULAR PURPOSE. Some states do not permit limitation or exclusion of implied warranties; therefore, the aforesaid limitation(s) or exclusion(s) may not apply to the purchaser.

EXCEPT AS PROVIDED ABOVE, IN NO EVENT WILL TRIPP LITE BE LIABLE FOR DIRECT, INDIRECT, SPECIAL, INCIDENTAL OR CONSEQUENTIAL DAMAGES ARISING OUT OF THE USE OF THIS PRODUCT, EVEN IF ADVISED OF THE POSSIBILITY OF SUCH DAMAGE. Specifically, TRIPP LITE is not liable for any costs, such as lost profits or revenue, loss of equipment, loss of use of equipment, loss of software, loss of data, costs of substitutes, claims by third parties, or otherwise.

The policy of TRIPP LITE is one of continuous improvement. Specifications are subject to change without notice.

### **Regulatory Compliance Identification Numbers**

Select models: For the purpose of regulatory compliance certifications and identification, your Tripp Lite product may have been assigned a unique series number. The series number can be found on the product nameplate label, along with all required approval markings and information. When requesting compliance information for this product, always refer to the series number. The series number should not be confused with the marking name or model number of the product.



1111 W. 35th Street, Chicago, IL 60609 USA  
773.869.1234 (USA) • 773.869.1212 (International)  
[www.triplite.com](http://www.triplite.com)

## Free Manuals Download Website

<http://myh66.com>

<http://usermanuals.us>

<http://www.somanuals.com>

<http://www.4manuals.cc>

<http://www.manual-lib.com>

<http://www.404manual.com>

<http://www.luxmanual.com>

<http://aubethermostatmanual.com>

Golf course search by state

<http://golfingnear.com>

Email search by domain

<http://emailbydomain.com>

Auto manuals search

<http://auto.somanuals.com>

TV manuals search

<http://tv.somanuals.com>