

Warranty Registration:
register online today for a
chance to win a FREE Tripp Lite
product—www.tripplite.com/warranty



Owner's Manual

Presentation Remote Pro Gyro Model: PR-PR04



Français

9

TRIPP·LITE



KEYSPAN

1111 W. 35th Street, Chicago, IL 60609 USA
www.tripplite.com/support
Copyright © 2010 Tripp Lite. All rights reserved.

Package Contents

- Remote Control
- Nano Receiver (located in compartment at top of remote)
- Drawstring Carry Pouch
- AAA Batteries (x2)
- Owner's Manual

Compatibility

The PR-PRO GYRO Presentation Remote is compatible with:

- Windows® 98SE
- Windows 2000™
- Windows ME
- Windows XP™
- Windows Vista™
- Windows 7

Note: HID Drivers are part of the Windows Operating System and need to be installed for the remote to function.

Overview & Features

The PR-PRO GYRO is a Presentation Remote and Microsoft Wireless Game Controller for PowerPoint® presentations, air mouse functions, and wireless gaming.

Using the PR-PRO GYRO

This product has two operating modes:

Presenter Mode: Air mouse and presentation functions. Presentation functions are based on Windows PowerPoint® and other popular presentation software.

Game Mode: Standard Microsoft wireless game controller function. Gamer mode works with standard keyboard-based Microsoft software.

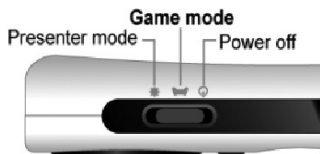

Mode Switch

This switch allows user to alternate between Presenter and Game Modes or to power off the remote.

Presenter Mode

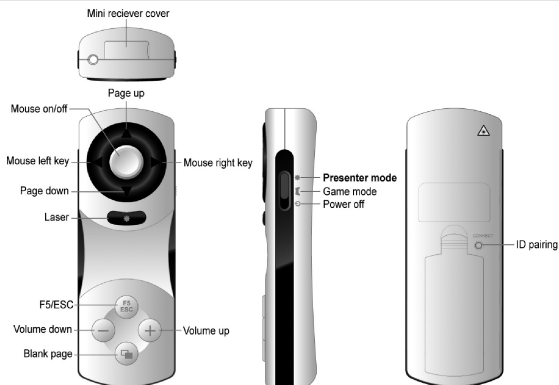

Note: Actual product may differ slightly from product images.

Control	Description
Mouse	Double click to turn on the cursor automatically/ Press and hold for semi-automatic control
UP	Power Point page up
DOWN	Power Point page down
LEFT	Mouse left key
RIGHT	Mouse right key
Laser	Laser ON/OFF button
F5/ESC	Power Point F5 and ESC
Blank Page	Power Point blank page
Volume Up	Power Point Volume up
Volume Down	Power Point Volume down

Game Mode

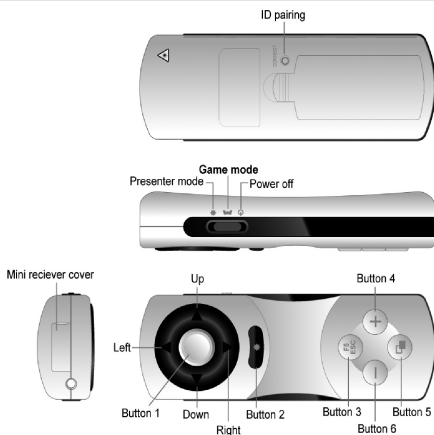

Control	Description
Button 1	Microsoft standard game controller button 1
Button 2	Microsoft standard game controller button 2
Button 3	Microsoft standard game controller button 3
Button 4	Microsoft standard game controller button 4
Button 5	Microsoft standard game controller button 5
Button 6	Microsoft standard game controller button 6
Up	Microsoft standard game controller button up
Down	Microsoft standard game controller button down
Left	Microsoft standard game controller button left
Right	Microsoft standard game controller button right

Pairing

You must pair the presenter and receiver before using your PR-PRO4 for the first time. After the initial pairing, you should not need to repeat this process.

- 1** Insert the Nano Receiver into an available USB port. Press the Connect button on the receiver. The blue LED will flash slowly.



- 2** Press the ID Pairing button on the presenter. The blue LED on the receiver will flash rapidly when the pairing process is complete.

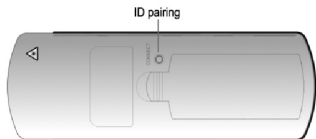

- 3** If your PR-PRO GYRO stops functioning properly, repeat the pairing process.

Remote Pointer Specifications

- 1** Frequency Range: 2.4 to 2.483 GHz
(16 multi channels and 65535 ID channels)
- 2** Operational Voltage: 2.4~3.2V

Warranty & Warranty Registration

1-Year Limited Warranty

TRIPP LITE warrants its products to be free from defects in materials and workmanship for a period of one (1) year from the date of initial purchase. TRIPP LITE's obligation under this warranty is limited to repairing or replacing (at its sole option) any such defective products. To obtain service under this warranty, you must obtain a Returned Material Authorization (RMA) number from TRIPP LITE or an authorized TRIPP LITE service center. Products must be returned to TRIPP LITE or an authorized TRIPP LITE service center with transportation charges prepaid and must be accompanied by a brief description of the problem encountered and proof of date and place of purchase. This warranty does not apply to equipment which has been damaged by accident, negligence or misapplication or has been altered or modified in any way.

EXCEPT AS PROVIDED HEREIN, TRIPP LITE MAKES NO WARRANTIES, EXPRESS OR IMPLIED, INCLUDING WARRANTIES OF MERCHANTABILITY AND FITNESS FOR A PARTICULAR PURPOSE. Some states do not permit limitation or exclusion of implied warranties; therefore, the aforesaid limitation(s) or exclusion(s) may not apply to the purchaser.

EXCEPT AS PROVIDED ABOVE, IN NO EVENT WILL TRIPP LITE BE LIABLE FOR DIRECT, INDIRECT, SPECIAL, INCIDENTAL OR CONSEQUENTIAL DAMAGES ARISING OUT OF THE USE OF THIS PRODUCT, EVEN IF ADVISED OF THE POSSIBILITY OF SUCH DAMAGE. Specifically, TRIPP LITE is not liable for any costs, such as lost profits or revenue, loss of equipment, loss of use of equipment, loss of software, loss of data, costs of substitutes, claims by third parties, or otherwise.

WARRANTY REGISTRATION

Visit www.triplite.com/warranty today to register the warranty for your new Tripp Lite product. You'll be automatically entered into a drawing for a chance to win a FREE Tripp Lite product!

* No purchase necessary. Void where prohibited. Some restrictions apply. See website for details.

Regulatory Compliance Identification Numbers

For the purpose of regulatory compliance certifications and identification, your Tripp Lite product has been assigned a unique series number. The series number can be found on the product nameplate label, along with all required approval markings and information. When requesting compliance information for this product, always refer to the series number. The series number should not be confused with the marking name or model number of the product.

Warranty & Warranty Registration (continued)

FCC Notice, Class B

This device complies with part 15 of the FCC Rules. Operation is subject to the following two conditions: (1) This device may not cause harmful interference, and (2) this device must accept any interference received, including interference that may cause undesired operation.

Note: This equipment has been tested and found to comply with the limits for a Class B digital device, pursuant to part 15 of the FCC Rules. These limits are designed to provide reasonable protection against harmful interference in a residential installation. This equipment generates, uses and can radiate radio frequency energy and, if not installed and used in accordance with the instructions, may cause harmful interference to radio communications. However, there is no guarantee that interference will not occur in a particular installation. If this equipment does cause harmful interference to radio or television reception, which can be determined by turning the equipment off and on, the user is encouraged to try to correct the interference by one or more of the following measures:

- Reorient or relocate the receiving antenna.
- Increase the separation between the equipment and receiver.
- Connect the equipment into an outlet on a circuit different from that to which the receiver is connected.
- Consult the dealer or an experienced radio/TV technician for help

Any changes or modifications to this equipment not expressly approved by Tripp Lite could void the user's authority to operate this equipment.

To protect against risk of fire, bodily injury, electric shock or damage to the equipment:

- Do not immerse any part of this product in water or other liquid.
- Do not spray liquid on this product or allow excess liquid to drip inside.
- Do not use this product if it has sustained damage, such as a damaged cord or plug.
- Disconnect this product or remove its batteries before cleaning.

WARNING!

Use of this equipment in life support applications where failure of this equipment can reasonably be expected to cause the failure of the life support equipment or to significantly affect its safety or effectiveness is not recommended. Do not use this equipment in the presence of a flammable anesthetic mixture with air, oxygen or nitrous oxide.

WEEE Compliance Information for Tripp Lite Customers and Recyclers (European Union)

Under the Waste Electrical and Electronic Equipment (WEEE) Directive and implementing regulations, when customers buy new electrical and electronic equipment from Tripp Lite they are entitled to:

- Send old equipment for recycling on a one-for-one, like-for-like basis (this varies depending on the country)
- Send the new equipment back for recycling when this ultimately becomes waste

Tripp Lite follows a policy of continuous improvement. Product specifications are subject to change without notice.



1111 W. 35th Street
Chicago, IL 60609 USA
www.triplite.com/support

Manuel du Propriétaire

Télécommande de Présentation Pro Gyro

Model: PR-PR04



English

1



1111 W. 35th Street, Chicago, IL 60609 USA
www.triplite.com/support
Copyright © 2010 Tripp Lite. Tous droits réservés.

Contenu du Coffret

- Télécommande
- Nanorécepteur (situé dans le compartiment au sommet de la télécommande)
- Bourse de transport à cordon
- Piles AAA (x2)
- Manuel de l'utilisateur

Compatibilité

La Télécommande de présentation PR-PRO GYRO est compatible avec:

- Windows® 98SE
- Windows 2000™
- Windows ME
- Windows XP™
- Windows Vista™
- Windows 7

Remarque: Les pilotes HID font partie du système d'exploitation Windows et doivent être installés pour que la télécommande fonctionne.

Présentation et Caractéristiques

Le modèle PR-PRO GYRO est une télécommande de présentation ainsi qu'une manette de jeu sans fil Microsoft pour les présentations PowerPoint®, les souris sans fil et les jeux sans fil.

Utilisation de PR-PRO GYRO

Ce produit a deux modes de fonctionnement :

Mode Présentation : Fonctions de présentation et souris sans fil. Les fonctions de présentation se basent sur Windows PowerPoint® et tout autre logiciel populaire de présentation.

Mode Jeu : Fonction de manette de jeu sans fil Microsoft standard. Le mode jeu fonctionne avec tous les logiciels Microsoft sur clavier standard.

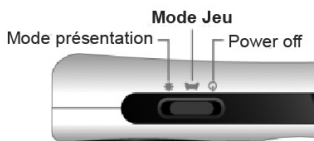

Mode Alternance

Ce mode permet à l'utilisateur d'alterner entre les modes présentation et jeu ou d'éteindre la télécommande.

Mode Présentation

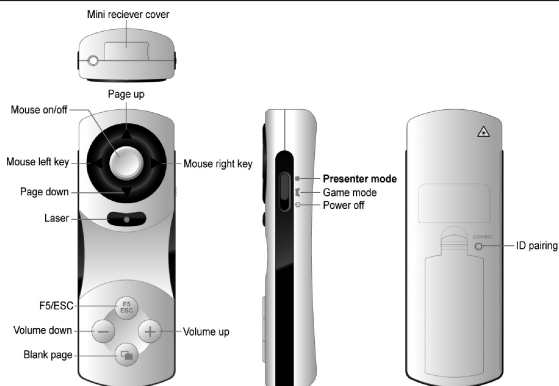

Remarque: Il se peut que le produit réel diffère légèrement des photos.

Commande	Description
Souris	Double-cliquez pour allumer le curseur automatiquement/Pressez et maintenez pour un contrôle semi-automatique
Flèche Haut	Page suivante Power Point
Flèche Bas	Page précédente Power Point
Flèche gauche	Bouton de gauche de la souris
Flèche droite	Bouton de droite de la souris
Laser	Bouton ON/OFF laser
F5/Échap	F5 et Échap Power Point
Page vierge	Page vierge Power Point
Hausse volume	Hausse volume Power Point
Baisse volume	Baisse volume Power Point

Mode Jeu

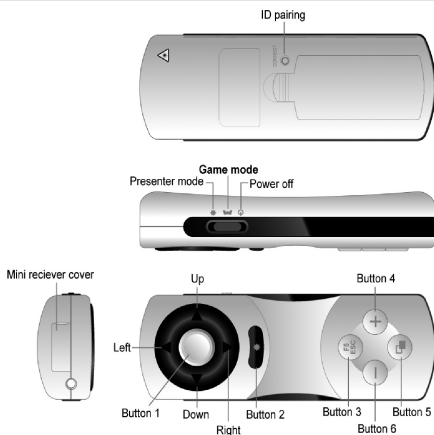

Commande	Description
Bouton 1	Bouton de manette de jeu standard Microsoft 1
Bouton 2	Bouton de manette de jeu standard Microsoft 2
Bouton 3	Bouton de manette de jeu standard Microsoft 3
Bouton 4	Bouton de manette de jeu standard Microsoft 4
Bouton 5	Bouton de manette de jeu standard Microsoft 5
Bouton 6	Bouton de manette de jeu standard Microsoft 6
Haut	Bouton de manette de jeu standard Microsoft Haut
Bas	Bouton de manette de jeu standard Microsoft Bas
Gauche	Bouton de manette de jeu standard Microsoft Gauche
Droite	Bouton de manette de jeu standard Microsoft Droite

Association

Vous devez associer le présentateur au récepteur avant d'utiliser votre PR-PRO4 pour la première fois. Après l'association initiale, vous ne devez pas répéter ce processus.

- 1** Insérez le nanorécepteur dans un port USB libre. Appuyez sur la touche « Connect » du récepteur. Le voyant bleu clignotera lentement.
- 2** Enfoncez le bouton « ID Pairing » du présentateur. Le voyant bleu du récepteur clignotera rapidement lorsque le processus d'association sera terminé.
- 3** Si votre PR-PRO GYRO ne fonctionne plus correctement, répétez le processus d'association.

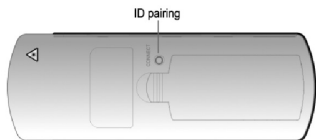

Spécifications de la Télécommande

- 1** Plage de fréquences : 2,4 à 2,483 GHz
(16 multicanaux et 65535 canaux ID)
- 2** Tension opérationnelle : 2,4~3,2V

Avertissements

Numéros d'identification de conformité aux règlements

À des fins de certification et d'identification de conformité aux règlements, votre produit Tripp Lite a reçu un numéro de série unique. Ce numéro se retrouve sur la plaque signalétique du produit, avec les inscriptions et informations d'approbation requises. Lors d'une demande d'information de conformité pour ce produit, utilisez toujours le numéro de série. Il ne doit pas être confondu avec le nom de la marque ou le numéro de modèle du produit.

Il est déconseillé d'utiliser cet équipement dans des applications médicales où une panne de cet équipement pourrait normalement provoquer la panne de l'équipement de survie ou altérer notablement sa sécurité ou son efficacité. Ne pas utiliser cet équipement en présence d'un mélange anesthésique inflammable avec de l'air, de l'oxygène ou de l'oxyde nitreux.

L'information de conformité WEEE pour les clients de Tripp Lite et recycleurs (Union européenne)

Sous les directives et règlements de déchet d'équipements électrique et électronique (Waste Electrical and Electronic Equipment, WEEE), lorsque les clients achètent le matériel électrique et électronique neuf de Tripp Lite ils sont autorisés à :

- Envoyer le vieux matériel pour le recyclage sur une base de un-contre-un et en nature (ceci varie selon le pays)
- Renvoyer le matériel neuf pour recyclage quand ceci devient éventuellement un rebut

La politique de Tripp Lite est celle d'une amélioration continue. Les spécifications peuvent être modifiées sans préavis.



1111 W. 35th Street
Chicago, IL 60609 USA
www.tripplite.com/support

Free Manuals Download Website

<http://myh66.com>

<http://usermanuals.us>

<http://www.somanuals.com>

<http://www.4manuals.cc>

<http://www.manual-lib.com>

<http://www.404manual.com>

<http://www.luxmanual.com>

<http://aubethermostatmanual.com>

Golf course search by state

<http://golfingnear.com>

Email search by domain

<http://emailbydomain.com>

Auto manuals search

<http://auto.somanuals.com>

TV manuals search

<http://tv.somanuals.com>