



32997-0920  
32997 (9.6V Turbo® Battery Pack & Charger)  
32998 (9.6V Turbo® Battery Pack)

# 9.6V TURBO™ PREMIUM NiCd RECHARGEABLE BATTERY PACK/CHARGER

The TYCO® R/C 9.6V Turbo® power system gives you economical and reliable power for speed, stunts and all-around performance. Here are a few tips and hints:

- The 9.6V Turbo Battery Pack and Charger will work with all 9.6V NiCd-powered R/C vehicles.
- Your vehicle's running time will vary depending on its power consumption (and your driving style).
- A high-performance vehicle driven at full speed, with frequent turns and stunts, will give the shortest running time between charges. For maximum performance, please read all operating instructions before operating.

**CAUTION-ELECTRIC TOY.** NOT RECOMMENDED FOR CHILDREN UNDER 8 YEARS OF AGE. AS WITH ALL ELECTRIC PRODUCTS, PRECAUTIONS SHOULD BE OBSERVED DURING HANDLING AND USE TO PREVENT ELECTRIC SHOCK.  
INPUT: 120VAC, 0.10VDC 60HZ, ONLY. OUTPUT: 11.5VDC, 1.05VA

Keep these instructions for future reference; they contain important information.



**TYCO® R/C  
CONSUMER AFFAIRS  
WE CARE!**

If you have questions or difficulty operating this vehicle, **DO NOT RETURN IT TO THE STORE!**  
Call Toll-Free 1-888-557-TYCO (1-888-557-8926) for EXPERT technical help and RAPID parts and service assistance.  
[www.tycorc.com](http://www.tycorc.com)

## TO CHARGE THE 9.6V TURBO® BATTERY PACK, PLEASE FOLLOW THESE INSTRUCTIONS:

1. Plug wall pack charger into standard wall outlet.
2. Connect the wires leading from the battery pack to the wall pack charger connector. Make certain the two connectors are tightly snapped together.
3. To disconnect wires, push down on the connector clip and pull apart.
4. Your battery pack consists of new parts and materials; therefore, you should charge the battery pack for 5 1/2 hours the first two times you charge the battery. Subsequent charges will require only 4 hours.
5. After charging for 4 hours, the battery will feel warm. This condition is normal for fully charged batteries.
6. Charging the battery pack for more than 4 hours will not give you a longer running time. 4 hours is all that is required for a fully charged battery pack.
7. Unlike alkaline batteries, where the power loss is gradual, a NiCd (Nickel-Cadmium) battery will run for its normal running time, depending on your particular vehicle, and then lose most of its power at once. It is time to recharge the battery pack.
8. After use, the battery pack will be hot! Wait at least 20 minutes until the battery pack cools before recharging. Recharging a warm or hot battery pack will greatly reduce the number of times your battery pack can be recharged.

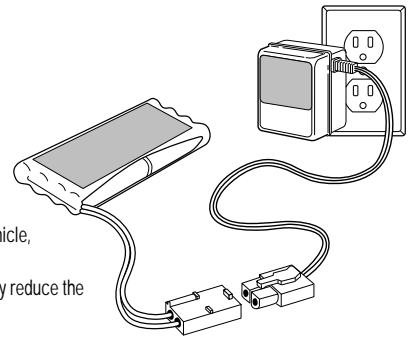

## IMPORTANT BATTERY INFORMATION

- INSURE THAT BATTERY POLARITY IS CORRECT.
- USE ONLY BATTERIES OF THE TYPE RECOMMENDED (OR EQUIVALENT).
- DO NOT MIX OLD AND NEW BATTERIES.
- DO NOT MIX ALKALINE, STANDARD (CARBON-ZINC), OR RECHARGEABLE (NICKEL-CADMIUM) BATTERIES.
- REMOVE USED-UP BATTERIES IMMEDIATELY. REMOVE BATTERIES IF VEHICLE WILL NOT BE USED FOR A LONG PERIOD.
- FOR BEST PERFORMANCE USE ALKALINE BATTERIES (WHERE DISPOSABLE BATTERIES ARE CALLED FOR). BATTERY LIFE MAY VARY DEPENDING ON BATTERY BRAND.
- DO NOT RECHARGE NON-RECHARGEABLE BATTERIES.
- DO NOT SHORT-CIRCUIT TERMINALS.

- REMOVE RECHARGEABLE BATTERIES BEFORE RECHARGING. RECHARGE BATTERIES ONLY UNDER ADULT SUPERVISION.
- DISPOSE OF BATTERIES SAFELY.

### CAUTIONS:

- DO NOT RECHARGE BATTERY PACK IF IT'S HOT. ALLOW IT TO COOL BEFORE RECHARGING.
- DO NOT CHARGE A BATTERY PACK THAT SHOWS LEAKAGE OR CORROSION.
- DO NOT DISASSEMBLE THE BATTERY PACK. THE BATTERY PACK IS A SEALED NiCd (NICKEL-CADMIUM) BATTERY.
- DO NOT DISPOSE OF THE BATTERY PACK IN FIRE.
- EXERCISE CAUTION IN HANDLING A HOT BATTERY PACK.
- IF BATTERY PACK AND/OR CHARGER ARE WET, THOROUGHLY DRY BEFORE CHARGING.

## SPECIAL NOTE TO ADULTS:

- This product is age-graded for ages 8 and over; it should be operated in the presence of children under age 8 only with adult supervision.
- Regularly examine for damage to the plug, enclosure and other parts. In the event of any damage, the toy must not be used with the transformer until the damage has been repaired.
- This toy is not intended for children under 3 years old. The transformer is not a toy.



This vehicle uses a Nickel-Cadmium rechargeable battery pack. Must be recycled or disposed of properly. NOTE: If you have any questions about proper disposal of Nickel-Cadmium batteries, contact your local county office of solid waste management (or other appropriate local office) for information.

## FREQUENTLY ASKED QUESTIONS

Here are our answers to some of the questions our customers ask most often.

Take a second to read them over. Maybe the answer to your question is here.



OTHER QUESTIONS?  
CALL OUR TOLL-FREE NUMBER.  
WE'LL BE GLAD TO HELP.

QUESTIONS?	ANSWERS!
Can I leave my battery pack charging for longer than 4 hours?	Although 4 hours is all you need for a full charge, leaving the battery pack charging for a brief additional period will do no harm. However, "overcharging" the battery pack on a regular basis will decrease battery pack life.
Can I leave my charger plugged in all the time?	Just as a matter of basic electrical safety, we don't recommend this practice.
Can I charge my battery pack for less than 4 hours if I don't need the full running time?	Although you can do this occasionally without harm to the battery pack, we don't recommend it as a routine practice. To cut down on waiting time, you might want to buy and charge an extra battery pack.
Can I recharge my battery pack before it's fully discharged?	We discourage this practice. Although it poses no safety hazard, it may significantly reduce battery pack life.
How will I know if my battery pack is "wearing out?"	After many, many uses, the battery pack's average running time will start to decrease: it's nearing the end of its life.
How long will a fully-charged battery pack hold its charge if I'm not actually using it?	At room temperature, the battery pack will hold a charge for a good while; at warmer temperatures, it will discharge more quickly. For gift giving, you can certainly charge your battery pack a day or so beforehand and wrap the battery pack and vehicle together. That way the fun can start right away!
If I'm going to store my battery pack for a long time, should I put it away charged or discharged?	From the standpoint of electrical safety, we recommend storing the battery pack in a discharged condition.

## WARRANTY

### TYCO® R/C 90-DAY LIMITED WARRANTY: Battery Pack/Battery Pack and Charger

Mattel, Inc. (the "Guarantor") warrants this Battery Pack/Battery Pack and Charger (the "Product") to be free from defects in material and workmanship for a period of ninety (90) days from the date of purchase. Guarantor will repair or replace the Product (at its sole option) if any such defect should appear within the period of this warranty. This warranty applies only to the original purchaser. PLEASE RETAIN YOUR ORIGINAL DATED PURCHASE RECEIPT.

#### RETURN PROCEDURE

In the event of such a defect occurring within the period of this warranty, DO NOT RETURN THE PRODUCT TO THE STORE. Instead, please call the TYCO® R/C toll-free number listed below. Many problems can be solved in this manner. If necessary, you will be given an authorization number to return the Product, postage prepaid insured, to the TYCO® R/C Consumer Affairs Department (please see address below). Enclose your name and address, your dated receipt, and an explanation of the defect. If the defect is covered by this warranty, replacement will be FREE OF CHARGE (less shipping and handling costs). Please do not send products without authorization; delays in service will result.

#### NOT COVERED UNDER WARRANTY

This warranty covers normal use and does not cover the Product if it has been damaged by unreasonable use, neglect, accident, abuse, misuse, improper service or other causes not arising out of defects in materials or workmanship. Failure to furnish an original dated purchase receipt may result in the Product not being covered by this warranty.

#### LIMITATIONS AND EXCLUSIONS

The Guarantor's sole and exclusive liability for defects in material and workmanship shall be limited to repair or replacement of the Product (at its sole option), and the Guarantor shall not be liable for incidental, consequential, or contingent damages (except in those states that do not allow this exclusion or limitation). This warranty is exclusive, and is made in lieu of any other express or implied warranty. This warranty gives you specific legal rights. You may have other rights which vary from state to state. This warranty (and toll-free number) valid in the U.S.A. only.

TOLL-FREE 1-888-557-TYCO (1-888-557-8926)

Call between 8:00 a.m.-5:00 p.m. Eastern Standard Time, Monday-Friday.

Expect some delay in January following the holiday season. Please be patient and keep trying the toll-free number.

CONSUMER AFFAIRS DEPARTMENT

636 Girard Avenue  
East Aurora, NY 14052

## Free Manuals Download Website

<http://myh66.com>

<http://usermanuals.us>

<http://www.somanuals.com>

<http://www.4manuals.cc>

<http://www.manual-lib.com>

<http://www.404manual.com>

<http://www.luxmanual.com>

<http://aubethermostatmanual.com>

Golf course search by state

<http://golfingnear.com>

Email search by domain

<http://emailbydomain.com>

Auto manuals search

<http://auto.somanuals.com>

TV manuals search

<http://tv.somanuals.com>