

WARRANTY REGISTRATION

Visit www.ultimatesupport.com for a quick and convenient process for registering your new Ultimate Support product. Warranty Registration and Proof of Purchase are required for warranty fulfillment. Full Limited Lifetime Warranty and Ultimate Protection Plus Premium Service and Support Plan details are available online under Music Gear & Instrument Stands / Customer Support.

ULTIMATE
SUPPORT™

LIMITED LIFETIME WARRANTY

Ultimate Support products are constructed of the finest materials and designed and tested to stand up to the demanding lifestyle of the touring musician, gigging DJ, and working sound engineer. In the unlikely event that a product should fail due to manufacturing defect, Ultimate Support is pleased to repair or replace that product.

Please see www.ultimatesupport.com for more information.

This warranty applies to the original purchaser only and does not include damage to the product resulting from normal wear and tear, accident, misuse, improper installation or operation, or unauthorized repair or alterations.

800.525.5628 . www.ultimatesupport.com . Copyright 2010, Ultimate Support Systems . All Rights Reserved

ULTIMATE
SUPPORT™

THE STRENGTH OF INNOVATION

Product Manual
for Ultimate Support

IQ SERIES®

2ND TIER ASSEMBLY FOR
IQ-1000 AND IQ-2000

IQ-200
ITEM #13360

ULTIMATE
SUPPORT™

LIMITED LIFETIME WARRANTY

Revision 6, 03.21.09 . Product Manual Item #13360M

PARTS INCLUDED

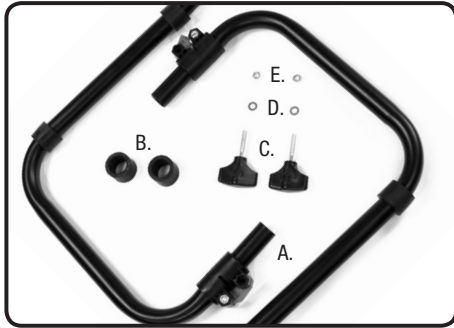

- A. (2) Tier Assemblies
- B. (2) Small Friction Sleeves
- C. (2) Z-nobs
- D. (2) Washers
- E. (2) Hex Nuts

Z-nobs, washer, and hex nuts are assembled together. Remove hex nuts when adding to tier assemblies.

IQ-200 SETUP INSTRUCTIONS



Remove rubber sleeves from back side of the two top tubes of the IQ-1000 or IQ-2000.



Slide on Small Friction Sleeve to desired position. Leave at least 1.25" clearance from the end of the tube for the 2nd Tier Assembly.



While holding the plastic red triangle, slide the 2nd tier into the top tube.



In preparation for STEP 3, use water and soap to lubricate tube.

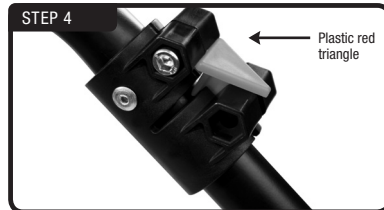

Make sure the plastic red triangle is at the joint. This helps keep the joint open for sliding the 2nd Tier Assembly into place.



Remove the plastic red triangle when Tier Assembly is fully in.

IQ-200 SETUP INSTRUCTIONS (Continued)



Install hand z-knob, washer, and hex nut. It is important to place the hand knob on the inside or stand will not fold fully. Also, be careful not to over-tighten the hand knobs because over-tightening may cause cracking of the collar.



Repeat steps 1-7 with other 2nd Tier Assembly.

IQ-200 TEAR DOWN INSTRUCTIONS

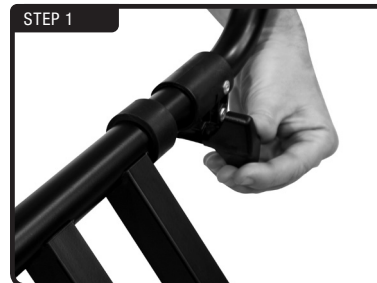

Loosen z-knob until resistance is gone. You do not have to completely unscrew for hex nut to adjust second tier.



Pull tier to the outside of the IQ-1000 or IQ-2000.



Fold stand into closed position and push 2nd tiers in. Tighten 2nd tier z-knobs.

Free Manuals Download Website

<http://myh66.com>

<http://usermanuals.us>

<http://www.somanuals.com>

<http://www.4manuals.cc>

<http://www.manual-lib.com>

<http://www.404manual.com>

<http://www.luxmanual.com>

<http://aubethermostatmanual.com>

Golf course search by state

<http://golfingnear.com>

Email search by domain

<http://emailbydomain.com>

Auto manuals search

<http://auto.somanuals.com>

TV manuals search

<http://tv.somanuals.com>