

Operating Manual for 2 in 1 Cable TV Remote Control

UR-J550TVE



Instructions

This remote control is preprogrammed to operate CABLE Box. Please program it for your TV by following the instructions shown below.

Batteries

The remote control uses AAA batteries. Please be sure to match the batteries with the (+) and (-) markings inside the battery compartment during installation.

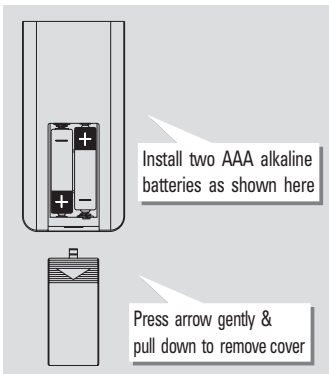

Programming your remote control

Setup for your cable box
No setup is required. The remote control is preprogrammed to operate your cable box.

Setup for your TV
Find your TV brand and its three-digit code on the back of this manual. If the TV brand is not listed, please use the Searching Method in **STEP3**.

STEP1 Turn on your TV manually.

***Tip:** If you have RCA TV, don't turn on the TV.

STEP2 Press [TV POWER] and [MUTE] buttons simultaneously until the red light is on.

STEP3 Point the remote control toward the TV and enter the three-digit code from the code table. If there is more than one code number assigned to your TV brand, try one code number at a time until the TV turns off right after you entered the number.

Searching Method

Press [CH +] button and hold until the TV turns off. As soon as the TV turns off, release [CH+] button.

***Tip:** You can confirm the power off and on by pressing [MUTE] button.

STEP4 Press [TV POWER] button to store the three-digit code.

***Tip:** Red light will blink twice.

Three-digit code :

Set-up for your VOLUME control

The remote control is preprogrammed to control VOLUME and MUTE functions through your TV. To switch VOLUME and MUTE functions to your Cable Box:

STEP1 Press [●/○] and [MUTE] buttons simultaneously until red light is on.

STEP2 Press [VOLUME +] button.

STEP3 Press [●/○] button.

To return to the TV's VOLUME, press [TV POWER] button.

***Tip:** Red light will blink twice.

Set-up for advanced functions

A. To turn on your TV and Cable at the same time with [●/○] button:

STEP1 Press [●/○] and [0] buttons simultaneously until the red light is on.

STEP2 Press [CH +] button.

***Tip:** Red light will blink twice

The [●/○] button sends out the TV and CABLE power commands if you press the [●/○] button.

To return to the original function, press the [CH-] button in the **STEP2**.

B. Recalling the TV Three-digit code :

STEP1 Press [TV POWER] and [MUTE] buttons simultaneously until the red light is on.

STEP2 Press [VOLUME -] button.

The red light will blink a number of times indicating the number of each digit of the code. Each digit is separated by one second interval of red light being off.

***Tip:** One blink, three blinks and 10 blinks, indicates the code number 130.

Helpful hints

Set-up for your Cable Box

The remote control is preprogrammed to control your cable box. If it does not work properly, please set-up the right code by using the three-digit code or searching method.

If you have a TV with a remote control, we recommend that you plug its power cord directly into a wall outlet if available (your cable installer may select an alternate setup)

Operation

If red light does not blink when you press keys the operation is intermittent:

Make sure the batteries are inserted correctly.

Replace old batteries with two new AAA batteries. Please do not mix old batteries with new ones.

Universal Remote Control, Inc.

www.universalsremote.com

OEE-0017D Rev 03(05/14/02)

Three-digit Code Table

CABLE

Remote	Converter	Converter Model	Code No
UR-J550TVE	Motorola	DPBB, DPV/DP/DQN,DL4,DQNV	002

TV

BRAND NAME	CODE NUMBER (3 DIGIT) LIST
A MARK	112 143
ADMIRAL	072 081 160 161
AIWA	234
AKAI	070 146 004
AMPRO	073 167 241
ANAM	043 054 055 056 080 112 131 232
AOC	058 070 004 112 222
AUDIOVOX	076 103
CANDLE	070 002 003 004
CANON	232
CAPEHART	058
CETRONIC	043
CITIZEN	070 002 003 004 101 103 143
CLASSIC	043
CONCERTO	004
CONTEC	043 051 207 230
CORONADO	143
CRAIG	043 054 028 235
CROWN	043 143
CURTIS MATHES	070 004 101 143 232
CXC	043
DAEWOO	076 103 055 004 127 143 016 043 044 125 120 214 215 229 231 243
DAYTRON	004 143
DWIN	161
DYNASTY	043
DYNATECH	062 209 234
ELECTROHOME	024 076 143
EMERSON	028 043 048 155 005 076 096 004 051 143 151 153 154 216 217 230 232 234 242 246
ENVISION	070
FISHER	007 057
FUNAI	028 043 234

TV

BRAND NAME	CODE NUMBER (3 DIGIT) LIST
FUTURETECH	043
GE	160 161 070 073 130 144 004 008 009 034 056 074 091 155 223 224 232 241
GOLDSTAR	004 106 119 110 112 113 127 143 242 244
GO VIDEO	235
HALL MARK	004
HARMAN KARDON	211
HITACHI	163 004 007 009 011 072 010 012 023 075 143 158 208 234
INFINITY	164
INKEL	129
INSTANTREPLAY	232
JBL	164 209
JCL	232
JCP	070
JCPENNY	004 008 024 030 065 101 143 160 156 235 242
JENSEN	013
JVC	038 001 034 083 232 238
KENWOOD	001 070 234
KLOSS	002 059
KMC	219
KTV	070 043 143 154
LG	004 106 119 110 112 113 127 143 242 244
LLOYD	234
LODGENET	072
LOGIK	072
LUXMAN	004
LXI	007 015 052 081 160 164 234
MAGNAVOX	070 003 004 022 059 060 061 063 064 127 164 094 160 056 232 234 239
MAGIN	235

TV

BRAND NAME	CODE NUMBER (3 DIGIT) LIST
MARANTZ	164 070 232
MARTA	242
MATSUI	164
MEMOREX	004 007 072 232 234 241 242
MEI	232
METZ	088
MGA	024 070 004 042
MINERVA	088
MITSUBISHI	109 024 042 004 040 146 028 124 226 247
MTC	070 004 062 101 209 229 234 235
MULTITECH	234
NAD	015 025
NEC	070 130 134 040 056 007 019 024 004 213
NIKEI	043
ONKING	043
ONWA	043
OPTONICA	019 081
ORION	096 201 202 203 204 205
PANASONIC	034 056 080 164 206 232 240
PENNEY	065 160 004 008 070 143 030 221
PENTAX	232
PHILCO	070 003 004 024 056 059 060 063 064 127 143 164 232 234
PHILIPS	164 005 038 093 127 070 003 004 059 232 234 242
PILOT	242
PIONEER	025 023 135 176 004 018 070
PORTLAND	004 143
PROSCAN	144 160 161 167
PROTON	004 058 143 171 173 193 131
QUASAR	034 056 232 240
RADIO SHACK	004 019 127 143 043 244
RCA	160 161 144 156 065 070 004 023 024 056 074 152 221 232 234 235
REALISTIC	007 019 232 234 235 242
RICO	237
RUNCO	072 169 073 130 179 180 181
SAMPO	070 004 058 218 220
SAMSUNG	004 101 127 133 143 160 089 105 070 233 235

TV

BRAND NAME	CODE NUMBER (3 DIGIT) LIST
SANYO	007 053 057 082 020 212
SCOTT	004 005 028 043 048 143
SEARS	004 007 015 028 030 057 082 094 143 160 242
SELECO	189
SHARP	081 014 019 028 004 022 081 143 175 029 232 245
SIGNATURE	072 234
SONY	001 085 126 139 232 236 237
SOUNDESIGN	003 004 028 043 234
SPECTRICON	112
SSS	004 043
SUPRE MACY	002
SYLVANIA	070 003 059 060 063 064 127 160 164 044 056 210 232 234
SYMPHONICS	052 234
TANDY	081 234
TATUNG	056 062 209
TEAC	234
TECHNICS	034 080 232 240
TECHWOOD	004
TEKNIKA	002 003 004 024 028 043 072 101 143 103 227 232 234 242
TELERENT	072
TERA	172
TMK	004
TOSHIBA	015 030 007 040 062 101
TOTEVISION	143 235 242
UNIVERSAL	008 009
UNITECH	235
VIDEO CONCEPTS	146 234
VIDEOSONIC	235
VIDIKRON	174 188
VIDTECH	004
WESTING HOUSE	076
WARDS	004 064 164 008 009 019 028 060 061 063 072 074 143 070 224 225 232 234 235
YAMAHA	004 070 234
YORK	004
YUPITERU	043
ZENITH	073 072 095 103 234 237 241 242
ZONDA	112

Free Manuals Download Website

<http://myh66.com>

<http://usermanuals.us>

<http://www.somanuals.com>

<http://www.4manuals.cc>

<http://www.manual-lib.com>

<http://www.404manual.com>

<http://www.luxmanual.com>

<http://aubethermostatmanual.com>

Golf course search by state

<http://golfingnear.com>

Email search by domain

<http://emailbydomain.com>

Auto manuals search

<http://auto.somanuals.com>

TV manuals search

<http://tv.somanuals.com>