

## V-1054 ONE-WAY AMPLIFIED CORNER SPEAKER

### INTRODUCTION

The interior corner speaker, the V-1054, is a 8" Speaker/Amplifier Assembly capable of reproducing paging as well as back ground music. The speaker has an externally accessible volume control that is screwdriver adjustable. The enclosures are made of steel with a durable powder coated finish. The color of the enclosures can easily be changed to match any decor. A cloth covered detachable grille is included. The speaker requires -24VDC, 50mA (1 Valcom power unit).

### Dimensions/Weight

- 10.00"H x 12.00"W x 4.50"D  
(25.4cm H x 30.48cm W x 11.43cm D)
- 3.0 lbs (1.36 kg)

### INSTALLATION

#### Typical Connections

**NOTE: Do not connect this speaker directly to a 25/70/100 Volt amplifier as damage to both the amplifier and speaker may occur. A V-1095 may be used to allow the use of Valcom self-amplified speakers on 70 Volt speaker lines.**

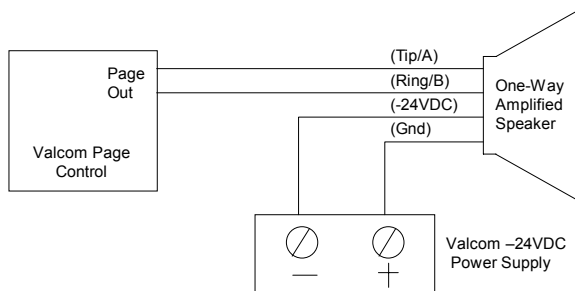

### Mounting

Remove cloth covered grille from baffle. Place speaker in the desired mounting location. Mark "keyhole" slot for mounting (see figure 1). After making the required connections, secure baffle to wall with a suitable mounting screw (#10 sheet metal screw or similar). Attach cloth covered grille to baffle.

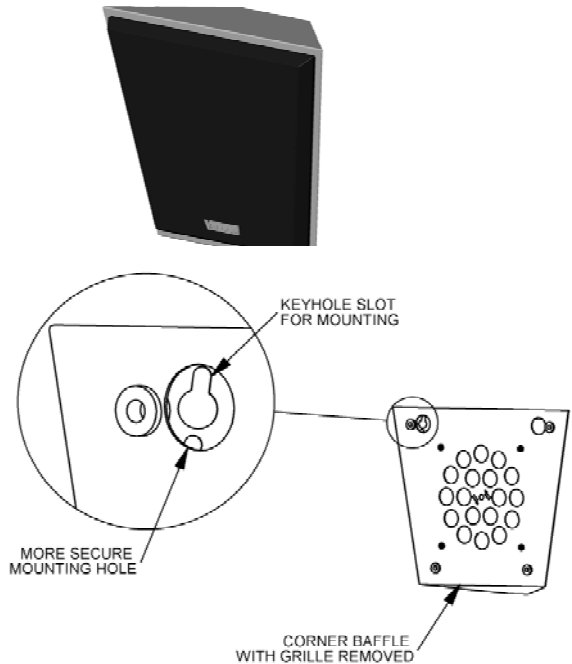

FIGURE 1

### COVERAGE

The area covered by a wall speaker is typically 600 square feet.

#### Number of Speakers per Audio Run

Wire Run (Feet)	22 AWG	24 AWG
400	100	60
800	50	30
1600	25	15

#### Number of Speakers per Power Run

1 Watt Interior Speakers	22 AWG	24 AWG
30	200 feet	125 feet
15	400 feet	250 feet
7	800 feet	500 feet

## TECHNICAL ASSISTANCE

When trouble is reported, verify there are no broken connections. Assistance in troubleshooting is available from the factory. Call (540) 563-2000 and press 1 for Technical Support or visit our website at <http://www.valcom.com>.

Valcom equipment is not field repairable. Valcom, Inc. maintains service facilities in Roanoke, VA. Should repairs be necessary, attach a tag to the unit clearly stating company name, address, phone number, contact person, and nature of the problem. Send the unit to:

**Valcom, Inc.**  
**Repair & Return Dept.**  
**5614 Hollins Road**  
**Roanoke, VA 24019-5056**

TROUBLESHOOTING CHART	
SYMPTOM	ACTION
1. No audio from speaker.	1a. Check that volume control is turned up (clockwise). 1b. Using a lineman's test set check for the proper audio level on the Tip and Ring leads and if necessary also at the source.
2. Low volume from speaker.	2a. Check that volume control is turned up. 2b. Check voltage at the speaker assembly when in use, -18 to -24VDC required. 2c. Using a lineman's test set, check for the proper audio level on Tip and Ring leads. It is possible that some low-level audio will be heard with only one side of Tip and Ring connected.
3. Loud squeal (feedback).	3a. Turn down (counter-clockwise) volume of the speaker. 3b. Increase the distance between the telephone and speaker. 3c. Install a noise canceling handset on the telephone in severe problem areas. 3d. Add a V-9964 Stacking Feedback Eliminator.

### VALCOM LIMITED WARRANTY

Valcom, Inc. warrants its products to be free from defects in materials and workmanship under conditions of normal use and service for a period of one year from the date of shipment. The obligation under this warranty shall be limited to the replacement, repair or refund of any such defective device within the warranty period, provided that:

1. inspection by Valcom, Inc. indicates the validity of the claim;
2. the defect is not the result of damage, misuse or negligence after the original shipment;
3. the product has not been altered in any way or repaired by others and that factory sealed units are unopened (a service charge plus parts and labor will be applied to units defaced or physically damaged);
4. freight charges for the return of products to Valcom are prepaid;
5. all units 'out of warranty' are subject to a service charge. The service charge will cover minor repairs (major repairs will be subject to additional charges for parts and labor).

**This warranty is in lieu of and excludes all other warranties, expressed or implied and in no event shall Valcom, Inc. be liable for any anticipated profits, consequential damages, loss of time or other losses incurred by the buyer in connection with the purchase, operation or use of the product.**

This warranty specifically excludes damage incurred in shipment. In the event a product is received in damaged condition, the carrier should be notified immediately. Claims for such damage should be filed with the carrier involved in accordance with the F.O.B. point.

Headquarters:  
 Valcom, Inc.  
 5614 Hollins Road  
 Roanoke, VA 24019-5056  
 Phone: (540) 563-2000  
 FAX: (540) 362-9800

## Free Manuals Download Website

<http://myh66.com>

<http://usermanuals.us>

<http://www.somanuals.com>

<http://www.4manuals.cc>

<http://www.manual-lib.com>

<http://www.404manual.com>

<http://www.luxmanual.com>

<http://aubethermostatmanual.com>

Golf course search by state

<http://golfingnear.com>

Email search by domain

<http://emailbydomain.com>

Auto manuals search

<http://auto.somanuals.com>

TV manuals search

<http://tv.somanuals.com>