

## SAFETY PRECAUTIONS



The lightning flash with an arrowhead symbol, within the equilateral triangle, is intended to alert the user to the presence of uninsulated "dangerous voltage" within the product's enclosure that may be of sufficient magnitude to cause an electric shock.

The exclamation point within the equilateral triangle is intended to alert the user to the presence of important operating and maintenance (servicing) instructions in this owner's manual.

\* SEE REAR OF UNIT FOR GRAPHIC SYMBOLS \*



**On Placement**

- Do not use the unit in places that are extremely hot, cold, dusty, or humid.
- Do not restrict the air flow of the unit by placing it in a place with poor air flow, by covering it with a cloth, or by placing it on carpeting.

**FCC Information**

WARNING: Changes or modifications to this unit not expressly approved by the party responsible for compliance could void the user authority to operate the equipment.

NOTE: This equipment has been tested and found to comply with the limits for a Class B digital device, pursuant to Part 15 of the FCC Rules. These limits are designed to provide reasonable protection against harmful interference in a residential installation. This equipment, used in accordance with the instructions, may cause harmful interference to radio communications.

However, there is no guarantee that interference will not occur in a particular installation. If this equipment does cause harmful interference to radio or television reception, which can be determined by turning the equipment off and on, the user is encouraged to try to correct the interference by one or more of the following measures:

- Reorient or relocate the receiving antenna.
- Increase the separation between the equipment and receiver.
- Connect the equipment into an outlet on a circuit different from that to which the receiver is connected.
- Consult the dealer or an experienced radio/TV technician for help.

Shielded cables must be used with this unit to ensure compliance with the Class FCC limits.

**On Safety**

- When connecting or disconnecting the AC cord, grip the plug and not the cord itself. Pulling the cord may damage it and create a hazard.
- When you are not going to use the unit for a long time, disconnect the power adapter.

**On Condensation**

- When left in a heated room where it is warm and damp, water droplets or condensation may form inside the unit. When there is condensation inside the unit, the unit may not function normally. Let the unit stand for 1 to 2 hours before turning the power on, or gradually heat the room and let the unit dry before use.

**Rating Plate Location**

- The rating plate location is on the rear of the unit.

## ACCESSORIES

**Please check and identify the supplied accessories.**

- To order accessories please visit <http://www.1800customersupport.com>
- Remote Control (with battery) ..... x 1
- Car Power Adapter ..... x 1
- Mounting Strap ..... x 1

## IMPORTANT SAFETY INSTRUCTIONS

- Read these instructions.
- Keep these instructions.
- Heed all warnings.
- Follow all instructions.
- Do not use this apparatus near water.
- Clean only with a dry cloth.
- Do not block any of the ventilation openings. Install in accordance with the manufacturer's instructions.
- Do not install near any heat sources such as radiators, heat registers, stoves, or other apparatus (including amplifiers) that produce heat.
- Do not defeat the safety purpose of the polarized or grounding - type plug. A polarized plug has two blades with one wider than the other. A grounding type plug has two blades and a third grounding prong. The wide blade or the third prong is provided for your safety. If the provided plug does not fit into your AC power outlet, consult an electrician for replacement of the obsolete outlet.
- Protect the AC power cord from being walked on or pinched particularly at plugs, convenience receptacles, and the point where they exit from the apparatus.
- Only use attachments/accessories specified by the manufacturer.
- Use only with a cart, stand, tripod, bracket, or table specified by the manufacturer, or sold with the apparatus. When a cart is used, use caution when moving the cart/apparatus combination to avoid injury from tip-over.
- Unplug this apparatus during lightning storms or when unused for long periods of time.
- Refer all servicing to qualified service personnel. Servicing is required when the apparatus has been damaged in any way, such as the power-supply cord or plug is damaged, liquid has spilled or objects have fallen into the apparatus, the apparatus has been exposed to rain or moisture, does not operate normally, or has been dropped.

## DISC FORMATS

The unit can playback discs bearing any of the following marks:

DVD [8cm(3")/12cm(5") disc]	Audio CDs [8cm(3")/12cm(5") disc]	CD-R CD-RW Compatible
--------------------------------	--------------------------------------	--------------------------

**Region Management Information**

This unit is designed and manufactured to respond to the Region Management Information that is encoded on DVDs. If the region number printed on the DVD does not correspond to the region number of this unit, this unit cannot play that disc.

The region number of this unit is 1.

**Disc Function or Operation that is Not Available**

When the symbol appears on the TV screen, it indicates that the function or operation attempted is not available at that time. This occurs because the DVD manufacturer determines the specific functions. Certain functions may not be available on some discs. Be sure to read the documentation provided with the disc.

**Title, Chapter and Tracks**

- DVDs are divided into "titles" and "chapters". If the disc has more than one movie on it, each movie would be a separate "title". "Chapters" are sections of titles.
- Audio CDs are divided into "tracks". A "track" is usually one song on an Audio CD.

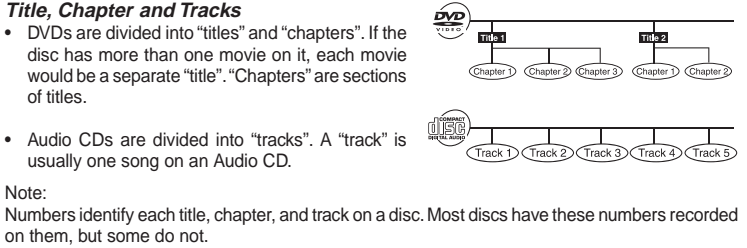

## REMOTE CONTROL

**Using the Remote Control**

- Point the remote control at the REMOTE SENSOR located on the unit.
- When there is a strong ambient light source, the performance of the infrared REMOTE SENSOR may be degraded, causing unreliable operation.
- The recommended effective distance for remote operation is about 16 feet (5 meters).

**To Change Remote Battery**

- Open the battery door.
- Insert one CR2025 (3V) size battery.

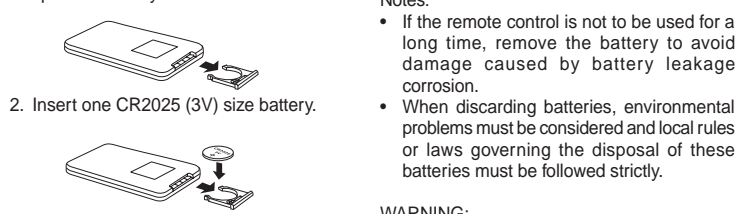

**CAUTION:** Danger of explosion if battery is incorrectly replaced. Replace only with the same or equivalent type.

**WARNING:**

- Do not dispose of battery in fire, battery may explode or leak.
- The battery shall not be exposed to excessive heat such as sunshine, fire or the like.

**Need More Help?**  
DO NOT RETURN THIS PRODUCT TO THE STORE.  
Please visit online help at <http://www.1800customersupport.com>

## CONTROL REFERENCE GUIDE

- OPEN Button  
Press the OPEN button and hold the front panel to open the disc door.
  - SEARCH  
Performs fast reverse playback.
  - SEARCH Button  
Performs fast forward playback.
  - PREV Button  
Goes backwards to previous chapters/tracks.
  - NEXT Button  
Advances chapters/tracks.
  - CHARGING Indicator  
\* (CHARGE) / STANDBY(power off) / ON Switch
  - POWER ON Indicator  
When the STANDBY / ON switch is in the ON position, the green light will illuminate.
  - PLAY Button  
Starts or resumes playback of a disc.
  - PAUSE Button  
Pauses playback and frame advance.
  - STOP Button  
Stops playing a disc.
  - Headphone Jack
  - VOLUME Control  
Adjusts the volume.
  - AUDIO / VIDEO OUT Jacks
  - DC IN 9V-12V Jack
  - Remote Sensor  
Receives the remote control signal.
  - LCD Screen
- \* If you have purchased a RECHARGEABLE BATTERY for this unit, slide to and a red CHARGING Indicator will be lit while your are charging up the battery. To order this battery or to get more information about this, visit [www.1800customersupport.com](http://www.1800customersupport.com).

- Remote Control**
- TV MODE button  
Adjusts Brightness, Contrast, Color or View Mode of the LCD screen.
  - PREV button  
Moves back through titles, chapters or tracks on a disc.
  - SEARCH buttons  
SEARCH: Fast reverse playback.  
SEARCH: Fast forward playback.
  - GOTO button  
Skips directly to a location on a DVD.
  - Cursor (V, A, L, R) buttons  
Use to move between selections on a menu screen and adjust certain settings. ENTER button  
Confirms selections on a menu screen.
  - MEMORY button  
In STOP mode, sets titles/chapters in a favourite order.
  - Number (0 - 9) buttons  
Use when creating programs, entering parental control password or locating a title/chapter/track or specific time.
  - REPEAT A-B button  
Performs point-to-point repeat playback on a DVD or CD.
  - REPEAT DISC button  
Repeats a DVD chapter or title.
  - SETUP button  
When a DVD is stopped, brings up the unit's SETUP menu.
  - SUBTITLE button  
Selects one of the subtitle languages programmed on a DVD (if available).
  - RETURN button  
Returns to normal operation after using the SETUP menu of a DVD.

- AUDIO button  
Selects one of the audio sound tracks on a DVD (if more than one is available) or select the audio output mode on a CD.
- ANGLE button  
Switches between multiple camera angles when the DVD you are playing has been programmed with multiple camera angles.
- DISPLAY button  
Shows status information on the screen.
- STOP button  
Stops playing a disc.  
PLAY button  
Starts or resumes playback of a disc.
- PAUSE button  
Pause playback and frame advance.
- NEXT button  
Moves forward through titles, chapters or tracks on a disc.
- MENU button  
Enters and exits the main DVD menu.

## MAINTENANCE

**Cleaning a Disc**

A defective or soiled disc inserted into the unit can cause sound to drop out during playback. Handle the disc by holding its inner and outer edges.

- Do NOT touch the surface of the unlabeled side of the disc.
- Do NOT stick paper or tape on the surface.
- Do NOT expose the disc to direct sunlight or excessive heat.
- Clean the disc before playback. Wipe the disc from the center outward with a cleaning cloth.
- NEVER use solvents such as benzine or alcohol to clean the disc.

**Cleaning the Unit**

- Be sure to turn the unit off and disconnect the car power adapter before maintaining the unit.
- Wipe the unit with a dry soft cloth. If the surfaces are extremely dirty, wipe clean with a cloth that has been dipped in a weak soap-and-water solution and wrung out thoroughly. Then wipe with a dry cloth.
- Never use alcohol, benzine, thinner, cleaning fluid or other chemicals. Do NOT use compressed air to remove dust.

**Important Note**

- Before transporting the unit, remove any disc from the disc compartment.

## UNIT OPERATION

- Turning on the Unit**
- Slide the (CHARGE) / STANDBY / ON switch on the unit to the ON position.
  - The DVD logo (start-up picture) will appear on the screen.
  - After use, slide the (CHARGE) / STANDBY / ON switch on the unit to STANDBY (power off) position.



## POWER SUPPLY

**Using the Car Power Adapter**

The included 12V car power adapter is designed for use with vehicles that have a 12V, negative ground electrical system.

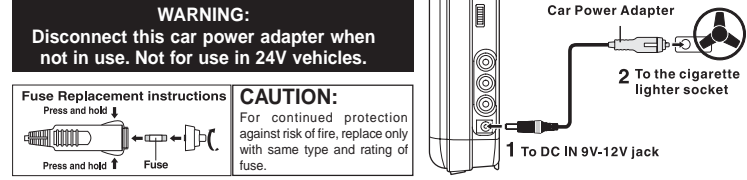

**WARNING:** Disconnect this car power adapter when not in use. Not for use in 24V vehicles.

**Fuse Replacement instructions:** Press and hold Fuse

**CAUTION:** For continued protection against risk of fire, replace only with same type and rating of fuse.

**Cautions:**

- Use this unit only with the included 12V car power adapter. Use with other car adapters could damage the unit, or even your vehicle.
- The included 12V car power adapter is for use with this unit only. Do not use it with any other equipment.

- In the interest of traffic safety, drivers should not operate the unit or view videos while driving.
- When the inside of the 12V car socket is dirty with ashes or dust, the plug section may become hot due to poor contact. Be sure to clean the 12V car socket before use.
- After use, disconnect the 12V car power adapter from both the unit and cigarette lighter socket.
- If the unit is not properly attached to a vehicle, it may become airborne in the event of an accident and cause damage, injury, or death.
- Check your local traffic laws for rules governing the use of video devices in vehicles.

## CONNECTIONS

**A. Connecting a TV**

If your TV has Audio/Video inputs, you can connect the unit to your TV using a standard A/V cable (not included).

**Watching a DVD on your TV**

- Turn on the unit.
- Turn on the TV and follow the instructions included with it to play the DVD.

**Notes:**

- Make sure to use the correct Audio/Video cable. Connecting the plugs incorrectly may cause a weak signal.
- If your TV does not have Audio/Video inputs, you will need to purchase an RF modulator (sold separately) and follow the instructions included with it to connect the unit to your TV.

**B. Using Headphones (not included)**

Turn down the volume before connecting the headphones/earphones. Slowly raise the volume with the headphones on until you reach your desired volume. When headphones are connected, the speaker is automatically disabled.

**Caution:** Avoid listening to sound at excessive levels which could be harmful to your ears.

## PLACEMENT

**A. Mounting in the Vehicle**

Use the supplied mounting strap to install the unit on the back of the vehicle's headrests. Tightly wrap the mounting strap around the headrest.

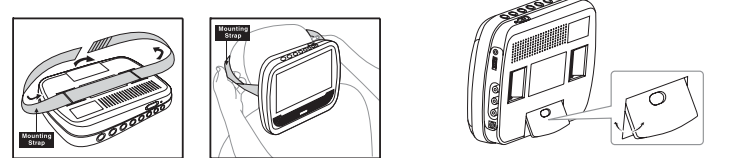

**B. Using the Stand**

You can stand the unit up on a desk or table using the stand on the back.

## SOUND SYSTEM

**Dolby Digital**

Dolby Digital is a technology developed by Dolby Laboratories. Soundtracks encoded in Dolby Digital can reproduce from one to 5.1 discrete channels of excellent quality audio. The unit automatically recognizes the Dolby Digital bitstream and provides a downmix suitable for two-channel listening. An additional Dolby Digital decoder is required for reproduction of the discrete multi-channel soundtracks available on many DVDs. Manufactured under license from Dolby Laboratories.

'Dolby' and the double-D symbol are trademarks of Dolby Laboratories.

## PLAYING A DISC

This owner's manual explains the basic instructions for operating this unit. Some DVDs are produced in a manner that allows specific or limited operation during playback. Therefore, this unit may not respond to all operating commands. **THIS IS NOT A DEFECT.** Please refer to the instructions accompanying the specific DVD in question for more information about the options available on that DVD. " " may appear on the screen during operation. A " " means that the desired operation is not permitted by the unit or disc.

### Playing a Disc

- Slide the **CHARGE/STANDBY/ON** switch to the ON position. See CUSTOMIZING THE FUNCTION SETTINGS before proceeding to step 2.
- Press the **OPEN** button and hold the front panel to open the disc door.
- Hold the disc by its sides and gently push it onto the spindle with label side facing towards you until you hear a "click".
- Gently push the disc door closed. It takes a short while for your unit to load the disc. After loading, for most DVDs, the unit will automatically take you main menu or start playing. If the unit does not automatically start playing the DVD, press the **PLAY** button.

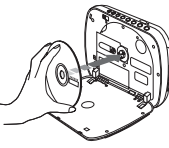

### Pausing Playback (Still Mode)

Press the **PAUSE** button. To resume normal playback, press the **PLAY** button. Each time you press the **PAUSE** button, the picture advances one frame.

### Stopping Playback

Press the **STOP** button at the location where you want to interrupt playback. To resume playback at the position where the disc was stopped, press the **PLAY** button. If you press the **STOP** button twice, the unit's memory will be cleared and pressing the **PLAY** button will reset the disc to the beginning.

### Fast Forward / Fast Reverse

- Press the **SEARCH** or **SEARCH** button when a disc is playing. Each time you press the **SEARCH** or **SEARCH** button, the playback speed changes in the following sequence:

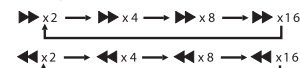

- Press the **PLAY** button when you reach the desired point to resume normal playback.
- Notes:
- The DVD player mutes sound and subtitles during reverse and forward scan of DVDs.
  - The fast playback speed may differ depending on the disc.

### Skip (Forward / Reverse)

- Press the **PREV** button to go back to current or previous chapters/tracks.
- Press the **NEXT** button to advance chapters/tracks.
- For audio CDs, use the number buttons on the remote control to jump immediately to the desired track number.

### Audio Selection

On some DVDs, the sound is recorded in two or more formats. Follow the directions below to select the preferred language and sound.

- While a disc is playing, press the **AUDIO** button to show the current audio format number.
- Press the **AUDIO** button repeatedly to select the desired audio format.

Notes:

- If only one audio format is recorded on the DVD, the number does not change.
- Some DVDs allow you to change audio selections only via the disc menu. If this is the case, press the **MENU** button and choose the appropriate language on the disc menu.
- You can select different audio channels (Stereo, Left or Right) on an Audio CD by pressing the **AUDIO** button repeatedly.

### Subtitle Selection

- While a DVD is playing, press the **SUBTITLE** button to display the current language setting, as shown in the example.

- Press the **SUBTITLE** button repeatedly to select the desired subtitle language. You can turn subtitles off by pressing the **SUBTITLE** button repeatedly until the "Off" is displayed.

Notes:

- Some DVDs are set to display subtitles automatically, and you cannot turn them off even if you set the subtitle function to off.
- During some scenes, the subtitles may not appear immediately after you select your desired scene.
- The number of subtitle languages recorded differs depending on the disc. If only one language is recorded, the language does not change.
- This function can only be used for discs on which subtitles have been recorded in multiple languages.
- Some DVDs allow you to change subtitles only via the disc menu. If this is the case, press the **MENU** button and choose the appropriate subtitle on the disc menu.

### Angle Selection

Some DVDs contain scenes which have been shot from a number of different angles. For these discs, the same scene can be viewed from each of these different angles.

- While you are playing a DVD with different angles recorded, press the **ANGLE** button to view the number of current angles available.
- Press the **ANGLE** button repeatedly to change the scene to the next recorded angle.

- After approximately two seconds, playback will continue from the new angle you selected.
- If no button is pressed within 10 seconds, playback continues without changing the current angle.

- This function can only be used for discs on which scenes shot from multiple angles have been recorded.
- If only one angle is recorded, "1/1" is

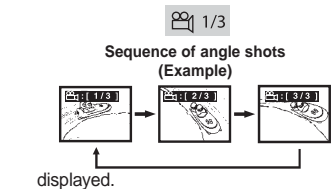

### Display Function

While the disc is playing, press the **DISPLAY** button repeatedly to display information on operation status.

### Elapsed Time:

Elapsed time from the beginning of the title which is currently playing.

### Remain Time:

Remaining time of the title which is currently playing.

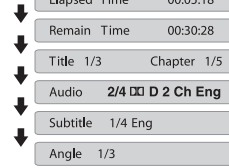

### Adjust the LCD Screen

You can adjust brightness, contrast, color or view mode of the LCD screen.

- Press the **TV MODE** button.
- Press the **▲ / ▼** button to select Brightness, Contrast, Color or View Mode.
- Then press the **◀ / ▶** button to change the setting. (For View Mode, press the **ENTER** button to change the setting.)
- Press the **TV MODE** button to exit the menu.

## LOCATING A DESIRED SECTION

### Locating a Specific Title

If a DVD contains title numbers, you can locate a specific title by directly selecting its title number.

- Press the **GOTO** button.
- Press the corresponding number button(s) for the title you want.
- Press the **ENTER** button to confirm. Playback starts from the selected section.



Notes:

- If the title numbers you entered is not permitted by the DVD, after you press the **ENTER** button, it will restore to -- -. You should re-enter correct numbers.
- Some discs may not respond to this process.
- This method of locating a title is available only on a DVD that contains title numbers.

### Locating a Specific Chapter

If you know the chapter number for the chapter that you want to play, you can locate it by directly selecting that number.

- Press the **GOTO** button.
- Press **▲** or **▼** button to display Chapter and press the corresponding number button(s) for the chapter you want.
- Press the **ENTER** button to confirm. Playback starts from the selected section.

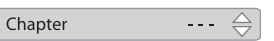

Notes:

- If the chapter numbers you entered is not

permitted by the DVD, after you press the **ENTER** button, it will restore to - - -. You should re-enter correct numbers.

- Some discs may not respond to this process.
- This method of locating a chapter is available only on a DVD that contains chapter numbers.

### Locating a Specific Time

You can move to a specific location by entering its corresponding time (hours, minutes, seconds).

- Press the **GOTO** button.
- Press **▲** or **▼** button to display Time and press the corresponding number buttons for the setting point you want.
- Press the **ENTER** button to confirm. Playback starts from the selected section.



Notes:

- If the time numbers you entered is not permitted by the DVD, after you press the **ENTER** button, it will restore to --:--:-- . You should re-enter correct numbers.
- Some discs may not respond to this process.
- Some scenes may not be located as precisely as you specified.
- This method for accessing specific locations is available only within the current title of the DVD.

## REPEAT PLAYBACK

You can play a specific title or chapter repeatedly. (Title repeat, chapter repeat, A-B repeat)

### Repeating a Chapter

- While the DVD is playing, press the **REPEAT DISC** button until the "Repeat Chapter" indicator displays on the screen. The current chapter is played repeatedly.

### Repeating a Title

- While the DVD is playing, press the **REPEAT DISC** button until the "Repeat Title" indicator displays on the screen. The current title is played repeatedly.

### To Resume Normal Playback

- While the DVD is playing, press the **REPEAT DISC** button until the "Repeat Off" indicator displays on the screen.

You can play a single track or the whole disc repeatedly.

### Repeating a Single Track

- While the CD disc is playing, press the **REPEAT DISC** button until the "Repeat single" indicator displays on the screen. The current track is played repeatedly.

### Repeating a Whole Disc

- While the CD disc is playing, press the **REPEAT DISC** button until the "Repeat all" indicator displays on the screen. The whole disc is played repeatedly.

## DVD PROGRAMMABLE MEMORY

### Playing Titles/Chapters in a Favourite Order

You can combine your favourite titles/chapters and play them in the order you determine.

- When a DVD is stopped, press the **MEMORY** button, the following display appears.
- Select the items in the order you want by pressing the number buttons. Each time you press the Cursor buttons (**▼**, **▲**, **◀**, **▶**), the space is highlighted. Highlight where you want to enter, then press the corresponding number buttons.
- Press the Cursor buttons (**▼**, **▲**, **◀**, **▶**) to move the highlighted bar to Play Memory, then press the **ENTER** button. The DVD player starts memory playback.
- To resume normal playback from memory playback
  - Press the **MEMORY** button in stop mode.
  - Press the Cursor buttons (**▼**, **▲**, **◀**, **▶**) to move the highlighted bar to "Clear All", then press the **ENTER** button. All the input programs will be cleared.
  - Press the **PLAY** button to resume normal playback.

Notes:

- If the title or chapter numbers you entered is not permitted by the DVD, after you press the **ENTER** button, it will restore to - - -. You should re-enter correct numbers.
- Some discs may not permit memory playback operation.
- If you select repeat during memory playback, the DVD player repeats the current memory playback.
- If you press the **MEMORY** button while the display appears on the TV screen, the display disappears.
- The programmed selections will be cleared when you open the disc tray or turn off the DVD player.

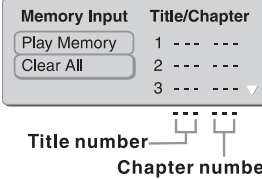

Title number Chapter number

## VIEWING JPG FILES

This unit can play JPG files recorded on a CD-R or CD-ROM disc (CD-RW is not recommendable).

### Viewing JPG Files

- Open the disc door.
- Hold a JPG file disc by its edge and gently push it onto the spindle with the label side facing up until you hear a "click".
- Close the disc door. A list of folders/files will appear on the screen.
- Press the **▲** or **▼** button to select your desired file, the selected picture will appear at the lower right corner. Press the **▶** **PLAY** button to start playback. Press the **█** button to display a folder list.

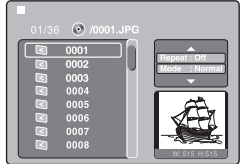

Notes:

- You can press the **PAUSE** button to interrupt playback. Press the **▶** **PLAY** button to resume playback.
- You can press the **STOP** button to quit playback.
- You can press the **PREV** or **NEXT** button to change the picture.
- You can press the **ANGLE** button to rotate direction of the picture by 90°.
- Some discs may not permit this operation.

## PLAY MODES FOR CD OR JPEG DISC

### Play Modes for CD or JPG Disc

When play CD / JPG discs, you can modify the Play Modes through the Toolkit which appears on the right of below picture on the screen. Press the **◀** **▶** button to navigate between the windows and the **▲** / **▼** button to select files/tracks or play mode items.

Then press the **ENTER** button.

- In Stop mode, press the Cursor buttons (**▼**, **▲**, **◀**, **▶**) to select "Edit mode" then press the **ENTER** button.
- Use the Cursor buttons (**▼**, **▲**, **◀**, **▶**) to select tracks/files shown on the left hand side of the window. Press the **ENTER** button to confirm the selected tracks/files. "✓" will appear in front of the selected tracks/files.
- Select "Add to program", then press the **ENTER** button. "✓" will disappear from the screen. It means that the tracks/files you have selected are added into the "Program view".
- Select "Program view" to view programmed files. To add more files by "Browser view" follow above steps.
- Press the **▶** **PLAY** button to start the program playback.

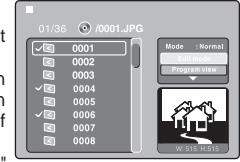

The Toolkit has the following play mode items:

- Repeat ( Off / Single / All ):**
  - Off:** Resumes normal playback.
  - Single:** Repeats the current track/file.
  - All:** Repeats all files on the current folder or all tracks on the disc.
- Mode ( Normal / Shuffle / Music intro ):**
  - Normal:** Resumes normal playback.
  - Shuffle:** Playbacks track/file in random order.
  - Music intro (for Audio CD only):** Only playbacks the first 10 seconds of all the tracks on the current folder/disc.
- Edit mode:** Program operation works only when "Edit mode" is selected.
- Program view:** To view tracks/files in the "Program view" list. It is disabled when the "Program view" list is empty.
- Add to program:** Add files/tracks to the "Program view" list. It is disabled if the "Edit mode" is not selected.
- Browser view:** To view files/tracks in the original view list.
- Clear program:** Delete the files/tracks in the "Program view" list. Select a file/track or more you want to delete in complete stop mode (press the **STOP** button twice). "✓" will appear beside the deleted file/track. Select "Clear program" and then press the **ENTER** button. It is disabled if the "Edit mode" is not selected.

Note: The program will be deleted if the **STOP** button is pressed twice, the disc door is opened, or selected files are deleted by selecting "Clear program".

## TROUBLESHOOTING GUIDE

### SYMPTOM CAUSE (AND REMEDY)

- |   |   |
|---|---|
| No power.                                     | <ul style="list-style-type: none"> <li>Ensure the car power adapter is connected.</li> <li>Make sure that the unit is turned on.</li> <li>Make sure that you select ON mode.</li> </ul>   |
| Very little or no sound is coming from a DVD. | <ul style="list-style-type: none"> <li>Make sure the unit is not paused. Press the <b>▶</b> <b>PLAY</b> button.</li> <li>Make sure the unit is not in fast-forward or fast-reverse mode. Press the <b>▶</b> <b>PLAY</b> button.</li> <li>Make sure the AUDIO/VIDEO input/output connections are correct.</li> <li>The DTS DVD cannot be decoded to have speaker output.</li> <li>The unit has overheated. Shut it off for 30 minutes to allow it to cool down.</li> </ul>         |
| No picture.                                   | <ul style="list-style-type: none"> <li>The region number of the disc doesn't match the region number of this unit.</li> </ul>   |
| The picture is not clear.                     | <ul style="list-style-type: none"> <li>The DVD is dirty. Gently clean the disc.</li> <li>The disc is scratched.</li> <li>Please adjust the LCD's brightness, contrast and color using the <b>TV MODE</b> button on the remote control.</li> </ul>   |
| Loud hum or noise is heard.                   | <ul style="list-style-type: none"> <li>The plugs and jacks are dirty. Wipe them with a cloth slightly moistened with alcohol.</li> <li>Clean the disc.</li> </ul>   |
| The disc does not play.                       | <ul style="list-style-type: none"> <li>There is no disc inside the unit ("No Disc" appears on the screen).</li> <li>Insert the disc correctly with the graphics facing up.</li> <li>Clean the disc.</li> <li>A non-NTSC disc has been inserted, or the disc region number does not match the region number of the unit.</li> <li>Condensation may have formed inside the unit due to a sudden change in temperature. Wait about an hour for it to clear and try again.</li> </ul> |

Specifications and external appearance are subject to change without notice.

## CUSTOMIZING THE FUNCTION SETTINGS

### Language

#### OSD Language

- Press the **SETUP** button in stop mode.
- Press the **▶** button to select OSD Language.
- Press the **ENTER** button, then the **▲** / **▼** button to shift and change the Language.
- Press the **ENTER** button.
- Press the **SETUP** or **RETURN** button to exit the menu.



#### Subtitle

- Press the **SETUP** button in stop mode.
- Press the **▶** button, then the **▲** / **▼** button to select Subtitle.
- Press the **ENTER** button, then the **▲** / **▼** button to shift and change the Language.
- Press the **ENTER** button.
- Press the **SETUP** or **RETURN** button to exit the menu.



Notes:

- Some DVDs may be set to display subtitles in a language other than the one you selected. A prior subtitle language may be programmed on the disc.
- Some DVDs allow you to change subtitle selections only via the disc menu. If this is the case, press the **MENU** button and choose the appropriate subtitle language from the selection on the disc menu.

#### Audio

- Press the **SETUP** button in stop mode.
- Press the **▶** button, then the **▲** / **▼** button to select Audio.
- Press the **ENTER** button, then the **▲** / **▼** button until your preferred Audio is displayed.
- Press the **ENTER** button.
- Press the **SETUP** or **RETURN** button to exit the menu.

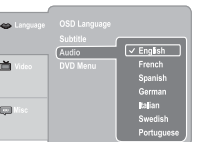

Note: Some DVDs may not play in the language you selected. A prior language may be programmed on the disc.

#### DVD Menu

- Press the **SETUP** button in stop mode.
- Press the **▶** button, then the **▲** / **▼** button to select DVD Menu.
- Press the **ENTER** button, then the **▲** / **▼** button until your preferred DVD Menu language is displayed.
- Press the **ENTER** button.
- Press the **SETUP** or **RETURN** button to exit the menu.

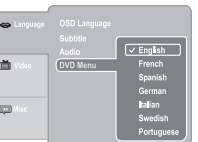

Note: Some DVDs may not include your pre-selected language. In this case, the DVD player automatically displays disc menus consistent with the disc's initial language setting.

#### Video

##### Aspect Ratio

- Press the **SETUP** button in stop mode.
- Press the **▲** / **▼** button to select Video.
- Press the **▶** button, then the **▲** / **▼** button to select Aspect Ratio.
- Press the **ENTER** button, then the **▲** / **▼** button to shift and change the aspect ratio.
- Press the **ENTER** button.
- Press the **SETUP** or **RETURN** button to exit the menu.



Notes:

- The displayable picture size is preset on the DVD. Therefore, the playback picture of some DVDs may not conform to the picture size you select.
- When you play DVDs recorded in the 4:3 picture size only, the playback picture always appears in the 4:3 picture size regardless of the Aspect Ratio setting.
- Select 16:9 to conform the LCD screen on the unit. Always be sure that your Aspect Ratio conforms to the actual TV in use if you connect the unit to a TV.

#### View Mode

- Press the **SETUP** button in stop mode.
- Press the **▲** / **▼** button to select Video.
- Press the **▶** button, then the **▲** / **▼** button to select View Mode.
- Press the **ENTER** button, then the **▲** / **▼** button to shift and change the View Mode.
- Press the **ENTER** button.
- Press the **SETUP** or **RETURN** button to exit the menu.

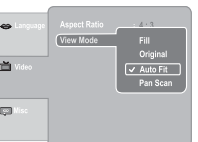

#### Fill

Fill the screen with decoded image.

#### Original

Display image as it's original size.

#### Auto Fit

Automatically fit the decoded image on screen without distortion. Black bars will be present on top/bottom or left/right of screen.

#### Pan Scan

Select when a standard 4:3 TV is connected. Displays pictures cropped to fill your TV screen. Sides of the picture are cut off.

Note: Depending on the DVDs, you may not be able to view the mode as selected.

#### Misc

##### Use Default Settings

- Press the **SETUP** button in stop mode.
- Press the **▲** / **▼** button to select Misc.
- Press the **▶** button, then press the **▲** / **▼** button to select "Use Default Settings" dialogue box.
- Press the **ENTER** button then press the **◀** / **▶** button to select "Yes". Press the **ENTER** button. The original setting will be restored. The unit will exit setting menu automatically and re-load the disc in the disc tray.

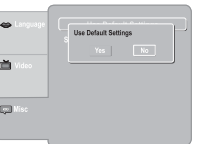

Note: It will take 3-5 seconds to reset the DVD player to the factory default.

##### Screen Saver

- Press the **SETUP** button in stop mode.
- Press the **▲** / **▼** button to select Misc.
- Press the **▶** button, then press the **▲** / **▼** button to select Screen Saver.
- Press the **ENTER** button, then press the **▲** / **▼** button to change the On/Off mode.
- Press the **ENTER** button.
- Press the **SETUP** or **RETURN** button to exit the menu.

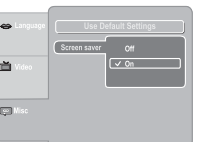

## Free Manuals Download Website

<http://myh66.com>

<http://usermanuals.us>

<http://www.somanuals.com>

<http://www.4manuals.cc>

<http://www.manual-lib.com>

<http://www.404manual.com>

<http://www.luxmanual.com>

<http://aubethermostatmanual.com>

Golf course search by state

<http://golfingnear.com>

Email search by domain

<http://emailbydomain.com>

Auto manuals search

<http://auto.somanuals.com>

TV manuals search

<http://tv.somanuals.com>