

Verizon FiOS TV P283v1 Big Button Remote Control Manual



Model: RC2834102/01B

For additional information about your **FiOS® TV** service and your remote, go to www.verizon.com/fiostvhelp

For video instructions, press the **<Menu>** key on your remote then select **help** on the Main Menu

Thank you for subscribing to FiOS® TV Service. This User Manual will show you how to program and operate your new **FiOS® TV Remote Control** (Model P283v1).

Quick Setup Guide -Verizon FiOS remote

The following steps will guide you to quickly set-up your Verizon **FiOS TV** remote for your TV.

1. Turn on your TV and the FiOS STB. Make sure you can see live television.



2. Locate the 3-digit code for your TV brand in the list to the right and circle the correct code.



If your TV brand is not listed, codes for additional TV brands are listed at the back of this manual.

3. Once you locate the brand code, press and hold the **<OK>**

and **0** keys together. The RED LED on the remote control will blink twice and then stay on.

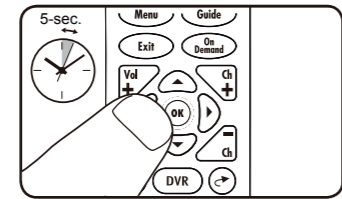

4. Enter the 3-digit TV code for your TV brand using the number pad. The RED LED will blink twice and then stay on.

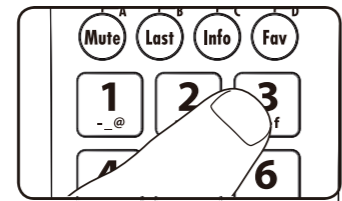

5. Press and release the **<CH +>** button repeatedly until the TV turns off. You can also “back up” by pressing the **<CH ->** button.

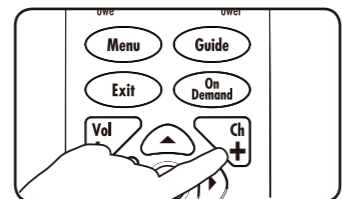

*Please note – some TVs may respond slower than others. Please allow 1 second between button presses.

6. Test that remote control is programmed for your TV
 - a. Turn the TV on using the **TV** key.

- b. Press **<VOL +>** and **<VOL ->** to make sure that the volume keys work.
- c. Press **Mute** and **<Input>** keys.
- d. If any of these keys do not work as expected, press and hold that key. Release it as soon as it works.

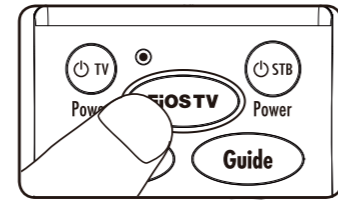

7. If all these keys work, press **<OK>** to save this TV brand code programming. The RED LED will blink 3 times and then turn off

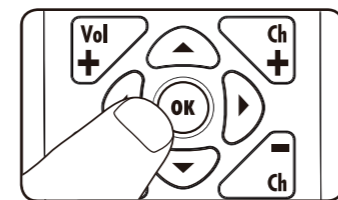

Your Remote Control is now programmed for your TV!

Acronyms

1. RC = Remote Control
2. STB = FiOS® TV Set Top Box
3. VOL = Volume
4. CH+ = Channel Up
5. CH- = Channel Down

FiOS® TV Remote Control Codes for Major TV Brands	TV Brand	Code
AOC	AOC	026
Audiovox	Audiovox	035
Coby	Coby	070
Envision	Envision	114
Funai	Funai	128
Haier	Haier	146
Hitachi	Hitachi	164
Insignia	Insignia	180
JVC	JVC	193
LG	LG	210
Magnavox	Magnavox	222
Mitsubishi	Mitsubishi	243
Panasonic	Panasonic	279
Philips	Philips	285
Pioneer	Pioneer	290
Polaroid	Polaroid	294
Proscan	Proscan	302
RCA	RCA	321
Samsung	Samsung	331
Sansui	Sansui	332
Sanyo	Sanyo	333
Sceptre	Sceptre	335
Sharp	Sharp	342
Sony	Sony	352
Sylvania	Sylvania	371
Toshiba	Toshiba	397
Viewsonic	Viewsonic	418
Vizio	Vizio	424
Westinghouse	Westinghouse	433
Zenith	Zenith	440

Press “**shift**” and dual designation key together to access secondary key functions

For Widgets press **MENU** and access via on-screen guide.

- 8) Troubleshooting
 - a. If the **TV** button does not work correctly, make sure the TV is on and go back to Step 1 of the **Quick Start Guide**. You can also try the **Code Search Method** below.
 - b. If the **<VOL>**, **<Mute>**, or **<Input>** buttons do not work correctly, please refer to the **Key Fix Feature**.
 - c. If you think you made a mistake with programming your remote, you can always press the **<Exit>** button and start over. The RED LED will turn off if the RC is not in programming mode.
 - d. If you don't press any buttons for 60 seconds, the remote control will automatically exit programming mode.
 - e. Note, if you press the **<CH>** button many times and the lights on the remote control all flash rapidly, the programming attempt was not successful.
 - f. If the Brand Search method does not work, please try the Code Search Method below, which scans the complete database for all TV codes.
 - g. If you are still having problems programming the remote, please refer to our website at www.verizon.com/fiostvhelp

Code Search Method to Program the RC (This method could take up to 15 minutes)

1. Turn on your TV and the FiOS STB.
2. Make sure you can see live television.
3. Press and hold the **<OK>** and **FiOS TV** buttons together, then release both.
 - The RED LED will blink twice and then stay on.
4. Press and hold down the **TV** button.
5. The Remote Control will try a new TV code every second, and the RED LED

- will blink each time a new code is sent.
6. When the TV turns off, stop pressing the play button right away.
 - Please note – some TVs may respond slower than others.
7. You can press the **<CH +>** or **<CH ->** buttons to go forward or back one TV code at a time.
8. Test that the remote control is programmed for your TV.
 - a. Turn the TV on using the **TV** key.
 - b. Press **<VOL +>** and **<VOL ->** to make sure that the volume keys work.
 - c. Press **Mute** and **<Input>**.
 - d. If any of these keys do not work as expected, press and hold that key. Release it as soon as it works.
 - e. If these keys all work, press **<OK>** to save this TV brand code programming. The RED LED will blink 3 times and then turn off.

Your Remote Control is now programmed for your TV!

10. Troubleshooting
 - a. If the **TV** button does not work correctly, make sure the TV is on and go back to Step 1 of the **Code Search Method**.
 - b. If the **<VOL>**, **<Mute>**, or **<input >** buttons do not work correctly, please refer to the **Key Fix Feature**.
 - c. If you think you made a mistake with programming your remote, you can always press the **<Exit>** button and start over. The RED LED will turn off if the RC is not in programming mode.
 - d. **Please Note, the Code Search Method could take up to 15 minutes**, as it must go through over 500 codes. The most common codes are tried first, but you may need to press and hold **TV** for a while to locate the correct code.

- e. Once you have tried all the TV codes in the remote control, the RED LED and the backlit buttons will flash 4 times rapidly, the RED LED will turn off and the remote will exit the programming mode.
- f. If you are still having problems programming the remote, please refer to our website at www.verizon.com/fiostvhelp

OPTIONAL FEATURES <STB Power> Button Turns on TV and STB

Your remote has separate power buttons for the TV and STB. You can program the **STB** key to turn on/off both your TV and STB at the same time.

1. Turn both your **TV** and **STB** on.
2. Press and hold the **<OK>** and **STB** buttons together, then release both.
 - The RED LED will blink twice and then stay on.
3. Press **9 – 7 – 7**.
4. Press **STB**.
5. Test that the **STB** key now turns on the TV and STB at the same time.
6. If you want to reset the remote so that the **STB** key controls **Only** the **STB**, follow the same steps as above but press **<OK>** in Step 4.

Control TV Volume Through STB

If the volume control keys don't work with your TV, you can program the remote so that the STB will control the volume.

1. Press and hold the **<OK>** and **STB** buttons together, then release both.
2. The RED LED will blink twice and then stay on.
3. Press **9 - 5 – 5**.

4. The RED LED light will blink twice, and remain on.
5. Press **STB**.
6. The RED LED will blink 3 times and then turn off.
7. If you want to change it back again so that volume buttons control the TV follow the same steps as above but press **TV** in Step 5.

Key Fix

If your remote control is programmed for your TV, but the **<VOL>**, **<Mute>**, or the **<Input >** keys do not work correctly, then you can try using the Key Fix feature to fix the buttons.

1. Press and hold the **<OK>** and **STB** buttons simultaneously.
 - The RED LED will blink twice and then stay on.
2. Press and hold the key that does not work correctly. The remote control will try a new code every second.
3. Once the TV responds correctly, release the button.
4. Press **<OK>** to save the current settings and finish programming your remote control.

Reset the Remote Control Original Settings

1. Press and hold the **<OK>** and **STB** buttons together, and release.
2. The RED LED will blink twice and then stay on.
3. Press **9 - 0 – 0**.
4. The RED LED will blink 3 times and then turn off to indicate original settings are restored.
5. CAUTION, all previous programming in the remote control will be lost if you follow this procedure.

General Instructions

1. Make sure the remote control has a clear, unobstructed view of the STB and TV.

2. Your FiOS® TV remote control will only operate your FiOS® TV STB and your TV.
3. The remote will not operate other devices like DVD Player or Audio Receiver.
4. The **<TV Power>**, **<VOL +>**, **<VOL ->**, **<Mute>** and **<Input>** buttons will always control your TV.
5. All other keys on the remote control will always control your FiOS® TV STB.

Getting Started

1. Turn on your TV and the STB using the **TV** and **STB** buttons.
2. If you have just watched a DVD, make sure your TV is set to the correct A/V Input for your STB.
3. Press the **<CH +>**, or **<CH ->** buttons to see the next higher or lower channel.
4. You can go directly to any channel by entering the channel number on the number pad and pressing **<OK>**.
5. Press **Guide** to see a list of TV programs.
6. Press **Exit** to return to TV watching.
7. Press the **Menu** button to launch the FiOS® TV Main Menu. From the Main Menu you can access all the features of your FiOS® TV service.
8. Press **<▲>** **<▼>** **<▶>** **<◀>** keys to navigate through the FiOS® TV Menus and Guides. To select any item, press **<OK>**.
9. Press **Last** to return to the last channel.
10. Press **<Info>** to see information about the current program.
11. Press **<Exit>** to return to the previous menu option or to watch TV.

New and Special Buttons

1. **On Demand** displays a list of movies and other programs you can watch at any time.
2. **Fav** displays your list of favorite channels.

3. **DVR** displays your list of recorded programs if you have DVR service.
4. **30** jumps back 30 seconds in the program you are watching.
5. **30** jumps forward 30 seconds in the program you are watching.
6. **REC** records the current program.
7. Buttons **30**, **30**, and **REC** will only operate during normal TV watching if you have DVR service.
8. “If the RED LED starts blinking 5 times rapidly when you press the **<CH +/->**, **<VOL +/->**, and **<OK>**, or if the buttons stop lighting up, you should replace the remote control batteries”

COMPLETE LIST OF TV BRAND CODES		Beko	040	Craig	078	Fidelity	121	Hornlyphon	165	Kolin	651	Multitech	248	Planar	291	Sceptre	335	Syntax	373	Vidikron	416
		Belcor	453	Crosley	079	Finlux	122	Howard Computers	636	Kolster	203	NAD	250	Plantron	292	Schneider	336	Systemax	685	Vidtech	417
TV Brand	Code	Bell & Howell	041	Crown	080	Firstline	123	Huafa	637	Konig	652	Nakamichi	501	Plextor	293	Scimitsu	524	Tacico	686	Viewsonic	418
3M	001	BenQ	042	Crown Mustang	618	Fisher	124	Huari	638	Konka	204	National	661	Polaroid	294	Scotch	337	Tagar Systems	687	Viking	419
A.R. Systems	002	Beon	043	CTX	081	FlexVision	479	Humax	167	Korpel	205	Naxa	502	Polyvision	670	Scott	338	Tandy	375	Villain	553
Abex	003	Bestar	044	Curtis	082	Flint	125	Huodateji	639	Kosmos	206	NEC	251	Portland	295	Sears	339	Tashiko	540	Viore	420
ABS	600	BGH	608	Curtis Mathes	083	Fortress	624	Hush	640	Kost	494	Neckermann	252	Presidian	513	SEG	340	Tatung	376	Visa	554
Accurian	441	Blue Sky	045	CXC	084	Fraba	126	Hypson	168	Kreisen	207	NEI	253	Priceclub	296	SEI	341	TCL	688	Visart	555
Acer	004	BOSS	046	CyberHome	466	Frigidaire	625	Hyundai	169	KTV	208	NetTV	503	Prima	297	Seleco	525	Teac	377	Visco	421
Action	442	Boxlight	454	CyberPower	619	Fujimaro	626	Iberia	170	Kunlun	653	Neufunk	255	Princeton	298	Semp	677	Technics	378	Vision	422
Admiral	005	BPL	047	Cytron	085	Fujimaru	627	iBUYPOWER	641	Leyco	209	New Tech	256	Prism	299	Shaofeng	678	Technika	689	Vistron	556
Advent	006	Bradford	048	Daewoo	086	Fujitsu	127	ICE	171	LG	210	Newave	662	Profitronic	300	Sharp	342	Technol Ace	541	Vito	423
Adventura	007	Brilliant	049	Dansai	087	Funai	128	I-Inc	484	Liesenkotter	211	Newsonic	663	Projectiondesign	514	Sharper Image	526	Techview	379	Vizio	424
Aftron	443	Brinkmann	050	Dawa	088	Furi	628	iLo	172	Lifetec	212	Nexus Electronics	504	Proline	301	Shen Ying	679	Techwood	380	Voodoo	694
Aiko	008	Brionvega	051	Daytron	089	Futuretech	129	Ima	173	Linksys	654	Nikkai	257	Proscan	302	Shencai	680	Teco	542	Vortec	425
Aim	009	Brockwood	455	Dayu	620	Galaxis	130	Imperial	174	LiteOn	495	Nikko	258	Prosonic	303	Sheng Chai	681	Teknika	381	Voxson	426
Aiwa	010	Broksonic	052	Decca	090	Garrard	480	Imperial Crown	642	Lloyd's	213	Niko	505	Proton	304	Sheng Chia	343	Telecor	383	VU	695
Akai	011	Bush	053	Dell	091	Gateway	131	Indiana	175	Loewe	214	Nimbro	664	Protron	305	Sherwood	527	Telefunken	384	Waltham	427
Akiba	012	Byd:sign	054	Delta	467	GE	132	Infinity	176	Logik	215	Niveus Media	665	Proview	306	Shogun	528	Telegazi	385	Wards	428
Akira	601	C & M	456	Denon	092	GEC	133	InFocus	177	Luce	496	Noblex	506	ProVision	307	Siarem	344	Telemagic	543	Warumaia	696
Akura	013	Cadia	457	Denstar	468	Genexxa	134	Initial	178	Luma	216	Norcent	259	Proxima	308	Sierra	345	Telemeister	386	Watson	429
Alaron	444	Cailing	609	Desmet	093	GFM	135	Inno Hit	179	Lumatron	217	Northgate	666	Pulsar	309	Signature	346	Telesonic	387	Waycon	430
Alba	014	Candle	055	Diamant	094	Gibraltar	136	Insignia	180	Luxman	218	Norwood Micro	260	Puneet	515	Signet	529	Telestar	388	Wega	431
Albatron	015	Canon	056	Diamond Vision	469	Gibson	629	Inteq	181	LXI	219	Noshi	507	Pvision	516	SIM2 Multimedia	347	Teletech	389	Weltblick	432
Alfide	602	Carena	057	Digisonic	621	Go Video	137	Interfunk	182	M & S	655	Novatronic	261	Pye	310	Simpson	348	Tensai	390	Westinghouse	433
Alienware	603	Carnivale	058	Digistar	470	Goldline	138	Intervision	183	MAG	220	NTC	262	Pyle	311	Sinotec	530	Tera	544	Wharfedale	697
Alleron	016	Carver	059	Digital Lifestyles	471	GoldStar	139	iRIS	485	Magnasonic	221	NuVision	263	Qingdao	671	Sinudyne	349	Thomas	391	White Westinghouse	434
Allstar	017	Cascade	060	Digital Projection Inc.	472	Goodmans	140	Irradio	184	Magnavox	222	Okano	264	Quanta	517	Skyworth	531	Thomson	392	WinBook	557
A-Mark	445	Casio	458	Dikom	622	GPX	141	IRT	643	Magnin	223	Olevia	265	Quasar	312	Solarism	532	Thorn	393	Wyse	558
Ambassador	446	Cathay	061	Dimensia	096	Gradiente	142	Isukai	185	Majestic	224	Olympus	508	Quelle	313	Sole	533	Tiane	690	XR-1000	559
America Action	018	CCE	062	DirecTV	473	Granada	143	ITS	186	Manesth	225	Onida	667	Radialva	314	Sonic Blue	534	TMK	394	Xrypton	435
Ampro	019	Celebrity	063	Disney	097	Grundig	144	ITV	187	Marantz	226	Onwa	266	Radio Shack	315	Sonoko	350	TNCi	395	Yamaha	436
Amstrad	020	Celera	064	Dixi	098	Grunpy	145	IX	486	Mark	227	Opera	267	Radiola	317	Sontec	351	Tobo	691	Yamishi	437
Amtron	021	Centurion	065	Dream Vision	474	H & B	481	Janeil	188	Mastro	656	Oppo	268	Radiomarelli	318	Sony	352	Tokai	396	Yapshe	698
Anam	022	Champion	459	Dual	099	Haier	146	JBL	189	Matsui	228	Optimus	269	RadioShack	319	Soundesign	353	Toshiba	397	Yokan	438
Anam National	023	Changcheng	610	Dumont	100	Hallmark	147	JC Penney	190	Matsushita	229	Optoma	270	Radiotone	320	Soundwave	354	Tosonic	545	Yoko	439
Anhua	604	Changfeng	611	Durabrand	101	Hankook	630	JCB	191	Maxent	230	Optonica	271	RCA	321	Sova	535	Totevision	398	Zenith	440
Anitech	024	Changhong	066	Dwin	102	Hanns.G	482	JCM	487	MB Quart	497	Orbit	272	Realistic	322	Sowa	682	Touch	692	Zonda	560
Ansonic	025	Chun Yun	612	Dynatech	475	Hannspree	148	Jean	644	Media Center PC	657	Orion	273	Recor	323	Soyo	355	Trans Continens	399	ZT Group	699
Anthem	447	Chung Hsin	613	Dynatron	103	Hanseatic	149	Jensen	192	Mediator	231	Orline	274	Redstar	324	Spectricon	536	Trical	546		
AOC	026	Cinego	460	Dynex	104	Hantarex	150	Jiahua	645	Medion	232	Osaki	275	Reflex	325	Spectroniq	537	Triumph	400		
Aomni	448	Cinema	614	Eiki	105	Hantor	151	Jinfeng	646	Megapower	233	Otic	668	Relon	672	Squareview	356	TruTech	401		
Apex Digital	028	Cineral	615	Elbe	106	Harley Davidson	152	Jinxing	647	Megatron	234	Otto Versand	276	Remotec	518	SSS	357	TVS	402		
Apple	605	Citizen	067	Electroband	107	Harman/Kardon	153	JVC	193	MEI	498	Ovation	509	Render	519	Stack 9	683	Uher	403		
Archer	449	Clairtone	461	Electrograph	108	Harsper	483	Kaisui	194	M-Electronic	235	Palladium	277	ReplayTV	520	Standard	358	Ultra	547		
Archos	029	Clarion	068	Electrohome	109	Harvard	154	Kamp	488	Memorex	236	Panama	278	RevolutionHD	521	Starlite	359	Ultravox	404		
Aristona	030	Classic	462	Elektra	623	Harwood	155	Kangli	648	Mercury	237	Panasonic	279	Revox	326	Starvision	538	Unic Line	405		
Asberg	031	Clatronic	069	Element	110	Hauppauge	631	Karcher	195	MGA	238	Panavision	280	Rhapsody	522	Strato	360	Universal	406		
Astar	032	CME	463	Elin	111	Havermy	156	Kawasho	196	Micro	499	Panda	669	Ricavision	673	Studio Experience	361	Universum	407		
Atlantic	033	Coby	070	Elite	112	HCM	157	Kaypani	489	Microsoft	658	PARK	510	R-Line	327	SunBrite	539	Univox	408		
Audiosonic	034	Colortyme	071	Emerson	113	Helios	158	KDS	490	Midland	239	PDI	511	Rosen	328	Sunstar	363	US Logic	548		
Audio-Technica	450	Colt	072	Emprex	476	Hello Kitty	159	KEC	197	Mind	659	Penney	281	Rowa	674	Sunwood	364	UTI Technology	549		
Audiovox	035	Commercial Solutions	073	Encross	477	Heran	632	Ken Brown	649	Minoka	240	Perdio	282	Runco	329	Superscan	365	Vector Research	409		
Aurora Systems	451	Compaq	464	Envision	114	Herosonic	633	Kendo	198	Mintek	241	Perfekt	283	Sampo	330	Supersonic	366	Venturer	411		
Aventura	036	Computime	465	Epson	115	Hewlett Packard	160	Kenwood	199	Minutz	242	Petters	512	Samsung	331	SuperTech	367	VEOS	550		
Axion	037	Concerto	074	Erae	478	Hikona	634	Kioto	650	Mitsubishi	243	Philco	284	Samsux	523	Supre-Macy	368	Vestel	412		
Baile	606	Condor	075	Erres	116	HiLine	161	KLH	200	Monivision	244	Philips	285	Sansei	675	Supreme	369	Vexa	413		
Bang & Olufsen	452	Conrowa	616	ESA	117	Hinari	162	Kloss	491	Motorola	246	Phoenix	287	Sansui	332	SVA	370	Victor	414		
Basic Line	038	Contec	076	Euroman	118	Hisense	163	Kloss Novabeam	201	Moxell	500	Phonola	288	Sanyo	333	Sylvania	371	Video Concepts	551		
Baur	039	Contec/Cony	077	Europhon	119	Hitachi	164	KMDS	492	MTC	247	Pilot	289	Sanyuan	676	Symphonic	372	Videocon	693		
Beijing	607	Continental	617	Exquisit	120	Hongmei	635	Kneissel	202	Mudan	660	Pioneer	290	SBR	334	Synco	684	VideoSystem	415		

Free Manuals Download Website

<http://myh66.com>

<http://usermanuals.us>

<http://www.somanuals.com>

<http://www.4manuals.cc>

<http://www.manual-lib.com>

<http://www.404manual.com>

<http://www.luxmanual.com>

<http://aubethermostatmanual.com>

Golf course search by state

<http://golfingnear.com>

Email search by domain

<http://emailbydomain.com>

Auto manuals search

<http://auto.somanuals.com>

TV manuals search

<http://tv.somanuals.com>