

GV BOILER - GAS CONVERSION KIT

Instructions on reverse side apply to the following conversion kits:

Natural to Propane - red propane orifice plate
and conversion label, 550-223-113

Propane to Natural - silver natural orifice plate
and conversion label, 550-223-109

Boiler Model	W-M Part Number*	Boiler Model	W-M Part Number*
GV-3	510-811-600	GV-3	510-811-620
GV-4	510-811-605	GV-4	510-811-625
GV-5	510-811-610	GV-5	510-811-630
GV-6	510-811-615	GV-6	510-811-635

WARNING

This conversion kit is to be installed by a qualified installer/service technician in accordance with the Weil-McLain instructions and all codes and requirements of the authority having jurisdiction.

Failure to follow all instructions in proper order can cause severe personal injury, death, or property damage.

The qualified agency performing this work assumes responsibility for this conversion.

DO NOT TAMPER WITH ORIFICE SIZE. CHANGING OR MODIFYING IN ANY WAY CAN CAUSE SEVERE PERSONAL INJURY, DEATH, OR PROPERTY DAMAGE.

DO NOT LEAVE ANY UNINSTALLED ORIFICE PLATES IN THE BUILDING.

550-110-085/0501

PROPANE CONVERSION IS EASIEST WHEN BOILER IS ON SKID.

1. REMOVE JACKET FRONT PANEL.
2. LOCATE EXISTING ORIFICE PLATE BETWEEN BLOWER HOUSING AND GAS/AIR MANIFOLD.
3. REMOVE FRONT 2 SCREWS HOLDING GAS/AIR MANIFOLD AND ORIFICE PLATE TO BLOWER HOUSING. LOOSEN BACK 2 SCREWS.
4. PULL OUT EXISTING ORIFICE PLATE.
5. SLIDE IN NEW ORIFICE PLATE UNTIL FRONT SCREW HOLES LINE UP.
6. INSTALL FRONT 2 SCREWS.
7. TIGHTEN ALL 4 SCREWS EVENLY.
8. BEND DOWN FRONT LIP ON ORIFICE PLATE.
9. REPLACE JACKET FRONT PANEL.
10. AFFIX CONVERSION LABEL ON LEFT SIDE OF BOILER ABOVE GAS PIPING, ON TOP OF RIVETS.
11. SEE BOILER MANUAL PACKED WITH BOILER FOR GAS LEAK TEST AND START-UP/CHECK-OUT PROCEDURES.

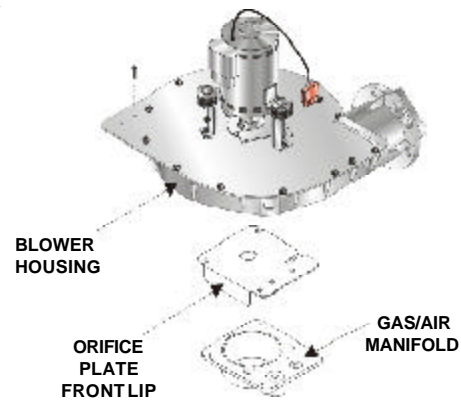

NOTES:

1. DO NOT ATTEMPT TO CHANGE MANIFOLD GAS PRESSURE. GAS VALVE IS SET CORRECTLY FOR NATURAL OR PROPANE.
2. CHECK GAS INLET PRESSURE (MIN. 4" W.C., MAX. 13" W.C.) WITH MANOMETER BY CONNECTING TO GAS INLET PRESSURE TAP ON THE GAS VALVE LOCATED JUST ABOVE THE GAS INLET PIPING.



WEIL-McLAIN
A United Dominion Company

Weil-McLain
500 Blaine Street
Michigan City, IN 46360-2388
<http://www.weil-mclain.com>

Free Manuals Download Website

<http://myh66.com>

<http://usermanuals.us>

<http://www.somanuals.com>

<http://www.4manuals.cc>

<http://www.manual-lib.com>

<http://www.404manual.com>

<http://www.luxmanual.com>

<http://aubethermostatmanual.com>

Golf course search by state

<http://golfingnear.com>

Email search by domain

<http://emailbydomain.com>

Auto manuals search

<http://auto.somanuals.com>

TV manuals search

<http://tv.somanuals.com>