



WELLS MANUFACTURING COMPANY
 2 ERIK CIRCLE, P. O. Box 280
 Verdi, NV 89439
 Customer Service (775) 345-0444 Ext.502
 fax: (775) 345-0569
 www.wellsbloomfield.com

SERVICE BULLETIN

102.004

TO: Wells Authorized Service Agencies
FROM: Hanju Lee, National Service Manager
SUBJECT: Magnetic Door Latch p/n 63946 - Replacement Parts

December 12, 2002

The following parts are available individually for the Magnetic Door Latch Assembly (p/n 63946):

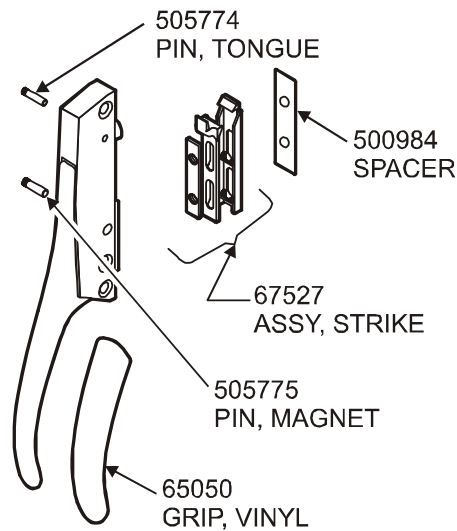

P/N	Description
63946	Handle Assy Complete
65050	Grip, Vinyl
67527	Strike Assy
505774	Pin, Tongue
505775	Pin, Magnet

PIN INSTALLATION INSTRUCTIONS

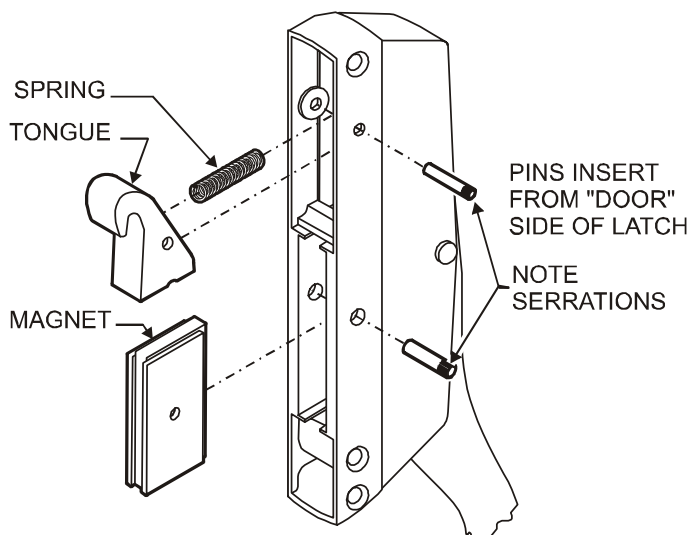

Pin Installation Instructions

1. Insert spring into recess in handle.
2. Note orientation of tongue. Press tongue against spring until holes line up.
3. Insert tongue pin from door side of handle.
Insert non-serrated end first.
 Press in until flush.
4. Assemble magnet.
 Note: Offset hole in rubber section goes toward rear of handle.
5. Insert magnet into handle until holes line up.
6. Insert magnet pin from door side of handle.
Insert non-serrated end first.
 Press in until flush.
7. Remount handle on door.

Free Manuals Download Website

<http://myh66.com>

<http://usermanuals.us>

<http://www.somanuals.com>

<http://www.4manuals.cc>

<http://www.manual-lib.com>

<http://www.404manual.com>

<http://www.luxmanual.com>

<http://aubethermostatmanual.com>

Golf course search by state

<http://golfingnear.com>

Email search by domain

<http://emailbydomain.com>

Auto manuals search

<http://auto.somanuals.com>

TV manuals search

<http://tv.somanuals.com>