

Wenger N.A.

15 Corporate Drive · Orangeburg, NY · 10962 · USA

Tel: 866-538-5760 to request a braille manual

800-431-2996, 845-365-3500

Web: www.WengerNA.com

Instruction Manual

Braille Watch



Maker of the Genuine Swiss Army Knife™



Maker of the Genuine Swiss Army Knife™

This manual is specifically intended for sighted individuals who are assisting the sight-impaired. To request this same manual printed in braille please call our toll free number 866-538-5760.

Table of Contents

Crafted for Life	1
Watch Components	2
General Features and Components	3
Operating Instructions	4
Caring For Your Watch	6
Warranty Information.	7
Warranty Service Instructions.	8
Registration Form.	9

Crafted For Life Delémont, Switzerland 1893

Over a century ago, Wenger built a factory in this tiny Swiss village and transformed it into production headquarters for the Genuine Swiss Army Knife™ still used by the Swiss Army today. As it was 100 years ago, each tool, implement and knife manufactured by Wenger is crafted by hand in solid stainless steel and each individually inspected for quality and craftsmanship. This same attention to detail has been applied to genuine Wenger watches. Wenger watches are Swiss-designed, -engineered and -crafted with only the most accurate Swiss movement available. Each watch is constructed with form and function that last a lifetime. As with the genuine Swiss Army knife, Wenger watches are durable, high quality, and versatile enough for use on any occasion.

Wenger Watch Components

Movement – Swiss quartz movement.

Water-Resistant – This watch is not water-resistant due to the flip-open crystal feature. Any contact with moisture may permanently damage the watch.

Strap – Genuine calfskin leather, with a butterfly clasp for easy on/off.

Crystal – The crystal is the clear surface which covers the watch dial. Unlike other watches, this crystal can be flipped open for touch-reading of the time.

Reinforced Hands – The hands of this watch are stronger than ordinary watch hands, to better withstand touch-reading.

Raised Markers – To assist with touch-reading, there are three different types of raised markers on the dial of this watch: a single oblong at 12 o'clock, pairs of dots at 9, 3 and 6 o'clock, and single dots at each of the hours in between.

General Features and Components

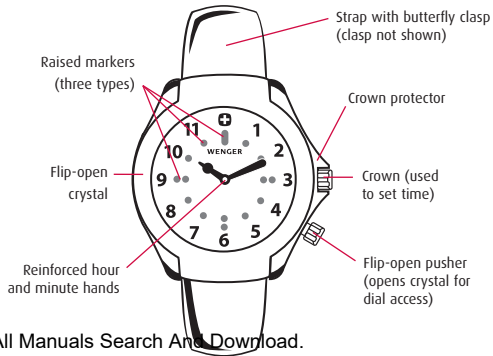

Download from Www.Somanuals.com. All Manuals Search And Download.

Setting the Time

1. Pull out the crown to Position 2 (all the way out). Rotate crown counterclockwise to set the hands to the correct time.
2. Return the crown to the fully depressed Position 1.

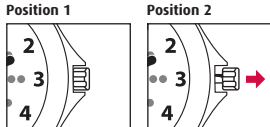

Additional Features

Flip-open Crystal

This feature enables you to open the crystal in order to touch-read the time.

1. Press the flip-open pusher, located on the outside of the watch at the 4 o'clock position. The crystal will spring open.
2. Touch the hands and dial to determine the time.
3. Return the crystal to its fully closed position manually.

Butterfly Clasp

This clasp assures a secure fit of your watch and easy opening and closing. It allows for a one-time strap fitting instead of refitting each time the watch is worn. We suggest sighted assistance for this initial fitting.

1. Remove the strap end from the leather loop(s).
2. Open the clasp by gently pulling the end of the strap away from the watch. In case the strap end is accidentally removed from the metal buckle, place it back into the buckle with the cross (which is slightly raised) facing outward.
3. Fitting the watch may take some trial and error. Start by identifying the small pin that's attached to the back of the buckle. Insert the pin into a hole in the strap. For thicker wrists use the holes closer to the end of the strap or, for thinner wrists, closer to the watch.
4. Pull the buckle toward the end of the strap to secure the pin.
5. Slip your wrist thru the strap and fold the metal hinge properly so it conforms to your wrist.

(continued next page)

6. Place the thumb of your opposite hand on the buckle and your index finger underneath the curved metal hinge and squeeze until the buckle snaps closed.
7. Gently pull the end of the strap away from your wrist to remove.
8. For adjustments to the pin position gently pull the buckle towards the watch to disengage the pin, then follow steps #3 - 5 on previous page again.

Caring for Your Watch

Do not expose this watch to moisture whatsoever. Doing so may cause permanent damage to the watch and void your warranty. We suggest sending your Wenger watch to our Customer Service Center for battery replacement (please see procedure under "Warranty Service"). Batteries should only be replaced by a professional jeweler.

3-Year Limited Warranty

Wenger is proud to stand by our quality Swiss craftsmanship with a 3-Year Limited Warranty. This Wenger watch is warranted to the original consumer/purchaser against breakage or malfunction under normal use due to defects in material or workmanship. This 3-Year Limited Warranty also includes all components and craftsmanship of the Swiss movement and watch case. We will repair, or at our option, replace any defective Wenger watch with the same or comparable model. We will refund the purchase if repair or replacement is not commercially possible. The warranty will become null and void if the timepiece is misused, abused, tampered with or taken apart, or if the timepiece is repaired by anyone other than an authorized dealer. The warranty is not extended to the watch strap, bracelet, finish, crystal or battery. The warranty does not cover any incidental, consequential or special damage arising from any or all uses of the Wenger watch. Wenger watches must be repaired by an authorized dealer or the warranty is void. Some states do not allow the exclusion or limitations of incidental, consequential or special damages, so the above limitations may not apply.

Please call us toll free at 866-538-5760 to request a copy of this manual, including warranty, in braille.

Download from www.Somanuals.com. All Manuals Search And Download.

Warranty Service

In the United States, please send your watch to: Wenger Watch Repair Center, 15 Corporate Drive, Orangeburg, NY 10962. Please include a check or money order payable to Wenger NA in the amount of \$10(US) to cover the cost of return shipping and handling (California residents exempt). If your warranty has been rendered void as a result of non-compliance with above warranty restrictions, we will send you an estimate before any repairs are made. When sending your watch to our Service Center, please pack it securely. We suggest insuring the shipment as Wenger NA cannot be responsible for packages not received by the company. Be sure to include your name, mailing address, phone number, email address, proof of purchase and a brief description of the problem. Wenger is not responsible for damage or loss in shipping. Note: Do not send watch boxes. If you have questions or concerns, please call 800-267-3577 or 800-447-7422 to speak to a Customer Care Associate. You may also visit us on the web at www.WengerNA.com or contact us via e-mail at Custsvc@WengerNA.com. In Canada call: 888-838-1504. Outside the U.S. or Canada, please visit www.WengerWatch.com for further instructions.

Wenger Watch Registration

For your convenience you can **register online** at www.WengerNA.com/warranty or complete the form below and mail it to the address on the back.

Name/Nombre: _____

Address/Dirección: _____

City/Cuidad: _____

State/Estado: _____ Zip Code/Código Postal: _____

Email: _____

Date Acquired/Fecha de Adquisición: _____

Gift/Regalo Purchase/Compre

Where Purchased/Lugar de Compra: _____

Free Manuals Download Website

<http://myh66.com>

<http://usermanuals.us>

<http://www.somanuals.com>

<http://www.4manuals.cc>

<http://www.manual-lib.com>

<http://www.404manual.com>

<http://www.luxmanual.com>

<http://aubethermostatmanual.com>

Golf course search by state

<http://golfingnear.com>

Email search by domain

<http://emailbydomain.com>

Auto manuals search

<http://auto.somanuals.com>

TV manuals search

<http://tv.somanuals.com>