

WESLO **PURSUIT** 795i

LOW IMPACT EXERCISE CYCLE

Model No. WLCCEX69571

Serial No. _____

Write the serial number in the space above for future reference.

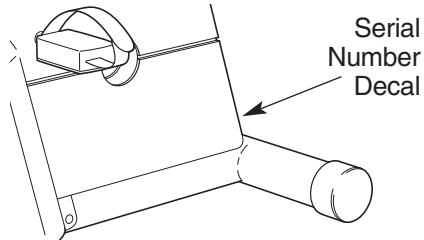

USER'S MANUAL

QUESTIONS?

As a manufacturer, we are committed to providing complete customer satisfaction. If you have questions, or if there are missing or damaged parts, we will guarantee complete satisfaction through direct assistance from our factory.

TO AVOID DELAYS, PLEASE CALL DIRECT TO OUR TOLL-FREE CUSTOMER HOT LINE. The trained technicians on our customer hot line will provide immediate assistance, free of charge to you.

CUSTOMER HOT LINE:

1-888-936-4266

Mon.-Fri., 8h00-18h30 EST

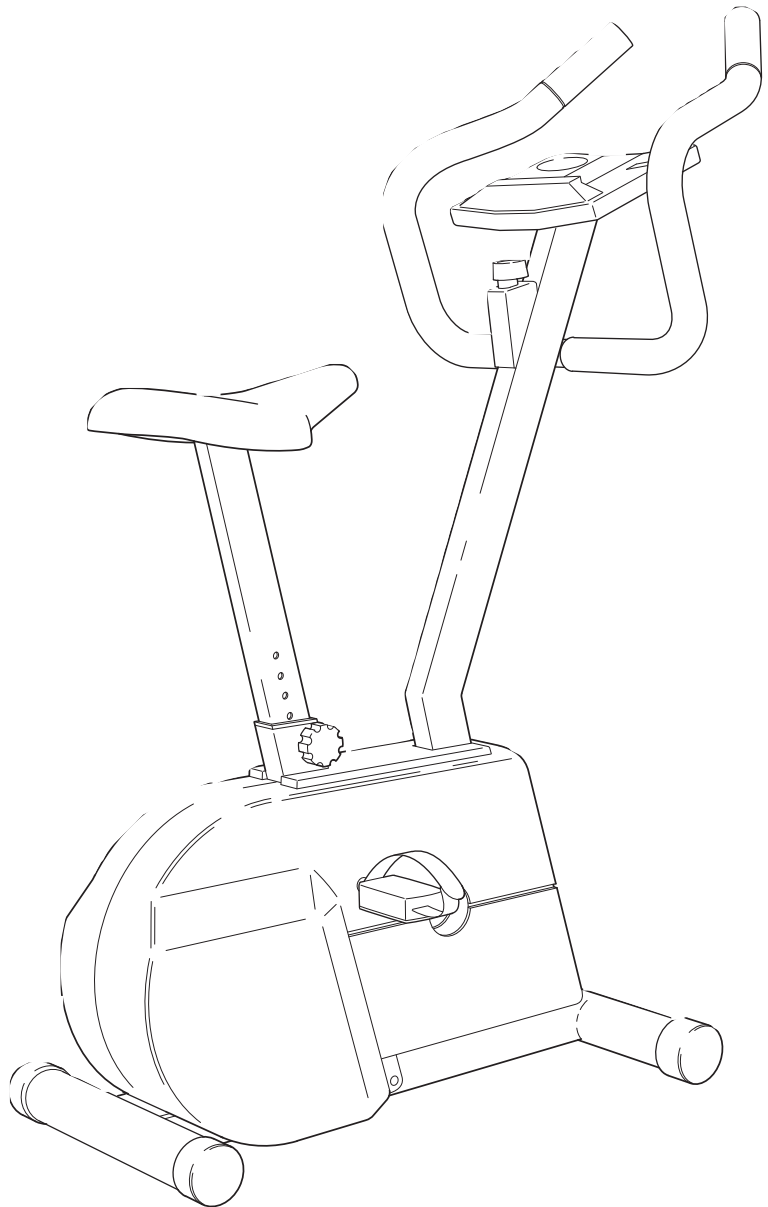

CAUTION

Read all precautions and instructions in this manual before using this equipment. Keep this manual for future reference.



Visit our website at

www.weslo.com

*new products, prizes,
fitness tips, and much more!*

WESLO **PURSUIT**795i
LOW IMPACT EXERCISE CYCLE

TABLE OF CONTENTS

IMPORTANT PRECAUTIONS3
BEFORE YOU BEGIN4
PART IDENTIFICATION CHART5
ASSEMBLY6
HOW TO USE THE PURSUIT 795i8
CONDITIONING GUIDELINES10
MAINTENANCE AND TROUBLE-SHOOTING11
PART LIST13
EXPLODED DRAWING14
HOW TO ORDER REPLACEMENT PARTS15
LIMITED WARRANTY	Back Cover

IMPORTANT PRECAUTIONS

WARNING: To reduce the risk of serious injury, read the following important precautions before using the exercise cycle.

1. Read all instructions in this manual before using the exercise cycle. Use the exercise cycle only as described.
2. It is the responsibility of the owner to ensure that all users of the exercise cycle are adequately informed of all precautions.
3. Use the exercise cycle indoors, away from moisture and dust. Place the exercise cycle on a level surface, with a mat beneath it to protect the floor or carpet from damage.
4. Inspect and tighten all parts regularly. Replace any worn parts immediately.
5. Keep children under the age of 12 and pets away from the exercise cycle at all times.
6. The exercise cycle should not be used by persons weighing more than 250 pounds (115 kg).
7. Wear appropriate clothing when exercising; do not wear loose clothing that could become caught on the exercise cycle. Always wear athletic shoes for foot protection.
8. When adjusting the seat, insert the seat knob through one of the holes in the seat post (see the drawing on page 4). Do not insert the seat knob under the seat post.
9. Always keep your back straight when using the exercise cycle. Do not arch your back.
10. If you feel pain or dizziness at any time while exercising, stop immediately and begin cooling down.
11. The exercise cycle is intended for in-home use only. Do not use the exercise cycle in a commercial, rental, or institutional setting.
12. The pulse monitor is not a medical device. Various factors, including the user's movement, may affect the accuracy of heart rate readings. The pulse monitor is intended only as an exercise aid in determining heart rate trends in general.

WARNING: Before beginning this or any exercise program, consult your physician. This is especially important for persons over the age of 35 or persons with pre-existing health problems. Read all instructions before using. ICON assumes no responsibility for personal injury or property damage sustained by or through the use of this product.

The decal shown at the right has been placed on the exercise cycle. If the decal is missing, or if it is not legible, please call our Customer Service Department to order a free replacement decal at 1-888-936-4266. Apply the replacement decal in the location shown.

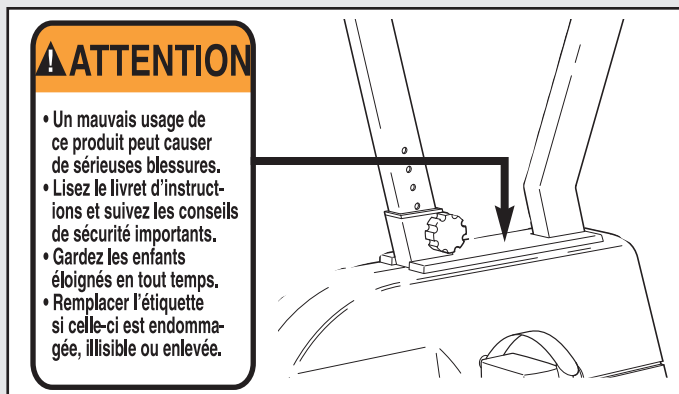

BEFORE YOU BEGIN

Thank you for selecting the new WESLO® PURSUIT 795i exercise cycle. The PURSUIT 795i blends advanced engineering with contemporary styling to provide you with a low-impact workout in the convenience and privacy of your own home.

For your benefit, read this manual carefully before you use the PURSUIT 795i. If you have additional questions, please call our Customer Service Department toll-free at 1-888-936-4266, Monday through Friday, 8:00 a.m. until 6:30 p.m. Eastern Time

(excluding holidays). To help us assist you, please mention the product model number and serial number when calling. The model number is WLCCEX69571. The serial number can be found on a decal attached to the PURSUIT 795i (see the front cover of this manual for the location of the decal).

Before reading further, please look at the drawing below and familiarize yourself with the parts that are labeled.

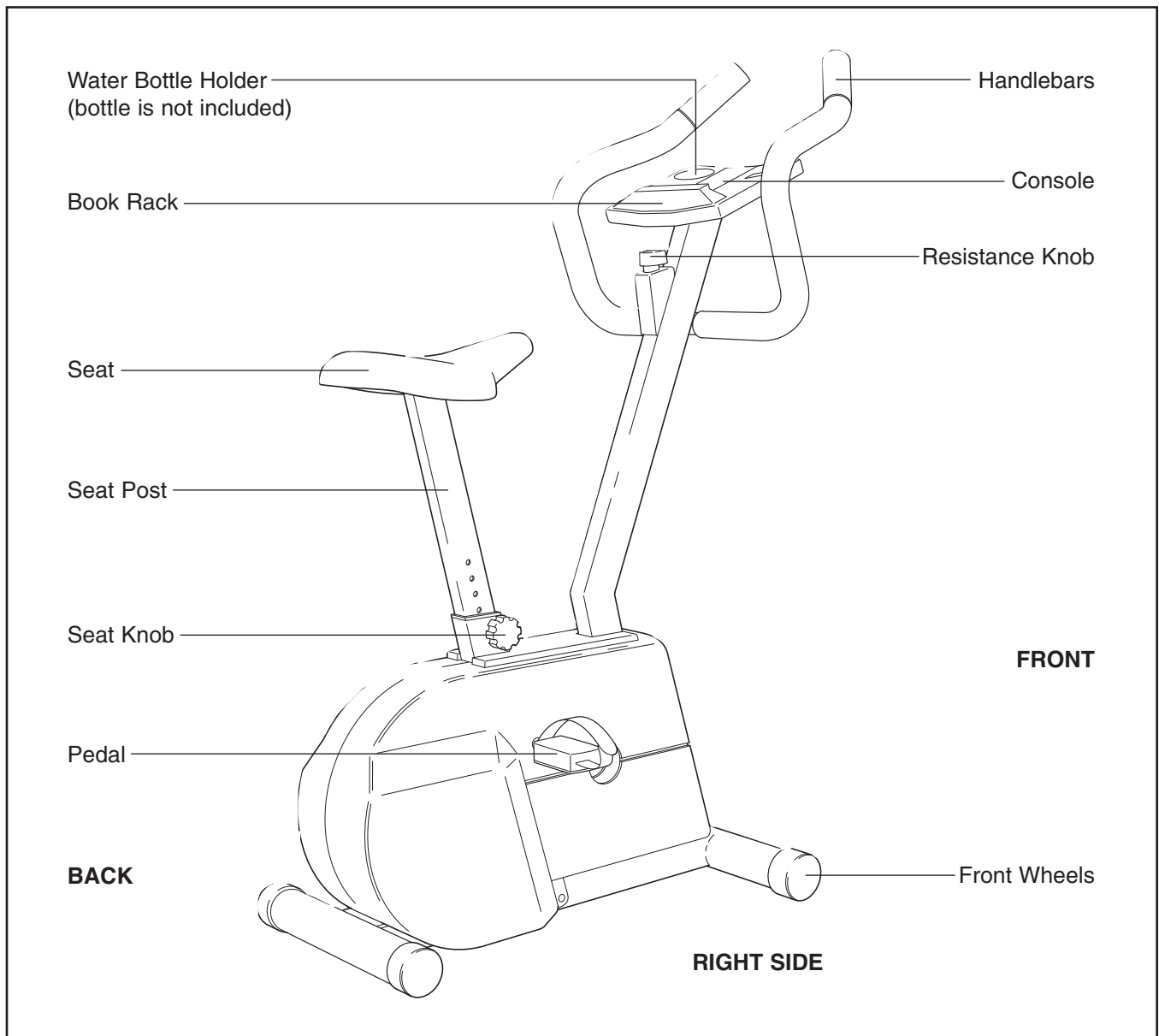

PART IDENTIFICATION CHART

Use the chart below for help identifying the small parts used in assembly. The number in parenthesis below each part refers to the key number of the part. The second number refers to the quantity used in

assembly. **Note: Some parts may have been pre-attached for shipping purposes. If a part is not found in the parts bag, check to see if it has been pre-attached.**

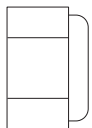
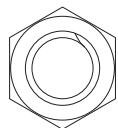

M8 Nylon Locknut (21)–3

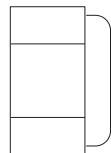
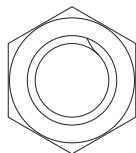

M10 Nylon Locknut (31)–4

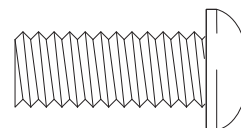

M10 x 25mm Button Screw (8)–5

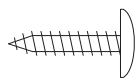

M4 x 16mm Screw (9)–5



M8 Split Washer (53)–3

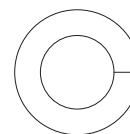

M10 Split Washer (41)–5



M10 x 70mm Carriage Bolt (30)–4

ASSEMBLY

Place all parts of the exercise cycle in a cleared area and remove the packing materials. **Do not dispose of the packing materials until assembly is completed.**

Assembly requires the included allen wrench  , a phillips screwdriver  and two adjustable wrenches  .

1. Identify the Front Stabilizer (17), which has Wheels (25) on the ends. Hold the Front Stabilizer against the saddle on the front of the Frame (15). Make sure that the Front Stabilizer is turned so the square holes are facing away from the saddle. Attach the Front Stabilizer with two M10 x 70mm Carriage Bolts (30) and two M10 Nylon Locknuts (31).

Attach the Rear Stabilizer (not shown) to the rear of the Frame (15) in the same manner.

2. The Console (7) requires two AA batteries (not included). Alkaline batteries are recommended. Refer to the inset drawing. Open the battery cover on the underside of the Console as shown. Press two batteries into the battery compartment. **Make sure that the negative ends of the batteries (marked “-”) are touching the springs in the battery compartment. Close the battery cover.**

Insert the console wire through the Handlebar Post (14). Connect the console wire to the Reed Switch Wire (54). Attach the Console (7) to the Handlebar Post with four M4 x 16mm Screws (9).

Carefully slide the Handlebar Post (14) onto the Frame (15). **Be careful to avoid pinching the wires inside the Handlebar Post.** Attach the Handlebar Post with three M10 x 25mm Button Screws (8) and three M10 Split Washers (41). Attach the Knob Housing (12) to the Handlebar Post with a M4 x 16mm Screw (9).

3. Attach the Handlebar (5) to the Handlebar Post (14) with two M10 x 25mm Button Screws (8) and two M10 Split Washers (41).

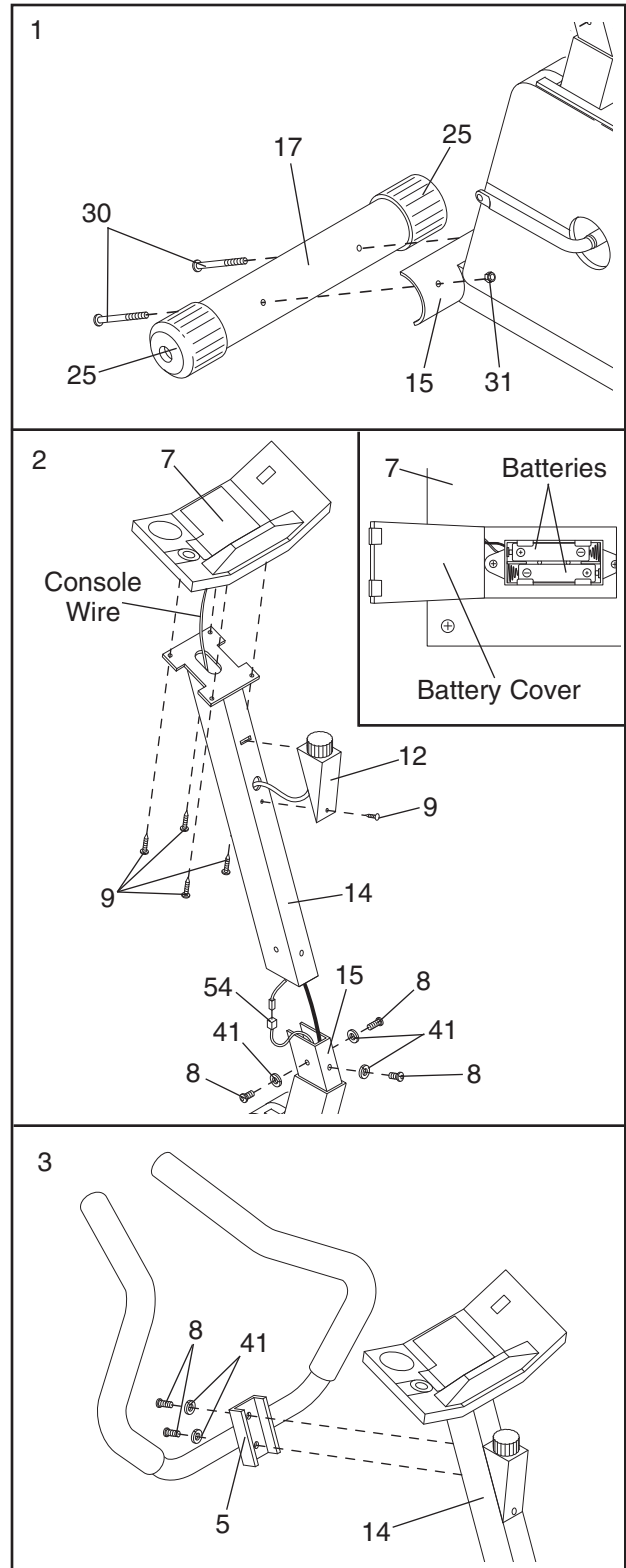

4. Tighten the two Side Shield Screws (4) in the Left Side Shield (1). Next, tighten the two Side Shield Screws in the Right Side Shield (2).

Press the Side Shield Cover (40) onto the Left and Right Side Shields (1, 2).

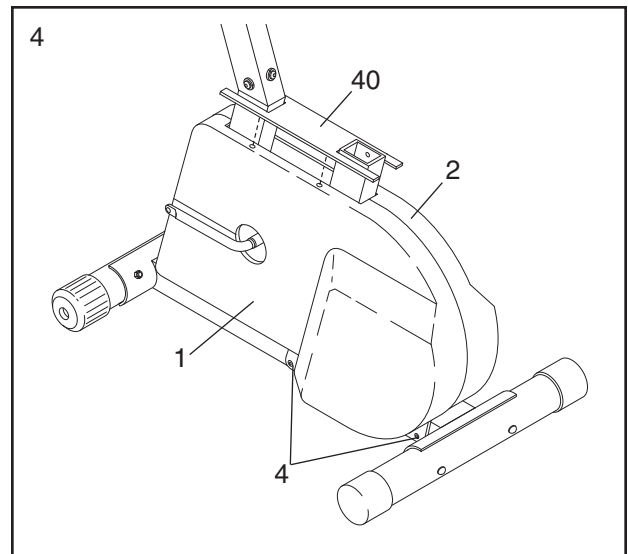

5. Insert the Seat Post (20) into the Frame (15). Align one of the holes in the Seat Post with the hole in the Frame. Insert the Seat Knob (29) into the Frame and the Seat Post, and tighten the Seat Knob into the Frame. **Make sure to insert the Seat Knob through one of the holes in the Seat Post; do not insert the Seat Knob under the Seat Post.**

Attach the Seat (19) to the Seat Post (20) with three M8 Nylon Locknuts (21) and three M8 Split Washers (53). (Note: The Nylon Locknuts and Split Washers may be pre-attached to the bottom of the Seat.)

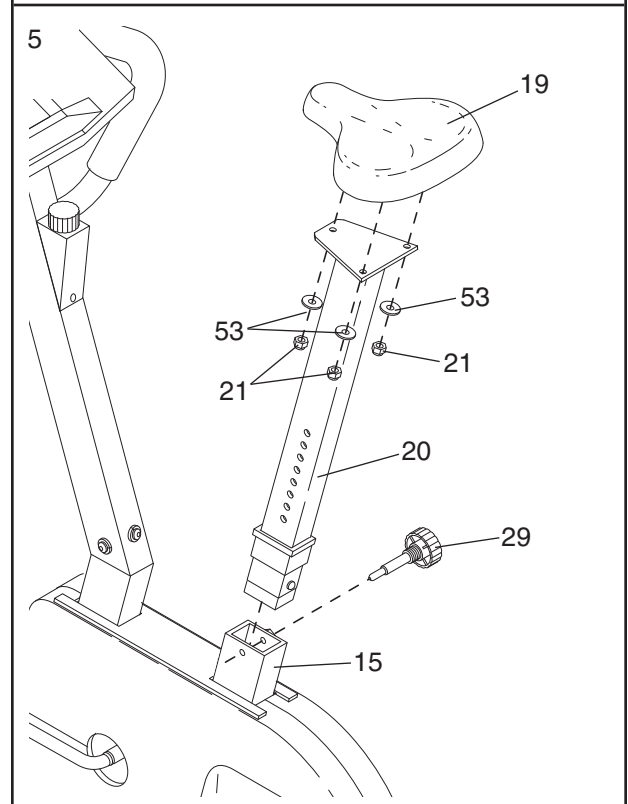

6. Identify the Left Pedal (28); there is an "L" on the Left Pedal for identification. Using an adjustable wrench, tighten the Left Pedal *counterclockwise* into the left arm of the Crank (33).

Tighten the Right Pedal (not shown) *clockwise* into the right arm of the Crank (33).

7. **Make sure that all parts are properly tightened before you use the exercise cycle.** Place a mat under the exercise cycle to protect the floor or carpet.

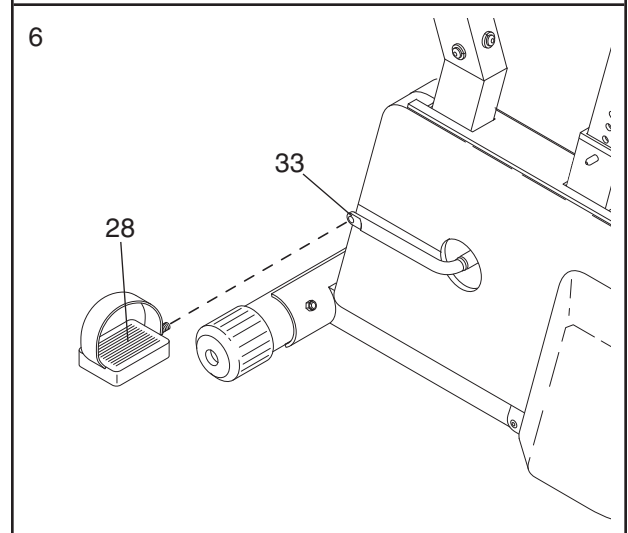

HOW TO USE THE PURSUIT 795i

HOW TO ADJUST THE SEAT

For effective exercise, the Seat (19) should be at the proper height. As you pedal, there should be a slight bend in your knees when the pedals are in the lowest position. To adjust the Seat, first hold the Seat and unscrew the Seat Knob (29). Align one of the holes in the Seat Post (20) with the hole in the Frame (15). Insert the Seat Knob into the Frame and the Seat Post, and tighten the Seat Knob into the Frame. **Caution: Make sure to insert the Seat Knob through one of the holes in the Seat Post; do not insert the Seat Knob under the Seat Post.**

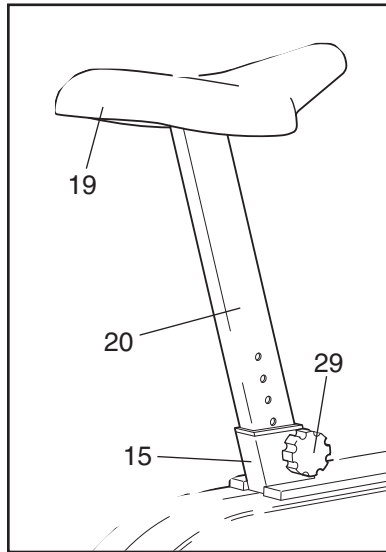

HOW TO ADJUST THE PEDALLING RESISTANCE

To vary the intensity of your exercise, the pedalling resistance can be adjusted. The resistance is controlled with the Resistance Knob (10). To increase the resistance, turn the Resistance Knob clockwise; to decrease the resistance, turn the Resistance Knob counterclockwise.

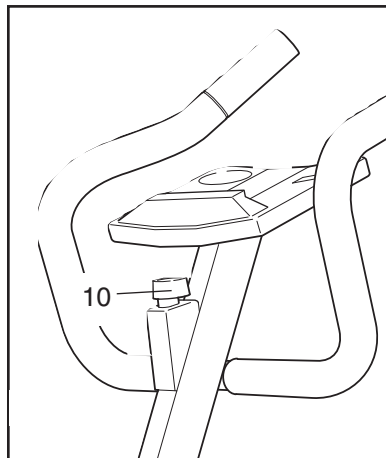

HOW TO APPLY AN INFORMATION DECAL TO THE CONSOLE

All of the information on the console is printed in English. The included decal sheet contains the same information in five other languages. If English is not your language, find the decal that is printed in your language.

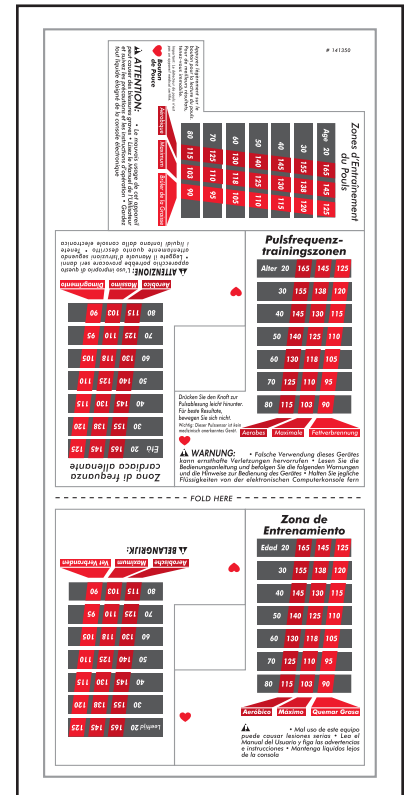

Next, peel the information decal off the decal sheet. Apply the decal to the console in the location shown.

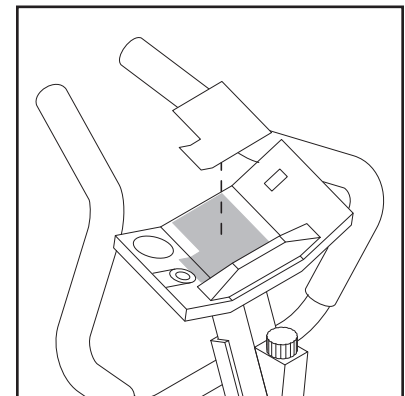



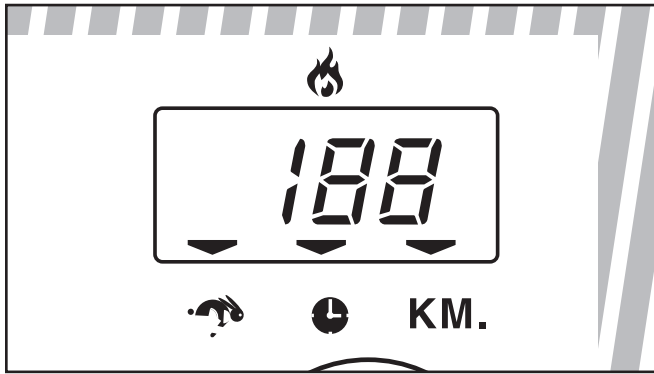

BATTERY INSTALLATION

Before the console can be operated, two AA batteries must be installed. If you have not installed batteries, see assembly step 2 on page 6.

DIAGRAM OF THE CONSOLE



The console offers six modes that provide instant exercise feedback. Each mode is displayed for five seconds in a repeating cycle. The modes are described below.

-  Pulse—This mode displays your heart rate when the pulse sensor is used.
-  Calorie—This mode displays the approximate number of calories you have burned.
-  Fat Calorie—This mode displays the approximate number of fat calories you have burned. (See BURNING FAT on page 10.)
-  Speed—This mode displays your pedalling speed, in kilometers per hour.
-  Time—This mode displays the length of time you have exercised.
- KM** Distance—This mode displays the total number of kilometers you have pedalled during your workout.

HOW TO OPERATE THE CONSOLE

1. To turn on the power, press the on/reset button or simply begin pedalling. When the power is turned on, the entire display will appear for two seconds. The console will then be ready for operation.

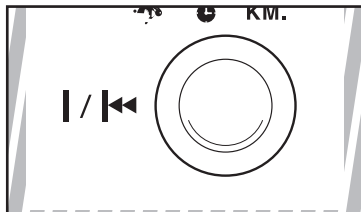

2. When the power is turned on, the console will begin displaying all modes in a repeating cycle (except for the pulse mode). Flashing arrows will show which mode is currently displayed.

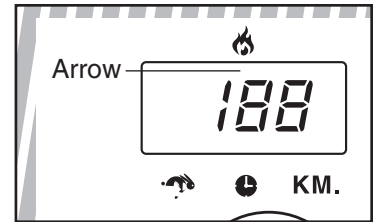

3. To measure your pulse, stop pedalling and place your thumb on the pulse sensor as shown. The pulse sensor is pressure-activated—fully press down the pulse sensor. **Do not press too hard, or the circulation in your thumb will be restricted, and your pulse will not be detected.** Next, slightly raise your thumb until the heart-shaped indicator in the display flashes **steadily**. Hold your thumb at this level. After 5 to 10 seconds, three dashes will appear in the display and your pulse will then be shown. Hold your thumb on the sensor for another 15 seconds for the most accurate reading. If the displayed pulse appears to be too high or too low, or if your pulse is not displayed, lift your thumb off the sensor and allow the display to reset. Press down again on the sensor as described above.

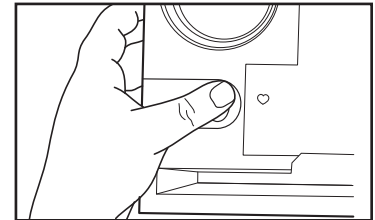

Make sure that your thumb is positioned as shown, and that you are applying the proper amount of pressure to the pulse sensor. Try the sensor several times until you become familiar with it.

4. To reset the display, press the on/reset button.

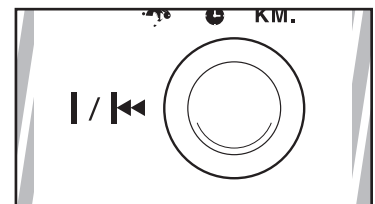

5. **To turn off the power, simply wait for about six minutes.** Note: The console has an “auto-off” feature. If the pedals are not moved and the console buttons are not pressed for six minutes, the power will turn off automatically in order to conserve the batteries.

CONDITIONING GUIDELINES

The following general guidelines will help you to plan your exercise program. Remember that proper nutrition and adequate rest are essential for successful results.

WARNING: Before beginning this or any exercise program, consult your physician. This is especially important for persons over the age of 35 or persons with pre-existing health problems.

The pulse monitor is not a medical device. Various factors, including the user's movement, may affect the accuracy of heart rate readings. The pulse monitor is intended only as an exercise aid in determining heart rate trends in general.

EXERCISE INTENSITY

Whether your goal is to burn fat or to strengthen your cardiovascular system, the key to achieving the desired results is to exercise with the proper intensity. The proper intensity level can be found by using your heart rate as a guide. The chart in the centre of the console shows recommended heart rates for fat burning, maximum fat burning, and cardiovascular (aerobic) exercise.

To find the proper heart rate for you, first find your age on the left side of the chart (ages are rounded off to the nearest ten years). Next, find the three numbers to the right of your age. The three numbers are your "training zone." The lowest number is the recommended heart rate for fat burning; the middle number is the recommended heart rate for maximum fat burning; the highest number is the recommended heart rate for aerobic exercise.

Burning Fat

To burn fat effectively, you must exercise at a relatively low intensity level for a sustained period of time. During the first few minutes of exercise, your body uses easily accessible *carbohydrate* calories for energy. Only after the first few minutes of exercise does your body begin to use stored *fat* calories for energy. If your goal is to burn fat, adjust the intensity of your exercise until your heart rate is near the lowest number in your training zone as you exercise.

For maximum fat burning, adjust the intensity of your exercise until your heart rate is near the middle number in your training zone as you exercise.

Aerobic Exercise

If your goal is to strengthen your cardiovascular system, your exercise must be "aerobic." Aerobic exercise is activity that requires large amounts of oxygen for prolonged periods of time. This increases the demand on the heart to pump blood to the muscles, and on the lungs to oxygenate the blood. For aerobic exercise, adjust the intensity of your exercise until your heart rate is near the highest number in your training zone.

HOW TO MEASURE YOUR HEART RATE

To measure your heart rate, first exercise for at least four minutes. Then, stop pedalling and measure your heart rate using the pulse sensor on the console.

WORKOUT GUIDELINES

Each workout should include the following three important parts:

A warm-up, consisting of 5 to 10 minutes of stretching and light exercise. A proper warm-up increases your body temperature, heart rate, and circulation in preparation for strenuous exercise.

Training zone exercise, consisting of 20 to 30 minutes of exercising with your heart rate in your training zone. (During the first few weeks of your exercise program, do not keep your heart rate in your training zone for longer than 20 minutes.)

A cool-down, with 5 to 10 minutes of stretching. This will increase the flexibility of your muscles and will help to prevent post-exercise problems.

EXERCISE FREQUENCY

To maintain or improve your condition, plan three workouts each week, with at least one day of rest between workouts. After a few months of regular exercise, you may complete up to five workouts each week, if desired. **Caution: Be sure to progress at your own pace and avoid overdoing it. Incorrect or excessive training may result in injury to your health.**

Remember, the key to success is make exercise a regular and enjoyable part of your everyday life.

MAINTENANCE AND TROUBLE-SHOOTING

Inspect and tighten all parts of the exercise cycle regularly. Replace any worn parts immediately.

The exercise cycle can be cleaned with a soft, damp cloth. Avoid spilling liquid on the console. Keep the console out of direct sunlight or the display may be damaged. Remove the batteries when storing the exercise cycle.

HOW TO TIGHTEN THE CRANK

If the arms of the Crank (33) become loose, they should be tightened in order to prevent excessive wear. Loosen the Crank Nut (56) on the left arm of the

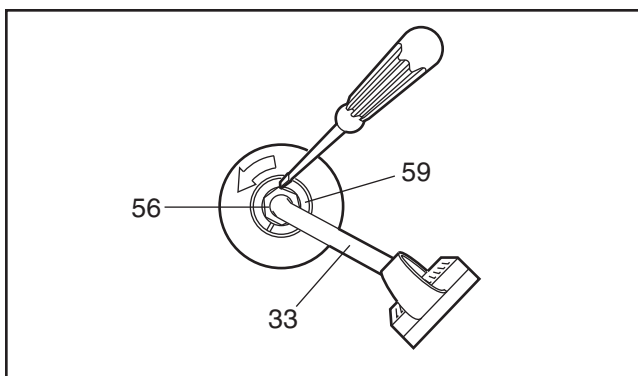

Crank. Place the end of a standard screwdriver in one of the slots in the Crank Bearing Assembly (59). Lightly tap the screwdriver with a hammer to turn the Crank Bearing Assembly counterclockwise until the arms are no longer loose. **Do not overtighten the Crank Bearing Assembly.** When the Crank Bearing Assembly is properly tightened, retighten the Crank Nut.

BATTERY REPLACEMENT

If the console does not function properly, the batteries should be replaced. To replace the batteries, see assembly step 2 on page 6. In addition, make sure that the console wire is connected to the reed switch wire.

HOW TO ADJUST THE REED SWITCH

If the console does not display correct feedback, the reed switch should be adjusted. In order to adjust the reed switch, the Left Side Shield (1) must be removed. Using an adjustable wrench, turn the Left Pedal (28)

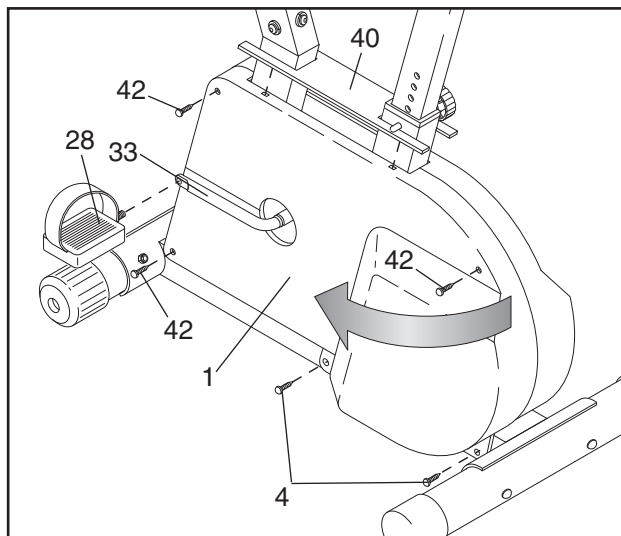

clockwise and remove it from the Crank (33). Remove the two Side Shield Screws (4) and the three M4 x 32mm Screws (42) from the Left Side Shield. Next, lift the Side Shield Cover (40) off the Side Shields. Grasp both Side Shields at the top and gently pull them apart. Make sure that the arm of the Crank is in the position shown in the drawing above. Carefully slide the Left Side Shield forward off the arm of the Crank and remove it.

Next, locate the Reed Switch (54). Turn the Crank (33) until the Magnet (55) is aligned with the Reed Switch. Loosen but do not remove the M4 x 16mm Screw (9). Slide the Reed Switch slightly closer to or away from

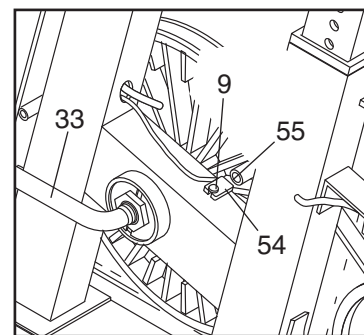

the Magnet. Retighten the Screw. Turn the Crank for a moment. Repeat until the console displays correct feedback. When the Reed Switch is correctly adjusted, reattach the left side shield and pedal.

HOW TO ADJUST THE RESISTANCE STRAP

If there is not enough pedalling resistance when the resistance knob is turned to the highest setting, the Resistance Strap (47) may need to be adjusted. To adjust the Resistance Strap, the left side shield must first be removed. Refer to the instructions at the left and remove the left side shield.

Next, turn the resistance knob to the lowest setting. Locate and open the Strap Buckle (46). Grip the end of the Resistance Strap (47) and pull it up to remove any slack. While holding the end of the Resistance Strap, **fully** close the Strap Buckle. Turn the Crank (33) for a moment to make sure that there is not too much resistance. When the Resistance Strap is properly adjusted, reattach the left side shield and pedal.

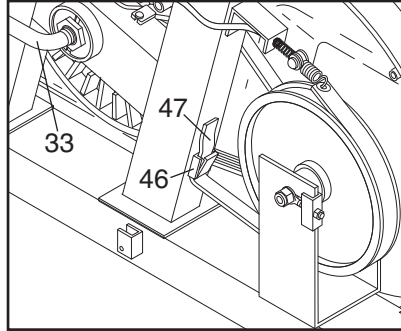

HOW TO ADJUST THE BELT

The exercise cycle features a precision belt that must be kept properly adjusted. If the belt causes excessive noise or slips as you pedal, the belt should be checked. To do this, the left side shield must first be removed. Refer to the instructions on page 11 and remove the left side shield.

Next, use an adjustable wrench to turn the right pedal counterclockwise and remove it. Remove the right side shield.

Press down on the centre of the Belt (16) between the front and rear pulleys. **There should be from 1/4" to 3/4" (6 to 19mm) of vertical movement in the center of the Belt.**

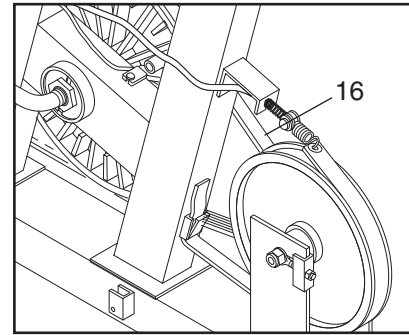

If the Belt (16) is properly adjusted, reattach the side shields and pedals. If the Belt needs to be adjusted, loosen the M8 Washer Nut (34) on each side of the Flywheel (39).

To tighten the Belt, turn the two M6 Nuts (37) clockwise; to loosen the Belt, turn the Nuts counterclockwise. Make sure that the Flywheel is straight and tighten the M8 Washer Nuts (34). Reattach the side shields and pedals.

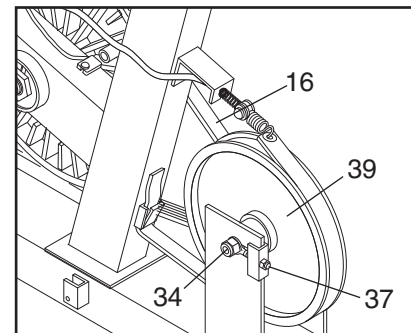

PART LIST—Model No. WLCCEX69571

R0500A

Key No.	Qty.	Description	Key No.	Qty.	Description
1	1	Left Side Shield	32	1	Small Spring
2	1	Right Side Shield	33	1	Crank/Pulley
3	2	Double Tree Fastener	34	2	M8 Washer Nut
4	4	Side Shield Screw	35	2	Adjustment Bolt
5	1	Handlebar	36	2	Adjustment Bracket
6	2	Foam Grip	37	2	M6 Nut
7	1	Console	38	1	Flywheel Axle
8	5	M10 x 25mm Button Screw	39	1	Flywheel
9	7	M4 x 16mm Screw	40	1	Side Shield Cover
10	1	Resistance Knob	41	5	M10 Split Washer
11	1	Resistance Cable	42	3	M4 x 38mm Screw
12	1	Knob Housing	43	2	Flywheel Bearing
13	1	Right Pedal	44	2	M10 Washer
14	1	Handlebar Post	45	1	M4 x 16mm Flat Head Screw
15	1	Frame	46	1	Strap Buckle
16	1	Belt	47	1	Resistance Strap
17	1	Front Stabilizer	48	2	Stabiliser Endcap
18	1	Rear Stabilizer	49	1	Large Spring
19	1	Seat	50	4	M6 Washer
20	1	Seat Post	51	1	M4 x 14mm Bolt
21	3	M8 Nylon Locknut	52	1	M4 Nut
22	1	25.4mm x 50.8mm Bushing	53	3	M8 Split Washer
23	1	38.1mm x 63.5mm Bushing	54	1	Reed Switch/Wire
24	2	Wheel Hub	55	1	Magnet
25	2	Wheel	56	1	Crank Nut
26	2	Wheel Spacer	57	2	Handlebar Endcap
27	2	M6 x 16mm Self-tapping Screw	58	1	Flywheel Spacer
28	1	Left Pedal	59*	2	Crank Bearing Assembly
29	1	Seat Knob	#	1	User's Manual
30	4	M10 x 70mm Carriage Bolt	#	1	Console Decal Sheet
31	4	M10 Nylon Locknut	#	1	Allen Wrench

* Includes all parts shown in the box

Note: “#” indicates a non-illustrated part. Specifications are subject to change without notice. See the page 15 of this manual for information about ordering replacement parts.

EXPLODED DRAWING—Model No. WLCCEX69571

R0500A

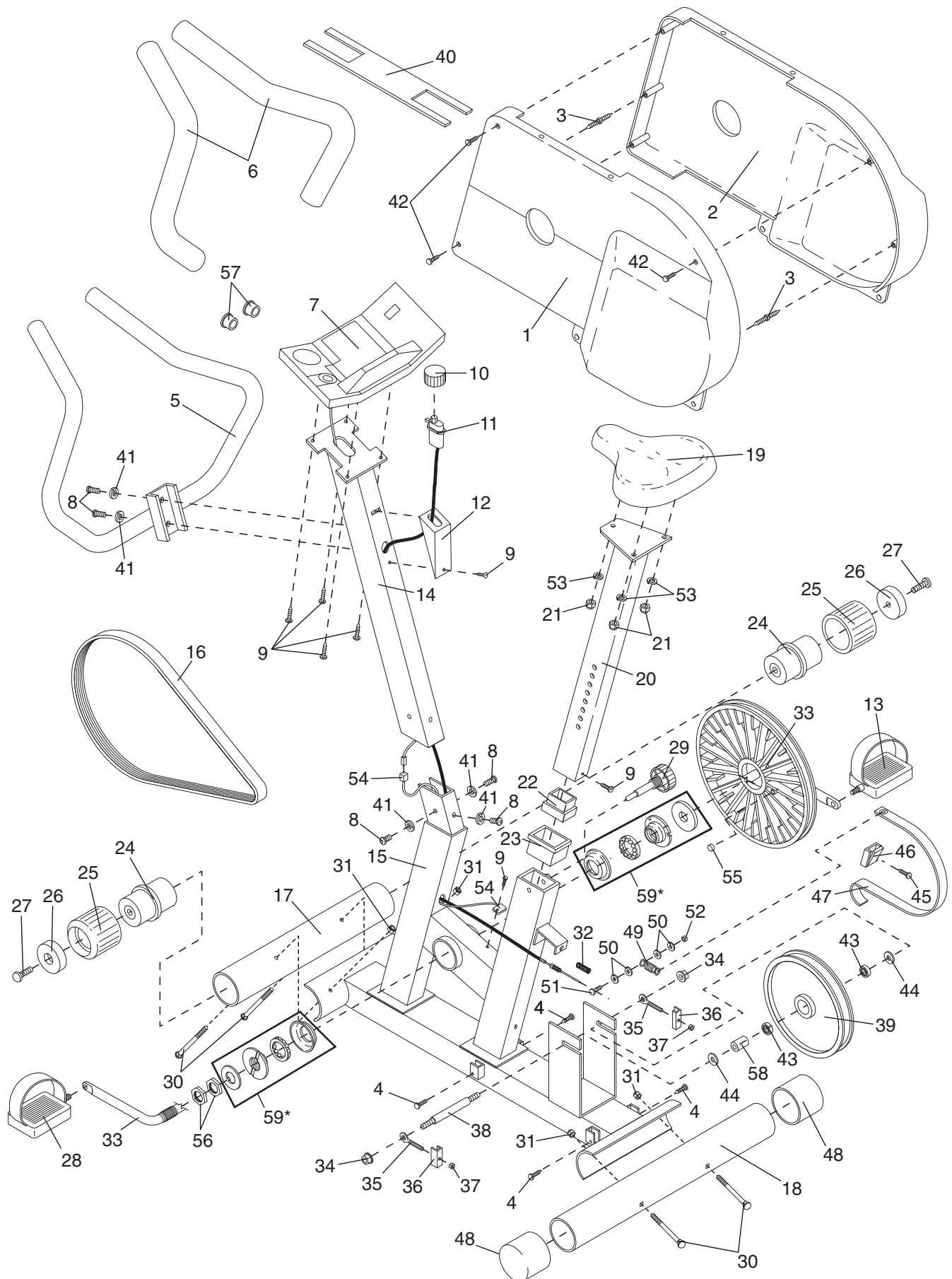

HOW TO ORDER REPLACEMENT PARTS

To order replacement parts, simply call our Customer Service Department toll-free at 1-888-936-4266, Monday–Friday, 8:00 am–6:30 pm EST (excluding holidays). To help us assist you, please be prepared to give the following information when calling:

- The MODEL NUMBER of the product (WLCCEX69571)
- The NAME of the product (WESLO® PURSUIT 795i)
- The SERIAL NUMBER of the product (see the front cover of this manual)
- The KEY NUMBER and DESCRIPTION of the part(s) (see the PART LIST on page 14 of this manual).

CUSTOMER RECORD

Serial No.: _____ Purchase Date: _____

Retailer Name: _____ Retailer Address: _____

**PLACE
STAMP
HERE**

ICON of Canada Inc.
900 de l'Industrie
St-Jérôme, Québec
Canada, J7Y 4B8

LIMITED WARRANTY

ICON OF/DU CANADA INC., (ICON), warrants this product to be free from defects in workmanship and material, under normal use and service conditions, for a period of ninety (90) days from the date of purchase. This warranty extends only to the original purchaser. ICON's obligation under this warranty is limited to replacing or repairing, at ICON's option, the product at one of its authorised service centres. All products for which warranty claim is made must be received by ICON at one of its authorised service centres with all freight and other transportation charges prepaid, accompanied by sufficient proof of purchase. All returns must be pre-authorised by ICON. This warranty does not extend to any product or damage to a product caused by or attributable to freight damage, abuse, misuse, improper or abnormal usage or repairs not provided by an ICON authorised service centre, to products used for commercial or rental purposes, or to products used as store display models. No other warranty beyond that specifically set forth above is authorised by ICON.

ICON is not responsible or liable for indirect, special or consequential damages arising out of or in connection with the use or performance of the product or damages with respect to any economic loss, loss of property, loss of revenues or profits, loss of enjoyment or use, costs of removal, installation or other consequential damages of whatsoever nature. Some provinces do not allow the exclusion or limitation of incidental or consequential damages. Accordingly, the above limitation may not apply to you. The warranty extended hereunder is in lieu of any and all other warranties and any implied warranties of merchantability or fitness for a particular purpose is limited in its scope and duration to the terms set forth herein. Some provinces do not allow limitations on how long an implied warranty lasts. Accordingly, the above limitation may not apply to you.

This warranty gives you specific legal rights. You may also have other rights which vary from province to province or so specified by the retailer of your equipment.

ICON OF/DU CANADA, 900 de l'Industrie, St. Jérôme, QC J7Y 4B8

 WEIDER PRO-FORM WESLO <small>of/du Canada Inc.</small>		PRODUCT WARRANTY REGISTRATION	
IMPORTANT: MAIL WITHIN 14 DAYS OF PURCHASE			
NAME: _____		PHONE: _____	
ADDRESS: _____			
COUNTY: _____		POSTCODE: _____	
MODEL NO. _____	SERIAL NO. _____	PURCHASE DATE: _____	
RETAILER NAME: _____		RETAILER ADDRESS: _____	
1) Primary user(s) of product: <input type="checkbox"/> Male <input type="checkbox"/> Female <input type="checkbox"/> Family	2) Age of primary user: <input type="checkbox"/> 0-24 <input type="checkbox"/> 35-44 <input type="checkbox"/> 55-64 <input type="checkbox"/> 25-34 <input type="checkbox"/> 45-54 <input type="checkbox"/> 65 and over	8) Did you consider purchasing fitness equipment from another manufacturer? <input type="checkbox"/> No <input type="checkbox"/> Yes What other Manufacturer? _____	9) Based on your impression of what you have purchased, would you buy another ICON product? <input type="checkbox"/> Yes <input type="checkbox"/> No <input type="checkbox"/> No Opinion If not, what other brand name equipment would you purchase? _____
3) Annual household income: <input type="checkbox"/> 0-9,999 <input type="checkbox"/> 15,000-19,999 <input type="checkbox"/> 10,000-14,999 <input type="checkbox"/> 20,000+	4) How many times a week do you exercise? <input type="checkbox"/> Less than 3 times <input type="checkbox"/> 3 times or more	10) What other type of exercise equipment do you own? <input type="checkbox"/> Bicycle <input type="checkbox"/> Exercise Cycle <input type="checkbox"/> Treadmill <input type="checkbox"/> Home Gym <input type="checkbox"/> Weight Bench <input type="checkbox"/> Stepper <input type="checkbox"/> Cardio Glide <input type="checkbox"/> Other	11) Which type of magazines do you read regularly? <input type="checkbox"/> Sports <input type="checkbox"/> Fitness <input type="checkbox"/> Motoring <input type="checkbox"/> Business <input type="checkbox"/> Computer <input type="checkbox"/> General
5) Have you ever purchased a ICON product before? <input type="checkbox"/> Yes <input type="checkbox"/> No	6) Where did you first see or hear about ICON products? <input type="checkbox"/> Magazine <input type="checkbox"/> Friend/relative <input type="checkbox"/> Newspaper Ad <input type="checkbox"/> Store <input type="checkbox"/> Other	12) Do you wish to be sent further bulletins about ICON products? <input type="checkbox"/> Yes <input type="checkbox"/> No	
7) What was the primary reason for purchasing this ICON product? <input type="checkbox"/> Store Employee <input type="checkbox"/> Television Ads <input type="checkbox"/> Colour <input type="checkbox"/> Electronic Features <input type="checkbox"/> Magazine Ads <input type="checkbox"/> Price <input type="checkbox"/> Product Design <input type="checkbox"/> Product Innovation <input type="checkbox"/> Other Features	THANK YOU FOR YOUR TIME		
© 2000 ICON of Canada, Inc. Printed in US			

WESLO® is a registered trademark of ICON Health & Fitness, Inc.

Free Manuals Download Website

<http://myh66.com>

<http://usermanuals.us>

<http://www.somanuals.com>

<http://www.4manuals.cc>

<http://www.manual-lib.com>

<http://www.404manual.com>

<http://www.luxmanual.com>

<http://aubethermostatmanual.com>

Golf course search by state

<http://golfingnear.com>

Email search by domain

<http://emailbydomain.com>

Auto manuals search

<http://auto.somanuals.com>

TV manuals search

<http://tv.somanuals.com>