

# COFFEE GRINDER

---



MODEL WST2006ZE

**OWNER'S MANUAL**



**Westinghouse**

# IMPORTANT SAFEGUARDS

When using electrical appliances, basic safety precautions should always be followed including the following:

1. Read all instructions.
2. To protect against risk of electrical shock do not put cord, plugs, or appliance in water or other liquid.
3. Close supervision is necessary when any appliance is used by or near children.
4. Unplug from outlet when not in use, before putting on or taking off parts, and before cleaning.
5. Avoid contacting moving parts.
6. Do not operate any appliance with a damaged cord or plug or after the appliance malfunctions, or is dropped or damaged in any manner. Contact Consumer Service for examination, repair or electrical or mechanical adjustment.
7. The use of attachments not recommended or sold by the manufacturer may cause fire, electric shock or injury.
8. Do not use outdoors.
9. Do not let cord hang over edge of table or counter.
10. Do not let cord contact hot surface, including the stove.
11. Check hopper for presence of foreign objects before using.

## SAVE THESE INSTRUCTIONS

**For Household Use Only**

# ADDITIONAL IMPORTANT SAFEGUARDS

1. All users of this appliance must read and understand this Owner's Manual before operating or cleaning this appliance.
2. The cord to this appliance should be plugged into a 120V AC electrical outlet only.
3. Do not leave this appliance unattended during use.
4. If this appliance begins to malfunction during use, immediately turn the unit OFF and unplug the cord. Do not use or attempt to repair the malfunctioning appliance.
5. IF this appliance falls or accidentally becomes immersed in water, unplug it immediately. **Do not reach into the water!** Do not use this appliance after it has fallen into or becomes immersed in water.
6. To reduce the risk of injury to persons or property, never use this appliance in an unstable position.
7. Do not use this appliance for other than its intended use.

## **POLARIZED PLUG**

This appliance has a polarized plug (one blade is wider than the other). To reduce the risk of electric shock, this plug is intended to fit into a polarized outlet only one way. If the plug does not fit fully in the outlet, reverse the plug. If it still does not fit, contact a qualified electrician. Do not attempt to modify the plug in any way.

## **SHORT CORD INSTRUCTIONS**

A short power-supply cord (or detachable power-supply cord) is provided to reduce the risk resulting from becoming entangled in or tripping over a longer cord.

Longer detachable power-supply cords or extension cords are available and may be used if care is exercised in their use.

If a longer detachable power-supply cord or extension cord is used, (1) the marked electrical rating of the cord set or extension cord should be at least as great as the electrical rating of the appliance, and (2) the cord should be arranged so that it will not drape over the countertop or tabletop where it can be pulled on by children or tripped over unintentionally.

## **ELECTRIC POWER**

If the electrical circuit is overloaded with other appliances, your appliance may not operate properly. It should be operated on a separate electrical circuit from other appliances.

# GETTING TO KNOW YOUR WESTINGHOUSE WST2006ZE COFFEE GRINDER

PRODUCT MAY VARY SLIGHTLY FROM ILLUSTRATION

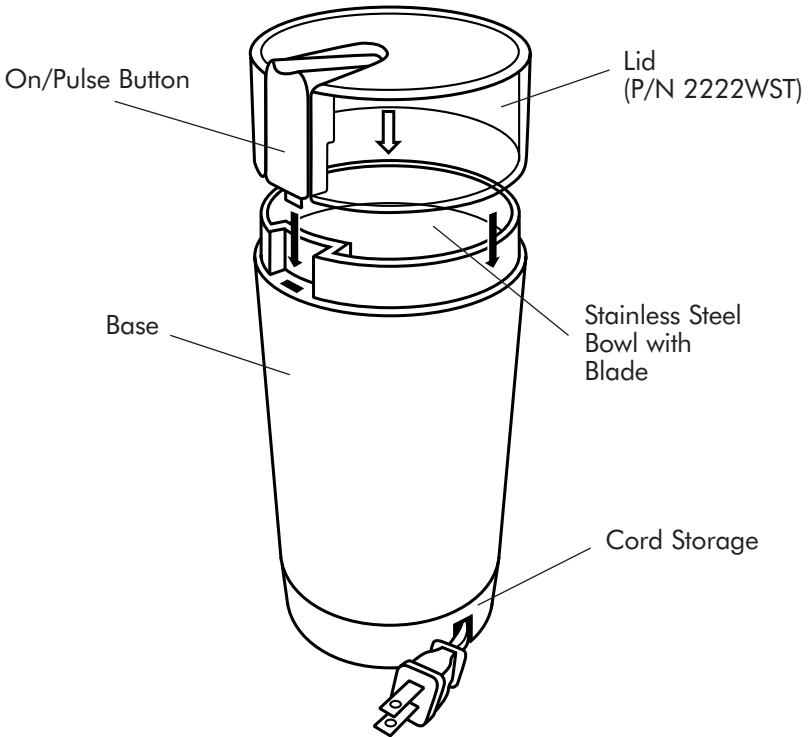

**Figure 1**

## BEFORE USING FOR THE FIRST TIME

1. Remove all packaging materials before using.
2. Before using, wipe blades and stainless steel bowl with a damp lint-free cloth, wash and dry lid (see CARE AND CLEANING).

**CAUTION: BLADES ARE SHARP. HANDLE CAREFULLY.**

**CAUTION: NEVER PLACE BASE OF APPLIANCE IN WATER OR OTHER LIQUIDS.**

## OPERATING INSTRUCTIONS

1. Place up to  $\frac{3}{4}$  cup of coffee beans at a time into the stainless steel bowl. If a larger quantity is needed, grind in several small batches.
2. Place the lid on top of the base (see Figure 1).

NOTE: The appliance will not operate unless the Lid is correctly placed on the base.

**CAUTION: DO NOT ATTEMPT TO OPERATE WITHOUT THE LID PROPERLY IN PLACE.**

3. Plug into 120 V ~ 60 Hz outlet.
4. To start grinder, depress the on/pulse button for 10-30 seconds until the beans are finely ground (see Figure 2). Grinding time will vary with capacity and personal preference. Do not operate for more than 60 seconds at a time.
5. When finished grinding, unplug the base.
6. Wait until the blades stop rotating, then remove lid.
7. Remove ground coffee from stainless steel bowl.



**Figure 2**

## **HINTS FOR GRINDING COFFEE BEANS**

1. Most beans require only 10-30 seconds to grind.
2. The maximum capacity of approximately  $\frac{3}{4}$  cup of coffee beans will yield ground coffee for 10-12 cups of brewed coffee.
3. Store coffee beans in an airtight container inside the freezer for up to two months—coffee beans can be ground while frozen.

## **GRINDING HERBS, SPICES, AND NUTS**

Use your grinder for grinding most herbs, spices, and nuts. They will have more flavor when freshly ground. Follow directions for grinding coffee beans and grind for 5-10 seconds. For large pieces, pulse the grinder. You may want to consider purchasing a separate grinder for herbs, spices and nuts since the flavor of the coffee may be affected.

## **HINTS FOR GRINDING HERBS, SPICES AND NUTS**

1. Do not attempt to grind anything oily or extremely hard such as chocolate, cinnamon, whole cloves or nutmeg.
2. Do not use to puree soft foods or attempt to make pastes from seeds, such as sesame or sunflower.
3. Do not attempt to grind grains such as corn, wheat, rice, rye, or barley.
4. Rinse and pat dry herbs before grinding.

# USER MAINTENANCE INSTRUCTIONS

This appliance requires little maintenance and contains no user serviceable parts. Do not try to fix it yourself. Refer it to a qualified repair technician if servicing is needed.

## CARE AND CLEANING

Remove all excess grounds from the stainless steel bowl to prevent stale coffee grounds from affecting the flavor of freshly ground beans.

1. Unplug the grinder.
2. Remove Lid, wash in warm sudsy water, rinse and dry thoroughly.

**CAUTION: BLADES ARE SHARP. HANDLE CAREFULLY.**

**CAUTION: NEVER PLACE BASE OF APPLIANCE IN WATER OR OTHER LIQUIDS.**

3. Use a stiff brush to remove any remaining coffee grinds or other ground food from inside the stainless steel bowl.
4. Clean exterior of base with a soft damp cloth and dry. Place lid on base for storing.
5. Turn upside down and wrap cord around cord storage on inside of base (see Figure 3).

**Any servicing requiring disassembly other than the above cleaning must be performed by an authorized service center.**

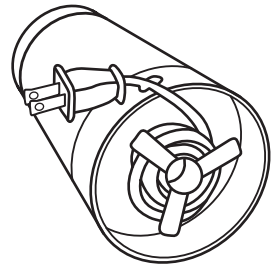

**Figure 3**



# NOTES

## LIMITED ONE-YEAR WARRANTY

**Warranty Coverage:** This product is warranted to be free from defects in materials or workmanship for a period of one (1) year from the original purchase date. This product warranty is extended only to the original consumer purchaser of the product and is not transferable. For a period of one (1) year from the date of original purchase of the product, our Repair Center will, at its option, either (1) repair the product or (2) replace the product with a reconditioned comparable model. These remedies are the purchaser's exclusive remedies under this warranty.

**Warranty Service:** To obtain warranty service, you must call our warranty service number at 1-800-233-9054 for return instructions on how to deliver the product, in either the original packaging or packaging affording an equal degree of protection to the Repair Center specified below. You must enclose a copy of your sales receipt or other proof of purchase to demonstrate eligibility for warranty coverage.

**To return the appliance, ship to:**

ATTN: Repair Center  
708 South Missouri Street  
Macon, MO 63552 USA

**To contact us, please write to, call, or email:**

Consumer Relations Department  
PO Box 7366  
Columbia MO 65205-7366 USA  
1-800-233-9054  
E-mail:  
consumer\_relations@toastmaster.com

**What Is Not Covered:** This warranty does not cover damage resulting from misuse, accident, commercial use, improper service or any other damage caused by anything other than defects in material or workmanship during ordinary consumer use. This warranty is invalid if the serial number has been altered or removed from the product. This warranty is valid only in the United States and Canada.

**LIMITATION ON DAMAGES:** THERE SHALL BE NO LIABILITY FOR ANY INCIDENTAL OR CONSEQUENTIAL DAMAGES FOR BREACH OF ANY EXPRESS OR IMPLIED WARRANTY OR CONDITION ON THIS PRODUCT.

**DURATION OF IMPLIED WARRANTIES:** EXCEPT TO THE EXTENT PROHIBITED BY APPLICABLE LAW, ALL IMPLIED WARRANTIES AND CONDITIONS, INCLUDING, WITHOUT LIMITATION, IMPLIED WARRANTIES AND CONDITIONS OF MERCHANTABILITY AND FITNESS FOR A PARTICULAR PURPOSE OR USE ON THIS PRODUCT ARE LIMITED IN DURATION TO THE DURATION OF THIS WARRANTY.

Some jurisdictions do not allow the exclusion or limitation of incidental or consequential damages, or allow limitations on how long an implied warranty lasts, so the above limitations or exclusions may not apply to you. This warranty gives you specific legal rights and you may have other rights under the laws of your jurisdiction.

For more information on our products, visit our website: [www.maxim-toastmaster.com](http://www.maxim-toastmaster.com).

## Free Manuals Download Website

<http://myh66.com>

<http://usermanuals.us>

<http://www.somanuals.com>

<http://www.4manuals.cc>

<http://www.manual-lib.com>

<http://www.404manual.com>

<http://www.luxmanual.com>

<http://aubethermostatmanual.com>

Golf course search by state

<http://golfingnear.com>

Email search by domain

<http://emailbydomain.com>

Auto manuals search

<http://auto.somanuals.com>

TV manuals search

<http://tv.somanuals.com>