

# WH-DFS

DIFFUSE SURROUND SPEAKER



*Wharfedale*  
BRITAIN'S MOST FAMOUS LOUDSPEAKERS

User's Manual

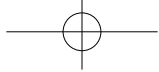

# WH-DFS Loudspeaker Instruction Manual

## INTRODUCTION

The WH-DFS speakers are bipolar units designed for use solely as rear effects speakers.

In a Home Theatre system, the directional cues come from the front and centre channels. The rear channels provide ambience and rear perspective and for this purpose a bipolar design with its mix of direct and reflected sound is ideal.

Before installing your loudspeakers please read these instructions in full.

## UNPACKING

Carefully unpack each component taking care not to mark the surface. Inspect the product and report any damage immediately to your dealer. Retain the packing so that the product may be safely shipped in the future.

## IMPORTANT DO'S AND DON'TS

**WARNING:** To reduce the risk of fire or electrical shock do not expose to this products to rain or moisture. The product must not be exposed to dripping and splashing and no object filled with liquids such as a vase of flowers should be placed on the product.

DO NOT allow foreign objects to fall into the units.

NO naked flame sources, such as lighted candle must be placed on the products.

NEVER remove any components and refer all servicing to qualified personnel.

DO NOT change any connections before your system is switched off.

DO NOT use your amplifier at its maximum volume setting. The resulting high levels of distortion may damage your loudspeakers.

DO turn down the volume control on your amplifier or receiver before turning the equipment on or off.

The product should be mounted to a wall or ceiling only as recommended by the manufacturer.

## PREPARATION

Each speaker is supplied with four self-adhesive spacers. Apply on to each rear corner before mounting the unit.

## CHOOSING AND PREPARING CABLES

Specialist audio cable offers better performance than general purpose 'zip' or 'bell' wire. Choose a cable of suitable diameter- cable that is too thin will limit the dynamics of the sound and may impair the bass response. Audio cable is polarised, with two cores of different colours or often a raised rib or coloured tracer in the case of twin cable. Split the cable at each end to a depth of 25mm. Strip about 7mm of insulation from each end and lightly twist to gather the wire stands.

When connecting cables, ensure that there are no loose stands which may touch adjacent terminals.

## CONNECTIONS

The WH-DFS speakers connect to the 'Rear' or 'Rear Surround' terminals of your AV amplifier or processor.

You will need one length of twin core cable per speaker. Connect the Red (+) terminal of the left rear unit to the Red (+) terminal of the amplifier's left rear channel output. Connect the Black (-) terminal of this unit to the corresponding Black (-) terminal of the amplifier. Repeat for the Right speaker. The connection panel uses screw terminals - the drawing illustrates the connection.

## MOUNTING

Connect the cable to the speaker. The speaker should ideally be sited 0.6-1.5 metres above the listening position and 2.5-3.5 metres apart, central to the listener and behind the listening position, preferably on a rear wall. If the listening position is some distance from a rear wall, the loudspeakers may be mounted on opposite side walls but always behind the listening position.

Ensure that the wall is sound and can support the product. Drill two 5mm holes in the wall 200mm apart and horizontally aligned. Fix a suitable No.8 round head screw firmly into each hole using appropriate wall plugs. Leave a stub of 5mm protruding from the wall.

Align the holes in the mounting brackets over the screw heads and carefully lower the unit onto the screws. The speaker should now be securely attached with the spacers resting against the wall. Now connect the speakers to the amplifier.

Note: As an alternative, the WH-DFS can be shelf or stand mounted. The badge on the WH-DFS can rotate to match the orientation of the loudspeaker.

## LOUDSPEAKER SIZES

Many digital AV Processors require you to specify the size of speakers in various channels. These are usually 'Large' or 'Small'. You must select 'Small' for the rear channels. Selecting 'Large' may degrade the performance of the WH-DFS. Set the subwoofer option on the processor to 'On' or 'Yes'. This will route all the deep bass to the subwoofer.

## CONNECTING WIRES

When wall mounting a loudspeaker the connecting cables may be unacceptably obvious. It may be less obtrusive to route cables from the loudspeaker to the ceiling and then within or underneath the ceiling or coving. The cable may return to floor level at a convenient room corner.

## CARE AND MAINTENANCE

NEVER touch the drive units which can be easily damaged. The loudspeaker cabinet can be cleaned with a damp cloth or with a spray furniture polish and a soft cloth. Apply the spray sparingly to the cloth and then polish the cabinet. NEVER apply spray directly to the cabinet.

Please refer to the relevant drawing on the facing page for guidance and further information.

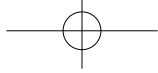

### WH-DFS Loudspeaker Connections

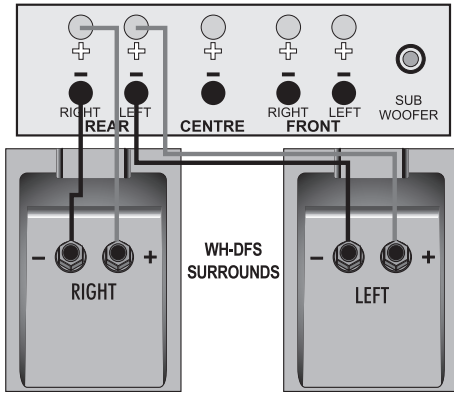

Preparing Speaker Cables

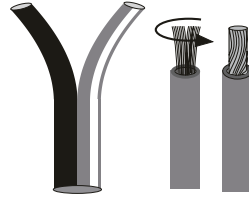

Connecting Speaker Cables

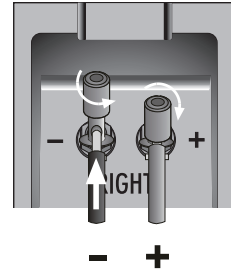

**IMPORTANT NOTE:**

It is not possible to bi-wire.

Do not ever connect both the left and right channels from your amplifier to one loudspeaker.

### Wall Mounting the WH-DFS Surrounds

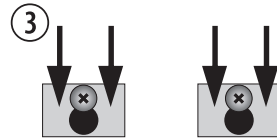
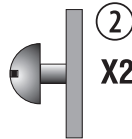
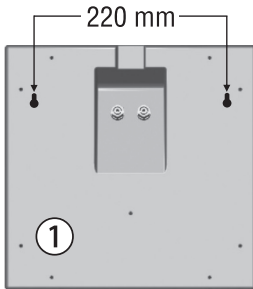

System with Mounted WH-DFS Surrounds

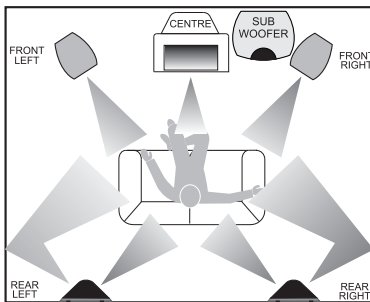

System with Side WH-DFS Surrounds

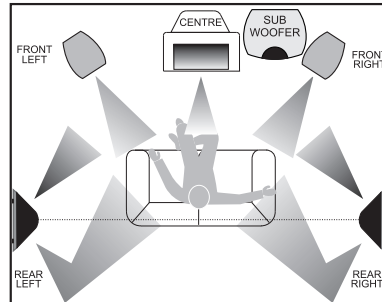



## Specifications

### WH-DFS Diffuse Surround Speaker

<b>Format</b>	Surround
<b>Bass</b>	2 x 100mm
<b>Tweeter</b>	2 x 25mm Dome
<b>Power Handling (Programme)</b>	15 - 200W
<b>Impedance</b>	6 Ohms
<b>A/V Shielded</b>	No
<b>Sensitivity (2.83V @1M)</b>	86 dB
<b>Frequency Range</b>	70 - 24kHz
<b>HF Limit (-10dB)</b>	44kHz
<b>Crossover Frequency</b>	3.5kHz
<b>System Frequency</b>	80Hz
<b>Dimensions (H x W x D)</b>	280mm x 290mm x 132mm

## Service

Items requiring service should be returned to the supplying dealer.  
In the event of any difficulties, contact the distributor for your area.

### UK

International Audio Group  
Unit 4, St Margaret's Way  
Stukeley Meadows Industrial Estate  
Huntingdon, Cambs, PE29 6EB  
Tel: +44 (0)1480 447700  
Fax: +44 (0)1480 431767

The name 'WHARFEDALE' is a registered trademark of  
Wharfedale International Limited.  
Wharfedale has a policy of continuous product development and reserves the  
right to change specification without notice.  
Wharfedale is a member of the International Audio Group.

*Wharfedale*

IAG House, Sovereign Court, Ermine Business Park, Huntingdon, Cambs, PE29 6XU, UK  
Tel: +44(0)1480 447700 Fax: +44(0)1480 431767 <http://www.wharfedale.co.uk>  
IAG reserves the right to alter the design and specifications without notice. All rights reserved © IAG Group Ltd.  
Wharfedale is a member of the International Audio Group. CODE: WH11-MNL0014b

## Free Manuals Download Website

<http://myh66.com>

<http://usermanuals.us>

<http://www.somanuals.com>

<http://www.4manuals.cc>

<http://www.manual-lib.com>

<http://www.404manual.com>

<http://www.luxmanual.com>

<http://aubethermostatmanual.com>

Golf course search by state

<http://golfingnear.com>

Email search by domain

<http://emailbydomain.com>

Auto manuals search

<http://auto.somanuals.com>

TV manuals search

<http://tv.somanuals.com>