

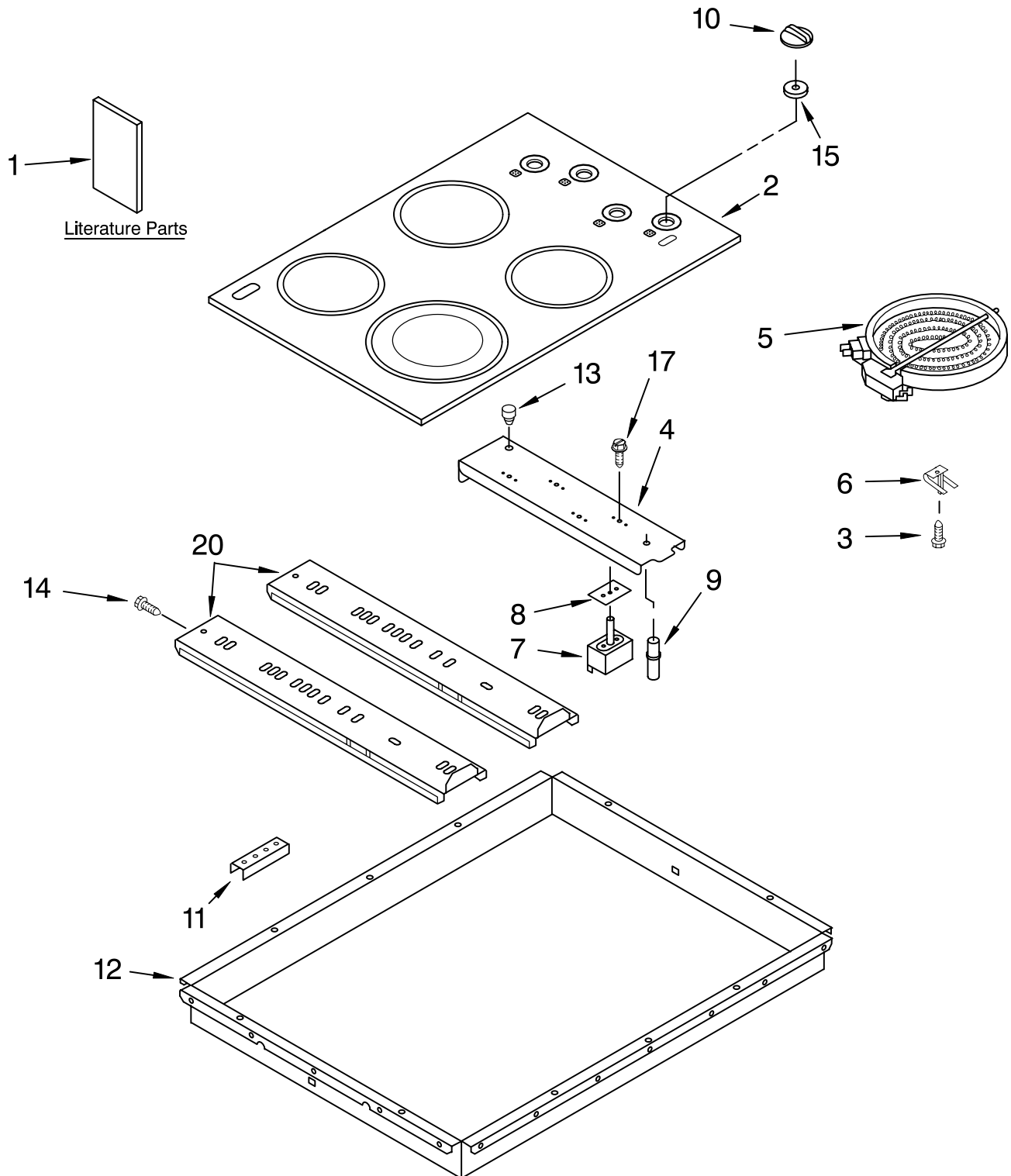

COOKTOP PARTS

For Models: GJC3034HB4, GJC3034HQ4, GJC3034HT4, GJC3034HP4
(Black) (White) (Biscuit) (Designer White)

30" ELECTRIC
BUILT-IN COOKTOP



FOR ORDERING INFORMATION REFER TO PARTS PRICE LIST

COOKTOP PARTS

For Models: GJC3034HB4, GJC3034HQ4, GJC3034HT4, GJC3034HP4
(Black) (White) (Biscuit) (Designer White)

| Illus. No. | Part No. | DESCRIPTION | Illus. No. | Part No. | DESCRIPTION | Illus. No. | Part No. | DESCRIPTION |
|------------|------------|--|------------|----------|-----------------------------|------------|----------|-------------------------|
| 1 | LIT4455836 | Literature Parts Installation Instructions | 4 | 3191310 | Bracket, Switch Mounting | 9 | 3191952 | Light, Indicator |
| | LIT8284862 | Use & Care Guide | 5 | 8272567 | Element, Surface 1200W – LR | 10 | 3196231 | Knob, Control (4) Black |
| | LIT3191773 | Wiring Diagram | | 8272564 | 1500W – RF | | 3196232 | White |
| | LIT3191638 | Safer Cooking Tips | | 8272566 | 1800W – RR | | 8272506 | Biscuit |
| 2 | | Cooktop & Bracket Assembly | | 8272563 | 1000/2400W – LF | 11 | 3183401 | Bracket, Mounting |
| | 4455568 | Black | 6 | 3191791 | Spring, Locator (8) | 12 | 4456401 | Box, Burner |
| | 4455569 | White | 7 | | Switch, Infinite | 13 | 3191953 | Bumper, Silicone |
| | 4455567 | Biscuit | | 3191050 | Use W/RR Burner | 14 | 3196537 | Screw |
| | 8284839 | White on White | | 3188516 | Use W/LF Burner | 15 | 3182435 | Seal, Switch Shaft (4) |
| 3 | 246119 | Screw (8) | | 3191049 | Use W/RF & LR Burners | 17 | 311865 | Screw |
| | | | 8 | 3192439 | Seal, Switch Cover | 20 | 3191515 | Rail, Element |
| | | | | | | | 3192737 | Seal, Heat |
| | | | | | | | 3183956 | Seal, Switch Cover |

MISCELLANEOUS PARTS

| Illus. No. | Part No. | DESCRIPTION | Illus. No. | Part No. | DESCRIPTION | Illus. No. | Part No. | DESCRIPTION |
|--|----------|----------------------|-------------------------------------|----------|----------------------------|-----------------------------|----------|-----------------------------|
| Following Parts Not Illustrated | | | SPLICING WIRES--25FT. LENGTH | | | ACCESSORY PARTS | | |
| | 3172515 | Mtg. Hardware Kit | | 242828 | Wire, Black 12 Ga. 150° C | | 3191048 | Cleaner |
| | 4455364 | Bracket, Support (6) | | 242820 | Wire, Black 14 Ga. 150° C | WIRING HARNESS PARTS | | |
| | | | | 242822 | Wire, Blue 14 Ga. 150° C | | 4455281 | Wiring Harness Surface Unit |
| | | | | 242830 | Wire, Brown 14 Ga. 200° C | | 3192170 | Harness, Conduit |
| | | | | 242823 | Wire, Green 14 Ga. 150° C | | 3400015 | Screw, 10–32 x 3/8 |
| | | | | 242824 | Wire, Orange 14 Ga. 150° C | | | |
| | | | | 242829 | Wire, Red 12 Ga. 150° C | | | |
| | | | | 242825 | Wire, Red 14 Ga. 150° C | | | |
| | | | | 242831 | Wire, Red 14 Ga. 200° C | | | |
| | | | | 242826 | Wire, White 14 Ga. 150° C | | | |
| | | | | 242827 | Wire, Yellow 14 Ga. 150° C | | | |
| | | | | 242832 | Wire, Yellow 14 Ga. 200° C | | | |

FOR ORDERING INFORMATION REFER TO PARTS PRICE LIST

Free Manuals Download Website

<http://myh66.com>

<http://usermanuals.us>

<http://www.somanuals.com>

<http://www.4manuals.cc>

<http://www.manual-lib.com>

<http://www.404manual.com>

<http://www.luxmanual.com>

<http://aubethermostatmanual.com>

Golf course search by state

<http://golfingnear.com>

Email search by domain

<http://emailbydomain.com>

Auto manuals search

<http://auto.somanuals.com>

TV manuals search

<http://tv.somanuals.com>