

OWNER'S MANUAL



WHISTLER 1640 LASER-RADAR DETECTOR



The Whistler Group Corporate Headquarters

13016 N. Walton Blvd. • Bentonville, AR 72712

Tel (479) 273-6012 • Fax (479) 273-2927

Customer Return Center

1201 N. Dixieland Rd. • Rogers, AR 72756

Customer Service Tel (800) 531-0004

If you have questions concerning the operation of this Whistler product please call:

CUSTOMER SERVICE

1-800-531-0004

Monday - Friday • 8:00 am - 5:00 pm CT

or visit our website

www.whistlergroup.com

Please keep the receipt in a safe place. You may register your product online at www.whistlergroup.com. For warranty verification purposes, a copy of your dated store receipt must still accompany any unit sent in for warranty work. If the unit is returned without a dated store receipt an out of warranty service charge applies. **Note:** Your warranty period begins at the time of purchase. The warranty is validated **only** by the dated store receipt! Now is the time to record the serial number of the unit in the space provided in the warranty section of the manual.

INTRODUCTION

Dear Whistler Owner,

For many of us, a vehicle is more than just transportation. It can be a mobile office, communications or entertainment center, or simply an expression of our personality. Whistler products are designed to make the time you spend in your vehicle more productive, more fulfilling, safer, or just simply more fun. Our mission is to provide products that improve your driving experience.

Your new Whistler 1640 laser/radar detector detects all radar, laser and safety radar systems, plus offers Whistler's exclusive Safe Driving System with Real Voice™ technology, Vehicle Battery Saver, and Digital Compass Features. The comprehensive safety system detects all safety radar including the Safety Warning System™ keeping you informed of road hazards and adverse weather. Plus, Whistler's unique Stay Alert™ feature tests driver's alertness on long solo trips. **Note: Compass must be calibrated before use! See "Compass Calibration Set-Up" Section.**

To fully acquaint yourself with the operation of the Whistler 1640 and to better understand the differences between detecting radar, laser and safety radar signals, we recommend reading this entire manual or visit our FAQ page on our website www.whistlergroup.com

Enjoy the Whistler 1640 and please drive safely.

Sincerely,

The Whistler Group

TABLE OF CONTENTS

Topic	Page
Model Features Summary	3 - 5
Installation	5 - 7
• Mounting Guidelines	
• Visor/Windshield Mounting	
• Power Connection And Fuse Replacement	
Compass Calibration Set-Up	8
Operation	9 - 15
• Power On And Self-Test	
• Self-Test Mute	
• Integrated Real Voice™	
• Feature Engaged Confirmation	
• Audio Level Adjustment	
• Auto Quiet/Quiet Mode	
• City Modes	
• Dim/Dark Mode	
• Engaging/Disengaging VG-2 Detection	
• Option Select Mode	
• Teach/Tutorial Mode	
• Vehicle Battery Saver Mode	
Radar, Laser And VG-2 Alerts	16 - 20
• Radar Alerts / Pulse Protection®	
• Safety Warning Systems™	
• Laser Audio/Visual Alerts	
• VG-2 Audio/Visual Alerts	
• Alert Priority	
• Reset Features	
• Care Maintenance	
Troubleshooting Guide	21
Are Detectors Legal?	22
Speed Monitoring Technologies	22 - 24
• Radar Facts	
• Laser Facts	
• Other Speed Detection Systems	
• Radar Detector Detectors	
Warranty Information	25 - 27
Specifications	28
Accessories	29

WHISTLER FEATURES

Whistler 1640



Whistler's ergonomic and user-friendly design provides a new level of operating convenience.

Special Features Include:

- 1. Bracket Release Button** – Provides quick and easy release of the mounting bracket.
- 2. Power Jack** – Provides connection for the power cord.
- 3. Speaker** – Provides distinct audio and Real Voice™ warnings for X, K, Ka band radar, safety radar, laser and VG-2.
- 4. Power / Dim / Dark Button** – Turns unit on/off and engages Dim/Dark modes (*press and hold for 2 seconds*).
- 5. Volume Up / Down Buttons** – Adjust volume up or down. Pressing both buttons enters Compass Calibration.

3

WHISTLER FEATURES

- 6. High Visibility Display** – Provides distinct visual confirmation of signals detected, signal strength, and indicates engaged modes of operation.
 - 7. Quiet / Menu Button** – Pressing QUIET before a signal is detected engages Auto Quiet Mode which automatically reduces the audio level after the initial warning to a low audio level setting. Pressing QUIET during a radar-laser encounter silences audio alerts, while allowing visual alerts to keep you informed. Pressing and holding for 2 seconds allows you to enter Option Select Mode (*see page 15*).
 - 8. City / City 1 / City 2 Button** – Reduces the annoyance of false alerts typically encountered in urban driving areas.
 - 9. Laser Antenna (Rear)** – An integrated optical waveguide provides superior detection of laser signals transmitted from behind.
-
- 10. Laser Antenna (Front)** – High gain optical lens provides increased sensitivity and field of view for leading-edge laser detection.
 - 11. Radar Antenna** – Compact, high-efficiency antenna receives radar signals.
 - 12. Mounting Bracket Location** – Slot holds mounting bracket firmly.

4

WHISTLER FEATURES

Accessories – Accessories included are highly functional and easy to use.

Power Cord – Connects to the unit power jack and your vehicle's lighter socket.

Windshield Bracket – Allows installation of unit on your vehicle's windshield.

INSTALLATION

Mounting Guidelines

- Mount the unit as low as possible near the center of the windshield. Unit must be level for compass to function properly.
- Do not mount your unit behind wipers, ornaments, mirrored sunscreens, etc. These obstructions have metal surfaces which can affect radar and laser signals and reduce critical warning time. (*Regular tinted glass does not affect reception.*)
- Some windshields have an Instaclear™ or Electriclear™ type coating, which affect radar signals. Consult your dealer or the owner's manual supplied with your vehicle to determine if your windshield has this coating.
- Avoid placing unit in direct contact with windshield.
- To reduce the possibility of theft, conceal your unit when not in use.

5

Windshield Mounting

- Install the two suction cups and rubber bumper onto the bracket by fitting them into their holes.
- Press the suction cups onto the windshield at the location you have chosen. **IMPORTANT:** Some newer cars have a plastic safety coating on the inside of the windshield. The suction cups may leave permanent marks on this type of surface. To find out if your vehicle has this type of windshield, check the owner's manual or ask your dealer. We recommend that you do not leave the suction cup bracket on the window in direct sunlight. If the detector is removed, this may cause blistering of the dash in some vehicles.

Visor Mounting (optional accessory)

- Slide the visor bracket into the bracket mounting slot.
- Slip the visor bracket onto the visor making sure it is relatively level and has a clear view of the road.

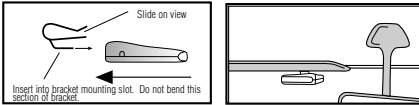

Power Connection

- Plug the small end of the power cord into the units power jack.
- Plug the large end into the vehicle's cigarette lighter.

6

Fuse Replacement

The lighter socket plug is equipped with a replaceable 2 amp 3AG fuse located behind the silver tip. To replace the fuse, carefully unscrew the tip of the plug. **IMPORTANT: Unscrew slowly. The tip contains a spring which may fly out when disassembling.** Insert the new fuse with the spring and screw on the tip. **With use, screw cap on plug may loosen. Retighten occasionally.**

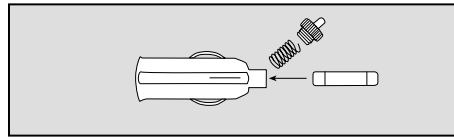

Unscrew the tip of the lighter socket plug carefully when replacing the 2 amp fuse.

7

Compass Calibration Set-Up

The unit will need to be calibrated in order for the compass to provide accurate readings. To calibrate the unit, perform the following procedure:

1. Mount the unit level in the center of the vehicle's windshield in which it will be used. Make sure there are no other magnetic sources near the detector (*i.e., speaker*).
2. Select a large clear area (*parking lot or field*) without any power lines.
3. While parked, press both volume buttons simultaneously until the compass headings start to rotate.
3. Drive vehicle slowly in two complete circles, in either direction. If calibration does not automatically finish press both volume buttons simultaneously to complete calibration. The unit will beep twice and show current compass heading.

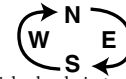

Note: If unit mounting is relocated in the vehicle, (*i.e. visor to windshield mounting or dash mounting*), or if the unit is moved to another vehicle, you must recalibrate the compass.

8

Power On And Self-Test

Each time your Whistler detector is turned on, an automatic self-test sequence confirms that the speaker and visual displays are functional.

- Press Power or apply Power. Display reads:

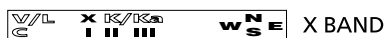

X BAND



K BAND



Ka BAND(Blinking)



LASER



HIGHWAY

Self-Test Mute

Simply press the Quiet button during the self-test sequence to cancel the self-test audio. This will not effect radar/laser alerts. To restore the self-test audio, simply press the Quiet button during the next self-test.

Integrated Real Voice

When selected, Real Voice will be used to articulate the following:

1. Band Identification
2. Safety Warning System message
3. Feature Selection

9

Memory/Beep Confirmation

All features selected (*except Stay Alert and Quiet*) are retained in memory. Each time a button is pressed one beep confirms feature "on", two beeps confirm feature "off".

Audio Level Adjustment

The audio levels can be adjusted high to low, or low to high, in seven steps:

- Press Volume up to increase audio level.
- Press Volume down to decrease audio level.

As audio level is adjusted, beeps are provided and the display indicates volume level.

Example:

LEVEL 6 Highest

LEVEL 5 #3 Blinking

Default - LEVEL 4 #2 Blinking

LEVEL 3 #2 Blinking

LEVEL 2 #1 Blinking

LEVEL 1 #1 Blinking

LEVEL 0 No Audio Level

10

Auto Quiet Mode

Auto Quiet reduces the selected audio level to a level (1) approximately 5 seconds after a radar or safety radar signal is detected. The alert for any new signal within 20 seconds will resume at level (1). Auto Quiet does not affect VG-2 or laser alerts.

- Press Quiet (*before a signal is detected*) to engage Auto Quiet. Unit will beep once.
- Once the Auto Quiet is engaged, you may cancel the audio alarm by pressing Quiet.
- Press Quiet (*when the unit is not alarming*) to cancel Auto Quiet mode. Unit will beep twice.

Quiet Mode

Quiet cancels audio during an alert and any new alert within 20 seconds. After 20 seconds, approximately 2 beeps are provided on any new alert and unit then remains quiet.

- Press Quiet to cancel the audio.
- Press Quiet a second time during an alert to restore the standard audio alert pattern; or turn the unit off, then on.

11

City / City 1 / City 2 Mode

Whistler's Three Stage City Mode is designed to reduce the annoyance of automatic door openers, intrusion alarms, and other devices which share frequencies with police radar.

- Press City to engage City. Display reads:



- Press City a second time engages City 1. Display reads:

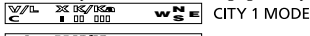

After 3 secs, turns off I LED

- Press City a third time engages City 2. Display reads:



After 3 secs, turns off II LED

- Press City a fourth time cancels City, City 1, and City 2. Display reads:



In City Mode, weak speed/safety radar signals give an initial alarm of two beeps, and then the unit remains quiet unless the signal strength increases, two additional beeps are provided. In City 1 Mode, only the X band sensitivity is lowered. In City 2 Mode, X-band is not detected.

CAUTION: Some towns/small cities may still be using X band radar. If Auto Quiet is engaged in City 1 or City 2 modes and the unit receives a strong radar signal, the unit performs the Auto Quiet feature. City Modes do not change the audio alert for laser of VG-2.

Dim/Dark Mode

Dim/Dark Mode reduces the illumination of the display.

- Press and hold Power for 2 seconds to reduce illumination to a Dim setting.



- Press and holding Power for 2 seconds a second time engages Dark Mode.



Dim or Dark can be engaged during an alert. In Dark Mode, the display goes dark for as long as a signal is being detected and for 20 seconds after, then the display returns to the dimmer setting.

- Pressing and holding power a third time restores full illumination to the display.

Engaging/Disengaging VG-2

See option select mode to turn this feature on.

Option Select Mode

Entering Option Select Mode allows you to turn on or off VG-2 detection or Voice alerts. Note: The unit must not be alarming.

To turn VG-2 detection on/off:

Press and hold the Quiet button until the unit provides a unique beep then release the Quiet button. Unit will say "VG-2" and the V/L light will illuminate briefly. If VG-2 detection is already on, the unit will provide a double beep to indicate VG-2 detection is turned off.

To turn Voice off/on:

Press and hold the Quiet button (*greater than 3 seconds*) until you hear a double beep then release the Quiet button. Voice alert is now off. If voice alert was already off, the unit will say "CAUTION".

Press Power anytime to exit.

Teach/Tutorial Mode

Provides simulated alerts for each type of signal.

- Press City and Quiet simultaneously and release.
- Press Power to exit.

Vehicle Battery Saver Mode

The Vehicle Battery Saver Mode automatically shuts off your detector within 6 hours if you forget to turn it off. The timer is reset if the detector is turned off, unplugged or any button is pressed before the 6 hours have expired. The detector will alert you with an audible and visual warning before it shuts off. Display shows:



During this warning you can momentarily reset the unit by pressing any button. This will reset the timer.

If the unit has automatically turned itself off, press the Power button to turn the unit back on. You can manually engage the Vehicle Battery Saver Mode by pressing and holding the City button until one beep is heard.

Speed Radar Audio / Visual Alerts

When X, K or Ka is detected the band ID and signal strength is displayed. The audio alert is continuous and has a geiger counter-like pattern. The faster the beep the closer or stronger the radar source. Example:

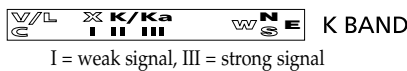

I = weak signal, III = strong signal

Pulse Protection®

When a pulse type signal (*instant on strong signal*) is detected an urgent 3 second audio warning is sounded and the display shows:

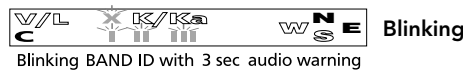

Blinking BAND ID with 3 sec audio warning

After 3 seconds standard alert pattern continues.

Safety Warning System™ / SWS

In communities where transmitters are located, the Safety Warning System alerts you with 60 voice messages. When Safety Radar is detected the audio alert is geiger counter-like.

Example:



Note: Not all areas have Safety Warning System™ transmitters. visit the Safety Warning System™ web page at www.safetyradar.com for SWS locations.

Laser Audio / Visual Alerts

When a laser signal is detected V/L and signal strength is displayed, the audio alert is continuous for a minimum of 3 seconds. Example:

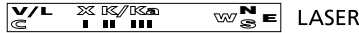

The more "III" the closer the laser source.

VG-2 Audio / Visual Alerts

Note: You must turn this feature on in option select mode before it will detect the VG-2 gun. When a VG-2 signal is detected, the detector "hides" its own radiated signal and becomes undetectable by the VG-2.



Every 30 seconds, the detector checks for a VG-2 signal. If a VG-2 signal is still present, the unit continues to hide and repeats the VG-2 alert. If no signal is detected, two beeps are provided, indicating an "all clear" condition. During VG-2 Alert X, K, and Ka band signals cannot be received. (Reference page 25 for VG-2 information.)

Alert Priority

When two or more signals are received at the same time, the alert priority is:

1. Laser
2. VG-2
3. Speed Radar
4. Safety Radar

Example: If X band is alerting, then suddenly VG-2 is detected, the VG-2 warning will override the X band alert.

Reset Features

All user features can be reset to factory settings.

- Unplug Power Cord from unit.
- Press and hold Power and Quiet.
- Plug Power Cord into unit.
- Wait for 2 beeps.
- Release Power and Quiet button. Unit is now reset.
 1. Audio to level (4).
 2. Highway Mode ON.
 3. Dim/Dark Mode to full illumination of display.
 4. Auto Quiet Mode OFF.
 5. VG-2 Detection Mode OFF.
 6. Voice ON.
 7. Battery Saver OFF.

Note: Must recalibrate compass after resetting detector.

CARE & MAINTENANCE

During the summer months, avoid prolonged exposure to direct sunlight by removing your unit from the dash when your vehicle is parked for an extended period of time.

Do not spray water, cleaners, or polishes directly onto the unit. The spray may penetrate through the openings and damage the unit. Also, do not use any abrasive cleaners on the units exterior.

Your Whistler detector is expertly engineered and designed to exacting quality standards to provide you with reliable, trouble-free operation. If your unit has been correctly installed following the guidelines in this manual, but is not operating optimally, please refer to the troubleshooting guide below.

PROBLEM: No display or audio.

- Check fuse in Whistler plug; replace if necessary with a 2 amp 3AG type.
- Check fuse for lighter socket; replace if necessary.
- Make sure lighter socket is clean.

PROBLEM: Unit alarms when vehicle hits bumps.

- Check for loose lighter socket; tighten and clean.
- Check connections at both ends of power cord. Substitute another cord to determine if cord is defective. Return defective cord to the factory.

PROBLEM: Unit alarms when using vehicle equipment, electrical accessories (brakes, power mirrors/windows, directionals, horn, etc.), or when accelerating.

- Vehicle's electrical system, including battery and alternator, may have electrical noise. Install a filter capacitor (470mfd. 25 volt or larger capacitance value) on the back of the lighter socket.

PROBLEM: Audio alerts are not loud enough.

- Cancel Auto Quiet Mode or City Mode.
- Check audio level setting (see page 10 & 11).

PROBLEM: No X band signals.

- Cancel City 2.

PROBLEM: Unit gives laser alert when accelerating.

- Possible bad or low quality distributor cap. Replace with high quality cap.

If difficulties occur which cannot be solved by information in this Troubleshooting Guide, please call Whistler Consumer Relations at 1-800-531-0004 before returning your unit for service.

ARE DETECTORS LEGAL?

SPEED MONITORING TECHNOLOGIES

SPEED MONITORING TECHNOLOGIES

In Most States YES!

Laser-radar detectors are legal in every state (with the exception of Virginia and Washington D.C., which have local regulations restricting the use of radar receivers in any vehicle) when used in automobiles or light trucks (under 10,000 lbs.).

Concerning trucks over 10,000 lbs., the Federal Highway Administration (FHWA) issued a regulation, effective January, 1944 which prohibits radar and laser detector use in the types of vehicles nationally.

Prior to the FHWA regulation, laws existed in the state of New York restricting the use of radar detectors in trucks over 18,000 lbs. and in Illinois in trucks over 26,000 lbs.

FCC ID HSXWH02

This device complies with part 15 of the FCC Rules.

Operation is subject to the following two conditions: (1)

This device may not cause harmful interference, and (2)

this device must accept any interference received, including interference that may cause undesired operation.

IMPORTANT

FCC requirements state that changes or modifications not expressly approved by Whistler could void the user's authority to operate the equipment.

Radar Facts

A radar gun operates by transmitting radio waves at certain frequencies which reflect off objects and are then picked up by the radar gun's receiving section. When a radar beam reflects off a moving target, a measurable frequency shift occurs. The radar unit converts this shift into miles per hour to determine your vehicle's speed. Currently, the FCC (Federal Communications Commission) permits operation to traffic radar guns at X Band (10.500 - 10.550 GHz), K Band (24.050 - 24.250 GHz), and Ka Band (33.400 - 36.000 GHz).

Note: A radar detector will not alarm if an officer is not transmitting on any one of the above radar bands.

Laser Facts

It's well documented that many radar guns cannot reliably provide the speed of a targeted vehicle that is traveling in a group of vehicles. In contrast, a laser gun can target a specific vehicle out of a line of traffic and determine its speed. The advantage of laser over radar in terms of target identification is the result of the laser gun's narrow beam. A radar transmission can cover more than a four-lane highway at a distance of 1,000 feet, compared with a laser transmission which covers about 6 feet at the same distance. For best protection, keep these points in mind:

- Because you vehicle's license plate or headlights are the laser gun's primary targets, mounting your Whistler detector on the dashboard can improve laser detection at short range.
- Do not follow closely behind any vehicle you cannot see through. If you can't see past a vehicle ahead of you, chances are your detector won't either.
- The receiving range of your laser detector will not be the same as a radar detector. Laser guns are most often used at short range.

Whistler Laser/Radar detectors receive all current laser guns which operate at a laser wavelength of 905 +/- 10mm.

- Pro Laser™ I II III
- LT1 20-20
- Ultra Lyte

Other Speed Detection Systems

Several techniques other than radar or laser are used to measure vehicle speeds. When these methods are being used, no detector can provide a warning. These techniques include:

- Pacing - A patrol car drives behind you and matches your driving speed.
- Vascar/ Aircraft - The time it takes a vehicle to travel a known distance is measured.

Radar Detector Detectors (VG-2)

The Interceptor VG-2, or simply VG-2, is a microwave receiver used by police to detect signals radiated by the local oscillator of a radar detector. Because its purpose is to identify persons driving with radar detectors, the VG-2 is known as a "radar detector detector".

The VG-2 is the primary tool used by the police to identify radar detector equipped vehicles. If caught, in a state where detectors are illegal, (see page 22), drivers risk losing their radar detector and receiving a fine. In addition, instant-on radar is almost always used in combination with a VG-2, leaving unsuspecting motorists vulnerable to receiving two tickets - one potentially for speeding, the other for possession of a detector. Having a radar detector capable of detecting the VG-2 may alert you to the presence of a speed trap.

For more information on speed monitoring technologies, please visit our FAQ page on our website:

www.whistlergroup.com

24

Consumer Warranty

This Whistler Laser/Radar detector is warranted to the original purchaser for a period of one year from the date of original purchase against all defects in materials and workmanship. This limited warranty is void if the unit is abused, modified, installed improperly, if the housing has been removed, or if the serial number is missing. There are no express warranties covering this product other than those set forth in this warranty. All express or implied warranties for this product are limited to one year. Whistler is not liable for damages arising from the use, misuse, or operation of this product.

Service Under Warranty

During the warranty period, defective units will be repaired without charge to the purchaser when returned with a dated store receipt to the address below. Units returned without dated store receipt will be handled as described in section "Service Out Of Warranty." Due to the specialized equipment necessary for testing a laser/radar receiver, there are no authorized service stations for Whistler brand detectors other than the Whistler factory.

When returning a unit for service under warranty, please follow these instructions:

1. Ship the unit in the original carton or in a suitable sturdy equivalent, fully insured, with return receipt requested to:

Whistler Repair Dept.
1201 North Dixieland Rd
Rogers, AR. 72756

IMPORTANT: Whistler will not assume responsibility for loss or damage incurred in shipping. Therefore, please ship your unit insured with return receipt requested. **CODs will not be accepted!**

2. Include with your unit the following information, clearly printed:
 - Your name and street address (for shipping via UPS), a daytime telephone number and email address, if applicable. (No P.O. Box please.)
 - A detailed description of the problem (e.g., "Unit performs self-test but does not respond to radar").
 - A copy of your dated store receipt or bill of sale.
3. Be certain your unit is returned with its serial number. For reference, please write your units serial number in the following space: s/n_____.

Units without serial numbers are not covered under warranty.

IMPORTANT: To validate that your unit is within the warranty period, make sure you keep a copy of your dated store receipt. You may register your warranty online at www.whistlergroup.com. For warranty verification purposes, a copy of your dated store receipt must still accompany any unit sent in for warranty work.

25

26

WARRANTY INFORMATION

SPECIFICATIONS

Service Out of Warranty

Units will be repaired at "out of warranty" service rates when:

- The units original warranty has expired.
- Dated store receipt is not supplied.
- The unit has been returned without its serial number.
- The unit has been abused, modified, installed improperly, or had its housing removed.

The minimum out of warranty service fee for your Whistler detector is \$55.00 (U.S.). If you require out of warranty service, please return your unit as outlined in the section "Service Under Warranty" along with a certified check or money order for \$55.00. Payment may also be made by MasterCard, VISA or American Express; **personal checks are not accepted.** In the event repairs cannot be covered by the minimum \$55.00 service fee, you will be contacted by a Whistler technical service specialist who will outline options available to you. If you elect not to have your unit repaired, it will be returned to you along with your certified check or money order.

IMPORTANT: When returning your unit for service, be certain to include a daytime telephone number, and email address (if applicable).

Customer Service

If you have questions concerning the operation of your Whistler detector, or require service during or after the warranty period, please call Customer Service at:

1-800-531-0004.

Representatives are available to answer your questions Monday - Friday from 8:00 a.m. to 5:00 p.m. CT.

27

Dimensions:

1.6"H x 2.9"W x 4.5"L

Weight: 7.5 oz.

Laser Wavelength:

905 ± 50 nanometers (nm)

Radar Frequencies:

10.500 - 10.550 GHz (X Band)
24.050 - 24.250 GHz (K Band)
33.400 - 36.000 GHz (Ka Superwideband)

Operating Temperature Range:

-20° C to +80° C (-4° F to +176° F)

Power Requirements:

Operational 12 to 15 volts DC, 250mA nominal
Vehicle Battery Saver, 30mA nominal.

One or more U.S. patents apply:

#5,146,227
#5,379,456
#5,666,120
#5,990,821.

Specifications are subject to change without notice.

28

ACCESSORIES

ACCESSORY ORDER FORM

The following accessories can be ordered directly from Whistler by calling 1-800-531-0004 or visit our online store at www.whistlergroup.com

Order Code	Description	Price
402081	Non-Skid Dash Pad	\$ 6.95
202138	Visor Bracket	\$ 6.95
202140	Windshield Bracket Kit	\$ 9.95
206294	*Modular Lighter Plug (Requires 206550 or 206551)	\$ 7.95
206550	*Modular Straight Power Cord (5')	\$ 6.95
	(Requires 206294)	
206551	*Modular Coiled Power Cord (7')	\$ 7.95
	(Requires 206294)	
206552	Straight Power Cord (5')	\$ 14.95
206553	Coiled Power Cord (7')	\$ 15.95
206879	Hook & Loop	\$ 1.95
206880	Hardwire Kit (10') (for wiring to fuse box)	\$ 9.95
203283	Socket Multiplier (Requires 206550 or 206551)	\$ 9.95
206666	Modular Cord Package (includes 206550, 206551, 206294)	\$ 17.95
159032	Package of 8 Suction Cups	\$ 2.95

*Modular: Interconnecting pieces cord and plug. Shipping and handling (per order) \$5.00 Prices are subject to change without notice.

29

PLEASE SHIP TO:

Name: _____
 Street: _____
 City: _____ State: _____ Zip: _____
 Telephone Number: (_____) _____

Order Code/Description	Quantity	Total Price
		\$
Subtotal		
Sales Tax (if Applicable)		
Shipping and Handling*		\$5.00
Total Enclosed		\$

SEND ORDER FORM WITH CERTIFIED CHECK OR MONEY ORDER TO:

Whistler CTS
 PO Box 1844
 Bentonville, AR 72712

IF PAYING BY MASTERCARD, VISA OR AMERICAN EXPRESS PLEASE PROVIDE:

Type of Card MasterCard Visa American Express
 Name on Card: _____
 Card Number: _____
 Expiration Date: _____
 Cardholder Signature: _____

*For expedited shipping costs, contact Whistler Customer Service, 1-800-531-0004

30

Free Manuals Download Website

<http://myh66.com>

<http://usermanuals.us>

<http://www.somanuals.com>

<http://www.4manuals.cc>

<http://www.manual-lib.com>

<http://www.404manual.com>

<http://www.luxmanual.com>

<http://aubethermostatmanual.com>

Golf course search by state

<http://golfingnear.com>

Email search by domain

<http://emailbydomain.com>

Auto manuals search

<http://auto.somanuals.com>

TV manuals search

<http://tv.somanuals.com>