

## OWNER'S MANUAL

# XCS-800 BATTERY POWERED LASER-RADAR DETECTOR



### The Whistler Group Corporate Headquarters

13016 N. Walton Blvd. • Bentonville, AR 72712  
Tel 479.273.6012 • Fax 479.273.2927

### Customer Return Center

551 North 13th Street. • Rogers, AR 72756  
Customer Service Tel 800.531.0004

[www.whistlergroup.com](http://www.whistlergroup.com)

P/N 203322-2, REV1©2007 The Whistler Group, Inc.



Dear Whistler Owner,

If you have questions concerning the operation of this Whistler product please call:

**CUSTOMER SERVICE**  
**1-800-531-0004**

Monday - Friday • 8:00 am - 5:00 pm CT

or visit our website

[www.whistlergroup.com](http://www.whistlergroup.com)

Please keep the receipt in a safe place. You may register your product online at [www.whistlergroup.com](http://www.whistlergroup.com). For warranty verification purposes, a copy of your dated store receipt must accompany any unit sent in for warranty work. If the unit is returned without a dated store receipt, an out of warranty service charge applies.

Note: **Your warranty period begins at the time of purchase. The warranty is validated only by the dated store receipt!** Please record the serial number of the unit in the space provided in the warranty section of the manual.

To fully acquaint yourself with the operation of your Whistler detector and to better understand the differences between detecting radar, laser and safety radar signals, we recommend reading this entire manual or visit our F.A.Q. page on our website [www.whistlergroup.com](http://www.whistlergroup.com)

Enjoy your Whistler and please drive safely.

Sincerely,

The Whistler Group, Inc.

Model Features Summary .....	2 - 3
Installation .....	4 - 6
• Battery Installation	4
• Trim Ring Installation	5
• Mounting Guidelines	5
• Windshield Mounting	6
• Power Connection and Fuse Replacement	6
Operation .....	7 - 13
• Battery Charging/External Power	7
• Battery Life	8
• Power On and Self-Test	8
• Feature Engaged Confirmation	8
• Audio Level Adjustment	8
• Quiet Mode	8
• Auto Quiet Mode	9
• Backlight Setting	9
• Highway Mode	10
• City/City 1/ City 2 Mode	10
• Setting Saver	11
• Engaging/Disengaging VG-2	11
• Battery Saver Mode	11
• Teach/Tutorial Mode	11
• Option Select Mode	12
• Stay Alert Feature	13
Safety Warning System™ .....	13
POP™ Mode Alerts .....	14
Laser/Radar Alerts .....	14
• Speed Radar Audio/Visual Alerts	14
• Laser Audio/Visual Alerts	14
• Pulse Protection®	14
VG-2 Alerts .....	15
• Alert Priority	15
Reset Features .....	16
Troubleshooting Guide .....	16 - 17
Care and Maintenance .....	18
Are Detectors Legal? .....	18
FCC Information .....	19
Speed Monitoring .....	19 - 22
• Radar Facts	19
• POP™ Mode	19
• Total Band Protection™	20
• Laser Facts	20 - 21
• Other Speed Detection Systems	21
Warranty Information .....	22 - 25
Specifications .....	25
Accessories .....	26

## WHISTLER FEATURES

### XCS-800



- Battery Operated With Built-in Battery Charger
- Replaceable Trim Rings
- Total Band Protection™
- POP™ Mode Detection
- Blue LCD Text Display
- High Gain Optical Lens
- Stay Alert™
- 360° Total Perimeter Protection™
- VG-2 Cloaking™ Technology
- 3 City Modes
- Quiet/Auto Quiet Modes
- Battery Saver
- Setting Saver
- Alert Priority
- Safety Warning System™

#### Accessories:

Windshield Bracket Kit, Rechargeable Batteries, Straight Power Cord, Home Battery Charger & 2 Additional Color Trim Rings

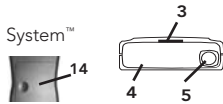

2

## FEATURE DESCRIPTIONS

Whistler's ergonomic and user-friendly design provides a new level of operating convenience. Special features include:

1. **Bracket Release Button** – provides quick and easy release of the mounting bracket.
2. **Speaker** – provides distinct audio warnings for X, K, Ka band radar, safety radar, laser and VG-2.
3. **Mounting Bracket Location** – slot holds mounting bracket firmly.
4. **Radar Antenna** – compact, high-efficiency antenna receives radar signals.
5. **Front Laser** – high gain optical lens provides increased sensitivity and field of view for leading-edge laser detection
6. **Rear Laser** – an integrated optical waveguide provides superior detection of laser signals transmitted from behind.
7. **City Button** - reduces the annoyance of false alerts typically encountered in urban driving areas.
8. **Quiet/Menu Button** - pressing QUIET before a signal is detected engages Auto Quiet Mode. Pressing QUIET during a radar/laser encounter silences audio alerts. (Pressing and holding for 2 seconds allows you to enter Option Select Mode—see page 12)
9. **Power/Dim** - turns unit on/off and engages Backlight settings (press and hold).
10. **Volume Down Button** – adjust volume down.
11. **Volume Up Button** – adjust volume up.
12. **Blue LCD Text Display** – provides distinct visual confirmation of signals detected, signal strength, and indicates engaged modes of operation.
13. **Power Jack** – provides connection for the power cord.
14. **Battery Compartment** – compartment for which you place the included 4 AA Ni-MH batteries.

3

## INSTALLATION

### Battery Installation

**Please charge batteries overnight before first use!**

Remove the battery compartment cover by sliding the cover to the edge of the unit and lift up. Observing correct polarity (+) and (-), insert batteries as shown. Reinstall battery compartment cover. Alkaline batteries are not recommended.

When replacing the Ni-MH rechargeable batteries we recommended batteries that have a power rating of 2100 mA or higher.

**Note:** DO NOT mix battery types as this can damage the batteries. Lithium batteries are recommended for use in cold temperatures.

**Important:** Ni-Cd batteries are not recommended. These batteries will not provide enough capacity to be useful. Replace the Ni-Cd's with Ni-MH type rechargeable batteries.

**Caution:** Only use rechargeable batteries in the optional home battery charger. Charging non-rechargeable batteries can damage the charger or possibly cause the batteries to explode. See battery charging section (page 7) to either charge batteries with the power cord or home battery charger.

4

## INSTALLATION

### Trim Ring Removal/Installation

To change the trim ring to another color, follow these simple steps:

#### Removal

- Locate the tab on the trim ring at the top of the mounting bracket location.
- Using your fore finger, lift up on the trim ring and the ring will pop out.

#### Installation

- Locate the tab near the button openings and insert this end first into the unit.
- Gently snap in the other tabs as you work your way to the back of the unit.

#### Mounting Guidelines

- Mount the unit as low as possible near the center of the windshield.
- Do not mount your unit behind wipers, ornaments, mirrored sunscreens, etc. These obstructions have metal surfaces which can affect radar and laser signals and reduce critical warning time. (Regular tinted glass does not affect reception.)
- Some windshields have an Instaclear™ or Electriclear™ type coating, which affect radar signals. Consult your dealer or the owner's manual supplied with your vehicle to determine if your windshield has this coating.
- Avoid placing unit in direct contact with windshield.
- To reduce the possibility of theft, conceal your unit when not in use.

5

## INSTALLATION

### Windshield Mounting

- Install the two suction cups and rubber bumper onto the bracket by fitting them into their holes.



- Press the suction cups onto the windshield at the location you have chosen.
- Slide the detector onto the bracket until it locks into place.
- If necessary, the unit may be leveled by bending the windshield bracket.
- Press the bracket release button and remove the detector before bending.

### Power Cord Connection

- Plug the small end of the power cord into the unit's power jack.
- Plug the large end into the vehicle's cigarette lighter.

**Note:** Cord fits tightly into detector. When installing the cord, expect some resistance. Do **NOT** put alkaline batteries in the detector if using the power cord.

### Fuse Replacement

The lighter socket plug is equipped with a replaceable 2 amp 3AG fuse located behind the silver tip. To replace the fuse, carefully unscrew the tip of the plug.

**Important:** Unscrew slowly. The tip contains a spring which may fly out when disassembling. Insert the new fuse with the spring and screw on the tip. With use, screw cap on plug may loosen. Retighten occasionally.

Unscrew the tip of the lighter socket plug carefully when replacing the 2 amp fuse.

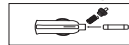

6

## OPERATION

### Battery Charging

**External/Home Battery Charger** - The home battery charger provides approximately 10 hour recharge time for Ni-MH batteries. Simply observe the battery polarity when installing the batteries into the charger and plug the home charger into a convenient outlet.

**Internal/Power Cord** - While traveling, plug your included power cord into your detector and into your lighter socket to slowly charge the rechargeable batteries. This will also provide power to the detector. The display will show an asterisk, i.e., (HIGHP\*) when the unit is charging the batteries. The asterisk will flash during charging and go out when charging is complete.\* **Note: Regular batteries (not Ni-Cd) can be used but NOT with the power cord and NOT with the home battery charger.** When the power cable is removed from the detector or the vehicle's lighter socket is switched off, the unit will alarm and display (PLUG OUT) then simply turns off.

**Note:** As with all battery operated devices, remove the batteries when this unit will not be used for an extended period of time. Damage caused by leaky or improperly charged batteries are not covered under warranty. Check with the battery manufacturer about their specific product warranty and disposal recommendations.

**Charging Note:** If the unit is displaying 20% or less and you wish to charge the batteries in the unit, you must plug in the cigarette lighter cord and insert into a live 12 volt DC socket for at least 8 hours or until the battery charge indicator (\*) on the display is no longer blinking.

7

## OPERATION

### Battery Life

The unit can provide over 20 hours of laser/radar detection. There are settings that can maximize battery life.

- 1) Backlighting set to OFF-OFF
- 2) Auto Quiet to ON
- 3) Battery saver set to 1 hour
- 4) Using a lower volume setting
- 5) Using Mute whenever possible

### Power On and Self-Test

Each time your Whistler detector is turned on, an automatic self-test sequence confirms that the speaker and visual displays are functional.

• Press Power. Display shows in order:

1. WHISTLER 2. X-Band 3. K-Band 4. Ka-Band
5. LASER 6. POP ON 7. VG2 OFF 8. SR OFF
9. Bat Full - This will display the battery status. 10. Highway

### Feature Engaged Confirmation

Each time a button is pressed one beep confirms feature "on", two beeps confirm feature "off".

### Audio Level Adjustment

The audio levels can be adjusted high to low or low to high.

- Press Volume ▲ up to increase audio level.
  - Press Volume ▼ down to decrease audio level.
- As audio level is adjusted, beeps are provided and the display indicates volume level.

### Quiet Mode

Quiet cancels audio during an alert and any new alert within 20 seconds. After 20 seconds, approximately 2 beeps are provided on any new alert and unit then remains quiet.

- Press Quiet to cancel the audio.
- Press Quiet a second time during an alert to restore the standard audio alert pattern; or turn the unit off, then on.

8

## OPERATION

### Auto Quiet Mode

Auto Quiet reduces the selected audio level to level (1) approximately 5 seconds after a radar or safety radar signal is detected. The alert for any new signal within 20 seconds will resume at level (1). Auto Quiet does not affect VG-2 or laser alerts.

- Press Quiet/Menu (before a signal is detected) to engage Auto Quiet.
- Once the Auto Quiet mode is engaged, you may cancel the audio alarm by pressing Quiet.
- Press Quiet (when the unit is not alarming) to cancel Auto Quiet mode.

### Backlight Setting

The backlighting can be programmed to be illuminated all the time, only when alarming, or choices in-between. The options are selectable by pressing and holding the Power/Dim button on the unit. The options are:

- OFF-OFF** = Backlight is off during normal operation and off when the unit alarms
- OFF-DIM** = Backlight is off during normal operation and dim when the unit alarms.
- OFF-BRT** = Backlight is off during normal operation and bright when the unit alarms.
- DIM-OFF** = Backlight is dim during normal operation and off when the unit alarms.
- DIM-BRT** = Backlight is dim during normal operation and bright when the unit alarms.

Backlight will turn on, if selected, while the unit alarms and remain on for 3 seconds after the unit stops alarming. When any button is pressed the backlight will illuminate at the dim setting and remain on for 3 seconds afterwards. The backlight will also illuminate while in option mode.

9

## OPERATION

### Highway Mode

Highway mode provides full audio warnings any time radar (X, K, Ka, Safety Radar) or laser signals are detected, and is recommended for open road driving. (Highway mode lets every signal in)

For more information on City and Highway mode, please visit our FAQ page on our website: [www.whistlergroup.com](http://www.whistlergroup.com)

### City/City 1/City 2 Mode

Whistler's Three Stage City Mode is designed to reduce the annoyance of automatic door openers, intrusion alarms and other devices which share frequencies with police radar. Generally, X band is used for these devices.

- Press City to cancel Highway mode and engage City.
- Press City again to enter City 1 Mode
  - display shows 'C1 Lo X'.
- Press City again to enter City 2 Mode
  - display shows 'C2 No X'
- Pressing City a fourth time cancels City 2 Mode and returns the unit to Highway Mode.

In City Mode, weak speed/safety radar signal give an initial alarm of two beeps, and then remains quiet unless the signal becomes very strong. When the signal strength increases, two additional beeps are provided. City 1 and City 2 Modes operate the same as Highway Mode, but in City 1 Mode, only the X band sensitivity is lowered. In City 2 Mode, X-band is not detected.

**Caution:** Some towns/small cities may still be using X band radar. City Modes do not change the audio alert for laser or VG-2.

10

## OPERATION

### Setting Saver

Setting Saver saves your personalized settings so that when the detector is turned off and then on again, you do not have to re-enter them.

### Engaging/Disengaging VG-2

See Option Select Mode to turn this feature on/off. For more VG-2 information see page 15.

### Battery Saver Mode

The Vehicle Battery Saver Mode automatically shuts off the detector if you forget to turn it off. The timer is reset if the detector is turned off, the optional power cord is unplugged or any button is pressed before the timer has expired. The detector will alert you with an audible and visual warning before it shuts off. This auto off function can be programmed for the following: Off, 1, 2, or 3 hours.

During this warning you can reset the timer by pressing any button.

If the unit has automatically turned itself off, press the Power button to turn the unit back on. You can manually engage the Battery Saver Mode by pressing and holding the City button until one beep is heard.

Refer to "Option Select Mode" for instructions for changing the Battery Saver Mode settings.

### Teach/Tutorial Mode

Provides simulated alerts for each type of signal.

- Press City and Quiet simultaneously and release.
- Display Shows: **TEACH**
- Press Power to exit.

11

## OPERATION

### Option Select Mode

Entering Option Select Mode allows you to customize options such as Tone Select, Abbreviated Power Up Sequence and VG-2 Mode. Press and hold quiet button to enter Option Select Mode. When selecting options, the volume up ▲, volume down ▼ or Quiet buttons must be pressed within 20 seconds or options mode will automatically be exited. To enter:

Press: Quiet	Display Reads:	To Change:	Option:
1st Time	TONE 3	▲ = YES ▼ = NO	Tone 1, 2, 3 (3 different X, K, Ka Patterns)
2nd Time	TEST YES	▲ = ON ▼ = OFF	X, K, Ka Audio tones 1 beep during Power Up
3rd Time	X-ON	▲ = ON ▼ = OFF	X Band On X Band Off
4th Time	K-ON	▲ = ON ▼ = OFF	K Band On K Band Off
5th Time	Ka-ON	▲ = ON ▼ = OFF	Ka Band On Ka Band off
6th Time	LASER ON	▲ = ON ▼ = OFF	LASER Band On LASER Band Off
7th Time	VG-2 OFF	▲ = ON ▼ = OFF	Turns VG-2 On Turns VG-2 Off
8th Time	SR OFF	▲ = ON ▼ = OFF	Safety Radar On Safety Radar Off
9th Time	POP ON	▲ = ON ▼ = OFF	Pop On Pop Off
10th Time	B SVR 1 HR	▲ OR ▼	Options are 1H, 2H, 3H & NO

12

## OPERATION

### Stay Alert Feature

The Stay Alert Feature is designed to test a driver's alertness. To engage (when unit is not alarming) :

- Press and hold City for approximately 2 seconds. Release button during or immediately after the alert is given. Display shows: **(RU ALERT)**

Within 30-60 seconds two beeps are sounded; to show alertness, the driver must press either the City, Volume, or Quiet buttons within 3-5 seconds. If a button is pressed within 3-5 seconds, the cycle is repeated.

If a button was not pressed within 3-5 seconds alarm sounds and the display shows: **(GET REST)**

- Press Power to exit.

**WARNING!!!** Stay Alert is NOT intended as a substitute for adequate rest. You should NOT operate a vehicle if you are drowsy. During extended periods of vehicle operation, you should take frequent breaks. Improper reliance on the Stay Alert feature may result in vehicle damage, personal injury or death. **NEVER OPERATE A VEHICLE IF YOU ARE DROWSY.**

## SWS™

### Safety Warning System™

In communities where transmitters are located, the Safety Warning System™ displays over 60 text messages. When Safety Radar is detected the audio alert is geiger counter-like.

**Note:** Safety Warning System™ is labeled "SR" in Option Select Mode.

### Safety Warning System Text

Example: Poor - Road - Surface.

**Note:** Not all areas have Safety Warning System™ transmitters.

13

## POP™ MODE ALERTS

### POP™ Mode Alerts

Because POP™ Mode radar utilizes the same K or Ka band frequencies, POP™ Mode Alerts will be displayed as regular radar alerts.

## LASER/RADAR ALERTS

### Speed Radar Audio/Visual Alerts

When X, K or Ka is detected, the band ID and signal strength is displayed. The audio alert is continuous and has a geiger counter-like pattern. The faster the beep, the closer or stronger the radar source.

### Laser Audio/Visual Alerts

When a laser signal is detected the audio alert is continuous for a minimum of 3 seconds.

- The Displays Shows: **(LASER IIII)**  
The more "IIII" the closer the laser source.

### Pulse Protection®

Pulse (or instant-on) radar is more difficult to detect than conventional radar because it remains 'off' until activated to measure the speed of a targeted vehicle.

When a pulse type transmission is detected, your Whistler detector sounds an urgent 3-second audio warning and the display shows: **(PULSE)**

After the 3-second pulse alert, the standard alert pattern continues for as long as the signal is present.

It is important to respond promptly to a pulse alert, since warning time may be minimal.

14

## VG-2 ALERTS

### VG-2 Audio/Visual Alerts

**Note:** You must turn this feature on before it will detect VG-2.

When a VG-2 signal is detected, the VG-2 alert is sounded and the display flashes "VG-2". After 3 seconds the audio is canceled and the display no longer flashes. This cycle is repeated if the VG-2 signal is again detected. When a VG-2 signal is detected, the detector 'hides' its own radiated signal and becomes undetectable by the VG-2.

Every 30 seconds, the detector checks for a VG-2 signal. If a VG-2 signal is still present, the unit continues to hide and repeats the VG-2 alert. If no signal is detected, two beeps are provided, indicating an 'all clear' condition.

During a VG-2 Alert X, K, and Ka band signals cannot be received (Reference page 21 for VG-2 information).

However, because the VG-2 alert has confirmed that a patrol car is nearby, you are already aware of the potential for speed monitoring and can adjust your speed accordingly. Laser detection is not affected while a VG-2 signal is detected.

### Alert Priority

When two or more signals are received at the same time, the alert priority is:

1. Laser
2. VG-2
3. Speed Radar
4. Safety Radar

### Example:

If X band is alerting, then suddenly a VG-2 signal is detected, the VG-2 warning will override the X band alert.

15

## RESET FEATURES

### Reset Features

All user features can be reset to factory settings.

- Unplug Power Cord from unit.
- Remove Batteries.
- Press and hold Power and Quiet.
- Plug Power Cord into unit.
- Wait for 2 beeps.
- Release Power and Quiet buttons.

**Unit is now reset to the following features and settings.**

### Default factory settings are:

1. Audio to level (4).
2. Display shows Highway.
3. Auto Quiet Mode OFF.
4. VG-2 Detection Mode OFF.
5. Safety Radar OFF.
6. Vehicle Battery Saver to 1 hour.
7. Full Power Up sequence.
8. Default TONE 3.
9. POP ON.
10. Backlighting Dim/Bright

## TROUBLESHOOTING

### PROBLEM: No display or audio.

- Make sure batteries are installed with the correct polarity.
- Make sure batteries are fully charged.
- Make sure battery contacts are clean.
- Check fuse in Whistler plug; replace if necessary with a 2 amp 3AG type.
- Check fuse for lighter socket; replace if necessary.
- Make sure lighter socket is clean.

### PROBLEM: Audio alerts are not loud enough.

- Cancel Auto Quiet Mode or City Mode.
- Check audio level setting (see page 8).

### PROBLEM: Low Battery Life.

- Recharge the batteries using the home charger.
- One or more of the batteries may be defective.
- See the battery life tips on page 8.

### PROBLEM: Unit turns itself off

- See battery saver feature on page 11

16

## TROUBLESHOOTING

**PROBLEM: Unit alarms when vehicle hits bumps.**

- Make sure batteries are seated properly.
- Make sure that the battery door is fully closed.
- Make sure battery contacts are clean.
- Check for loose lighter socket; tighten and clean.

**PROBLEM: Unit not charging in car and unit displays "NO BAT" or the \* is not blinking.**

- The batteries may be too low and need to be refreshed. To refresh the batteries, you need to charge them in the home charger for 10 hours, remove the charger from the wall outlet to reset the 10 hour timer and then re-insert for a 2nd charge of 10 hours. This will peak and refresh the batteries to maximum capacity.

**PROBLEM: Battery gauge indicates "BATT FULL" but the unit only a few hours**

- If you had a low battery warning and you charge the batteries for 1 or 2 hours using the power cord, the battery gauge may say BATT FULL because the battery voltage is greater than 1.25 volts per cell but the capacity is not full and as a result the battery operation of your unit will be greatly diminished. Recharge the batteries using the home charger overnight or in the unit for at least 8 hours using the power cord and a live cigarette lighter socket. The battery gauge is only accurate if the batteries are fully charged by the procedures as indicated above.

If difficulties occur which cannot be solved by information in this Troubleshooting Guide, please call Whistler Customer Service at **800.531.0004** or visit our F.A.Q. page at [www.whistlergroup.com](http://www.whistlergroup.com) before returning your unit for service.

17

## CARE AND MAINTENANCE

### Care And Maintenance

During the summer months, avoid prolonged exposure to direct sunlight by removing your unit from the dash when your vehicle is parked for an extended period of time. Do not spray water, cleaners, or polishes directly onto the unit. The spray may penetrate through the openings and damage the unit. Also, do not use any abrasive cleaners on the unit's exterior.

As with all battery operated devices remove the batteries when this unit will not be used for an extended period of time. Damage caused by leaky or improperly charged batteries are not covered under warranty. Check with the battery manufacturer about the specific battery warranty.

### ARE DETECTORS LEGAL?

#### In Most States YES!

Laser-Radar detectors are legal in every state (with the exception of Virginia and Washington, D.C., which have local regulations restricting the use of radar receivers in any vehicle) when used in automobiles or light trucks (under 10,000 lbs.).

Concerning trucks over 10,000 lbs., the Federal Highway Administration (FHWA) issued a regulation, effective January, 1994 which prohibits radar and laser detector use in these types of vehicles nationally. Prior to the FHWA regulation, laws existed in the state of New York restricting the use of radar detectors in trucks over 18,000 lbs. and in Illinois in trucks over 26,000 lbs.

18

## FCC INFORMATION

### FCC ID : HSXWH15

This device complies with part 15 of the FCC Rules. Operation is subject to the following two conditions:

- (1) This device may not cause harmful interference, and
- (2) this device must accept any interference received, including interference that may cause undesired operation.

**Important:** FCC requirements state that changes or modifications not expressly approved by Whistler could void the user's authority to operate the equipment.

## SPEED MONITORING

### Radar Facts

A radar gun operates by transmitting radio waves at certain frequencies which reflect off objects and are picked up by the radar gun's receiving section. When a radar beam reflects off a moving target, a measurable frequency shift occurs. The radar unit converts this shift into miles per hour to determine your vehicle's speed. Currently, the FCC (Federal Communications Commission) permits operation of traffic radar guns at X Band (10.500 - 10.550 GHz), K Band (24.050 - 24.250 GHz), and Ka Band (33.400 - 36.000 GHz).

**Note:** A radar detector will not alarm if an officer is not transmitting on any one of the above radar bands.

### POP™ Mode

POP™ Mode is a feature on some newer radar guns operating on K and Ka bands. When the gun is in POP™ Mode and activated, a brief burst of energy, less than 1/15 of a second, is transmitted and the vehicle's speed is quickly acquired. A detector without POP™ Mode detection capability cannot respond to this brief transmission.

19

## SPEED MONITORING

### Total Band Protection™

Complete Band Coverage that detects laser, radar, VG-2 and safety radar bands.

### Laser Facts

It's well documented that many radar guns cannot reliably provide the speed of a targeted vehicle that is traveling in a group of vehicles. In contrast, a laser gun can target a specific vehicle out of a line of traffic and determine its speed. The advantage of laser over radar in terms of target identification is the result of the laser gun's narrow beam. A radar gun's transmission can cover more than a four-lane highway at a distance of 1,000 feet, compared with a laser gun's transmission which covers about 3 feet at the same distance. For best protection, keep these points in mind:

- Because the vehicle's license plate or headlights are the laser gun's primary targets, mounting the Whistler detector on the dashboard can improve laser detection at short range.
- Do not follow closely behind any vehicle you cannot see through. If you can't see past a vehicle ahead of you, chances are your detector won't either.
- The receiving range of your laser detector will not be the same as a radar detector. Laser guns are most often used at short range.

Whistler Laser-Radar detectors receive all current laser guns which operate at a laser wavelength of 905 +/- 10nm.

- Pro Laser™ I II III
- LT1 20-20
- Ultra Lyte

20

## SPEED MONITORING

### Laser Tips

If you are the targeted vehicle, a laser gun can often determine your speed within a few seconds after you receive an alert. In this situation there is generally no time to safely adjust your speed. However, if you are traveling near or behind the targeted vehicle and receive an alert, response time should be sufficient. Any laser alert, regardless of duration, requires immediate action!

### Other Speed Detection Systems

Several techniques other than radar or laser are used to measure vehicle speeds. When these methods are being used, no detector can provide a warning. These techniques include:

- **Pacing** - A patrol car drives behind you and matches your driving speed.
- **Vascar/Aircraft** - The time it takes a vehicle to travel a known distance is measured.

### Radar Detector Detectors: VG-2, Spectre

The Interceptor VG-2 or simply VG-2, is one type of microwave receiver used by Police to detect signals radiated by the local oscillator of a radar detector. Because its purpose is to identify persons driving with radar detectors, these devices are known as a "radar detector detector" (RDD).

An RDD is the primary tool used by the police to identify radar detector equipped vehicles. If caught in a state or country where detectors are illegal (see page 18), drivers risk losing their radar detector and receiving a fine. In addition, instant-on radar is almost always used in combination with a RDD, leaving unsuspecting motorists vulnerable to receive two tickets - one potentially for speeding, the other for possession of a detector.

21

## SPEED MONITORING

**Note:** Having a radar detector capable of detecting the VG-2 may alert you to the presence of a speed trap. The newest tool Police have to detect radar detectors is called Spectre. As of this printing, Spectre can detect all undetectable (VG-2) laser/radar detectors on the market.

It is the responsibility of the individual radar detector owner to know and understand the laws in your area regarding the legality of the use of radar detectors.

## WARRANTY INFORMATION

### Consumer Warranty

This Whistler Laser-Radar detector is warranted to the original purchaser for a period of one year from the date of original purchase against all defects in materials and workmanship. This limited warranty is void if the unit is abused, modified, installed improperly, if the housing and/or serial numbers have been removed. There are no express warranties covering this product other than those set forth in this warranty. All express or implied warranties for this product are limited to the above time. Whistler is not liable for damages arising from the use, misuse, or operation of this product.

**Note:** Damaged caused by incorrect battery placement or battery leakage is not covered under this warranty.

22



## WARRANTY INFORMATION

### Service Under Warranty

During the warranty period, defective units will be repaired without charge to the purchaser when returned with a dated store receipt to the address below. Units returned without a dated store receipt will be handled as described in section

#### "Service Out Of Warranty."

Due to the specialized equipment necessary for testing a Laser-Radar receiver, there are no authorized service stations for Whistler brand detectors other than Whistler.

When returning a unit for service under warranty, please follow these instructions:

1. Ship the unit in the original carton or in a suitable sturdy equivalent, fully insured, with return receipt requested to:

**Whistler Repair Dept.**  
551 North 13th Street.  
Rogers, AR. 72756

**Please allow 3 weeks turnaround time.**

**Important:** Whistler will not assume responsibility for loss or damage incurred in shipping. Therefore, please ship your unit insured with return receipt requested. **CODs will not be accepted!**

2. Include with your unit the following information, clearly printed:
  - Your name and street address (for shipping via UPS), a daytime telephone number and an email address, if applicable.
  - A detailed description of the problem (e.g., "Unit performs self-test but does not respond to radar").
  - A copy of your dated store receipt or bill of sale.

23

## WARRANTY INFORMATION

3. Be certain your unit is returned with its serial number. For reference, please write your unit's serial number in the following space:  
s/n \_\_\_\_\_.

Units without serial numbers are not covered under warranty.

**Important: To validate that your unit is within the warranty period, make sure you keep a copy of your dated store receipt. You may register your warranty online at [www.whistlergroup.com](http://www.whistlergroup.com), however, for warranty verification purposes, a copy of your dated store receipt must accompany any unit sent in for warranty work.**

### Service Out of Warranty

Units will be repaired at 'out of warranty' service rates when:

- The unit's original warranty has expired.
- A dated store receipt is not supplied.
- The unit has been returned without its serial number.
- The unit has been abused, modified, installed improperly, or had its housing removed.

The minimum out of warranty service fee for your Whistler detector is \$55.00 (U.S.). If you require out of warranty service, please return your unit as outlined in the section "Service Under Warranty" along with a certified check or money order for \$55.00. Payment may also be made by MasterCard, VISA or American Express; **personal checks are not accepted.**

**In the event repairs cannot be covered by the minimum \$55.00 service fee, you will be contacted by a Whistler technical service specialist who will outline options available to you.**

If you elect not to have your unit repaired, it will be returned to you along with your certified check or money order.

24

## WARRANTY INFORMATION

**Important:** When returning your unit for service, be certain to include a daytime telephone number and an email address (if applicable).

### Customer Service

If you have questions concerning the operation of your Whistler detector, or require service during or after the warranty period, please call Customer Service at:

**1-800-531-0004**

Representatives are available to answer your questions Monday - Friday from 8:00 a.m. to 5:00 p.m. (CT) or visit the FAQ's at [www.whistlergroup.com](http://www.whistlergroup.com).

## SPECIFICATIONS

### Radar Frequencies:

10.500 - 10.550 GHz (X Band)  
24.050 - 24.250 GHz (K Band )  
33.400 - 36.000 GHz (Ka Superwideband)

**Operating Temperature Range:** -20° C to +80° C  
(-4° F to +176° F)

### Power Requirements:

4 AA Ni-MH batteries 4.8 volts.  
12 volts with power cord.

### One or more U.S. patents may apply:

#5,146,227, #5,379,456, #5,666,120, #5,990,82, #7,215,276

POP™ Mode is a trademark of MPH Industries, Inc.

Specifications are subject to change without notice.

25

## ACCESSORIES

These and other accessories can be ordered directly from Whistler by calling **1-800-531-0004** or visit our online store at [www.whistlergroup.com](http://www.whistlergroup.com)

Order #	Description	Price
500501	Zippered Travel Case	\$ 9.95
600111	Home Battery Charger	\$ 9.95
202152	Windshield Bracket Kit	\$ 9.95
206552	Straight Power Cord (5')	\$14.95
206553	Coiled Power Cord (7')	\$15.95
206880	Hardwire Kit (10' ) (for wiring to fuse box)	\$ 9.95
206666	Modular* Cord Package (includes coiled and straight cords, and power adapter)	\$17.95
402081	Non Skid Dash Pad	\$ 6.95
206660	Straight Modular Cord & Socket Multiplier	\$11.95
206661	Coiled Modular Cord & Socket Multiplier	\$12.95
26005P	Replaceable Ring and Insert Set Includes 6 trim rings: metallic blue, metallic gold, metallic red, pink, silver and white and 2 inserts: metallic silver and metallic black.	\$14.95

\* Modular: Interconnecting pieces cord and plug.  
**Shipping and handling (per order) \$5.00 . Prices are subject to change without notice.**

26

## Free Manuals Download Website

<http://myh66.com>

<http://usermanuals.us>

<http://www.somanuals.com>

<http://www.4manuals.cc>

<http://www.manual-lib.com>

<http://www.404manual.com>

<http://www.luxmanual.com>

<http://aubethermostatmanual.com>

Golf course search by state

<http://golfingnear.com>

Email search by domain

<http://emailbydomain.com>

Auto manuals search

<http://auto.somanuals.com>

TV manuals search

<http://tv.somanuals.com>