

Traditional home comfort with lower heating costs, convenience and high-efficiency!

Value-for-your-money-priced models feature energy and money-saving operating costs. Easily recessed or surface-mounted installation are great in homes, schools, cabins, apartments, offices and shops.

Heating rooms individually allows comfort in areas being used while saving fuel cost in unused areas.

For additional money-saving efficiency, install one of our optional blowers.



### **Fireplace-in-a-Furnace** ▲

An attractive innovation that captures the essence of the traditional fireplace and combines it with the convenience of a 35,000 Btu/hr modern gas home heater.

### **Dual-Wall Top-Vent** ►

This high-efficiency 50,000 Btu/hr dual-wall model, with patented, energy-maximizing side-relief draft hood openings, will heat two or more rooms, quickly and economically. Conveniently installs in the wall to heat two adjacent rooms (25,000 Btu/hr on each side).

**50,000  
Btu/hr**



### **Design Features**

- No electricity required
- "Matchless" pilot igniter
- Easy installation
- Patented, side-relief opening draft hood design reduces flue gas temperature to minimize normal heat loss
- Natural and propane gas models (Conversion kits available)
- Automatic temperature and safety controls
- Resettable vent-limit safety switch
- Thermostat included, may be wall-mounted or cabinet-mounted

# Monterey Home Furnaces

Model Number		Btu/hr Input Rating	Btu/hr Output Rating	Efficiency Percentages		Face Panel Dimensions			Gas Connection	Type of Control	Shipping Weight (lbs.)
Natural	Propane			Thermal	AFUE	Width	Depth	Height			
<b>MONTEREY HOME FURNACES</b> <span style="float: right;"><i>Conversion Kit Available</i></span>											
2509622	2509621	25,000	19,350	77.0	71.0	16"	6"	65 <sup>3</sup> / <sub>4</sub> "	1/2"	Millivolt Wall	83
3509622	3509621	35,000	25,930	74.0	69.0	16"	6"	65 <sup>3</sup> / <sub>4</sub> "	1/2"	Millivolt Wall	83
<b>MONTEREY HOME FURNACES - DOUBLE-SIDED</b> <span style="float: right;"><i>Conversion Kit Available</i></span>											
5009622	5009621	50,000	38,500	77.0	71.0	16"	6"	65 <sup>3</sup> / <sub>4</sub> "	1/2"	Millivolt Wall	137
<b>MONTEREY FIREPLACE-IN-A-FURNACE</b> <span style="float: right;"><i>Conversion Kit Available</i></span>											
3509622.6	-	32,000	24,000	75.0	69.0	16"	6"	65 <sup>3</sup> / <sub>4</sub> "	1/2"	Millivolt Wall	83

Gas Connection: 1/2" · All models are rated for 4,500' elevation

## Features

### "Matchless" Pilot Igniter

All models include a "matchless" pilot igniter. Assures convenient pilot lighting without matches.

### Automatic Thermostat - Included with all models

(No Electricity Required)  
All models are equipped with a self-generating millivolt thermostat that may be wall or cabinet-mounted. All models feature resettable vent-limit safety switch as standard equipment.

### Contemporary Finish

Soft-white, powder-coat scratch-resistant finish to complement any décor.

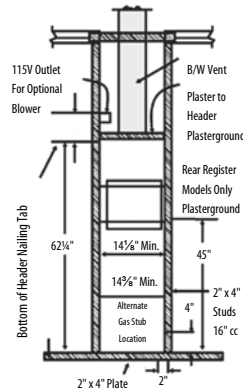

## Accessories

### Blower

Attaches to top of Monterey furnaces with on/off switch or automatic operation. Improves circulation of warm air and reduces temperature differences in the room. Optional deluxe blower for increased air flow, 125 CFM. Two blowers may be used on 50,000 Btu/hr.

**Model 2901**, shipping weight 9 lbs.  
**Model 2907**, shipping weight 9 lbs.



### Rear-Outlet Register

Chain-operated damper with register flush on rear wall, adjusts amount of heat delivered through rear register. Motorized rear-outlet register for increased airflow.

**Model 6901** for Monterey, shipping weight 4 lbs.  
**Model 6905** Plasterground, shipping weight 1 lb.  
**Model 6919** for Monterey with a recessed installation.  
**Model 6920** for Monterey with surface-mounted installation. Motorized models, shipping weight 10 lbs.

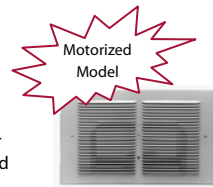

## Dimensions and Clearances

### Monterey Models

4" to intersecting wall  
16" from top of appliance to ceiling  
Clearance requirements may vary by area

*Clearance requirements may vary by local codes*

### Top-View Single-Sided Models

25,000 & 35,000 Btu/hr

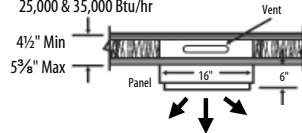

### Top-View Double-Sided Models

50,000 Btu/hr

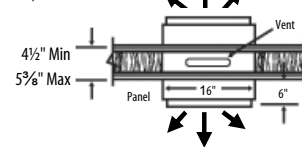

## Important

- Read owner's manual before using/installing.
- Photographs are representative only.
- Specify propane or natural gas when ordering.
- Check local codes and ordinances for permitted uses.
- Consult installation manual for clearances prior to installation.
- We reserve the right to amend product specifications without notice.
- Installation and servicing recommended by a qualified service person.
- Please read the warranty, for any limitations or disclaimers. Combustion chamber carries a ten-year limited warranty. All other parts carry a one-year limited warranty.
- Venting must comply with the "Venting and Chimney Requirements" section of installation manual.
- Massachusetts approval G3-0305-171

## High-Altitude Models

### Conversion Kits

### Oval-Vent Starter Kit

Contains starter hold down plate, oval-to-round-adapter and two pieces of oval pipe. **Model 9901**, shipping weight 9 lbs.

### Vent Adapter

Surface-mounted gas installations only. With blower installed, **Model 9910**, shipping weight 3 lbs. Without blower installed, **Model 9902**, shipping weight 3 lbs.

### Freestanding Kit

Allows single-sided furnaces to be surface mounted instead of recessed. Ideal for remodeling in existing masonry wall construction or when studding is substandard. **Model 4901**, shipping weight 23 lb

### Replacement Face Panel

Soft-white, powder-coated replacement face panel. **Model 4915**, shipping weight 30 lbs.



Requires  
No Electricity

Great During  
Power Outages



250 West Laurel Street · Colton, California 92324 USA  
(909) 825-0993 · Fax: (909) 370-0581 or (909) 824-8009  
Consumer Line: (888) 256-6465  
Homeowner Assistance: (909) 426-0978  
www.e-wfc.com





## Optional Remote Controls Wireless Thermostats Digital Thermostats

*For Use with All Monterey, Direct-Vent Gravity and Console Hearth Heaters*



Model:  
P332492

Retail List Price  
\$220

### Wireless Digital Wall Thermostat

Model: P332491

- ❖ Wireless Thermostat or Manual On/Set/Off Operation
- ❖ Wall-Mounted Installation
- ❖ Easy-To-Read LCD Screen
- ❖ Displays Room Temperature in F° or C°
- ❖ Battery Operated

Retail List Price  
\$197



### Wireless Remote Control

- ❖ Three Functions:
  - On – Off – Thermostat Setting
- ❖ Easy-To-Read LCD Screen
- ❖ Displays Room Temperature in F° or C°
- ❖ Battery Operated
- ❖ Four-Button Control
- ❖ Velvet-Touch Casings

### Digital Wall Thermostat

Model: P332493

- ❖ Wired Thermostat or Manual On/Set/Off Operation
- ❖ Wall-Mounted Installation
- ❖ Easy-To-Read LCD Screen
- ❖ Displays Room Temperature in F° or C°
- ❖ Battery Operated

Retail List Price  
\$80

## Free Manuals Download Website

<http://myh66.com>

<http://usermanuals.us>

<http://www.somanuals.com>

<http://www.4manuals.cc>

<http://www.manual-lib.com>

<http://www.404manual.com>

<http://www.luxmanual.com>

<http://aubethermostatmanual.com>

Golf course search by state

<http://golfingnear.com>

Email search by domain

<http://emailbydomain.com>

Auto manuals search

<http://auto.somanuals.com>

TV manuals search

<http://tv.somanuals.com>