



## Pro Low-Profile Wall Ventilation Hoods

With standard features like heat sentry and dual setting halogen lighting, Wolf Pro wall hoods provide the ultimate in ventilation. Pro low-profile wall ventilation hoods are available in four widths and all have the classic stainless steel finish. You also have the option of a decorative rail. While a classic stainless steel rail is standard on (R) models, platinum or brass rails are available to match the bezels of our dual fuel ranges and sealed burner rangetops.



Model PW362210R shown with decorative rail.

### Features

- Classic stainless steel finish
- Rail (R) models feature a classic stainless steel decorative rail
- Heavy-duty, 16-gauge brushed stainless steel with continually welded seams, hemmed edges and sides
- Stainless steel enclosed liner
- Recessed easy-access controls
- Infinite-speed blower control
- Heat sentry feature automatically turns unit on when heat is sensed and automatically adjusts blower speed
- Halogen lighting with two settings
- Removable, dishwasher-safe, restaurant-grade stainless steel baffle filters

### Model Options

Model	PW302210	PW362210	PW422210	PW482210
Overall Width	30"	36"	42"	48"

Model numbers are for hoods without decorative rail, add (R) to the model number for rail option models.

### Accessories

- Platinum or brass decorative rail and stand-offs
- 38" high classic stainless steel backsplash with or without warming racks
- 6", 12", 18" and 24" classic stainless steel duct covers
- Transitions for 8" and 10" round duct
- Recirculating kit (30" and 36" wide hoods)



Model PW362210R Pro Wall Hood

Accessories are available through your Wolf dealer. To obtain local dealer information, visit the Showroom Locator section of our website, [wolfappliance.com](http://wolfappliance.com).

### Blower Options

- 500 CFM internal blower
- 600 CFM in-line blower
- 600 and 900 CFM remote blowers

Pro low-profile wall hoods are sold as a shell only. An internal, in-line or remote blower is required. For blower recommendations, visit our website, [wolfappliance.com](http://wolfappliance.com).



Recessed Controls



Baffle Filters



## Pro Low-Profile Wall Ventilation Hoods

### Overall Dimensions

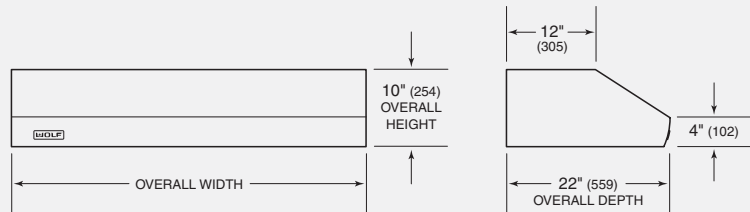

Pro Low-Profile Wall Hood

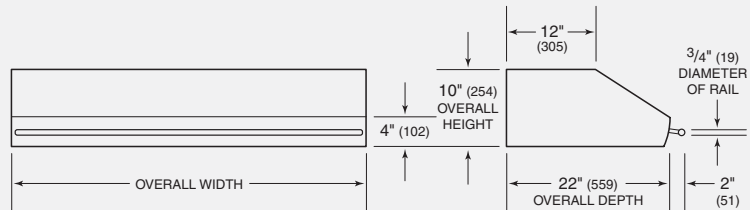

Pro Low-Profile Wall Hood—Rail (R) Model

Unit dimensions may vary by  $\pm 1/8$ ".

### Specifications

Exterior Finish	Classic Stainless Steel
Overall Widths	30", 36", 42" and 48"
Overall Height	10"
Overall Depth (including rail)	22"
Bottom of Hood to Countertop	30" to 36"
Discharge	Vertical or Horizontal
Duct Size (recommended)	10" Round*
Electrical Requirements	110/120 V AC 60 Hz, 15 amp dedicated circuit
Shipping Weight	39–55 lbs

\*Duct size may vary based on blower and transition used.

### Installation Notes

Low-profile wall hoods are sold as a shell only. An internal, in-line or remote blower is required. For blower recommendations, visit our website, [wolfappliance.com](http://wolfappliance.com).

Pro low-profile wall ventilation hoods are recommended for use with all Wolf cooking appliances.

**IMPORTANT NOTE:** For optimal performance, a Pro 27" deep wall hood is recommended for use with ranges and rangetops that contain a charbroiler or griddle.

Complete installation specifications can be found on our website, [wolfappliance.com](http://wolfappliance.com).

### Installation Specifications

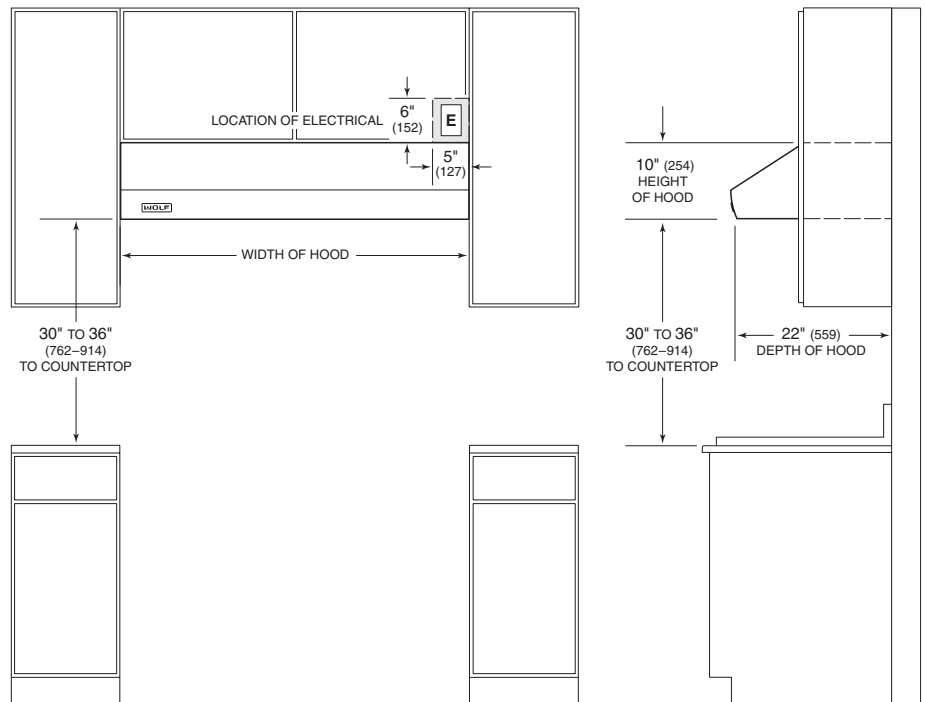

NOTE: Pro low-profile wall hoods have an adjustable discharge.

Dimensions in parentheses are in millimeters unless otherwise specified.

## Free Manuals Download Website

<http://myh66.com>

<http://usermanuals.us>

<http://www.somanuals.com>

<http://www.4manuals.cc>

<http://www.manual-lib.com>

<http://www.404manual.com>

<http://www.luxmanual.com>

<http://aubethermostatmanual.com>

Golf course search by state

<http://golfingnear.com>

Email search by domain

<http://emailbydomain.com>

Auto manuals search

<http://auto.somanuals.com>

TV manuals search

<http://tv.somanuals.com>