

## WOLF CONVECTION MICROWAVE

Taking the experience we've gained from our microwave ovens and combining that with the expertise of convection, Wolf has brought the best of both cooking technologies together in one unit.

This handsome unit comes with trim kits to mount the unit above a 30" (762) or 36" (914) Wolf oven and finish off your cooking tower in a single look. The trim comes in three stainless steel looks—classic, platinum and carbon.

Aside from looking beautiful whether you use it in conjunction with an oven or not, the unit offers you all the performance you would expect from Wolf—a cooking company with a heritage of nearly 75 years in the kitchen.



Model MWC24  
Free-Standing



Model MWC24  
with 30" (762) Trim



Model MWC24  
with 36" (914) Trim

## FEATURES

**Built-in** or free-standing convection microwave oven with 1.5 cu ft (43 L) capacity and 900 watts of power

**30"** (762) or **36"** (914) trim kit allows microwave to be built in to fit above a Wolf built-in oven

**Classic**, platinum or carbon stainless steel trim finishes

**Sensor** cooking

**Slow** cook mode for up to four hours

**Easy-to-operate** control panel and programmable power options

**Interactive** display—99 minutes, 99 seconds

**Menu** label and food guide

**Multi-language**—English, French and Spanish

**Removable** 15<sup>3</sup>/<sub>8</sub>" (391) turntable and turntable support

**Oven** door with window

**Multiple** rack baking

**Safety** door latches—oven will not operate unless the door is closed

**Oven** light comes on when oven is operating or door is open

**Tight** door seals with one-touch door open pad

**Rear** ventilation openings

## CONVECTION MICROWAVE FEATURES

Model MWC24

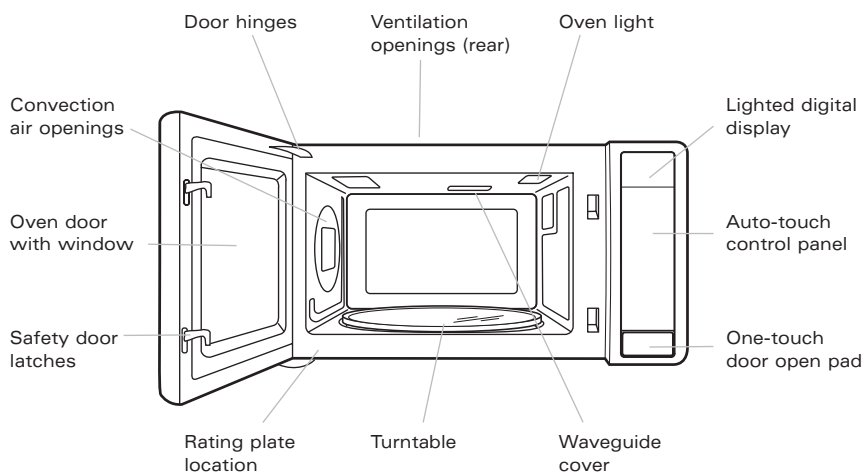



## PLANNING INFORMATION

The Wolf convection microwave oven can be used free-standing or with optional 30" (762) or 36" (914) trim, or can be built in to fit above a Wolf 30" (762) or 36" (914) single oven.

**IMPORTANT NOTE:** In all instances, where the microwave oven is built in, you must use one of Wolf's trim kits to ensure proper ventilation.

The Wolf convection microwave oven with 30" (762) or 36" (914) trim kit will overlap stiles and rails. The trim overlaps for the 30" (762) and 36" (914) trim kits are  $1\frac{3}{16}$ " (21) on the bottom,  $\frac{5}{16}$ " (8) on the top and  $1\frac{3}{16}$ " (30) on each side.

Refer to the installation instructions provided with the trim kit for detailed specifications. These instructions can also be found on the Wolf website at [wolfappliance.com](http://wolfappliance.com).

When using the Wolf convection microwave oven as a free-standing unit, allow 2" (51) of airflow space on top, rear and both sides. A minimum  $20\frac{1}{8}$ " (511) cabinet depth is required.

Specifications on the following pages provide overall dimensions, rough openings and installation options for the convection microwave oven. We have minimized the information contained in the illustrations, concentrating on the critical information you must plan into your installation.

The Wolf convection microwave oven with 30" (762) trim kit may be installed in combination with a 30" (762) single oven and 30" (762) warming drawer with stainless steel drawer front. With the 36" (914) trim kit, the convection microwave may be installed in combination with a 36" (914) single oven and warming drawer with integrated drawer front. Refer to installation options on the following pages.

## ELECTRICAL REQUIREMENTS

The Wolf convection microwave oven requires a separate, grounded 110/120 V AC, 60 Hz power supply. The service should have its own 15 amp circuit breaker, and a grounded 3-prong receptacle should be located within reach of the power cord.

**IMPORTANT NOTE:** A ground fault circuit interrupter (GFCI) is not recommended and may cause interruption of operation.

You must follow all National Electrical Code regulations. In addition, be aware of local codes and ordinances when installing your service.

## WOLF WARRANTY

**Wolf products are covered by a two and five year residential warranty (exclusions apply). See warranty details at the end of this guide.**

## ACCESSORIES

**Optional accessories are available through your Wolf dealer. To obtain local dealer information, visit the Locator section of our website, [wolfappliance.com](http://wolfappliance.com).**

## TRIM KIT OPTIONS

### *Convection Microwave*

#### **30" (762) Stainless Steel Trim**

Classic Trim	<b>MWCTRIM30/S</b>
Platinum Trim	<b>MWCTRIM30/P</b>
Carbon Trim	<b>MWCTRIM30/B</b>

#### **36" (914) Stainless Steel Trim**

Classic Trim	<b>MWCTRIM36/S</b>
Platinum Trim	<b>MWCTRIM36/P</b>
Carbon Trim	<b>MWCTRIM36/B</b>

*Optional trim kits are ordered and shipped as sales accessories.*

*Dimensions in parentheses are in millimeters unless otherwise specified.*



OVERALL DIMENSIONS

Convection Microwave and Trim

SPECIFICATIONS

Convection Microwave (free-standing)

Overall Width	<b>24<sup>3</sup>/<sub>4</sub>" (629)</b>
Overall Height	<b>14<sup>7</sup>/<sub>8</sub>" (378)</b>
Overall Depth	<b>20<sup>1</sup>/<sub>8</sub>" (511)</b>
Interior Oven Cap	<b>1.5 cu ft (43 L)</b>
Interior Oven Dim (W x H x D)	<b>16<sup>1</sup>/<sub>8</sub>" x 9<sup>5</sup>/<sub>8</sub>" x 16<sup>1</sup>/<sub>8</sub>" (410 x 244 x 410)</b>
Electrical Supply	<b>120 V AC, 60 Hz 15 amp dedicated circuit</b>
Power	<b>900 W</b>
Power Requirement (with convection)	<b>1.6 kw</b>
Power Cord	<b>3<sup>1</sup>/<sub>2</sub>' (1.1 m) 3-prong</b>
Shipping Weight	<b>68 lbs (31 kg)</b>

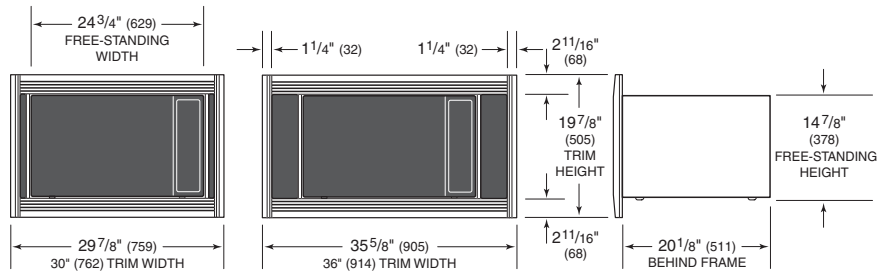

INSTALLATION SPECIFICATIONS

Convection Microwave with 30" (762) Trim  
Wall Application

SPECIFICATIONS

Convection Microwave with 30" (762) Trim

Overall Width	<b>29<sup>7</sup>/<sub>8</sub>" (759)</b>
Overall Height	<b>19<sup>7</sup>/<sub>8</sub>" (505)</b>
Overall Depth	<b>20<sup>1</sup>/<sub>8</sub>" (511)</b>
Rec Cabinet Width	<b>33" (838)</b>
Min Cabinet Width	<b>30" (762)</b>
Min Base Support	<b>125 lbs (57 kg)</b>
Opening Width	<b>27<sup>1</sup>/<sub>2</sub>" (699)</b>
Opening Height	<b>18<sup>11</sup>/<sub>16</sub>" (475)</b>
Opening Depth	<b>20<sup>1</sup>/<sub>8</sub>" (511) min</b>

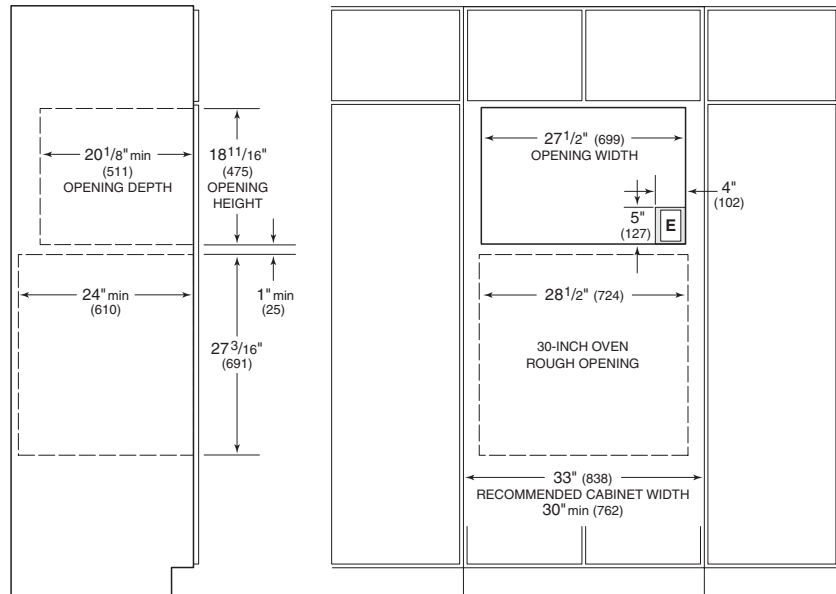

NOTE: At installation, wood cleats must be added to the opening for the microwave trim.

SPECIFICATIONS

Convection Microwave with 36" (914) Trim

Overall Width	<b>35<sup>5</sup>/<sub>8</sub>" (905)</b>
Overall Height	<b>19<sup>7</sup>/<sub>8</sub>" (505)</b>
Overall Depth	<b>20<sup>1</sup>/<sub>8</sub>" (511)</b>
Rec Cabinet Width	<b>39" (991)</b>
Min Cabinet Width	<b>36" (914)</b>
Min Base Support	<b>125 lbs (57 kg)</b>
Opening Width	<b>33<sup>3</sup>/<sub>8</sub>" (854)</b>
Opening Height	<b>18<sup>11</sup>/<sub>16</sub>" (475)</b>
Opening Depth	<b>20<sup>1</sup>/<sub>8</sub>" (511) min</b>

Undercounter Installation

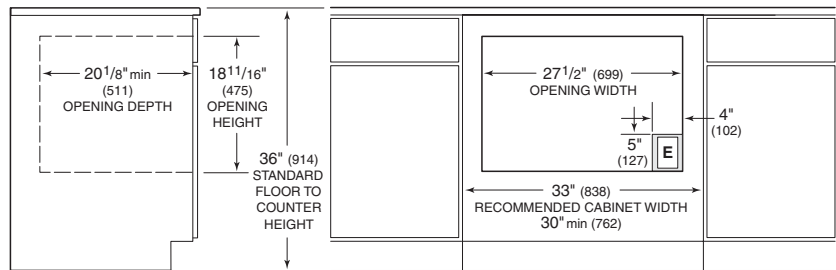

NOTE: At installation, wood cleats must be added to the opening for the microwave trim.

Dimensions may vary to ±1/8" (3).

**IMPORTANT NOTE:** At installation, wood cleats (not included) must be added to the microwave opening for the 30" (762) and 36" (914) trim. Refer to the installation instructions provided with the trim kit for detailed specifications.

**IMPORTANT NOTE:** For installation of the convection microwave with 36" (914) trim, add 6" (152) to the overall width dimensions shown in the illustrations.

INSTALLATION SPECIFICATIONS

Convection Microwave with 30" (762) Trim

Installation with single oven and warming drawer

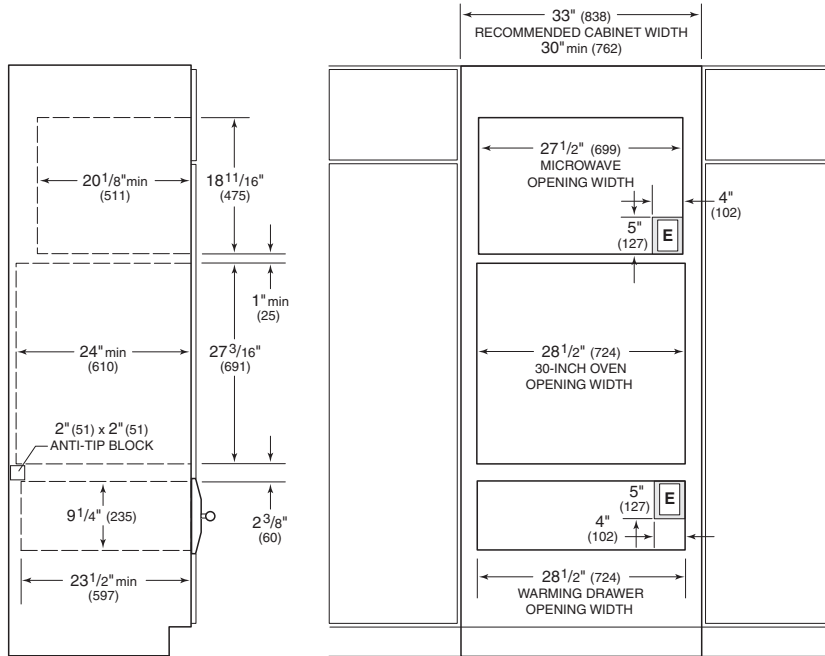

NOTE: Refer to the built-in 30" (762) single oven specifications for electrical location.  
NOTE: At installation, wood cleats must be added to the opening for the microwave trim.

INSTALLATION SPECIFICATIONS

Convection Microwave with 36" (914) Trim

Installation with single oven and warming drawer

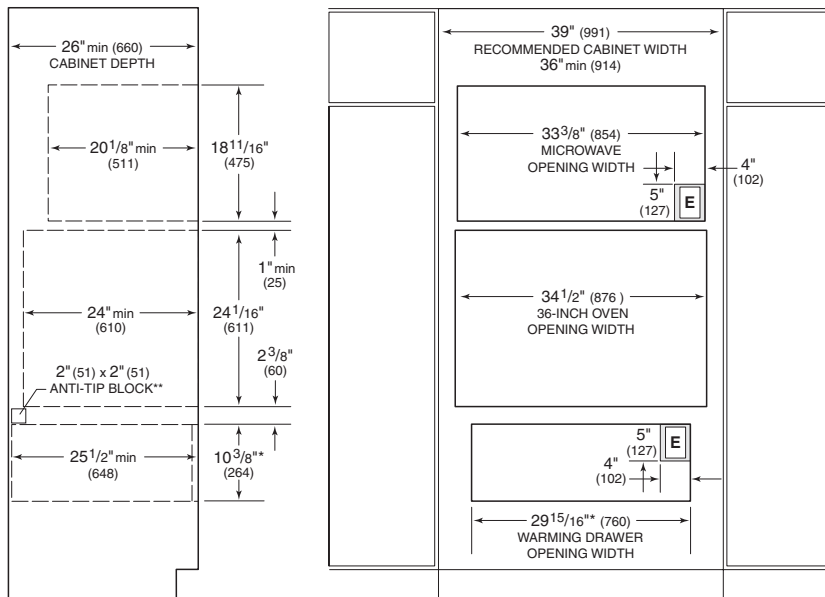

\*Dimension may vary by ± 1/8" (3).  
\*\*Refer to installation instructions provided with the integrated drawer front (WDFRONT/I) for accurate placement of the anti-tip block.  
NOTE: Refer to the built-in 36" (914) single oven specifications for electrical location.  
NOTE: The width of the custom panel for the warming drawer with integrated drawer front will vary according to the specific installation, but the rough opening width will remain 29 15/16" (760).  
NOTE: At installation, wood cleats must be added to the opening for the microwave trim.

Dimensions in parentheses are in millimeters unless otherwise specified.

INSTALLATION OPTIONS

The Wolf convection microwave oven with 30" (762) trim kit may be installed in combination with a 30" (762) single oven and 30" (762) warming drawer with stainless steel drawer front. Refer to page 6 for installation specifications for the 30" (762) single oven.

Refer to the installation instructions provided with each microwave trim kit and warming drawer front for detailed specifications. These instructions can also be found on the Wolf website, wolfappliance.com. Dimensions will vary according to the specific installation.

INSTALLATION OPTIONS

The Wolf convection microwave oven with 36" (914) trim kit may be installed in combination with a 36" (914) single oven and warming drawer with integrated drawer front. Refer to page 7 for installation specifications for the 36" (914) single oven.

Keep in mind that the width of the custom panel for the warming drawer with integrated drawer front will vary according to the specific installation. The rough opening width will remain 29 15/16" (760) whether installed in combination with a 30" (762) or 36" (914) single oven and microwave.

**IMPORTANT NOTE:** In all applications, a minimum 26" (660) deep cabinet is required for the warming drawer with integrated drawer front.

Refer to the installation instructions provided with each microwave trim kit and warming drawer front for detailed specifications. These instructions can also be found on the Wolf website, wolfappliance.com. Dimensions will vary according to the specific installation.

## Free Manuals Download Website

<http://myh66.com>

<http://usermanuals.us>

<http://www.somanuals.com>

<http://www.4manuals.cc>

<http://www.manual-lib.com>

<http://www.404manual.com>

<http://www.luxmanual.com>

<http://aubethermostatmanual.com>

Golf course search by state

<http://golfingnear.com>

Email search by domain

<http://emailbydomain.com>

Auto manuals search

<http://auto.somanuals.com>

TV manuals search

<http://tv.somanuals.com>