

X10[®] Wireless Camera System - *Get Started Quickly!*

1



Unpack these items.

2

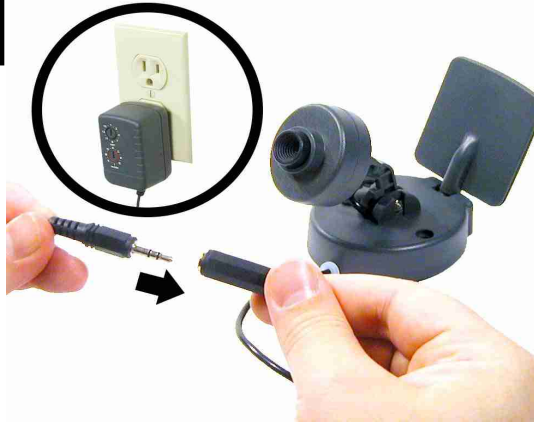

Connect the camera to its power supply and plug it into a wall outlet.

3



Connect the wireless video receiver to power and plug it into a wall outlet.

4



Connect the video receiver to your TV.

5



Turn the video receiver on and flip up the antenna. Point the antenna towards the camera.

6



Select your TV's video input (or try channel 0 and then Channel Down). The camera's picture should appear.



Free Manuals Download Website

<http://myh66.com>

<http://usermanuals.us>

<http://www.somanuals.com>

<http://www.4manuals.cc>

<http://www.manual-lib.com>

<http://www.404manual.com>

<http://www.luxmanual.com>

<http://aubethermostatmanual.com>

Golf course search by state

<http://golfingnear.com>

Email search by domain

<http://emailbydomain.com>

Auto manuals search

<http://auto.somanuals.com>

TV manuals search

<http://tv.somanuals.com>