



LC3

MUSIC LAB

Expansion Kit Installation Guide

Yamaha LC3 Expansion Kit Installation Guide

| Contents | Page |
|---|-------------|
| <hr/> | |
| Chapter 1 | |
| Introducing the LC3 Expansion Kit | 1 |
| Chapter 2 | |
| Installing the LC3 Expansion Kit | 2 |
| Step 1 thru Step 3 | 2 |
| Step 4 thru Step 5 | 3 |
| Step 6 thru Step 9 | 4 |
| Step 10 thru Step 11 | 5 |

Chapter 1

Introducing the LC3 Expansion Kit

The LC3 Expansion Kit allows you to add ports to your Music Teaching Lab System, enabling you to accommodate more students. Each Expansion Kit adds eight ports, which gives you room for an additional eight students in stereo mode or 16 students in split mode.

What's Included

The Expansion Kit includes

- (1) 8-port channel card
- (8) Instrument Boxes (SB-2)
- (8) Headsets with microphones
- (8) RJ45 lab connector cables
- (8) 1/4" stereo cables
- (5) Aluminum spacers

Chapter 2

Installing the LC3 Expansion Kit(s)

Installing the Kit is straightforward and can be done by anyone with basic technical knowledge and a screwdriver.

Step 1

If the LC3 is installed, turn it off and remove all cables connected to the Expansion Kit. If the RJ45 cables plugged into the Instrument Boxes are not labeled, it is recommended that you label them before removing them from the system in order to make the process of reconnecting them later much easier.

Step 2

Remove the seven black screws from the top panel, seven black screws from the back panel and four screws from the RCA connectors on the back panel as shown in the diagram.

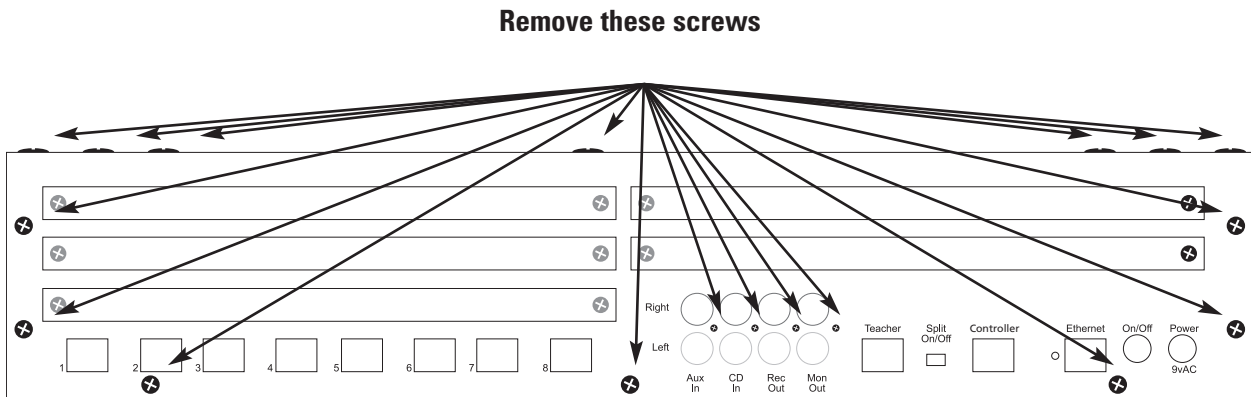

Lab Hub Rear Panel

Step 3

Lift and remove the top/rear panel from the Lab Hub.

Step 4

Install the Channel Circuit Board from the Expansion Kit into the Lab Hub by inserting the pin end into the connector on the back panel. Make sure that the holes for the spacers on the Channel Circuit Board line up correctly with the silver spacers.

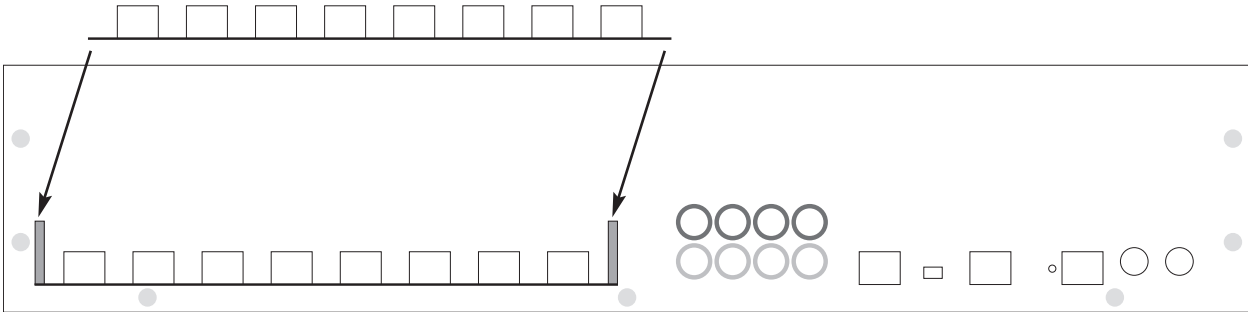

Step 5

Install the five spacers into the holes in the new Channel Circuit Board to secure it to the Channel Board below it. Add any additional Channel Circuit Boards.

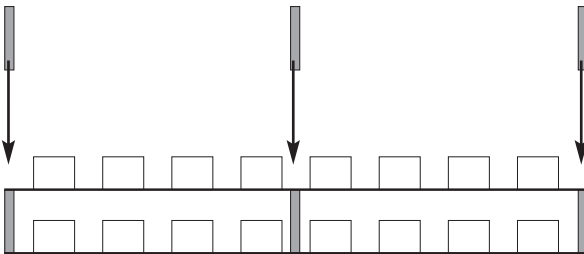

Step 6

Remove the blank plates covering the newly populated connectors.

Remove these screws as needed

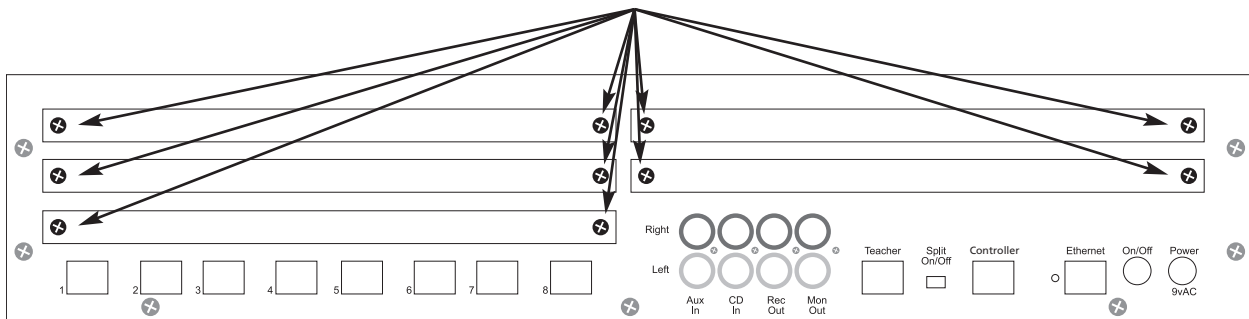

Step 7

Replace the cover and all the screws.

Step 8

Replace all the cables that were unplugged at the beginning of this installation. Make sure that the power is still switched off.

Step 9

Place the new Instrument Boxes with the desired instruments. Plug one end of the instrument cable into the headphone output on the piano and the other end into the Instrument Box INSTRUMENT IN connector. Plug the supplied student headset into the Instrument Box HEADSET and MIC connectors. For best results, set the volume on the instruments to maximum and adjust the trimmer on the side of the Instrument Boxes to a safe, comfortable level for the headsets. Repeat this process until all the instruments are connected to an Instrument Box.

Step 10

Connect the new Instrument Box to the newly added Channel Circuit Board connectors using the provided RJ45 cables.

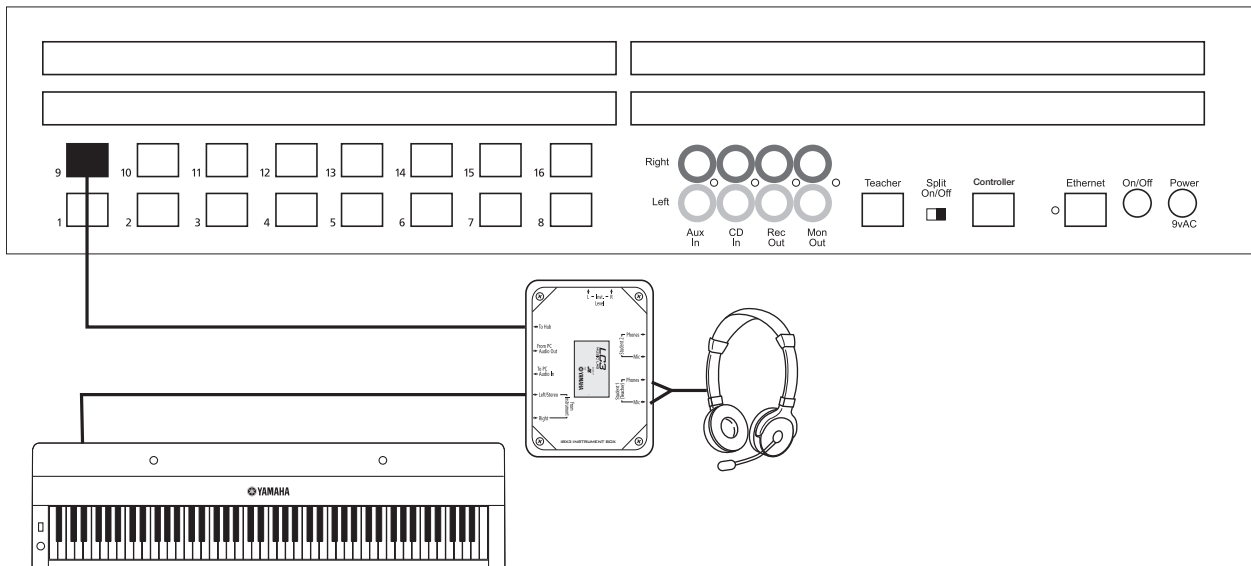

Step 11

You're done. Power up the system. You can select the new students by pressing the BANK button on the Controller. For more information about using the system, refer to the *LC3 Operation Guide*.



©2009 Yamaha Corporation of America. All rights reserved.
www.yamaha.com/LC3

Free Manuals Download Website

<http://myh66.com>

<http://usermanuals.us>

<http://www.somanuals.com>

<http://www.4manuals.cc>

<http://www.manual-lib.com>

<http://www.404manual.com>

<http://www.luxmanual.com>

<http://aubethermostatmanual.com>

Golf course search by state

<http://golfingnear.com>

Email search by domain

<http://emailbydomain.com>

Auto manuals search

<http://auto.somanuals.com>

TV manuals search

<http://tv.somanuals.com>