

GB User manual

2

Dishwasher

USER MANUAL

ZANUSSI

Get Living!

ZDT311

Contents

Safety information _____	2	Multitab function _____	11
Control panel _____	3	Setting and starting a washing programme _____	11
Washing programmes _____	5	Care and cleaning _____	12
Use of the appliance _____	6	What to do if... _____	13
Setting the water softener _____	6	Technical data _____	15
Use of dishwasher salt _____	7	Environment concerns _____	15
Use of rinse aid _____	8	Installation _____	16
Loading cutlery and dishes _____	8	Water connection _____	16
Use of detergent _____	10	Electrical connection _____	17

Subject to change without notice



Safety information

i For your safety and correct operation of the appliance, read this manual carefully before installation and use. Always keep these instructions with the appliance even if you move or sell it. Users must fully know the operation and safety features of the appliance.

Correct use

- The appliance is designed exclusively for domestic use.
- Only use the appliance to clean household utensils that are applicable for dishwashers.
- Do not put solvents in the appliance. Risk of explosion.
- Put the knives and all items with sharp points in the cutlery basket with their points down. If not, put in a horizontal position in the upper basket.
- Use only branded products for dishwashers (detergent, salt, rinse aid).
- If you open the door while the appliance is in operation, hot steam can escape. Risk of skin burns.
- Do not remove dishes from the dishwasher before the end of the washing programme.
- When the washing programme is completed, disconnect the mains plug from the mains socket and close the water tap.
- Only an authorised service engineer can repair this appliance. Use only original spare parts.
- Do not do repairs yourself to prevent injury and damage to the appliance. Always contact your local Service Force Centre.

General safety

- Persons (including children) with reduced physical sensory, mental capabilities or lack of experience and

knowledge must not use the appliance. They must have supervision or instruction for the operation of the appliance by a person responsible for their safety.

- Obey the safety instructions from the manufacturer of the dishwasher detergent to prevent burns to eyes, mouth and throat.
- Do not drink the water from the dishwasher. Detergent residues can stay in your appliance.
- Always close the door when you do not use the appliance to prevent injury and not to stumble over the open door.
- Do not sit or stand on the open door.

Child safety

- Only adults can use this appliance. Children must get supervision to make sure that they do not play with the appliance.
- Keep all the packaging away from children. There is a risk of suffocation.
- Keep all detergents in a safe area. Do not let children touch the detergents.
- Keep children away from the appliance when the door is open.

Installation

- Make sure that the appliance is not damaged because of transport. Do not connect a damaged appliance. If necessary, contact the supplier.
- Remove all packaging before first use.
- A qualified and competent person must do the electrical installation.
- A qualified and competent person must do the plumbing installation.

- Do not change the specifications or modify this product. Risk of injury and damage to the appliance.
- Do not use the appliance:
 - if the mains cable or water hoses are damaged,
 - if the control panel, worktop or plinth area are damaged, that you can get access to the inner side of the appliance.

Contact your local Service Force Centre.

- Do not drill into the sides of the appliance to prevent damage to hydraulic and electrical components.



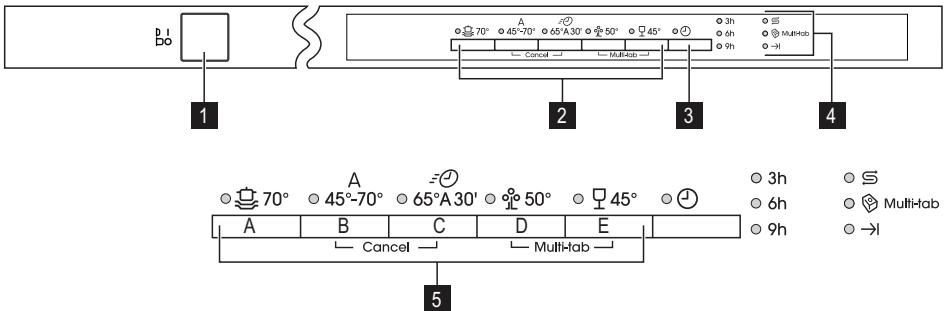

Warning! Carefully obey the instructions for electrical and water connections.

Control panel



- 1 On/off button
- 2 Programme selection buttons
- 3 Delay start button
- 4 Indicator lights
- 5 Function buttons

Indicator lights

 1)	<p>The indicator light comes on when it is necessary to fill the salt container. Refer to the chapter 'Use of dishwasher salt'.</p> <p>The salt indicator light can stay on for some hours, but it does not have an unwanted effect on the operation of the appliance.</p>
 Multi-hab	<p>The indicator light shows the activation/deactivation of the multitab function. Refer to the chapter 'Multitab function'.</p>

Indicator lights



The indicator light comes on when the washing programme is completed. Auxiliary functions:

- Level of the water softener.
- Activation/deactivation of the audible signals.
- Activation/deactivation of the rinse aid dispenser.
- An alarm if the appliance has a malfunction.

1) The indicator light is off while a washing programme operates.

Function buttons

Use the function buttons for these operations:

- To set the water softener. Refer to the chapter 'Setting the water softener'.
- To deactivate/activate the audible signals. Refer to the section 'Audible signals'.
- To activate/deactivate the multitab function. Refer to the chapter 'Multitab function'.
- To deactivate/activate the rinse aid dispenser when multitab function is active. Refer to the chapter 'Multitab function'.
- To cancel the washing programme in progress or a delay start in progress. Refer to the chapter 'Setting and starting a washing programme'.

Delay start button

Use the delay start button to delay the start of the washing programme with an interval of 3, 6 or 9 hours. Refer to the chapter 'Setting and starting a washing programme'.

Setting mode

The appliance is in setting mode when all the programme indicator lights are on.

The appliance must be in setting mode for these operations:

- To set a washing programme.
- To set the water softener level.
- To deactivate/activate the audible signals.
- To deactivate/activate the rinse aid dispenser.

If a programme indicator light is on, cancel the programme to go back to the setting mode. Refer to the chapter "Setting and starting a washing programme".

Audible signals

You can hear an audible signal:

- At the end of the washing programme.
- During the setting of the level of the water softener.
- When the appliance has a malfunction.

The activation of the audible signals is set at the factory.

Do these steps to deactivate the audible signals:





1. Switch on the appliance.
2. Make sure that the appliance is in setting mode.
3. Press and hold function buttons B and C until the indicator lights of function buttons A, B and C start to flash.
4. Press the function button C.
 - Indicator lights for function buttons A and B go off.
 - Indicator light for function button C starts to flash.
 - The end indicator light comes on. The audible signals are activated.
5. Press the function button C again.
 - The end indicator light goes off. The audible signals are deactivated.
6. Switch off the appliance to save the operation.

Do these steps to activate the audible signals:

1. Do the above procedure until the end indicator light comes on.

Washing programmes

Washing programmes





Programme	Degree of soil	Type of load	Programme description
	Heavy soil	Crockery, cutlery, pots and pans	Prewash Main wash up to 70°C 2 intermediate rinses Final rinse Drying
A ¹⁾	Any	Crockery, cutlery, pots and pans	Prewash Main wash up to 45°C or 70°C 1 or 2 intermediate rinses Final rinse Drying
 ²⁾	Normal or light soil	Crockery and cutlery	Main wash up to 65°C Final rinse
 ³⁾	Normal soil	Crockery and cutlery	Prewash Main wash up to 50°C 1 intermediate rinse Final rinse Drying
	Normal or light soil	Delicate crockery and glassware	Main wash up to 45°C 1 intermediate rinse Final rinse Drying

1) During the Auto programme, the soil level of the dishes is given by how cloudy the water is. The programme duration and consumptions can change. This depends if the appliance is fully or not and on the level of soil on the dishes. The appliance adjusts automatically the temperature of the water during the main wash.

2) This is the perfect daily programme to clean a not fully load. Ideal for a family of 4 persons who only want to load breakfast and dinner crockery and cutlery.

3) Test programme for test institutes. Please refer to separate leaflet supplied, for test data.

Consumption values

Programme	Duration (in minutes)	Energy (in kWh)	Water (in litres)
	80-90	1,6-1,8	22-24
A	90-130	1,1-1,7	12-23
	30	0,9	9
	150-160	1,0-1,1	14-15
	60-70	0,8-0,9	14-15

 The pressure and temperature of the water, the variations of power supply and the quantity of dishes can change these values.

Use of the appliance

Refer to the following instructions for each step of procedure:

1. Make a check if the water softener level is correct for the water hardness in your area. If necessary set the water softener.
2. Fill the salt container with dishwasher salt.
3. Fill the rinse aid dispenser with rinse aid.
4. Load cutlery and dishes into the dishwasher.

5. Set the correct washing programme for the type of load and soil.
6. Fill the detergent dispenser with the correct quantity of detergent.
7. Start the washing programme.



If you use detergent tablets, refer to the chapter 'Use of detergent'.

Setting the water softener

The water softener removes minerals and salts from the water supply. Minerals and salts can have bad effect on the operation of the appliance.

Water hardness is measured in equivalent scales:

- German degrees (dH°).
- French degrees (°TH).

- mmol/l (millimol per litre - international unit for the hardness of water).

- Clarke.

Adjust the water softener to the water hardness in your area. If necessary, contact your local water authority.

Water hardness				Water hardness setting	
°dH	°TH	mmol/l	Clarke	manually	electronically
51 - 70	91 - 125	9,1 - 12,5	64 - 88	2	10
43 - 50	76 - 90	7,6 - 9,0	53 - 63	2	9
37 - 42	65 - 75	6,5 - 7,5	46 - 52	2	8
29 - 36	51 - 64	5,1 - 6,4	36 - 45	2	7
23 - 28	40 - 50	4,0 - 5,0	28 - 35	2	6
19 - 22	33 - 39	3,3 - 3,9	23 - 27	2	5
15 - 18	26 - 32	2,6 - 3,2	18 - 22	1	4
11 - 14	19 - 25	1,9 - 2,5	13 - 17	1	3
4 - 10	7 - 18	0,7 - 1,8	5 - 12	1	2
< 4	< 7	< 0,7	< 5	1 ¹⁾	1 ¹⁾

1) No use of salt required.

You must set the water softener manually and electronically.

Manual adjustment

The appliance is set at the factory at position 2.

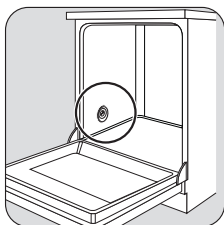

1

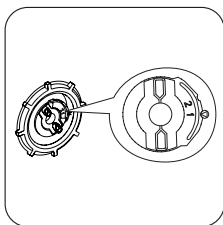

2

Set switch to position 1 or 2.

Electronic adjustment

The water softener is set at the factory at level 5.

1. Switch on the appliance.
2. Make sure that the appliance is in setting mode.
3. Press and hold function buttons B and C until the indicator lights for function buttons A, B and C start to flash.

4. Release function buttons B and C.
5. Press function button A.
 - The indicator light for function button A continues to flash.
 - The indicator lights for function buttons B and C go off.
 - The end indicator light starts to flash.
 - You can hear an audible signal.
 The setting function of the water softener is activated. The end indicator light flashes and an audible signal operates to show the level of the water softener. The pause is approximately 3 seconds.
 Example: 5 flashes / 5 intermittent audible signals - pause - 5 flashes / 5 intermittent audible signals - pause - etc... = level 5
6. Press the function button A one time to increase the water softener level by one step.
7. Press the on/off button to save the operation.

Use of dishwasher salt

! Caution! Only use dishwashers salt. Types of salt that are not applicable for dishwashers cause damage to the water softener.

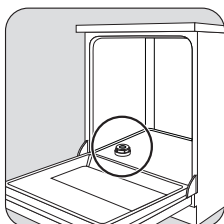

1

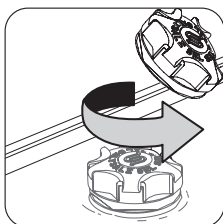

2



3

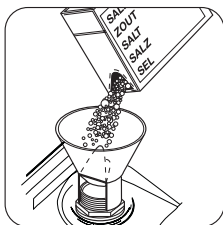

4

Fill the salt container with 1 litre of water (only the first operation).

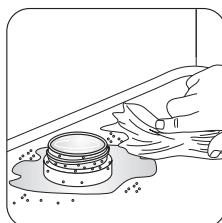

5

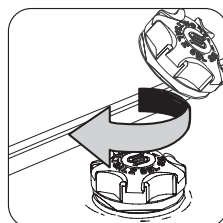

6

- i** It is normal that water overflows from the salt container when you fill it with salt.
- i** Make sure that there is no grain of salt outer of the salt compartment. Salt which stays on the tank for a while drills the tank. It is recommended to start a washing programme immediately after you fill the salt container. This prevents of corrosion because of spilled salt.

When you set electronically the water softener to level 1, the salt indicator light does not stay on.

Use of rinse aid

! **Caution!** Only use branded rinse aid for dishwashers.

Do these steps to fill the rinse aid dispenser:

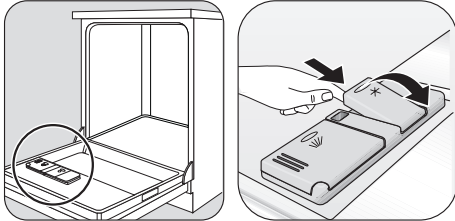

1

2

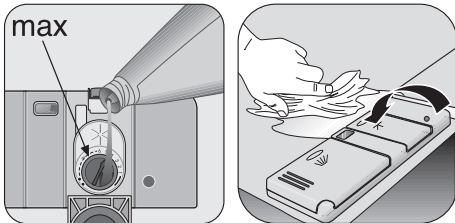

3

4

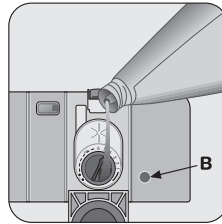

5

Fill when the rinse aid indicator (B) becomes clear.

! **Caution!** Do not fill the rinse aid dispenser with other products (e.g. dishwasher cleaning agent, liquid detergent). There is a risk of damage to the appliance.

Adjusting the dosage of rinse aid

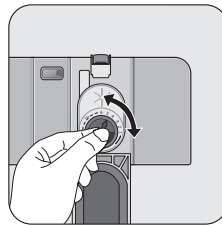

The rinse aid dial is set at the factory at position 4. To increase or decrease the dosage refer to 'What to do if...'

Loading cutlery and dishes

Helpful hints and tips

! **Caution!** Only use the appliance for household utensils that are applicable for dishwashers.

Do not use the appliance to clean objects that can absorb water (sponges, household cloths, etc.).

- Before you load cutlery and dishes, do these steps:
 - Remove all food remainings and debris.
 - Make burnt, remaining food in pans soft.
- While you load cutlery and dishes, do these steps:
 - Load hollow items (e.g. cups, glasses and pans) with the opening down.
 - Make sure that water does not collect in the container or in a deep base.
 - Make sure that cutlery and dishes do not lie inside one another.

- Make sure that cutlery and dishes do not cover other cutlery and dishes.
- Make sure that glasses do not touch other glasses.
- Put small objects in the cutlery basket.
- Plastic items and pans with non-stick coatings can keep water droplets. Plastic items do not dry as well as porcelain and steel items.
- Put light items in the upper basket. Make sure that the items do not move.

! **Caution!** Make sure that the spray arms can move freely before you start a washing programme.

! **Warning!** Always close the door after you load or unload the appliance. An open door can be dangerous.

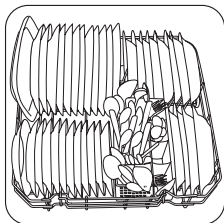

1
Arrange service dishes and large lids around the edge of the lower basket.

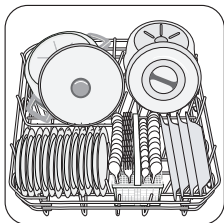

2

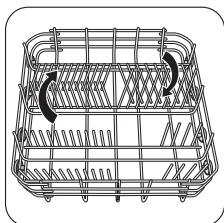

3
The rows of prongs in the lower basket can be flat to load pots, pans and bowls.

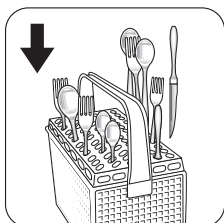

1

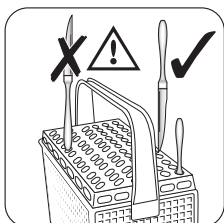

2

i Use the cutlery grid. If the dimensions of the cutlery prevent use of the cutlery grid, remove it.

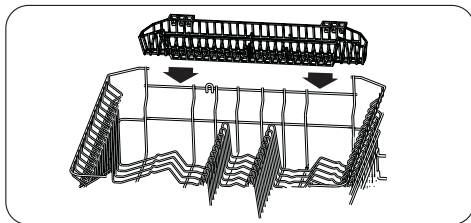

Put long-bladed knives and long or sharp items in the knife basket. The knife basket is in the rear part of the upper basket and, if necessary, can be removed.

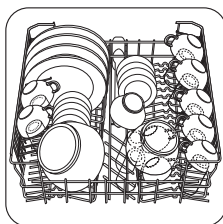

1

Arrange the items to let water touch all surfaces.

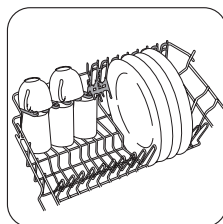

2

For longer items fold the cup racks up.

i Prevent to put plates in the first three sections in the front part of the upper basket. Make sure the plates tilt forward.

Adjustment of the height of the upper basket

If you put large plates in the lower basket, first move the upper basket to an upper position.

! **Warning!** Adjust the height before you load the upper basket.

Maximum height of the dishes in :

	upper basket	lower basket
Upper position	20 cm	31 cm
Lower position	24 cm	27 cm

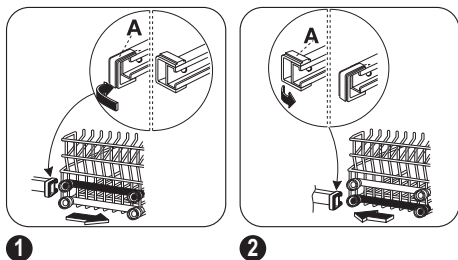

Do these steps to move the upper basket to the upper or lower position:

1. Move the front runner stops (A) out.
2. Pull the basket out.
3. Put the basket in the upper or lower position.
4. Replace the front runner stops (A) in their initial position.

! **Caution!** If the basket is in the upper position, do not put cups on the cup racks.

Use of detergent

i Only use detergents (powder, liquid or tablet) that are applicable for dishwashers.

Follow the data on the packaging:

- Dosage recommended by the manufacturer.
- Storage recommendations.

🌿 Do not use more than the correct quantity of detergent to save an environment.

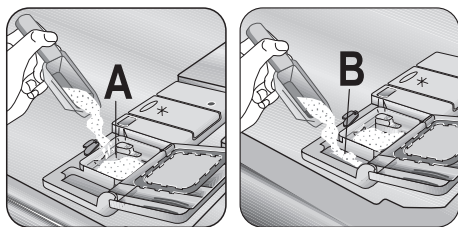
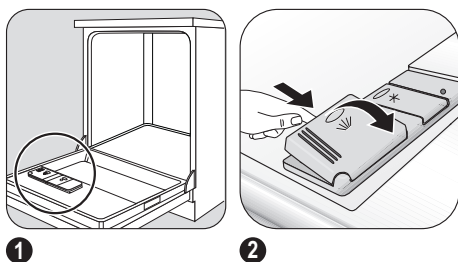
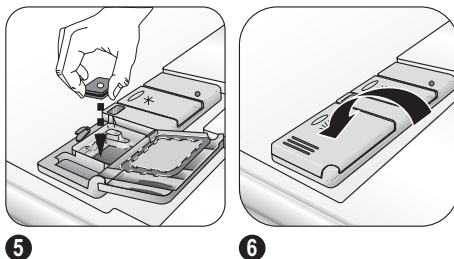

3 Fill the detergent dispenser (A) with detergent.

4 If you use a washing programme with prewash phase, put more detergent in the prewash detergent compartment (B).

i Different brands of detergent dissolve in different times. Some detergent tablets do not have the best cleaning results during short washing programmes. Use long washing programmes when you use detergent tablets to fully remove the detergent.

Multitab function

The multitab function is for combi detergent tablets. These tablets contain agents such as detergent, rinse aid and dishwasher salt. Some types of tablets can contain other agents.

Do a check if these tablets are applicable for the local water hardness. Refer to the instructions from the manufacturer. When you set the multitab function, it stays on until you deactivate it.

The multitab function stops automatically the flow of rinse aid and salt. The rinse aid indicator light and salt indicator light are deactivated.

The programme duration can increase if you use the multitab function.

 Activate or deactivate the multitab function before the start of a washing programme.

You cannot activate or deactivate the multitab function when the programme operates. Cancel the washing programme, then set the programme again.

To activate the multitab function:

- Press and hold the two multitab buttons (function buttons D and E). The multitab indicator light comes on.

To deactivate the multitab function:

- Press and hold the two multitab buttons (function buttons D and E). The multitab indicator light goes off.

 **Do these steps if the drying results are not satisfactory:**

1. Fill the rinse aid dispenser with rinse aid.
2. Activate the rinse aid dispenser.
3. Set the rinse aid dosage to position 2.

Setting and starting a washing programme

 Set the washing programme with the door ajar. The washing programme only starts after you close the door. Until then it is possible to modify the settings.

Do these steps to set and start a washing programme:

1. Switch on the appliance.
2. Make sure that the appliance is in setting mode.
3. Press one of the programme buttons. Refer to the chapter 'Washing programmes'.
 - The programme indicator light comes on.
4. Close the door.
 - The washing programme starts.

- You can only activate or deactivate the rinse aid dispenser when the multitab function is activated.

To activate the rinse aid dispenser:

1. Switch on the appliance.
2. Make sure that the appliance is in setting mode.
3. Press and hold function buttons B and C.
 - The indicator lights for function buttons A, B, and C start to flash.
4. Press function button B.
 - The indicator lights for function buttons A and C go off.
 - The indicator light for function button B continues to flash.
5. Press function button B again.
 - The end indicator light comes on.
6. Switch off the appliance to save the operation.

To deactivate the rinse aid dispenser do the above steps until the end indicator light goes off.

 To use normal detergent again:

1. Deactivate the multitab function.
2. Fill the salt container and rinse aid dispenser.
3. Adjust the water hardness setting to the highest level.
4. Do a washing programme without dishes.
5. Adjust the water softener to the water hardness in your area.
6. Adjust the rinse aid dosage.

 When the washing programme operates, you cannot change the programme. Cancel the washing programme.

 **Warning!** Only interrupt or cancel a washing programme if necessary.

 **Caution!** Open the door carefully. Hot steam can come free.

Canceling a washing programme

1. Press and hold function buttons B and C until all the programme lights come on.

2. Release function buttons B and C to cancel the washing programme.

At this time you can do these steps:

1. Switch off the appliance.
2. Set a new washing programme .

Fill the detergent dispenser with detergent before you set a new washing programme.

Interrupting a washing programme

Open the door.

- The programme stops.

Close the door.

- The programme continues from the point of interruption.

Setting and starting a washing programme with delay start

1. Press the on/off button.
2. Set a washing programme.
 - The programme indicator light comes on.
3. Press the delay start button until the indicator light with the correct number of hours starts to flash (3, 6, or 9 hours).
4. Close the door.
 - The countdown of the delay start starts.
 - The countdown of the delay start decreases with steps of 3 hours.When the countdown is completed, the washing programme starts automatically.

 Do not open the door during the countdown to pre-

vent interruption of the countdown. When you close the door again, the countdown continues from the point of interruption.

Cancelling a delay start:

1. Press and hold function buttons B and C until all the programme lights come on.
 - When you cancel a delay start, you also cancel the washing programme.
2. Set a new washing programme.

End of the washing programme

Switch off the appliance in these conditions:

- The appliance stops automatically.
 - The audible signals for the end of the programme operate.
1. Open the door.
 - The end indicator light comes on.
 - The programme indicator light stays on.
 2. Press the on/off button.
 3. For better drying results, keep the door ajar for some minutes before you remove the dishes.

Let the dishes cool down before you remove them from the appliance. Hot dishes are easily damaged.

Removing the load

- First remove items from the lower basket, then from the upper basket.
- There can be water on the sides and door of the appliance. Stainless steel becomes cool more quickly than the dishes.

Care and cleaning

 **Warning!** Switch the appliance off before you clean the filters.

Cleaning the filters

Important! Do not use the appliance without the filters. Make sure that the installation of the filters is correct. Incorrect installation will cause unsatisfactory washing results and damage to the appliance.

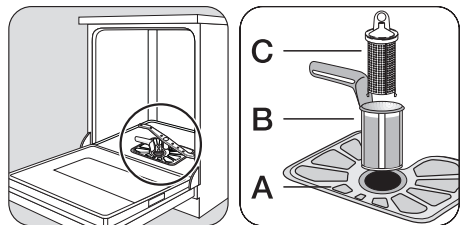

1

2

Fully clean the filters A, B and C below running water.

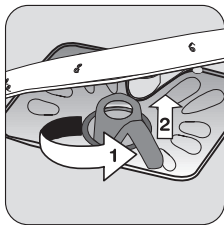

3 To remove filters B and C, turn the handle approximately 1/4 anticlockwise.

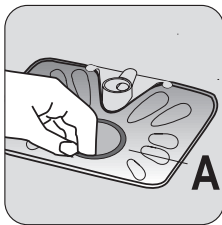

4 Remove the flat filter A from the bottom of the appliance.

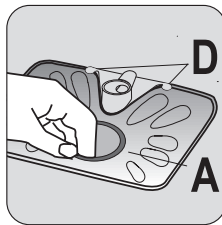

5 Put the flat filter A in the bottom of the appliance. Install the flat filter correctly under the two guides D.

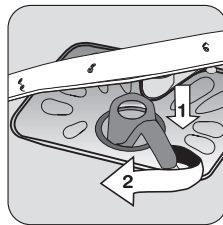

6 Put the filter system in position. To lock the filter system, turn the handle clockwise until it locks in position.

Important! Do not remove the spray arms.

If the holes in the spray arms become clogged, remove remaining parts of soil with a cocktail stick.

External cleaning

Clean the external surfaces of the appliance and control panel with a damp soft cloth. Only use neutral detergents. Do not use abrasive products, scouring pads or solvents (acetone, trichloroethylene etc...).

Frost precautions

 **Caution!** Do not install the appliance where the temperature is below 0 °C. The manufacturer is not responsible for damage because of frost.

If not possible, empty the appliance and close the door. Disconnect the water inlet hose and remove water from the water inlet hose.

What to do if...

The appliance does not start or stops during operation.

If there is a fault, first try to find a solution to the problem yourself. If you cannot find a solution to the problem yourself, contact the Service Force Centre.

Fault code and malfunction	Possible cause and solution
<ul style="list-style-type: none"> • continuous flash of the light of the running programme • intermittent audible signal • 1 flash of the end indicator light <p>The dishwasher does not fill with water</p>	<ul style="list-style-type: none"> • The water tap is blocked or furred with limescale. Clean the water tap. • The water tap is closed. Open the water tap. • The filter in the water inlet hose is blocked. Clean the filter. • The connection of the water inlet hose is not correct. The hose can be kinked or squashed. Make sure that the connection is correct.
<ul style="list-style-type: none"> • continuous flash of the light of the running programme • intermittent audible signal • 2 flashes of the end indicator light <p>The dishwasher will not drain</p>	<ul style="list-style-type: none"> • There is a blockage in the sink spigot. Clean the sink spigot. • The connection of the water drain hose is not correct. The hose can be kinked or squashed. Make sure that the connection is correct.
<ul style="list-style-type: none"> • continuous flash of the light of the running programme • intermittent audible signal • 3 flashes of the end indicator light <p>The anti-flood device operates</p> <p>The programme does not start</p>	<ul style="list-style-type: none"> • Close the water tap and contact your local Service Force Centre. • The appliance door is not closed. Close the door. • Mains plug is not connected in. Put in the mains. • The fuse has blown out in the household fuse box. Replace the fuse. • Delay start is set. Cancel the delay start to start the programme immediately.

After the check, switch on the appliance. The programme continues from the point of interruption. If the malfunction shows again, contact your Service Force Centre. These data are necessary to help you quickly and correctly:

- Model (Mod.)
- Product number (PNC)

- Serial number (S.N.)
- For these data, refer to the rating plate.
Write the necessary data here:
Model description :
Product number :
Serial number :

The cleaning results are not satisfactory

The dishes are not clean	<ul style="list-style-type: none"> • The selected washing programme is not applicable for the type of load and soil. • The baskets are loaded incorrectly so that water cannot reach all surfaces. • Spray arms do not turn freely because of incorrect arrangement of the load. • The filters are dirty or not correctly installed. • The quantity of detergent is too little or missing.
Limescales particles on the dishes	<ul style="list-style-type: none"> • The salt container is empty. • The water softener is adjusted on a wrong level. • The salt container cap is not closed correctly.
The dishes are wet and dull	<ul style="list-style-type: none"> • No rinse aid has been used. • The rinse aid dispenser is empty.
There are streaks, milky spots or a bluish coating on glasses and dishes	<ul style="list-style-type: none"> • Decrease the rinse aid dosage.
Dry water drop signs on glasses and dishes	<ul style="list-style-type: none"> • Increase rinse aid dosage. • The detergent can be the cause.

Technical data

Dimensions	Width cm	59,6
	Height cm	81,8-87,8
	Depth cm	55,5
Electrical connection - Voltage - Overall power - Fuse	Information on the electrical connection is given on the rating plate on the inner edge of the dishwasher door.	
Water supply pressure	Minimum	0,5 bar (0,05 MPa)
	Maximum	8 bar (0,8 MPa)
Capacity	Place settings	12

Environment concerns

The symbol  on the product or on its packaging indicates that this product may not be treated as household waste. Instead it should be taken to the appropriate collection point for the recycling of electrical and electronic equipment. By ensuring this product is disposed of correctly, you will help prevent potential negative consequences for the environment and human health, which could otherwise be caused by inappropriate waste handling of this product. For more detailed

information about recycling of this product, please contact your local council, your household waste disposal service or the shop where you purchased the product.

The packaging materials are environmentally friendly and can be recycled. The plastic components are identified by markings, e.g. >PE<, >PS<, etc. Discard the packaging materials in the applicable container at the community waste disposal facilities.

Warning! To discard the appliance, follow the procedure:

- Pull the mains plug out of the socket.
- Cut off the mains cable and mains plug and discard them.

- Discard the door catch. This prevents the children to close themselves inside the appliance and endanger their lives.

Installation

Warning! Make sure that mains plug is disconnected from the mains socket during installation.

Important! Obey the instructions in the enclosed template to:

- Build-in the appliance.
- Install the furniture panel.
- Connect to the water supply and drain.

Install the appliance under a counter (kitchen worktop or sink).

If a repair is necessary, the appliance must be easily accessible for the engineer.

Put the appliance adjacent to a water tap and a drain.

For the venting of the dishwasher only water fill, water drain and power supply cable openings are necessary.

The dishwasher has adjustable feet to allow the adjustment of the height.

Make sure that the water inlet hose, the drain hose and the supply cable are not kinked or squashed, when you insert the machine.

Attaching the appliance to the adjacent units

Make sure that the counter below which you attach the appliance is a safe structure (adjacent kitchen units, cabinets, wall).

Adjusting the level of the appliance

Make sure that the appliance is level to close and seal the door correctly. If the level of the appliance is correct, the door does not catch on the sides of the cabinet. If the door does not close correctly, loosen or tighten the adjustable feet until the appliance is level.

Water connection

Water inlet hose

Connected the appliance to a hot (max. 60°) or cold water supply.

If the hot water comes from alternative sources of energy that are more environmentally friendly (e.g. solar or photovoltaic panels and aeolian), use a hot water supply to decrease energy consumption.

Connect the inlet hose to a water tap with an external thread of 3/4".

Caution! Do not use connection hoses from an old appliance.

The water pressure must be in the limits (refer to the chapter 'Technical data'). Make sure that the local water authority gives you the average mains pressure in your area.

Make sure that there are no kinks in the water inlet hose and that the water inlet hose is not squashed or entangled. Turn the inlet hose to the left or the right to suit the installation. Fit the locknut correctly to prevent water leaks.

Caution! Do not connect the appliance to new pipes or pipes that are not used for a long time. Let the water run for some minutes, then connect the inlet hose.

Water inlet hose with safety valve

The water inlet hose is a double-walled and has an inner mains cable and a safety valve. The water inlet hose is under pressure only while the water is running. If there is a leak in the water inlet hose, the safety valve interrupts the running water.

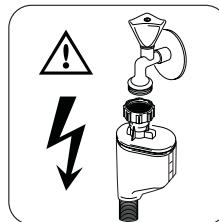

Warning! Dangerous voltage

Be careful when you connect the water inlet hose:

- Do not put the water inlet hose or the safety valve in water.
- If the water inlet hose or the safety valve is damaged, immediately disconnect the mains plug from the mains socket.
- Only let the Service Force Centre replace the water inlet hose with safety valve.

Drain hose

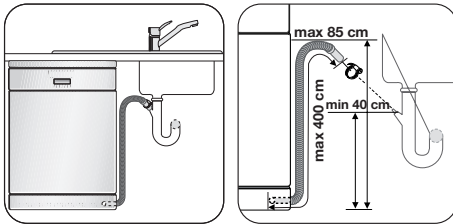

1
Connect the water drain hose to the sink spigot.

2

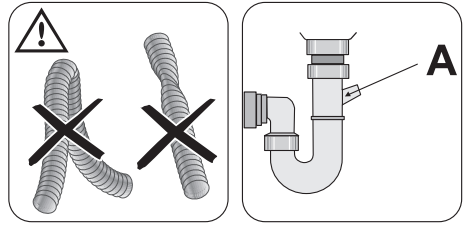

3

4

The internal diameter must not be smaller than the diameter of the hose.

If you connect the water drain hose to a trap spigot under the sink, remove the plastic membrane (A). If you do not remove the membrane, remaining food can cause a blockage in the drain hose spigot.

! **Caution!** Make sure that the water couplings are tight to prevent water leakage.

Electrical connection

! **Warning!** The manufacturer is not responsible if you do not follow these safety precautions. Ground the appliance according to safety precautions. Make sure that the rated voltage and type of power on the rating plate agree with the voltage and the power of the local power supply. Always use a correctly installed shockproof socket. Do not use multi-way plugs, connectors and extension cables. There is a risk of fire.

Do not replace the mains cable yourself. Contact the Service Force Centre. Make sure that the mains plug is accessible after installation. Do not pull the mains cable to disconnect the appliance. Always pull the mains plug.

156950310-00-022009



Free Manuals Download Website

<http://myh66.com>

<http://usermanuals.us>

<http://www.somanuals.com>

<http://www.4manuals.cc>

<http://www.manual-lib.com>

<http://www.404manual.com>

<http://www.luxmanual.com>

<http://aubethermostatmanual.com>

Golf course search by state

<http://golfingnear.com>

Email search by domain

<http://emailbydomain.com>

Auto manuals search

<http://auto.somanuals.com>

TV manuals search

<http://tv.somanuals.com>