

## RANGE COMPOSITION

A range of wall-mounted hoods used for snack applications and on the N700 and N900 Series cooking units. Their particular profile and the limited installation height makes them suitable for use in places with low ceilings.

The range consists of hoods with 8 different lengths (1200, 1600, 2000, 2400, 2800, 3200, 3600 and 4000 mm) and a depth of 900 mm.



# MASTER - M line - 900 mm

## 430 AISI WALL TYPE HOODS **ZANUSSI** PROFESSIONAL

### FUNCTIONAL AND CONSTRUCTION FEATURES

- ◆ Constructed entirely in 430 AISI stainless steel.
- ◆ Labyrinth filters in 430 AISI stainless steel easily removable for cleaning. Labyrinth filters guarantee constant filtration to avoid clogging and protect against fire.

- ◆ Back drain pipe with drain hole to transfer grease into a 304 AISI container.
- ◆ External panels with upturned edges to avoid injuries.
- ◆ Blind panels in 304 AISI stainless steel for a correct exhaustion.
- ◆ The outlet holes are sized in order to minimize drops in pressure.

- ◆ Pressure gauging for perfect calibration.
- ◆ Condensate collection tray in 304 AISI stainless steel.
- ◆ Eyebolts and screw anchors for ceiling installation.
- ◆ Prearranged for installation of lighting.

| TECHNICAL DATA                    |                   |                   |                   |                   |                   |                   |                   |                   |
|-----------------------------------|-------------------|-------------------|-------------------|-------------------|-------------------|-------------------|-------------------|-------------------|
| CHARACTERISTICS                   | MODELS            |                   |                   |                   |                   |                   |                   |                   |
|                                   | MP912BT<br>642286 | MP916BT<br>642287 | MP920BT<br>642288 | MP924BT<br>642289 | MP928BT<br>642001 | MP932BT<br>642290 | MP936BT<br>642291 | MP940BT<br>642292 |
| External dimensions - mm          |                   |                   |                   |                   |                   |                   |                   |                   |
| width                             | 1200              | 1600              | 2000              | 2400              | 2800              | 3200              | 3600              | 4000              |
| depth                             | 900               | 900               | 900               | 900               | 900               | 900               | 900               | 900               |
| height                            | 500               | 500               | 500               | 500               | 500               | 500               | 500               | 500               |
| Air Capacity - mc/h               | 1200              | 1600              | 2000              | 2400              | 2800              | 3200              | 3600              | 4000              |
| Net weight - kg.                  | 23                | 29                | 36                | 42                | 48                | 55                | 60                | 67                |
| <b>INCLUDED ACCESSORIES</b>       |                   |                   |                   |                   |                   |                   |                   |                   |
| 304 S/S BLIND PANEL 400X500H MM   | 1                 | 1                 | 1                 | 1                 |                   |                   | 1                 | 1                 |
| 430 S/S LABYRINTH FILTER H=500 MM | 2                 | 2                 | 4                 | 4                 | 5                 | 6                 | 6                 | 7                 |

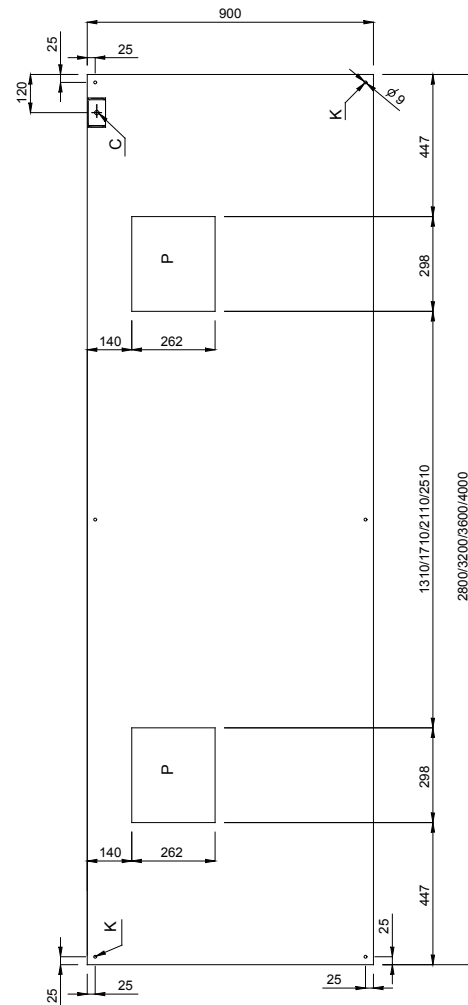
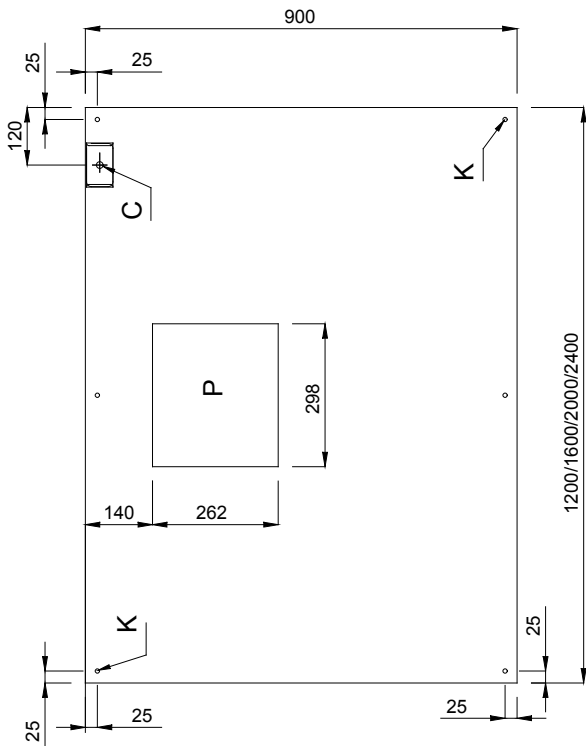
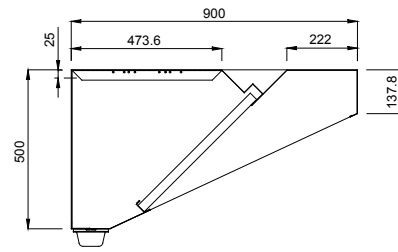
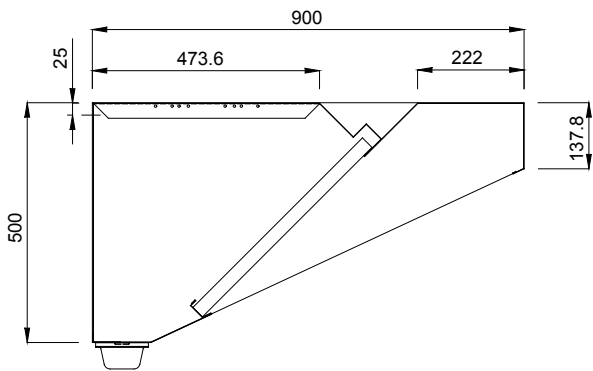

**OPTIONAL ACCESSORIES**

| ACCESSORIES                              | MODELS            |                   |                   |                   |                   |                   |                   |                   |
|--|-------------------|-------------------|-------------------|-------------------|-------------------|-------------------|-------------------|-------------------|
|  | MP912BT<br>642286 | MP916BT<br>642287 | MP920BT<br>642288 | MP924BT<br>642289 | MP928BT<br>642001 | MP932BT<br>642290 | MP936BT<br>642291 | MP940BT<br>642292 |
| 27-WATT LIGHTING FIXTURE W/1 LAMP-IP 65  | 680804            |                   | 680804            | 680804            |                   |                   | 680804            | 680804            |
| 36-WATT LIGHTING FIXTURE W/1 LAMP-IP 65  |                   | 680805            |                   |                   | 680805            | 680805            | 680805            | 680805            |
| DRAIN FOR HOODS DIAM.1/2"(M) WITH PLUG   | 640409            | 640409            | 640409            | 640409            | 640409            | 640409            | 640409            | 640409            |
| FAN FOR VENTIL HOODS+DUCTED EXTRACT.UNIT | 640748            | 640748            | 640748            | 640748            | 640748            | 640748            | 640748            | 640748            |
| SPEED VARIATOR FOR MOTORS UP TO 1.17 KW  | 640076            | 640076            | 640076            | 640076            |                   |                   |                   |                   |
| SPEED VARIATOR FOR MOTORS UP TO 1.7 KW   |                   |                   |                   |                   | 640686            | 640686            | 640686            | 640686            |



www.zanussiprofessional.com

## Free Manuals Download Website

<http://myh66.com>

<http://usermanuals.us>

<http://www.somanuals.com>

<http://www.4manuals.cc>

<http://www.manual-lib.com>

<http://www.404manual.com>

<http://www.luxmanual.com>

<http://aubethermostatmanual.com>

Golf course search by state

<http://golfingnear.com>

Email search by domain

<http://emailbydomain.com>

Auto manuals search

<http://auto.somanuals.com>

TV manuals search

<http://tv.somanuals.com>