



**MOTOROLA**



 **Bluetooth®**

**Wireless Headset**

**User Guide**



**MOTOROLA**  
*intelligence everywhere™*

**Figure 1**

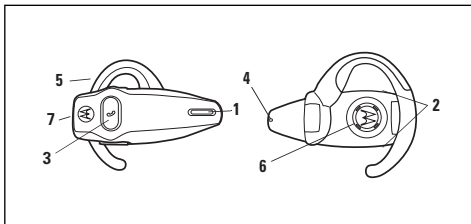

**Figure 2**

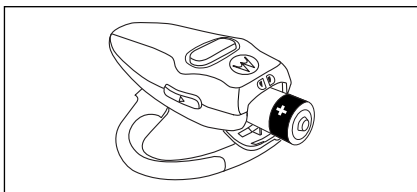

**Figure 3**

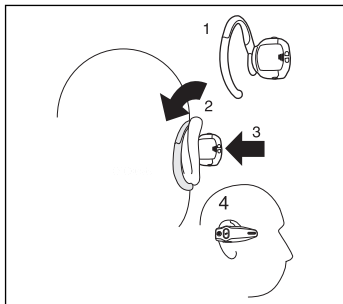

**Figure 4**

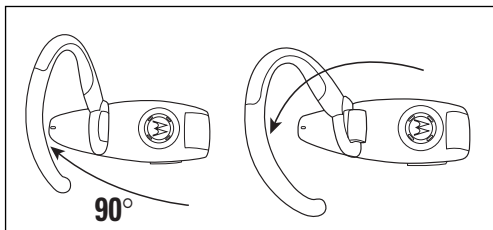

## Welcome

---

Welcome to Motorola's "connected" world of Bluetooth® personal area wireless networking.

The headset provides hands-free convenience and freedom from cables and wires. You can place a call directly from your Bluetooth Wireless Headset by using your Bluetooth capable phone and your phone's activation feature. Bluetooth wireless technology makes all connections quickly and without cables.

All Motorola wireless products are designed and manufactured to meet Motorola's rigorous specifications and world-class quality standards. During development, our testing team took the Motorola Bluetooth Wireless Headset through rigorous durability tests including temperature, humidity, shock, dust, vibration, and drop tests.

Thank you for choosing a Motorola product equipped with Bluetooth® technology!

## English

### Safety and General information

---

Users are not permitted to make changes or modify the device in any way. Changes or modifications not expressly approved by the party responsible for compliance could void the user's authority to operate the equipment.

#### **Electromagnetic Interference/Compatibility**

Nearly every electronic device is susceptible to electromagnetic interference (EMI) if inadequately shielded, designed, or otherwise configured for electromagnetic compatibility.

Turn off your device in any facility where posted notices instruct you to do so. These facilities may include hospitals or health care facilities that may be using equipment that is sensitive to external RF energy.

#### **European Union Directives Conformance Statement**

Hereby, Motorola declares that this product ("HS805") is in compliance with

- The essential requirements of European Union Directive 1999/5/EC

You can view your product's Declaration of Conformity (DoC) to Directive 1999/5/EC (the R&TTE Directive) at [www.motorola.com/rtte](http://www.motorola.com/rtte).

## Introduction

---

### What Is Bluetooth wireless technology?

Bluetooth wireless technology propels you into a new dimension in connectivity. Bluetooth devices communicate without wires, using built-in radio transceivers that operate on a globally available radio frequency to ensure worldwide compatibility. Your Bluetooth Wireless Headset can communicate with other Bluetooth devices within a range of approximately 10 meters (33 feet).

### How can I use my wireless headset?

Your Wireless Headset equipped with Bluetooth wireless technology lets you connect with other similarly equipped devices :

- Use your phone hands-free.
- Handle incoming and outgoing calls with the headset multifunction control button
- Use voice activation to make calls.

### Headset Features

Please refer to figure 1 on page 1.

1. **Headset Indicator LED** Provides visual cue about headset status.
2. **Volume Control Buttons** Adjust speaker volume up and down.
3. **Multifunction Button** Controls several headset functions.
4. **Microphone** Picks up your voice input.
5. **Earhook** Attaches headset to ear.
6. **Speaker** Plays the sound you receive on the call.
7. **Battery door** Allows you to change the battery.

## English

### Using your headset

#### Replacing your headset battery

Please refer to figure 2 on page 1.

- Open the battery door on the back of the headset.
- Insert a new battery following the + and - markings in the battery compartment.
- Close the battery door.

For best performance, use AAA alkaline batteries. A fresh battery will provide up to 22 hours talk time and 20 days standby time (based on performance using Energizer® e2 AAA batteries).

#### Turning your headset on and off

To turn the headset on or off, press the multifunction button until the indicator flashes.

#### Wearing your headset

Placing the headset on your ear:  
Changing for wear on the left ear:

refer to figure 3 on page 2.  
refer to figure 4 on page 2.

#### Adjusting volume

To adjust volume, press either one of the bottom and top volume buttons repeatedly until you reach the desired volume level.

**Volume Orientation technology** - To change the volume button orientation from left or right rear: with the headset off, press the multifunction button and desired volume button to assign a "volume up" until the LED flashes 2 times and the headset powers up.

#### Pairing your headset and phone

You must pair your headset and phone before you can make a call. "Pairing" creates a link between devices equipped with Bluetooth wireless technology and allows the phone to remember the headset's unique ID. Once your headset and phone are paired, your headset automatically connects to your phone.

## **Pairing**

With the headset and phone in close proximity:

- Step 1:** When the headset is off, press and hold the multifunction button until the headset indicator turns on permanently.
- Step 2:** Perform a device discovery (or scan) from the phone. For details about device discovery consult your phone's user guide.
- Step 3:** Select the Motorola HS805 in the list of discovered devices and confirm by following the on-screen prompts.
- Step 4:** When requested by the phone, enter the passkey 0000 and confirm.

The device ID is now stored in the phone's memory. Pairing is successful when the headset indicator flashes rapidly.

## **Paired link to additional devices**

Your headset can store pairing information for up to 8 different devices equipped with Bluetooth wireless technology. Devices are stored in a "Paired Device List" in memory in chronological order. When an attempt to pair to more than 8 devices is made, the oldest paired device is removed from the list.

The headset will automatically initiate a connection with the last device it was connected to either by powering up the headset or by pressing the multifunction button. If you want to connect the headset to another device in the paired device list, you must initiate the connection from that device. Whichever of the 8 devices initiates a connection to the headset afterwards, that device then becomes the "last connected" device.

## **Placing and receiving calls**

You can use the phone as usual to dial a number.

Your headset supports both Hands Free and Headset Profiles. Accessing call functions depend on which profile your phone supports.

**Note:** some phones do not support all features listed. See your phone user' guide.



## English

You can activate call functions for the hands-free profile according to the following table:

Function	Phone Status	Action (Hands-free profile)
Receive a call	ON - phone rings	Short press $\zeta$
Make a voice dial call	ON - idle	Short press $\zeta$ , speak name
Redial a number	ON - voice dialing turned on or off	Long press $\zeta$
End a call	ON - in call	Short press $\zeta$
Transfer call from phone to headset	ON - in call	Short press $\zeta$
Toggle between two calls	ON - in call, another call is coming in ON - in call, another call is on hold	Long press $\zeta$
Reject a call	ON - phone rings	Long press $\zeta$

**Note:** if the link abnormally disconnects (for example, out of range), the headset tries to reestablish the link.

## Using your headset indicators

### Headset indicator (LED)

Headset indicator	Headset
OFF	Power off
ON (steady)	Pairing mode
10 rapid flashes	Pairing successful
Flashes at a 3-second interval	Standby (not on a call)
Flashes at a 8-second interval	Connected (on a call)

**Note:** When the wireless headset is paired to the phone and there is no activity for 5 minutes, the green flashing LED turns off. Any button press on the headset will reawaken the headset and the flashing resumes. If you press the up and down volume buttons simultaneously, the flashing LED turns off.

If you press the up and down volume buttons simultaneously, during a call, the flashing LED turns off.

**English****Audio tones**

<b>Audio Tone</b>	<b>Headset status</b>
Single high tone when pressing volume button	Volume maximum or minimum reached
Five rapid high tones, repeated every 60 seconds	Low battery
No audio indications; deteriorating audio quality	Out of range
Series of 4 tones, low to high	ON
Ring tone	Incoming call
Single high tone	Pairing confirmation
Single low tone	Initiate voice activation
Dual high/low tone voice	Voice tag not recognized
Single high tone	End call
Series of 4 tones, high to low	OFF

If you have additional questions, please call your local hotline or visit us at [www.hellomoto.com](http://www.hellomoto.com)

## Free Manuals Download Website

<http://myh66.com>

<http://usermanuals.us>

<http://www.somanuals.com>

<http://www.4manuals.cc>

<http://www.manual-lib.com>

<http://www.404manual.com>

<http://www.luxmanual.com>

<http://aubethermostatmanual.com>

Golf course search by state

<http://golfingnear.com>

Email search by domain

<http://emailbydomain.com>

Auto manuals search

<http://auto.somanuals.com>

TV manuals search

<http://tv.somanuals.com>