



Wii U™

Operations Manual



The official seal is your assurance that this product is licensed or manufactured by Nintendo. Always look for this seal when buying video game systems, accessories, games and related products.



Please carefully read this Operations Manual before setup or use of the Wii U™ system. If you have problems or questions after reading all of the instructions, please visit our customer service area at support.nintendo.com or call 1-800-255-3700. Also, additional pre-installed electronic manuals are available for the Wii U system and software applications from the HOME Menu, as described on the next page.



Product recycling information:

Visit recycle.nintendo.com

IMPORTANT: The Wii U system specifications and Wii U Services are constantly evolving and we may update or change the Wii U system or the Wii U Services in whole or in part, without notice to you. Such updates may be required for you to play new Wii U games, enjoy new features, or continue to access the Wii U Services. After the Wii U system is updated, any existing or future unauthorized modification of the hardware or software of your Wii U system, or the use of an unauthorized device in connection with your system, will render the system permanently unplayable. Content obtained through the unauthorized modification of the hardware or software of your Wii U system will be removed.

This product only plays Wii and Wii U Game Discs manufactured for use in the Americas. This Wii U console is for use only in the Americas.

Patents issued and pending both domestically and internationally. Visit patents.nintendo.com for list of patent numbers.

NOTE: This product does not contain latex. This product complies with applicable laws barring the use of toxic materials such as lead, mercury, cadmium, hexavalent chromium, PBB, or PBDE in consumer products.

AOSS™ and AOSS™ are the trademarks of BUFFALO INC. The Wi-Fi Protected Setup icon is a registered trademark of the Wi-Fi Alliance. Trademarks are property of their respective owners. Wii U is a trademark of Nintendo. © 2012 Nintendo.

Wii U System Manuals

Types of Manuals

Printed manuals

- Wii U Quick Start Guide**

This guide covers the basic information for setting up and using your Wii U system.

- Wii U Operations Manual (this manual)**

This manual gives the names of each component and describes how to recharge the controller, configure System Settings, and perform various procedures. It also provides troubleshooting and support information.

Pre-installed electronic manuals

- Wii U Electronic Manual (?)**

This manual describes the Wii U features and gives detailed instructions on how to use the preinstalled software.

- Wii Menu Electronic Manual**

This manual describes the Wii Menu features and gives detailed instructions on how to use the included software.

Viewing an Electronic Manual

Press on the Wii U™ GamePad to open the HOME Menu, then tap to open the Wii U Electronic Manual. Press or select the button in the lower right corner of the screen to switch languages.

- Press while playing a Wii U software title to see the electronic manual for that software.
- Touch at the bottom left of the screen to close the manual and return to the previous screen you were viewing before opening the HOME Menu.

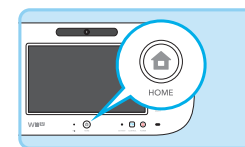

HOME Menu



Electronic Manual Contents

Use the stylus to tap and slide or use the L or R Stick (p. 10) to view the manual.



Selecting items

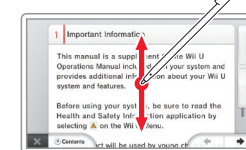

Viewing pages

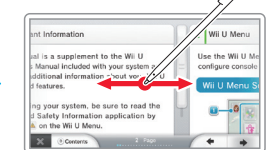

Changing pages

NOTE: Above images are for reference only; the actual screen content may vary.

Contents

Wii U System Manuals	1
Types of Manuals	1
Viewing an Electronic Manual	1
Health and Safety Information	4

System Setup

System Components	8
Charging the Wii U GamePad	18
Charging Options	18
Battery LED Status	19
Charging the Wii U Pro Controller	20
Charging Procedure	20
Battery LED Status	21
Turning the Power On/Off	22
Options for Turning the Power On	22
Turning the Power Off	23
Turning Only the Wii U GamePad Screen Off	23
Pairing Controllers	24
Pairing Procedure for Controllers	24
Pairing Procedure for the Wii U GamePad	24
Using Wii Remote Controllers	25
Installing the Sensor Bar	25
Recommended Play Environment	26
Using the Wii Remote Jacket	27
Installing Batteries in the Wii Remote	27
Wearing the Wii Remote Wrist Strap	28
Using the Nunchuk	29
Disconnecting the Nunchuk	30

System Configuration

System Settings	32
Configuring Settings	32
User Settings	33
Adding Users	33
Switching Users	33

Internet Settings	34
Internet Connection Requirements	34
Parental Controls	36
Restriction Options	36

System Operations

Transferring System Data	38
Data You Can Transfer	38
Transfer Procedure	39
On-Screen Keyboard	40
Wii U On-Screen Keyboard	40
Input Modes	40
Controller Calibration	41
Calibrating the Touch Screen	41
Resetting the L and R Control Sticks	41
Battery Replacement	42
Wii U GamePad	42
Wii U Pro Controller	44
Wii U Console	46

Consumer Information

Troubleshooting	48
Warranty and Service Information	54
Regulations for Equipment Use	55

Health and Safety Information

Before using the Wii U system read the following important health and safety information, and be sure to read the information in the Health and Safety application available on the Wii U Menu screen. This application also contains important usage guidelines for Wii U components and accessories.



Important Safety Information

Read the following warnings before setup or use of the Wii U system. If this product will be used by young children, this manual should be read and explained to them by an adult. Failing to do so may cause injury. Please carefully review the instructions for the game you are playing for additional health and safety information.

Throughout this manual, you will see this symbol  followed by WARNING or CAUTION, or you may see the term IMPORTANT. These terms have different levels of meaning as outlined below. Please read and understand these terms and the information that appears after them before using your Wii U system.

WARNING: Warns you about incorrect use of this system that could result in serious personal injury.

CAUTION: Cautions you about incorrect use of this system that could result in personal injury or damage to the system, components, games, or accessories.

IMPORTANT: Informs you about incorrect use of the system that could result in damage to the system, components, games, or accessories.

WARNING - SEIZURES

- Some people (about 1 in 4000) may have seizures or blackouts triggered by light flashes or patterns, and this may occur while they are watching TV or playing video games, even if they have never had a seizure before.
- Anyone who has had a seizure, loss of awareness, or other symptom linked to an epileptic condition should consult a doctor before playing a video game.
- Parents should watch their children play video games. Stop playing and consult a doctor if you or your child has any of the following symptoms:

Convulsions	Eye or muscle twitching	Loss of awareness
Altered vision	Involuntary movements	Disorientation

To reduce the likelihood of a seizure when playing video games:

1. Sit or stand as far from the screen as possible.
2. Play video games on the smallest available television screen.
3. Do not play if you are tired or need sleep.
4. Play in a well-lit room.
5. Take a 10 to 15 minute break every hour.

WARNING - REPETITIVE MOTION INJURIES AND EYESTRAIN

Playing video games can make your muscles, joints, skin or eyes hurt. Follow these instructions to avoid problems such as tendinitis, carpal tunnel syndrome, skin irritation or eyestrain:

- Avoid excessive play. Parents should monitor their children for appropriate play.
- Take a 10 to 15 minute break every hour, even if you don't think you need it.
- If your hands, wrists, arms or eyes become tired or sore while playing, or if you feel symptoms such as tingling, numbness, burning or stiffness, stop and rest for several hours before playing again.
- If you continue to have any of the above symptoms or other discomfort during or after play, stop playing and see a doctor.

CAUTION - MOTION SICKNESS

Playing video games can cause motion sickness in some players. If you or your child feels dizzy or nauseous when playing video games, stop playing and rest. Do not drive or engage in other demanding activity until you feel better.

WARNING - ELECTRIC SHOCK

To avoid electric shock when you use this system:

- Do not use the Wii U system during a lightning storm. There may be a risk of electric shock from lightning.
- Use only the AC adapter that comes with your system.
- Do not use the AC adapter if it has damaged, split or broken cords or wires.
- Make sure that the AC adapter cord is fully inserted into the wall outlet or extension cord.
- Always carefully disconnect all plugs by pulling on the plug and not on the cord. Make sure the Wii U power button is turned OFF before removing the AC adapter cord from an outlet.

WARNING - RADIO FREQUENCY INTERFERENCE

The Wii U console and accessories, including the Wii U GamePad, Wii U Pro Controller, and Wii Remote controllers, can emit radio waves that can affect the operation of nearby electronics, including cardiac pacemakers.

- Do not operate the Wii U console and accessories within 9 inches of a pacemaker.
- If you have a pacemaker or other implanted medical device, do not use the Wii U console and accessories without first consulting your doctor or the manufacturer of your medical device.

CAUTION - LASER DEVICE

The Wii U console is a Class I laser product. Do not attempt to disassemble the Wii U console. Refer servicing to qualified personnel only.

CAUTION: Use of controls or adjustments or procedures other than those specified herein may result in hazardous radiation exposure.

Specifications: Laser Type: Semiconductor laser Laser Wavelength: 405nm, 660nm
Laser Power: Max. 0.6mW, Max. 0.9mW Numeric aperture: 0.85, 0.6

WARNING - BATTERY LEAKAGE

The Wii U GamePad and Wii U Pro Controller contain a rechargeable lithium ion battery.

Leakage of ingredients contained within the battery, or the combustion products of the ingredients, can cause personal injury as well as damage to your Wii U system. If battery leakage occurs, avoid contact with skin. If contact occurs, immediately wash thoroughly with soap and water. If liquid leaking from a battery comes into contact with your eyes, immediately flush thoroughly with water and see a doctor.

To avoid battery leakage:

- Do not expose battery to excessive physical shock, vibration, or liquids.
- Do not disassemble, attempt to repair, or deform the battery.
- Do not dispose of battery in a fire.
- Do not touch the terminals of the battery or cause a short between the terminals with a metal object.
- Do not peel or damage the battery label.

Some accessories may use AA batteries. Nintendo recommends high quality alkaline batteries for best performance and longevity of battery life. If you use rechargeable nickel metal hydride (NiMH) batteries, be sure to follow the manufacturer's guidelines for safety and proper usage.

Leakage of battery fluid can cause personal injury as well as damage to your system and accessories. If battery leakage occurs, thoroughly wash the affected skin and clothes. Keep battery fluid away from your eyes and mouth. Leaking batteries may make popping sounds.

To avoid battery leakage:

- Do not mix used and new batteries (replace all batteries at the same time).
- Do not mix different brands of batteries.
- Nintendo recommends alkaline batteries. Do not use Lithium ion, nickel cadmium (NiCd), or carbon zinc batteries.
- Do not leave batteries in the remote for long periods of non-use.
- Do not recharge alkaline or non-rechargeable batteries.
- Do not put the batteries in backwards. Make sure that the positive (+) and negative (-) ends are facing in the correct directions. Insert the negative end first. When removing batteries, remove the positive end first.
- Do not use damaged, deformed or leaking batteries.
- Do not dispose of batteries in a fire.

The Wii U console contains a lithium coin cell battery. Contains perchlorate material - special handling may apply. For more information visit www.dtsc.ca.gov/hazardouswaste/perchlorate/. Do not remove the battery from the Wii U console unless it needs to be replaced.

PRECAUTIONS WHEN USING AC ADAPTERS

Please read and follow the precautions listed below when setting up and using the Wii U system. Failure to do so may result in damage to your Wii U system or accessories.

- Plug the AC adapter into an easily accessible standard wall outlet near your Wii U system.
- Make sure there is adequate ventilation around the AC adapter and Wii U system, and that any air vents are unobstructed.
- Do not expose the AC adapter or Wii U system to extremes of heat.
- Do not expose the AC adapter or Wii U system to any type of moisture.
- Do not place objects filled with liquids on or near the AC adapter or Wii U system.

See the bottom of the AC adapter for additional information.

System Setup

System Components	8
Charging the Wii U GamePad	18
Charging Options	18
Battery LED Status	19
Charging the Wii U Pro Controller	20
Charging Procedure	20
Battery LED Status	21
Turning the Power On/Off	22
Options for Turning the Power On	22
Turning the Power Off	23
Turning Only the Wii U GamePad Screen Off	23
Pairing Controllers	24
Pairing Procedure for Controllers	24
Pairing Procedure for the Wii U GamePad	24
Using Wii Remote Controllers	25
Installing the Sensor Bar	25
Recommended Play Environment	26
Using the Wii Remote Jacket	27
Installing Batteries in the Wii Remote	27
Wearing the Wii Remote Wrist Strap	28
Using the Nunchuk	29
Disconnecting the Nunchuk	30

System Components

Wii U Console

■ Front View (showing the slot cover open)

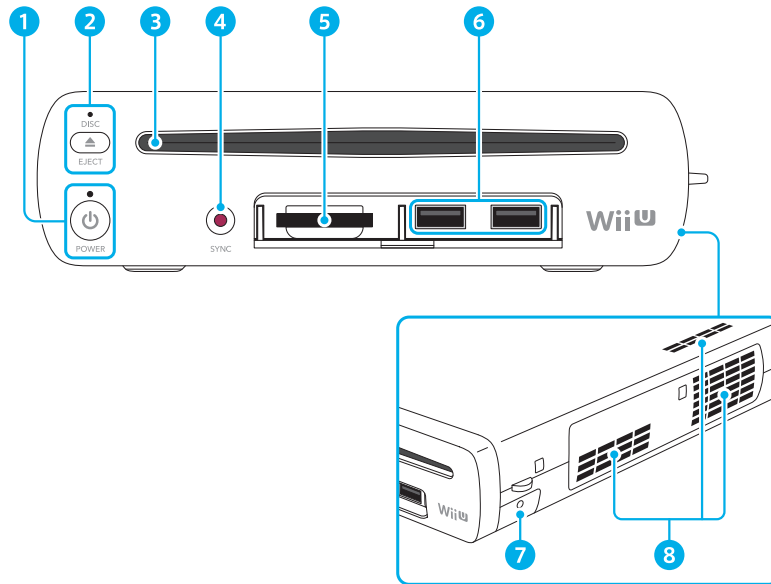

Right side view

■ Back View

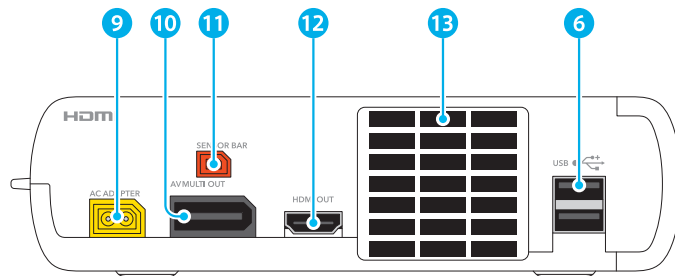

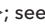
- 1 POWER Button**
Press to turn the Wii U console on or off.
Power LED
Indicates the status of the console (p. 22).
 - (Blue): Power is on
 - (Red): Power is off
- 2 EJECT Button**
Press this button to eject discs.
Disc LED
Lights up when a disc is inserted into the console.
- 3 Disc Slot**
For inserting a Wii U or Wii Game Disc.
- 4 SYNC Button**
Press this to pair (synchronize) the Wii U GamePad, Wii U Pro Controller (sold separately), or Wii Remote™ Plus controller (sold separately) with the console (p. 24).
- 5 SD Card Slot**
For inserting SD Cards (sold separately), see the Wii U Electronic Manual (📖), **Using SD Cards**.
- 6 USB Ports**
For connecting USB devices (sold separately; devices may be marked with ; see the Wii U Electronic Manual (📖), **Using USB Devices**).
- 7 Battery Cover**
A coin cell battery (CR2032) is included.
 - See the Battery Leakage warning in Health and Safety Information (p. 4) for important information about this battery.
 - Do not remove the battery from the Wii U console unless it needs to be replaced.
- 8 Air Intake**
- 9 AC Adapter Connector**
- 10 AV Multi Out Connector**
- 11 Sensor Bar Connector**
- 12 HDMI™ Port**
- 13 Air Vent**

Wii U™ GamePad

Front View

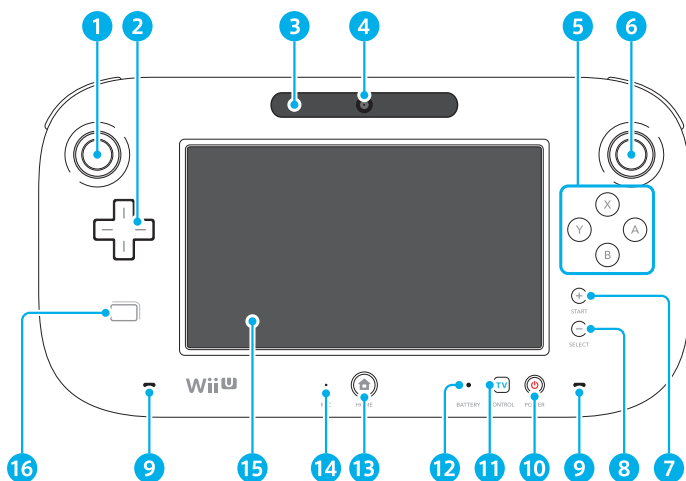

- 1 L Stick
 - Can also function as a button when pressed.
- 2 +Control Pad
- 3 Sensor Bar

Works with a Wii Remote controller (sold separately) when used to interact with the Wii U GamePad (this feature works with compatible software only).
- 4 Camera
- 5 A/B/X/Y Buttons
- 6 R Stick
 - Can also function as a button when pressed.
- 7 + Button/START
- 8 – Button/SELECT
- 9 Speakers
- 10 POWER Button

Press to turn the Wii U console and Wii U GamePad on or off (p. 22).

- 11 TV Control Button

Press to switch to the TV Remote Features screen. Allows input to your TV, DVD recorder, or cable or satellite TV tuner (p. 22).
- 12 Battery LED

Indicates charging status and remaining battery life (p. 19).
- 13 HOME Button

Displays the HOME Menu, where you can configure the Wii U GamePad and Wii Remote controllers or view pre-installed electronic manuals. See the Wii U Electronic Manual (E), on the HOME Menu.
- 14 Microphone
- 15 Touch Screen
- 16 NFC (near-field communication) location

Built-in NFC feature allows the system to read or write to an enabled card or other device. This works with Wii U software exclusively designed to use this feature (see game packaging for compatibility information).

Using the Touch Screen

You can use the stylus or your fingertip to lightly tap or touch the screen.

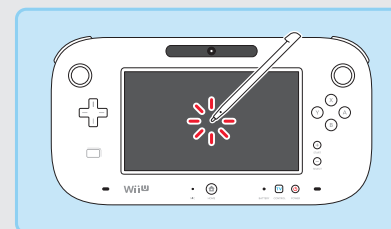

You can touch the screen and lightly slide the tip across the surface.

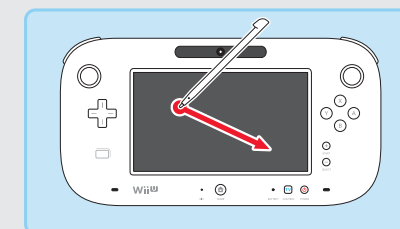

- If the Touch Screen does not seem to respond correctly to stylus input, you can calibrate it on the GamePad from System Settings on the Wii U Menu. If you are unable to operate the Wii U Menu properly using the Touch Screen, use the +Control Pad and (A).

Using the Wii U GamePad with a stand or cradle

Place the Wii U GamePad stand or Wii U GamePad cradle (both included in the Deluxe Set only) on a flat, horizontal surface, and place the Wii U GamePad on the stand or cradle horizontally.

- Do not place the Wii U GamePad vertically.
- When using the Touch Screen or buttons, hold the Wii U GamePad in your hands (not the stand or cradle).

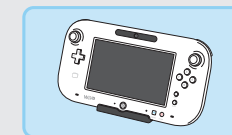

Top View

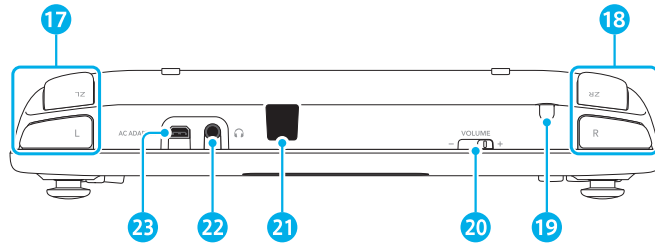

Back View

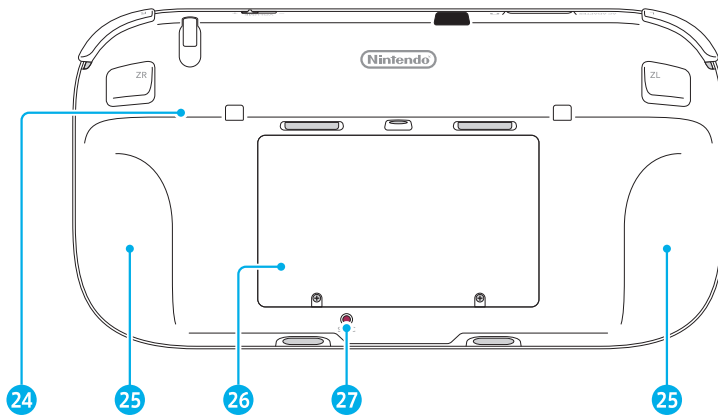

Bottom View

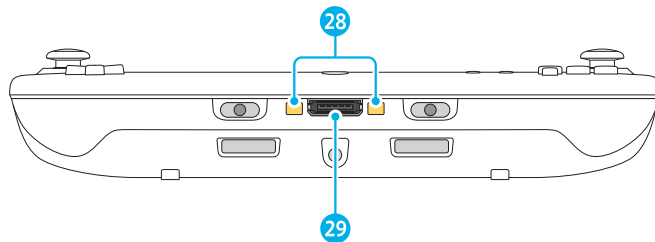

- 17** L & ZL Buttons
- 18** R & ZR Buttons
- 19** Stylus Holder
 - Always replace the stylus in the stylus holder when not in use.
- 20** Volume
 - Slide to adjust the volume level of the Wii U GamePad speakers.
- 21** Infrared Transceiver
 - Sends and receives information when using infrared communication.
- 22** Audio Jack
 - For connection of stereo headphones (sold separately).
 - If headphones are connected, no sound will play through the speakers.
- 23** AC Adapter Connector
 - For connecting the Wii U GamePad AC adapter ([p. 18](#)).
- 24** GamePad Support
- 25** Hand Grips
- 26** Battery Cover
 - You can remove the cover if you need to replace the rechargeable battery ([p. 42](#)).
 - Do not remove the cover unless you need to replace the battery or check battery installation.
- 27** SYNC Button
 - Press this to pair the Wii U GamePad with the console ([p. 24](#)).
- 28** Charging Terminals
 - These contact the terminals on the cradle when charging.
- 29** Accessory Connector
 - For connecting external accessories to the Wii U GamePad.

Wii Remote™ Plus Controller (optional accessory)

The **Wii Remote Plus Controller is sold separately**. This controller only works with Wii software, as well as Wii U software that supports Wii Remote gameplay (see game packaging for compatibility information). This controller can be used with the Wii Menu feature of your console.

Front and Back View

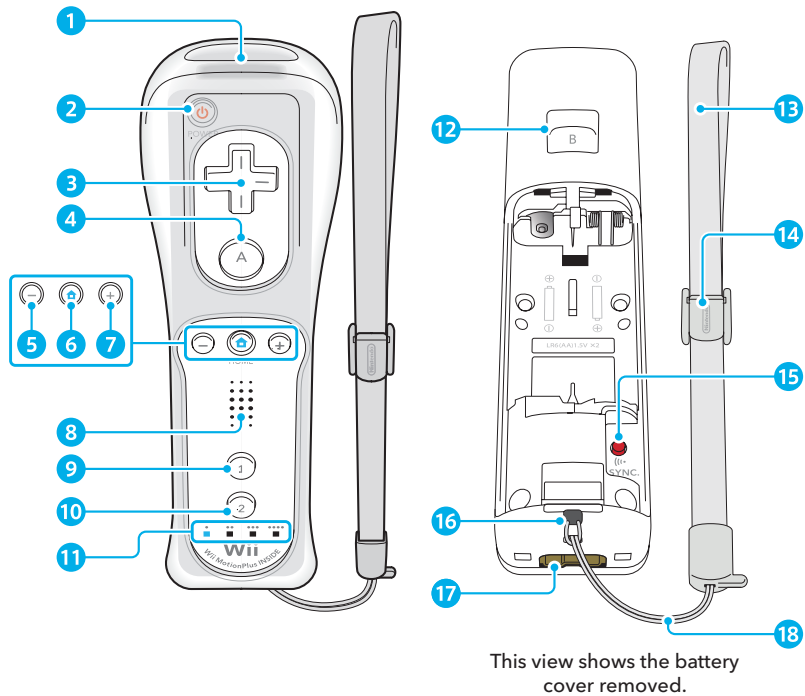

- 1 Pointer Lens
- 2 POWER Button
Press to turn the Wii U console on or off.
- 3 +Control Pad
- 4 A Button
- 5 – Button
- 6 HOME Button
Displays the HOME Menu, where you can configure the Wii U GamePad and Wii Remote controllers or view pre-installed electronic manuals. See the Wii U Electronic Manual (?), on the HOME Menu.

- 7 + Button
- 8 Speaker
- 9 1 Button
- 10 2 Button
- 11 Player LEDs
Indicates the player number assigned to the controller currently in use.
- 12 B Button
- 13 Wii Remote Wrist Strap
- 14 Strap Lock
- 15 SYNC Button
Press this to pair (synchronize) the Wii Remote Plus with the console (see illustration below).
- 16 Wrist Strap Attachment
- 17 External Extension Connector
Allows connection of external accessories such as the Nunchuk™.
- 18 Wrist Strap Cord

Using the SYNC Button

Some Wii Remote models require you to remove the battery cover to press the SYNC Button.

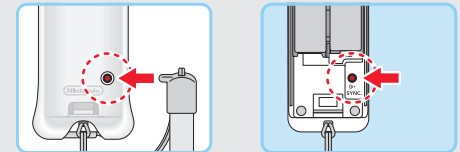

Recalibrating the Wii Remote Plus

If the cursor on the TV screen moves even if the Wii Remote Plus is not being moved, or moves differently than when the Wii Remote Plus is moved, the remote may need to be recalibrated due to the following:

- Changing batteries in the Wii Remote Plus during gameplay.
- Moving the Wii Remote Plus from a cold environment into a warm environment.

To recalibrate the Wii Remote Plus, place it on a flat horizontal surface with the buttons facing down. Wait for a few seconds and check the operation. Also, review the instruction manual for the game you are playing for more information.

NOTE: This procedure must be done during gameplay.

Wii U™ Pro Controller (optional accessory)

The **Wii U Pro Controller** is sold separately. This controller only works with Wii U software that supports Wii U Pro Controller gameplay (see game packaging for compatibility information). This controller can be used with the Wii U Menu and for Wii U system operations.

Front View

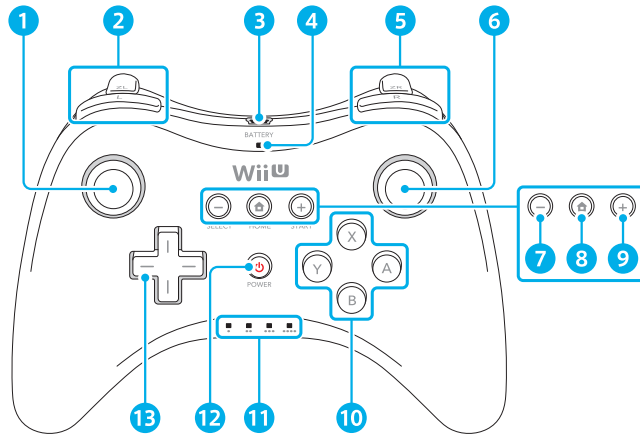

Back View

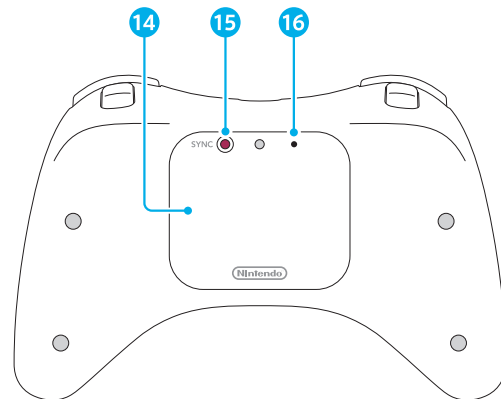

- 1 L Stick
 - Can also function as a button when pressed.
- 2 L & ZL Buttons
- 3 USB Port
 - Connects to the USB cable for charging the controller (p. 20).
- 4 Battery LED
 - Indicates charging status and remaining battery life (p. 21).
- 5 R & ZR Buttons
- 6 R Stick
 - Can also function as a button when pressed.
- 7 - Button/SELECT
- 8 HOME Button
 - Displays the HOME Menu, where you can configure or check the battery life of the Wii U Pro Controller or view pre-installed electronic manuals. See the Wii U Electronic Manual (?), on the HOME Menu.
- 9 + Button/START
- 10 A/B/X/Y Buttons
- 11 Player LEDs
 - Indicates the player number assigned to the controller currently in use.
- 12 POWER Button
 - Press to turn the Wii U console on or off (p. 22).
- 13 +Control Pad
- 14 Battery Cover
 - You can remove the cover if you need to replace the rechargeable battery (p. 42).
 - Do not remove the cover unless you need to replace the battery or check battery installation.
- 15 SYNC Button
 - Press this to pair the Wii U Pro Controller with the console (p. 24).
- 16 RESET Button
 - See the Wii U Electronic Manual (?), **Troubleshooting**, "The Wii U Pro Controller does not respond," for more information.

Charging the Wii U GamePad

The Wii U GamePad can be charged with either the AC adapter or with the AC adapter and Wii U GamePad cradle (included in the Deluxe Set only). See the illustrations below for connection details.

The battery LED will light orange when the battery is charging and turn off when charging is complete.

- Optimal charging temperature is between 50°-95°F (10°-35°C).
- Be sure to fully charge the battery before use for the first time, or if the system has not been used for a long time.
- If you play a game while charging, the battery LED may not always turn off once charging has completed.

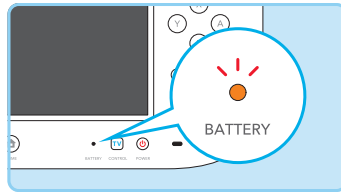

Charging Options

Using the AC Adapter

When charging is complete, first unplug the AC adapter from the outlet, then unplug it from the GamePad by pulling the AC plug straight out from the controller.

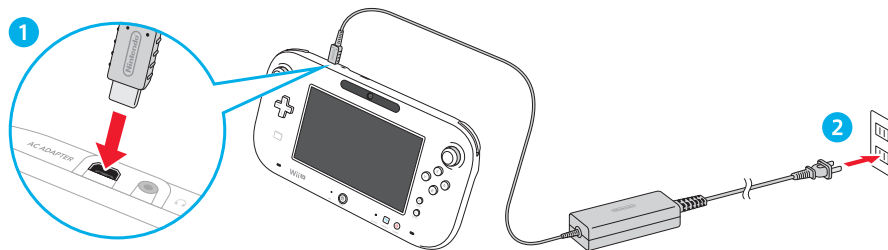

Using the AC Adapter and Wii U GamePad Cradle (Deluxe Set only)

- Place the cradle on a flat, stable surface during use.

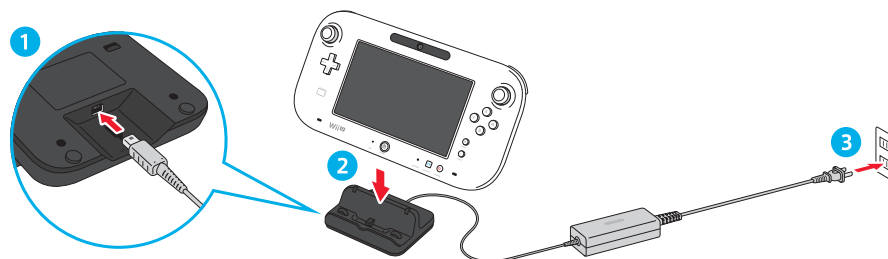

IMPORTANT:

- The Wii U GamePad AC adapter, Model No. WUP-011(USA), is only for use with the Wii U GamePad or cradle. It is not compatible with any other Nintendo product. Do not use the AC adapter with voltage transformers, dimmer switches, or any other equipment. It is only for use in a standard household AC outlet.
- Be sure the AC adapter connector plug is facing in the correct direction before inserting it into the AC adapter connector on the controller.
- Insert the AC adapter connector plug straight all the way into the AC adapter connector.
- When disconnecting any plugs from the controller, charging cradle, or wall outlet, carefully pull by the plug itself rather than by the cord.

Estimated Charging Time and Battery Life

- **Charging Time:** approx. 2.5 hours

Charging time will vary depending on how the system is being used and how much charge is left in the battery.

- **Battery Life:** approx. 3-5 hours

Actual battery life depends on the screen brightness, the features used (such as the camera or microphone), wireless communication use, ambient temperature, and other factors.

- The screen brightness is set to 4 by the manufacturer. You can change the screen brightness from the HOME Menu in **Controller Settings**.

Power-Saving Mode

Power-saving mode increases battery life by automatically adjusting screen brightness and color based on what is being displayed at the time. You can enable power-saving mode from the HOME Menu in **Controller Settings, Wii U GamePad**.

Battery LED Status

The color and status of the LED changes depending on the remaining battery charge.

- If you run out of battery life while playing a game, you will not be able to use the Wii U GamePad. **If the battery LED turns red, charge the Wii U GamePad.**

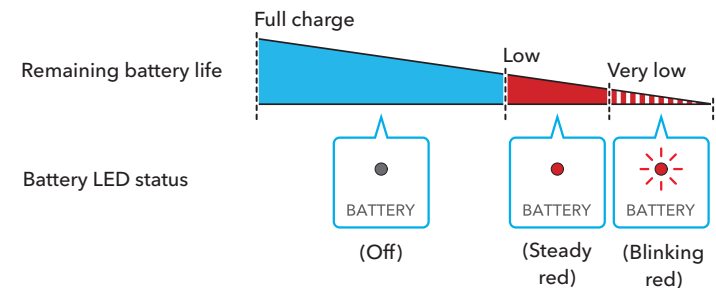

Charging the Wii U Pro Controller

The Wii U Pro Controller is a dedicated wireless controller for the Wii U system. **This accessory is sold separately.**

The battery LED will light orange when the battery is charging and turn off when charging is complete.

- Be sure to fully charge the battery before use for the first time, or if the system has not been used for a long time.
- The Wii U console must be turned on to charge the controller
- Optimal charging temperature is between 50°-95°F (10°-35°C).
- Before use with the Wii U system, wireless controllers must be charged and paired with the console (p. 24).

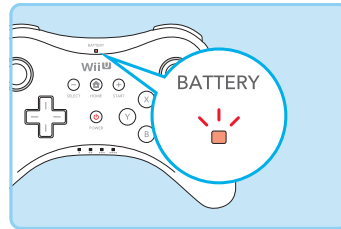

Charging Procedure

Connect the Wii U Pro Controller USB cable, included with the Wii U Pro Controller, as shown below. Make sure all plugs are inserted straight all the way into the connectors.

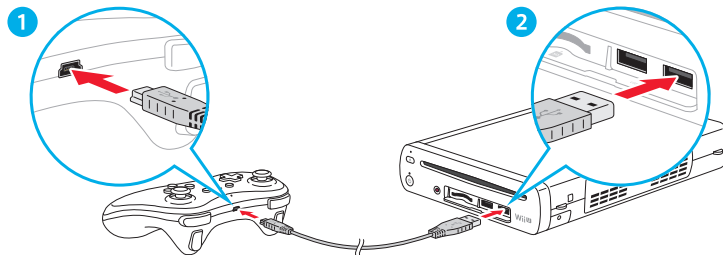

Estimated Charging Time and Battery Life

- **Charging Time:** approx. 4.5 hours
Charging time will vary depending on how the system is being used and how much charge is left in the battery.
- **Battery Life:** approx. 80 hours
Actual battery life depends on the features used, such as the rumble feature or wireless communication use, ambient temperature, and other factors.

Battery LED Status

The color and status of the LED changes depending on the remaining battery charge.

- If you run out of battery life while playing a game, you will not be able to use the controller.
If the battery LED turns red, charge the Wii U Pro Controller.

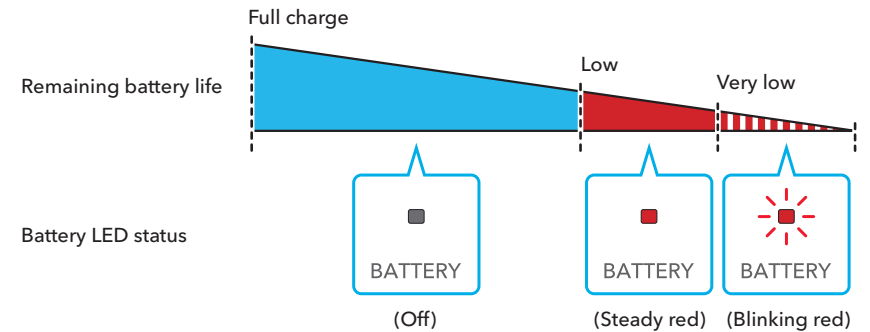

Turning the Power On/Off

You can turn the power on and off using either the Wii U console or the Wii U GamePad. **Make sure the included Wii U GamePad has been paired with the console before use (p. 24).**

Options for Turning the Power On

Using (POWER Button) on the Wii U GamePad

Press  on the Wii U GamePad to turn the Wii U console power on and display the Wii U GamePad screen.

- You can also turn the Wii U console power on by pressing  on a Wii Remote or Wii U Pro Controller.

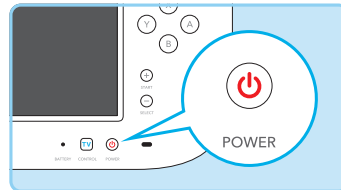

Using (TV Control Button) on the Wii U GamePad

Press  on the GamePad to display the TV Remote Features Screen. Tap **Play Wii U**.

- The TV Remote feature allows you to control the TV using the GamePad. See the Wii U Electronic Manual () , **TV Remote**.

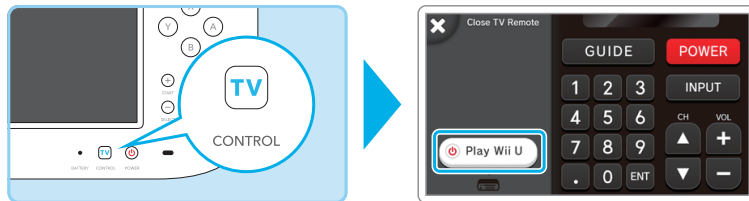

User Selection Screen

After you turn the power on, the user-selection screen appears. After a user is selected, the Wii U Menu will be displayed on the Wii U GamePad screen.

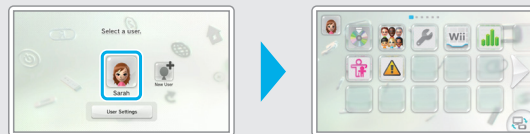

Turning the Power Off

Press and hold the POWER Button on the console or controller for at least one second. The Wii U console will turn off, the power LED will turn from blue to red, and the GamePad screen will turn off.

- The power LED does not turn off when the console turns off unless the console is unplugged from the wall outlet.
- You cannot turn off the power using the GamePad if you are using the Wii Menu or a Wii Game Disc.

Automatic Power Off Feature

The Wii U console can be set to automatically turn off if it is unused for a certain amount of time. You can configure this feature in System Settings on the Wii U Menu, **Automatic Power Off**.

- This feature has been set by the manufacturer to turn off the system after one hour.

Turning Only the Wii U GamePad Screen Off

If you are not using the GamePad screen, you can temporarily turn it off to save battery life. To turn off the screen, go to the HOME Menu and tap **Controller Settings**.

Pairing Controllers

Before using a Wii U GamePad, Wii U Pro Controller, or Wii Remote controllers, they must first be paired with the Wii U console. After pairing, you will be able to turn the console power on and off by pressing  on the controller. See the information at the bottom of the page for specific information on pairing a Wii U GamePad.

- If you will be using Wii Remote controllers, you must first install the included sensor bar ([p. 25](#)). Some software titles do not require a Sensor bar.
- A controller must always be paired to the console you wish to use it with. If a controller has been paired to a different console, it will need to be paired again to any new console you wish to use it with.
- For the Wii Balance Board™, please see the instruction manual included with compatible software for pairing instructions.

Pairing Procedure for Controllers

To pair a Wii Remote, Wii U Pro Controller, or other compatible accessory, first open the Wii U Menu, then press SYNC on the front of the Wii U console.

Follow the on-screen instructions and press SYNC on the controller to finish the pairing procedure.

You can pair up to 10 controllers with the console. If you pair additional controllers, the oldest controller pairing data is deleted and replaced by the newest data.



The Player LED on the controller will light up when pairing is complete. The Player LED indicates the player number of the controller currently in use.

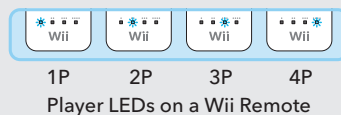

Pairing Procedure for the Wii U GamePad

To pair a Wii U GamePad, first open the Wii U Menu. Press SYNC on the front of the Wii U console TWICE, then press SYNC on the Wii U GamePad.

Follow the on-screen instructions, entering the graphic symbols as described.



Using Wii Remote Controllers

IMPORTANT: Before using Wii Remote or Wii Remote Plus controllers, be sure to review **Health and Safety Information on the Wii U Menu**.

To use software that is compatible with Wii Remote controllers, you must first install the included sensor bar as described below. (Some software titles do not require a sensor bar.)

Installing the Sensor Bar

- 1 Connect the sensor bar to the Wii U console.

NOTE: If you already have a sensor bar installed for a Wii console, you can switch it to the Wii U console, rather than installing an additional one.

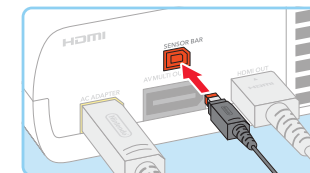

- 2 Remove the protective film from the foam pads on the bottom of the sensor bar.

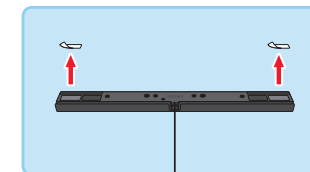

- 3 Place the sensor bar above or below the TV screen.

See **sensor bar Placement Guidelines** on the next page for reference.

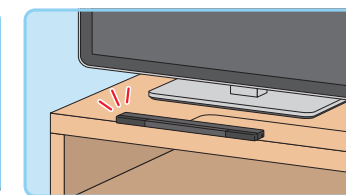
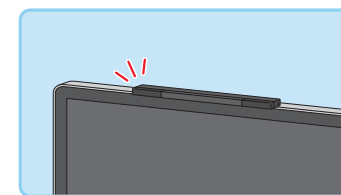

If you place your sensor bar under the TV screen:

On the Wii U Menu in System Settings, select **Wii Remote and Sensor Bar**, **Set Sensor Bar Position**, and set the position of the sensor bar to **Below the TV**. (This is necessary for proper operation of the Wii Remote controllers.)

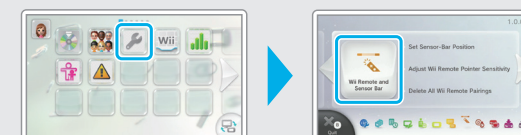

Sensor Bar Placement Guidelines

Center the sensor bar with the TV screen, facing straight ahead.

- Do not place the sensor bar over air vents on the TV.

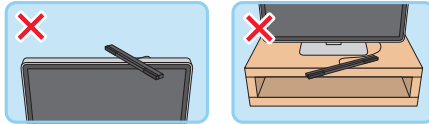
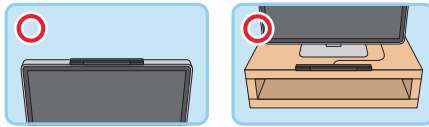

Place the sensor bar to slightly overhang the front surface of the TV screen.

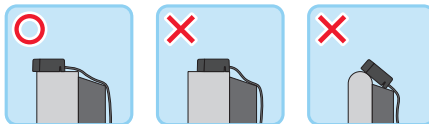

Place the sensor bar on the same surface as the TV.

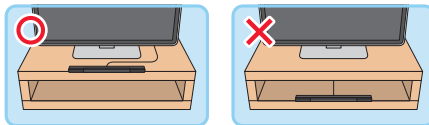

Recommended Play Environment

For the best results when using the Wii Remote controller:

- The front of the sensor bar should be directly in front of you and clearly visible
- Avoid blocking the signal between the remote and the console or sensor bar
- Sit (or stand) directly in front of the TV, between 3 and 10 feet (1-3m) away
- Avoid bright light sources behind or near the TV

If the Wii Remote is not operating properly, see **Wii Remote and Sensor Bar** in System Settings on the Wii U Menu to make adjustments, or review "Wii Remote Controllers" in **Troubleshooting** (p. 53).

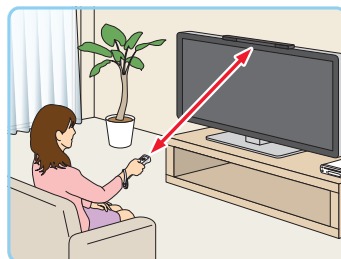

Using the Wii Remote Jacket

- Be sure that the Wii Remote Jacket is installed prior to gameplay to reduce the risk of harm to the remote, surrounding objects, or people.

It might be necessary to remove the Wii Remote Jacket - for example, to replace the batteries in the Wii Remote controller. If you do remove the Wii Remote Jacket, be sure to put it back on before further play.

Installing Batteries in the Wii Remote

- Pull the jacket from the base of the controller and pull the wrist strap out.

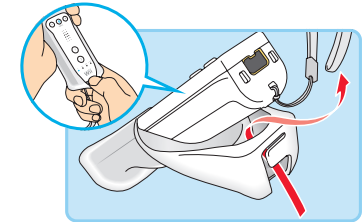

- Pull the jacket up to expose the entire battery cover and remove the cover.

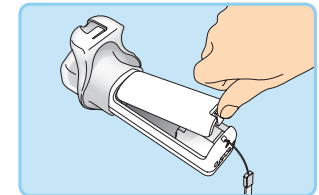

- Insert the batteries, negative (-) end first. When removing batteries, remove the positive (+) end first.

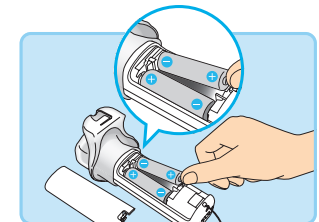

- Replace the battery cover and pull the wrist strap back through the hole in the bottom of the jacket. Pull the jacket back over the base of the controller.

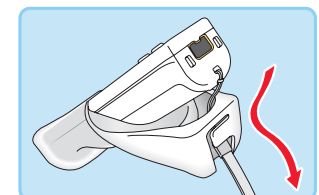

- 5** If you completely remove the jacket, replace it by inserting the controller as shown - pushing it all the way into the top of the jacket.

- Be sure to thread the wrist strap back through the hole in the bottom of the jacket, as shown in step 4.

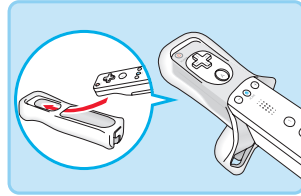

- 6** Insert the connector cover into the external extension connector on the bottom of the controller.

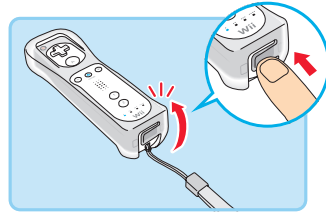

Wearing the Wii Remote Wrist Strap

- 1** Open the lever on the strap lock and place your hand through the wrist strap. Hold the remote firmly during use.

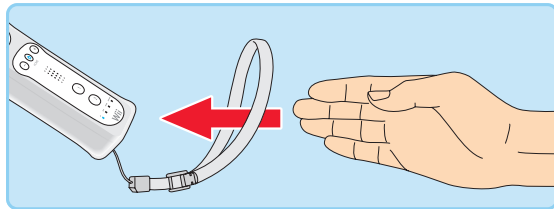

- 2** Slide the strap lock up so that the strap will not fall off your wrist. Close the lever to hold the lock in place.

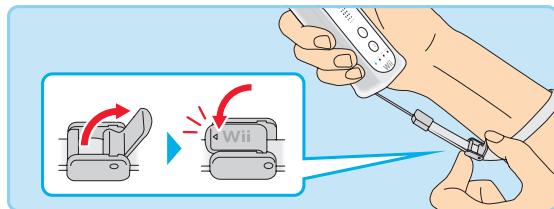

Using the Nunchuk

(The Nunchuk is an optional accessory for the Wii Remote, sold separately.)

IMPORTANT: Before using the Nunchuk™ accessory, be sure to review **Health and Safety Information on the Wii U Menu**.

- The Nunchuk can only be used with a Wii Remote controller and with games that include compatible features. Review the instructions for the game you are playing for more information.

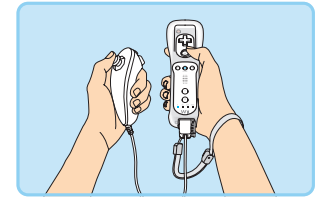

Be sure to install the Nunchuk as described. Use the connector hook on the Nunchuk plug with the wrist strap cord to prevent the Nunchuk plug from becoming separated from the external extension connector on the remote and striking objects or people.

- 1** Feed the cord on the wrist strap through the connector hook on the Nunchuk plug, as shown.

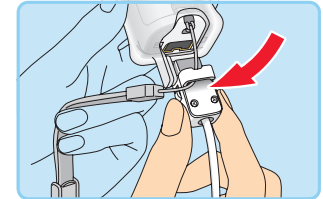

- 2** Insert the Nunchuk plug into the connector on the bottom of the remote until it snaps into place.

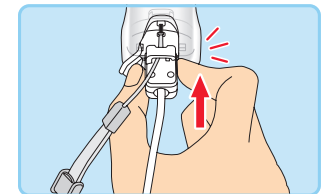

- 3 Open the lever on the strap lock and place your hand through the wrist strap. Slide the strap lock up so that the strap will not fall off your wrist. Close the lever to hold the lock in place. Hold the Wii Remote controller firmly during use.

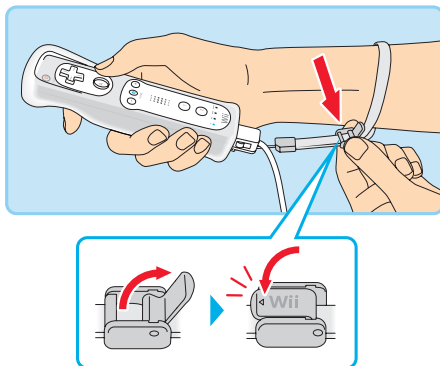

Disconnecting the Nunchuk

Press the lock/release levers on the sides of the Nunchuk plug as shown. Pull the plug straight out of the connector on the bottom of the controller.

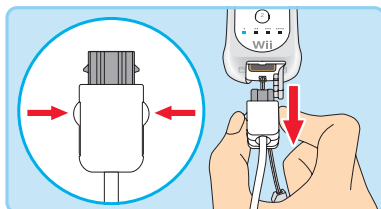

System Configuration

System Settings	32
Configuring Settings	32
User Settings	33
Adding Users	33
Switching Users	33
Internet Settings	34
Internet Connection Requirements	34
Parental Controls	36
Restriction Options	36

System Settings

In System Settings, you can configure many of the features of your Wii U system, including connecting to the Internet or managing data, or you can view information such as the system version of the Wii U console.

- System settings apply to all users. You cannot set up different settings for each user.



Configuring Settings

See the Wii U Electronic Manual (?), **System Settings**, for more information on the settings that you can configure.

Settings category

Tap to configure options for this category.

List of settings options within a category

System version of console

Icon list of settings categories

Tap an icon to select a category, or scroll between pages by sliding the stylus or tapping the page scroll arrow.

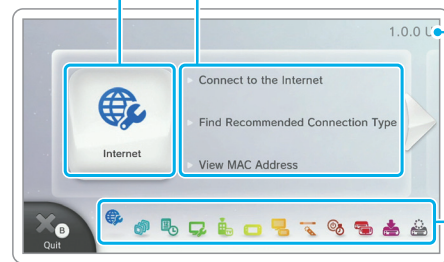

Descriptions of Settings

The TV screen will display information about configuring the specific setting during the process.

Use the R Stick on the Wii U GamePad to scroll through the information on the TV screen.

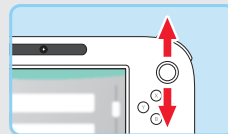

User Settings

On the Wii U system, game save data, gameplay times, and other player information can be saved and managed for each person using the system.

If more than one person will be using the Wii U system, see the information below for adding multiple users or switching users.

Adding Users

To add a user, tap **New User** on the user-selection screen that appears after turning on the Wii U console, then follow the on-screen instructions.

To use network-based services or features, you must first configure various settings, including those for your Internet connection. See the Wii U Electronic Manual (?), **User Settings**, for additional information.

- You can have a maximum of 12 users on a single Wii U console.
- You can also add a user by touching the Mii™ character in the upper-left corner of the Wii U Menu.

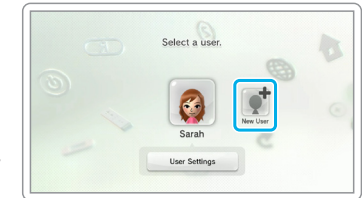

Switching Users

You can display the user-selection screen by touching the Mii character in the upper-left corner of the Wii U Menu. Touch a Mii character to switch to that user.

Touch **User Settings** to change the Mii character used for a particular user, or to delete a user.



Internet Settings

Connect to the Internet to download software not available in stores and play online with people around the world.

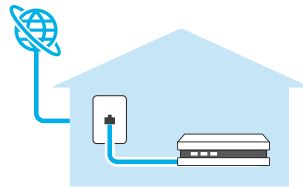

Internet Connection Requirements

What you will need depends on your household environment.

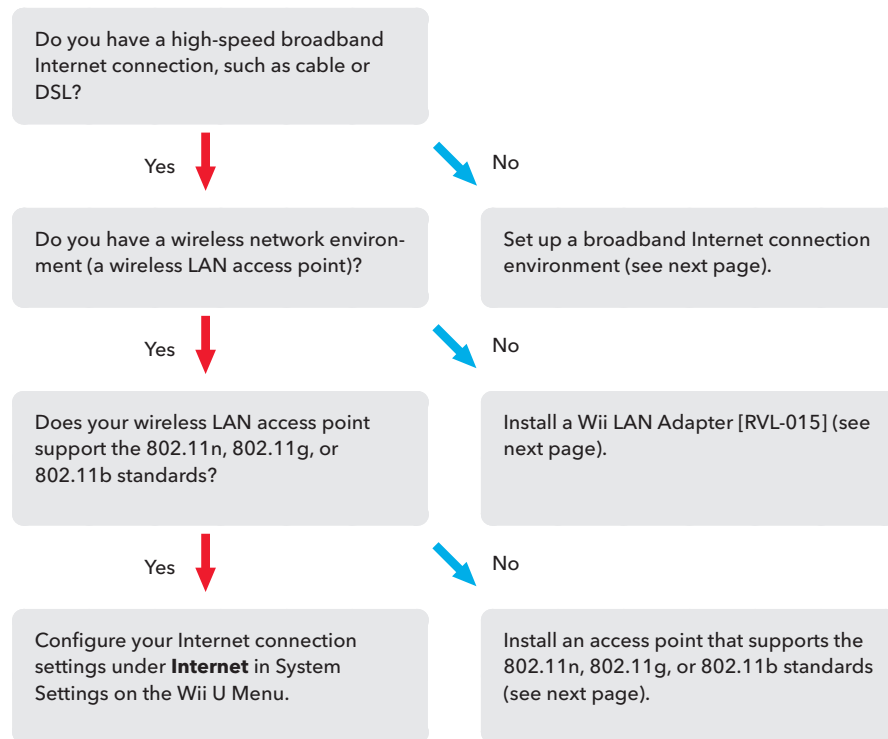

Broadband Internet Environment

There may be several options to get a broadband connection to your home. Cable, DSL, and optical-fiber networks are among the most common. Check with your local broadband providers for more information.

Communication Device (Wired or Wireless)

You will need one of the following.

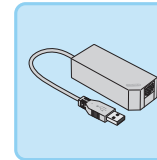

Wii LAN Adapter (sold separately)

This connects to the Internet using a cable connection. See the LAN adapter manual for information on how to connect the LAN adapter.

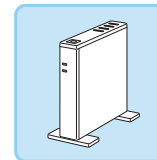

Wireless LAN Access Point (sold separately)

Use an access point that supports the 802.11n, 802.11g, or 802.11b standard to connect to the Internet wirelessly.

Setup can be simplified if you use an access point that includes one of the following features:



- If you are using a bridge modem that does not include any router functionality, you will also need a separate broadband router.
- Visit support.nintendo.com for a list of wireless access points (routers) confirmed to work with the Wii U console. You cannot use access points that only support the 802.11a standard.

When your network environment is ready...

Configure your connection settings in System Settings, **Internet**, on the Wii U Menu.

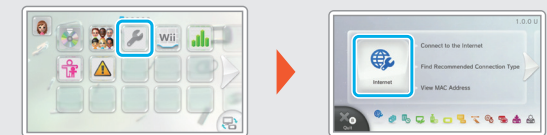

Parental Controls

Parental Controls can limit the download and use of certain content on the Wii U system. Parental Controls can also limit the use of certain Wii U system features.

- When Parental Controls are enabled, some System Settings, such as Internet Settings, System Transfer, and Format System Memory, cannot be accessed. You will need to enter the PIN to access these features.



IMPORTANT: A parent or guardian should configure the Parental Controls settings.

PIN for Identification

Make sure to not forget the PIN and answer to the secret question that you create when setting Parental Controls. If you do forget these, tap **"I Forgot"** in the upper right corner of the screen and follow the instructions displayed.

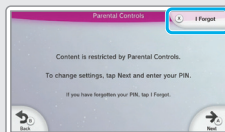

Restriction Options

See the Wii U Electronic Manual (📖), **Parental Controls**, for more information.

IMPORTANT: Restriction options are dependent on the availability of system features. A System Update may be required for a complete list of options.

Game Rating	Restricts all usage (as well as purchase through Nintendo eShop) of software exceeding the selected rating.
Online Interaction in Games	Restricts online features and exchange of content through games.
Internet Browser	Restricts the use of the Internet browser.
Wii U Shopping Services	Restricts the use of credit cards or the purchase of software through services such as Nintendo eShop.
Miiverse	Restricts users from viewing or posting content on Miiverse.
Friend Registration	Prevents the registration of additional friends.
Entertainment Excluding Games	Restricts the viewing of video content, both streaming and stored on physical media such as discs. This setting may also restrict software with video-playback functions.
Data Management	Restricts the deletion or moving of software or save data using Data Management
Internet Settings	Restricts the addition, modification, or deletion of Internet settings

- Some features, such as Adding Users (p. 33) and Format System Memory, are restricted automatically.
- The Wii U Menu and the Wii Menu have different restriction options.

System Operations

Transferring System Data	38
Data You Can Transfer.....	38
Transfer Procedure.....	39
On-Screen Keyboard	40
Wii U On-Screen Keyboard	40
Input Modes	40
Controller Calibration	41
Calibrating the Touch Screen.....	41
Resetting the L and R Control Sticks.....	41
Battery Replacement	42
Wii U GamePad	42
Wii U Pro Controller.....	44
Wii U Console.....	46

Transferring System Data

You can transfer software, saved game data, and other data from your Wii console to your Wii U console.

In addition to the Wii U system, you will need the following items before transferring:

- An operational Wii system and two Wii Remote controllers—one paired with the Wii console and one paired with the Wii U console (p. 24).
- An SD or SDHC Memory Card (with at least 512 MB of free space)
- A broadband Internet connection (both systems must be connected to the Internet)
 - See the **Wii Operations Manual - Channels & Settings** for details on Internet connections for the Wii console.

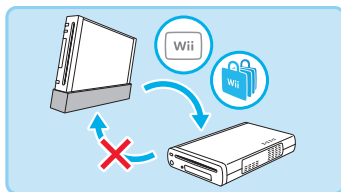



IMPORTANT: Transferred data is permanently deleted from the Wii console. Once you have transferred data to the Wii U console, it cannot be transferred back to a Wii console. Data cannot be transferred from your Wii U console to a Wii console.

Data You Can Transfer

You can transfer the following data only. All data that can be transferred will be transferred at one time, so you are unable to select which data to transfer.

Visit support.nintendo.com/wiiu/transferdata for more information.

 Wii Software	<ul style="list-style-type: none"> ● Wii Software Save Data¹ ● WiiWare and Save Data^{1,2} ● Virtual Console titles and Save Data^{1,2} ● Add-on Content
 Wii Shop Channel	<ul style="list-style-type: none"> ● Wii Points³ ● Wii Shop Channel Account Activity
Other	<ul style="list-style-type: none"> ● Mii Characters⁴

- 1 When transferring save data on an SD Card, transfer data after returning it to the Wii console.
- 2 Preinstalled software cannot be transferred. Visit support.nintendo.com for more information.
- 3 Any Wii Points you have purchased will be added to the balance in the Wii Shop Channel, accessed from the Wii Menu application on the Wii U console. Transfer is not possible if the combined point total would exceed 10,000 Wii Points.
- 4 Mii characters are moved to the Mii Channel, accessed from the Wii Menu application on the Wii U console.

When Deleting Software or Moving to an SD Card from a Wii U console

If you delete software purchased from the Wii Shop Channel, or move it to an SD Card, the software will appear in the Wii Shop Channel on the Wii Menu of Wii U. You can download it again from the Wii Shop Channel at no cost.

Transfer Procedure

IMPORTANT: To avoid loss of data or damage to your system or components, do not remove the SD Card, turn off the console, or unplug the AC adapter during the transfer process.

Both systems must be connected to a TV. If both systems are connected to the same TV, you will need to switch between the two systems as you go through the transfer steps. There are two ways this can be done:

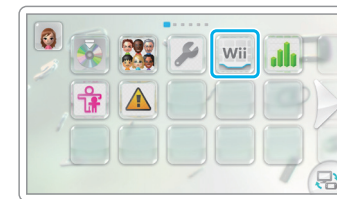

- Use the input select of the TV to switch between the two systems; or
- Plug the standard AV cable that came with your Wii console into your TV and swap the cable between the two systems during the transfer process. (Swap the cables at the same time you are swapping the SD Card.)

See the illustration below for the transfer procedure and follow the on-screen instructions. Use the Wii Remote controller for navigating the screen and making selections.

Wii U

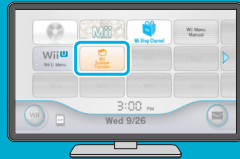

1. Insert the SD Card into the Wii U console.
2. On the Wii U system, start the Wii Menu application and select **Wii System Transfer**.
3. Follow the on-screen instructions.
4. Remove the SD Card from the Wii U console and insert the same SD Card into the Wii console.

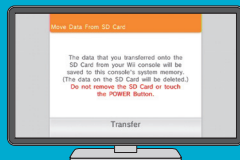

1. To begin transferring data, insert the SD Card into the Wii U console.
2. Confirm the message and select Transfer.
3. The data on the SD Card is saved on to the Wii U console and deleted from the SD Card.

Wii



1. With the SD Card inserted in the Wii console, open Wii Shop Channel and download the transfer application.
2. After the download is complete, select the transfer application to begin retrieving the data.
3. When the data transfer is complete, remove the SD Card from the Wii console and insert it into the Wii U console.

NOTE: The data you are able to transfer is saved to the SD Card that was used with the Wii U console.

On-Screen Keyboard

You can use the on-screen keyboard when you need to enter text.

Wii U On-Screen Keyboard

Tap the keys on the keyboard to enter text or to switch input modes (PC-style keyboard shown).

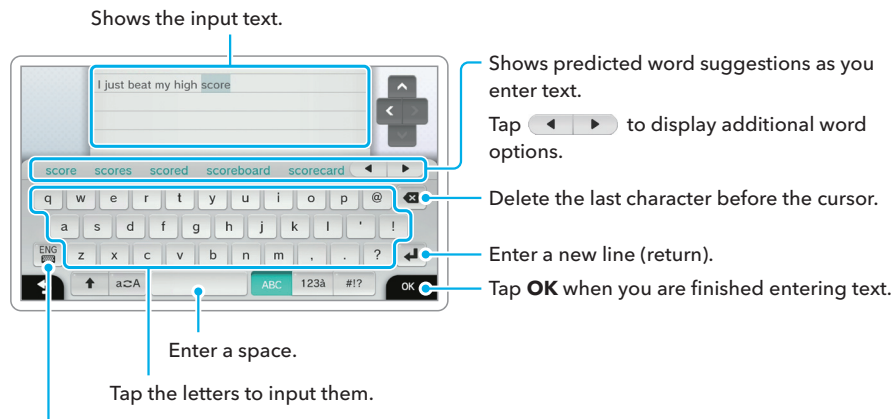

Switch the character set based on language, or to other special character sets.

Input Modes

There are three input modes (all modes may not be available in some software titles).

PC style	A keyboard with the same alphabetic layout as a computer.
Numbers and accented characters	A keyboard with numbers, letters with accents, and a few symbols.
Special symbols	A keyboard with various symbols.

Controller Calibration

Use the following instructions to recalibrate the Touch Screen or reset the L and R control sticks if they do not seem to be operating correctly.

Calibrating the Touch Screen

Open the Wii U Menu and select System Settings. Select the option for calibrating the Wii U GamePad Touch Screen and follow the on-screen instructions. If you are unable to use the Touch Screen properly, use the +Control Pad and .



Resetting the L and R Control Sticks

The neutral position of the control sticks can be incorrectly set if you move them during the following actions:

- turning the console on
- launching software
- quitting software and returning to the Wii U Menu

This can cause erratic gameplay control or cause objects on the screen to move when you are not using the controller.

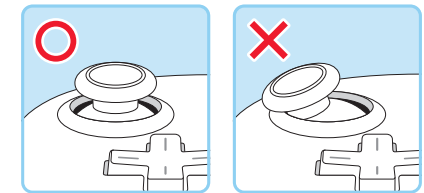

Wii U GamePad L Stick

Reset Procedure

To reset the control sticks, allow them to return to a neutral untouched position and simultaneously hold down , , , and for at least three seconds.

Battery Replacement

Rechargeable batteries become worn with repeated charge/discharge cycles, and the amount of time they can be used when fully charged will decrease gradually over time (after 500 charges, usage time may be reduced to 70%). If you feel the usage time has dropped off noticeably, replace the battery.

IMPORTANT: Batteries should always be replaced by an adult.

Wii U GamePad

Do not use any battery other than the Wii U GamePad Battery, Model No. WUP-012.

A replacement battery can be ordered from the Nintendo website at store.nintendo.com (USA/Canada only) or by calling Customer Service at 1-800-255-3700.

- To avoid damage to the screw or threads, use a screwdriver that is appropriate for the screw (crosshead style, size 0).
- Before replacing the battery, turn the power off and disconnect the AC adapter if it is connected to the controller.

- 1 Press and hold  for at least one second to turn off the power.**

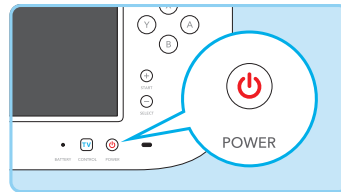

- 2 Loosen the battery cover screws.**

The battery cover is designed so the screws can be loosened, but not fully removed.

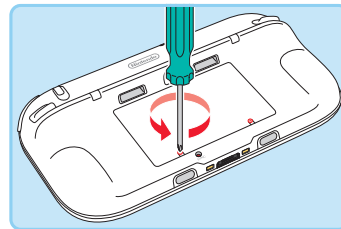

- 3 Remove the battery cover.**

Lift the edge of the battery cover slightly and then remove it as shown below.

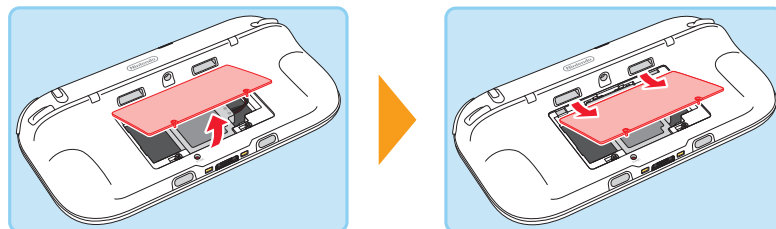

- 4 Remove the battery.**

Unplug the connector first, and then remove the battery, as shown below.

- When disconnecting the battery cable, pull by the plug, not the cable.
- Please recycle the used battery ([p. 45](#)).

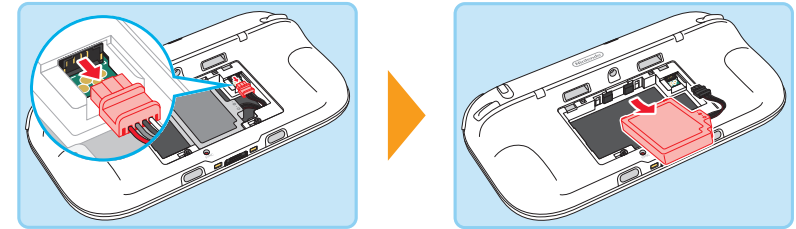

- 5 Wait at least 10 seconds before inserting the new battery.**

Make sure the battery is oriented correctly, as shown below.

- Waiting 10 seconds will allow the power LED to reset correctly.

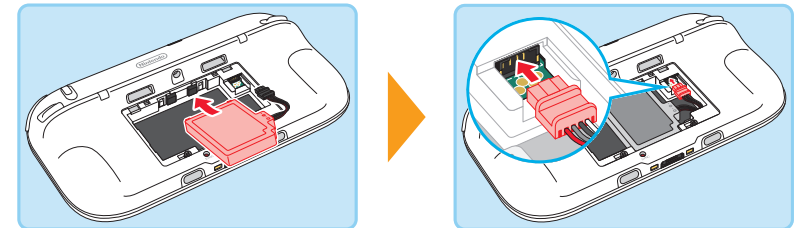

- 6 Replace the battery cover.**

After replacing the battery cover, tighten the two screws, being careful not to overtighten them.

IMPORTANT: Always be sure to replace the battery cover and tighten the screws before resuming use.

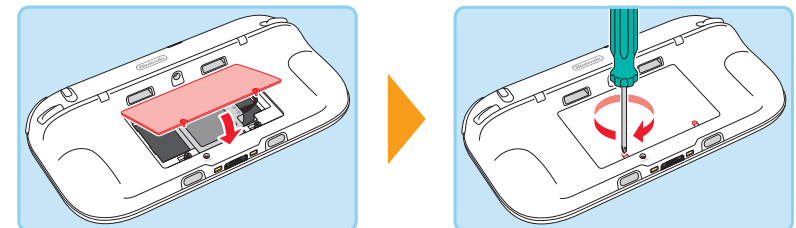

Wii U Pro Controller

Do not use any battery other than the Wii U Pro Controller rechargeable battery, Model No. CTR-003.

A replacement battery can be ordered from the Nintendo website at store.nintendo.com (USA/Canada only) or by calling Customer Service at 1-800-255-3700.

- Before replacing the battery, turn the Wii U console power off and disconnect the USB cable if it is connected to the controller.
- To avoid damage to the screw or threads, use a screwdriver that is appropriate for the screw (crosshead style, size 0).

1 Loosen the screw and remove the battery cover.

The battery cover is designed so the screw can be loosened, but not fully removed.

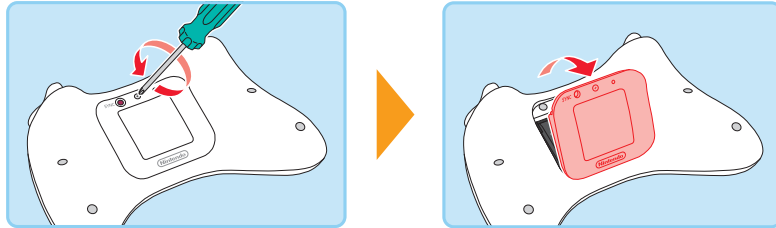

2 Remove the battery.

Insert the stylus from the Wii U GamePad under the battery, as shown below, and gently lift the edge, allowing you to remove the battery.

- Please recycle the used battery (p. 45).

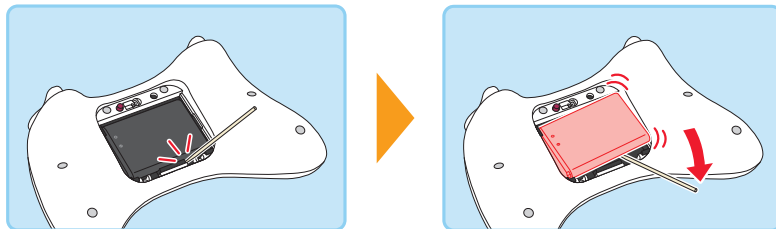

3 Wait at least 10 seconds before inserting the new battery.

Make sure the battery is oriented correctly, as show in the illustration.

- Waiting 10 seconds will allow the power LED to reset correctly.

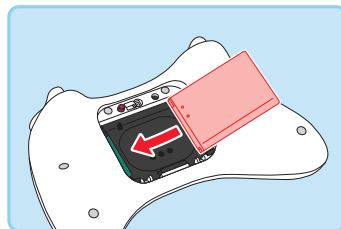

4 Replace the battery cover.

After replacing the battery cover, tighten the screw, being careful not to overtighten it.

IMPORTANT: Always be sure to replace the battery cover and tighten the screw before resuming use.

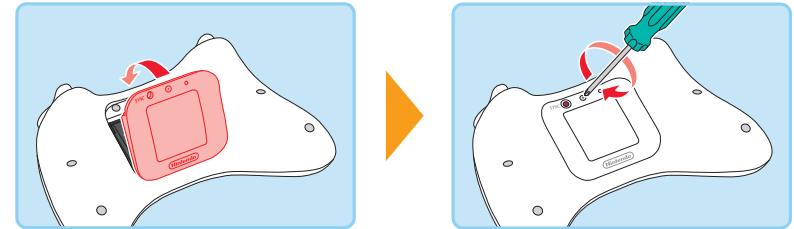

PLEASE RECYCLE YOUR USED BATTERIES

When disposing of a rechargeable battery, take care to follow appropriate local guidelines and regulations.

Cover the terminals with tape before recycling.

- Do not disassemble, attempt to repair, or deform the battery pack.
- Do not dispose of rechargeable batteries in a fire.

To find a collection site near you, contact your local solid waste authority or, in the United States, visit:

<http://www.epa.gov/osw/conserve/materials/battery.htm>

For more information or for assistance from Nintendo, visit: recycle.nintendo.com

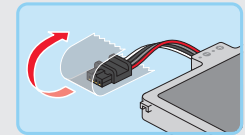

Battery for the
Wii U GamePad

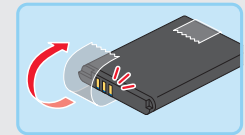

Battery for the
Wii U Pro Controller

Wii U Console

The Wii U console uses a lithium coin cell battery. **Contains perchlorate material - special handling may apply.** For more information visit www.dtsc.ca.gov/hazardouswaste/perchlorate/.

- Do not remove the battery from the Wii U console unless it needs to be replaced (if the console clock stops functioning).
- To avoid damage to the screw or threads, use a screwdriver that is appropriate for the screw (crosshead style, size 0).

1 Make sure that the disc LED is not on.

If the disc LED is illuminated, press  on the front of the console to eject the Game Disc.

2 Turn the power off and unplug the AC adapter.

Make sure the power LED is off, and then unplug the AC adapter from the wall outlet.

3 Turn the console over, and remove the battery cover.

The battery cover is designed so the screw can be loosened, but not fully removed.

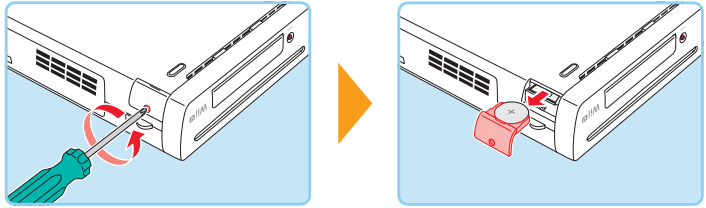

4 Remove the button cell battery, and replace the battery cover.

Insert a new battery (type CR2032) so that the + (positive) side is up, and then replace the battery cover.

After replacing the battery cover, tighten the screw, being careful not to overtighten it.

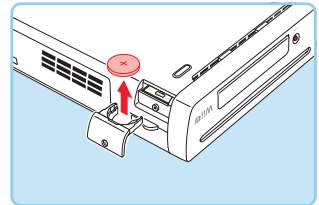

IMPORTANT: Always be sure to replace the battery cover and tighten the screw before resuming use.

Handling Used Button Cell Batteries

- Cover the + (positive) and - (negative) sides with tape.
- Dispose of following local laws and regulations.
- For more information visit www.dtsc.ca.gov/hazardouswaste/perchlorate/.

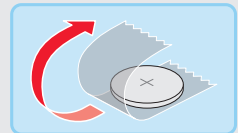

Consumer Information

Troubleshooting	48
Warranty and Service Information.....	54
Regulations for Equipment Use.....	55

Troubleshooting

Before seeking assistance, please review the following problems and solutions. You can also visit support.nintendo.com for assistance and additional troubleshooting and repair options, or call 1-800-255-3700.

- Additional information can be found in the Wii U Electronic Manual (📖), **Troubleshooting**.
- See the Wii Menu Electronic Manual (📖) for more information about using the Wii Menu.
- Review instruction manuals for any games or accessories you are using.

Power supply and operating temperature

The Wii U console won't turn on.

Are the DC and AC plugs of the AC adapter fully inserted?	Check the connections to make sure they are fully inserted (see the Wii U Quick Start Guide).
Is the Power LED of the Wii U console lit?	If the Wii U console's power LED does not turn on even after pressing the Power Button, unplug the AC adapter from the wall, wait two minutes, and plug it in again. If the power LED is blinking red, unplug the AC adapter from the wall. Make sure that the console is not in a location where it is exposed to high temperatures and that it has proper ventilation (at least 4"/10 cm). Wait about two minutes, then plug the AC adapter back into the outlet and turn the console power on.

The Wii U GamePad won't turn on.

Is the battery depleted?	Recharge the Wii U GamePad (p. 18). If the battery LED blinks orange when charging, check the battery replacement information to make sure that the battery pack is installed correctly (p. 42).
--------------------------	-----------------------------------------------------------------------------------------------------------------------------------------------------------------------------------------------------

The Wii U console suddenly shuts off.

Is there dust or other material clogging or blocking the console vents?	Unplug the AC adapter for the Wii U console from the wall outlet, and remove any dust, dirt, or other foreign material from the vents.
Is the console located where it can be exposed to high temperatures?	Move the console away from sources of heat and make sure there is at least 4" (10 cm) between the console vents and any walls or other objects.
Is the Wii U console's automatic shutoff feature enabled?	If the automatic shutoff feature is enabled, the system will automatically turn off if there has been no input for a set period of time. You can adjust the period of time in System Settings on the Wii U Menu, Automatic Shutoff .

The Wii U console or Wii U GamePad feel hot to the touch.

Is the system or controller exposed to high temperatures, or is the controller being used for long periods while charging it?	Such use can cause the system to become hot. Use the system and components within the following temperature recommendations: Wii U console: 50°-104°F (10°-40°C) Wii U GamePad: 50°-95°F (10°-35°C) Wii U Pro Controller: 50°-95°F (10°-35°C)
-------------------------------------------------------------------------------------------------------------------------------	--------------------------------------------------------------------------------------------------------------------------------------------------------------------------------------------------------------------------------------------------------

The Wii U console will not turn off (the power LED won't turn red).

Did you press and hold down the POWER Button for at least one second?	If the power does not turn off after holding down the POWER Button for at least one second (the power LED should turn from blue to red), unplug the Wii U AC adapter from the wall outlet. <ul style="list-style-type: none"> • You cannot use the Wii U GamePad to turn off the console power if you are using the Wii Menu or playing a Wii Game Disc.
-----------------------------------------------------------------------	-------------------------------------------------------------------------------------------------------------------------------------------------------------------------------------------------------------------------------------------------------------------------------------------------------------------------------------------------------------------------

The Wii U GamePad won't turn off.

Did you press and hold down the GamePad POWER Button for at least one second?	If the power does not turn off after holding down the GamePad POWER Button for at least one second, then hold the POWER Button down for at least four seconds.
-------------------------------------------------------------------------------	----------------------------------------------------------------------------------------------------------------------------------------------------------------

The Wii U GamePad battery LED does not turn on

The battery LED will only turn on when charging the battery or when the battery level is low.

Batteries and battery charging

Cannot charge or recharging takes a long time.	
Are you using the correct charging equipment?	<ul style="list-style-type: none"> • Wii U GamePad - use the Wii U GamePad AC adapter, Model No. WUP-011(USA). • Wii U Pro Controller - use the Wii U Pro Controller USB Cable, Model No. WUP-018.
Is the AC adapter plug or USB cable fully inserted?	<ul style="list-style-type: none"> • Wii U GamePad - remove the AC adapter for two minutes, then reinsert it into the AC adapter connector on the controller or charging stand and into the power outlet, and try recharging again (p. 18). • Wii U Pro Controller - remove the USB cable, wait a few seconds, then reinsert it and try recharging again (p. 20).
NOTE: You can only charge the Wii U Pro Controller when the Wii U console is turned on.	
Are you charging at an ambient temperature of 50°-95°F (10°-35°C)?	Charge within the recommended temperature range of 50°-95°F (10°-35°C). Battery charging can be adversely affected by extremes of temperature.
Is the battery LED blinking orange?	Make sure that the battery is properly connected - see the section on Battery Replacement (p. 42). If the LED is still blinking during the charging procedure, contact Nintendo Customer Service.

Battery charge doesn't last long and/or recharging takes a long time.	
Are you playing or charging at an ambient temperature below 50°F (10°C)?	Usage time may be reduced and recharge time may be increased when temperatures are below 50°F (10°C). For best results, use the system within the recommended temperature range of 50°-95°F (10°-35°C).
Are you using an old battery?	Over time and repeated charging, battery performance will gradually decrease. If the usage time has gotten noticeably shorter, the battery may need to be replaced (p. 42).

The battery appears slightly swollen.	
Due to the nature of lithium-ion batteries, repeated charging and use over time can cause the battery pack to swell. If the battery pack is swollen and battery duration doesn't last very long, it should be replaced (p. 42).	
If the battery leaks fluid or is exposed to moisture, see the Battery Leakage warning in Health and Safety Information (p. 4) and contact Nintendo Customer Service for repair information.	

TV screen display and audio

The TV screen doesn't display anything, or there is no sound.	
Has the TV input been correctly set?	Press the input button on the TV several times to switch between inputs until the Wii U screen appears. <ul style="list-style-type: none"> • If you are using an HDMI cable, it might take some time until an image is displayed on the TV screen, depending on your TV model. Wait a short time after switching the input.
Are the connection method and resolution configured correctly?	Check the configuration in System Settings on the Wii U Menu, TV , for your cable and TV combination.
Are you using any accessories not licensed by Nintendo or not designed for use with the Wii U system?	Remove any unlicensed or incompatible components or accessories from your system.

Wii U GamePad screen

The Wii U GamePad screen doesn't display anything.	
Is the Wii U GamePad battery LED slowly blinking blue?	If the LED is blinking blue, the screen has been turned off. Press one of the buttons (other than the POWER Button) to turn the screen back on.
If you press the POWER Button with the AC adapter connected, does the screen display turn on after a few seconds?	If the screen turns on, the Wii U GamePad's battery level is low. Recharge the battery. If the screen still does not display anything, contact Nintendo Customer Service for repair information.

Wii U GamePad screen (continued)

I can't use the Touch Screen or the Touch Screen does not respond properly.	
Is there anything near the Wii U console or controller that could interfere with the signal between the two components?	Avoid using the Wii U system near large metal objects or TV stands or devices that might cause electromagnetic interference (such as AV devices, microwave ovens, or cordless devices).
Does the Touch Screen need to be calibrated?	If the Touch Screen positioning appears to be off, calibrate the Touch Screen in System Settings on the Wii U Menu, Wii U GamePad . If you are unable to operate the Wii U Menu properly using the Touch Screen, use the +Control Pad and A .
Have you attached a screen protector to the Touch Screen?	The Touch Screen can react to a screen protector that is out of alignment, or to air bubbles or foreign particles trapped between the sheet and the screen, causing improper operation. Try removing it and using the screen again. If it operates correctly, reattach the screen protector, carefully following the instructions included with it, or avoid using one. <ul style="list-style-type: none"> • Please use screen protectors officially licensed by Nintendo.

The Wii U GamePad screen appears irregular or erratic/sound is intermittent.	
Is anything blocking or interfering with the signal between the console and the GamePad?	Remove possible causes of interference, such as metal racks or shelves, or wireless devices, microwave ovens, or AV equipment.
The video or sound may cut off at times. This is due to the nature of wireless communication and does not indicate a defective product.	

The Wii U GamePad screen color changes, the screen brightness changes erratically, or bright colors cannot be seen.	
Is power-saving mode on?	When the power-saving mode is on, the system automatically adjusts the screen brightness and color to match the displayed image, in order to reduce battery power use. Depending on the image, faint colors may look washed out, or the color may appear to change. For uniform brightness and hue, open the HOME Menu off and turn power-saving mode off (p. 19).

Some pixels on the Wii U GamePad screen are always dark or lit.	
Due to the characteristics of liquid crystal displays, a small number of pixels may not illuminate or may always stay lit. This is normal and not considered a defect unless the number of pixels that don't function normally increases over time.	

Wii Remote controllers

I can't use the Wii Remote, or the Wii Remote does not respond properly.	
Is the Player LED on the Wii Remote lit?	Press one of the buttons on the Wii Remote (not the POWER Button). If the Player LED does not turn on, make sure that the batteries are inserted correctly. If the LED still won't turn on, replace both of the batteries.
Have you synchronized the Wii Remote with this Wii U console?	Press the SYNC Button on the Wii U console and follow the instructions on the screen.
Are you either too close or too far from the sensor bar?	Always play from 3-10' (1-3 m) from the sensor bar. If this does not resolve the issue, adjust the sensor bar sensitivity in System Settings on the Wii U menu, Adjust Sensitivity .
Is there any obstruction in front of the sensor bar?	Remove any objects that might be blocking the signals between the Wii Remote and the sensor bar.
Is the sensor bar installed correctly?	Make sure that the sensor bar is placed correctly (p. 25). Make sure the sensor bar plug is fully inserted into the connector on the console.
Are there any play conditions that could interfere with the operation of the remote?	If you think any of the following conditions are affecting the operation of the remote, try removing or reducing the source of interference: <ul style="list-style-type: none"> • Bright light sources, including sunlight, behind or near the TV, shining toward the remote or reflecting off the TV screen • Highly reflective surfaces near the sensor bar • Sources of infrared light in the gameplay area such as electric, propane, or kerosene heaters, flames from fireplaces or candles, and stoves or other sources of heat • Radio frequency interference may cause the Wii Remote to work erratically. Check for and move or turn off wireless devices such as cordless phones, wireless computer keyboards or mice, or other similar devices
Is the Wii Remote pointed at the sensor bar?	Point the Wii Remote at the front of the sensor bar when using.
If the remote does not operate normally after checking all of the above, press the POWER button on the Wii U console and make sure the Power LED is red, and then unplug the Wii U AC adapter from the wall outlet. Wait two minutes, then plug the AC adapter back into the wall outlet, turn the Wii U console power on, and try using the remote again.	

If your Wii U system still does not operate correctly after trying the troubleshooting steps, DO NOT return the console to the store. You may lose saved game data, Nintendo eShop downloads, and any balance left in your Nintendo eShop account. For assistance and additional troubleshooting and repair options visit support.nintendo.com, or call 1-800-255-3700.

Warranty and Service Information

You may need only simple instructions to correct a problem with your product. Try our website at support.nintendo.com or call our Consumer Assistance Hotline at 1-800-255-3700, rather than going to your retailer. Hours of operation are 6 a.m. to 7 p.m., Pacific Time, Monday - Sunday (times subject to change). If the problem cannot be solved with the troubleshooting information available online or over the telephone, you will be offered express factory service through Nintendo. Please do not send any products to Nintendo without contacting us first.

HARDWARE WARRANTY

Nintendo of America Inc. ("Nintendo") warrants to the original purchaser that the hardware product shall be free from defects in material and workmanship for twelve (12) months from the date of purchase. If a defect covered by this warranty occurs during this warranty period, Nintendo will repair or replace the defective hardware product or component, free of charge.* The original purchaser is entitled to this warranty only if the date of purchase is registered at point of sale or the consumer can demonstrate, to Nintendo's satisfaction, that the product was purchased within the last 12 months.

GAME & ACCESSORY WARRANTY

Nintendo warrants to the original purchaser that the product (games and accessories) shall be free from defects in material and workmanship for a period of three (3) months from the date of purchase. If a defect covered by this warranty occurs during this three (3) month warranty period, Nintendo will repair or replace the defective product, free of charge.*

SERVICE AFTER EXPIRATION OF WARRANTY

Please try our website at support.nintendo.com or call the Consumer Assistance Hotline at 1-800-255-3700 for troubleshooting information and repair or replacement options and pricing.*

* In some instances, it may be necessary for you to ship the complete product, FREIGHT PREPAID AND INSURED FOR LOSS OR DAMAGE, to Nintendo. Please do not send any products to Nintendo without contacting us first.

WARRANTY LIMITATIONS

THIS WARRANTY SHALL NOT APPLY IF THIS PRODUCT: (a) IS USED WITH PRODUCTS NOT SOLD OR LICENSED BY NINTENDO (INCLUDING, BUT NOT LIMITED TO, NON-LICENSED GAME ENHANCEMENT AND COPIER DEVICES, ADAPTERS, SOFTWARE, AND POWER SUPPLIES); (b) IS USED FOR COMMERCIAL PURPOSES (INCLUDING RENTAL); (c) IS MODIFIED OR TAMPERED WITH; (d) IS DAMAGED BY NEGLIGENCE, ACCIDENT, UNREASONABLE USE, OR BY OTHER CAUSES UNRELATED TO DEFECTIVE MATERIALS OR WORKMANSHIP; OR (e) HAS HAD THE SERIAL NUMBER ALTERED, DEFACED OR REMOVED.

ANY APPLICABLE IMPLIED WARRANTIES, INCLUDING WARRANTIES OF MERCHANTABILITY AND FITNESS FOR A PARTICULAR PURPOSE, ARE HEREBY LIMITED IN DURATION TO THE WARRANTY PERIODS DESCRIBED ABOVE (12 MONTHS OR 3 MONTHS, AS APPLICABLE). IN NO EVENT SHALL NINTENDO BE LIABLE FOR CONSEQUENTIAL OR INCIDENTAL DAMAGES RESULTING FROM THE BREACH OF ANY IMPLIED OR EXPRESS WARRANTIES. SOME STATES DO NOT ALLOW LIMITATIONS ON HOW LONG AN IMPLIED WARRANTY LASTS OR EXCLUSION OF CONSEQUENTIAL OR INCIDENTAL DAMAGES, SO THE ABOVE LIMITATIONS MAY NOT APPLY TO YOU.

This warranty gives you specific legal rights. You may also have other rights which vary from state to state or province to province.

Nintendo's address is: Nintendo of America Inc., P.O. Box 957, Redmond, WA 98073-0957 U.S.A.

This warranty is only valid in the United States and Canada.

Regulations for Equipment Use

Regulations for Equipment Use in U.S.A. and Canada

FCC and Industry Canada Information

In order to comply with FCC radio-frequency radiation exposure guidelines for an uncontrolled exposure, this device and its antenna must not be co-located or operating in conjunction with any other antenna or transmitter.

This device complies with Part 15 of the FCC Rules and RSS-210 of Industry Canada. Operation is subject to the following two conditions: (1) This device may not cause harmful interference, and (2) this device must accept interference received, including interference that may cause undesired operation.

Changes or modifications not expressly approved by the manufacturer could void the user's authority to operate this device.

This equipment has been tested and found to comply with the limits of a Class B digital device, pursuant to part 15 of the FCC Rules and the Canadian ICES-003 Class B specifications. These limits are designed to provide reasonable protection against harmful interference in a residential installation. This equipment generates, uses and can radiate radio frequency energy and, if not installed and used in accordance with the instructions, may cause harmful interference to radio communications. However, there is no guarantee that interference will not occur in a particular installation. If this equipment does cause harmful interference to radio or television reception, which can be determined by turning the equipment off and on, the user is encouraged to try to correct the interference by one or more of the following measures:

- Reorient or relocate the receiving antenna.
- Increase the separation between the equipment and receiver.
- Connect the equipment into an outlet on a circuit different from that to which the receiver is connected.
- Consult the dealer or an experienced radio/TV technician or call Nintendo Consumer Service at 1-800-255-3700 for assistance.

The user may find the following booklet prepared by the Federal Communications Commission helpful: How to Identify and Resolve Radio-TV Interference Problems. This booklet is available from the U.S. Government Printing Office, Washington, D.C., 20402, Stock No. 004-000-00345-4.

Usage restrictions for the Wii U console and Wii U GamePad:

This product is restricted to indoor use only to reduce any potential for harmful interference with licensed operation in the 5.15-5.25 GHz range.

⚠ WARNING - RADIO FREQUENCY EXPOSURE

To comply with FCC and IC RF exposure compliance requirements when using the Wii U console, a separation distance of at least eight inches (20 cm) must be maintained between the antenna of this device and all persons.

MEMO

.....

.....

.....

.....

.....

.....

.....

.....

.....

.....

.....

.....

.....

.....

.....

.....

.....

.....

.....

.....

.....

.....

.....

.....

.....

Free Manuals Download Website

<http://myh66.com>

<http://usermanuals.us>

<http://www.somanuals.com>

<http://www.4manuals.cc>

<http://www.manual-lib.com>

<http://www.404manual.com>

<http://www.luxmanual.com>

<http://aubethermostatmanual.com>

Golf course search by state

<http://golfingnear.com>

Email search by domain

<http://emailbydomain.com>

Auto manuals search

<http://auto.somanuals.com>

TV manuals search

<http://tv.somanuals.com>