

Nokia Stereo Headset HS-16

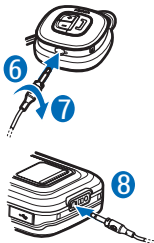

9202246/1



© 2007 Nokia. All rights reserved.

Reproduction, transfer, distribution or storage of part or all of the contents in this document in any form without the prior written permission of Nokia is prohibited.

Nokia and Nokia Connecting People are registered trademarks of Nokia Corporation. Other product and company names mentioned herein may be trademarks or tradenames of their respective owners.

Nokia operates a policy of ongoing development. Nokia reserves the right to make changes and improvements to any of the products described in this document without prior notice.

Under no circumstances shall Nokia be responsible for any loss of data or income or any special, incidental, consequential or indirect damages howsoever caused.

The contents of this document are provided "as is". Except as required by applicable law, no warranties of any kind, either express or implied, including, but not limited to, the implied warranties of merchantability and fitness for a particular purpose, are made in relation to the accuracy, reliability or contents of this document. Nokia reserves the right to revise this document or withdraw it at any time without prior notice.

The availability of particular products may vary by region. Please check with the Nokia dealer nearest to you.

Export Controls

This device may contain commodities, technology or software subject to export laws and regulations from the US and other countries. Diversion contrary to law is prohibited.

Introduction

With the Nokia Stereo Headset HS-16 you can make and answer calls and listen to music from a compatible device.

Keep all accessories and enhancements out of the reach of small children.

Parts of the headset are magnetic. Metallic materials may be attracted to the headset. Do not place credit cards or other magnetic storage media near the headset, because information stored on them may be erased.



Warning: When you use the headset, your ability to hear outside sounds may be affected. Do not use the headset where it can endanger your safety.

Get started

Unfold the headset, and select the correct cable according to the connector on your device.

To connect the headset to a compatible Nokia device that has the Nokia 2.5-mm or 3.5-mm AV connector, use the cable labeled with "Nokia AV 2.5 mm" or "Nokia AV 3.5 mm". See the user guide of the device for details. Insert one plug of the cable into the connector (part 1 shown on the title page) on the headset (6) and the labeled plug into the AV connector on your mobile device (8).

To connect the headset to a compatible device (such as a PC or music player) with the standard 3.5-mm audio connector, use the cable labeled with "3.5 mm". Insert one plug of the cable into the headset and the labeled plug into your device. When you use this cable, you cannot make or receive calls or adjust the volume with the headset.

To lock the plug into the headset, turn the plug clockwise (7). (To unlock the plug, turn it counterclockwise.)

To put the headset on your head, lower the neckband behind your head, and place the headset over your ears so that the speaker pads fit comfortably. The headset is now ready for use.

Call handling

To make a call, use your mobile device in the normal way. During the call, speak into the microphone (2) of the headset.

To answer an incoming call, press the answer/end key (3). To reject an incoming call, press the answer/end key twice. To end a call, press the answer/end key.

To adjust the volume, press the volume up (4) or volume down (5) key.

Care and maintenance

Your device is a product of superior design and craftsmanship and should be treated with care. The following suggestions will help you protect your warranty coverage.

- Keep the device dry. Precipitation, humidity, and all types of liquids or moisture can contain minerals that will corrode electronic circuits. If your device does get wet, allow it to dry completely.

- Do not use or store the device in dusty, dirty areas. Its moving parts and electronic components can be damaged.
- Do not store the device in hot areas. High temperatures can shorten the life of electronic devices, damage batteries, and warp or melt certain plastics.
- Do not store the device in cold areas. When the device returns to its normal temperature, moisture can form inside the device and damage electronic circuit boards.
- Do not attempt to open the device.
- Do not drop, knock, or shake the device. Rough handling can break internal circuit boards and fine mechanics.
- Do not use harsh chemicals, cleaning solvents, or strong detergents to clean the device.
- Do not paint the device. Paint can clog the moving parts and prevent proper operation.

If the device is not working properly, take it to the nearest authorized service facility for service.



Disposal

The crossed-out wheeled-bin symbol on your product, literature, or packaging reminds you that in the European Union all electrical and electronic products, batteries, and accumulators must be taken to separate collection at the end of their working life. Do not dispose of these products as unsorted municipal

waste.

Return the products to collection to prevent possible harm to the environment or human health from uncontrolled waste disposal and to promote the sustainable reuse of material resources. Collection information is available from the product retailer, local waste authorities, national producer responsibility organizations, or your local Nokia representative. For more information, see product Eco-Declaration or country-specific information at www.nokia.com.

Free Manuals Download Website

<http://myh66.com>

<http://usermanuals.us>

<http://www.somanuals.com>

<http://www.4manuals.cc>

<http://www.manual-lib.com>

<http://www.404manual.com>

<http://www.luxmanual.com>

<http://aubethermostatmanual.com>

Golf course search by state

<http://golfingnear.com>

Email search by domain

<http://emailbydomain.com>

Auto manuals search

<http://auto.somanuals.com>

TV manuals search

<http://tv.somanuals.com>