

Operation Manual

7 inch Wide AV System Display

AVX-7650

English

Español

Português (B)

中文

العربية

Thank you for buying this Pioneer product.

Please read through these operating instructions so you will know how to operate your model properly. *After you have finished reading the instructions, keep this manual in a safe place for future reference.*

01 Precautions

- IMPORTANT SAFEGUARDS 3
- To ensure safe driving 3
- To avoid battery exhaustion 3

Specifications 18

02 Before You Start

- About this unit 4
- About this manual 4
- Precautions 4
- To protect the LCD screen 4
- For viewing LCD comfortably 4
- Resetting the microprocessor 4
- Use and care of the remote control 5

03 What's What

- Display unit 6
- Remote control 7

04 Basic Operations

- Turning the unit on and selecting a source 8
- Turning the unit off 8
- Opening and closing the LCD panel 8
- Changing the wide screen mode 9
- Adjusting the picture adjustment 10
- Protecting your unit from theft 11

05 Other Functions

- Introduction of setup adjustments 12
- Setting the video input 1 12
- Setting the video input 2 12
- Switching the warning tone 13
- Setting the automatic open function 13
- Setting the clock 13
- Switching the background display 14

Additional Information

- Troubleshooting 15
- Using the display correctly 16

Precautions

IMPORTANT SAFEGUARDS

Please read all of these instructions regarding your display and retain them for future reference.

- 1 **Read this manual fully and carefully before operating your display.**
- 2 **Keep this manual handy as a reference for operating procedures and safety information.**
- 3 **Pay close attention to all warnings in this manual and follow the instructions carefully.**
- 4 **Do not allow other persons to use this system until they have read and understood the operating instructions.**
- 5 **Do not install the display where it may (i) obstruct the driver's vision, (ii) impair the performance of any of the vehicle's operating systems or safety features, including air bags, hazard lamp buttons or (iii) impair the driver's ability to safely operate the vehicle.**
- 6 **As with any accessory in your vehicle's interior, the display should not divert your attention from the safe operation of your vehicle. If you experience difficulty in operating the system or reading the display, please park safely before making adjustments.**
- 7 **Do not attempt to install or service your display by yourself. Installation or servicing of the display by persons without training and experience in electronic equipment and automotive accessories may be dangerous and could expose you to the risk of electric shock or other hazards and can cause damage to the system that is not covered by warranty.**
- 8 **Please remember to wear your seat belt at all times while operating your vehicle. If you are ever in an accident, your injuries can be considerably more severe if your seat belt is not properly buckled.**
- 9 **Never use headphones while driving. **

To ensure safe driving



WARNING

- **LIGHT GREEN LEAD AT POWER CONNECTOR IS DESIGNED TO DETECT PARKED STATUS AND MUST BE CONNECTED TO THE POWER SUPPLY SIDE OF THE PARKING BRAKE SWITCH. IMPROPER CONNECTION OR USE OF THIS LEAD MAY VIOLATE APPLICABLE LAW AND MAY RESULT IN SERIOUS INJURY OR DAMAGE.**
- To avoid the risk of accident and the potential violation of applicable laws, the front DVD or TV feature should never be used while the vehicle is being driven. Also, rear displays should not be in a location where it is a visible distraction to the driver.
- In some countries or states the viewing of images on a display inside a vehicle even by persons other than the driver may be illegal. Where such regulations apply, they must be obeyed.

This unit detects whether your vehicle's parking brake is engaged or not, and prevents you from watching a DVD or TV on the front display while driving. When you attempt to watch a DVD or TV, the warning **VIDEO VIEWING IS NOT AVAILABLE WHILE DRIVING** will appear on the front display.

To watch a DVD or TV on the front display, park your vehicle in a safe place and apply the parking brake. 

To avoid battery exhaustion

Be sure to run the vehicle engine while using this unit. Using this unit without running the engine can result in battery drainage.



WARNING

Do not use with vehicles that do not feature an ACC position. 

About this unit

NTSC/PAL compatibility

This unit is NTSC/PAL system compatible. When connecting other components to this unit, be sure components are compatible with the same video system otherwise images will not be correctly reproduced.

About this manual

This unit features a number of sophisticated functions ensuring superior reception and operation. All the functions have been designed for the easiest possible use, but many are not self-explanatory. This operation manual will help you benefit fully from this unit's potential and to maximize your listening enjoyment. We recommend that you familiarize yourself with the functions and their operation by reading through the manual before you begin using this unit. It is especially important that you read and observe precautions noted on this page and in other sections.

Precautions

- Keep this manual handy as a reference for operating procedures and precautions.
- Always keep the volume low enough so that you can hear sounds from outside the vehicle.
- Protect this unit from moisture.
- If the battery is disconnected or discharged, the preset memory will be erased and must be reprogrammed.
- If this unit does not operate properly, contact your dealer or nearest authorized Pioneer Service Station.

To protect the LCD screen

- Do not allow direct sunlight to fall on the display when this unit is not being used. Extended exposure to direct sunlight can result in LCD screen malfunction due to the resulting high temperatures.
- When using a portable phone, keep the antenna of the portable phone away from the display to prevent disruption of the video by the appearance of spots, colored stripes, etc.

For viewing LCD comfortably

Due to its construction, the view angle of the LCD screen is limited. The viewing angle (vertical and horizontal) can be increased, however, by using **BRIGHT** to adjust the black density of the video. When using for the first time, adjust the black density in accordance with the viewing angle (vertical and horizontal) to adjust for clear viewing. **DIMMER** can also be used to adjust the brightness of the LCD screen itself to suit your personal preference.

Resetting the microprocessor

The microprocessor must be reset under the following conditions:

- Prior to using this unit for the first time after installation
- If the unit fails to operate properly
- When strange or incorrect messages appear on the display

Before You Start

- Press **RESET** with a pen tip or other pointed instrument.

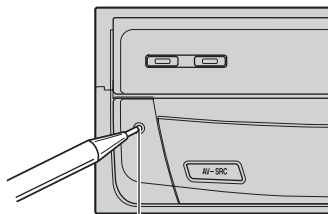

RESET button



Use and care of the remote control

Installing the battery

Slide the tray out on the back of the remote control and insert the battery with the plus (+) and minus (-) poles pointing in the proper direction.

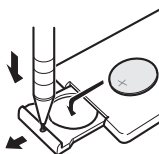

! WARNING

Keep the battery out of the reach of children. Should the battery be swallowed, immediately consult a doctor.

! CAUTION

- Use only one **CR2025 (3 V)** lithium battery.
- Remove the battery if the remote control is not used for a month or longer.
- Do not recharge, disassemble, heat or dispose of the battery in fire.
- Do not handle the battery with metallic tools.

- Do not store the battery with metallic materials.
- In the event of battery leakage, wipe the remote control completely clean and install a new battery.
- When disposing of used batteries, please comply with governmental regulations or environmental public institutions' rules that apply in your country/area.

Using the remote control

Point the remote control in the direction of the front panel to operate.

- The remote control may not function properly in direct sunlight.

👉 Important

- Do not store the remote control in high temperatures or direct sunlight.
- Do not let the remote control fall onto the floor, where it may become jammed under the brake or accelerator pedal. 

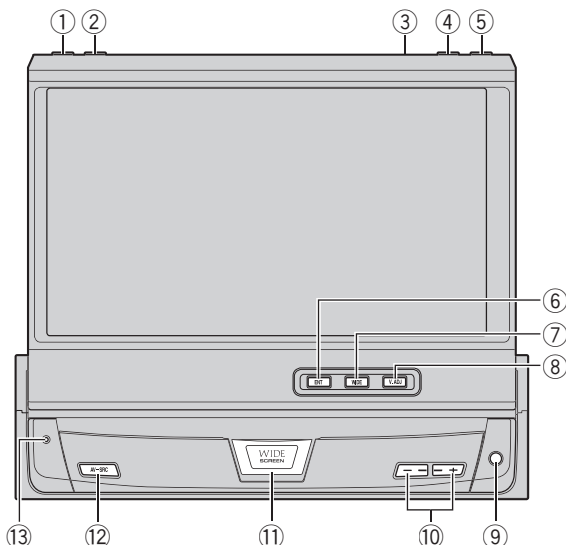

Display unit

① DISPLAY button

Press to display various informations.

② BACK LIGHT button

Press and hold to turn the backlight off.
Press again to turn the backlight on.

③ Ambient light sensor

Senses ambient light. This system automatically adjusts the brightness of the display to compensate for ambient light.

④ FLIP DOWN button

Press to turn the LCD panel horizontal temporarily from upright position.

⑤ OPEN/CLOSE button

Press to open or close the LCD panel.

⑥ ENTERTAINMENT button

Press to switch between the background displays.

⑦ WIDE button

Press to select a desired mode for enlarging a 4:3 picture to a 16:9 one.

⑧ V.ADJ button

Press and hold to display the picture adjustment menu.

⑨ Signal receptor

Receives signals from a remote control.

⑩ ANGLE (+/-) button

Press to change the LCD panel angle.

⑪ RELEASE button

Move downward to remove the front panel from this unit.

⑫ AV SOURCE button

This unit is turned on by selecting a source. Press to cycle through all the available sources.

⑬ RESET button

Press to return to the factory settings (initial settings). 

What's What

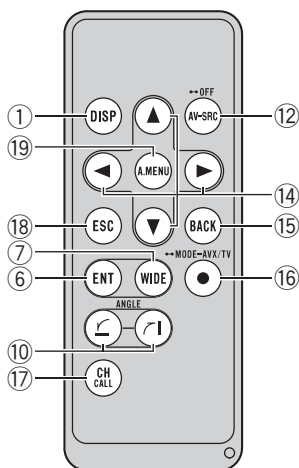

Remote control

⑭ ▲/▼/◀/▶ buttons

Press to control functions.

⑮ BACK button

Press to return to the previous display.

⑯ MODE button

Press and hold to switch the operation mode between **AVX** and **TV** modes. Normally, set to **AVX**.

- **AVX** – For common operation of this unit
- **TV** – Only for TV tuner operation

For details, refer to **TV mode operation** on this page.

⑰ CH CALL button

Press to display the TV reception information such as the channel and band.

⑱ ESC button

Press to cancel the control mode of functions.

⑲ A.MENU button

Press to display **MENU**. Also used for selecting functions.

TV mode operation

To operate the TV, switch the mode to **TV**. In this case, ▲, ▼, ◀, ▶ and **A.MENU** buttons' operation is changed for TV.

- For details concerning operation, refer to the TV tuner's operation manuals.
- **When you want to operate the following functions, switch the mode to TV:**
 - When performing manual or seek tuning by pressing ◀ or ▶.
 - When recalling preset stations by pressing ▲ or ▼.
 - When selecting the country group by pressing **A.MENU** and then pressing ◀ or ▶. (This function can be operated only when connecting a TV tuner (e.g. GEX-P6450TVP) featuring the country setting.)



Note

With the mode switched to **TV**, you cannot use **ESC**, **BACK** and **DISPLAY** buttons. □

Turning the unit on and selecting a source

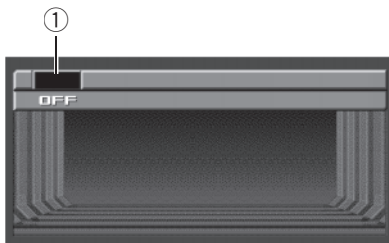

① Source icon

Shows which source has been selected.

● Press AV SOURCE to select a video source.

Press **AV SOURCE** repeatedly to switch between the following sources:

AV-1 (video input 1)—**AV-2** (video input 2)
—**AV** (video of currently selected source)



Notes

- Equipment which is connected to AV-BUS input can be selected as **AV** source. You can watch video from connected equipment which is selected as a source by a head unit.
- In the following cases, the sound source will not change:
 - When there is no unit corresponding to the selected source connected to this unit.
 - When **AV INPUT1** (video input 1) and/or **AV INPUT2** (video input 2) are not set to **VIDEO** (refer to page 12). □

Turning the unit off

- Press **AV SOURCE** and hold until the unit turns off. □

Opening and closing the LCD panel

The LCD panel will be opened or closed automatically with the turning of the ignition switch on or off. You can turn off the automatic close/open function. (Refer to page 13.)

- Do not close the LCD panel with hands by force. That cause malfunction.
- The automatic close/open function will operate the display as follows.
 - When the ignition switch is turned OFF while the LCD panel is opened, the LCD panel will close after six seconds.
 - When the ignition switch is turned ON again (or turned to ACC), the LCD panel will be opened automatically.
 - Removing or attaching the front panel will automatically close or open the LCD panel. (Refer to page 11.)
- When the ignition switch is turned OFF after the LCD panel has been closed, turning the ignition switch ON again (or turning it to ACC) will not open the LCD panel. In this case, press **OPEN/CLOSE** to open the LCD panel.
- When closing the LCD panel, check to make sure that it has closed completely. If the LCD panel has stopped halfway, leaving it like this could result in damage.

● Press OPEN/CLOSE to open the LCD panel.

- To close the LCD panel, press **OPEN/CLOSE** again.

Adjusting the LCD panel angle



Important

- If you can hear the LCD panel knocking against your vehicle's console or dashboard, press **ANGLE (-)** to move the LCD panel a little forward.

Basic Operations

- When adjusting the LCD panel angle, be sure to press **ANGLE (+/-)**. Forcibly adjusting the LCD panel by hand may damage it.

- **Press ANGLE (+/-) to adjust the LCD panel to an easily viewable angle.**

The LCD panel angle continues changing as long as you press **ANGLE (+/-)** and hold.

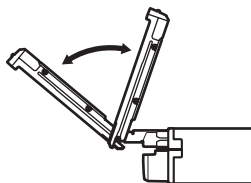

- The adjusted the LCD panel angle will be memorized and automatically returned to the next time the LCD panel is opened.

Turning the LCD panel horizontal

When the LCD panel is upright and it hinders the operation of the air conditioner, the panel can be turned horizontal temporarily.

- **Press FLIP DOWN to turn the LCD panel horizontal.**

- To return to original position, press **FLIP DOWN** again.
- The LCD panel returns to the original position automatically with beeping sound 10 seconds after operation. □

Changing the wide screen mode

You can select a desired mode for enlarging a 4:3 picture to a 16:9 one.

- **Press WIDE to select the desired setting.**

Press **WIDE** repeatedly to switch between the following settings:

FULL (full)—**JUST** (just)—**CINEMA** (cinema)
—**ZOOM** (zoom)—**NORMAL** (normal)

FULL (full)

A 4:3 picture is enlarged in the horizontal direction only, giving you a 4:3 TV picture (normal picture) without any omissions.

JUST (just)

The picture is enlarged slightly at the center and the amount of enlargement increases horizontally to the ends, enabling you to enjoy a 4:3 picture without sensing any disparity even on a wide screen.

CINEMA (cinema)

The picture is enlarged by the same proportion as **FULL** or **ZOOM** in the horizontal direction and by an intermediate proportion between **FULL** and **ZOOM** in the vertical direction; ideal for a cinema-sized picture (wide screen picture) where captions lie outside.

ZOOM (zoom)

A 4:3 picture is enlarged in the same proportion both vertically and horizontally; ideal for a cinema-sized picture (wide screen picture).

NORMAL (normal)

A 4:3 picture is displayed as it is, giving you no sense of disparity since its proportions are the same as that of the normal picture.





Notes

- Different settings can be memorized for each video source.
- When video is viewed in a wide screen mode that does not match its original aspect ratio, it may appear different.
- Remember that using the wide mode feature of this system for commercial or public viewing purposes may constitute an infringement on the author's rights protected by the Copyright Law.

- Video will appear grainy when viewed in **CINEMA** or **ZOOM** mode.
- The rear view camera picture is always **FULL**. 

Adjusting the picture adjustment

You can adjust **BRIGHT** (brightness), **CONTRAST** (contrast), **COLOR** (color) and **HUE** (hue) for each source and rear view camera.

- The adjustments of **BRIGHT** and **CONTRAST** are stored separately for light ambient (daytime) and dark ambient (nighttime). A sun  or moon  is displayed to the left of **BRIGHT** and **CONTRAST**, respectively, as the ambient light sensor determines brightness or darkness.
- You cannot adjust **HUE** for PAL video.
- You cannot adjust **COLOR** or **HUE** for the audio source.
- This unit detects whether your vehicle's parking brake is engaged or not, and prevents you from adjusting the picture adjustment while driving. When you attempt to adjust the picture adjustment, the warning **YOU CANNOT USE THIS FUNCTION WHILE DRIVING** will appear on the display and indicate that the picture adjustment cannot be used.

1 Press V.ADJ and hold to display PICTURE ADJUST.

Press **V.ADJ** until **PICTURE ADJUST** appears in the display.

2 Use ▲, ▼ and A.MENU to select the function to be adjusted.

Press ▲/▼ to change the function; press **A.MENU** to select the function.

The adjustment function names are displayed and adjustable ones are highlighted.

- **BRIGHT** – Adjust the black intensity

- **CONTRAST** – Adjust the contrast
- **COLOR** – Adjust the color saturation
- **HUE** – Adjust the tone of color (red is emphasized or green is emphasized)
- **DIMMER** – Adjust the brightness of display
- **BACK-CAMERA** – Switch to the picture adjustment display for the rear view camera
- **SOURCE** – Return to the picture adjustment display for each source

■ You can adjust the picture adjustment for rear view camera only when **B. CAMERA** is turned on. (Refer to *Setting for rear view camera* on page 12.)

■ **SOURCE** will appear in the display instead of **BACK-CAMERA** when you select **BACK-CAMERA**.

■ With some rear view cameras, picture adjustment may not be possible.

3 Press ◀ or ▶ to adjust the selected item.

Each press of ◀ or ▶ increases or decreases the level of selected item. **+24** – **–24** is displayed as the level is increased or decreased.

4 Press ESC to return to the display of each source.

Adjusting the dimmer

The adjustment of **DIMMER** is stored separately for each ambient light; daytime, evening and nighttime. The brightness of LCD screen will be adjusted to optimum level automatically in accordance with the ambient light based on the setting values.

1 Press V.ADJ and hold to display PICTURE ADJUST.

Press **V.ADJ** until **PICTURE ADJUST** appears in the display.

2 Press ▲ or ▼ to select DIMMER.

The ambient light level used as the standard for adjusting **DIMMER** appears above the level bar.

Basic Operations

- Yellow sun ☀ – Adjust the brightness for bright ambient light (daytime)
- Red sun 🌅 – Adjust the brightness for intermediate brightness (evening)
- Blue moon 🌙 – Adjust the brightness for dark ambient light (nighttime)

3 Press ◀ or ▶ to adjust the brightness.

Each press of ◀ or ▶ moves yellow towards the left or the right.

The level indicates the brightness of the screen being adjusted. The farther yellow moves to the right, the brighter the screen.

4 Press ESC to return to the display of each source.

Note

The icons indicating the current ambient brightness used for adjusting **BRIGHT** and **CONTRAST** may differ from **DIMMER** slightly. 

Protecting your unit from theft

The front panel can be detached from this unit to discourage theft.

- If the front panel is not detached from this unit within five seconds of turning off the ignition, a warning tone will sound.
- You can turn off the warning tone. See *Switching the warning tone* on page 13.

Important

- Never use force or grip the display and the buttons too tightly when removing or attaching.
- Avoid subjecting the front panel to excessive shocks.
- Keep the front panel out of direct sunlight and high temperatures.
- If removed, replace the front panel on the unit before starting up your vehicle.

Removing the front panel

- Move downward **RELEASE** and remove the front panel toward you.

The LED indicator will flash while the front panel is being detached.

Take care not to grip it too tightly or to drop the front panel and protect it from contact with water or other fluids to prevent permanent damage.

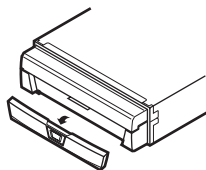

Attaching the front panel

- Replace the front panel by clipping it into place.

Align the groove on the bottom of the front panel with the guide on the display unit.

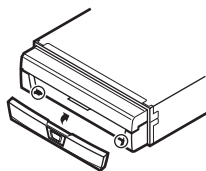

- Press **RELEASE** until the front panel clicks into place. 

Introduction of setup adjustments

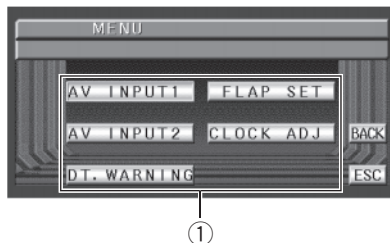

① Function display

Shows the function names.

1 Press A.MENU to display the function names.

The function names are displayed and operable ones are highlighted.

2 Use ▲, ▼, ◀, ▶ and A.MENU to select the desired function.

Press ▲/▼/◀/▶ to change the function; press A.MENU to select the function.

The function selected with ▲/▼/◀/▶ is displayed with a frame.

- To return to the previous display, press **BACK**.
- To return to the display of each source, press **ESC**.

Note

If you do not operate the setup function within about 30 seconds, the display is automatically returned to the source display. 

Setting the video input 1

You can switch the setting according to the connected component.

- Select **VIDEO** to watch video of a connected component as **AV-1** source.

1 Use ▲, ▼, ◀, ▶ and A.MENU to select AV INPUT1.

2 Press ◀ or ▶ to select the video input 1 setting.

Press ◀ or ▶ until the desired setting appears in the display.

- **OFF** – No video component is connected
- **VIDEO** – External video component 

Setting the video input 2

You can switch the setting according to the connected component.

- Select **VIDEO** to watch video of a connected component as **AV-2** source.
- Select **B. CAMERA** when a rear view camera is installed on your vehicle.

1 Use ▲, ▼, ◀, ▶ and A.MENU to select AV INPUT2.

2 Press ◀ or ▶ to select the video input 2 setting.

Press ◀ or ▶ until the desired setting appears in the display.

- **OFF** – No video component is connected
- **VIDEO** – External video component
- **B. CAMERA** – Rear view camera

Setting for rear view camera

CAUTION

Pioneer recommends the use of a camera which outputs mirror reversed images, otherwise screen image may appear reversed.

This unit features a function that automatically switches to the rear view camera video

Other Functions

(**VIDEO 2/BACK CAMERA INPUT** jack) when a rear view camera is installed on your vehicle. When the gear shift is in **REVERSE (R)** position, the video automatically switches to a rear view camera video. (For more details, consult your dealer.)

- Confirm the setting immediately whether the display changes to a rear view camera video when the gear shift is moved to **REVERSE (R)** from another position.
- When the display changes to a rear view camera video during normal drivings, switch to another setting.
- To return to the source display, press **V.ADJ.**

1 Use ▲, ▼, ◀, ▶ and A.MENU to select AV INPUT2.

2 Press ◀ or ▶ to select B. CAMERA.

3 Press ▼ to select POLARITY.

4 Press ◀ or ▶ to select an appropriate setting for polarity.

Each press of ◀ or ▶ switches between the following polarity:

- **BATTERY** – When the polarity of the connected lead is positive while the gear shift is in **REVERSE (R)** position
- **GND** – When the polarity of the connected lead is negative while the gear shift is in **REVERSE (R)** position

Switching the warning tone

If the front panel is not detached from this unit within five seconds of turning off the ignition, a warning tone will sound. You can turn off the warning tone.

1 Use ▲, ▼, ◀, ▶ and A.MENU to select DT. WARNING.

2 Press ▲ to turn warning tone on.

- To turn warning tone off, press ▼.

Setting the automatic open function

To prevent the display from hitting the shift lever of an automatic vehicle when it is in **P** (park) position, or when you do not wish the display to open/close automatically, you can set the automatic open function in the manual mode.

Furthermore, to adjust the LCD panel slide position, you can turn the set back on or off.

1 Use ▲, ▼, ◀, ▶ and A.MENU to select FLAP SET.

2 Press ▲ and the LCD panel slides to the back.

- Press ▼ and the LCD panel slides to the front.

3 Press ◀ or ▶ to select the display to open/close automatically or manually.

Press ◀ to select **MANUAL**, and you have to press **OPEN/CLOSE** to open/close the display. Press ▶ to select **AUTO**, and the display automatically opens/closes when power to this unit is turned on.

Setting the clock

Use these instructions to set the clock.

1 Use ▲, ▼, ◀, ▶ and A.MENU to select CLOCK ADJ.

2 Press ◀ or ▶ to select OFF and then press A.MENU to turn the clock display on.

ON will appear in the display instead of **OFF**. Clock display is now on.

- To turn the clock display off, press ◀ or ▶ to select **ON** and then press **A.MENU**.

3 Press ◀ or ▶ to select the segment of the clock display you wish to set.

Each press of ◀ or ▶ selects one segment of the clock display:

Hour—Minute

As you select segments of the clock display the segment selected will be highlighted.

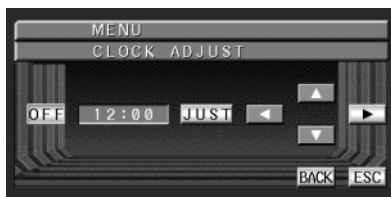

4 Press ▲ or ▼ to set the clock.

Pressing ▲ will increase the selected hour or minute. Pressing ▼ will decrease the selected hour or minute.

Notes

- You can match the clock to a time signal by pressing ◀ or ▶ to select **JUST** and then pressing **A.MENU**.
 - If the minute is **00—29**, the minutes are rounded down. (e.g., **10:18** becomes **10:00**.)
 - If the minute is **30—59**, the minutes are rounded up. (e.g., **10:36** becomes **11:00**.)
- Even when the sources are off, the clock display appears on the display. 

Switching the background display

You can switch background displays while listening to each source.

● Press **ENTERTAINMENT**.

Each time you press **ENTERTAINMENT** the display changes in the following order:
Video of currently selected source—**BGV** (background visual)

- When this unit is turned off, you cannot use **ENTERTAINMENT**.

Note

When the selected source is an audio source, when you select the video of currently selected source, nothing is displayed on the display. 

Additional Information

Troubleshooting

Common

Symptom	Cause	Action (See)
Power doesn't turn on. The unit doesn't operate.	Leads and connectors are incorrectly connected.	Confirm once more that all connections are correct.
	The fuse is blown.	Rectify the reason for the fuse blowing, then replace the fuse. Be very sure to install the correct fuse with the same rating.
	Noise and other factors are causing the built-in microprocessor to operate incorrectly.	Press RESET . (Page 4)
Operation with the remote control isn't possible. The unit does not operate correctly even when the appropriate remote control buttons are pressed.	The remote control operation mode is incorrect.	Switch to the correct remote control mode. (Page 7)
	Battery power is low.	Load new battery. (Page 5)
There is no picture.	The parking brake cord is not connected.	Connect a parking brake cord, and apply the parking brake.
	The parking brake is not applied.	Connect a parking brake cord, and apply the parking brake.
There is audio and video skipping.	The unit is not firmly secured.	Secure the unit firmly.
When the ignition switch is turned ON (or turned to ACC), the motor sounds.	The unit is confirming whether a disc is loaded or not.	This is a normal operation.
Nothing is displayed.	The rear view camera is not connected. B. CAMERA is at incorrect setting.	Connect a rear view camera. Press V.ADJ to return to the source display and then select the correct setting for B. CAMERA . (Page 12)



Additional Information

Using the display correctly

CAUTION

- If liquid or foreign matter should get inside this unit, turn off the power immediately and consult your dealer or the nearest authorized PIONEER Service Station. Do not use the unit in this condition because doing so may result in a fire, electric shock, or other failure.
- If you notice smoke, a strange noise or smell, or any other abnormal signs from the display, turn off the power immediately and consult your dealer or the nearest authorized PIONEER Service Station. Using this unit in this condition may result in permanent damage to the system.
- Do not disassemble or modify this unit, as there are high-voltage components inside which may cause an electric shock. Be sure to consult your dealer or the nearest authorized PIONEER Service Station for internal inspection, adjustments or repairs.

Handling the display

- When the display is subjected to direct sunlight for a long period of time, it will become very hot resulting in possible damage to the LCD screen. When not using this unit, close the display and avoid exposing it to direct sunlight.
- The display should be used within the temperature ranges shown below.
Operating temperature range: -10 to $+50$ °C
Storage temperature range: -20 to $+80$ °C
At temperatures higher or lower than the operating temperature range the display may not operate normally.
- The LCD screen of this unit is exposed in order to increase its visibility within the vehicle. Please do not press strongly on it as this may damage it.

- Do not place anything on the display when it is opened. Also, do not attempt to carry out angle adjustment, or open/close the display by hand. Applying strong force to the display may damage it.
- Do not push the LCD screen with much force as this may scratch it.
- Be careful not to place anything between the display and the main body when the display is opening or closing. If an object gets between the display and main body, the display may stop working.
- Be careful of fingers, long hair, and loose articles of clothing which could possibly get caught between the display and the main body and cause serious injury.

Liquid crystal display (LCD) screen

- If the display is near the vent of an air conditioner when it is opened, make sure that air from the air conditioner is not blowing on it. Heat from the heater may damage the LCD screen, and cool air from the cooler may cause moisture to form inside the display resulting in possible damage. Also, if the display is cooled down by the cooler, the screen may become dark, or the life span of the small fluorescent tube used inside the display may be shortened.
- Small black dots or white dots (bright dots) may appear on the LCD screen. These are due to the characteristics of the LCD screen and do not indicate a problem with the display.
- At low temperatures, the LCD screen may be dark for a while after the power is turned on.
- The LCD screen will be difficult to see if it is exposed to direct sunlight.
- When using a portable phone, keep the antenna of the portable phone away from the display to prevent disruption of the video by

Additional Information

the appearance of spots, colored stripes, etc.

Keeping the display in good condition

- When removing dust from the screen or cleaning the display, first turn the system power off, then wipe with a soft dry cloth.
- When wiping the screen, take care not to scratch the surface. Do not use harsh or abrasive chemical cleaners.

Small fluorescent tube

- A small fluorescent tube is used inside the display to illuminate the LCD screen.
 - The fluorescent tube should last for approximately 10,000 hours, depending on operating conditions. (Using the display at low temperatures reduces the service life of the fluorescent tube.)
 - When the fluorescent tube reaches the end of its useful life, the screen will be dark and the image will no longer be projected. If this happens, consult your dealer or the nearest authorized PIO-NEER Service Station. 

Specifications

General

Rated power source	14.4 V DC
	(allowable voltage range: 12.0 – 14.4 V DC)
Grounding system	Negative type
Max. current consumption	3.0 A
Dimensions (W × H × D):	
DIN	
Chassis	178 × 50 × 160 mm
Nose	188 × 58 × 30 mm
D	
Chassis	178 × 50 × 165 mm
Nose	170 × 46 × 25 mm
Weight	1.7 kg

Display

Screen size/aspect ratio	7 inch wide/16:9
	(effective display area: 154 × 87 mm)
Pixels	336,960 (1,440 × 234)
Type	TFT active matrix, transmis- sive type
Color system	NTSC/PAL compatible
Operating temperature range	-10 – +50 °C
Storage temperature range	-20 – +80 °C
Angle adjustment	50 – 110°
	(initial settings: 110°)

Infrared remote control

Wavelength	945 nm
Output	typ; 10 mw/sr per Infrared LED



Note

Specifications and the design are subject to possible modifications without notice due to improvements. ▣

感謝惠購先鋒產品。

請通讀使用說明書以了解本型號的正確操作方法。通讀完畢後，請妥善保存，以備日後參考。

01 注意事項

- 重要安全措施 60
- 確保安全駕駛 60
- 防止電池耗盡 60

02 開始使用之前

- 關於本機 61
- 關於本說明書 61
- 注意事項 61
- 保護LCD螢幕 61
- 舒適觀看LCD須知 61
- 重置微處理器 61
- 遙控器之使用與保養 61

03 按鈕功能

- 顯示幕 63
- 遙控器 64

04 基本操作

- 開啟本機與選擇播放源 65
- 關閉本機 65
- 打開與關閉LCD面板 65
- 改變寬螢幕模式 66
- 調節圖像調整 66
- 本機之防盜 67

05 其他功能

- 設置調節之介紹 68
- 設定視頻輸入1 68
- 設定視頻輸入2 68
- 切換警告音 69
- 設定自動打開功能 69
- 設定時鐘 69
- 切換背景顯示 69

● 附加資訊

- 故障排除 70
- 正確使用顯示幕 71
- 規格 72

重要安全措施

請通讀顯示幕有關指示，並將其收藏妥當，以備日後參考。

- 1 操作顯示幕之前，請完整，認真閱讀本說明書。
- 2 請將本說明書保存於隨手可取之處，以備查閱操作步驟及安全資訊。
- 3 請特別注意本說明書中的所有警告，並嚴格遵照指示操作。
- 4 他人未閱讀和了解本說明書之前，請勿讓其操作本機。
- 5 請勿將顯示幕安裝在（1）妨礙司機視線；（2）影響車輛任何操作系統或安全裝置，包括氣囊，危險警告燈按鈕等性能；或（3）影響司機安全駕駛的位置。
- 6 正如車內其他配件一樣，顯示幕不應分散安全駕駛的注意力。如果操作本機或觀看顯示幕出現困難，請將車停好後再作調整。
- 7 請勿自行安裝或維修顯示幕。若未經電子設備與汽車配件方面的專門培訓，或具有相關的工作經驗即貿然安裝或維修顯示幕，則會發生危險，導致觸電或其他事故，並造成機器損壞，這將不在保固之列。
- 8 駕車時請切記要系好安全帶。若發生意外事故時安全帶未扣好，後果將不堪設想。
- 9 切勿在駕駛時使用頭戴式耳機。▣

確保安全駕駛



警告

- 電源接口處的淺綠色引線設計用於偵測車輛停放狀態，必須將其連接至手煞車相關的電源側。該引線若連接或使用不當會違反適用法律，並導致嚴重人身傷害或機器損壞。
- 為防止出現意外事故並避免違反適用法律，切勿在行車時使用前DVD或電視機機能。此外，後顯示幕不應安裝在可能分散司機注意力的位置。
- 在某些國家或州，即使司機以外的乘客若在車內通過顯示幕觀看影像亦會違法。在實行這樣法規的地方，必須依法照辦。

本機可偵測汽車手煞車是否啟用，並防止您在駕駛時通過前顯示幕觀看DVD或電視節目。若您試圖觀看DVD或電視節目，警告**VIDEO VIEWING IS NOT AVAILABLE WHILE DRIVING**會在前顯示幕上出現。通過前顯示幕觀看DVD或電視節目時，請將車泊在安全位置，並拉起手煞車。▣

防止電池耗盡

使用本機時請務必啟動汽車引擎。在未啟動汽車引擎時使用本機會造成電池放電。



警告

請勿使用未配備ACC位置的車輛。▣

開始使用之前

關於本機

NTSC/PAL兼容性

本機兼容NTSC/PAL制式。在將其他設備連接至本機時，該設備務必兼容相同的視頻系統；否則，影像可能會無法正常再現。▣

關於本說明書

本機具備一系列高級功能，以確保接收效果和操作性能俱佳。所有這些功能均為盡可能方便使用而設計，但其中多數未自帶說明。本使用說明書將助您充分發揮本機性能，從而獲得最佳的聽覺享受。

我們建議您在開始使用本機之前先通讀本說明書，熟悉其功能以及相關操作。尤為重要的是要閱讀並遵循本頁以及其他章節中之注意事項。▣

注意事項

- 請將本說明書保存於隨手可取之處，以備查閱操作步驟及注意事項。
- 請務必保持在適當的音量，以能聽見車外的聲響為準。
- 請注意本機的防潮。
- 如果電池未接通或電量用完，預設記憶將被抹去，必須重新編序。
- 如果本機無法正常工作，請與經銷商或就近的先鋒授權服務站聯繫。▣

保護LCD螢幕

- 當本機未使用時，請勿讓顯示幕朝向直射陽光。長時間在直射陽光下會造成LCD螢幕因高溫而發生故障。
- 使用手提電話時，應將其天線遠離顯示幕，以免視頻因雪花點，彩色條紋等出現受到干擾。▣

舒適觀看LCD須知

LCD因其構造使其視角受到侷限。但是，通過使用**BRIGHT**調節視頻的黑度可增大視角（水平和垂直方向）。初次使用螢幕時，應根據視角（水平和垂直方向）調節黑度，以獲得清晰的影像。**DIMMER**亦可用於根據個人偏愛調節LCD本身的亮度。▣

重置微處理器

微處理器在以下情形必須重置：

- 安裝本機後首次使用之前
- 如果本機無法正常工作
- 當顯示幕上出現異常或不正確的訊息時
- 用筆尖或其他尖利工具按壓**RESET**。

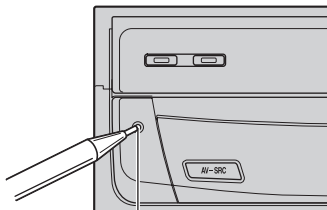

RESET按鈕

▣

遙控器之使用與保養

安裝電池

從遙控器背後滑出電池座，然後按正確的正極（+）和負極（-）方向插入電池。

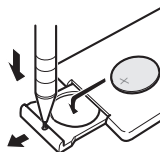

開始使用之前

警告

請讓電池遠離兒童。如果電池被其吞下，請立即就醫。

小心

- 請僅使用一節CR2025 (3 V) 鋰電池。
- 遙控器至少一個月不使用時，請取出電池。
- 請勿對電池充電，將其拆解，加熱或棄於火中。
- 請勿用金屬工具操作電池。
- 請勿用金屬材料保存電池。
- 如果出現電池漏液，請將遙控器徹底拭淨並裝上新電池。
- 處理用過的電池時，請遵循貴國或貴地區政府法規或環境公共組織的條例。

使用遙控器

將遙控器對著前面板進行操作。

- 遙控器在直射陽光下可能無法正常工作。

重要

- 請勿將遙控器保存在高溫條件或直射陽光下。
- 請勿讓遙控器墜落在地板上，否則它可能會卡在煞車或油門之下。▣

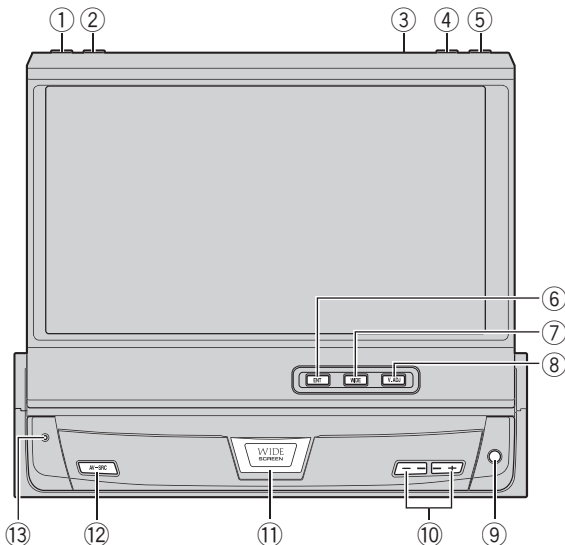

顯示幕

① DISPLAY按鈕

按該按鈕可顯示各種資訊。

② BACK LIGHT按鈕

按住該按鈕可關閉背光。再按則可開啟背光。

③ 環境光傳感器

它感應環境光。本機可自動調節顯示幕的亮度，以補償環境光。

④ FLIP DOWN按鈕

按該按鈕可暫時將LCD面板從垂直位置轉為水平位置。

⑤ OPEN/CLOSE按鈕

按該按鈕可打開或關閉LCD面板。

⑥ ENTERTAINMENT按鈕

按該按鈕可切換背景顯示。

⑦ WIDE按鈕

按該按鈕可選擇適當的模式將4:3圖像放大到16:9。

⑧ V.ADJ按鈕

按住該按鈕可顯示圖像調整選單。

⑨ 信號接收器

接收遙控器的信號。

⑩ ANGLE (+/-)按鈕

按該按鈕可改變LCD面板的角度。

⑪ RELEASE按鈕

向下移動該按鈕可將前面板從本機卸下。

⑫ AV SOURCE按鈕

選擇一個播放源可開啟本機。按該按鈕可在所有可用的播放源之間循環切換。

⑬ RESET按鈕

按該按鈕可恢復原廠設定（初始設定）。■

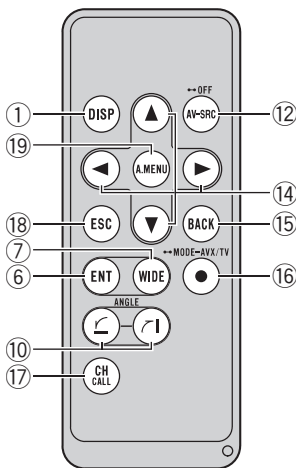

遙控器

⑭ ▲/▼/◀/▶ 按鈕

按該按鈕可控制各項功能。

⑮ BACK 按鈕

按該按鈕可返回前一顯示畫面。

⑯ MODE 按鈕

按住該按鈕可在 **AVX** 與 **TV** 模式之間切換操作模式。通常情況下應將其設定在 **AVX**。

- **AVX** – 用於本機的一般操作
- **TV** – 僅用於電視諧調器的操作

有關詳情，請參見本頁上 **TV 模式的操作**。

⑰ CH CALL 按鈕

按該按鈕可顯示電視接收資訊，例如頻道與波段。

⑱ ESC 按鈕

按該按鈕可取消各功能的控制模式。

⑲ A.MENU 按鈕

按該按鈕可顯示 **MENU**。它亦可用於選擇功能。

TV 模式的操作

操作電視機時，請將模式切換為 **TV**。在這種情況下，▲，▼，◀，▶ 與 **A.MENU** 按鈕變為電視機操作所用。

- 有關操作的詳情，請參見電視諧調器使用說明書。

● 要操作以下功能時，請將模式切換為 **TV**：

- 當通過按◀或▶執行手動或搜尋調頻時。
- 當通過按▲或▼調出預設電臺時。
- 當通過按A.MENU，然後按◀或▶選擇國家組時。（本功能僅可在連接具有國家設定「例如，GEX-P6450TVP」的電視諧調器時有效。）



注意

當模式切換為 **TV** 時，**ESC**、**BACK** 與 **DISPLAY** 按鈕無法使用。□

基本操作

開啟本機與選擇播放源



① 播放源圖示

顯示已經選擇的播放源。

● 按AV SOURCE選擇視頻播放源。

反覆按AV SOURCE可在以下播放源之間切換：

AV-1（視頻輸入1）－AV-2（視頻輸入2）－AV（當前所選播放源的視頻）

注意

- 連接至AV-BUS輸入端的設備可選為AV播放源。影像可通過由主機選為播放源的已連接設備觀看。
- 在下列情況時，音源不會改變：
 - 當本機未連接所選播放源相應的裝置時；
 - 當AV INPUT1（視頻輸入1）和/或AV INPUT2（視頻輸入2）未設為VIDEO（請參見第68頁）時。□

關閉本機

- 按住AV SOURCE直至本機關閉。□

打開與關閉LCD面板

隨著點火開關啟動或關閉，LCD面板會自動打開或關閉。此自動關閉／打開功能可關閉。（請參見第69頁。）

- 請勿用手用力關閉LCD面板。那會導致故障。

- 自動關閉／打開功能將如下操作顯示幕。
 - 當LCD面板打開時若點火開關關閉，LCD面板將在六秒後關閉。
 - 當點火開關再次啟動（或轉到ACC位置）時，LCD面板將自動打開。
 - 拆裝前面板會自動關閉或打開LCD面板。（請參見第67頁。）
- LCD面板關閉後若點火開關關閉，再次啟動點火開關（或轉到ACC位置）不會打開LCD面板。此時，應按OPEN/CLOSE以打開LCD面板。
- 關閉LCD面板時，應務必將其關緊。如果LCD面板未關緊，這將對其造成損壞。
- 按OPEN/CLOSE打開LCD面板。
 - 關閉LCD面板時，請再次按OPEN/CLOSE。

調節LCD面板角度

重要

- 如果聽到LCD面板與車輛控制台或儀表板的碰撞聲，應按ANGLE (-)將LCD面板略為前移。
- 調節LCD面板角度時，請務必按ANGLE (+/-)。強行用手調節LCD面板可能會對其造成損壞。
- 按ANGLE (+/-)將LCD面板調節到方便觀看的角度。
 - 只要按住ANGLE (+/-)，LCD面板角度就會持續變化。

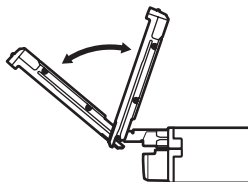

- LCD面板調節後的角度會被記憶，而且LCD面板在下次打開時自動返回該角度。

水平轉動LCD面板

若LCD面板直立時妨礙冷風機工作，可暫時將其水平轉動。

- 按**FLIP DOWN**水平轉動LCD面板。
 - 返回原位時，請再次按**FLIP DOWN**。
 - 操作10秒後，LCD面板會伴隨嗶聲自動返回原位。□

改變寬螢幕模式

您可選擇適當的模式將4:3圖像放大到16:9。

- 按**WIDE**選擇所需設定。
反覆按**WIDE**可在以下設定之間切換：
FULL（完整）－**JUST**（精確）－**CINEMA**（電影）－**ZOOM**（縮放）－**NORMAL**（正常）

FULL（完整）

4:3圖像僅在水平方向放大，使4:3電視圖像（正常圖像）一覽無遺。

JUST（精確）

圖像中央略為放大，且放大量在水平方向向兩端遞增，從而使4:3圖像即使在寬螢幕上也不會令人察覺到任何差異。

CINEMA（電影）

圖像按與**FULL**或**ZOOM**相同的比例在水平方向放大，按**FULL**與**ZOOM**的中間比例在垂直方向放大；這最適用標題在圖像之外的電影規格圖像（寬螢幕圖像）。

ZOOM（縮放）

4:3圖像在水平與垂直方向按相同的比例放大；這最適用電影規格圖像（寬螢幕圖像）。

NORMAL（正常）

4:3圖像原樣顯示；由於其比例與正常圖像相同，因此不會令人感覺到有任何差異。

注意

- 各視頻播放源可記憶不同的設定。

- 若在與其原始螢幕比例不一致的寬螢幕模式下觀看視頻，它可能會出現差異。
- 請記住，若使用本機的寬螢幕模式功能從事商業或公共放映，這可能會構成對受版權法保護的著作權的侵犯。
- 視頻在**CINEMA**或**ZOOM**模式下觀看時會出現雜點。
- 後視相機的圖像始終設為**FULL**。□

調節圖像調整

各播放源與後視相機的**BRIGHT**（亮度），**CONTRAST**（對比度），**COLOR**（顏色）與**HUE**（色度）可進行調節。

- **BRIGHT**與**CONTRAST**調節後分別存儲用於白亮氛圍（白天）與黑暗氛圍（夜間）。在環境光傳感器感應亮度或暗度時，**BRIGHT**與**CONTRAST**的左側分別顯示太陽圖標☀或月亮圖標☾。
- PAL視頻的**HUE**無法調節。
- 音頻播放源的**COLOR**或**HUE**無法調節。
- 本機可偵測汽車手煞車是否啟用，並防止您在駕駛時進行圖像調整。若您試圖進行圖像調整，警告**YOU CANNOT USE THIS FUNCTION WHILE DRIVING**將在顯示幕中出現，提醒不能使用圖像調整功能。

1 按住**V.ADJ**以顯示**PICTURE ADJUST**。

按**V.ADJ**直至**PICTURE ADJUST**在顯示幕中出現。

2 使用▲、▼與**A.MENU**選擇要調節的功能。

按▲/▼可改變功能；按**A.MENU**則選擇功能。

調整功能名稱顯示，同時可調節的名稱高亮顯示。

- **BRIGHT**－調節黑度
- **CONTRAST**－調節對比度
- **COLOR**－調節顏色飽和度
- **HUE**－調節色調（偏紅或偏綠）
- **DIMMER**－調節顯示幕的亮度
- **BACK-CAMERA**－切換至後視相機的圖像調整顯示

基本操作

- **SOURCE** – 返回各播放源的圖像調整顯示
 - 後視相機的圖像調整僅可在**B. CAMERA**開啟時調節。（請參見第68頁上**後視相機之設定**。）
 - 當**BACK-CAMERA**選定時，**SOURCE**而不是**BACK-CAMERA**將在顯示幕上出現。
 - 對於某些後視相機，圖像調整可能無法進行。
- 3 按◀或▶調節所選項目。
每按一次◀或▶即增大或減小所選項目的水平。**+24**–**-24**隨著水平增大或減小而顯示。
- 4 觸摸ESC返回各播放源顯示。

調節顯示幕亮度調整

DIMMER調節後分別按各環境光，白天，傍晚與夜間存儲。LCD螢幕的亮度將根據環境光設定值自動調節到最佳水平。

- 1 按住**V.ADJ**以顯示**PICTURE ADJUST**。
按**V.ADJ**直至**PICTURE ADJUST**在顯示幕中出現。
- 2 按▲或▼選擇**DIMMER**。
調節**DIMMER**所使用的標準環境光水平在水平尺上出現。
- 黃色太陽圖標☀ – 調節明亮環境光（白天）的亮度
 - 紅色太陽圖標☀ – 調節中間亮度的亮度（傍晚）
 - 藍色月亮圖標☾ – 調節黑暗環境光的亮度（夜間）
- 3 按◀或▶調節亮度。
每按一次◀或▶使黃色向左或向右移動。水平尺指示螢幕正在調節的亮度。黃色越向右移動，螢幕越亮。
- 4 觸摸ESC返回各播放源顯示。

注意

用於調節**BRIGHT**或**CONTRAST**，指示當前環境亮度的圖標可能會與**DIMMER**略為不同。▣

本機之防盜

前面板可從本機卸下，以免被盜。

- 如果點火裝置關閉後五秒內前面板不從本機卸下，警告音將響起。
- 警告音可關閉。請參見第69頁上**切換警告音**。

重要

- 拆裝時切勿魯莽或用力抓住顯示幕與按鈕。
- 請避免使前面板受到劇烈撞擊。
- 請將前面板遠離直射陽光下和高溫。
- 如果前面板已卸下，請在啟動車輛之間將其裝回原位。

拆卸前面板

- 向下移動**RELEASE**，然後向外卸下前面板。

當前面板在卸下時，LED指示器將閃爍。請小心不要將前面板抓得過緊，或使其墜落，而且應防止與水或其他液體接觸，以免造成永久損壞。

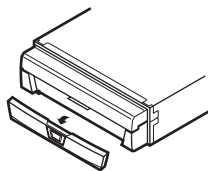

安裝前面板

- 放回前面板使其卡住到位。
請將前面板底部的凹槽與顯示幕的導軌對齊。

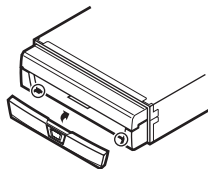

- 按**RELEASE**直至前面板喀嗒一聲到位。▣

設置調節之介紹

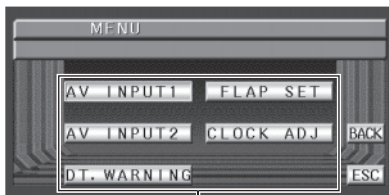

①

① 功能顯示

顯示功能名稱。

1 按A.MENU可顯示功能名稱。

功能名稱顯示，同時可操作的名稱高亮顯示。

2 使用▲，▼，◀，▶與A.MENU選擇所需功能。

按▲/▼/◀/▶可改變功能；按A.MENU則選擇功能。

使用▲/▼/◀/▶選定的功能顯示帶方框。

- 返回前一顯示畫面時，請按BACK。
- 返回各播放源之顯示時，請按ESC。



注意

如果不在約30秒之內操作設置功能，顯示幕將自動返回播放源顯示。▣

設定視頻輸入1

本設定可根據連接的設備進行切換。

- 選擇VIDEO按AV-1播放源觀看所連接設備的影像。

1 使用▲，▼，◀，▶與A.MENU選擇AV INPUT1。

2 按◀或▶選擇視頻輸入1設定。

按◀或▶直至所需設定在顯示幕中出現。

- OFF—未連接視頻設備
- VIDEO—外部視頻設備▣

設定視頻輸入2

本設定可根據連接的設備進行切換。

- 選擇VIDEO按AV-2播放源觀看所連接設備的影像。
- 當車上裝有後視相機時請選擇B. CAMERA。

1 使用▲，▼，◀，▶與A.MENU選擇AV INPUT2。

2 按◀或▶選擇視頻輸入2設定。

按◀或▶直至所需設定在顯示幕中出現。

- OFF—未連接視頻設備
- VIDEO—外部視頻設備
- B. CAMERA—後視相機

後視相機之設定



小心

先鋒建議使用輸出反像的相機；否則，螢幕上的影像可能會顛倒。

當車上裝有後視相機時，本機可自動切換至後視相機視頻（VIDEO 2/BACK CAMERA

INPUT插孔）。當汽車排檔掛在REVERSE（R）位置時，視頻會自動切換為後視相機視頻。（有關更多資訊，請向經銷商垂詢。）

- 請及時確認設定，看汽車排檔從其他位置換到REVERSE（R）時，顯示幕是否切換至後視相機視頻。
- 如果在汽車正常行駛時顯示幕切換至後視相機視頻，請改變設定。
- 返回播放源顯示時，請按V.ADJ。

1 使用▲，▼，◀，▶與A.MENU選擇AV INPUT2。

2 按◀或▶選擇B. CAMERA。

3 按▼選擇POLARITY。

4 按◀或▶選擇正確的極性設定。

每按一次◀或▶即切換以下極性：

- BATTERY—當汽車排檔在REVERSE（R）位置時連接的引線為正極
- GND—當汽車排檔在REVERSE（R）位置時連接的引線為負極▣

其他功能

切換警告音

如果點火裝置關閉後五秒內前面板不從本機卸下，警告音將響起。警告音可關閉。

1 使用▲，▼，◀，▶與A.MENU選擇DT. WARNING。

2 按▲開啟警告音。

- 關閉警告音時，請按▼。□

設定自動打開功能

為防止顯示幕在汽車排檔處於P（手煞車）位置時碰到排擋桿，或當不希望顯示幕自動打開／關閉時，可將自動打開功能設為手動模式。而且，調節LCD面板滑動位置時，可將設定重新開啟或關閉。

1 使用▲，▼，◀，▶與A.MENU選擇FLAP SET。

2 按▲，LCD面板將滑到後面。

- 按▼，LCD面板將滑到前面。

3 按◀或▶選擇顯示幕自動或手動打開／關閉。

按◀可選擇MANUAL，此時必須按

OPEN/CLOSE才能打開／關閉顯示幕。按▶可選擇AUTO，此時若本機電源接通，顯示幕會自動打開／關閉。□

設定時鐘

請按照這些指示設定時鐘。

1 使用▲，▼，◀，▶與A.MENU選擇CLOCK ADJ.

2 按◀或▶選擇OFF，然後按A.MENU開啟時鐘顯示。

ON而不是OFF將在顯示幕中出現。時鐘顯示現在開啟。

- 關閉時鐘顯示時，請按◀或▶選擇ON，然後按A.MENU。

3 按◀或▶選擇所需設定之時鐘顯示部分。

每按一次◀或▶即選擇時鐘顯示的一部分：

小時—分鐘

當時鐘顯示某部分被選時，所選部分將高亮顯示。



4 按▲或▼設定時鐘。

按▲將增大所選小時或分鐘數。而按▼將減小所選小時或分鐘數。

注意

- 通過按◀或▶選擇JUST，然後按A.MENU可使時鐘與時間信號匹配。
 - 如果分鐘數為00—29，則會向下取整。（例如，10:18變為10:00。）
 - 如果分鐘數為30—59，則會向上取整。（例如，10:36變為11:00。）
- 即使播放源關閉，時鐘顯示仍會在顯示幕中出現。□

切換背景顯示

收聽各播放源的同時可切換背景顯示。

● 按ENTERTAINMENT。

每按一次ENTERTAINMENT，顯示幕會按以下順序變化：

當前所選擇播放源的視頻—BGV（背景視覺）

- 當本機關閉時，ENTERTAINMENT無法使用。

注意

當所選擇播放源為音頻播放源時，若選擇當前所選擇播放源的視頻，顯示幕上將無任何顯示。□

故障排除

常見故障

症狀	原因	措施 (請參見)
電源無法接通。 本機無法操作。	引線與連接器連接不當。	再次確認所有連接是否正確。
	保險絲熔斷。	糾正保險絲熔斷原因，然後更換保險絲。切記要安裝額定值相同的正確保險絲。
	雜訊以及其他因素導致內置微處理器運轉不當。	按 RESET 。(第 61 頁)
無法使用遙控器進行操作。 即使按下正確的遙控器按鈕，本機亦不正常工作。	遙控操作模式不當。	切換至正確遙控模式。(第 64 頁)
	電池電量太低。	安裝新電池。(第 61 頁)
無圖像。	手煞車拉索未連接。	連接手煞車拉索，並拉起手煞車。
	手煞車未拉起。	連接手煞車拉索，並拉起手煞車。
音頻與視頻發生跳躍。	本機未安裝牢固。	固定本機。
當點火開關轉到ON (或ACC) 位置時，馬達響起。	本機正在確認碟片是否裝入。	這是正常現象。
無任何內容顯示。	後視相機未連接。 B. CAMERA 設定不當。	連接後視相機。 按 V.ADJ 返回播放源顯示，然後為 B. CAMERA 選擇正確的設定。(第 68 頁)



附加資訊

正確使用顯示幕



小心

- 如果液體或異物進入機內，應立即關閉電源，並向經銷商或就近之先鋒授權服務站垂詢。請勿在此條件下使用本機，因這可能會引起火災，觸電或其他事故。
- 如果發現顯示幕冒煙，發出異響或異味，或出現任何其他異常現象，應立即關閉電源，並向經銷商或就近之先鋒授權服務站垂詢。在此條件下使用本機可能會引起系統永久損壞。
- 請勿拆解或改裝本機，否則機內的高壓部件可能會導致觸電。有關機內檢查，調節或修理事宜，請務必向經銷商或就近之先鋒授權服務站垂詢。

操作顯示幕

- 若將顯示幕長時間置於直射陽光下，它會發燙從而可能損壞LCD螢幕。不使用本機時，應閉上顯示幕並避免直射陽光照射。
- 顯示幕應在以下溫度範圍內使用。
工作溫度範圍：-10至+50° C
保存溫度範圍：-20至+80° C
在高於或低於工作溫度範圍時，顯示幕可能會無法正常工作。
- 本機的LCD螢幕露出，以提高其在車內的可視性。請勿劇烈擠壓，否則會對其造成損壞。
- 當顯示幕展開時請勿在上面擱置任何物體。同樣，請勿用手調節其角度，或用手打開／關閉顯示幕。顯示幕用力過猛會對其造成損壞。
- 請勿用力推LCD螢幕，否則會在上面留下刮痕。
- 當顯示幕打開或關閉時，它與其主體之間千萬不要擱置任何物體。如果它們之間存在任何物體，顯示幕可能會停止工作。
- 請小心手指，長發與衣物上的鬆散飾品，以免其被夾在顯示幕與主機之間，從而造成嚴重傷害。

液晶 (LCD) 螢幕

- 顯示幕打開時如果靠近空調機通風孔，應勿使其對著空調機的風向。暖風機的熱風會損壞LCD螢幕，而冷風機的冷風則會導致顯示幕內部形成溼氣，從而會造成損壞。另外，如果顯示幕用冷風機降溫，其螢幕會變暗，顯示幕內部小螢光管的使用壽命亦可能會縮短。
- LCD螢幕上可能會出現小黑點或白點（亮點）。這是由LCD螢幕的特性所致，並不表示顯示幕出現故障。
- 在低溫時，電源接通後LCD螢幕可能會在一定時間內發暗。
- LCD螢幕在直射陽光下會難以看清。
- 使用手提電話時，應將其天線遠離顯示幕，以免視頻因雪花點，彩色條紋等出現受到干擾。

維護顯示幕

- 在掃除螢幕上的灰塵或清潔顯示幕時，應先關閉系統電源，然後再用柔軟的乾布擦拭。
- 在擦拭螢幕時，應小心不要刮壞其表面。請勿使用刺激性或研磨性化學清潔劑。

小螢光管

- 小螢光管用在顯示幕內部，為LCD螢幕提供照明。
 - 螢光管應可使用約10000小時，但會應工作條件而異。（在低溫條件下使用顯示幕會縮短螢光管的使用壽命。）
 - 當螢光管的使用壽命結束時，螢幕將變暗，而且無影像投射。此時，請向經銷商或就近之先鋒授權服務站垂詢。□

規格

一般

額定電源	14.4 V DC (容許電壓範圍：12.0–14.4 V DC)
接地系統	負極型
最大電流消耗	3.0 A
尺寸 (寬×高×深)：	
DIN	
機身	178×50×160 毫米
前端部分	188×58×30 毫米
D	
機身	178×50×165 毫米
前端部分	170×46×25 毫米
重量	1.7 公斤

顯示

螢幕尺寸／螢幕比例	7 吋寬／16:9 (有效顯示面積：154 × 87 mm)
像素	336,960 (1,440 × 234)
類型	TFT Active Matrix · 透射式
色彩系統	NTSC/PAL 兼容
工作溫度範圍	-10–+50° C
保存溫度範圍	-20–+80° C
角度調整	50–110° (初始設定：110°)
波長	945 nm
輸出	typ；每個紅外線 LED 10 mw/sr



注意

因產品改進，規格及設計若有變更，恕不另行通知。 □



PIONEER CORPORATION

4-1, MEGURO 1-CHOME, MEGURO-KU, TOKYO 153-8654, JAPAN

PIONEER ELECTRONICS (USA) INC.

P.O. Box 1540, Long Beach, California 90801-1540, U.S.A.
TEL: (800) 421-1404

PIONEER EUROPE NV

Haven 1087, Keetberglaan 1, B-9120 Melsele, Belgium
TEL: (0) 3/570.05.11

PIONEER ELECTRONICS ASIACENTRE PTE. LTD.

253 Alexandra Road, #04-01, Singapore 159936
TEL: 65-6472-1111

PIONEER ELECTRONICS AUSTRALIA PTY. LTD.

178-184 Boundary Road, Braeside, Victoria 3195, Australia
TEL: (03) 9586-6300

PIONEER ELECTRONICS OF CANADA, INC.

300 Allstate Parkway, Markham, Ontario L3R OP2, Canada
TEL: 1-877-283-5901

PIONEER ELECTRONICS DE MEXICO, S.A. de C.V.

Bldv.Manuel Avila Camacho 138 10 piso
Col.Lomas de Chapultepec, Mexico, D.F. 11000
TEL: 55-9178-4270

先鋒股份有限公司

總公司：台北市中山北路二段44號13樓
電話：(02) 2521-3588

先鋒電子（香港）有限公司

香港九龍尖沙咀海港城世界商業中心
9樓901-6室
電話：(0852) 2848-6488

Published by Pioneer Corporation.
Copyright © 2004 by Pioneer Corporation.
All rights reserved.

Printed in Japan

<CRD3871-A> ES

<KMMZF> <04C00000>

Free Manuals Download Website

<http://myh66.com>

<http://usermanuals.us>

<http://www.somanuals.com>

<http://www.4manuals.cc>

<http://www.manual-lib.com>

<http://www.404manual.com>

<http://www.luxmanual.com>

<http://aubethermostatmanual.com>

Golf course search by state

<http://golfingnear.com>

Email search by domain

<http://emailbydomain.com>

Auto manuals search

<http://auto.somanuals.com>

TV manuals search

<http://tv.somanuals.com>