

CDC-825
10 - DISC CD CHANGER

CDC-10R
WIRELESS REMOTE CONTROL (OPTIONAL)



SPS *SPECIAL
PERFORMANCE
SERIES*

**OWNER'S
MANUAL**

HINTS FOR CORRECT AND SAFE OPERATION

The CDC-825 is designed to be operated only on 12 volt DC negative ground systems. The unit can not be used on 24 volt or positive ground systems.

TEMPERATURE

The unit may not operate correctly in extremely hot or cold temperatures. It is equipped with a built-in thermal protection circuit which will stop operation of the unit when the temperature reaches the pre-set level. If this should happen, the unit will resume operation when the vehicle returns to a normal temperature range.

Remove the magazine from the unit when it is not being used during hot weather. If the discs are left in an extremely hot car they may warp. If the CD changer is not used for long periods of time, remove the compact discs from the magazine, and store them in their cases.

CONDENSATION

Moisture can condense on the laser lens of the CD changer during rainy and humid days, or right after the heater is turned on in the car (if the changer is mounted in the passenger compartment). If this should happen the unit will not operate correctly. To remedy the situation, remove the discs from the unit and wait approximately one hour. During this time the moisture will evaporate and the unit will operate normally.

INTERRUPTIONS IN SOUND (Skipping)

The sound from the unit may "skip" and be interrupted if the anti-vibration springs are not set correctly, if the changer is mounted in excess of a 15° angle, or when travelling on very rough road surfaces. If this should occur, check for errors made during installation or wait for the road surface to improve.

3" (8cm) CD-SINGLES

The CDC-825 is not designed to play 3" (8cm) CD-Single discs. Inserting a 3" disc into the magazine, either with or without a 3" disc adaptor, can damage the changer and the disc. Such damage will not be covered by the Warranty on this product.

HANDLING THE DISCS

Dirt, dust, scratches and warpage cause sound skips during playback and a deterioration of sound quality. To take proper care of your discs:



1. Use compact discs that have the mark shown on the right.
2. Fingerprints and dust should be carefully wiped off the disc's signal surface (glossy side) with a soft cloth. Unlike conventional records, the compact disc has no grooves to collect dust and microscopic debris, so gently wiping with a soft cloth should remove most particles. Wipe in a straight motion from the inside to the outside of the disc. Small dust particles or light stains will have absolutely no effect on reproduction quality.
3. Never use such chemicals as record sprays, antistatic sprays or fluids, benzine or thinner to clean compact discs. Such chemicals could irreparably damage the disc's plastic surface.
4. Discs should be put back in their cases after use to avoid serious scratches that could cause the sound to skip.
5. Do not expose discs to direct sunlight, high humidity, or high temperatures for extended periods of time. Long exposure to high temperatures can warp the disc.
6. Do not stick paper, labels, or tape on the disc surface.
7. Do not write with any type of pen, pencil, or marker on the disc surface.
8. To minimize fingerprints and smudges on the signal surface, always try to hold the discs by their outer edge and center hole.

USE OF THE CD MAGAZINE

LOADING DISCS INTO THE MAGAZINE

The CDC-825 CD Changer uses a specially-designed magazine to hold up to 10 compact discs. Insert discs into the magazine with the label side up as shown in Figure 1. As each disc is inserted into the magazine, the push-out knob for that slot will be raised as shown in Figure 2.

REMOVING DISCS FROM THE MAGAZINE

To remove a disc from the magazine, press the push-out knob for the desired disc and carefully remove the disc by holding the edge as shown in Figure 3.

NOTES:

Avoid touching the playing side of the disc.

Only one disc can be inserted into each tray of the magazine. Do not try to insert more than one disc into each tray as damage to the discs and magazine may occur.

The CDC-825 is not designed to play 3" CD-Single discs (8cm). Inserting a 3" disc into the magazine, either with or without a 3" disc adaptor, can damage the changer and the disc. Such damage will not be covered by the Warranty on this product. Additional CD magazines are available as accessory item CDC-7C from your SPS/Audiovox dealer, or you may contact us directly at:

Attention: SPS Division
Audiovox Corporation
150 Marcus Blvd.
Hauppauge, NY 11788

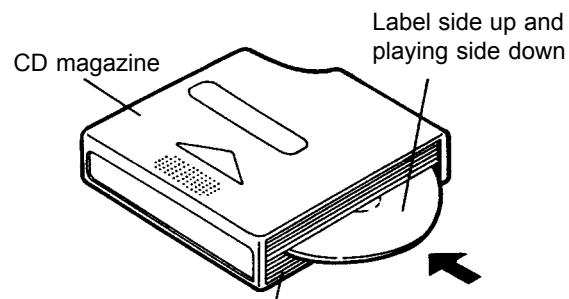

Fig. 1 One disc in each slot (10 discs)

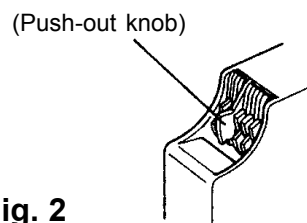

Fig. 2

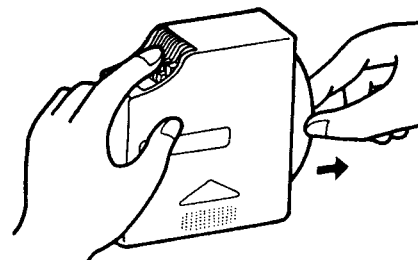

Fig. 3

LOADING THE MAGAZINE INTO THE CHANGER

Completely slide the door on the changer to the right as shown in Figure 4. Making sure the top of the magazine is facing upward, gently insert it into the unit until it clicks into place, as shown in Figure 5. Slide the door of the changer fully closed and the unit is ready for operation.

REMOVING THE MAGAZINE FROM THE CHANGER

To remove the magazine, slide open the door on the changer and press the eject button as shown in Figure 6.

NOTE: Be sure to keep the door on the changer closed at all times when not loading or removing the magazine. Leaving the door open could allow dust, dirt and moisture to enter the changer which could cause the unit to malfunction.

Fig. 4

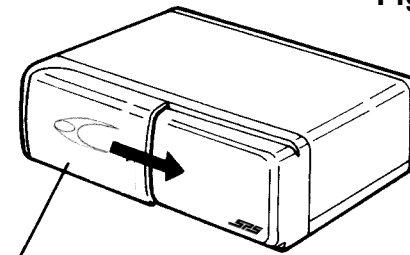

Fig. 5

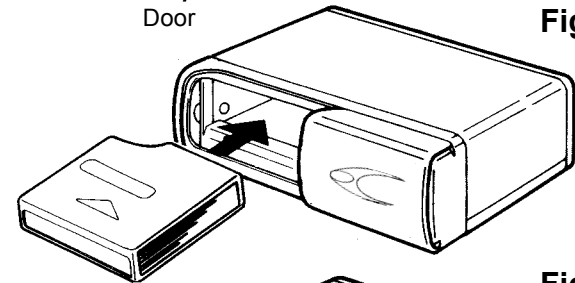
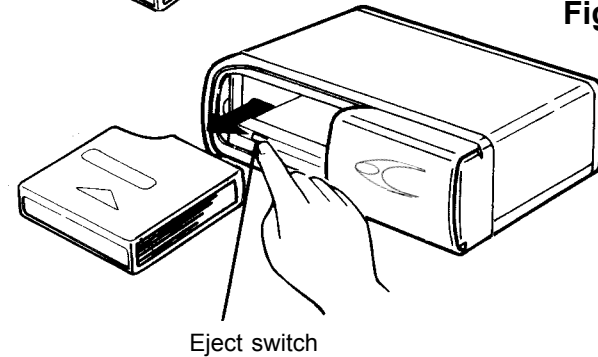

Fig. 6



CD CHANGER OPERATING INSTRUCTIONS

The CDC-825 10-disc changer is designed to operate through the FM stereo section of your automotive sound system and therefore the adjustment of volume, balance, tone and other audio adjustments are made by using the controls on the car stereo. Control of disc play is by the control unit of the CDC-825 which can be conveniently mounted to the dashboard. The output signal from the unit is at either 89.1 or 88.7 MHz. (set by installer) on the FM band and it is recommended that a pre-set memory push-button of the radio be set to the output frequency of the CDC-825 to simplify operation of the system. Consult the operating instructions of the car stereo for directions on setting the memory push-button.

SETTING UP FOR OPERATION

Following the instructions in the "USE OF THE CD MAGAZINE" section, load the desired number (up to 10) of 5" (12cm) compact discs into the CD magazine and insert the magazine into the changer. **DO NOT USE 3" (8cm) CD SINGLES, EITHER WITH OR WITHOUT AN ADAPTOR, IN THE CDC-825.**

Turn on the car stereo and select FM band operation. Tune the radio to either 87.7 or 89.1 MHz. (depending on the frequency to which the installer has set the unit) or push the pre-set memory button that has been set as per the above description.

Turn on the changer by pressing the PLAY/PAUSE switch **2** on the control unit. The LCD panel on the control unit will illuminate and play of disc #1 will begin. Adjust volume, balance, and tone to your taste by using the controls on the car stereo.

When the last track on a disc has played, the unit will automatically advance to and begin play of the next disc. When the last track on disc #10 has been played, the unit will automatically return to disc #1 and begin play again.

5

WIRED CONTROL UNIT

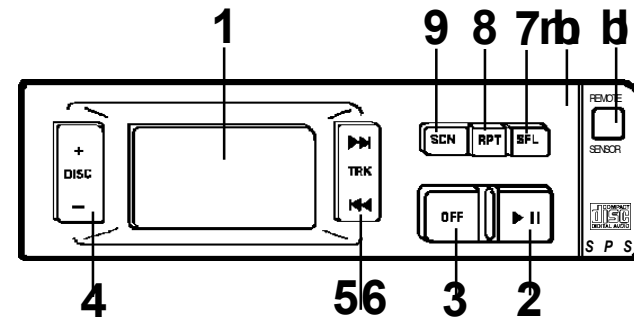

1 LCD DISPLAY

The LCD Display Panel will illuminate when the CD changer is operating. Different symbols will appear depending on the function and operation in use. Each display is explained in the applicable function explanation below.

2 PLAY / PAUSE (▶/||)

Pressing this button turns on the CD changer, illuminates the LCD panel and begins play of disc #1 if a new CD magazine has been loaded into the changer. If a magazine was already in the changer, play will resume from the track on the disc previously in play. Play of the disc is shown by the indication ▶ and the rotating disc symbol on the LCD panel. Pressing the button again will temporarily stop play of the disc. The pause indication || will be shown on the LCD panel and the disc symbol will stop rotating and flash instead. Press the button again to resume play of the disc.

NOTE: If left in the PAUSE mode for 5 minutes, the unit will automatically shut off.

3 POWER OFF SWITCH (OFF)

Press this switch to turn the CD changer off and return to normal FM reception.

4 DISC SELECT (- +)

Press this disc select button to select the desired disc for play as shown on the LCD panel. The unit will automatically load the selected disc and begin play. To advance to a higher number disc, press the + side of the button. To return to a lower number, press the - side.

5 TRACK SKIP (⏮ ⏭)

The track skip function is used to quickly access the beginning of a particular track. Press Forward Track Skip (⏭) or Backward Track Skip (⏮) to locate the desired track as shown by the track number indication on the LCD panel.

6 TRACK SEARCH (⏮ ⏭)

High-speed audible search to any section of the disc can be made by the search functions. Press and hold the ⏭ button to advance quickly in the forward direction or press and hold the ⏮ button to advance rapidly in the backward direction. During search operation, the rotating disc symbol will turn faster and the appropriate symbol (⏭) or (⏮) will flash on the LCD panel. When the forward search (⏭) button is held down and the end of the last track is reached, or the backward search (⏮) is held down and the unit reaches the beginning of the first track on the disc, the unit will enter the Pause mode until the button is released.

7 TRACK / DISC SHUFFLE (SFL)

When the Shuffle button is pressed, the indication "SHFL" will appear on the LCD panel and the tracks on the disc will be played in a random, shuffled order. The Track Skip 5 function will also select tracks in the shuffled order instead of the normal progression. The Track Shuffle mode can be cancelled by pressing the Shuffle button 7 again, or by

activating the Scan 9 or Repeat 8 functions.

When the Shuffle button is pressed and held longer than 2 seconds, the "SHFL" and "DISC" indications will appear on the LCD panel and the discs in the magazine will be played in a random shuffled order, as well as the tracks on each disc. When all the tracks on the selected disc have been played, the next disc will be selected in shuffled order and its tracks will be played in shuffled order. The Disc Shuffle mode can be cancelled by pressing the Shuffle button again, or by activating the Scan 9 or Repeat 8 functions.

8 TRACK / DISC REPEAT (RPT)

When the Repeat button is pressed, the indication "RPT" will appear on the LCD panel and play of the selected track will be continuously repeated until the Track Repeat mode is cancelled by pressing the Repeat button again or by activating the Scan 9 or Shuffle 7 functions.

When the Repeat button is pressed and held longer than 2 seconds, the "RPT" and "DISC" indications will appear on the LCD panel and play of the selected disc will be continuously repeated until the Disc Repeat mode is cancelled by pressing the Repeat button again or by activating the Scan 9 or Shuffle 7 functions.

9 TRACK / DISC SCAN (SCN)

When the Scan button is pressed, the indication "SCN" will appear on the LCD panel and the first 10 seconds of each track on the disc will be played in order. When a desired track is reached, press the Scan button again and play of that track will continue ("SCN" will disappear from the display). Track Scan mode will be cancelled by activating any other function (Repeat, Shuffle, Disc Select, Track Skip, or Track Search).

When the Scan button is pressed and held for longer than 2 seconds, the "SCN" and "DISC" indications will appear on the LCD panel and the first 10 seconds of the first track of each disc in the magazine will be played. When a desired disc is reached, press the Scan button again and play

of that disc will continue ("SCAN" and "DISC" will disappear from the display). Disc Scan mode will also be cancelled by activating any other function (Repeat, Shuffle, Disc Select, Track Skip, or Track Search).

bl REMOTE SENSOR

The sensor for the infrared signal from the optional wireless remote control is located behind this lens. For optimal operation of the remote control, keep the lens clean and do not allow objects to block it.

bm RESET BUTTON

A reset button is located on the front panel of the remote control which must be activated with a pen or other thin object as it is recessed to prevent accidental engagement. The reset circuitry is provided to protect the unit's microprocessor and laser pick-up system and should only be activated under the following circumstances:

1. Initial installation after all wiring is completed (this must be done).
2. If abnormal disc operation is encountered, the reset button may be pressed to clear the system and return to normal operation.

IMPORTANT: Use of the Reset button on the CD Changer will cause the CD magazine to be automatically ejected. Make certain changer door is fully opened prior to using Reset.

CAUTION: When the CD magazine is ejected by the use of the Reset button, whichever disc was in play prior to depressing Reset may be left in the play position in the changer. It is critical that before re-inserting the CD magazine, you must REMOVE ALL DISCS from it. After you have inserted the empty CD magazine, press the "EJECT" button on the changer and the "in play" disc will be loaded into the empty magazine. You may then remove the magazine and re-load as many discs as desired.

WARNING: Avoid use of Reset buttons after initial use unless you have a definite abnormal disc operation. Use the EJECT button on the changer to remove the CD magazine for normal operation.

ERROR SIGNS:

If a problem should develop while operating the CD changer, the following error signs may be displayed on the LCD panel:

E - 01 : Indicates abnormal disc change function. Contact the place of purchase for further service advise.

E - 30 : Indicates excessive temperature conditions. The error sign will go off and play will resume when the changer temperature returns to normal range

- - - - : Magazine is not loaded in the changer.

0 - 0 0 : No discs are loaded in the magazine.

1 - - - : No disc is loaded in magazine slot #1. (2---- indication for slot #2, etc.)

SPECIFICATIONS:

Changer:

Frequency Response: 5 - 20,000 Hz. ± 1 dB
Distortion: 0.008% @ 1 kHz.
Dynamic Range: 95 dB
Signal-to-Noise Ratio: 95 dB
Channel Separation: 80 dB @ 1 kHz.
Wow & Flutter: below measurable limits

FM Modulator:

Output Frequency: 88.7/89.1 MHz. (switchable)

General:

Dimensions:
Changer: 11-1/2"W x 3-5/8"H x 7-1/2"D
291 mm x 92 mm x 190 mm
Control Unit: 4-3/4"W x 1-5/8"H x 5/8"D
120 mm x 40 mm x 17 mm
Operating Voltage: 12 volts DC, negative ground

WIRELESS REMOTE CONTROL

The CDC-10R Wireless Remote Control (optional) is capable of operating all functions of the wired control unit. Each button on the remote control functions in the same way as the comparable button on the wired control unit. For optimal operation of the remote control, always aim it toward the Remote Sensor **bl** on the control unit.

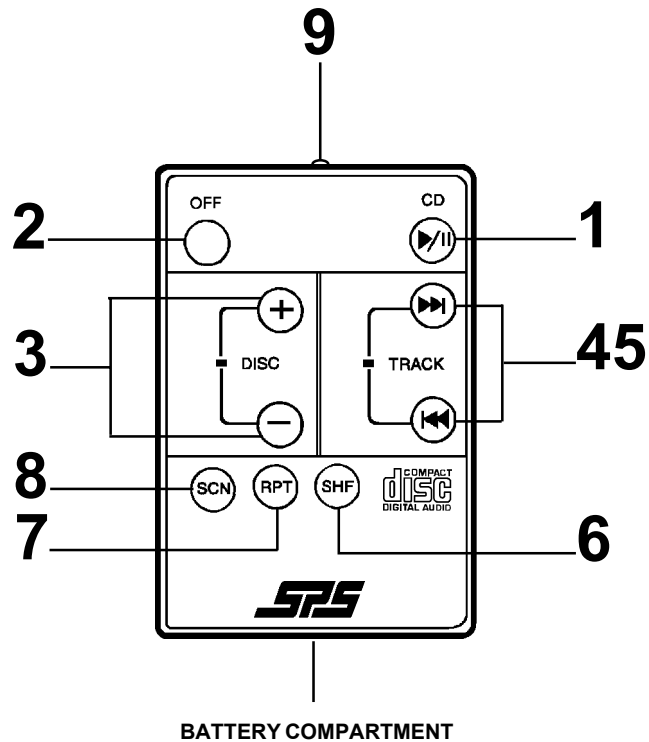

- 1** PLAY / PAUSE (▶ / ||)
See Wired Control Unit **2**
- 2** POWER OFF SWITCH (OFF)
See Wired Control Unit **3**
- 3** DISC SELECT (- +)
See Wired Control Unit **4**
- 4** TRACK SKIP (▶▶)
See Wired Control Unit **5**
- 5** TRACK SEARCH (◀◀)
See Wired Control Unit **6**
- 6** TRACK / DISC SHUFFLE (SHF)
See Wired Control Unit **7**
- 7** TRACK / DISC REPEAT (RPT)
See Wired Control Unit **8**
- 8** TRACK / DISC (SCN)
See Wired Control Unit **9**

9 INFRARED SENDER

The wireless signal from the remote control is sent from this lens. For optimal range and performance of the remote control, always aim the Sender at the Remote Sensor **bl** on the wired control unit. Do not let your finger interfere with the signal and make sure the lens does not become blocked by dirt, dust, etc. If necessary, clean the lens with a soft dry cloth or cotton swab.

NOTES ON REMOTE CONTROL USE:

The remote control operates on a 3 volt lithium battery (type CR-2025). Install the battery into the compartment at the bottom of the remote control, making sure to observe correct polarity (match “+” side of battery to “+” indication on compartment).

If remote control fails to operate, always check battery condition and replace if necessary before servicing the unit.

Dispose of batteries properly. Do not heat, disassemble, or throw batteries into a fire.

Keep the remote control away from areas where it may be exposed to heat, moisture or sunlight.

TROUBLESHOOTING

An error made in operation or during installation of this product may be mistaken for a system malfunction. Please perform the checks described below before contacting your dealer or service facility.

Symptom	Possible Cause	Remedy
No power	Blown fuse	Check fuses in vehicle fuse box and changer system. Replace as necessary with fuse of same type and rating as original. If fuse blows again, consult with service facility.
	Incorrect connection	Check all wiring and correct as necessary.
Magazine cannot be installed	Magazine is inserted in wrong direction	Insert magazine in proper direction.
CD is not played	Disc is loaded incorrectly in magazine	Load disc correctly in the magazine.
Noise, skipping, or intermittent sound during playback.	Scratches on disc or warped disc	Check sound on another disc. If sound from second disc is OK, first disc is defective.
	Extremely dirty disc	Clean disc
	Transit screws still in place	Remove the transit screws from bottom of the unit.
	Mounting angle adjustment is not correct	Set the mounting angle adjustment to the correct position as per the installation instructions.

36 MONTH LIMITED WARRANTY

Applies to Compact Disc Changers

AUDIOVOX CORPORATION (the Company) warrants to the original retail purchaser of this product that should this product or any part thereof, under normal use and conditions, be proven defective in material or workmanship within 36 months from the date of original purchase, such defect(s) will be repaired or replaced with new or reconditioned product (at the Company's option) without charge for parts and repair labor. During the first year of the warranty, there will be no charge for removing or reinstallation of a defective product. After the first year, a labor charge may be assessed for removal and reinstallation.

If Warranty Service is required, please use the exclusive **TRAVELER'S WARRANTY SERVICE (U.S.A. and Canada only):**
1-800-645-4994

Simply call toll free to our control office for reference to the Authorized Warranty Station in your area, and to obtain an Authorization Number. No repairs or replacements will be allowed without a valid Authorization Number.

This Warranty does not extend to the elimination of car static or motor noise, to correction of antenna problems, to costs incurred for removal or reinstallation of the product, or damage to compact discs, speakers, accessories, or vehicle electrical systems.

This Warranty does not apply to any product or part thereof which, in the opinion of the Company, has suffered or been damaged through alteration, improper installation, mishandling, misuse, neglect, accident, or by removal or defacement of the factory serial number/bar code label(s). THE EXTENT OF THE COMPANY'S LIABILITY UNDER THIS WARRANTY IS LIMITED TO THE REPAIR OR REPLACEMENT PROVIDED ABOVE AND, IN NO EVENT, SHALL THE COMPANY'S LIABILITY EXCEED THE PURCHASE PRICE PAID BY PURCHASER FOR THE PRODUCT.

This Warranty is in lieu of all other express warranties or liabilities. ANY IMPLIED WARRANTIES, INCLUDING ANY IMPLIED WARRANTY OF MERCHANTABILITY, SHALL BE LIMITED TO THE DURATION OF THIS WRITTEN WARRANTY. ANY ACTION FOR BREACH OF ANY WARRANTY HEREUNDER INCLUDING ANY IMPLIED WARRANTY OF MERCHANTABILITY MUST BE BROUGHT WITHIN A PERIOD OF 48 MONTHS FROM DATE OF ORIGINAL PURCHASE. IN NO CASE SHALL THE COMPANY BE LIABLE FOR ANY CONSEQUENTIAL OR INCIDENTAL DAMAGES FOR BREACH OF THIS OR ANY OTHER WARRANTY, EXPRESS OR IMPLIED, WHATSOEVER. No person or representative is authorized to assume for the Company any liability other than expressed herein in connection with the sale of this product.

Some states do not allow limitations on how long an implied warranty lasts or the exclusion or limitation of incidental or consequential damage so the above limitations or exclusions may not apply to you. This warranty gives you specific legal rights and you may also have other rights which vary from state to state.

128-4245E

Free Manuals Download Website

<http://myh66.com>

<http://usermanuals.us>

<http://www.somanuals.com>

<http://www.4manuals.cc>

<http://www.manual-lib.com>

<http://www.404manual.com>

<http://www.luxmanual.com>

<http://aubethermostatmanual.com>

Golf course search by state

<http://golfingnear.com>

Email search by domain

<http://emailbydomain.com>

Auto manuals search

<http://auto.somanuals.com>

TV manuals search

<http://tv.somanuals.com>