

INSTALLATION INSTRUCTIONS
FOR
50-0311x-015 SERIES 1181337
GRAND CARAVAN
OVERHEAD CONSOLE for use with FLIPDOWN VIDEO SYSTEM



These instructions are intended for use only by experienced professionals in the automotive customizing business. Special tools and equipment, as well as specialized handling and care of product during installation, may be required. Before beginning this installation, carefully read through the following instructions. **Use extreme care when cutting headliner material.** Check for wiring or other componentry above headliner material. Cut only where indicated.

Materials/ Tools required for this installation:

1. #2 Phillips screwdriver
2. Powered screwdriver or drill with adapter
3. Awl or similar tool
4. Razor knife or similar
5. 18 GA wire 4' - 6'
6. Test light
7. Audiovox Series 640/650 Video Module

NOT FOR VEHICLES EQUIPPED WITH SUN ROOF.

MATERIALS PROVIDED FOR INSTALLATION:

ITEM	Description	QTY
1	SCREW, # 8 X 9/16" PWH	4
2	SCREW, 6-32 X 3/4" PPH	6
3	WASHER, 3.5 mm	4
4	SCREW, # 8 X 1 1/2" PWH	1
5	SCREW, # 6 X 1/2" PFH	2
6	MOUNTING BRACKET	1
7	CONSOLE	1
8	SPEAKER GRILLE	1
9	COVER PLATE	1
10	COVER PLATE DECAL	1

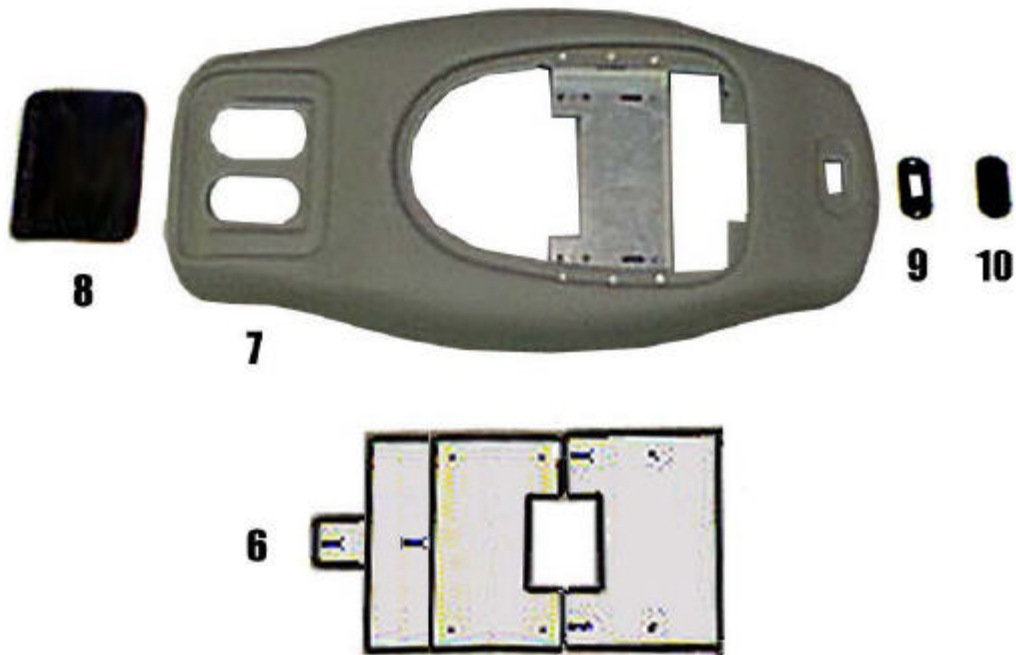
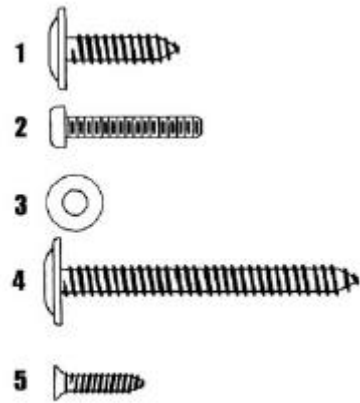

I. PREPARATION OF VEHICLE INTERIOR

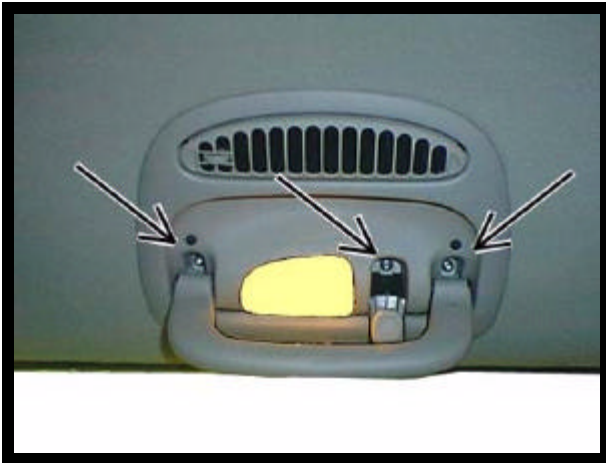

FIGURE 1

1. Remove and retain (3) three screws which secure dome light in place. See Figure 1.
2. Disconnect wiring and lay light in a safe place.

3. Using O.E. console as a reference, carefully measure and trim headliner as shown. **Caution: Before cutting headliner material, check for wiring or other componentry above headliner. Cut only where indicated. DO NOT OVERCUT HEADLINER.** Make sure that the 7 1/2" cut is centered left to right in vehicle. See Figure 2.
4. If speaker upgrade kit was purchased, trim these (*) locations. See Figure 2.

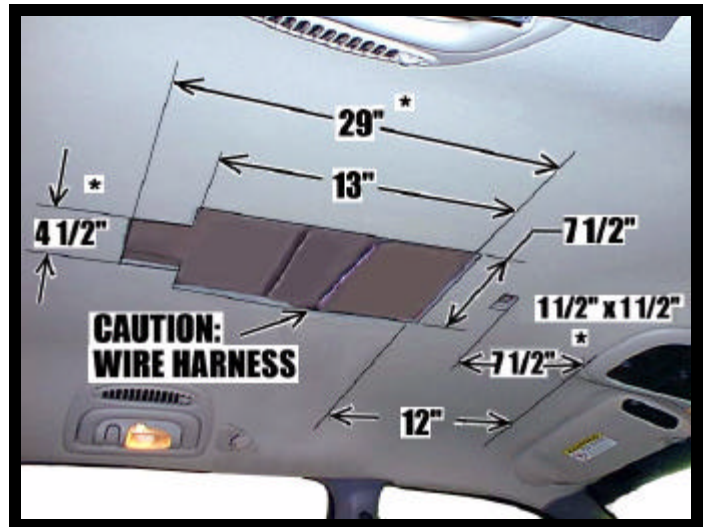

FIGURE 2

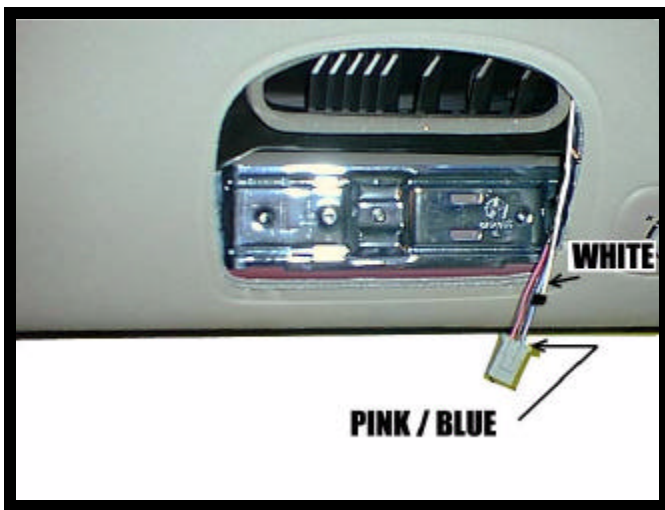

FIGURE 3

5. Construct a jumper harness that will connect the vehicle's dome light wires to the lights in video system. Connect the white wire from video system to the O.E. pink/blue wire. Connect the black wire from video system to the chassis ground. See Figure 3.
6. Using a test light, check function of lights.
7. Install O.E. dome light in original manner.

8. Install and route all video and audio cables, and any other added component requirements to their respective places in the vehicle. Refer to component installation instructions for wiring diagrams. The suggested routing of the video system cable is as follows: Above the headliner from video system rearward to the C-pillar. Down the C-pillar to the floor. Route the power lead to a fused accessory controlled source. Connect the ground lead to the vehicle chassis. Route the remaining wiring (RCA plugs, Remote Sensor extension, etc.) to the VCP location. See Figure 4. Connect per instructions included with the video system. If video system is to be used as a television, install an appropriate antenna per instructions included with the antenna.

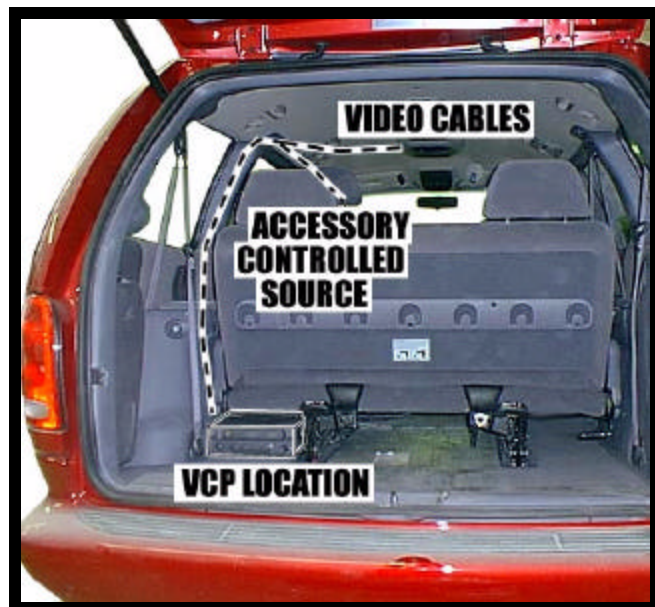

FIGURE 4

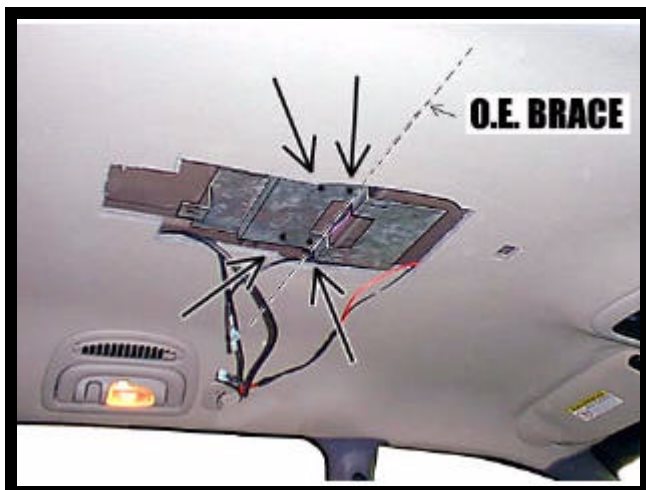

FIGURE 5

9. Install console mounting bracket (item 6 pg 2) over O.E. bracket on roof brace. Align bend in bracket with edge of O.E. brace. Secure bracket using (4) four # 8 x 9/16" screws (item 1 pg 2). See Figure 5.

II. INSTALLATION OF CONSOLE

IF SPEAKER UPGRADE KIT WAS PURCHASED, INSTALL PER INSTRUCTIONS PROVIDED.

10. Raise console (item 7 pg 2) into approximate position against headliner. Loosely install using (2) two 6-32 X 3/4" screws (item 2 pg 2) through the smaller holes in bracket on console into threaded clips on mounting bracket. See Fig. 6.
11. Using a scribe or similar tool, align hole in rear of console with slot in mounting bracket. Loosely secure rear of console using (1) # 8 X 1 1/2" screw (item 4 pg 2). Make sure console is straight then tighten (2) two 6-32 screws previously installed. See Figure 6.

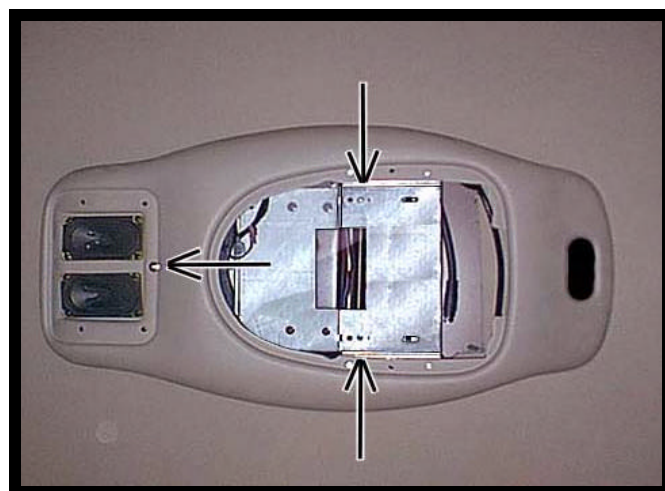

FIGURE 6

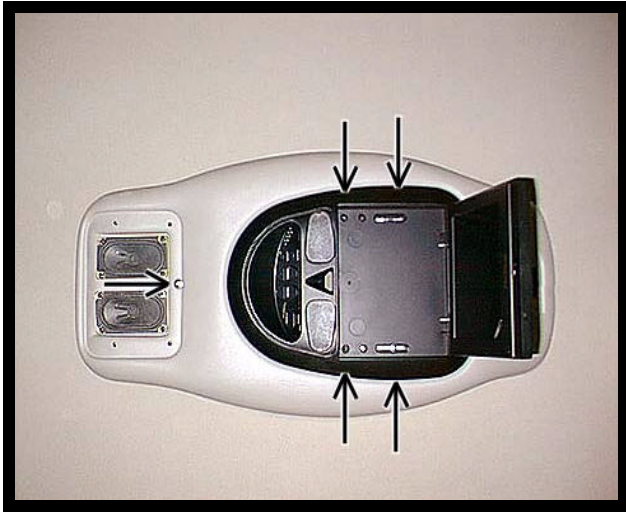

FIGURE 7

12. Release video screen from locked position. Lower video screen to viewing position for access to mounting locations in top of video system housing.
13. Raise video system into approximate position and connect all wiring to components. Connect wiring and cabling to video system per instructions included with video system.
14. Check function of all components and lights. See operating instructions for video system operations check. For further assistance, refer to the video system manual for the technical support phone number listed for your area.

15. Insert video system into opening in console. **Note: Make sure wires do not get pinched between video system and console.** Align holes in housing with clips in mounting bracket. Secure using (4) four 6-32 x 3/4" screws (item 2 pg 2) and (4) four 3.5 mm washers (item 3 pg 2). See Figure 7.
Caution: Do not overtighten screws.

16. Tighten screw previously installed to secure rear of console to headliner. **Caution: Do not overtighten screws or damage to vehicle roof may occur.**
17. Raise video screen into locked position.
18. Install speaker grille (item 8 pg 2). Align clips in grille with holes in console and press firmly. See Figure 8.
19. If speaker upgrade kit was not installed, install cover plate (item 9 pg 2) at front of console and secure using (2) two # 6 X 1/2" screws (item 5 pg 2).
20. Install cover plate decal (item 10 pg).

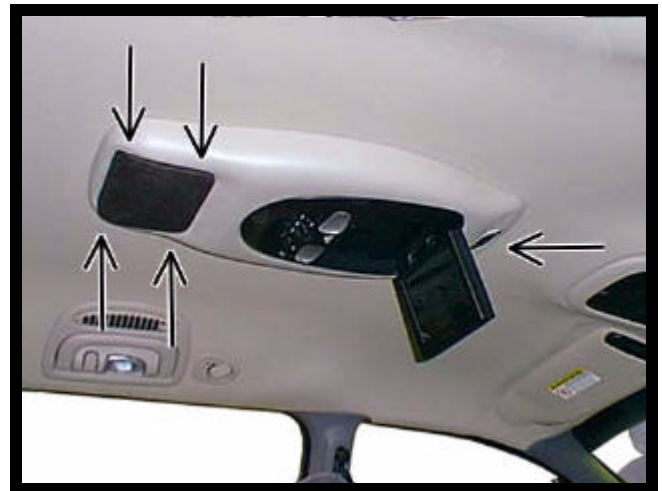

FIGURE 8

Free Manuals Download Website

<http://myh66.com>

<http://usermanuals.us>

<http://www.somanuals.com>

<http://www.4manuals.cc>

<http://www.manual-lib.com>

<http://www.404manual.com>

<http://www.luxmanual.com>

<http://aubethermostatmanual.com>

Golf course search by state

<http://golfingnear.com>

Email search by domain

<http://emailbydomain.com>

Auto manuals search

<http://auto.somanuals.com>

TV manuals search

<http://tv.somanuals.com>