

# Pioneer DVD Player

## DV-3022V/DV-3020V DV-2022/DV-2020

### Operating Instructions



English on top side.  
Italiano sul lato opposto.

Thank you for buying this Pioneer product. Please read through these operating instructions so you will know how to operate your model properly. After you have finished reading the instructions, put them away in a safe place for future reference.

<b>Table of contents</b>	<b>Lower half</b>
<b>Upper half</b>	<b>Changing the settings</b>
<b>Before you start</b>	<b>Playable discs and files</b>
<b>Part names and functions</b>	<b>Troubleshooting</b>
<b>Convenient functions</b>	<b>Additional information</b>

### What's in the box

- Remote Control
- AAA batteries (R603) x 2
- Warranty card
- Operating instructions (This document)

Discover the benefits of registering your product online at <http://www.pioneer.co.uk> (or <http://www.pioneer.eu>)  
Download an electronic version of this manual from our website.

© 2011 PIONEER CORPORATION. All rights reserved.



**PIONEER CORPORATION**  
1-1, Shin-ogura, Saitai-ku, Kawasaki-shi, Kanagawa 212-0031, Japan  
**PIONEER EUROPE NV**  
Haven 1087, Kesterparkgebied, B-9120 Mellebe, Belgium TEL: 03570 0511  
8002 R2, Eindhoven

Printed in Thailand

## Safety cautions

### IMPORTANT

The lightning flash with rounded symbol, within an equilateral triangle, is intended to alert the user to the presence of unshielded "dangerous voltage" within the product's enclosure that may be of sufficient magnitude to constitute a risk of electric shock to persons.

**CAUTION**  
RISK OF ELECTRIC SHOCK  
DO NOT OPEN

**CAUTION**  
TO PREVENT THE RISK OF ELECTRIC SHOCK, DO NOT REMOVE COVER (OR BACK). NO USER-SERVICEABLE PARTS INSIDE. REFER SERVICING TO QUALIFIED SERVICE PERSONNEL.

The exclamation mark within an equilateral triangle is intended to alert the user to the presence of important operating and maintenance (servicing) instructions in the literature accompanying the appliance.

**CAUTION**  
The **STANDBY/ON** switch on this unit will not completely shut off all power on the AC outlet. Since the power cord serves as the main disconnect device for the unit, you will need to unplug it from the AC outlet to shut down all power. Therefore, make sure the unit has been installed so that the power cord can be easily unplugged from the AC outlet in case of an accident. To avoid fire hazard, the power cord should also be unplugged from the AC outlet when left unattended for a long period of time (for example, when on vacation).

If the AC plug of this unit does not match the AC outlet you want to use, the plug must be removed and appropriate one fitted. Replacement and mounting of an AC plug on the power supply cord of this unit should be performed only by qualified service personnel. If connected to an AC outlet, the cut-off plug can cause severe electrical shock. Make sure it is properly disposed of after removal. The equipment should be disconnected by removing the mains plug from the wall socket when left unused for a long period of time (for example, when on vacation).

**WARNING**  
To prevent a fire hazard, do not place any naked flame sources (such as a lighted candle) on the equipment.

**WARNING**  
Before plugging in for the first time, read the following section carefully.  
The voltage of the available power supply differs according to country or region. Be sure that the power supply voltage of the area where this unit will be used meets the required voltage (e.g. 230 V or 120 V) written on the rear panel.

This product is for general household purposes. Any failure due to use for other than household purposes (such as long term use in a car or ship) and which requires repair will be charged for even during the warranty period.

**Operating Environment**  
Operating environment temperature and humidity: +5°C (+41°F) to +35°C (+95°F) less than 85% RH (cooling vents not blocked)  
Do not install this unit in a poorly ventilated area, in a location exposed to high humidity or direct sunlight or strong artificial light.

**POWER-CORD CAUTION**  
Handle the power cord by the plug. Do not pull out the plug by tugging the cord and never touch the power cord when your hands are wet as this could cause a short circuit or electric shock. Do not place the unit, a piece of furniture, etc., on the power cord or pinch the cord. Never make a knot in the cord or tie it with other cords. The power cords should be routed such that they are not likely to be stepped on. A damaged power cord can cause a fire or give you an electrical shock. Check the power cord once in a while. When you find it damaged, ask your nearest PIONEER authorized service center or your dealer for a replacement.

**VENTILATION CAUTION**  
Place this unit on a level surface to leave space around the unit for ventilation to improve heat radiation (at least 10 cm to 10 cm at rear and 10 cm at each side).

**WARNING**  
Slits and openings in the cabinet are provided for ventilation to ensure reliable operation of the product, and to protect it from overheating. To prevent fire hazard, the openings should never be blocked or covered with items (such as newspapers, tablecloths, curtains) or by operating the equipment on thick carpet or rug.

## Specifications

Power requirements: AC 220 V to 240 V, 50 Hz/60 Hz  
Input (DV-3022V, 7 W (DV-3020V), 10 W (DV-2022), 6 W (DV-2020))  
Power consumption (standby)  
DV-3022V/DV-3020V ..... 0.8 W  
DV-2022/DV-2020 ..... 0.5 W  
Weight ..... 1.2 kg  
External dimensions ..... 380 mm (W) x 42 mm (H) x 200 mm (D)  
Tolerable operating humidity ..... 5% to 85% (no condensation)  
AV Connector (21-pin connector assignment)  
AV connector output ..... 21-pin connector  
This connector provides the video and audio signals for connection to a compatible color TV or monitor.  
PIN no.  
1 ..... Audio L/R out  
2 ..... Audio L/R out  
3 ..... GND  
4 ..... B out  
5 ..... Status  
6 ..... G out  
7 ..... R out  
8 ..... GND  
9 ..... Video out  
10 ..... B out  
11 ..... GND  
12 ..... Video out  
13 ..... GND  
14 ..... Video out  
15 ..... GND

Video output  
Output level ..... 1 Vp-p (75 Ω)  
Output impedance ..... RCA terminal  
HDMI output (Only for DV-3022/DV-3020V)  
Output terminal ..... 19-pin  
Audio output (Stereo L/R)  
Audio output level ..... 200 mVrms (1 kHz, 20 dB)  
Output terminal ..... RCA terminal  
Frequency response ..... 4 Hz to 44 kHz

Digital audio output  
Connector type ..... RCA terminal  
Additional information (Only for DV-3022V/DV-2022)  
USB port ..... A-Type

**Notes**  
• The specifications and design of this product are subject to change without notice.  
• This product includes FontAvenue fonts licensed by NEC Corporation. FontAvenue is a registered trademark of NEC Corporation.  
• The **AV RECEIVER** and design of this product are subject to change without notice.  
• This product includes FontAvenue fonts licensed by NEC Corporation. FontAvenue is a registered trademark of NEC Corporation.

## Before you start

### Loading the batteries in the remote control

• Open the rear lid and insert the batteries.  
**WARNING**  
Do not use or store batteries in direct sunlight or other excessively hot place, such as inside a car or near a heater. This can cause batteries to leak, overheat, explode or catch fire. It can also reduce the life or performance of batteries.

**Notes**  
• When inserting the batteries, make sure not to damage the springs on your battery's (+) terminals.  
• Do not use any batteries other than the ones specified.  
• Also, do not use a battery together with an old one.  
• When loading the batteries into the remote control, set them in the proper direction, as indicated by the polarity (+) and (-) marks.  
• Do not let batteries, disassemble them, or throw them into flames or water.  
• Batteries may have different voltages, even if they are the same size and shape. Do not use different types of batteries together.  
• To prevent leakage of battery fluid, remove the batteries if you do not plan to use the remote control for a long period of time (1 month or more). If the fluid should leak, wipe it carefully off the inside of the case. Then insert new batteries. If a battery should leak and the fluid should get on your skin, flush it off with large quantities of water.  
• When disposing of used batteries, please comply with governmental regulations or environmental protection institution's rules that apply in your country/area.

**Notes for DV-3022/DV-3020V**  
• Signals can be transferred to an HDMI-compatible TV without loss of picture or sound quality using an HDMI cable.  
• Follow the TV instructions after the connections, then set HDMI Resolution (section 4).  
• This player's interface is designed according to the High-Definition Multimedia Interface specifications. When an HDMI-compatible device is connected, the resolution is displayed on the front panel display.  
• The resolution of the video signals output from the HDMI OUT terminal can be changed manually. Change the HDMI Resolution setting (section 4). Settings for two units can be stored in the memory.  
• This player is designed for connecting to HDMI-compatible devices. It may not operate properly if connected to DVD devices.

**Playing audio signals through the HDMI OUT terminal (DV-3022V/DV-3020V)**  
• 4+1 kHz to 48 kHz, 16-bit/20-bit/24-bit 2-channel linear PCM audio (including 2-channel downmixing)  
• Dolby Digital 5.1-channel audio  
• DTS 5.1-channel audio  
• MPEG audio

**Connecting using commercially available cables**  
• The player can be connected to an AV amplifier, etc. using commercially available digital audio cables.

## 2 Part names and functions

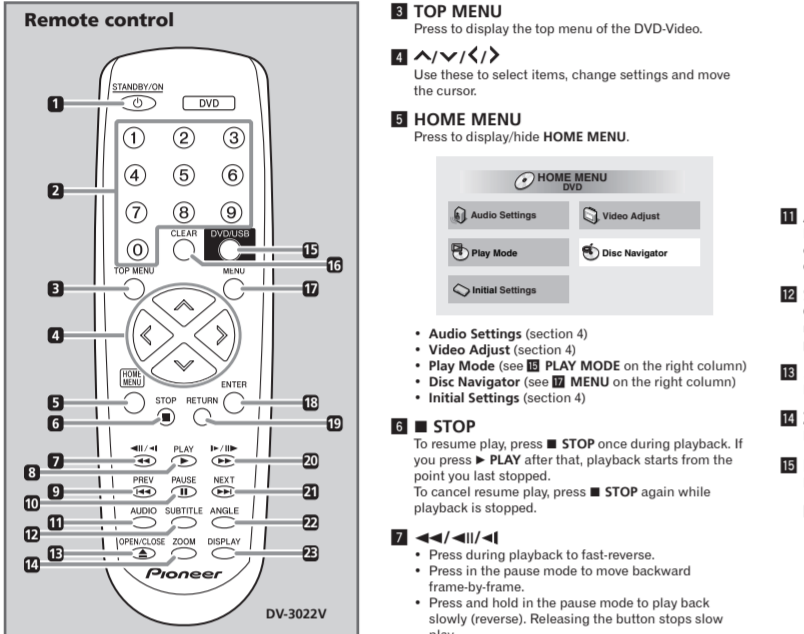

**Remote control**  
1. STANDBY/ON  
2. Home Menu  
3. Stop  
4. Arrow keys  
5. Repeat  
6. Play/Pause  
7. Previous  
8. Next  
9. Clear/Display  
10. Enter  
11. DVD/USB  
12. Subtitle  
13. A/B Repeat  
14. Zoom  
15. Play/Pause  
16. Stop  
17. Previous  
18. Next  
19. Clear/Display  
20. Enter  
21. DVD/USB  
22. Subtitle

**TOP MENU**  
Press to display the top menu of the DVD-Video.  
Press to select items, change settings and move the cursor.  
**HOME MENU**  
Press to display/hide HOME MENU.  
**Audio Settings**  
Press to adjust audio settings.  
**Video Adjust**  
Press to adjust video settings.  
**Initial Settings**  
Press to return to initial settings.

**Audio Settings** (section 4)  
**Video Adjust** (section 4)  
**Play Mode** (see PLAY MODE on the right column)  
**Disc Navigator** (see DISC NAVIGATOR on the right column)  
**Initial Settings** (section 4)

**STOP**  
To resume play, press **STOP** once during playback. If you press **PLAY** after that, playback starts from the point you last stopped.  
To cancel resume play, press **STOP** again while playback is stopped.

**Fast Reverse/Play/Pause**  
Press during playback to fast-reverse, press in the pause mode to move backward frame-by-frame.  
Press and hold in the pause mode to play back slowly (reverse). Releasing the button stops slow play.

**PLAY**  
Press to start playback.  
**PREV**  
Press to return to the beginning of the currently playing title, chapter, track or file. Press twice to move back to the beginning of the previous title, chapter, track or file.

**PAUSE**  
Press to stop playback temporarily. Press again to resume.

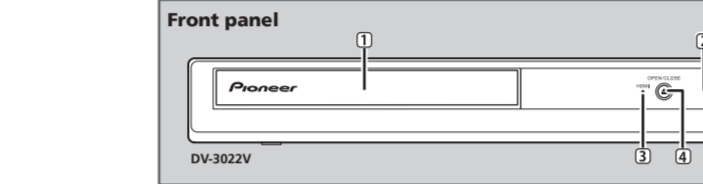

**AUDIO**  
For discs or files with multiple audio streams/channels, the audio stream/channel can be changed through playback.  
**SUBTITLE**  
On DVD-Video or DivX discs containing subtitles in multiple languages, the subtitle can be changed during playback.  
**OPEN/CLOSE**  
Press to open and close the disc tray and load the disc.  
**Zoom**  
Press to zoom on the image.  
**DVD/USB (section 3) (DV-3022V/DV-2022)**  
Press to return to the DVD/USB settings.  
**PLAY MODE (DV-3020V/DV-2020)**  
A B Repeat  
The specified setting within a single title or track is played repeatedly.  
• **Repeat**  
Plays titles, chapters, tracks or files repeatedly.  
• **Random**  
Plays titles, chapters or tracks in random order.  
• **Program**  
See section 3 for details.  
• **Search Mode**  
Plays the specified number or time within the title, chapter, track or file.  
The **Play Mode** function may not work for some discs or files.

**CLEAR**  
Press to cancel the selected item.  
**MENU**  
Press to display MENU screen or **Disc Navigator**.  
• Select the title, chapter, track or file from the **Disc Navigator** to play back.  
**ENTER**  
Use this to implement the selected item or enter a setting that you have changed.  
**RETURN**  
Press to return to the previous screen.  
• Press **RETURN** to return to the previous screen.  
• Press and hold in the pause mode to play back slowly (reverse). Releasing the button stops slow play.  
**NEXT**  
Press during playback to skip ahead to the beginning of the next title, chapter, track or file.  
**ANGLE**  
• On DVD-Video discs containing multiple angles, the angle can be changed during playback.  
• Press and hold during the Audio CD playback to change angles.  
Each time you press and hold, the repeat mode changes between the disc repeat and track repeat mode.  
**DISPLAY**  
The elapsed time, amount remaining, etc., is displayed.

## 3 Convenient functions

### Playing in the desired order (Programmed Play)

**1 Display the Play Mode screen.**  
Press **PLAY** mode.  
**2 Select Program.**  
Use **Left/Right** to select, then press **ENTER**.  
**3 Select Create/Edit.**  
Press **ENTER**.  
**4 Select the title, chapter, track or file.**  
Use **Left/Right** to select, then press **ENTER**.  
To add a program, first select the place in the program (the program steps), next select the title, chapter, track or file then press **ENTER** (files are added at the end of program).  
**5 OPEN/CLOSE**  
Press **OPEN/CLOSE** (type A) (DV-3022V/DV-2022) to start a play.  
**Notes**  
• To play the program, select **Play Start** from the program screen, then press **ENTER**.  
• To resume normal playback, select **Play Stop** from the program screen, then press **ENTER**. The program remains in the memory.  
• To cancel the entire program, select **Program Delete** from the program screen, then press **ENTER**.

## 4 Changing the settings

The factory default settings are indicated in *italics*.  
**Audio Settings parameters**  
**Sound Retriever (High/Low/Off)**  
The sound of a WMA or MP3 file is played with high sound quality. This is only valid for files with the extension ".wma" or ".mp3".  
This setting only affects Dolby Digital signals.  
The effect depends on the volume of the connected units.  
**Equalizer (Off/Rock/Pop/Live/Dance/Techno/Classic/Soft)**  
• Select according to the genre of music to be listened to.  
• This makes loud sounds weaker and weak sounds louder.  
• This effect depends on the volume of the connected units.  
**Dialog (High/Medium/Low/Off)**  
Change this setting if the sound of the dialogs is too low.  
**About Sound Retriever function**  
When audio data is removed during the compression process, sound quality is degraded. The Sound Retriever function automatically enhances compressed audio and restores CD quality sound.  
**Video Adjust parameters**  
**Sharpness (Fine/Standard/Soft)**  
Adjusts the picture's sharpness.  
**Brightness (20 to +20)**  
Adjusts the picture's brightness.  
**Contrast (-16 to +16)**  
Adjusts the ratio of the brightness of the brightest and darkest portions of the picture.  
**Gamma (-3 to +3)**  
Adjusts the look of the dark portions of the picture.  
**Hue (green 9 to red 9)**  
Adjusts the balance between green and red.  
**Chroma Level (-8 to +8)**  
Adjusts the density of the colors. This setting is effective for sources with many colors, such as cartoons.  
**Brightness, Contrast, Gamma, Hue and Chroma Level** are set to 0 upon purchase.  
**Initial Settings parameters**  
• The player's detailed settings can be changed here.  
• **Initial Settings** cannot be selected during playback.  
**Digital Audio Out settings**  
**HDMI Out (DV-3022V/DV-3020V)**  
Select the audio signals to be output from the HDMI OUT terminal (PCM/COAX/Auto/Off) according to the connected HDMI-compatible device.  
**Digital Out**  
Select whether to output digital audio signals (On) from the COAXIAL/DIGITAL AUDIO OUT terminals or not (Off).  
**Dolby Digital Out**  
Select whether to output Dolby Digital audio signals (Dolby Digital) or to convert them into linear PCM signals (Dolby Digital > PCM), according to the connected unit.  
**DTS Out**  
Select whether to output DTS audio signals (DTS) or not (Off), according to the connected unit.  
**96 kHz PCM Out**  
Select whether to output 96 kHz audio signals (96kHz) or to convert them into linear PCM signals (96kHz > 48kHz), according to the connected unit.  
**MPEG Audio**  
Select whether to output MPEG audio signals (MPEG) or to convert them into linear PCM signals (MPEG > PCM), according to the connected unit.  
**Video output settings**  
**TV Screen**  
• Change the picture's display format (4:3 (Letter Box)/4:3 (Pan & Scan)/16:9 (Wide)/16:9 (Compressed)), according to the connected TV.  
The player's factory default settings are set as below.  
DV-3022V/DV-3020V ..... 16:9 (Wide)  
DV-2022/DV-2020 ..... 4:3 (Letter Box)  
• **16:9(Compressed)** can only be set on DV-3022V and DV-3020V.  
**HDMI Resolution (DV-3022V/DV-3020V)**  
• Change the resolution of the video signals output from the HDMI OUT terminals (720x480/720x576/720x480p/720x576p/1280x720p/1920x1080/1920x1080p).  
**HDMI Compatible (DV-3022V/DV-3020V)**  
• Change the video signals output from the HDMI OUT terminal (Full range RGB/RGB Component).  
**Deep Color (DV-3022V/DV-3020V)**  
• Select whether to connect the connected TV monitor is compatible with Deep Color (Auto/Off).

## 5 Playable discs and files

**Playable discs**  
• DVD-Video discs  
• DVD-R/RW, DVD+R/RW, DVD-RAM discs recorded in the Video mode  
• Video CDs (including Super VCDs)  
• Audio CDs  
• CD-R/RW, ROM discs containing music recorded in the CD-DA format  
• JPEG files recorded on DVD-R/RW/RL discs, CD-R/RW/ROM discs  
• DivX video files recorded on DVD-R/RW/RL discs, CD-R/RW/ROM discs  
• WMA files recorded on DVD-R/RW/RL discs, CD-R/RW/ROM discs  
• MP3 files recorded on DVD-R/RW/RL discs, CD-R/RW/ROM discs  
• FUJICOLOR-CD  
• KODAK Picture CD  
**Discs that cannot be played**  
• Blu-ray discs  
• HD-DVDs  
• AVCHD  
• AVCHC  
• DVD-Audio discs  
• DVD-RAM discs  
• SACDs  
• CDDs  
• CDs recorded with packet writing  
• Programs that can be recorded only once and that are (already) recorded on a DVD-R/RW/RL disc  
**About region numbers**  
All DVD-Video discs carry a region mark (number) on the case. The mark (number) denotes the region(s) of the world in which the disc is compatible. Your DVD player also has a region mark (number), which you can find on the rear panel.  
If you try to play a disc of an incompatible region, "Incompatible disc region number Can't play disc" will be displayed on the screen and you will not be able to play the disc. Discs marked "ALL" can be played in any player. The diagram below shows the various DVD regions of the world.  
**Disabling external subtitle files**  
• The font sets listed below are available for external subtitle files. You can see the proper font set on-screen by setting the **Subtitle Language** in section 4 to match the subtitle file.  
• This player supports the following language groups:  

<b>Group 1</b>	Afrikaans (af), Basque (eu), Catalan (ca), Danish (da), Dutch (nl), English (en), Finnish (fi), French (fr), Galician (gl), German (de), Greek (el), Hebrew (iw), Hindi (hi), Indonesian (id), Italian (it), Japanese (ja), Korean (kr), Latvian (lv), Lithuanian (lt), Maltese (mt), Norwegian (no), Persian (fa), Polish (pl), Portuguese (pt), Romanian (ro), Russian (ru), Serbian (sr), Spanish (es), Swedish (sv), Turkish (tr)
<b>Group 2</b>	Albanian (sq), Armenian (hy), Czech (cs), Hungarian (hu), Irish (ga), Italian (it), Latvian (lv), Lithuanian (lt), Maltese (mt), Norwegian (no), Persian (fa), Polish (pl), Portuguese (pt), Romanian (ro), Russian (ru), Serbian (sr), Spanish (es), Swedish (sv), Turkish (tr)
<b>Group 3</b>	Arabic (ar), Bulgarian (bg), Chinese (zh), Croatian (hr), Czech (cs), Dutch (nl), English (en), Estonian (et), Finnish (fi), French (fr), Galician (gl), German (de), Greek (el), Hebrew (iw), Hindi (hi), Indonesian (id), Italian (it), Japanese (ja), Korean (kr), Latvian (lv), Lithuanian (lt), Maltese (mt), Norwegian (no), Persian (fa), Polish (pl), Portuguese (pt), Romanian (ro), Russian (ru), Serbian (sr), Spanish (es), Swedish (sv), Turkish (tr)
<b>Group 4</b>	Bengali (bn), Burmese (my), Byelorussian (ru), Macedonian (mk), Malayalam (ml), Marathi (mr), Serbian (sr), Slovenian (sl), Ukrainian (uk), Hebrew (iw), Yiddish (yi)
<b>Group 5</b>	Turkish (tr)

  
• Some external subtitle files may be displayed incorrectly or not at all.  
• For external subtitle files the following subtitle format filename extensions are supported (please note that this player does not allow to insert the disc navigation menu): .rt, .sub, .ssa, .smi  
• The filename of the movie file has to be repeated at the beginning of the filename for the external subtitle file.  
• The number of external subtitle files which can be switched for the same movie file is limited to a maximum of 10.  
**Supported image file formats**  
**JPEG**  
Resolution: Up to 3 072 x 2 048 pixels  
• This player supports baseline JPEG.  
• Bit rate: Up to 192 kbps  
• This player does not support progressive JPEG.  
**Supported audio file formats**  
• This player does not support VBR (Variable Bit Rate) and lossless encoding.  
**Windows Media® Audio (WMA)**  
• Sampling frequencies: 32 kHz, 44.1 kHz and 48 kHz  
• Bit rate: Up to 192 kbps  
• This player supports files encoded using Windows Media Player Ver. 7.1.1. Windows Media Player for Windows XP and Windows Media Player 9 Series.  
• Windows Ver. is either a registered trademark or trademark of Microsoft Corporation in the United States and/or other countries.  
• This product includes technology owned by Microsoft Corporation and cannot be used or distributed without a license from Microsoft Licensing, Inc.  
**MPEG-1 Audio Layer 3 (MP3)**  
• Sampling frequencies: 32 kHz, 44.1 kHz and 48 kHz  
**Video files**  
• Files not containing DivX video signals cannot be played, even if they have the extension ".avi"  
**Image files**  
• JPG  
• BMP  
• WMA  
• MP3  
**Supported image file formats**  
• This player does not support VBR (Variable Bit Rate) and lossless encoding.

## 6 Troubleshooting

**Incorrect operation is often mistaken for trouble or malfunction.** If there is something wrong with this player, check the symptoms below.  
Sometimes the trouble lie in another component connected to this player. Inspect the component and electrical appliances being used. If the trouble cannot be rectified after checking the items below, ask your nearest Pioneer authorized service center or your dealer to carry out repair work.  
The player may not operate properly due to static electricity or other external influences. In such cases, normal operation may be restored by unplugging the power cord then plugging it back in.  
**Difference in volume between DVD and CD.**  
The volume may sound different due to differences in aspect ratio when recorded on the disc.  
**Disc cannot be played or disc tray opens automatically.**  
• If the disc is dirty, wipe the disc off the disc (section 7).  
• Set the disc with the printed side facing up.  
• Check the disc's region number, and if the number is compatible for playback on the player (section 5).  
• Clean the disc with the appropriate region number or "ALL" can be played.  
**The power turns off automatically.**  
• If **Auto Power Off** is set to On, the power turns off automatically if no operation has done for over 30 minutes (section 4).  
**Picture is stretched, or aspect ratio cannot be changed.**  
• Refer to the TV's operating instructions and set the TV's aspect ratio properly.  
• Set **TV Screen** properly (section 4).  
**Picture is disturbed or dark during playback.**  
• When the player and the TV are connected via a video cable, "analog copy protect function" may cause the picture being played on the video deck not to display properly. Connect the player and TV directly.  
• Set the TV system properly. The factory default setting is AUTO. If the picture is distorted, switch the TV system to the one used in your country or region (NTSC or PAL) (section 7).  
**96 kHz/82.2 kHz digital audio signals are not output from the COAXIAL/DIGITAL AUDIO OUT terminals.**  
• Set **96 kHz PCM Out** to **96kHz** or **48kHz**.  
• The 96 kHz/82.2 kHz digital audio signals of copyright-protected discs cannot be output.  
**Folder or file names are not recognized.**  
• This player can recognize up to 259 folders on one disc and 648 files within one folder. Depending on the folder structure, however, the player may not be able to recognize certain folders or files.  
**Folder or file names are not displayed or properly displayed.**  
• The maximum displayable number of characters for the folder and file names on the Disc Navigator is 14.  
**Folder or file names are not displayed in alphabetical order.**  
• The order of the folder and file names displayed on the screen is dependent on the time and date when the folders or files were created on the USB device.  
**Multiple time is required to recognize the USB device.**  
• It may take longer to load data when a large capacity USB device is connected (this could take several minutes).

## 7 Additional information

**When connected to an HDMI-compatible device (DV-3022V/DV-3020V)**  
**Picture is not displayed.**  
• Restore HDMI Resolution to the default setting (720x480p/720x576p) (section 4).  
• Use the buttons on the front panel.  
**Multichannel audio signals are not output.**  
• Set **HDMI Out to Auto** (section 4).  
**Control function does not work.**  
• Set **Control to On** on the player (section 4).  
• The control function does not work with devices of other brands. Even when connected to a Pioneer product compatible with the **Control** function, some of the functions may not work.  
**The message CEC200 appears.**  
• When the **Disc Navigator** is selected using the Flat Screen TV's remote controller and the player is turned off, the message **CEC200** will be displayed. This is also a malfunction.  
Turn on the player to use the function.  
**The player turns on or off automatically.**  
• The player may turn on together with the TV connected to **HDMI OUT** terminal. If you do not want them to turn on at the same time, set **Control** to **Off** (section 4).  
**The input of the connected TV or AV system is switched to the player's automatically.**  
• The input of the TV and AV system (AV receiver or amplifier, etc.) connected to **HDMI OUT** terminal may be automatically switched to the player when playback starts on the player or the menu screen (**HOME MENU**, etc.) is displayed. If you do not want the connected TV and AV system (AV receiver or amplifier, etc.) affected by the player's operation, set **Control** to **Off** (section 4).  
**Setting the TV system**  
• If the picture of the disc being played is distorted, switch the TV system to the one used in your country or region.  
• When the TV system is switched, the types of discs that can be played are limited.  
• The factory default setting is AUTO.  
**While the player is in the standby mode...**  
**Press STANDBY/ON while pressing ■.**  
• Use the buttons on the front panel.  
• The power turns on and the TV system settings as shown below.  
• AUTO → NTSC  
• NTSC → PAL  
• PAL → AUTO  

Types of discs/files	Format	Player setting	NTSC	PAL	AUTO
DVD-VIDEO	NTSC	NTSC	PAL	NTSC	
DVD-R/RW	NTSC	NTSC	PAL	NTSC	
DVD+R/RW	PAL	NTSC	PAL	PAL	
DIVX	NTSC	NTSC	PAL	NTSC	
CD/DA	NTSC	PAL	NTSC	PAL	
WMA	NTSC	PAL	NTSC	PAL	
JPEG	NTSC	PAL	NTSC	PAL	
no disc					

  
**Cautions on use**  
**When moving the player**  
When moving the player, check first that there is no disc loaded and that the disc tray is closed. Then press **STANDBY/ON** on the player or **STANDBY/ON** on the remote control, wait for the OFF indicator on the front panel display to turn off, then unplug the power cord. Moving the player with a disc inside it could result in damage.  
**Place of installation**  
• Choose a stable place near the TV or stereo system using used with the player.  
• Do not place the player on top of a TV or color monitor.  
• Also install it away from cassette decks and other devices easily affected by magnetic forces.  
**Avoid the following types of places:**  
• Places exposed to direct sunlight  
• Humid or poorly ventilated places  
• Extremely hot places  
• Places exposed to vibrations  
• Places in which there is much dust or cigarette smoke  
• Places exposed to soot, steam or heat (kitchens, etc.)  
**Do not place objects on the player.**  
Do not place any objects on top of the player.  
**Do not obstruct the ventilation holes.**  
Do not use the player on shaggy rugs, beds, sofas, etc., or in a rack, as they may prevent the heat from dispersing, leading to damage.  
**Do not expose to heat.**  
Do not place the player on top of an amplifier or other products in contact with the player's power is on. If this happens, turn the player's power off.  
**About condensation**  
If the player is moved suddenly from a cold place into a warm room (in winter, for example) or if the temperature in the room in which the player is installed rises suddenly due to a heater, etc., water droplets (condensation) may form inside (on operating parts and the lens). When condensation is present, the player will not operate properly and playback is not possible. Let the player stand at room temperature for 1 or 2 hours with the power turned on (the time depends on the extent of condensation). The water droplets will dissipate and playback will become possible. Condensation can also occur in the summer if the player is exposed to the direct wind from an air-conditioner. If this happens, move the player to a different place.  
**Cleaning the product**  
• Unplug the power cord from the power outlet when cleaning the player.  
• Clean the player using a soft cloth. For tough dirt, apply some neutral detergent diluted in 5 to 6 parts water to a soft cloth, wring out thoroughly, wipe off the dirt, then wipe again with a soft, dry cloth.  
• Alcohol, thinner, benzene, insecticides, etc., could cause the print or paint to peel off. Also, leaving rubber or vinyl products in contact with the player for long periods of time could ruin the cabinet.  
• When using cleaning-impermeated waxes, etc., read the cautions included with the waxes carefully.  
**Caution for when the unit is installed in a rack with a glass door**  
Do not use **OPEN/CLOSE** on the remote control to open the disc tray while the glass door is closed. The door will hamper the movement of the disc tray, and the unit could be damaged.  
**Cleaning the lens**  
The player's lens should not become dirty in normal use. However, if the lens is heavily soiled or scratched, dust, dirt, or dirt, consult your nearest Pioneer authorized service center. Although lens cleaners for players are commercially available, do not use them as they may prevent the heat from dispersing, leading to damage.  
**About copyrights**  
This item incorporates copy protection technology that is protected by U.S. patents and other intellectual property rights of NEC Corporation. Reverse engineering and disassembly are prohibited.  
**Handling discs**  
**Storing**  
• Always place discs in their cases and store them vertically, avoiding places hot, humid, exposed to direct sunlight and extremely cold.  
• Be sure to read the cautions included with the disc.  
**Cleaning discs**  
• Discs may not play if there are fingerprints or dust on them. In this case, use a cleaning cloth, etc., to gently wipe the disc from the inside towards the outside. Do not use dirty cleaning cloths.  
• Do not use benzene, thinner or other volatile chemicals. Do not use acetone or any other multistage-agent solvents.  
• The player may not be able to play discs recorded using a computer or a BD/DVD recorder, if burn quality is not good or if they are recorded from a cold place (particularly in winter) into a warm room. Discs may not play normally if there is no glue around the edges of such labels before using rented discs.  
**About specially shaped discs**  
Specially shaped discs (heart-shaped, hexagonal, etc.) cannot be played on this player. Do not attempt to play such discs, as they could damage the player.  
**About condensation on discs**  
Water droplets (condensation) may form on the surface of discs if they are moved from a cold place (particularly in winter) into a warm room. Discs may not play normally if there is condensation on them. Carefully wipe the water droplets off the surface of the disc before loading it.

## 8 Playable discs and files

**Disabling external subtitle files**  
• The font sets listed below are available for external subtitle files. You can see the proper font set on-screen by setting the **Subtitle Language** in section 4 to match the subtitle file.  
• This player supports the following language groups:  

Group 1	Group 2	Group 3	Group 4	Group 5
Afrikaans (af), Basque (eu), Catalan (ca), Danish (da), Dutch (nl), English (en), Finnish (fi), French (fr), Galician (gl), German (de), Greek (el), Hebrew (iw), Hindi (hi), Indonesian (id), Italian (it), Japanese (ja), Korean (kr), Latvian (lv), Lithuanian (lt), Maltese (mt), Norwegian (no), Persian (fa), Polish (pl), Portuguese (pt), Romanian (ro), Russian (ru), Serbian (sr), Spanish (es), Swedish (sv), Turkish (tr)	Albanian (sq), Armenian (hy), Czech (cs), Hungarian (hu), Irish (ga), Italian (it), Latvian (lv), Lithuanian (lt), Maltese (mt), Norwegian (no), Persian (fa), Polish (pl), Portuguese (pt), Romanian (ro), Russian (ru), Serbian (sr), Spanish (es), Swedish (sv), Turkish (tr)	Arabic (ar), Bulgarian (bg), Chinese (zh), Croatian (hr), Czech (cs), Dutch (nl), English (en), Estonian (et), Finnish (fi), French (fr), Galician (gl), German (de), Greek (el), Hebrew (iw), Hindi (hi), Indonesian (id), Italian (it), Japanese (ja), Korean (kr), Latvian (lv), Lithuanian (lt), Maltese (mt), Norwegian (no), Persian (fa), Polish (pl), Portuguese (pt), Romanian (ro), Russian (ru), Serbian (sr), Spanish (es), Swedish (sv), Turkish (tr)	Beng	



## Free Manuals Download Website

<http://myh66.com>

<http://usermanuals.us>

<http://www.somanuals.com>

<http://www.4manuals.cc>

<http://www.manual-lib.com>

<http://www.404manual.com>

<http://www.luxmanual.com>

<http://aubethermostatmanual.com>

Golf course search by state

<http://golfingnear.com>

Email search by domain

<http://emailbydomain.com>

Auto manuals search

<http://auto.somanuals.com>

TV manuals search

<http://tv.somanuals.com>