

# 5 1/4-Inch 2-Way Ceiling Speaker

40-4091

OWNER'S MANUAL — Please read before using this equipment.

## ! IMPORTANT !

If an icon appears at the end of a paragraph, go to the box on that page with the corresponding icon for pertinent information.

⚠ — Warning

! — Important

⚡ — Caution

💡 — Hint

✓ — Note

Your RadioShack 5 1/4-Inch 2-Way Ceiling Speaker features a crossover, a 5 1/4-inch woofer for rich lows, and a 1/2-inch tweeter for crisp highs. The speaker can handle up to 40 watts of music power. The wing-type mounting system makes it easy to mount

your speaker flush with the ceiling or wall, making it ideal for unobtrusive use in a surround-sound system. The frame and grille can also be painted to match the room's decor.

## INSTALLATION

### PREPARING THE LOCATION

To mount your speaker, you need the following items (not supplied, available at your local RadioShack or online at RadioShack.com).

- drywall or keyhole saw
- wire stripper
- Phillips screwdriver
- pencil or marker
- 18–20 gauge speaker wire

1. Be sure the mounting surface is between 3/8 inch and 1 1/4-inch thick, with at least a 2 3/4-inch clearance behind the mounting surface and no wall studs or other objects to block the back of the speaker.

2. Remove the inner cardboard disc from the supplied template/paint mask and keep it for later. Use the outer portion as a template to mark the cutout hole size and location for mounting the speaker.

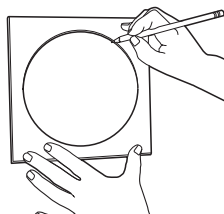

3. Use a drywall or keyhole saw to cut the hole. ⚡

### PREPARING THE SPEAKER

If you choose to paint the frame and grille, paint them and let them dry before you connect the speaker wire or mount the speaker.

To remove the grille for painting, insert a paper clip into one of the grille openings, then pull up. Or, you can carefully twist the plastic frame back and forth until the grille edge becomes exposed, then lift the grille to remove it.

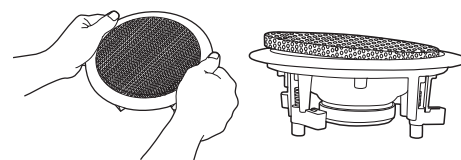

Carefully remove the dust cloth from behind the grill and replace it after you are finished painting. ✓

You can also paint the frame to match your wall or ceiling. To prevent paint from entering the speaker, remove the grille and insert the supplied cardboard paint mask. After the paint is dry, remove the paint mask and replace the grille.

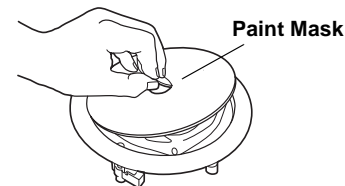

### CONNECTING THE SPEAKER WIRES

Your local RadioShack store sells a wide selection of speaker wire. We recommend you use wire that is color-coded or marked on one side to help you connect the wire correctly.

1. Route the speaker wire to the speaker from the receiver. ✓

2. Separate about 4 inches of speaker wire at each end.

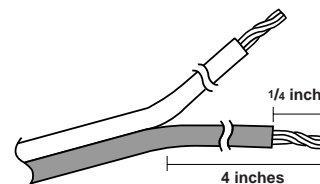

## ✓ NOTE ✓

Do not paint the speaker element. We recommend you spray-paint the grille so paint does not block the holes.

## ⚡ CAUTION ⚡

Be sure not to cut into any existing wiring or plumbing hidden behind the wall.

## ✓ NOTES ✓

- Avoid routing the speaker wire near electrical wires.
- Do not nail or staple the speaker wire.



**RadioShack**®

www.radioshack.com™

© 2002 RadioShack Corporation.  
All Rights Reserved.  
RadioShack and RadioShack.com are trademarks  
used by RadioShack Corporation.

### Limited Two-Year Warranty

This product is warranted by RadioShack against manufacturing defects in material and workmanship under normal use for two (2) years from the date of purchase from RadioShack company- owned stores and authorized RadioShack franchisees and dealers. EXCEPT AS PROVIDED HEREIN, RadioShack MAKES NO EXPRESS WARRANTIES AND ANY IMPLIED WARRANTIES, INCLUDING THOSE OF MERCHANTABILITY AND FITNESS FOR A PARTICULAR PURPOSE, ARE LIMITED IN DURATION TO THE DURATION OF THE WRITTEN LIMITED WARRANTIES CONTAINED HEREIN. EXCEPT AS PROVIDED HEREIN, RadioShack SHALL HAVE NO LIABILITY OR RESPONSIBILITY TO CUSTOMER OR ANY OTHER PERSON OR ENTITY WITH RESPECT TO ANY LIABILITY, LOSS OR DAMAGE CAUSED DIRECTLY OR INDIRECTLY BY USE OR PERFORMANCE OF THE PRODUCT OR ARISING OUT OF ANY BREACH OF THIS WARRANTY, INCLUDING, BUT NOT LIMITED TO, ANY DAMAGES RESULTING FROM INCONVENIENCE, LOSS OF TIME, DATA, PROPERTY, REVENUE, OR PROFIT OR ANY INDIRECT, SPECIAL, INCIDENTAL, OR CONSEQUENTIAL DAMAGES, EVEN IF RadioShack HAS BEEN ADVISED OF THE POSSIBILITY OF SUCH DAMAGES.

Some states do not allow limitations on how long an implied warranty lasts or the exclusion or limitation of incidental or consequential damages, so the above limitations or exclusions may not apply to you.

In the event of a product defect during the warranty period, take the product and the RadioShack sales receipt as proof of purchase date to any RadioShack store. RadioShack will, at its option, unless otherwise provided by law: (a) correct the defect by product repair without charge for parts and labor; (b) replace the product with one of the same or similar design; or (c) refund the purchase price. All replaced parts and products, and products on which a refund is made, become the property of RadioShack. New or reconditioned parts and products may be used in the performance of warranty service. Repaired or replaced parts and products are warranted for the remainder of the original warranty period. You will be charged for repair or replacement of the product made after the expiration of the warranty period.

This warranty does not cover: (a) damage or failure caused by or attributable to acts of God, abuse, accident, misuse, improper or abnormal usage, failure to follow instructions, improper installation or maintenance, alteration, lightning or other incidence of excess voltage or current; (b) any repairs other than those provided by a RadioShack Authorized Service Facility; (c) consumables such as fuses or batteries; (d) cosmetic damage; (e) transportation, shipping or insurance costs; or (f) costs of product removal, installation, set-up service adjustment or reinstallation.

This warranty gives you specific legal rights, and you may also have other rights which vary from state to state.

RadioShack Customer Relations, 200 Taylor Street, 6th Floor, Fort Worth, TX 76102

12/99

- Using a wire stripper, remove about 1/4 inch of insulation from each wire. Then twist the ends of each wire.
- Connect the marked wire to a red speaker terminal by pressing the release tab, inserting the wire into the hole, and then releasing the tab. Repeat this

procedure to connect the unmarked wire to the black terminal.

- Connect the marked wire coming from the speaker to the left channel of the receiver's positive (+) terminal. Then connect the unmarked wire to the left channel of the amplifier's negative (-) terminal.

## MOUNTING THE SPEAKER

- Remove the grille to expose the mounting screws.
- Be sure the mounting tabs are turned in, allowing the speaker to fit into the hole. Then insert the speaker into the mounting hole.
- Use the four screws to tighten the mounting tabs to the wall or ceiling. Be careful not to overtighten the screws.

- Replace the grille.

Mounting Tabs

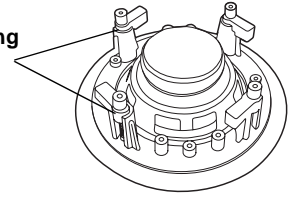

To remove the speaker from the wall or ceiling, loosen the screws only far enough to remove the speaker. This will prevent loss of the mounting tabs.

## SPECIFICATIONS

Resonance Frequency .....	70 Hz ±20%
Frequency Response .....	40 Hz through 20 kHz
Power Rating .....	20 Watts RMS, 40 Watts Max.
Impedance (nominal) .....	8 Ohms
Sensitivity .....	86 dB ±3 dB
Voice Coil .....	1 in. (25 mm)
Voice Coil (Tweeter) .....	1/2 in. (14 mm)
Magnet Size (Woofer).....	5.3 oz

The plastic enclosure for this speaker meets UL 94 requirements for flammability.

Specifications are typical; individual units may vary. Specifications are subject to change or improvement without notice.

## Free Manuals Download Website

<http://myh66.com>

<http://usermanuals.us>

<http://www.somanuals.com>

<http://www.4manuals.cc>

<http://www.manual-lib.com>

<http://www.404manual.com>

<http://www.luxmanual.com>

<http://aubethermostatmanual.com>

Golf course search by state

<http://golfingnear.com>

Email search by domain

<http://emailbydomain.com>

Auto manuals search

<http://auto.somanuals.com>

TV manuals search

<http://tv.somanuals.com>