



## Common Questions

TV1

- Q. I have my TV in a metal cabinet. Will the antenna work for me?
- A. Any large metal objects will prevent the antenna signal from reaching the antenna. You must place the antenna outside of or above the metal cabinet.
- Q. My home has aluminum siding/insulation. Where should I place my antenna?
- A. Place the antenna near a window to minimize interference and improve your reception.
- Q. Can I use my antenna in a basement?
- A. TV signals cannot penetrate into basement locations due to their lower elevation.

### Please Note:

Other variables, which are not related to antenna performance, can effect your reception. These include distance from the source transmitting the desired station, and man-made and natural conditions.

Example: Obstacles such as buildings between the transmitting source and your antenna.

4

## Performance Specifications

### Channels:

VHF: 2-13 UHF: 14-69

Operating Bandwidth: 54 MHz to 806 MHz

Output Impedance: 300 Ohms

### Dimensions:

Height of Base 3<sup>3</sup>/<sub>8</sub>"

Height with Dipoles (Closed): 12<sup>1</sup>/<sub>2</sub>" (Extended): 42<sup>1</sup>/<sub>2</sub>"

## Limited Warranty

Audiovox Corporation (Audiovox) warrants this product against defects in materials or workmanship for one (1) year from the date of purchase. During this period, this product will be replaced without charge. This warranty does not cover any damage due to acts of nature, commercial use, accident, misuse, abuse or negligence. This warranty is only valid in the USA. Replacement as provided under this warranty is the exclusive remedy of the consumer.

Audiovox shall not be liable for any incidental or consequential damages for breach of any express or implied warranty on this product, except to the extent that limitations of this sort are prohibited by applicable law.

**THERE ARE NO IMPLIED WARRANTIES OF MERCHANTABILITY OR FITNESS FOR A PARTICULAR PURCHASE EXCEPT TO THE EXTENT THAT IMPLIED WARRANTIES OR EITHER SORT ARE REQUIRED BY APPLICABLE LAW, AND IN SUCH CASE, EACH WARRANTY IS LIMITED IN DURATION TO THE ONE YEAR.**



For Customer Service  
Visit Our Website At  
[www.audiovox.com](http://www.audiovox.com)

Product Information, Photos,  
FAQ's, Owner's Manuals

**For customer service and  
technical information::1.800.290.6650**

TERK and the TERK logo are registered trademarks of AUDIOVOX Corp.

54P010A

# TV1

OWNER'S MANUAL



TV1  
Indoor Television Antenna

**TERK**  
by AUDIOVOX



## About Your TERK TV1

Thank you for choosing the TERK TV1. TERK antennas are designed to help deliver sharp, clear video reception. Our engineering department is dedicated to designing antennas that enhance both the latest technology and the aesthetics of any viewing environment. The TV1 installs in minutes, is easy to use and simple to adjust. Before using your antenna, please remove all parts from the box and read this owner's manual carefully.

### Flexible Design for Any Situation

The TV1 is great as a primary antenna or as a reliable back-up in the event of a cable or satellite outage. A UHF loop antenna is included to ensure reception of all off-air TV signals, and the 300/75 ohm transformer ensures compatibility with any television set.



## Making Connections With Your New TV1

Simply use the diagram below that matches the rear of your television set:

Connect the VHF and UHF antenna leads to the matching VHF and UHF screw terminals on the TV. See Fig. 1.

Connect the VHF antenna cable into the 300/75 ohm matching transformer (included) and insert the transformer into the VHF connection on the TV. Connect the UHF loop directly to the matching screw terminals on the TV. See Fig. 2.

Connect the VHF antenna cable into the 300/75 ohm matching transformer (included) and insert the transformer into the VHF connection on the TV. See Fig. 3.



## Locating Your TV1 For Best Results

Your TV1 is a precision instrument and should be placed in a location that is best for receiving TV signals. It can be placed on top of any standard TV for ease of adjustment.

## Helpful Information About Your TV1

The TV1 can be used with the weighted non-skid base or mounted directly to most TVs. See Fig. 4 and 5.

TV1

TV1

TV1

1

2

3

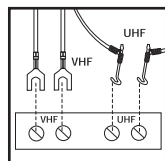

Fig. 1

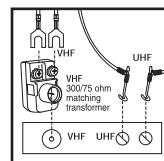

Fig. 2

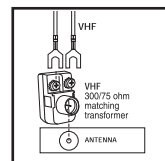

Fig. 3

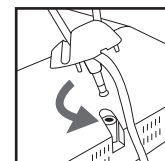

Fig. 4

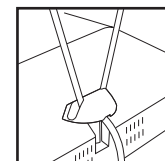

Fig. 5

## Free Manuals Download Website

<http://myh66.com>

<http://usermanuals.us>

<http://www.somanuals.com>

<http://www.4manuals.cc>

<http://www.manual-lib.com>

<http://www.404manual.com>

<http://www.luxmanual.com>

<http://aubethermostatmanual.com>

Golf course search by state

<http://golfingnear.com>

Email search by domain

<http://emailbydomain.com>

Auto manuals search

<http://auto.somanuals.com>

TV manuals search

<http://tv.somanuals.com>