

To Shut Off

While grill is sizzling, press and hold the red "ignition" button for at least 3 seconds to shut off. **Note:** Grill will not shut off if button is pressed while talking feature is active. Grill will automatically shut off if left inactive for a brief period of time. (To turn on the grill again, activate any of the 4 features mentioned previously.)



This toy simulates the function of a real grill. Please caution your child about the hazards of a real grill.

FCC STATEMENT

This equipment has been tested and found to comply with the limits for a Class B digital device, pursuant to part 15 of the FCC Rules. These limits are designed to provide reasonable protection against harmful interference in a residential installation. This equipment generates, uses and can radiate radio frequency energy, and, if not installed and used in accordance with the instructions, may cause harmful interference to radio communications. However, there is no guarantee that interference will not occur in a particular installation. If this equipment does cause harmful interference to radio or television reception, which can be determined by turning the equipment off and on, the user is encouraged to try to correct the interference by one or more of the following measures:

- Reorient or relocate the receiving antenna.
- Increase the separation between the equipment and the receiver.
- Consult the dealer or an experienced radio/TV technician for help.

AGES 3+

06539

PLAYSKOOL®



Bobby Q. The Magic Talkin' Grill™

Thank you for choosing this PLAYSKOOL product!

Includes 3 x 1.5V "AA"/R6 batteries. Alkaline batteries recommended. Phillips/cross head screwdriver (not included) required for battery replacement.

Includes grill, hot dog and bun, burger and bun, ear of corn, spatula, fork, ketchup and mustard. (Pieces are packed in a plastic bag.)

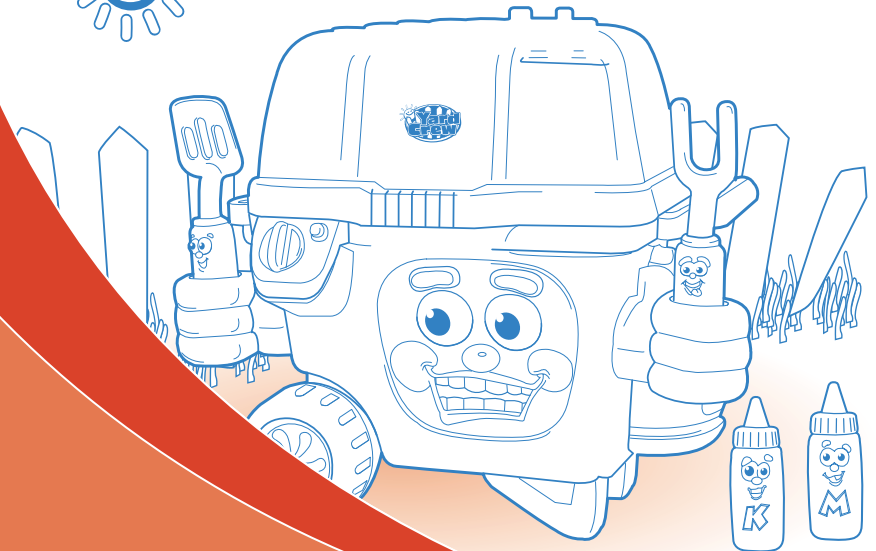

To Play

Preschoolers can have a pretend backyard barbecue with the BOBBY Q. MAGIC TALKIN' GRILL toy! This lovable friend comes to life with light, sounds, animation and fun activities!

- This special toy says over 50 fun phrases and has eyes and a mouth that move, a light-up grill and sizzle sounds! *To activate all these features, you can do one of four things: press the "ignition" button, turn the "temperature" dial, press on the grill surface or lift up the grill top.*
- The MAGIC TALKIN' GRILL toy also interacts with his cooking buddies! *Place the mustard, ketchup, spatula or fork in either of the grill's hands to hear the grill and accessory "talk" to each other!* Side tray holds 2 accessories. (Note: Accessories don't talk when placed in side tray.)
- "Cook" the hot dog, burger and ear of corn on the grill, then "toast" the buns and have a pretend feast! (Note: hot dog, burger and corn do not "talk.")

Placing food on grill surface does not activate features. Grill surface must be pressed down for activation.

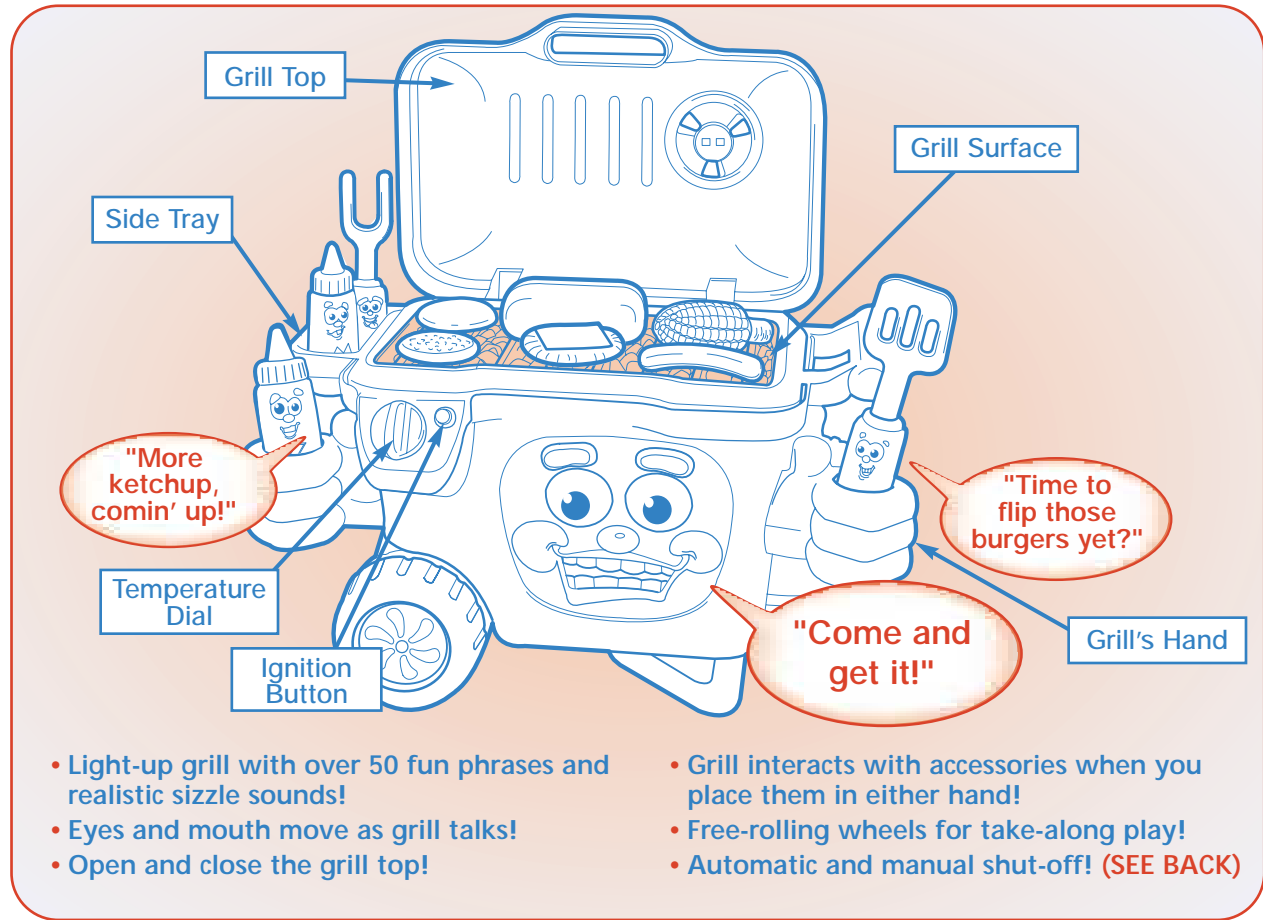

To Replace Batteries

Use a Phillips/cross head screwdriver to loosen screw in battery compartment door (screw remains attached to door). Remove door. Remove and discard old batteries. Replace with 3 x 1.5V "AA"/LR6 alkaline batteries. Replace door and tighten screw.

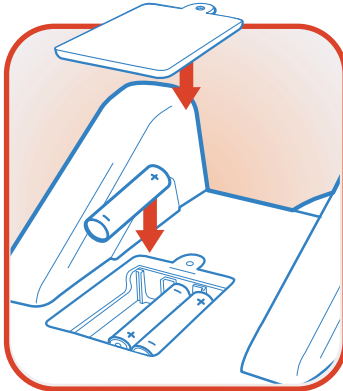

Note: Avoid exposure to water to prevent damaging sound electronics.

⚠ CAUTION: TO AVOID BATTERY LEAKAGE

- 1) Be sure to insert the batteries correctly and always follow the toy and battery manufacturers' instructions;
- 2) Do not mix old and new batteries or alkaline, standard (carbon-zinc) or rechargeable (nickel-cadmium) batteries;
- 3) Always remove weak or dead batteries from the product.

IMPORTANT: BATTERY INFORMATION

Please retain this information for future reference. Batteries should be replaced by an adult.

⚠ CAUTION:

1. Always follow the instructions carefully. Use only batteries specified and be sure to insert them correctly by matching the + and - polarity markings.
2. Do not mix old batteries and new batteries or standard (carbon-zinc) with alkaline batteries.
3. Remove exhausted or dead batteries from the product.
4. Remove batteries if product is not to be played with for a long time.
5. Do not short circuit the supply terminals.
6. Should this product cause, or be affected by, local electrical interference, move it away from other electrical equipment. Reset (switching off and back on again or removing and re-inserting batteries) if necessary.
7. RECHARGEABLE BATTERIES: Do not mix these with any other types of battery. Always remove from the product before recharging. Recharge batteries under adult supervision. DO NOT RECHARGE OTHER TYPES OF BATTERIES.

Free Manuals Download Website

<http://myh66.com>

<http://usermanuals.us>

<http://www.somanuals.com>

<http://www.4manuals.cc>

<http://www.manual-lib.com>

<http://www.404manual.com>

<http://www.luxmanual.com>

<http://aubethermostatmanual.com>

Golf course search by state

<http://golfingnear.com>

Email search by domain

<http://emailbydomain.com>

Auto manuals search

<http://auto.somanuals.com>

TV manuals search

<http://tv.somanuals.com>