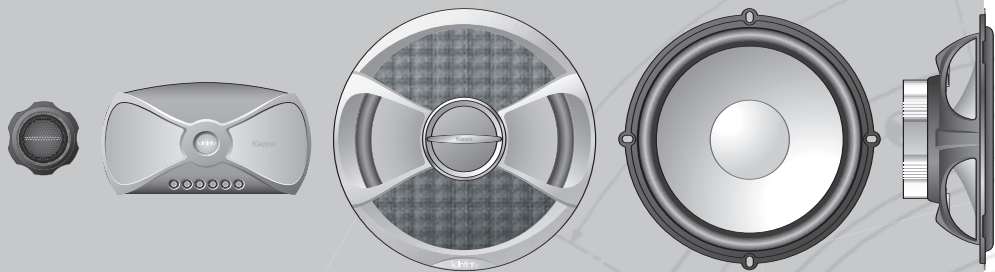


50.7cs, 60.7cs, 65.7cs, 680.7cs



 **Infinity**<sup>®</sup>

instructions

**kappa**<sup>®</sup> **series**

## INSTALLATION WARNINGS AND TIPS

**THANK YOU** for purchasing Infinity's Kappa® Series automotive loudspeaker components. We've organized this manual to make their installation as simple and trouble-free as possible. Please read it thoroughly before proceeding.

Remember to keep your sales receipt with this manual in a safe place so both are available for future reference.

### ABOUT THESE INSTRUCTIONS

Installation of automotive stereo components can require extensive experience with a variety of mechanical and electrical procedures. Although these instructions explain how to install Kappa Series Component Systems in a general sense, they do not show the exact installation methods for your particular vehicle. If you do not feel you have the experience, do not attempt the installation yourself, but instead ask your authorized Infinity car audio dealer about professional installation options.

### LOUD MUSIC AND HEARING

Playing loud music in an automobile can hinder your ability to hear traffic, as well as permanently damage your hearing. The maximum volume levels achievable with Infinity speakers, combined with high power amplification, may exceed safe levels for extended listening. We recommend using low volume levels when driving. Infinity accepts no liability for hearing loss, bodily injury, or property damage as a result of use or misuse of this product.

### REAR DECK PRECAUTION

In some cars, fuel tanks may be located directly beneath the rear deck. Before installation, make sure there is adequate speaker basket clearance before considering this location!

### ABOUT THE CONTENTS

The Kappa Component System includes:

- 5-1/4" or 6-1/2" or 165mm or 6" x 8" woofer
- Grille and mounting adaptor(s)
- 1" Tweeter with surface/flush I-Mount™ (patent no. 5,859,917) kits
- Crossover network with mounting screws

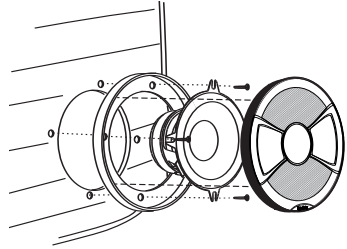
*Note: The supplied crossover network is optimized for each specific speaker system it is packaged with. Do not substitute another crossover network or use other speakers when connecting the system (see Figure 8A).*

### INSTALLATION TIPS

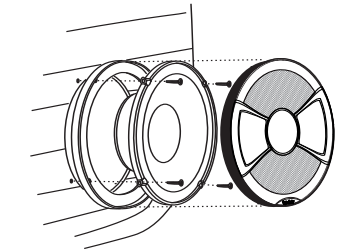
- Always wear protective eyewear when using any tools.
- Turn off all audio components and other electrical devices before you start. Disconnect the (-) negative lead from your vehicle's battery.
- Keep speakers in their package until final installation. When moving a speaker, always rest it with the cone or dome facing up. Never use force to install any speaker.
- Check clearances on both sides of a planned mounting surface before drilling any holes or installing any screws. Remember that the screws can extend behind the surface.
- At the installation sites, locate and make a note of all fuel lines, hydraulic brake lines, vacuum lines and electrical wiring. Use extreme caution when cutting or drilling in and around these areas.
- Before drilling or cutting holes, use a utility knife to remove unwanted fabric or vinyl, to keep material from snagging in a drill bit or saw.
- For door installations, check the clearance with the windows throughout the range of the window's travel, and verify that a mounted speaker will not interfere with the window crank or power window mechanism.
- If mounting speakers elsewhere, check for clearance around rear deck torsion bars, glove box or other structural elements.
- Do not mount speakers where they will get wet.
- If possible, select a mounting site for the crossover network that is near the speakers and provides easy access for connections.

## INSTALLATION

**Figure 1.** Mounting the 50.7cs woofer with the grille.



**Figure 2.** Mounting the 60.7cs woofer with the grille.



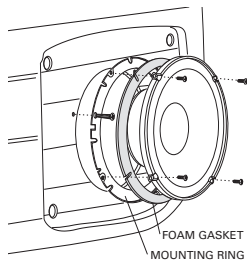
*Note: The 680.7cs is designed to replace 5" x 7" and 6" x 8" speakers installed behind existing vehicle grilles, and does not include grilles.*

## INSTALLATION

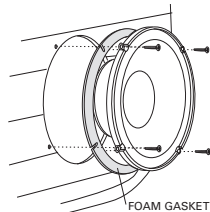
### INTERMOUNT III MOUNTING RINGS

The Kappa 60.7cs is packaged with two different speaker adaptor rings. The rings will allow the speakers to be installed into various factory 6" 6-1/2" and 6-3/4" openings. The metal ring can be mounted in many European vehicles, Japanese vehicles or vehicles with 6" speaker locations. The plastic ring can be mounted in many vehicles using 6-3/4" speaker locations or three-point mounting frames.

**Figure 3.** Mounting the 65.7cs in a 165mm speaker location using the supplied metal ring.

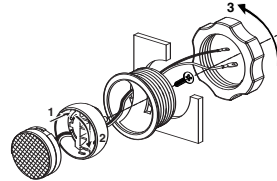


**Figure 4.** Mounting the 60.7cs woofer in a standard speaker location.



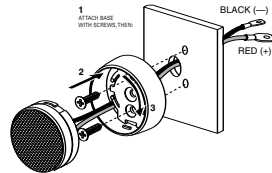
### FLUSH-MOUNT

**Figure 5A.** Mounting the tweeter using the I-Mount™ flush-mounting kit.



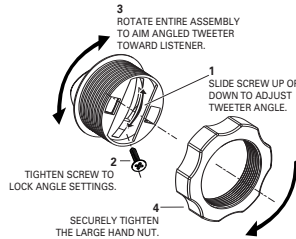
### SURFACE-MOUNT

**Figure 5B.** Mounting the tweeter using the I-Mount surface-mounting cup.



### TWEETER ANGLE

**Figure 6.** Aim the tweeter at the listening position by sliding the stud in the groove on the back of the tweeter cup and rotating the entire assembly in the mounting surface. Lock the tweeter in place, using the small retaining screw.

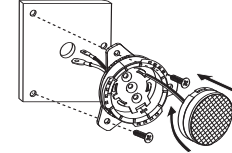


**Figures 7A through 7D.** The Starfish™ tweeter mount is intended to be used when the tweeter will be installed behind a factory grille (e.g., replacing the factory tweeter behind a door panel). The Starfish will allow you to mount the component tweeter directly to the panel itself or to the area behind the panel. The six mounting tabs can be removed easily to create a number of custom configurations.

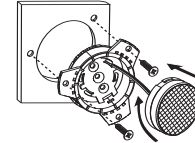
*Note: Check screw clearance before installing. Use glue if clearance is an issue.*

*Note: Not all possible mounting configurations are shown.*

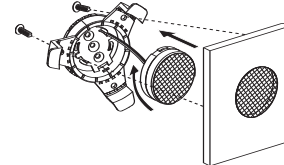
**Figure 7A.** Behind grille panel.



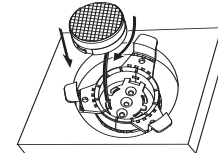
**Figure 7B.** Mounted to surface behind grille panel.



**Figure 7C.** Mounted to grille panel.



**Figure 7D.** In-dash location (may require gluing).



## INSTALLATION

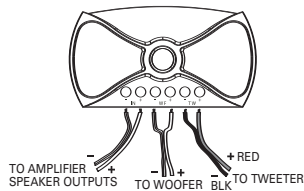
### MOUNTING THE CROSSOVER

Open the crossover housing by placing your fingers between the terminals and the top cover, and gently pulling off the cover. Using screws or a wire tie, mount the crossover through the holes provided.

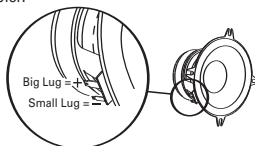
### CONNECTIONS

Observing proper polarity, connect the speakers and amplifier as shown in 8A and 8B. Replace the cover when you are finished making connections.

**Figure 8A.** Wiring connections on the crossover network (shown with cover on).

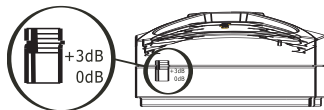


**Figure 8B.** Locating wiring connections on the woofer.



### TWEETER LEVEL ADJUSTMENT

Located on the right side of the crossover network is a small switch which controls the tweeter level. The upper position is +3dB and the lower position is 0dB. Adjust to personal preference.



### Declaration of Conformity



We, Harman Consumer Group International  
2, route de Tours  
72500 Chateau-du-Loir  
France

declare in own responsibility that the products described in this owner's manual are in compliance with technical standards:

EN 61000-6-3:2001  
EN 61000-6-1:2001

*Klaus Lebherz*  
Klaus Lebherz  
Harman Consumer Group International  
Chateau-du-Loir, France 2/05

## SPECIFICATIONS

### 50.7cs

Type: 5-1/4" 2-Way Component  
Crossover Frequency: 3.5kHz  
Woofer  
Speaker Impedance: 2 ohms  
Power Handling: 85W RMS, 255W Peak  
Sensitivity: 94dB @ 2.83V, 1m  
Frequency Response: 55Hz – 25kHz  
Mounting Depth: 2-1/16" (53mm)  
Cutout Diameter: 4-11/16" (120mm)  
Tweeter  
Speaker Impedance: 2 ohms  
Power Handling: 50W RMS, 150W Peak  
Sensitivity: 94dB @ 2.83V, 1m  
Frequency Response: 3.5kHz – 25kHz  
Mounting Depth: 3/4" (19mm)  
Cutout Diameter: 1-7/8" (48mm)

### 60.7cs

Type: 6-1/2" 2-Way Component  
Crossover Frequency: 3.5kHz  
Woofer  
Speaker Impedance: 2 ohms  
Power Handling: 90W RMS, 270W Peak  
Sensitivity: 95dB @ 2.83V, 1m  
Frequency Response: 45Hz – 25kHz  
Mounting Depth: 2-3/16" (56mm)  
Cutout Diameter: 5" (127mm)  
Tweeter  
Speaker Impedance: 2 ohms  
Power Handling: 50W RMS, 150W Peak  
Sensitivity: 94dB @ 2.83V, 1m  
Frequency Response: 3.5kHz – 25kHz  
Mounting Depth: 3/4" (19mm)  
Cutout Diameter: 1-7/8" (48mm)

### 65.7cs

Type: 165mm 2-Way Component  
Crossover Frequency: 3.5kHz  
Woofer  
Speaker Impedance: 2 ohms  
Power Handling: 90W RMS, 270W Peak  
Sensitivity: 95dB @ 2.83V, 1m  
Frequency Response: 45Hz – 25kHz  
Mounting Depth: 2-1/4" (58mm)  
Cutout Diameter: 5-5/8" (143mm)  
Tweeter  
Speaker Impedance: 2 ohms  
Power Handling: 50W RMS, 150W Peak  
Sensitivity: 94dB @ 2.83V, 1m  
Frequency Response: 3.5kHz – 25kHz  
Mounting Depth: 3/4" (19mm)  
Cutout Diameter: 1-7/8" (48mm)

### 680.7cs

Type: 6" x 8" 5" x 7"  
Crossover Frequency: 2-Way Component  
3.5kHz  
Woofer  
Speaker Impedance: 2 ohms  
Power Handling: 90W RMS, 270W Peak  
Sensitivity: 94dB @ 2.83V, 1m  
Frequency Response: 40Hz – 25kHz  
Mounting Depth: 2-1/4" (58mm)  
Cutout Diameter: 7-1/8" x 4-7/8" (181mm x 124mm)  
Tweeter  
Speaker Impedance: 2 ohms  
Power Handling: 50W RMS, 150W Peak  
Sensitivity: 94dB @ 2.83V, 1m  
Frequency Response: 3.5kHz – 25kHz  
Mounting Depth: 3/4" (19mm)  
Cutout Diameter: 1-7/8" (48mm)

**A valid serial number is required for warranty coverage.**

Features, specifications and appearance are subject to change without notice. Intermount III patent no. 6,505,705.



Infinity Systems, 250 Crossways Park Drive, Woodbury, NY 11797 USA  
516.674.4463 • FAX 516.682.3523 • www.infinitysystems.com  
© 2005 Harman International Industries, Incorporated • Part No. KAPCSOM2/05  
H A Harman International Company

## Free Manuals Download Website

<http://myh66.com>

<http://usermanuals.us>

<http://www.somanuals.com>

<http://www.4manuals.cc>

<http://www.manual-lib.com>

<http://www.404manual.com>

<http://www.luxmanual.com>

<http://aubethermostatmanual.com>

Golf course search by state

<http://golfingnear.com>

Email search by domain

<http://emailbydomain.com>

Auto manuals search

<http://auto.somanuals.com>

TV manuals search

<http://tv.somanuals.com>