

# 700XMALPIN

## XM Direct Satellite Radio Pkg for Alpine

700XMALPIN is a Package Item Number containing the following items:

209XMD1000 - XM Satellite XMD1000 Universal XM Satellite Radio

209XMDALP1 - XM Satellite XMDALP100 XMDirect Alpine Smart Digital Adapter

# SMART DIGITAL ADAPTER

## Installation Guide



XMDALP100

Smart Digital Adapter for Alpine Car Stereos

**TERK**®

# Introduction

## Smart Digital Adapter

Thank you for purchasing the TERK Smart Digital Adapter for XM ready Alpine car stereo head units. This product must be used in conjunction with the XM Universal Tuner Box (part # XMD1000) sold separately. The Smart Digital Adapter for Alpine allows you to adapt a satellite radio ready car stereo to receive XM Satellite Radio service.

Important Note::

The TERK Smart Digital Adapter for Alpine car stereo head units is compatible with most Alpine head units displaying the **(XM) READY** logo. For a complete compatibility list go online to [TERK.com/XMDirect](http://TERK.com/XMDirect)

The XMDALP100 is easy to install plugging directly into the XMD1000 and the Alpine car stereo head unit\*. No splicing or cutting of existing wiring within the vehicle is required. The illustration below shows the complete installation of the XM Direct system, including the XMDALP100 and the XMD1000 into your Alpine car stereo head unit.

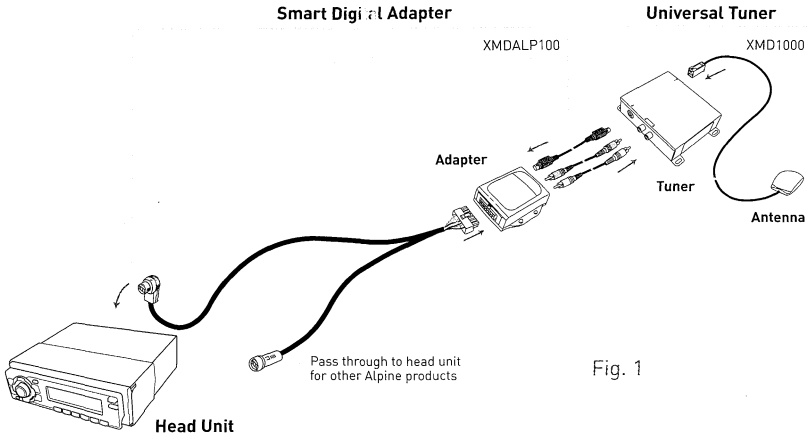

Fig. 1

\*IT IS RECOMMENDED THAT A PROFESSIONAL INSTALLER INSTALLS THE XM DIRECT SYSTEM (XMDALP100 AND XMD1000).

# Installation Overview

### Installation Basics::

When choosing a location to mount the components, care must be taken not to interfere with any of the vehicles existing systems. Good installation practices should be observed when mounting components to avoid any vibration, movement or rattling after installation. When routing the cables avoid blocked passages and any obstructions that could kink, crimp, twist, or chafe the cables. Components should be secured in place with methods such as Velcro, double stick foam tape, screws and nuts, cable ties etc. All mounting hardware and methods are at the discretion of the installer. Cables should also be secured in place to avoid movement. Care should be taken not to crimp any of the cables when installing them. And special care should be taken not to route cables on or near sharp edges that could eventually cut into the jacket of the cable.

### Installation Planning::

The XMDALP100 should be located within 2-3 feet of the XMD1000 due to the cable lengths. The antenna should be located in an area to insure the cable will reach the tuner location. Check this prior to installation. The installation guide supplied with your XM Universal Tuner and bundled antenna has additional information on antenna location and installation.

## Installation

Prior to installation, locate the area where the XM Universal Tuner Box is installed. Make sure you have followed the location requirements for the XM Universal Tuner prior to installing the Alpine Smart Digital Adapter.

### Step 1

Remove the Alpine car stereo head unit from your dash board.

Important: Depending on how your Alpine head unit was installed you may have to remove part or all of your dash board to remove the head unit before the Alpine head unit can be pulled out. You may also have to remove screws to complete this step.

### Step 2

Connect the red and white audio cables into the red and white connectors on the XM tuner box (XMD1000) as well as the black cable with straight connector. Plug the other end of these three cables into the top of the Alpine smart digital adapter as shown in Fig 2.

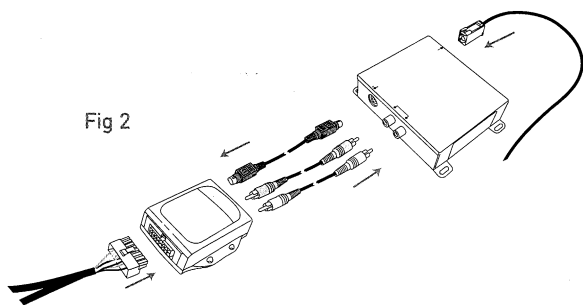

Note: Make sure all cables are connected securely.

### Step 3

Connect the remaining cable with the white rectangle connector into the bottom of the XMDALP100 as shown in Fig 2.

## Step 4

Take the end of the cable with the right angle connector and plug it into the back of the Alpine head unit as shown in Fig 3. The other end of the cable coming from the white rectangle connector is a pass through cable that can be used to connect other Alpine products to your Alpine head unit, i.e. CD changer.

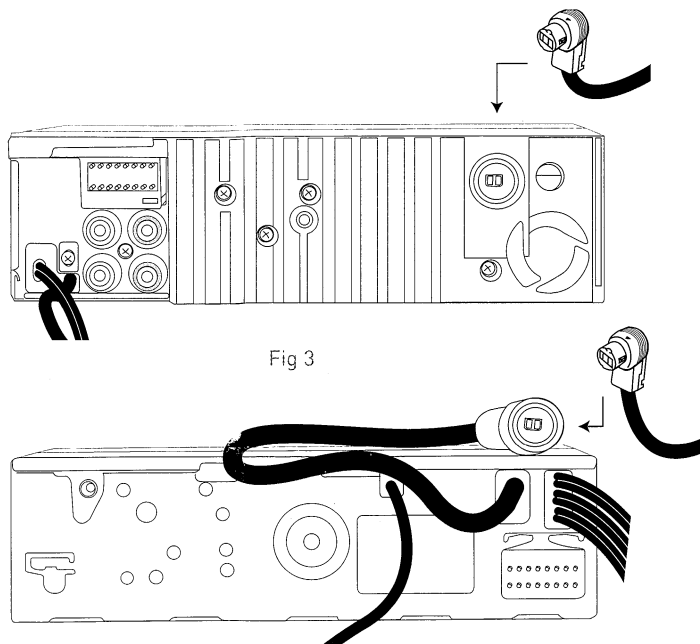

Note: The location of the connections on the Alpine head unit may vary depending on the Alpine model.

## Step 5

Start your car and turn on your Alpine head unit to confirm that the XM Direct system is properly connected. Please refer to your Alpine stereo owners manual on how to get into XM mode. When you tune to XM channel 1, you should see "XM Preview" on your Alpine head unit LCD, and hear that channel through your car speakers. If not, check to make sure all connections are correct or refer to the trouble shooting section of this installation guide.

# 4

## Step 6

Mount and secure the XMDALP100 in a suitable location that will not interfere with the radio and will not vibrate or rattle after installation.

## Installation (continued)

### Step 7

Return the Alpine car stereo head unit back to its original location in the dash board, be careful with cables that you just installed so that they do not unplug or get kinked by the head unit.

Note: If you had removed screws to pull the Alpine car stereo head unit out please screw those back in.

### Step 8

If you had removed the dash board during installation please return it back to its original location.

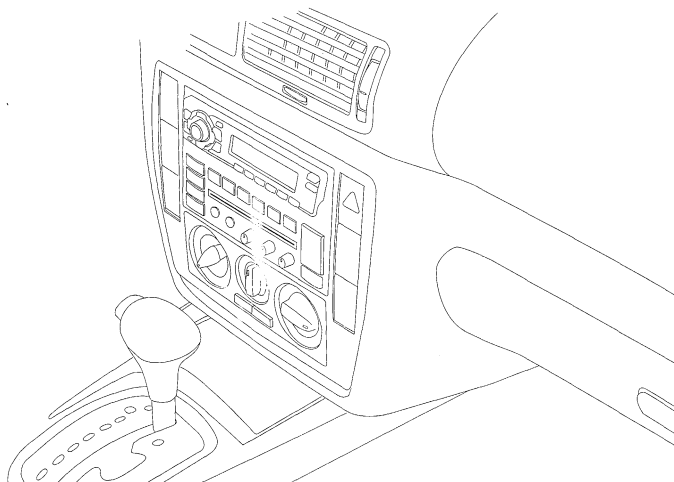

### Completing Activation::

Now that your XM Direct system has been installed your XM Universal Tuner will need to be activated. Tune your Alpine car stereo head unit to the XM Preview Channel, channel 1 and follow instructions for activation. You can also go on-line at [XMradio.com](http://XMradio.com) or call the toll free XM activation number at 1-800-852-9696.

### **XM SATELLITE RADIO OPERATION**

Please refer to the XM Radio Operation section of your Alpine owners manual.

# Troubleshooting

## ANTENNA

The XM antenna is not connected to the XM tuner.

- Check whether the XM antenna cable is attached securely.

## UPDATING

Radio is being updated with latest encryption code.

- Wait until encryption code has updated. Channels 0 and 1 should function normally.

## NO SIGNAL

XM signal is too weak or blocked at the current location.

- Wait until the car reaches a location with a stronger signal or
- Wait until the car is in an area that has a clear view of the open sky.

## LOADING

Radio is acquiring audio or program information.

- Wait until the radio has received the information.

## OFF AIR

The channel currently selected has stopped broadcasting.

- Select another channel.

“----” or “-----”

The user has selected a Channel Number that does not exist or is not subscribed to.

- The unit will revert back to the previously selected channel. or

There is no artist name/feature, song/program title, or additional information associated with the channel at that time.

- No action needed.



# Limited Warranty

---

TERK Technologies Corp. (TERK) warrants this product against defects in materials or workmanship for one (1) year from the date of purchase. During this warranty period, this product will be replaced without charge. This warranty does not cover any damage due to acts of nature, commercial use, accident, misuse, abuse or negligence. This warranty is only valid in the USA. Replacement as provided under this warranty is the exclusive remedy of the consumer. TERK shall not be liable for any incidental or consequential damages for breach of any express or implied warranty on this product, except to the extent that limitations of this sort are prohibited by applicable law. THERE ARE NO IMPLIED WARRANTIES OF MERCHANTABILITY OR FITNESS FOR A PARTICULAR PURCHASE EXCEPT TO THE EXTENT THAT IMPLIED WARRANTIES OF EITHER SORT ARE REQUIRED BY APPLICABLE LAW, AND IN SUCH CASE, EACH WARRANTY IS LIMITED IN DURATION TO ONE YEAR.

---

**For additional information: call 1.800.942.TERK (8375)  
or visit [www.terk.com](http://www.terk.com).**

**For more information about XM Satellite Radio service, visit [www.xmradio.com](http://www.xmradio.com) or call  
1-800-852-9696.**

405P006

The XM name and related logos are trademarks of XM Satellite Radio Inc.

TERK is a registered trademark. The TERK logo is a trademark of the TERK Technologies Corp

XMDALP100

**XMDirect™**

**TERK**



## Smart Digital Adapter for Alpine Satellite Radio Ready Car Stereo Head Units

Requires XMDirect™ Universal Tuner Box (Sold Separately)

- ▶ Direct connect for true digital sound quality
- ▶ Control XM channels with your Alpine car stereo using the same buttons, knobs and display
- ▶ Completely hidden installation

### ALPINE

CDA-7892	CDA-9805	CDA-9826	CVA-1003
CDA-7893	CDA-9807	CDA-9827	CVA-1004
CDA-7894	CDA-9811	CDA-9830	DVA-7996
CDA-7897	CDA-9813	CDA-9831	IVA-D300
CDA-7995	CDA-9815	CDA-9833	IVA-D900
CDA-7998	CDA-9825	CDA-9835	IVA-D901



If your head unit model number is not listed, use the XMCommander

Download from [www.Somanuals.com](http://www.Somanuals.com). All Manuals Search And Download.



Integrates with your  
existing Alpine car stereo  
for an installation that's  
as easy as:

- 1 Connect the Smart Digital Adapter to your Alpine car stereo
- 2 Connect the Universal Tuner Box to the Smart Digital Adapter
- 3 Connect the Magnetic Roof-mount Antenna to the Universal Tuner Box



For more information about the XMDirect™ Smart Digital Adapter, visit [www.terk.com](http://www.terk.com), or call technical support 1.800.942.TERK (8375)

For more information about XM Satellite Radio service, visit [www.xmradio.com](http://www.xmradio.com)

XMDirect Smart Digital Adapter requires the separate purchase of an XMDirect Universal Tuner Box. Hardware and required basic monthly subscription sold separately. Other fees and taxes, including a one-time activation fee may apply. Subscription fee is consumer only. Reception of the XM signal may vary depending on location. All fees and programming subject to change. Subscriptions subject to Customer Agreement, included with the XM Welcome Kit and available at [xmradio.com](http://xmradio.com). Only available in the 48 contiguous United States. ©2004 TERK Technologies Corp. TERK and TERK Technologies are trademarks of TERK Technologies Corp. Commack, NY. All rights reserved. XM Satellite Radio Inc. XMDirect™ is a trademark of XM Satellite Radio Inc. All other trademarks are the property of their respective owners.

XMDALP100

One year limited warranty  
Made in China

405P008



12T04



## XMDALP100 Tech Bulletin

The current XMDALP100 that is on shelves at retail has an application guide on the front of the package with 2003 and 2004 Alpine head unit models. These units are **NOT** compatible with the Alpine 2005 head unit models listed below:

*CDA-9847 CDA-9851 CDA-9853 CDA-9855 CVA-1014 DVA-9860 IVA-D310*

The packaging for this SKU works with 2003 and 2004 models and looks like this:



There are 10K units of the XMDALP100 with a small update in the software which now makes it compatible with the following 2005 Alpine head units:

*CDA-9847 CDA-9851 CDA-9853 CDA-9855 CVA-1014 DVA-9860 IVA-D310*

There will **not** be a change in the part number or the UPC code, they will stay the same on the XMDALP100. There will be a black and orange label on the front of the package that states this unit is now compatible with the above 2005 Alpine head units. This sku will work with 2003, 2004 and 2005 models and looks like the following.



In summary, The XMDALP100 will only work with the 2005 Alpine models if the XMDALP100 has the 2005 label on the front of the package. If the XMDALP100 does not have the 2005 label then it will not work with the 2005 models. All XMDALP100 orders will ship with the 2005 label going forward.

# Direct™

## Installation Guide

XM-RVR-D-002

---

### Package Contents



Antenna

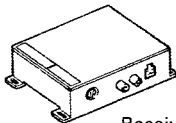

Receiver

## Important!

- This XM Receiver is designed to be use in automobiles with 12V battery and negative grounding. Before installing in any vehicle, ensure that the battery voltage is proper.
- Before installing this system, be sure to disconnect the “negative” battery cable to avoid short circuits.
- Refer to the vehicle’s Owner’s Manual for details on connecting power amplifiers and other units before proceeding to make connections.
- Secure all wiring with appropriate clamps and/or adhesive electrical tape. To protect wires, wrap adhesive electrical tape around them where they contact any surface.
- Route and secure all wiring so it is free and clear of all moving parts such as gear shifts, pedals, hand brake and seat rails. Keep all wiring free and clear of any areas prone to excessive heat. Damaged wiring (ruptured insulation) can cause a short circuit if it contacts the vehicle body.
- **DO NOT** shorten any leads. Shortening leads may prevent the proper functioning of the protection circuit.
- Never feed power to other units by stripping the insulation of the power supply lead and tapping into it with another unit’s lead. This will exceed the unit’s current capacity and cause the unit to overheat.
- If replacing a fuse, be sure to use only the fuse specified inside the fuse holder.

**!WARNING:** Professional Installation Recommended. Failure to properly follow all installation instructions may result in personal injury or damage to your XMDIRECT, your vehicle or your vehicle A/V system.

# Antenna Installation

## Where to locate:

- Best reception is achieved with the antenna mounted on the metal surface of the vehicle roof in the center of an area with at least 12" x 12" of surface area and a minimum of 6" from a window or sunroof.
- If the vehicle has roof racks or skid ribs, it may be necessary to mount the antenna off-center.
- If the vehicle roof does not provide sufficient metal surface area then the antenna can be mounted on the metal trunk lid at least 4" from the rear window.
- CAUTION: DO NOT INSTALL ANTENNA INSIDE VEHICLE PASSENGER COMPARTMENT. Mounting the antenna in the passenger compartment either on the front dash board or on the rear window deck area of the vehicle may interfere with reception and must be avoided.
- CAUTION: Mounting the antenna on a non-metallic surface will also result in severe degradation in reception.
- If an appropriate antenna mounting location cannot be identified, contact your local distributor installation department for additional guidance.

## Cable routing:

- Once you have mounted the antenna in the correct location, plan how to route the cable from this location to the receiver, avoiding blocked passages and any obstructions that could kink, crimp, twist or chafe the cable. If the cable will come into contact with a rough metal opening, use a rubber grommet to prevent damage.



- For antenna mounting locations at the front or middle of the roof, the cable can be routed down along the door jam and into the car. In some cars, the cable may be brought into the vehicle through the grommet in the door jam which carries the power window and power lock wires. If the cable does not fit easily through this grommet, do not try to force it through. Instead, route the cable under the weather seal near the bottom of the door.
- For antenna mounting locations at the rear of the roof, the antenna cable can be routed into the vehicle through the trunk. Always route the cable under the weather seal near the lowest part of the trunk to reduce possible water leaks.
- Use pre-existing wiring channels created by the vehicle manufacturer whenever possible.

**Tools Required:**

- The antenna contains a powerful magnet that will secure it to a metal roof under normal driving conditions. No additional tools should be necessary to mount the antenna.

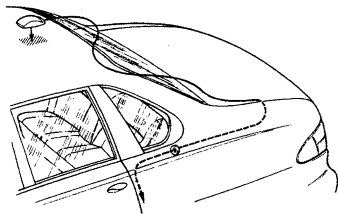
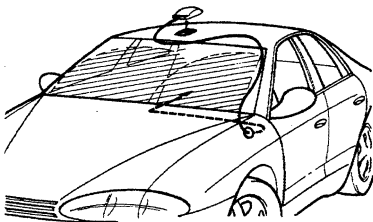

## Receiver Installation

### Notes:

- Locate the unit in an area of the vehicle where it will not obstruct the driver's operation of the vehicle and where it will not pose a risk to driver or passenger in the event of an emergency stop.
- When Mounting the Receiver, ensure that all wires and cables are free of crimps and kinks and are not trapped between the unit and the mounting surface.
- Do not locate the unit in close proximity to the automobile heater or any heating vents.
- Locate the unit where it will remain shielded from rainwater.
- Before drilling any holes for mounting, be sure to check the surface behind the mounting surface to be sure it is clear of obstruction and no critical automobile systems will be damaged such as break lines, electrical wiring, etc.
- Ensure that the unit is securely mounted and will not shift during vehicle motion.
- Before final installation of the unit, make all system connections temporarily and test the system for proper functioning.

**!WARNING:** Use only the parts supplied with this unit for installation. Use of other components may cause system malfunction and may void the product warranty.

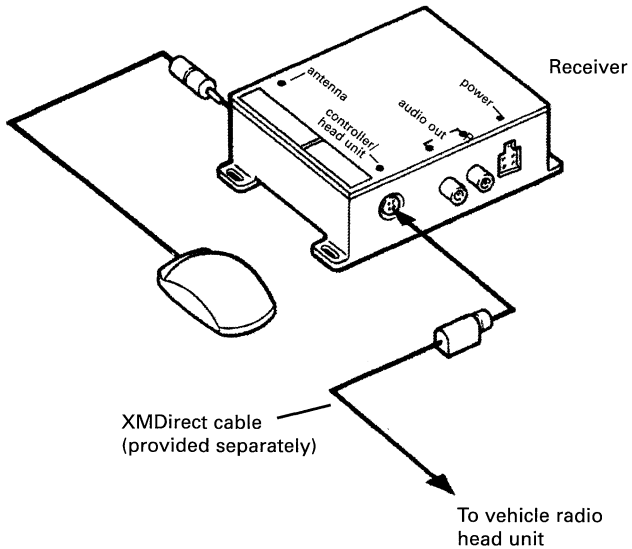

# Warranty

**1. Warranty Statement** — This express warranty is extended by XM Satellite Radio Inc., a Delaware corporation having its principal office at 1500 Eckington Place N.E., Washington, DC 20002 (“XM”) to the original end user purchaser. XM warrants the XMDirect (“Product”) to be free of defects in material and workmanship for a limited period of one (1) year from the date of sale to the original end user purchaser, subject to the following conditions herein.

**2. General Provisions** — This warranty sets forth the full extent of XM’s responsibilities and consumer’s exclusive remedy regarding the Product. XM will, as its sole obligation under this warranty, replace any Product that does not conform to this warranty. Such replacement unit may include factory rebuilt or refurbished parts. For further information concerning this warranty and return details, please visit the following website: <http://xmdirect.xmradio.com>.

THIS WARRANTY IS GIVEN IN LIEU OF ALL OTHER EXPRESS WARRANTIES. IMPLIED WARRANTIES, INCLUDING WITHOUT LIMITATION, IMPLIED WARRANTIES OF MERCHANTABILITY AND FITNESS FOR A PARTICULAR PURPOSE, ARE LIMITED TO THE WARRANTY PERIOD SET FORTH IN THE LIMITED WARRANTY BELOW. IN NO EVENT SHALL XM BE LIABLE FOR DAMAGES IN EXCESS OF THE PURCHASE PRICE OF THE PRODUCT, FOR ANY LOSS OF USE, LOSS OF TIME, INCONVENIENCE, COMMERCIAL LOSS, LOST PROFITS OR SAVINGS OR OTHER INCIDENTAL, SPECIAL OR CONSEQUENTIAL DAMAGES ARISING OUT OF THE USE OR INABILITY TO USE SUCH PRODUCT, TO THE FULL EXTENT AS MAY BE DISCLAIMED BY LAW. THIS WARRANTY IS NOT TRANSFERABLE AND APPLIES ONLY TO THE ORIGINAL CONSUMER PURCHASER OF THE PRODUCT.

**3. One (1) Year Standard Limited Warranty** — This product is shipped from the factory with a standard limited warranty of one (1) year on parts and labor from the date of purchase by the original end user purchaser, based on proof of purchase receipt. In the event of a defect, malfunction, or failure to conform to specifications during the warranty period, XM will replace the Product (replacements available through the distributor/dealer where the Product was purchased, only if all component parts and original packaging and manual are returned). This warranty excludes dealership labor and/or installation costs and does not cover defects, malfunctions, performance failures or damages to the product resulting from use in other than its normal and customary manner, misuse, accident or neglect, the use of non-conforming parts, failure to properly follow the Installation Guide, or alterations or repairs not authorized by XM.

**4. Voiding of Warranty** — This warranty will be VOID if a Product is received by XM for replacement and: (a) is incomplete (i.e., boards or components are missing), or does not include all original packaging and user manual; (b) has been opened by, or has had work performed by, anyone other than a XM Satellite Radio authorized service provider; (c) has non-conforming or non-XM-approved housing or parts.

**5. How to Receive Warranty Service** — To obtain warranty service you must return the defective Product with a copy of the original dated sales receipt to the distributor/dealer where the Product was purchased, along with all component parts and original packaging, including user manual.

**6. State Law Rights** — Some states do not allow the exclusion or limitation of incidental or consequential damages, or limitation on how long an implied warranty lasts. Therefore the above limitations or exclusions may not apply. This warranty gives you specific legal rights and you may also have other rights which vary from state to state.

# Technical

## Product Technical Information

- Dimensions..... 95 mm W x 110.5 mm H x 32.5 mm D
- Weight..... 12.7 oz

## Inputs/Outputs

- Antenna: 1 RF SMB Connector
- Power: P13 connector, 12V DC, 500 mA maximum
- Audio Output: 3.5 mm diameter ministereero jack

## Care of the Device

(Failure to follow these instructions may result in personal injury or damage to your XMDIRECT, vehicle or A/V system)

- Use only a soft, dry cloth to clean the outside of the device and any accessories
- Do not use any solvents, chemicals or cleaning solutions containing alcohol, ammonia or abrasives
- Do not allow liquids to spill on the unit
- Do not use sprays near the device
- Keep the XMDIRECT device out of direct sunlight or other sources of extreme heat
- Avoid placing the XMDIRECT in a setting where air cannot circulate around the unit

## **Repair**

Contact your distributor for information on replacement.

## **Contact XM**

- Activations: 1-800-852-9696
- Listener Care: 1-800-852-9696
- On the web: [www.xmradio.com](http://www.xmradio.com)
- By Mail: XM Satellite Radio, Inc.  
1500 Eckington Place, N.E.  
Washington, DC 20002

**!CAUTION:** Connect only appropriate input devices to the XMDIRECT device. Connecting an incorrect input device may damage the system and/or the external electronic device. It is recommended that you use only the A/C Power Adaptor that came with your XMDIRECT kit.

**Note:** Wires and leads for this product may be different colors from those supplied with other manufacturer's systems, even though they serve the same function. When connecting this product to any other product, refer to the supplied Installation Manuals of both products and connect only those wires or leads that have similar function.

Hardware and required basic monthly subscription sold separately. Premium Channel available for additional monthly fee. Other fees and taxes, including a one-time activation fee may apply. Subscription fee is consumer only. Reception of the XM signal may vary depending on location. All fees and programming subject to change. Subscriptions subject to Customer Agreement included with the XM Welcome Kit and available at [xmradio.com](http://xmradio.com). Only available in the 48 contiguous United States. ©2003 XM Satellite Radio Inc. XMDirect is a trademark of XM Satellite Radio Inc. All rights reserved. All other trademarks registered are the property of their respective owners.

# XM 101 Channel Guide.



## DECADES 8 Channels

- 4 Big Band/Swing/Forties
- 5 Fifties
- 6 Sixties
- 7 Seventies
- 8 Eighties
- 9 Nineties

## COUNTRY 8 Channels

- 10 Classic Country
- 11 Top Country Hits
- 12 Progressive Country
- 13 Traditional Country
- 14 Bluegrass
- 15 Folk

## HITS 11 Channels

- 20 Top 20 Hits
- 21 LA Rock
- 22 Pop Mix
- 23 Love Songs
- 24 Beautiful Music
- 25 MTV
- 26 VH1
- 27 Movie Soundtracks
- 28 Show Tunes
- 29 Euro & Global Chart Hits
- 30 Special Topics

## CHRISTIAN 2 Channels

- 31 Christian Rock
- 32 Christian Pop

## ROCK 12 Channels

- 40 Deep Album Rock
- 41 Hard Rock
- 42 Heavy Rock ■
- 43 New Music
- 44 Classic Alternative
- 45 Modern/Soft Alternative
- 46 Classic Rock
- 47 Alternative Hits ■
- 48 Hard Alternative ■
- 50 Acoustic Rock
- 51 Progressive Fusion
- 52 Unsigned Artists

## URBAN 8 Channels

- 60 Classic Soul
- 61 Neo Soul
- 62 Urban Adult
- 63 Gospel
- 64 Old School R&B
- 65 Classic Rap ■
- 66 Uncut Hip Hop ■
- 67 Urban Top 40

## JAZZ & BLUES 7 Channels

- 70 Traditional Jazz
- 71 Contemporary Jazz
- 72 Modern Jazz
- 73 Great Vocals/Standards
- 74 Blues
- 75 Latin Jazz
- 76 Cocktail Mix

## DANCE 4 Channels

- 80 Underground Dance
- 81 Club Hits
- 82 Electronica
- 83 Disco

## LATIN 5 Channels

- 90 Spanish Top 40
- 91 Spanish Pop Hits
- 92 Rock in Spanish
- 93 Tejano
- 94 Caribbean

## WORLD 5 Channels

- 100 World
- 101 Reggae
- 102 African
- 103 New Age
- 104 Eclectic

## CLASSICAL 3 Channels

- 110 Traditional Classical
- 112 Opera/Classical Vocals
- 113 Popular Classical

## KIDS 2 Channels

- 115 Radio Disney
- 116 Children

## NEWS 11 Channels

- 121 FOX News
- 122 CNN
- 123 CNN Headline News
- 124 ABC News & Talk
- 125 The Weather Channel

## NEWS 11 Channels *continued*

- 127 CNBC
- 129 Bloomberg Radio
- 130 C-Net Radio
- 131 BBC World Service
- 132 C-SPAN
- 134 CNN in Español

## SPORTS 5 Channels

- 140 ESPN Radio
- 141 ESPNews
- 142 FOX Sports Radio
- 143 Sporting News Radio
- 144 NASCAR Racing

## COMEDY 3 Channels

- 150 Comedy ■
- 151 Family Comedy
- 152 Radio Crazies ■

## TALK & VARIETY 10 Channels

- 161 Discovery Channel Radio
- 162 El Entertainment
- 163 Books & Drama
- 164 Old Time Radio
- 165 Experts & Advice
- 166 Talk & Opinion
- 168 Concerts/Interviews
- 169 African American Talk
- 170 Christian Talk
- 171 Truckers' Channel

## PREMIUM Additional Fee Required

- 205 Adult ■

XM Previews on Channel 1. Channels in Red are Commercial Free. Premium Channel available with basic XM subscription for an additional monthly fee. ■ May include frequent explicit language. Please call XM Listener Care at 1-800-852-9995 for Parental Control Option. Programming subject to change.

Download from [www.Somanuals.com](http://www.Somanuals.com) All Manuals Search And Download.



XMD1000

XMDirect



SATELLITE  
RADIO

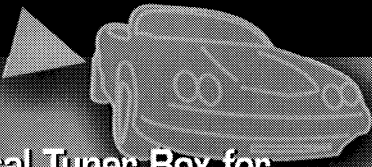

## Universal Tuner Box for Satellite Radio Ready Car Stereos

- ▶ Enables Satellite Radio Ready car stereos to receive 100 XM channels
- ▶ Direct connection for true digital sound — The best sound quality in satellite radio
- ▶ Hide-away tuner box integrates seamlessly with your car stereo — behind-dash installation optional
- ▶ Ultra-thin Micro Antenna requires no drilling



Requires XMDirect Smart Digital Adaptor (sold separately)

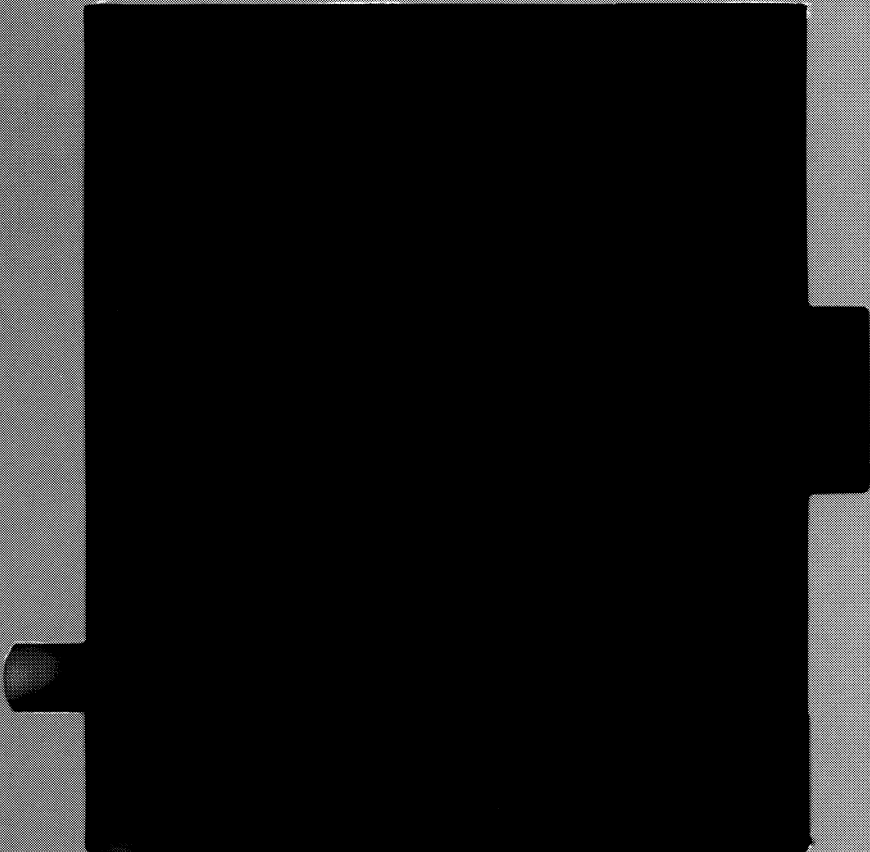

**XMDirect**



**SATELLITE  
RADIO**



XMDirect™ is a revolutionary universal tuner that can be connected to a Satellite Radio Ready car stereo to enable it to receive 100 XM channels of Music, News, Sports and Entertainment. A direct, digital connection ensures true digital sound. The XMDirect "black box" connects to a wide range of aftermarket and factory-installed stereos via a growing lineup of Smart Digital Adaptors (sold separately). XMDirect provides seamless integration with your existing car stereo. Install the "black box" behind the dashboard, connect to your car stereo via the Smart Digital Adaptor and place the Micro Antenna on the roof of your vehicle. Use your existing stereo controls to select XM channels. XMDirect...the "Black Box" that Rocks!

**Radio ID**



**XM Satellite Radio**  
Washington, D.C. 20002 USA  
xmradio.com  
Made in Malaysia

XM Direct requires the separate purchase of an XM Direct Smart Digital Adaptor. XM Direct Smart Digital Adaptors may not be available for all car stereo types and models. Features and required basic monthly subscription vary by region and separately. Premium Channel available for additional monthly fee. Other fees and taxes, including a one-time activation fee, may apply. Subscription fee is irrevocable. Reception of the XM signal may vary depending on location. All fees and programming subject to change. Subscriptions subject to Customer Agreement included with the XM Satellite Kit and available at xmradio.com. Only available in the 48 contiguous United States. ©2004 XM Satellite Radio Inc. XM Direct is a trademark of XM Satellite Radio Inc. All rights reserved. All other trademarks are the property of their respective owners.

## Free Manuals Download Website

<http://myh66.com>

<http://usermanuals.us>

<http://www.somanuals.com>

<http://www.4manuals.cc>

<http://www.manual-lib.com>

<http://www.404manual.com>

<http://www.luxmanual.com>

<http://aubethermostatmanual.com>

Golf course search by state

<http://golfingnear.com>

Email search by domain

<http://emailbydomain.com>

Auto manuals search

<http://auto.somanuals.com>

TV manuals search

<http://tv.somanuals.com>