



## Compact Mechanical Keyboard



Model: MKB-125B

# QuickGuide

English

www.adesso.com

①

### LIMITED WARRANTY

ADESSO provides one year limited warranty for the quality of all its products in materials and workmanship.

During this period, ADESSO will repair or replace all merchandise, which proved to be defective. However, ADESSO will not warranty any product which has been subjected to improper freight Handling, shipping abuse, neglect or unauthorized repair or installation. The warranty also will not cover products installed with Non-ADESSO components and product with broken sealed and assembly trace. After replacement of RMA, ADESSO reserves the right to request the total cost of the replacement products with broken seals or assembly trace.

If you discover a defect, Adesso will, at its option, repair or replace the product at no charge to you, provided you return it during the warranty period with transportation charges pre-paid to Adesso. You must contact Adesso at [support@adesso.com](mailto:support@adesso.com) for a Return Merchandise Authorization number (RMA) prior to returning any product. For each product returned for warranty service, please include your name, shipping address (no P.O. Box), telephone number, copy of the bill of sale as proof of purchase and have the package clearly marked with your RMA number.

### SUPPORT

We have listed most of our FAQ's (Frequently Asked Questions) at: <http://www.adesso.com/faqs.asp>. Please visit our FAQ Service & Support pages before you contact our E-mail or Telephone Support.

**Email Support:** If our FAQ's do not help you resolve your issues, please email [support@adesso.com](mailto:support@adesso.com)

**Telephone Support:**  
Toll Free: (800) 795-6788  
9:00AM to 5:00PM PST Monday - Friday

②

### INTRODUCTION

Adesso's mechanical switches provide instant sound feedback due to the clicking heard with each keystroke. It is this tactile and audible response in typing that improves accuracy, productivity and efficiency. Fast typists and gamers will be delighted to use this mechanical key switch keyboard.

### FEATURES

- Compact size featuring 104 keys
- Lifecycle of 20 million mechanical keystrokes
- Connection: USB or PS/2 port
- Storage temperature: -4°F to 140°F
- Operating temperature: 32°F to 122°F
- Dimensions: 16" x 7.25" x 1.25"
- Weight: 2.5 lbs.
- Cable length: 6 feet
- Approvals: FCC, CE and ROHS

### REQUIREMENTS

- Hardware: IBM, Pentium II class compatible or higher
- Operating system: Windows 7, Vista, XP and below
- Available USB or PS/2 port

③

### INSTALLATION

1. Make sure that your computer is turned OFF before installing this keyboard. Your wired mini keyboard requires either a USB or PS/2 port.

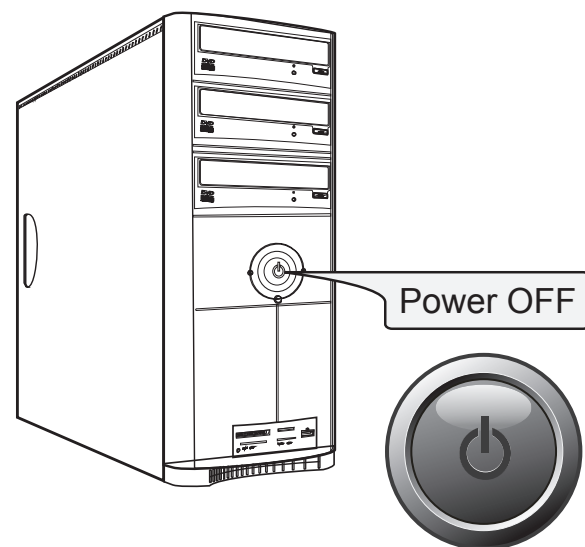

④

2. **FOR USB CONNECTION:**  
Plug in the USB cable to the USB port.

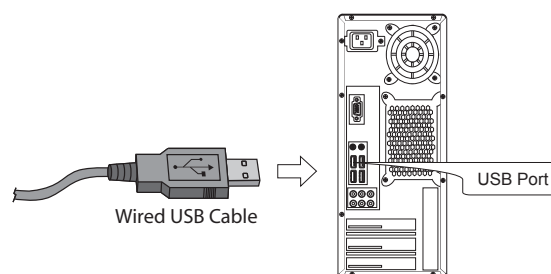

- FOR PS/2 CONNECTION:**  
Connect the USB to PS/2 adaptor with the USB cable and plug it into the computer's PS/2 keyboard port.

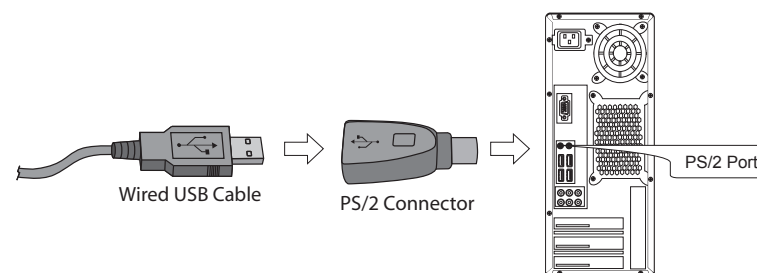

⑤

3. Turn On your computer and your operating system will detect the device automatically. This device is plug and play, no driver required.

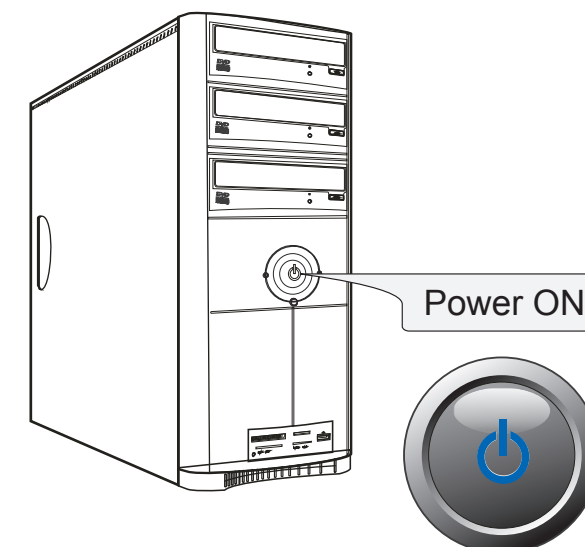

⑥

## Free Manuals Download Website

<http://myh66.com>

<http://usermanuals.us>

<http://www.somanuals.com>

<http://www.4manuals.cc>

<http://www.manual-lib.com>

<http://www.404manual.com>

<http://www.luxmanual.com>

<http://aubethermostatmanual.com>

Golf course search by state

<http://golfingnear.com>

Email search by domain

<http://emailbydomain.com>

Auto manuals search

<http://auto.somanuals.com>

TV manuals search

<http://tv.somanuals.com>