



# Waterproof Mini Flex Keyboard



Model: AKB-210



## QuickGuide English

①

### LIMITED WARRANTY

ADESSO provides one year limited warranty for the quality of all its products in materials and workmanship.

During this period, ADESSO will repair or replace all merchandise, which proved to be defective. However, ADESSO will not warranty any product which has been subjected to improper freight Handling, shipping abuse, neglect or unauthorized repair or installation. The warranty also will not cover products installed with Non-ADESSO components and product with broken sealed and assembly trace. After replacement of RMA, ADESSO reserves the right to request the total cost of the replacement products with broken seals or assembly trace.

If you discover a defect, Adesso will, at its option, repair or replace the product at no charge to you, provided you return it during the warranty period with transportation charges pre-paid to Adesso. You must contact Adesso at support@adesso.com for a Return Merchandise Authorization number (RMA) prior to returning any product. For each product returned for warranty service, please include your name, shipping address (no P.O. Box), telephone number, copy of the bill of sale as proof of purchase and have the package clearly marked with your RMA number.

### SUPPORT

We have listed most of our FAQ's (Frequently Asked Questions) at: <http://www.adesso.com/faqs.asp>. Please visit our FAQ Service & Support pages before you contact our E-mail or Telephone Support.

**Email Support:** If our FAQ's do not help you resolve your issues, please email [support@adesso.com](mailto:support@adesso.com)

**Telephone Support:**  
Toll Free: (800) 795-6788  
9:00AM to 5:00PM PST Monday - Friday

②

### INTRODUCTION

Adesso is proud to introduce its new and improved, Waterproof Mini Flex Keyboard. This revolutionary keyboard is water resistant, flexible, and dust and contaminant proof. The keyboard is great for use in industrial environments, hospitals, libraries, and marine and boating applications. In fact, almost anywhere dust and liquids are present! The silicon-based material is resistant to almost anything!

The flat, comfortable design offers easy typing, which eliminates negative-angle stress to your wrists. Its improved raised keys provide better tactile feedback than previous flexible designs.

### FEATURES

- LED lights for Caps Lock
- Key Layout: 85 Keys
- Dimensions: 13.7" x 5.3" x 0.5"
- Weight: 7 oz
- Temperature Range: 32 °F to 175 °F
- Approvals: FCC, CE and ROHS

### REQUIREMENTS

- Hardware: IBM, Pentium II class compatible or higher
- Operating system: Windows 7, Vista, XP and below
- Available USB or PS/2 port

③

### INSTALLATION

1. Make sure that your computer is turned OFF before installing this keyboard. Your wired keyboard requires either a USB or PS/2 port.

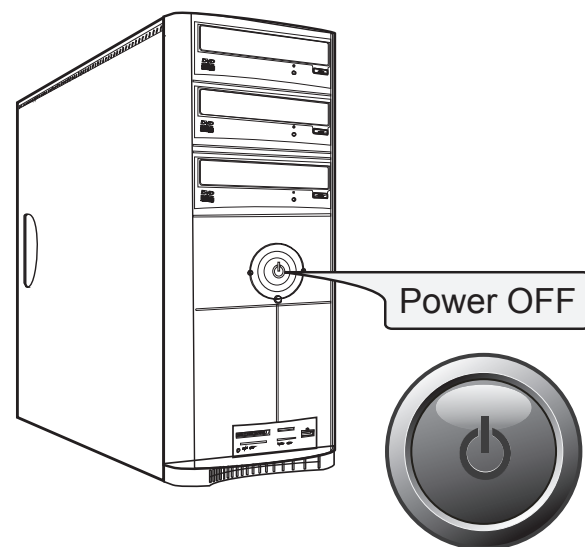

④

#### 2. FOR USB CONNECTION:

Plug in the USB cable to the USB port.

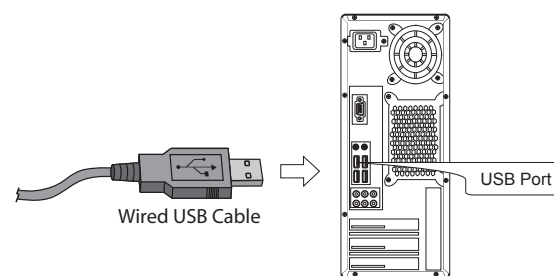

#### FOR PS/2 CONNECTION:

Connect the USB to PS/2 adaptor with the USB cable and plug it into the computer's PS/2 keyboard port.

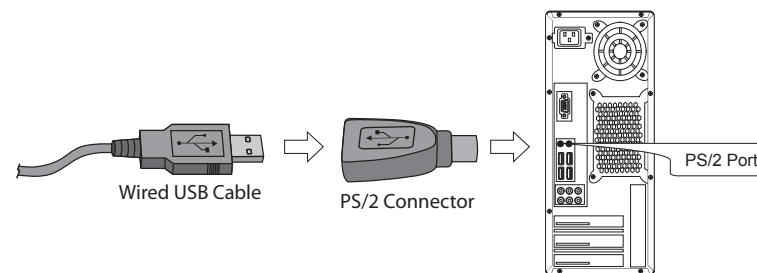

⑤

3. Turn On your computer and your operating system will detect the device automatically. This device is plug and play, no driver required.

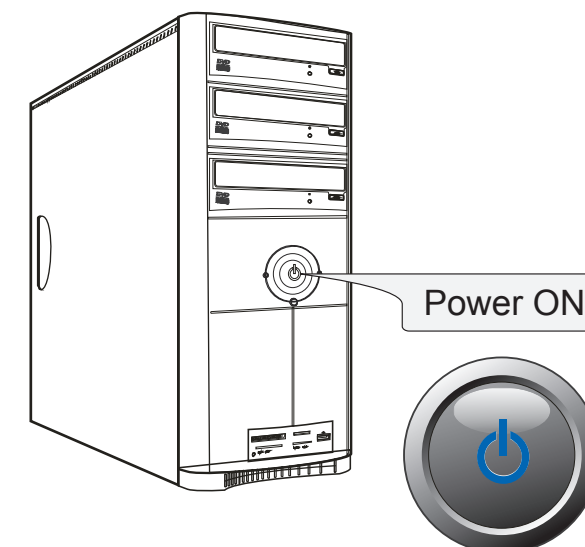

V2.1 122909

⑥

## Free Manuals Download Website

<http://myh66.com>

<http://usermanuals.us>

<http://www.somanuals.com>

<http://www.4manuals.cc>

<http://www.manual-lib.com>

<http://www.404manual.com>

<http://www.luxmanual.com>

<http://aubethermostatmanual.com>

Golf course search by state

<http://golfingnear.com>

Email search by domain

<http://emailbydomain.com>

Auto manuals search

<http://auto.somanuals.com>

TV manuals search

<http://tv.somanuals.com>