

AOC

LED TV User Manual

T2242we/ T2442e

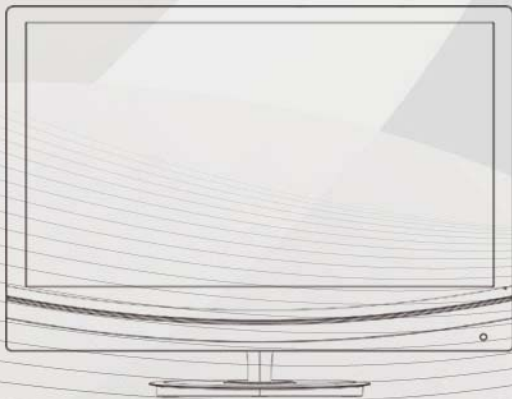

www.aoc.com

©2009 AOC. All Rights Reserved.

Thank you for choosing this AOC LED TV.

Before installing and turning on your AOC LED TV, please spend a few minutes to read this manual thoroughly and retain it for future reference.

Note: This product is subject to continuing improvement, and changes may be made without prior notice.

*The illustrations in the manual may not be exactly the same as those displayed on the screen. In this case, please operate according to the version you have purchased.

Contents

IMPORTANT INFORMATION	3
WARNING	3
CAUTION	3
Product disposal at end of life	3
IMPORTANT SAFETY INSTRUCTIONS	3
SAFE USE OF TV	4
Installation	4
AC outlet	4
LCD screen	4
Wiring	5
Electric shock	5
Lightning storms	5
When not in use	5
Overloading	5
Optional equipment	5
Small accessories	6
Antennas	6
Disposal of used batteries	6
Cleaning	6
Magnetic interference	6
Sound	6
Ventilation	7
Moisture	7
Volume Adjustment	7
Servicing	7
PACKAGE CONTENTS	8
LOCATING CONTROLS AND INPUT IN THE TV	9
Inserting batteries into the remote control	10
INSTALLATION	11
Installing the table-top stand	11
Wall-mounting	11
CONNECTING THE TV	12
Cable System or VHF/UHF Antenna System	12
HD Cable Box/HD Satellite Box	12
Connection with HDMI	12
Connection with Component Video	13
Connection with Composite Video	13
Connection with PC	13
PC INPUT SIGNAL REFERENCE TABLE	14
HDMI INPUT SIGNAL REFERENCE TABLE	14
VIDEO INPUT SIGNAL REFERENCE TABLE	14
VIDEO COMPONENTS SUPPORTING TV, VIDEO AND S-VIDEO	14
USING AOC TV	15
Turning the TV on and off	15
Setting Language	16
Search Channels	17
Select a Source	18
Channel switch/return	19
Volume adjustment and muting	19
Screen settings	20
Sound settings	21
Channel Settings	22
PC Settings	23
Function settings	24
TROUBLESHOOTING	25
DIMENSIONS AND SPECIFICATIONS	26

Important Information

WARNING



This symbol is intended to alert the user to the presence of un-insulated dangerous voltage that may cause risk of electric shock to persons.



This symbol is intended to alert the user to important operating and maintenance (servicing) instructions in the printed information that comes with the TV.

To reduce the risk of fire or electric shock, do not expose this TV to rain or moisture and do not place objects filled with liquids, such as vases, on the TV.

CAUTION

To prevent electric shock, do not use the polarized AC plug of this TV with an extension cord. Fully insert the prongs into the plug to prevent blade exposure.

AOC strongly recommends that users use the wall-mount bracket or table-top stand designed for your ACO LCD TV. Contact your dealers for details.

Use of wall-mount brackets or table-top stands designed for other LCD TVs may result in instability and cause injury.

Product disposal at end of life

AOC is concerned about environmental protection. This LCD TV contains recyclable materials.

At the end of life, professional waste disposal companies can disassemble the recyclable materials of this product and minimize the quantity of materials needing processing. The LCD used in this product contains no mercury. Please dispose of this product properly at the end of its useful life according to the local laws.



TruSurround XT is a trademark of SRS Labs, Inc. TruSurround XT technology is incorporated under license from SRS Labs, Inc. TruSurround XT[®] creates a truly immersive surround sound experience with rich bass and clear dialog from only two speakers.

Important Safety Instructions

- 1) Read and keep these instructions.
- 2) Heed all warnings.
- 3) Follow all instructions.
- 4) Connect the TV only to the appropriate power source.

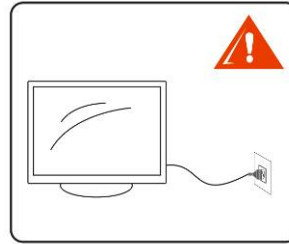

- 5) Do not install the TV in places with high temperatures or humidity or places with excessive dust or mechanical vibration.
- 6) Do not block any ventilation vents to protect the TV from overheating. Install in accordance with the manufacturer's instructions.
- 7) Do not install near any heat sources, such as radiators, heat registers, stoves, or other apparatus (including amplifiers), that produce heat.

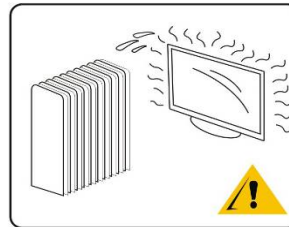

- 8) Do not use this apparatus near water.
- 9) If the provided plug does not fit into your outlet, consult an electrician for replacement of the obsolete outlet.
- 10) Protect the power cord from being walked on or pinched, particularly at plugs, convenience receptacles and the point where it exits from the apparatus
- 11) Use only the accessories/attachments approved by the manufacturer.
- 12) Use only with the cart, stand, tripod, bracket or table manufactured or specified by the manufacturer, or sold with the apparatus. When a cart is used, use caution when moving the cart and apparatus together to avoid injury from overturn.
- 13) Unplug this apparatus during lightning storms or when unused for long periods of time.
- 14) Refer all servicing to qualified service personnel. Servicing is required when the apparatus has been damaged in any way, such as when a power-supply cord or plug is damaged, liquid has been spilled on or objects have fallen into the apparatus or when the apparatus has been exposed to rain or moisture and does not operate normally, or has been dropped.
- 15) When any liquid or solid object enters the enclosure, unplug the TV from the outlet and call to have it serviced before using again.
- 16) Do not use the TV under 0°C.
- 17) When moving the TV from a cooler place to a hotter place or from and to places with dramatic temperature changes, blurred images or abnormal colors may occur due to vapor condensation. Please wait for a few hours to let the vapor clear before turning on the TV again.

Safe use of TV

Installation

Placement for viewing

When watching TV, users are recommended to maintain at a distance of 3-7 times the screen height and watch in moderately bright surroundings. Watching TV for too long or in a dark environment may cause eye fatigue. In order to obtain a clear picture, do not project the screen to direct illumination. Users are recommended to use spot lighting directed down from the ceiling and block the screen with an opaque cloth. It is best to install the TV in a room without reflective materials on the floor and walls.

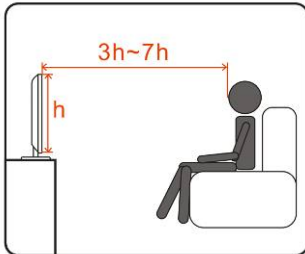

Take actions to prevent the TV from toppling over and causing injury by securing the TV to a wall or stand.

The TV should be installed near an easily accessible AC power outlet.

Follow the instructions below to place the TV to prevent the TV from falling off the stand or wall-mount bracket. This may cause damage or serious injury.

- Place the TV on a stable, level surface.
- Do not hang anything on the TV. Never allow children to climb on the TV.
- Do not install the TV in places producing extreme temperatures, such as under direct sunlight, near a radiator, near a heating vent, or in the direct line of air-conditioning vents.
- Never place the TV in hot, oily, humid or excessively dusty places.
- Do not install the TV where insects may enter.
- Do not install the TV in places that may be exposed to mechanical vibration.
- Do not install the TV in places where it may protrude, such as on or behind a pillar, or where you may bump your head on it. This may result in injury.

Outdoor use

Do not install this TV outdoors. If the TV is exposed to rain, it may cause a fire or electric shock. Never expose the TV to direct sunlight to prevent damage as a result of high temperatures.

Vehicles, ships and other vessels

- Do not install this TV in a vehicle.
- Bumping of the vehicle may cause the TV to fall and cause injury.
- Do not install this TV in a ship or vessel. If seawater enters the TV, it may cause a fire or damage the TV.

Medical institutions

- Do not place this TV in places where medical equipment is in use.
- Interference may cause malfunction of both the TV and medical equipment.

Attachments

Do not use attachments not recommended by the manufacturer to prevent potential hazards.

Wall-mount installation

Wall mount installation requires the use of a wall-mount bracket. When installing or removing the TV on or from the wall-mount bracket, make sure that it is done by qualified contractors. The TV may fall and cause serious injury if it is not securely installed on properly removed from the wall-mount bracket.

Please follow the instructions below to install the TV on a wall-mount bracket.

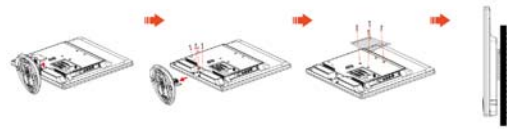

- Follow the installation instructions that come with the wall-mount bracket exactly when installing the TV on the bracket.
- Make sure to install the brackets that come with the Wall-mount Bracket.
- Do not hang the TV from the ceiling. It may fall and cause serious injury.

AC outlet

- Use the AC power cord specified by AOC and suitable for the voltage of the local area.
- If you are unable to insert the plug fully into the outlet, contact your dealer.
- If you will not use the TV for several days, unplug the power cord from the outlet. Do not pull on the cord, but only on the plug itself.
- The outlet should be easily accessible.
- Do not place the TV where the power cord is subject to wear or damaged.
- Do not pinch, bend, or twist the cord excessively. The core lines may be peeled off and cut, thus causing a short circuit and resulting in fire or electric shock.
- Do not modify or damage the power cord.
- Do not put objects on or roll objects over the power cord.
- Do not move the TV while it is connected to a power supply.
- Keep the power cord away from heat sources.
- When unplugging the power cord from the outlet, unplug it from the wall outlet first.
- Always unplug a power cord from the plug.
- Do not pull on the cord.
- Do not use the power cord coming with your AOC LCD TV on other equipment.
- Always use the authentic power cord from AOC.

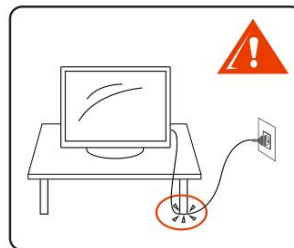

The TV should be installed near an easily accessible AC power outlet. Do not connect the TV to an outlet with poor contact. Make sure that the plug can be fully inserted into the outlet. Surge may occur and cause a fire if the plug is poorly connected to the outlet. If the outlet has poor contact, have it replaced by an electrician.

Follow the instructions below to prevent the power cord from being damaged. A damaged power cord may cause a fire or electric shock. If this happens, stop using the power cord and call your dealer or the AOC Service Center to have it replaced.

LCD screen

- Although the LCD screen is made with high-precision technology and delivers over 99.99% of effective pixels, black or white spots (RGB) may appear continually on the LCD screen. Either black or white spots are the structural property of the LCD panel and not a malfunction.
- The LCD screen is made with high-precision technology to deliver high performance and picture quality. Although the backlight of this TV is to maximize the brightness of the TV, the brightness of the screen may be uneven in the absence of any input signal or when the screen is blank when viewed in a dark environment. This is normal and not a malfunction of the TV. Changing the Backlight Control from the Function Setting can improve this condition.
- Avoid exposing the LCD screen in direct sunlight. This will damage the LCD panel.
- Do not press on or scratch the LCD screen nor put objects on the TV. This may make the image display uneven or damage the LCD panel.

- Although smears may appear on the screen or the screen may turn dark when using the TV in a cold environment, it is not a sign of failure. As the temperature rises, the condition will improve.
- Ghosting may occur on the screen when still pictures are displayed for a long time. It should disappear after some time.
- Both the screen and the enclosure will turn warm when the TV is in use. This is not a malfunction.
- Avoid spraying insecticides containing volatile substances on the screen.
- Avoid prolonged contact with rubber or plastics.

Broken pieces

Do not throw anything at the TV. The screen glass may break as a result of impact and cause serious injury.

If the TV screen cracks, do not touch it before disconnecting the TV from the power source. Doing so may cause electric shock.

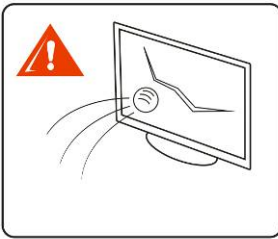

Handling broken glass and liquid crystal leakage

Broken glass will fall off and crystalline liquid may leak out when the LCD panel is damaged. Do not touch the broken glass and toxic crystalline liquid with bare hands to prevent cuts, poisoning or infection. Also, avoid contact of the broken glass or crystalline liquid with the eyes or mouth. If this happens, rinse with a large amount of drinking water immediately and consult your physician.

Wiring

Unplug the power cord from the outlet before connecting cables to ensure personal safety. Avoid stepping on the cables to prevent damaging the TV.

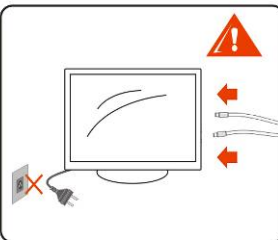

Electric shock

Do not touch the AC power cord or the TV with wet hands. Plugging in or unplugging the AC power cord in or from the outlet with wet hands may cause electric shock.

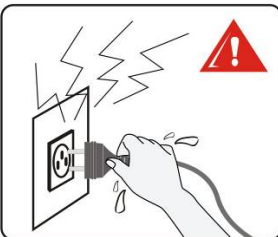

Lightning storms

Unplug the TV from the outlet and disconnect the antenna during

lightning storms or when unused for long periods of time in order to prevent damage to the TV as a result of lightning or power line surges, and thereby enhance the protection for the TV.

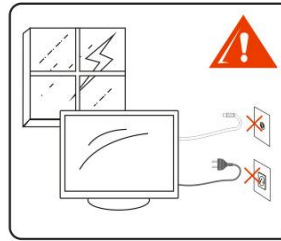

When not in use

If you will not use the TV for several days, unplug the power cord from the outlet for environmental and safety reasons. Even when the TV is turned off, it is still connected to a power source. Therefore unplug the power cord from the outlet to disconnect the TV from the power supply.

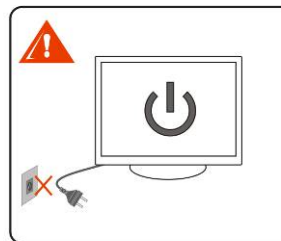

Overloading

This TV is designed to operate at 220VAC. Avoid connecting too many appliances to the same receptacle to avoid fire or electric shock.

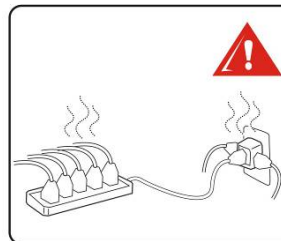

Optional equipment

Do not install optional equipment too close to the TV. Keep equipment at least 30cm from the TV. If the VCR is connected in front of or next to the TV, the picture quality may be distorted. When placing equipment with EMI near the TV, picture distortion or noise may occur.

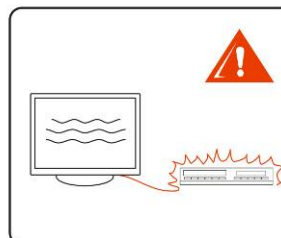

Small accessories

Keep small accessories out of children's reach.

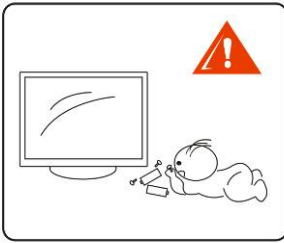

Antennas

If an outdoor antenna is installed, follow the precautions below. Keep an outdoor antenna away from high-voltage feeder lines or other streetlamp or power circuits or in places that may come in contact with power lines or circuits of such kind.

When installing an outdoor antenna system, do not touch these power lines or circuits. The consequence may be fatal.

The antenna system must be grounded to prevent surges or built-up static charges.

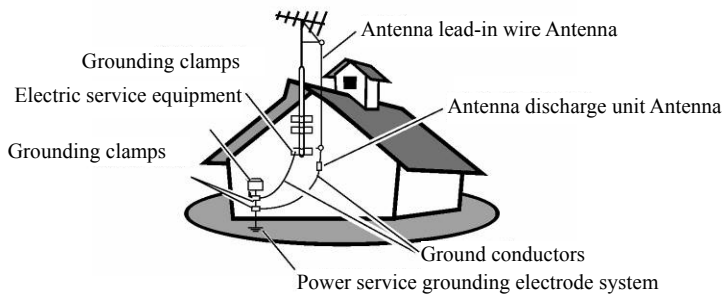

Antenna grounding according to the National Electrical Code

Caution for CATV system providers: CATV system providers shall follow the NEC Section 820-40 where the proper grounding principles are specified; particularly that cables must be grounded to the building's grounding system and kept as close as possible to the antenna lead-in point.

Batteries

- Do not dispose of batteries in the fire.
- Do not short-circuit, disassemble or overheat batteries.
- Incorrect replacement of batteries may cause the risk of battery explosion. Always replace with batteries of the same or equivalent type.

Disposal of used batteries

Dispose of used batteries according to local laws and regulations to protect our environment.

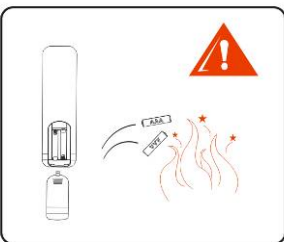

Cleaning

Cleaning the AC power plug

Unplug the AC power cord to clean the plug regularly. If too much dust is deposited on the plug, it will absorb moisture, which reduces insulation performance and may lead to a fire.

Clean the TV screen and enclosure

- Unplug the AC power cord from the outlet to prevent electric shock during the cleaning process.
- Clean the TV enclosure with a soft dry cloth. Wipe off the dust on the screen gently with a soft cloth. Remove stubborn stains with a soft cloth dampened with mild soapy water. Never use strong solvents, such as thinner or benzene to clean the screen or enclosure.
- When cleaning with a chemically pretreated cloth, follow the instructions on the package.
- Dust may accumulate at the ventilation vents over time. Therefore, users are recommended to remove the dust at ventilation vents with a vacuum cleaner regularly (once a month) to ensure good ventilation.

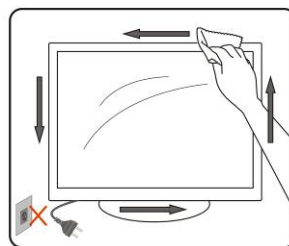

Magnetic interference

The speakers equipped on this TV contain a strong magnet which generates a magnetic field. Keep objects that may interfere with magnetic fields away from the TV speakers.

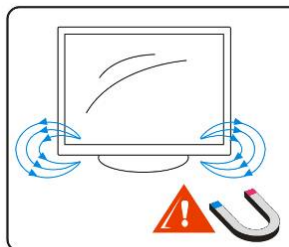

Sound

If a snapping or popping sound is often heard from the TV when in use, disconnect the power supply of the TV and consult your dealer or service personnel. It is normal that snapping or popping sounds are heard occasionally from the TV, particularly when turning the power on and off.

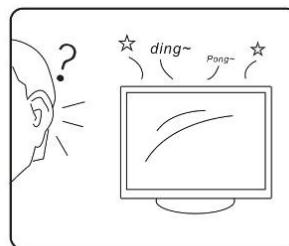

Ventilation

The vents on the TV enclosure are intended for ventilation. Do not block or cover these vents to ensure reliable TV operations and prevent it from overheating.

Dust and dirt deposits will accumulate in the TV in case of poor ventilation. Follow the instructions below to ensure good ventilation.

- Do not install the TV with the screen facing upwards, downwards or to either side.
- Do not install the TV turned over or upside down.
- Do not cover the ventilation vents with cloth or any materials.
- Do not place the TV on a bed, couch, rug or surface of similar nature to that may block the ventilation vents.
- Unless proper ventilation is available, do not put the TV inside a bookshelf or cabinet.

Always leave some space around the TV as shown below to promote air circulation and thereby prevent the TV from overheating, which may cause a fire or damage the TV.

Wall Installation with the Wall-mount Bracket

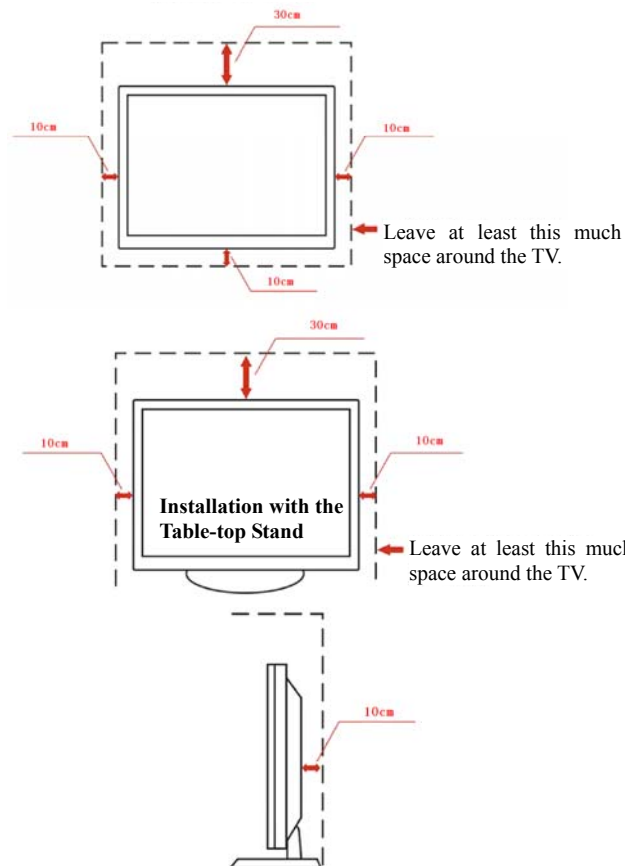

Do not install the TV in places with poor ventilation.

Objects and ventilation vents

Do not insert objects into the TV through the ventilation vents on the enclosure. They may touch the high voltage points inside the TV or cause short circuit to the TV and finally result in a fire or electric shock. Do not put any object on the TV.

Moisture

Moisture and flammable objects

- Do not put objects containing liquid on the TV, this includes vases, to prevent liquid from dripping or splashing into the TV.
- Do not use AC-operated TVs near water, such as a bathtub, washbowl, kitchen sink, laundry tub, swimming pool or wet basement, to prevent a fire or electric shock due to short circuit.
- Do not expose the TV to water. Never spray liquid of any kind on the TV. When liquids or solid objects enter the enclosure, stop using the TV immediately to prevent electric shock or damage to the TV. Call for service by qualified service personnel.
- Keep flammable objects or open flames (e.g. candles) away from the TV to prevent a fire.

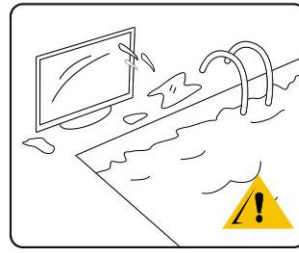

Volume Adjustment

Adjust the volume so as not to disturb your neighbors. Sound carries, especially at night. Users are recommended to close the window or use headphones when watching TV at night.

When using headphones, adjust the volume appropriately to prevent hearing damage.

Servicing

Do not attempt to service your TV on your own. There is high voltage and other hazards inside the TV. Call for service by qualified personnel.

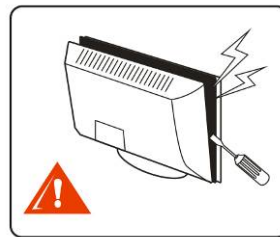

Replacement parts

When it is necessary to replace a part, make sure that the service personnel give you a written guarantee that the replacement part is the one specified by the manufacturer with the same technical characteristics of the original one.

Use of unauthenticated replacement parts may cause a fire, electric shock or other hazards.

Safety check

After the service, ask the service personnel to run a routine safety check specified by the manufacturer to ensure that the TV is operated in a safe condition. Always ask for service from qualified service personnel.

Thank you for purchasing the AOC high-definition television. The picture quality on the screen varies according to the TV signals received. If you want to experience perfect picture quality of the AOC high-definition television, you should choose HD programs. The AOC high-definition television can receive and display HD programs through the following ways:

- Use of an HD antenna to receive HD program broadcasts.
- Subscription to HD cable TV service.
- Subscription of HD satellite TV service.
- Use of Blue-ray Disc player or other external equipment.

Contact your cable or satellite TV service provider for more information about upgrading to HD programs.

Package Contents

After opening the TV package, check if the TV and all accessories are in good condition and free from damage.

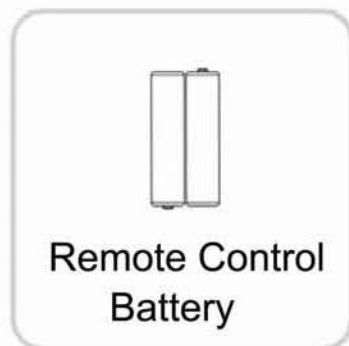
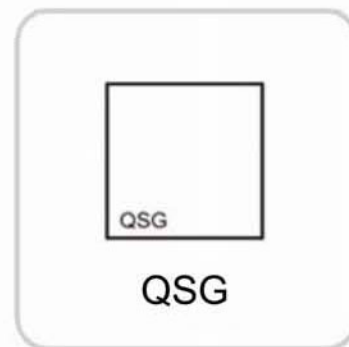
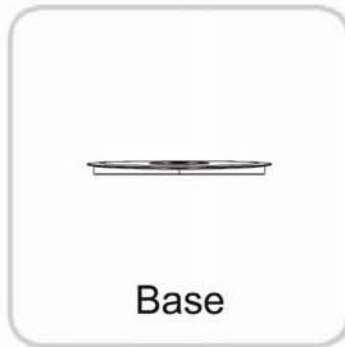

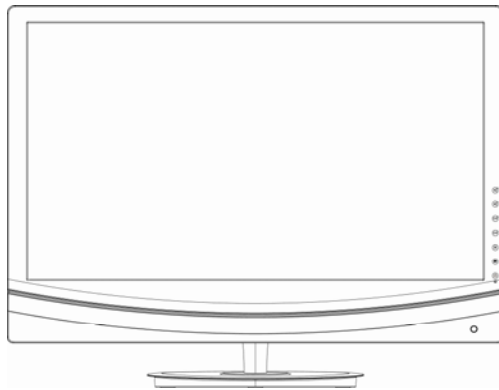

* Not all signal cables (Analog, USB, DVI, and HDMI cables) will be provided for all countries and regions. Please check with the local dealer or AOC branch office for confirmation.

Locating controls and input in the TV

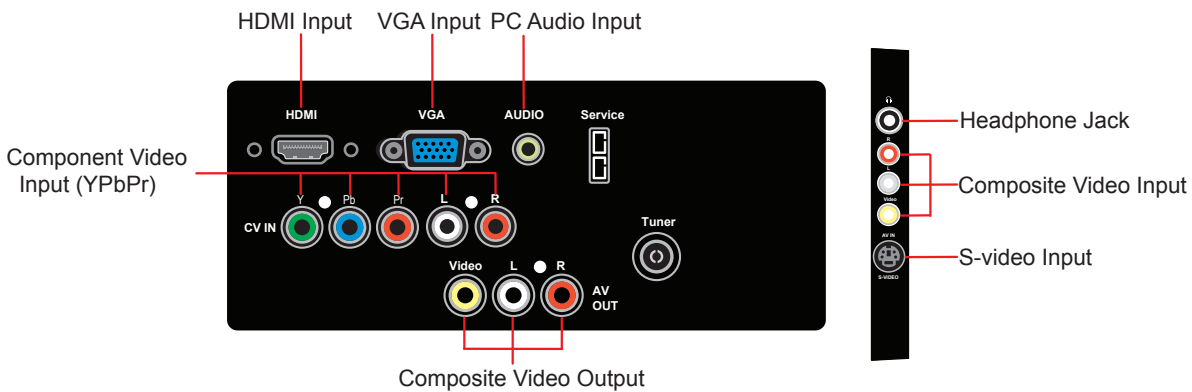

- Volume +
- Volume -
- Channel +
- Channel -
- Menu
- Source
- Power Button

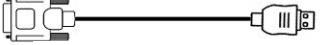

Item Description	
Headphone Jack	For users to connect the headphones. If the size of the headphones connector is incorrect, please use an adaptor (not supplied by AOC). The TV speakers will be muted after connecting the headphones to the TV.
Composite Video Input	The Composite Video Input (yellow) is designed for connecting with composite video out on video equipment. The composite audio inputs (L (white)/R (red)) next to the Composite Video Input are designed for connecting with the audio out of the video equipment.
Composite Video Output	The Composite Video Output (yellow) is designed for connecting with the component composite video input on video equipment. The composite audio outputs (L (white)/R (red)) next to the Composite Video Output are designed for connecting with the TV audio input. This function is effective in TV, video and S-video modes.
S-video Input	The S-video Input is designed for connecting with webcams or any video equipment with the S-video output. The picture quality of S-video is better than that of the composite video. The audio input is shared with the composite audio input.
HDMI Input	<p>The HDMI (High Definition Multimedia Interface) provides an uncompressed, all-digital audio/video interface between this TV and any audio/video equipment equipped with the HDMI (e.g. STB, DVD player, Blue-ray Disc player, A/V receiver and PC). The HDMI supports enhanced or high-definition video and digital audio as well.</p> <p>If the equipment is equipped with the DVI (Digital Video Interface) rather than the HDMI, connect the equipment to this TV with a DVI-HDMI cable or DVI-HDMI adaptor. In this case, you will need to connect the audio of the equipment to the PC Audio Input of this TV.</p>  <p>DVI-HDMI cable</p>  <p>DVI-HDMI adaptor</p> <p>If you want to view a program in 480im, 480p, 720p, 1080i, and 1080p modes, you will need to connect the equipment to this TV with the HDMI. Make sure to use HDMI cables carrying the HDMI logo.</p>
VGA Input	<p>When using this TV as a PC monitor, connect the VGA out of the PC to the VGA Input on this TV with a HD15-HD15 cable (analog RGB). You can also connect other RGB video sources to this TV from this port. Refer to VGA Input Signal Reference Table on p.14 for details.</p> <p>For some Apple Macintosh computers, you may need to use an adaptor (not supplied). If this happens, connect the adaptor to an Apple Macintosh computer before connecting the Apple Macintosh computer to this TV with a HD25-HD15 cable. If the screen has noise, is flickering or blurred, adjust the Pitch and Phase from the function menu.</p>
Component Video Input (YPbPr)	This allows you to connect the video and audio of a video component with component video output. When compared with the S-video and composite video, the component video delivers better picture quality.
Antenna Input (Tuner)	The RF input allows you to connect the cable TV or VHF/UHF antenna to this TV.

Buttons located on the right hand side of the TV operate the same way as these buttons on the remote control.



Button ""	Description
	Power button Press this button to turn the TV on and off. When the TV is turned off, it will enter the energy-saving mode instead of disconnecting the power unless the AC supply is turned off or the power cord is unplugged from the outlet.
	TV/Video/HDMI/C/Component Press this button to directly launch to the corresponding mode, including TV/Video/HDMI/PC/Component.
	0-9 Press the 0-9 buttons to select a channel. After pressing the number, the TV will switch to that channel in about 2 seconds.
	- / -- Press the 0-9 buttons and this button to select a channel with 3 digits.
	Return Press this button to return to the previous channel or exit from the OSD (On Screen Display) menu when displaying the menu items or settings.
	Volume \wedge/\vee Press this button to adjust volume .
	Source Press this button to display the input source list.
	Mute Press this button to mute the sound. Press the button again or the Volume button (\wedge/\vee) to restore sound.
	Program \triangle/∇ Press this button to scan channels. Press \triangle/∇ to quickly change from one channel to another.
	$\blacktriangle/\blacktriangledown/\blacktriangleleft/\blacktriangleright$ Press the arrow buttons to select an item or adjust the settings in the OSD function menu . OK Press this button to select or confirm an item or setting.
	Zoom Press this button repeatedly to toggle from one display mode to another. In general, there are Wide, 4:3, Zoom-in 1, Zoom-in 2, Movie 1, and Movie 2 modes. In the HDMI mode, no display mode is available. In the PC mode, only 4:3 and Wide are available.
	Menu Press this button to display various hotkey functions and function menu hotkeys. The items in the OSD function menu vary according to the input mode and contents.
	Display Press this button to display the information of the channel or program, if any. The OSD will disappear in a few seconds. Press the button again to turn off the display.
	Picture Press this button repeatedly to toggle from one picture mode to another, including Standard, Vivid, Movie, Energy-saving and Custom. The picture mode is also adjustable from the screen settings. Refer to Screen Settings in p. 20.
	Sound Press this button repeatedly to toggle from one sound mode to another, including Standard, Music, Voice and Custom. The sound mode is also available from the Sound Settings in p.22.
	Sleep Press this button to select the time to turn off the TV (ineffective in the PC mode). The sleep timer is also available from the OSD. Refer to Screen Settings in the TV function menu.

Inserting batteries into the remote control

Insert two "AAA" batteries (supplied) into the removed control as shown in the diagram.

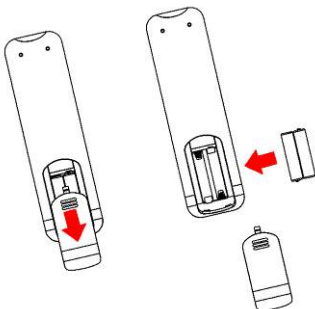

Installation

Refer to the illustrations in the “Safe Use of TV.”

Installing the table-top stand

Take out the TV set and the table-top stand from the box and assemble them together with the screws in the attachment box as shown below.

1. Place the TV screen downward on a table covered with a soft cloth or cushion. Put the table-top stand on a firm surface.
2. Insert the table-top stand into the hole at the bottom of the TV set.

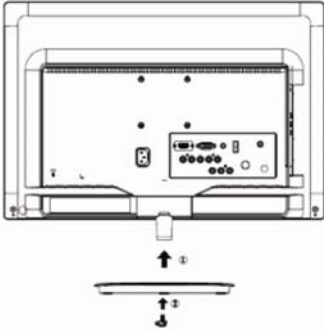

Place the TV on a firm surface.

1. Make sure that the TV is placed in an area with good ventilation and the vents on the back cover are not blocked.
2. Make sure that at least 15cm of space is maintained around the TV to ensure good ventilation.
3. Do not place the LCD TV near a radiator or other power sources.
4. Do not use candles and other fire sources to prevent danger.
5. Avoid exposing the TV to high temperature, direct sunlight and rain. Keep the TV away from splashes.

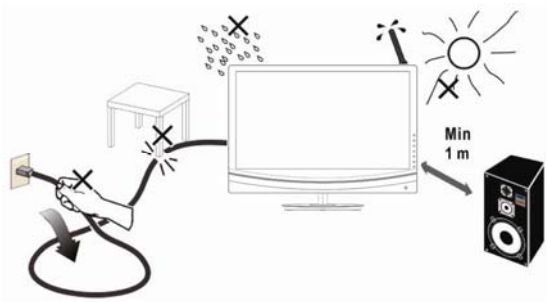

Wall-mounting

Install the TV on a wall by using the wall-mount bracket (sold separately). Before mounting the TV on a wall, remove the table-top stand from the TV according to the following simple steps:

1. Disconnect all cables from the TV.
2. Gently lay the TV screen downward on a firm table covered with a thick and soft cloth. Make sure that the table-top stand is hanging over the edge.
3. Remove the screws as shown in the illustration for your model, pull the table-top stand out, and secure the screws back in their positions.
4. Do not remove other screws from the TV.

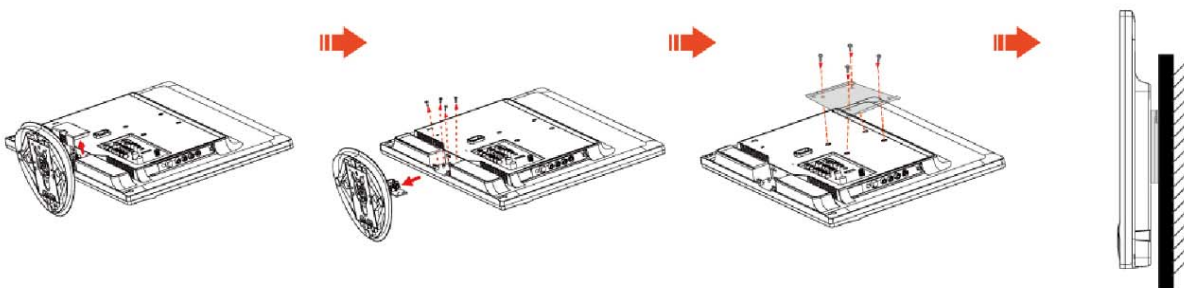

- Do not remove the table-top stand for any reason, except for installing the TV to a wall.
- Keep properly the screws removed from the TV and the table-top stand for re-installation of the TV on the table-top stand. Also, keep the screws out of children’s reach.
- Refer to the instruction guide of the Wall-Mount Bracket for your model to install the wall-mount bracket. It needs special know-how to install this TV, particularly for judging the strength of the wall to support the TV’s weight.

For product protection and safety reasons, AOC strongly recommends you to use the wall-mount bracket designed for your TV model and have your TV installed on a wall by an AOC dealer or licensed contractor.

Connecting the TV

Cable System or VHF/UHF Antenna System

Apart from the standard-definition programs, you can watch high-definition programs with this TV (if they are available in your area).

This TV supports the reception of unscrambled digital programming for both cable and VHF/UHF antennas.

As 300Ω twin lead cables are easily affected by radio frequency interference and this will downgrade the signals; we strongly recommend that users connect the antenna/cable input with 75Ω coaxial cables to obtain the optimal picture quality.

Cable or VHF/UHF (or VHF only)

75Ω coaxial cable
(Supplied)

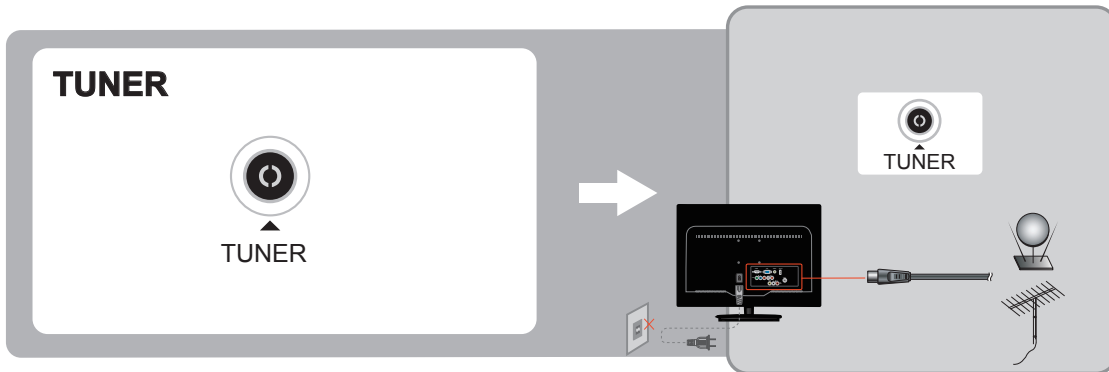
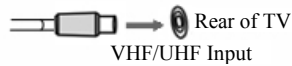

HD Cable Box/HD Satellite Box

By subscribing to HD cable service or HD satellite service, you can enjoy HD programs. Make sure to connect the HD cable or HD satellite box to this TV via the HDMI I or component video (with audio) input for the best picture quality.

Connection with HDMI

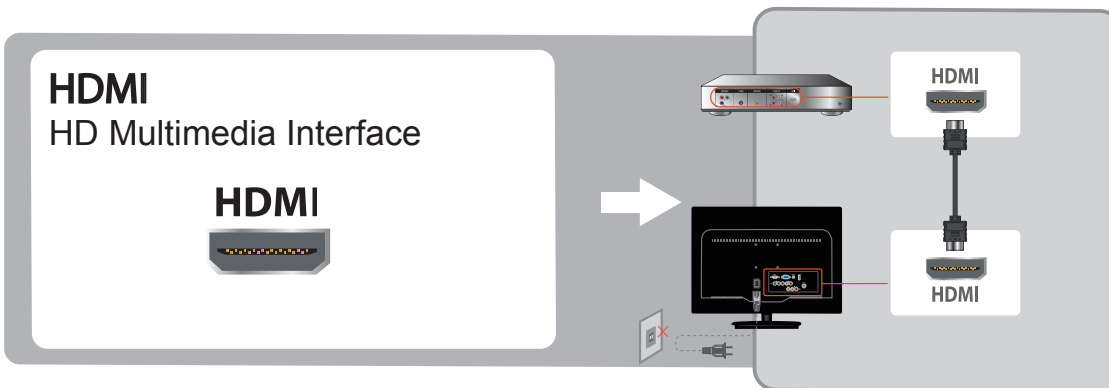

If the HD cable or HD satellite box is equipped with DVI rather than HDMI, connect the HD cable or HD satellite box to this TV from the DVI out on the HD cable or HD satellite box to the HDMI in of this TV with a DVI-to-HDMI cable or adaptor and connect the audio out of the HD cable or HD satellite box to the PC Audio of this TV.

Connection with Component Video

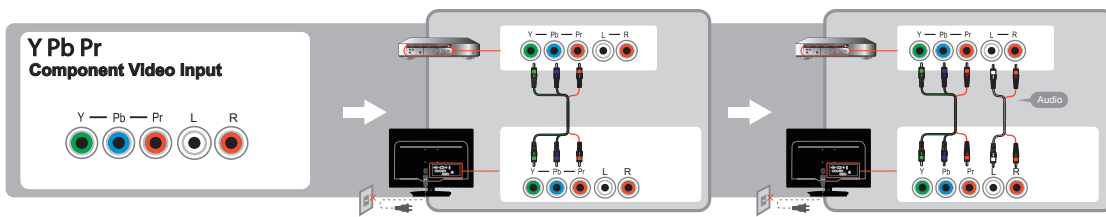

Connection with Composite Video

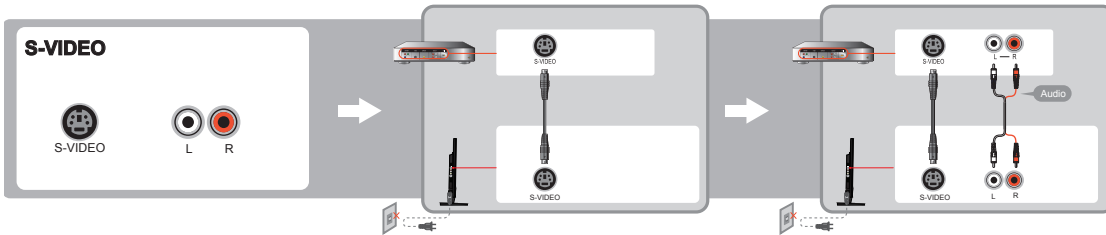
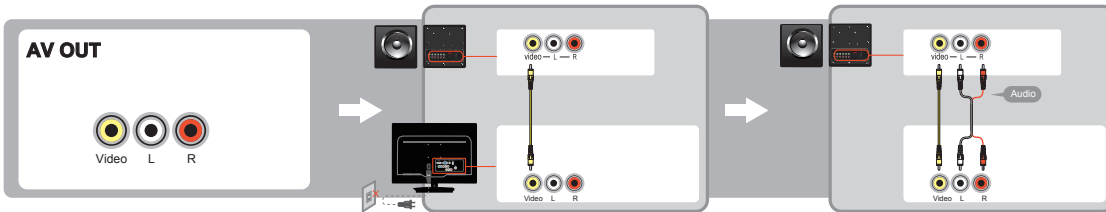
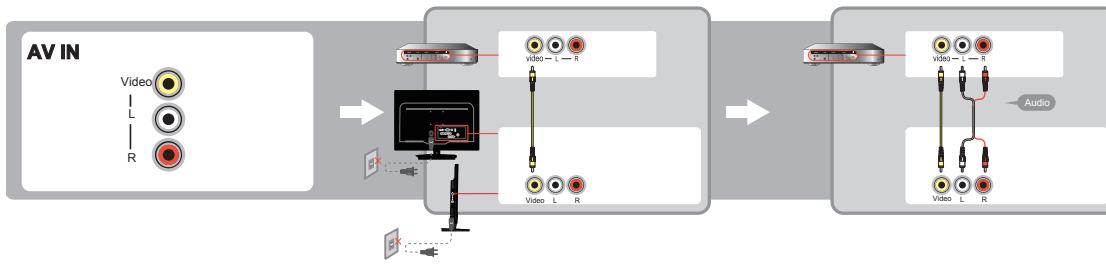

Connection with PC

As shown below, you can use this TV as a PC monitor by connecting the PC to the TV with a VGA cable. This TV also supports PCs with DVI or HDMI video.

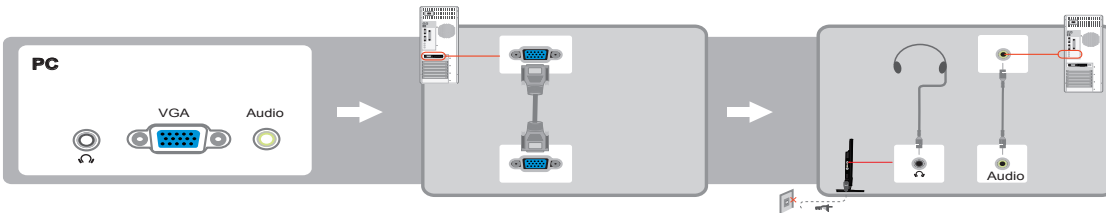

- Connect the PC to the TV with a ferrite core VGA cable and audio cable.
- If the PC is connected to the TV and no signal is detected after 30 seconds, the TV will automatically enter standby mode.

PC Input Signal Reference Table

After connecting the PC to the TV with the VGA port, set the PC output signal according to the table below.

Default PC mode			
Standard	Resolution	H. Sync. (kHz)	V. Sync. (kHz)
VESA	640 x 480	31.469	59.94
VESA	800 x 600	37.879	60.317
VESA	1024 x 768	48.363	60.004
VESA	1360 x 768	47.72	59.799
WXGA+	1400 x 900	59.887	55.935
WSXGA	1680 x 1050	59.884	64.674
FHD	1920 x 1080	60	67.5

HDMI Input Signal Reference Table

When connecting the PC to this TV with HDMI, set the PC output signal according to the table below.

Default HDMI mode			
Standard	Resolution	H. Sync. (kHz)	V. Sync. (kHz)
VESA	640 x 480	31.469	59.94
VESA	800 x 600	37.879	60.317
VESA	1024 x 768	48.363	60.004
VESA	1360 x 768	47.72	59.799
WXGA+	1400 x 900	59.887	55.935
WSXGA	1680 x 1050	59.884	64.674
HD	1920 x 1080	60	67.5

Video Input Signal Reference Table

- After connecting video equipment to this TV with component video or HDMI, set the output signals of the video equipment according to the table below.
- If the graphic card of the PC supports video out, you can also set the PC output signals according to the table below.

Default Component Video or HDMI mode			
SD	720 x 480i	15.734	60
SD	720 x 480P	31.5	60
SD	720 x 576i	15.625	50
SD	720 x 576P	31.25	50
HD	1280 x 720P	37.5	50
HD	1280 x 720P	45	60
HD	1920 x 1080i	28.125	50
HD	1920 x 1080i	33.75	60
FHD	1920 x 1080P	56.3	50
FHD	1920 x 1080p	67.5	60

Video Components Supporting TV, Video and S-video

PAL D/K B/G I ; NTSC M/N

HD Interface

You can also play back traditional programs with a DVD player or VCR player by connecting these video components to the TV from the video or S-video terminals on the side of the TV.

Using AOC TV





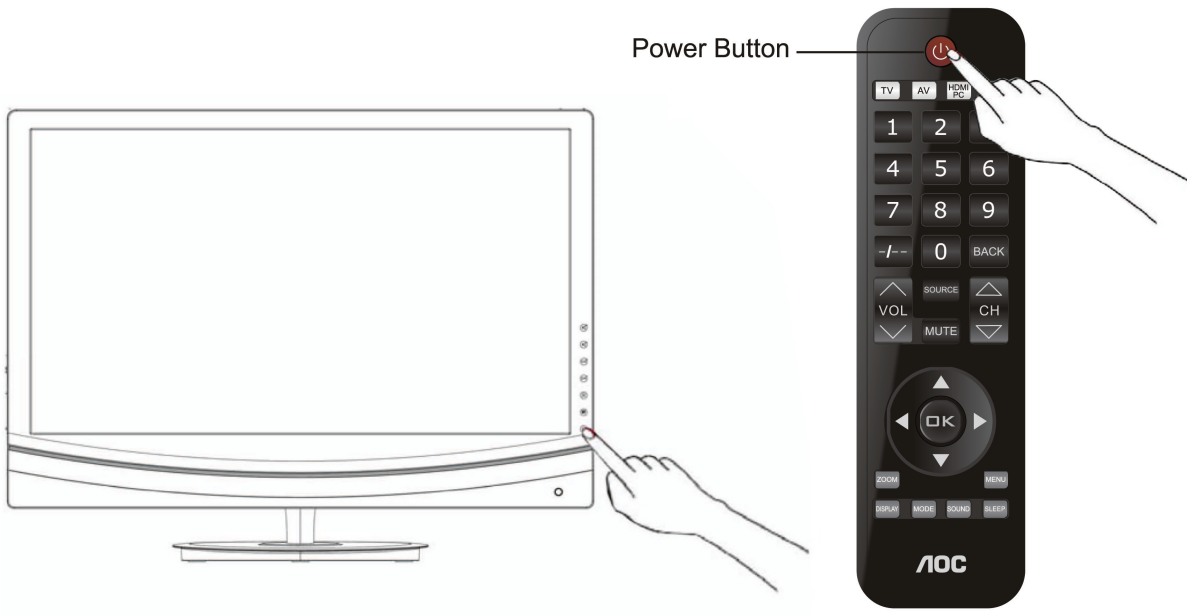

Turning the TV on and off

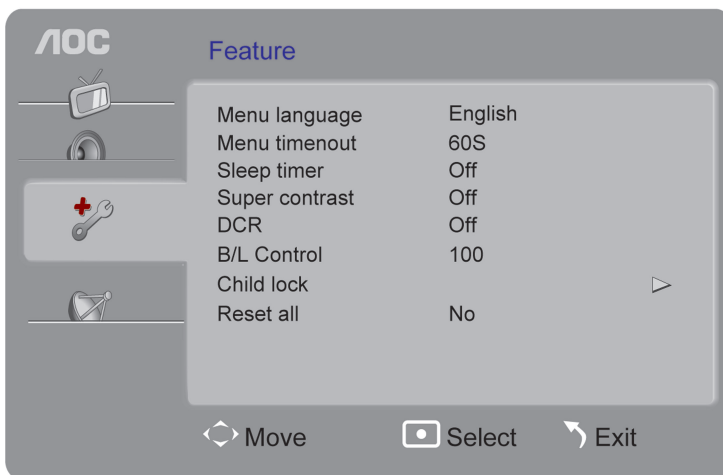
Press the Power button on the TV or remote control to turn on the TV.









Setting Language

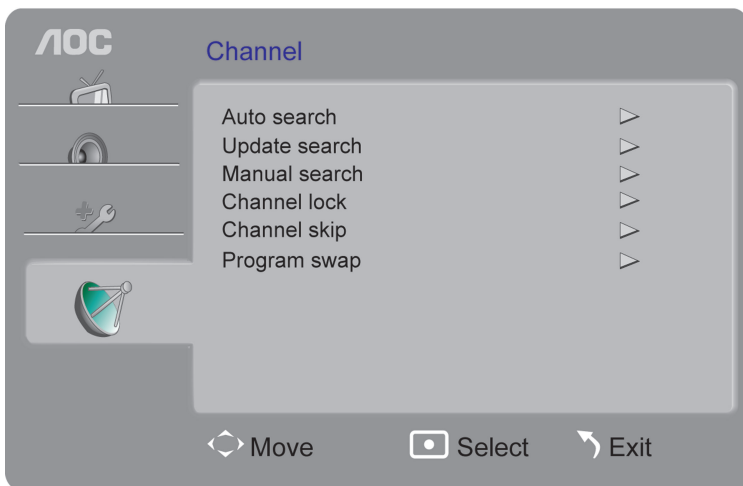

1		Press the Menu button to open the menu.
2		Press the ▲/▼ buttons to select [Function]  and press the OK button.
3		Press the ▲/▼ buttons to select [Menu Language].
4		Press the ◀/▶ button to select a language : 简体中文, English, Français, Español, Português, Русский, العربية
5		Press the Menu button to exit.

Search Channels



1		Press the Menu button to open the menu.
2		Press the ▲/▼ buttons to select [Channel]  and press the OK button.
3		Press the ▼/▲ buttons to select [Auto Search] and press the OK button.
4		Press the ◀/▶ buttons to select [Yes] and press the OK button.

Select a Source



On the AOC TV, you can directly select a source by the remote control or press the **Source** button to select a source from the OSD menu .

When selecting a source directly from the remote control, press the following buttons to directly switch to the corresponding source

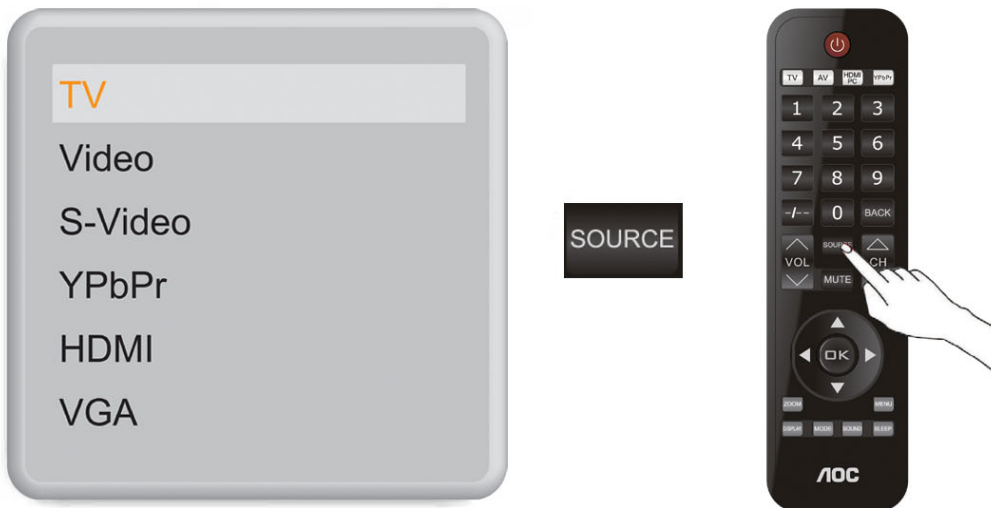

When pressing the **Source** button,



1		Press the Source button to open the Source Function Menu .
2		Press the ▲/▼ buttons to select a source: TV, Video, S-video, YPrPb, HDMI or PC.
3		Press the Menu button to enter.

Channel switch/return

On the AOC TV, you can directly switch to another channel using the remote control or press the **CH ▲/▼** buttons on the side of the TV to switch to another channel.

- 1) Press the number buttons to switch to another channel .



- 2) Press the **Program** button to switch to another channel.



- 3) Press the **Return** button to return to the previous channel.



Volume adjustment and muting

- 1) Press the **Volume** button to adjust the TV volume.



- 2) Press the **Mute** button to mute the TV.



Press the **Sound** button to select a sound mode: Standard , Music, Voice, Custom.

Refer to Sound Settings on p.21 for more details.

Screen settings

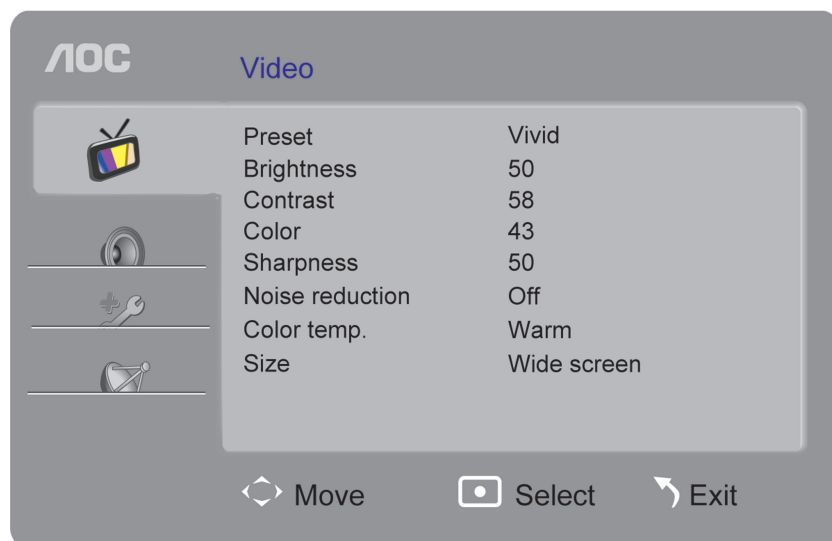





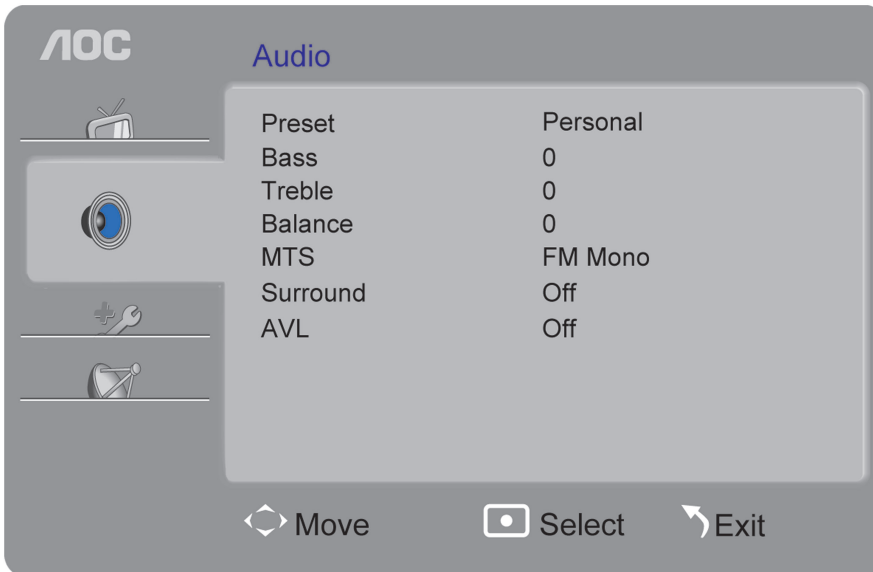

1		Press the Menu button to open the menu.
2		Press the ▲/▼ buttons to select [Video]  and press the OK button.
3		Press the ▼/▲ buttons to select an item: Picture Mode , Brightness, Contrast, Color, Sharpness, Noise Reduction , Color Temperature or Screen Ratio and press the OK button to enter.
4		Press the ◀/▶ button to adjust.
5		Press the Menu button to exit.

Item	Description	
Picture Mode	Standard	Standard picture settings recommended for home entertainment.
	Vivid	Enhanced picture contrast and sharpness.
	Movie	For viewing movie-based contents, suitable for viewing in a cinema-like environment.
	Energy Saving Mode	Saves energy by reducing backlight strength.
	Custom	User-defined mode.
Brightness	Adjusts screen brightness.	
Contrast	Adjust screen contrast.	
Color	Adjust screen color.	
Sharpness	Adjust screen sharpness.	
Noise Reduction	Reduces the noise level of connected equipment and VHF/UHF/CABLE input.	
Color Temperature	Neutral	Gives the white colors a neutral tint.
	Cool	Gives the white colors a bluish tint.
	Warm	Gives the white colors a reddish tint.
Screen Ratio	Screen ratio modes: 4:3, Wide, Zoom-in 1, Zoom-in 2, Movie 1 and Movie 2 for general input sources. No screen aspect is available in the HDMI mode. In the PC mode only 4:3 and 16:9 are available. Users can press the Zoom button on the remote control to change the screen ratio.	

- All screen modes are switchable from the **Picture** button on the remote control.

Sound settings







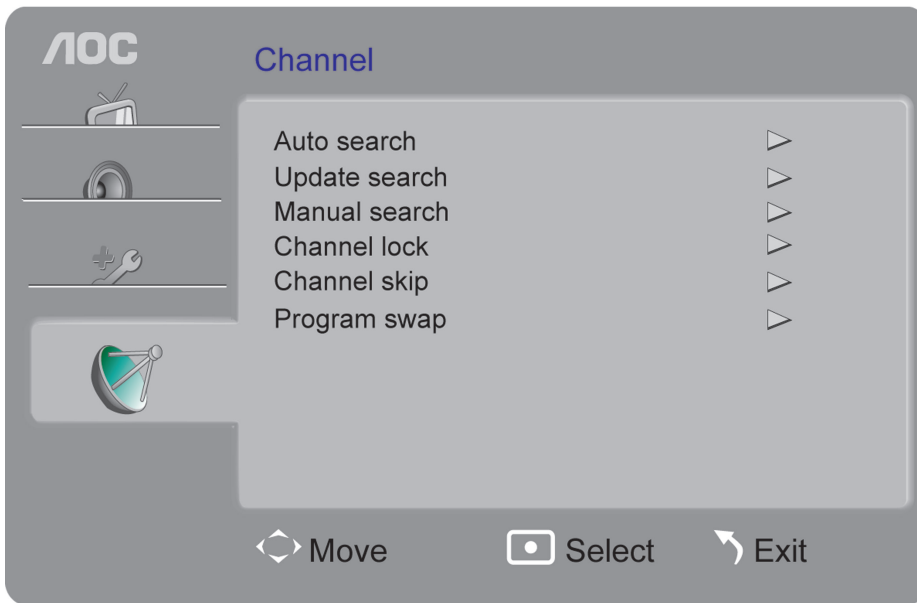

1		Press the Menu button to open the menu.
2		Press the ▲/▼ buttons to select [Audio]  and press the OK button.
3		Press the ▲/▼ button to select an item: Sound Mode, Bass, Treble, Balance , MTS, Surround, AVL, and press the OK button to enter.
4		Press the ◀/▶ buttons to select.
5		Press the Menu button to exit.

Item	Description
Sound Mode	Voice: Enhances treble and maintains bass at a medium level.
	Custom: Enhances bass and maintains treble at a medium level.
	Standard: Suitable for spoken dialog.
	Music: Enhanced treble and bass.
	• Sound Mode is also accessible from the Sound button on the remote control.
Bass	Increases or decreases bass.
Treble	Increases or decreases treble.
Balance	Emphasizes left or right speaker balance .
MTS	Selects sound effect mode: Mono or NICAM.
Surround	Sets surround.
AVL	Enables or disables Auto Volume.

Channel Settings

The channel settings are available only in the TV mode.







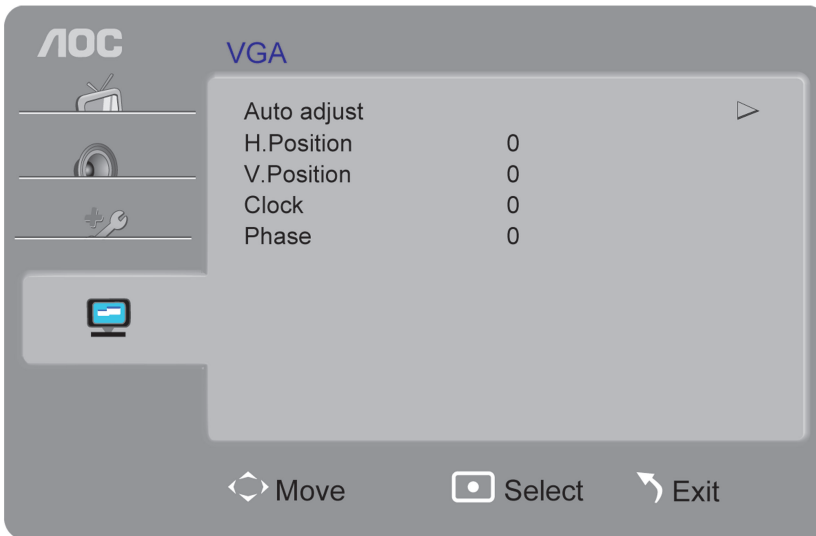

1		Press the Menu button to open the menu.
2		Press the ▲/▼ buttons to select [Channel]  and press the OK button.
3		Press the ▼/▲ buttons to select an item: Auto Search, Add Channel , Manual Search, Lock Channel , Skip Channel or Channel Exchange and press the OK button to enter.
4		Press the ◀/▶ buttons to adjust.
5		Press the Menu button to exit.

Item	Description
Auto Search	Automatically sets up the channel list on the TV for all receivable channels. 1. Select Auto Search. 2. Press the OK (confirm) button or the ▶ button to start auto channel search. After the auto search is completed, the channels found will be stored . 3. Press the OK (confirm) button or the Menu button to end auto search. 4. If you run Auto Search again, the previously found channels will be overwritten with the newly searched channels.
Add Channel	Adds a new channel to the channel list.
Manual Search	Press the ▶ for 3 seconds to enter the manual search mode. The channel searched for will be stored by its default channel number and exit the manual search mode.
Lock Channel	Locks a channel so that it cannot be modified.
Skip Channel	When it is enabled, the current channel will be skipped with pressing the ▲/▼ button.
Channel Exchange	Exchanges from one designated channel to another designated channel.

PC Settings

These settings are available only in the PC mode.







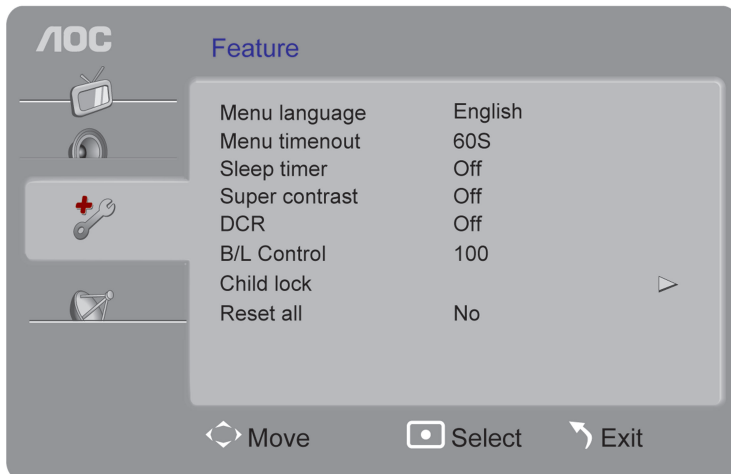

1		Press the Menu button to open the menu.
2		Press the ▲/▼ buttons to select  and press the OK button.
3		Press the ▲/▼ buttons to select an item: Auto Adjustment., H. Sync, V. Sync, Pitch and Phase and press the OK button to enter.
4		Press the ◀/▶ buttons to adjust.
5		Press the Menu button to exit.

Item	Description
Auto Adjustment	Automatically adjusts the resolution for full-screen display of an input signal the TV receives from the connected PC. Please refer to the PC Input Signal Reference Table for more about the resolutions supported by this TV.
H. Sync	Adjusts the horizontal position of the picture.
V. Sync	Adjusts the vertical position of the picture.
Pitch	Adjusts the pitch frequency of signals.
Phase	Adjusts the phase frequency of signals.

Function settings



1		Press the Menu button to open the menu.
2		Press the ▲/▼ buttons to select [Function]  and press the OK button.
3		Press the ▲/▼ buttons to select an item: Menu Language , Menu Display Time, Sleep Timer, Advanced Contrast, Dynamic Contrast, Backlight Control ,Channel Block or System Reset and press the OK button to enter.
4		Press the ◀/▶ buttons to adjust.
5		Press the Menu button to exit.

Item Description	
Menu Language	Selects the TV language .
Menu Display Time	Sets the menu display time.
Sleep Timer	Sets the time to enter the standby mode (ineffective in the PC mode). Users can also set the timer from the Sleep button on the remote control.
Advanced Contrast	Sets contrast to the maximum value.
Dynamic Contrast	Allows the TV to automatically adjust the contrast according to the brightness of screen.
Backlight Control	Adjusts the brightness of the backlight (when the brightness of backlight is too low, the white screen may flicker when turning on the TV; this is normal).
Channel Block	When it is turned on, users will need to input a 4-digit password to 1. Enter the Channel Search menu; 2. Watch the blocked channel; and 3. Enter the Channel Block Sub-menu. When the TV is turned on, users only need to input the 4-digit password once to unlock all functions.
System Reset	Reset all items to their default values.

Troubleshooting

Condition	Explanation/Solution
No picture	
No picture	Check the Power Saving settings.
Cannot receive any channels	Make sure the power cord is correctly connected. Turn on the TV. Check the antenna/cable connections. Make sure the Cable setting is correct for your TV signal source.
The TV is locked to one channel	Run Auto Program to add receivable channels that are not present in the TV's memory.
Cannot receive select channels	Run Auto Program to add receivable channels that are not present in the TV's memory. Check if the antenna is connected to the TV at the rear of TV. This may be a problem of the TV station. Try another channel. Adjust contrast and brightness.
The TV turns off automatically	Check if the Sleep Timer is enabled or confirm the duration setting of timer. Check PC Power Management in General Settings.
No picture is displayed from some video sources	Check the connection between the optional equipment and the TV. Press the Source (input) on the remote control. Select the desired input from the External Inputs list.
Condition	Explanation/Solution
Poor picture quality	
The quality of images is not as good as seen at the store	Picture quality depends on the signal quality.
Double images or ghosts	Check the antenna/cable connections. Check the antenna location and direction.
Only snow and noise are displayed on the screen	Check if the antenna is broken or bent. Check if the antenna has reached the end of its serviceable life. (3-5 years in normal, 1-2 years at the seaside.)
Dotted lines or strips	Keep the TV away from noise sources, such as cars, motorcycles or hairdryers. If using 300 Ω twin lead, move the excess lead away from the TV or try using 75Ω coaxial cable instead.
No color/Dark picture/Incorrect colors/Too bright picture	Press Picture to select the desired Picture Mode. Adjust the Picture Mode item in the Picture Settings .
Noisy picture	Make sure that the antenna is connected with a 75Ω coaxial cable. Keep the antenna cable away from other connecting cords. To avoid TV interference, make sure to use an undamaged antenna cable.
Condition	Explanation/Solution
No sound/Noisy sound	
Good picture, no sound	Check the volume control. Press the Mute or Vol+ button on the remote control until the muting symbol  disappears from the screen. Disconnect your headphones. For HDMI equipment, confirm that the audio output setting of the connected equipment is set to PCM. This TV's HDMI inputs support PCM 32, 44.1 and 48 kHz.
Audio Noise	Make sure that the antenna is connected with a 75Ω coaxial cable. Keep the antenna cable away from other connecting cords. To avoid TV interference, make sure to use an undamaged antenna cable.
Condition	Explanation/Solution
PC Input	
No picture/No signal	Confirm the PC is correctly connected to the TV from either the PC OUT (with an HD15 cable) or HDMI out. Ensure the output from the PC is one of the formats listed on p.18. Turn off the PC. Confirm the PC connection and restart the PC. Plug and play will automatically detect the TV and correctly set up PC resolution. Verify if the Power Management on the PC is activated.
Poor picture quality	Adjust the resolution. Adjust Pitch and Phase.
Wide Mode changes automatically	If the 4:3 Default in the Screen settings is set to other options than Off, the current Wide Mode setting is automatically replaced with the 4:3 default setting when you change the channel or video input. If you want to select the Wide mode from the Zoom on the remote control, set the 4:3 Default to Off in the Screen settings. Check the Wide options in the Screen settings.
Picture size reduces suddenly	The picture size reduces during the commercials. This is because of the way the provider broadcasts the commercial content. When HD content channels switch to SD contents (commercials), the picture size will reduce and will be surrounded by a black border.
Black bands appear at the edges of the screen	Some wide screen programs are filmed in aspect ratios that are greater than 16:9 (particularly for theatrical releases). When displaying these programs, black bands will appear at the top and bottom of the screen . Programs in 4:3 aspect ratio will have bands on the left and right sides of the screen.
Some details are lost when displayed in certain programs on DVD or other digital sources display, particularly in scenes with fast motion or a darker tone	This is because the digital compression of the source content used by certain digital broadcasts and DVDs may cause your TV screen to display fewer details than usual or artifacts (small blocks or dots, pixilation) on the screen. These signal compressions are more visible and depend on the clarity and resolution of the television.
Remote control does not operate	Check the polarity of the batteries or replace the batteries. Point the remote control at the remote control sensor located at the front of the TV. Fluorescent lamps can interfere with the operations of your remote control. Turn off fluorescent lamps and try again. Remove obstacles within effective range of the remote control sensor.

Dimensions and specifications

Model	T2242we	T2442e
Panel size	54.6cm (21.5")	60.9cm (24")
Resolution	1920 x 1080	1920 x 1080
Viewing angle	Horizontal: 170° Vertical: 160°(Typ.)	Horizontal: 170° Vertical: 160°(Typ.)
Brightness	250cd/m ²	250cd/m ²
Dynamic contrast	20,000,000:1	20,000,000:1
Speakers	5W x 2	5W x 2
Video System	PAL DK/BG/I	PAL DK/BG/I
Audio System	DK/BG/I	DK/BG/I
Antenna impedance	75Ω	75Ω
Input Voltage	220V, 50/60Hz	220V, 50/60Hz
Power consumption	≤ 45W	≤ 45W
Standby power consumption	≤1W	≤1W
Dimensions (WxHxD) (with stand and support) (mm)	521x401.5x179.4	581.4x435.6x194.4
Wall-mounting Accessories	Optional	Optional
Wall-mounting bracket dimensions	75 x75mm M4x4 pcs (screws)	100 x100mm M4x4 pcs (screws)
Equipment Operating temperature Operating humidity Storage temperature Storage humidity	0°C~35°C 20~80% -20°C~50°C 10~90%	0°C~35°C 20~80% -20°C~50°C 10~90%

Free Manuals Download Website

<http://myh66.com>

<http://usermanuals.us>

<http://www.somanuals.com>

<http://www.4manuals.cc>

<http://www.manual-lib.com>

<http://www.404manual.com>

<http://www.luxmanual.com>

<http://aubethermostatmanual.com>

Golf course search by state

<http://golfingnear.com>

Email search by domain

<http://emailbydomain.com>

Auto manuals search

<http://auto.somanuals.com>

TV manuals search

<http://tv.somanuals.com>