



**SINGLE LINE
BUSINESS
TELEPHONES
DESK, WALL AND
TRIMLINE® MODELS**

ISSUE 3

APRIL 1986
403683022
999-500-270-IS
950-270-IS

INTRODUCTION

This booklet contains installation and removal instructions for standard modular desk or wall telephones.

Installation of the following options requires a professional installer.

- Adjunct Dialer
- SPOKESMAN® Loudspeaker
- External Speakerphone
- Headset Adapter

Contact your place of purchase for details.

Package Content

Make sure your package contains the following items:

- Telephone
- Handset
- Handset cord
- Line cord
- Number card

Modular Outlet Requirement

You must have a standard modular telephone jack, such as one of those shown below, to install your phone. If you have one of these jacks already mounted, no tools are needed.

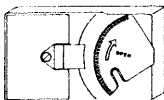
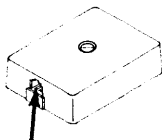
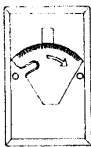
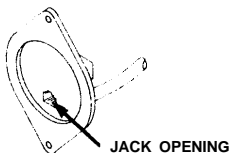

Jacks for Desk or Trimline® Telephones

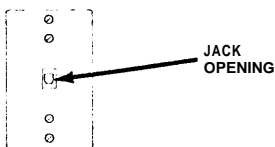

Jack For Wall Telephone

Figure 1. Standard Modular Telephone Jacks

If you do not have a standard modular telephone jack, contact your local telephone company or AT&T Information Systems for details on converting your present outlet to a modular jack.

INSTALLATION

Your telephone is fully assembled except for the coiled handset cord and clear line cord.

To Install Your Desk Or Trimline® Telephone

1. Plug one end of the coiled handset cord into the opening in the handset. Push the plug in until it clicks. (Figure 2)
2. Plug the other end of the cord into the side opening in the base. Push the plug in until it clicks.
3. Plug one end of the clear line cord into the jack in the base of the telephone. Push the plug in until it clicks.

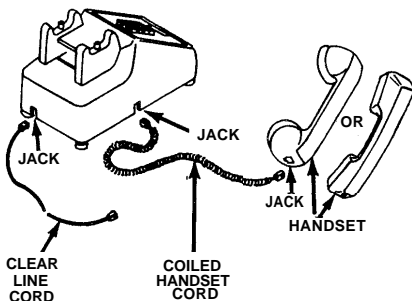

Figure 2. Desk Telephone Installation

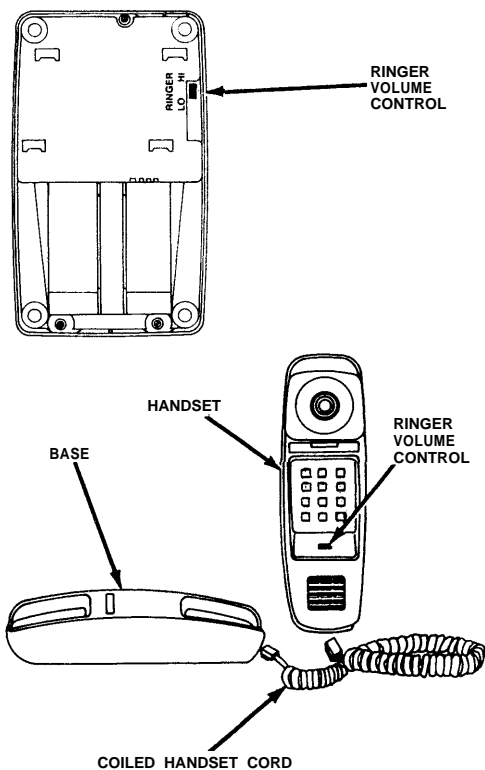

Figure 3. Setting the Ringer Volume Control (Desk and Trimline Telephones)

4. Plug the other end of the cord into the telephone jack in your office. Push the plug in until it clicks.
5. Turn your telephone over or for Trimline telephones, lift the handset. (Figure 3)
6. Set the ringer volume switch or thumbwheel to the setting you want.

To Install Your Wall Telephone

1. Align the wall phone plug with the jack, then line up the hole in the back of the telephone set with the rivets on the wall outlet plate. Push in and slide the telephone down into place. (Figure 4)

2. Plug one end of the coiled handset cord into the jack in the handset. Push the plug in until it clicks.
3. Plug the other end of the cord into the jack in the bottom of the wall base. Push the plug in until it clicks.
4. Adjust the ringer volume switch on the upper right side of the telephone to the desired setting.

For All Telephones

Place the number card on your telephone following the instructions on the back of the number card label.

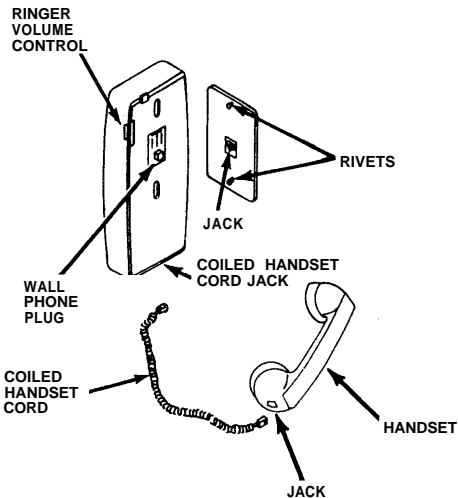

Figure 4. Wall Telephone Installation

To Remove Your Telephone

1. To disconnect or remove your telephone reverse the installation procedures. To remove any modular plug, squeeze the clip of the plug and pull it out of the jack.
2. To disconnect a wall set, slide the set up to lift it off the rivets and pull it away from the wall.

Warranty

All terms and conditions specified in your agreement with AT&T apply.

Federal Communications Commission Registration Information Statement (Part 68)

The following information is applicable only to equipment connected directly to the telephone network and not to connection of stations behind terminal systems.

The following equipment is registered with the Federal Communications Commission (FCC) in accordance with Part 68 of its Rules:

Apparatus Code*	Standard Network Interface Jack(s)
500ADM	RJ11C, RJ14C, RJ36X
500BDM	RJ11C, RJ14C, RJ36X
500MM	RJ11C, RJ14C, RJ36X
500SM	RJ11C, RJ14C, RJ36X
503CM	RJ11C, RJ14C, RJ36X
514BMW	RJ11C, RJ14C, RJ36X
514CM	RJ11C, RJ14C, RJ36X
554BMPA	RJ11W, RJ14W
2223C	RJ11C, RJ17C
2224C	RJ11W, RJ17C
2500MM	RJ11C, RJ14C, RJ36X
2500MMG	RJ11C, RJ14C, RJ36X
2500MMGB	RJ11C, RJ14C, RJ36X
2500MMGF	RJ11C, RJ14C, RJ36X
2500SM	RJ11C, RJ14C, RJ36X
2503CM	RJ11C, RJ14C, RJ36X
2504BM	RJ11C, RJ14C, RJ36X
2504CM	RJ11C, RJ14C, RJ36X
2514BM	RJ11C, RJ14C, RJ36X
2514CM	RJ11C, RJ14C, RJ36X
2554BMPA	RJ11C, RJ14W
2554BMPB	RJ11W, RJ14W

*** The apparatus code is stamped on the bottom of the set.**

In compliance with the rules, you should be aware of the following:

1. Connection of this equipment to the telephone network must be through one of the standard network interface jacks listed above. These may be ordered from the local telephone company or through AT&T Information Systems as your authorized agent.
2. Customers connecting equipment to the telephone network shall, upon request of the local telephone company, provide the following information:

- The telephone number assigned to the line used with this telephone.
- The Registration Number and the Ringer Equivalence Number (REN) from the Registration label on the bottom of the telephone.

Note: This equipment is registered to be used on telephone lines with "A" type ringing frequencies. However, some telephone companies use a variety of other ringing frequencies, e.g., "B", "C". As a result, this telephone may or may not ring properly when connected to a telephone line that provides other than "A" type ringing. Consult your AT&T Information Systems representative for advice.

3. Notify the local telephone company when this equipment is permanently disconnected from the line.
4. If trouble is experienced, the telephone set should be unplugged from the network interface to determine if the telephone set or the telephone line is the trouble source. If your telephone set is determined to be malfunctioning, it should not be reconnected until repairs are made.
5. Repairs to this equipment, other than routine repairs, can be made only by AT&T Technologies or its authorized agents.
6. If a telephone set causes harm to the telephone network, the local telephone

company may temporarily discontinue your service and, if possible, notify you in advance. If advance notice is not practical, you will be notified as soon as possible. You will be given the opportunity to correct the problem and informed of your right to file a complaint with the FCC.

The local telephone company may make changes in its facilities, equipment, operation, or procedures that could affect the proper functioning of your equipment. If they do, you will be given adequate notice in writing to allow you an opportunity to maintain uninterrupted telephone service.

Hearing Aid Compatibility

These telephones are compatible with inductively coupled hearing aids as prescribed by the Federal Communications Commission (FCC), except for Models 223C and 224C.

CAUTION

The following safety information is important to you. All of the telephones listed, with the exception of message waiting models, are NOT FOR RESIDENTIAL USE. They are sold for BUSINESS SYSTEMS APPLICATIONS ONLY. Use in a residential environment could result in an electrical short circuit when the telephone wiring is set up to provide other applications, e.g. appliance control, power transformers lighting telephones, etc. The AC power used in these applications may create a safety hazard since lifting the handset from the telephone base places a direct short circuit across the telephone wiring.

Free Manuals Download Website

<http://myh66.com>

<http://usermanuals.us>

<http://www.somanuals.com>

<http://www.4manuals.cc>

<http://www.manual-lib.com>

<http://www.404manual.com>

<http://www.luxmanual.com>

<http://aubethermostatmanual.com>

Golf course search by state

<http://golfingnear.com>

Email search by domain

<http://emailbydomain.com>

Auto manuals search

<http://auto.somanuals.com>

TV manuals search

<http://tv.somanuals.com>