



GLASS DOOR COOLERS

ATC-10

Key Features

- Forced Air Refrigeration
- Adjustable Thermostat
- Bright Interior Lighting
- Self Closing Glass Door
- Brushed Aluminum Door Frame
- Adjustable Coated Wire Shelves

| Model | Doors | Capacity cu.ft (lt) | Shelves | Exterior Dimensions inches (mm) | | | Interior Dimensions inches (mm) | | | Power (V-Hz-Ph) | Amps | HP | Crated Weight lbs (kg) |
|--------|-------|------------------------|---------|------------------------------------|-----------------|------------------|------------------------------------|-----------------|-------------|--------------------|------|-----|------------------------------|
| | | | | L | D | H | L | D | H | | | | |
| ATC-10 | 1 | 9 1/2 (269) | 4 | 24 7/8 (632) | 24 5/8 (625) | 54 1/8 (1375) | 22 (559) | 20 1/2 (520) | 35 (889) | 115.60.1 | 3 | 1/4 | 210 (95) |

Details

Cabinet Construction

- Exterior: Galvanized, pre-painted steel cabinet, gray.
- Interior: Durable ABS Plastic lining allows for easy cleaning.
- High-density, CFC-Free, polyurethane insulation.
- Four (4) low profile adjustable feet.

Door

- Self-closing door with aluminum frame and recessed side handle.
- Low-E, tempered, thermal glass door for increased efficiency and maximum product visibility.
- Strong magnetic gasket ensures a tight seal.

Shelving

- Four (4) heavy-duty coated adjustable wire shelves: 21 7/8" x 17" (556 x 432)
- Shelves slide into plastic liner and are easily adjustable in one (1) inch increments.

Lighting

- Bright, fluorescent lighting provides for maximum illumination of products.
- Utilizes T8 bulbs and an electronic ballast for increased energy efficiency and extended life.

Electrical

- Ready for connection to 115V/60Hz single phase 20 amp outlet.
- Includes an 8' cord and plug set.



NEMA 5-15R

Options

- 208-230V/50Hz
- Custom Graphics
- Additional Shelves
- 3" Heavy Duty Casters
- Various Cabinet Colors

Refrigeration System

- Forced air, environmentally friendly refrigeration system using CFC-free R134A refrigerant.
- Self-contained heated drain pan and condensate evaporation system.
- Automatic self-defrost cycle.
- Electronic temperature control maintains 34°F to 41°F (1°C to 5°C).
- Bottom mounted refrigeration unit slides out for easy maintenance and service.

Technical Drawing

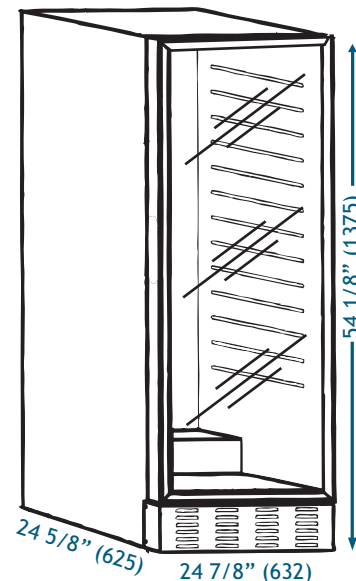

ATC-10



3235 Industry Drive • Suite C
North Charleston, SC 29418
Phone: 843-767-6855
Toll Free: 800-905-4768

Fax: 843-767-6858
Toll Free Fax: 800-906-4768
www.atcgroup.net
sales@atcgroup.net

WARRANTY

One year warranty on all parts and labor and an additional 4 year prorated warranty on compressor.

Free Manuals Download Website

<http://myh66.com>

<http://usermanuals.us>

<http://www.somanuals.com>

<http://www.4manuals.cc>

<http://www.manual-lib.com>

<http://www.404manual.com>

<http://www.luxmanual.com>

<http://aubethermostatmanual.com>

Golf course search by state

<http://golfingnear.com>

Email search by domain

<http://emailbydomain.com>

Auto manuals search

<http://auto.somanuals.com>

TV manuals search

<http://tv.somanuals.com>