

# ASPIRE RF<sup>TM</sup>

WIRELESS CONTROL SYSTEM

## Wireless Keychain Remote Control

*Control Garage Door Opener and  
ASPIRE RF<sup>TM</sup> System from your car.*

CAT. #: RFKGT

---

## User Guide

A Step-by-Step Guide for Installing and Operating  
the Wireless Keychain Remote Control

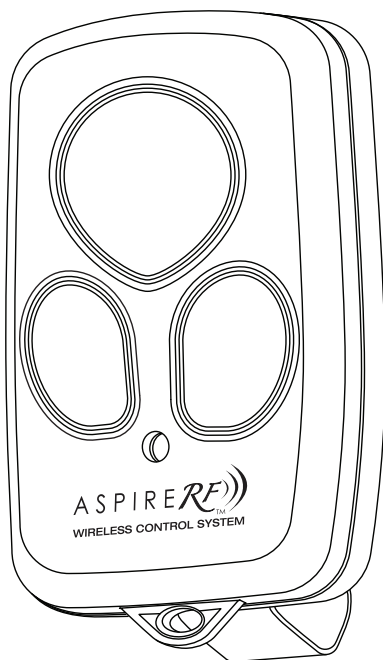

**COOPER** Wiring Devices

Thank you for purchasing the RFKGT Wireless Keychain Remote Control. ASPIRE RF products by Cooper Wiring Devices allow you to control your home by remote control. You can create a complete Home Control and Access Network by combining your Wireless Keychain Remote Control with other ASPIRE RF products. Indoor and outdoor lighting, security systems, garage door openers, and thermostats are just a few of the items you can easily control with additional ASPIRE RF products.

Your new Wireless Keychain Remote Control is compatible with Wayne-Dalton garage door openers, the Garage Door Opener Conversion Module and the Wireless Gateway to give you control of Z-Wave™ enabled modules.

**Home Control Basics**

ASPIRE RF products will allow you to easily control multiple devices in a home with the push of a button in what is known as a “scene”. Turning on all of the lights as you come home is an example of a scene. Dimming lights and closing your curtains to watch TV, is also a scene.

Visit [www.cooperwiringdevices.com/ASPIRERF](http://www.cooperwiringdevices.com/ASPIRERF) to get ideas on how to create scenes with your Remote Control and other Z-Wave™ enabled ASPIRE RF products.

**Table of Contents**

Warnings and Glossary .....2  
 Setup.....3-4  
 Examples .....5  
 Advanced Features .....6  
 Troubleshooting .....6-7  
 Compliance .....8



Look for the Quick Start symbol for basic instructions.

**Package Contents**





User Guide



RFKGT  
Wireless Keychain Remote

**WARNING - Installation Safety Precautions**

-  Never let children operate or play with door controls. Keep remote controls away from children. Fatal injury could result should a child become trapped between the door and the floor.
-  Always keep moving door in sight and keep people and objects away until it is completely closed. To prevent serious injury or death, avoid standing in the open doorway or walking through the doorway while door is moving.

## Glossary

**Copy** – See Replicate.

**Delete** – Erase transmitter or SCENE information from Controller. Also known as Exclude.

**Device** – Any item that is connected to a module (for example, lamps).

**Exclude** – Remove a module from the controller.

**Include** – Add a module to the controller.

**Module** – Any ASPIRE RF or Z-Wave™ product that is controlled with a ASPIRE RF or Z-Wave™ remote controller. A module can be part of more than one scene.

**Network** – A collection of devices controlled by primary or secondary controllers operating on the same system. A network has its own unique identification code so that no one else can control the system.

**Operator** – Garage Door Opener

**Primary Controller** – The first controller used to set up your modules and network. NOTE: Only the Primary Controller can be used to include or delete modules from a network. It is recommended that you mark the primary controller for ease in modifying your network.

**Replicate** – Copy from one controller to another.

**Scene** – A scene is a series of Z-Wave™ devices programmed to turn to a specific level (on, off, dim) with the push of a button on a controller.

**Secondary Controller** – A controller containing network information about other modules within the network, and is created FROM the primary controller. Secondary controllers cannot include or delete modules to the network.

**Transmitter** – Garage Door Opener transmitter.

## Programming To Operate

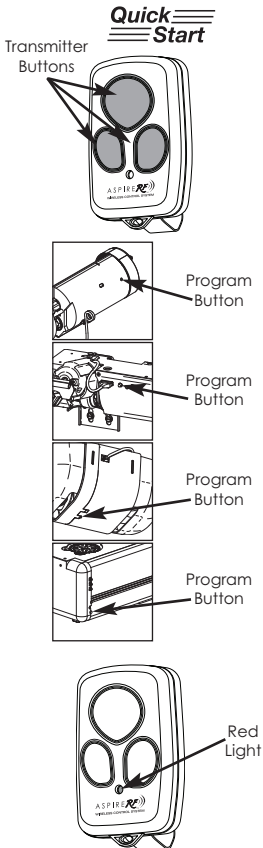

NOTE: Any of the three transmitter buttons can be programmed to activate the door. In multi-door installations, each button can be programmed to activate a separate door. Only one button at a time (per-transmitter) can be programmed to activate a door.

To program the transmitter:

1. Place the emergency disconnect handle in the manual door operated position. This is for safety reasons.
2. Press program button on Wayne Dalton DoorMaster™ light fixture, idrive®, prodrive™, Quantum™ or Classicdrive™ operator. LED will light or idrive® operator will beep once indicating that it is ready to learn a transmitter.
3. Within 30 seconds, press and hold the desired transmitter button(s); LED will turn off or idrive® operator will beep once. On the DoorMaster™ only, release the transmitter button and press again. LED will light briefly then turn off.
4. Return the emergency disconnect handle to motor operated position.
5. Press same transmitter button(s) again; door should operate. Transmitter is now programmed to operator.
6. To OPERATE, press the transmitter button.

NOTE: idrive® model only: The first transmitter command after programming will only open the door through a six inch up/down cycle. Normal door operation will then occur on all subsequent transmitter commands.

## Programming To Controller

### Quick Start

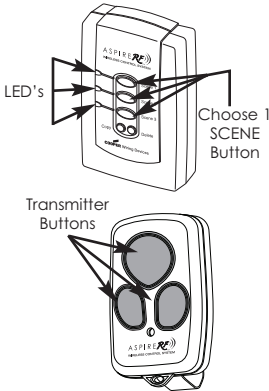

Use the following procedure to program the Wireless Keychain Remote control button to a SCENE button on the Wireless Gateway, RFBGD. This procedure also is used to reassign a transmitter button to a different SCENE button.

1. Press and Hold SCENE button you wish to program, either Scene 1, 2 or 3, until the LED turns off, then immediately release the SCENE button.
2. Press and hold the desired Keychain Remote Control button.

The LED on the Wireless Gateway will flash three (3) times quickly to indicate the programming is successful.

3. Release the transmitter button.

Note: Your Keychain Remote cannot directly operate Z-Wave™ modules, the Z-Wave™ modules must be programmed to the Gateway Scene to which you have programmed your transmitter button.

4. To OPERATE, plug the Wireless Gateway into AC power, then press the transmitter button corresponding to the programmed SCENE which you want to activate.

Best Practice Tip: Program the garage door opener to a button by itself and SCENE's to their own transmitter buttons.

## Programming To Conversion Module

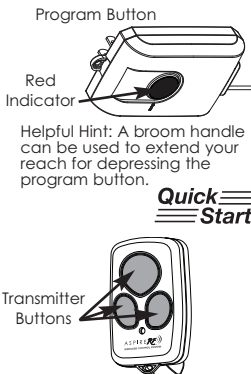

Use the following procedure to program the Wireless Keychain Remote control button to a ASPIRE RF Garage Door Opener Conversion Module, Model RFUGR. This module will allow your Keychain Remote Control to operate any brand Garage Door Opener.

1. Install the Garage Door Opener Conversion Module per the instructions provided with it.
2. Press and release the PROGRAM button on the Conversion Module. The red indicator will turn on.
3. Press and release the desired transmitter button.

The Red LED indicator will flash to indicate as successful operation.

4. To OPERATE, press the transmitter button corresponding to the Conversion module.
4. Release the transmitter button.

## Examples Of Scenes

The following examples describe how your Wireless Gateway can be used. For further ideas, please visit our website at [www.cooperwiringdevices.com/ASPIRERF](http://www.cooperwiringdevices.com/ASPIRERF).

1. Approaching your home in your car, you wish to turn on the outside lights near the garage, front door and rear door, as well as a lamps in the kitchen and family room. Wireless Gateway SCENE 1 can be programmed to turn all of these lights ON. To operate SCENE 1 from your car, you will also need to program one button of the remote located in your car to SCENE 1.

Examples require the following modules:

- 1 - Wireless Gateway, RFBGD
- 1 - Keychain Remote, (RFKGT) or any built-in vehicular remote control
- 3 - Dimmer Switch, RF9534 (for each light switch)
- 2 - Lamp Module, RFLDM (for lamp in kitchen and family room)

## Examples Of Scenes

2. In your car and leaving your home you wish to turn off the outside lights near the garage, front door and rear door, as well as interior lights and appliances. Wireless Gateway SCENE 2 can be programmed to turn all of these modules OFF and to turn ON the security alarm. To operate SCENE 2 from your car, you will also need to program one button of the remote located in your car to SCENE 2.

- 1 - Wireless Gateway, RFBGD
- 1 - Keychain Remote, (RFKGT) or any built-in vehicular remote control
- 3 - Dimmer Switch, RF9534 (for each light switch)
- 2 - Lamp Module, RFLDM (for lamp in kitchen and family room)

3. Noises outside your home awaken you during the night. SCENE 3 is programmed to turn on only the outside lights. You can turn on SCENE 3 with your Keychain Remote from your bedroom to illuminate the area and scaring off any potential intruders.

- 1 - Wireless Gateway, RFBGD
- 1 - Keychain Remote, RFKGT
- 3 - Dimmer Switch, RF9534 (for each light switch)
- 2 - Switches, RF9501 (for exterior lights)

4. Lights out! You have tucked your 2 children in bed and one has your permission to read for 15 minutes while the other has your permission to watch TV for 15 minutes. After 15 minutes you want to turn off their lights and TV. SCENE 2 is programmed to their bedroom lights, lamps and to a TV in the child's room. Using your Keychain Remote you can turn their lights and TV off.

- 1 - Wireless Gateway, RFBGD
- 1 - Keychain Remote, RFKGT
- 2 - Dimmer Switch, RF9534 (for each light switch)
- 2 - Lamp Module, RFLDM (for lamp in kitchen and family room)
- 1 - Appliance Module, RFAPM (for the TV)

## Button Combinations



Press two transmitter buttons at the same time

Use this procedure to program your Keychain Remote for up to 6 actions.

In any of the previous programming instructions at the point where you need to activate a transmitter button to complete the programming step, simply simultaneously press a combination of any two buttons. Then to activate that programmed action, simultaneously press those two buttons.

Example of Use: Single Big button is programmed only to activate Garage Door Opener, while each of the two smaller buttons are programmed to SCENE 1 and 2 of the Gateway Module. SCENE 3 of the Gateway module can be programmed to activate by pressing the two smaller buttons at the same time.

## Troubleshooting

**Problem:**  
The range of the transmitter is reduced.

**Solution:**  
Replace Battery.

**Problem:**  
The LED (light) on the transmitter does not turn on when pressed.

**Solution:**  
To change the batteries, insert a coin in the coin slot and twist to access the battery compartment. Your transmitter may use one or two CR2016 batteries. Remove the batteries from the battery cage and replace with fresh batteries. Be sure to maintain the correct polarity (+).

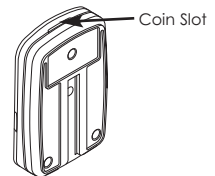

## Troubleshooting

**Problem:**  
One of my Wireless Gateway SCENES is not working.

**Solution:**  
The Cooper Wiring Devices Wireless Gateway can be activated by up to 12 transmitter programs. When exceeded the last one programmed will be dropped.

**Problem:**  
My operator no longer works with my remote.

**Solution:**  
The Wayne Dalton operator can be activated by up to six remote control devices (including wall station and keyless entry controls). If a seventh control is programmed, one of the programmed controls will be overwritten and will no longer activate the operator. To clear the programming of all remote control devices, press and hold the DoorMaster™ light fixture program button, idrive®, Quantum™ or Classic drive™ operator program button for approximately ten seconds. When the DoorMaster™, Quantum™, Classic drive™ status LED goes out or idrive® operator beeps three times, then all controls are erased.

## Compliance

Covered by one or more of the following Wayne Dalton Patents D413,055; D413,579; D413,867; D421,031; D472,568; D472,910; D473,573; D473,574; D505,393; 5,929,580; 5,931,212; 6,078,249; 6,161,438; 6,145,570; 6,164,014; 6,325,134; 6,326,751; 6,326,754; 6,401,792; 6,561,255; 6,561,256; 6,568,454; 6,588,156; 6,605,910; 6,667,591; 6,739,372; 6,845,804; 6,851,465; 6,873,127; 6,880,609; 6,903,650. Other US and Foreign Patents pending.

Z-Wave™ is a trademark of Zensys Corp.

## FCC and IC Statement

### FCC Regulatory Information:

NOTE: This equipment has been tested and found to comply with the limits for a Class B digital device, pursuant to Part 15 of the FCC Rules. These limits are designed to provide reasonable protection against harmful interference in a residential installation. This equipment generates, uses, and can radiate radio frequency energy and, if not installed and used in accordance with the instruction, may cause harmful interference to radio communications. However, there is no guarantee that interference will not occur in a particular installation. If this equipment does cause harmful interference to radio or television reception, which can be determined by turning the equipment off and on, the user is encouraged to try and correct the interference by one or more of the following measures:

- a) reorient or relocate the receiving antenna,
- b) increase the separation between the equipment and receiver,
- c) connect the equipment into an outlet on a circuit different from that to which the receiver is connected.

Consult the dealer or an experienced radio/TV technician for help.

### IC Regulatory Information:

This Class B digital apparatus meets all requirements of the Canadian Interference Causing Equipment Regulations. Operation is subject to the following two conditions: (1) this device may not cause harmful interference, and (2) this device must accept any interference received, including interference that may cause undesired operation of the device.

**WARNING:** Changes or modifications to this receiver not expressly approved by Cooper Wiring Devices could void the user's authority to operate this equipment.

## Warranty

### YOUR COOPER WIRING DEVICES ASSEMBLED PRODUCT ONE YEAR LIMITED WARRANTY

For a period of 1 year from the date of purchase, Cooper Wiring Devices will replace or repair the Wireless Keychain Remote Control provided that it has not been subject to abuse, improper installation or improper use, and is returned prepaid to Cooper Wiring Devices Quality Control Department at 203 Cooper Circle, Peachtree City, GA 30269. If the product has been discontinued, replacement will be made with the nearest available equivalent model. This warranty does not cover consumables (such as fuses). Proof of purchase in the form of a bill of sale or receipted invoice that shows that the item is within the applicable warranty period must be presented to obtain the repair or replacement provided by the warranty. Repair or replacement as provided under this warranty is the exclusive remedy of the customer. Cooper Wiring Devices shall not be liable for any incidental or consequential damages for breach of any express or implied warranty on any of its products. Except to the extent limited or prohibited by applicable law, any implied warranty of merchantability or fitness for a particular purpose on this product is limited in duration to the duration of this warranty. Some states do not allow the exclusion or limitation of incidental or consequential damages, or allow limitations on how long an implied warranty lasts, so the above limitations may not apply to you. This warranty gives you specific legal rights and you may also have other rights which vary from state to state.



#### IN U.S.A.:

Cooper Wiring Devices  
203 Cooper Circle  
Peachtree City, GA 30269  
866-853-4293  
Made in China

#### IN CANADA:

Cooper Wiring Devices  
5925 McLaughlin Road,  
Mississauga, Ontario L5R 1B8  
800-267-1042  
Fabrique en Chine

#### Importado por

**(si se vende en México):**  
Industrias Royer, S.A. de C.V.  
Tres Anegas #404  
Col. Nueva Industrial Vallejo  
C.P. 07700, México D.F.  
01-5747-4519  
Hecho en China

## Free Manuals Download Website

<http://myh66.com>

<http://usermanuals.us>

<http://www.somanuals.com>

<http://www.4manuals.cc>

<http://www.manual-lib.com>

<http://www.404manual.com>

<http://www.luxmanual.com>

<http://aubethermostatmanual.com>

Golf course search by state

<http://golfingnear.com>

Email search by domain

<http://emailbydomain.com>

Auto manuals search

<http://auto.somanuals.com>

TV manuals search

<http://tv.somanuals.com>