

Atlona Captive Screw Ready IR Receiver

AT-IRX-CS



Introduction

The Atлона Captive Screw Ready IR Receiver provides greater distance and better IR rejection from sources such as: plasma, CFL, and LCD panels.

Features and Specifications

- Frequency range from 30 to 60 kHz
- Distance up to 10m w/no interference on axis
 - *Operational distance may vary due to interference from IR radiating sources
Ex. Sunlight, CFL, LCD, or Plasma displays
- Reception Angle: +/- 45° off axis
- Dimensions (H x W x D)

10 x 62 x 10 (mm)
0.39 x 2.44 x 0.39 (inch)
- Red status LED indicator for quick verification the IR receiver is picking up the IR remote's signal

Captive Screw

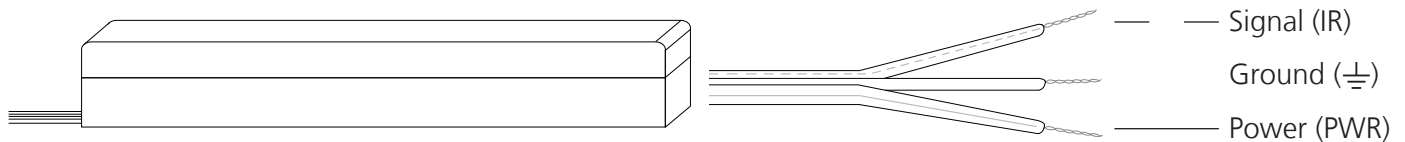

Connection Diagram

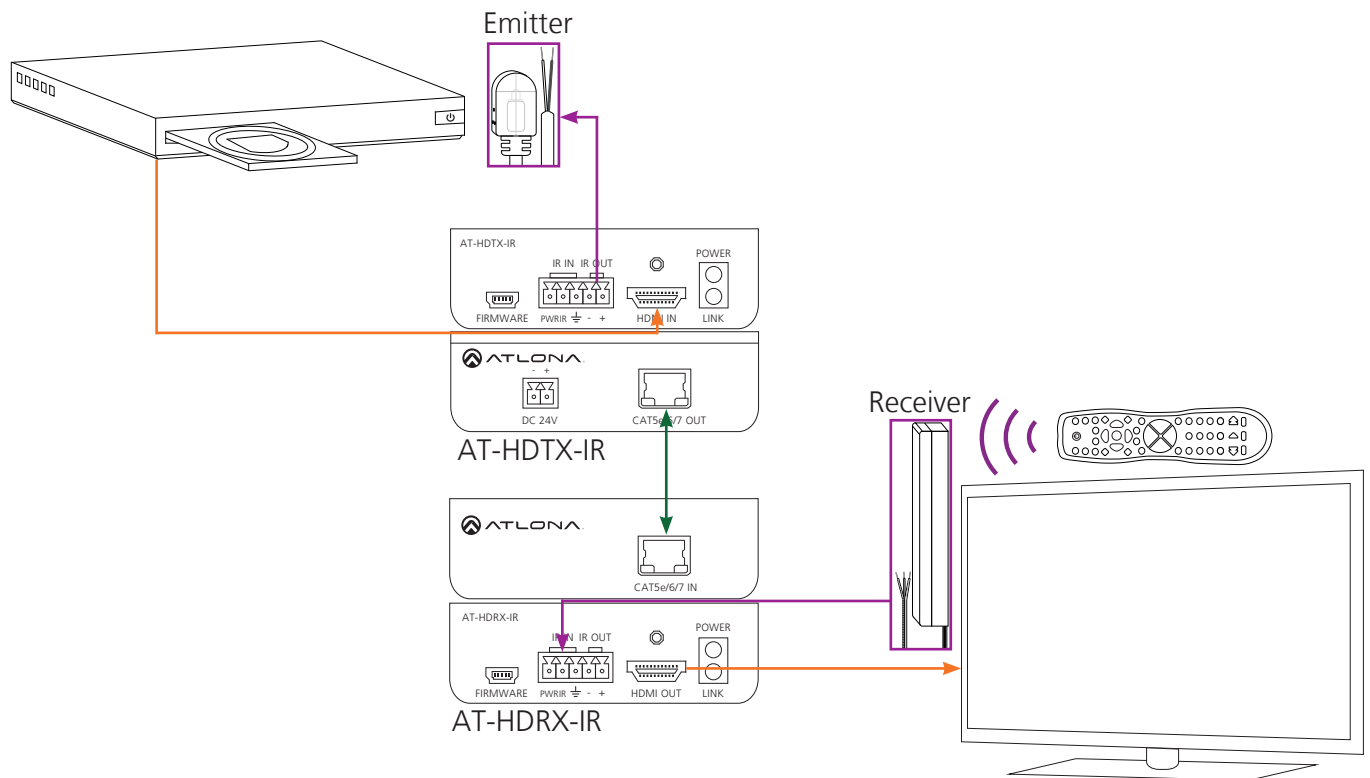

* Designed for select Atлона products

** For warranty information see http://www.atлона.com/marketing/img/limited_warranty/

Free Manuals Download Website

<http://myh66.com>

<http://usermanuals.us>

<http://www.somanuals.com>

<http://www.4manuals.cc>

<http://www.manual-lib.com>

<http://www.404manual.com>

<http://www.luxmanual.com>

<http://aubethermostatmanual.com>

Golf course search by state

<http://golfingnear.com>

Email search by domain

<http://emailbydomain.com>

Auto manuals search

<http://auto.somanuals.com>

TV manuals search

<http://tv.somanuals.com>